

# TEMPORARY DETOUR

BRIDGE NO. 650093

PROJECT REFERENCE NO. <i>BR-0118</i>		SHEET NO. 5	
RW SHEET NO.		HYDRAULICS ENGINEER	
ROADWAY DESIGN ENGINEER		HYDRAULICS ENGINEER	
<b>DOCUMENT NOT CONSIDERED FINAL UNLESS ALL SIGNATURES COMPLETED</b>			
PREPARED IN THE OFFICE OF:			
		NC FIRM LICENSE NO. C-1508 301 Fayetteville St., Suite 1500 Raleigh, NC 27601 (919) 862-7839	

**-TL-**

PI Sta 11+72.60 Δ = 21° 33' 25.0" (RT) D = 22° 55' 05.9" L = 94.06' T = 47.59' R = 250.00' e = NC	PI Sta 15+57.47 Δ = 23° 23' 40.3" (LT) D = 22° 55' 05.9" L = 102.08' T = 51.76' R = 250.00' e = RC
PI Sta 12+73.11 Δ = 24° 23' 56.4" (LT) D = 22° 55' 05.9" L = 106.46' T = 54.05' R = 250.00' e = RC	PI Sta 16+59.21 Δ = 23° 14' 41.3" (RT) D = 22° 55' 05.9" L = 101.42' T = 51.42' R = 250.00' e = NC

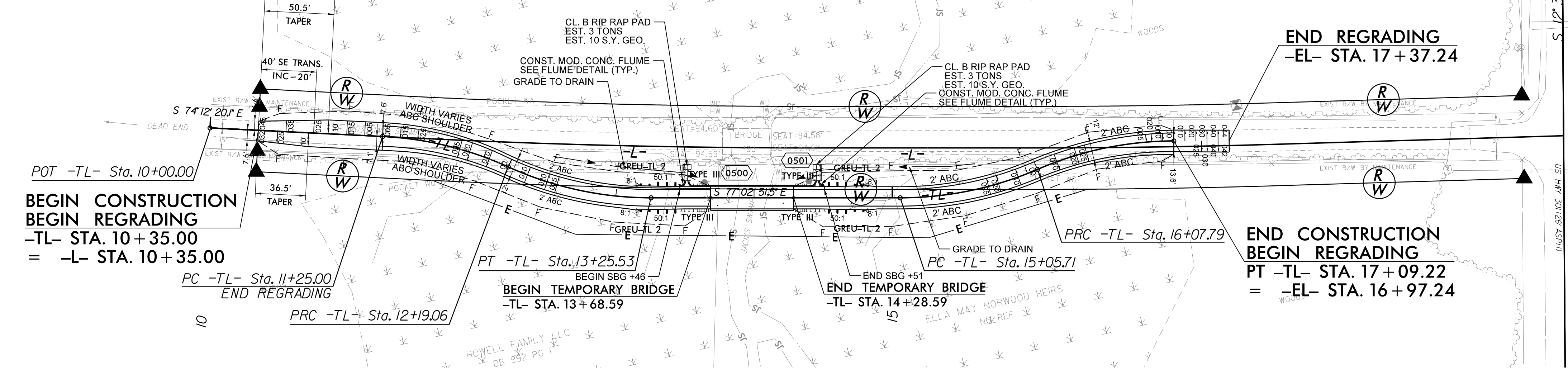

REVISIONS

