

TIP PROJECT: BR-0112

STATE	STATE PROJECT REFERENCE NO.	SHEET NO.	TOTAL SHEETS
N.C.	BR-0112	RW01	XX

STATE OF NORTH CAROLINA
DIVISION OF HIGHWAYS

SURVEY CONTROL, EXISTING CENTERLINES,
RIGHT OF WAY, EASEMENTS AND PROPERTY TIES

EDGEcombe COUNTY

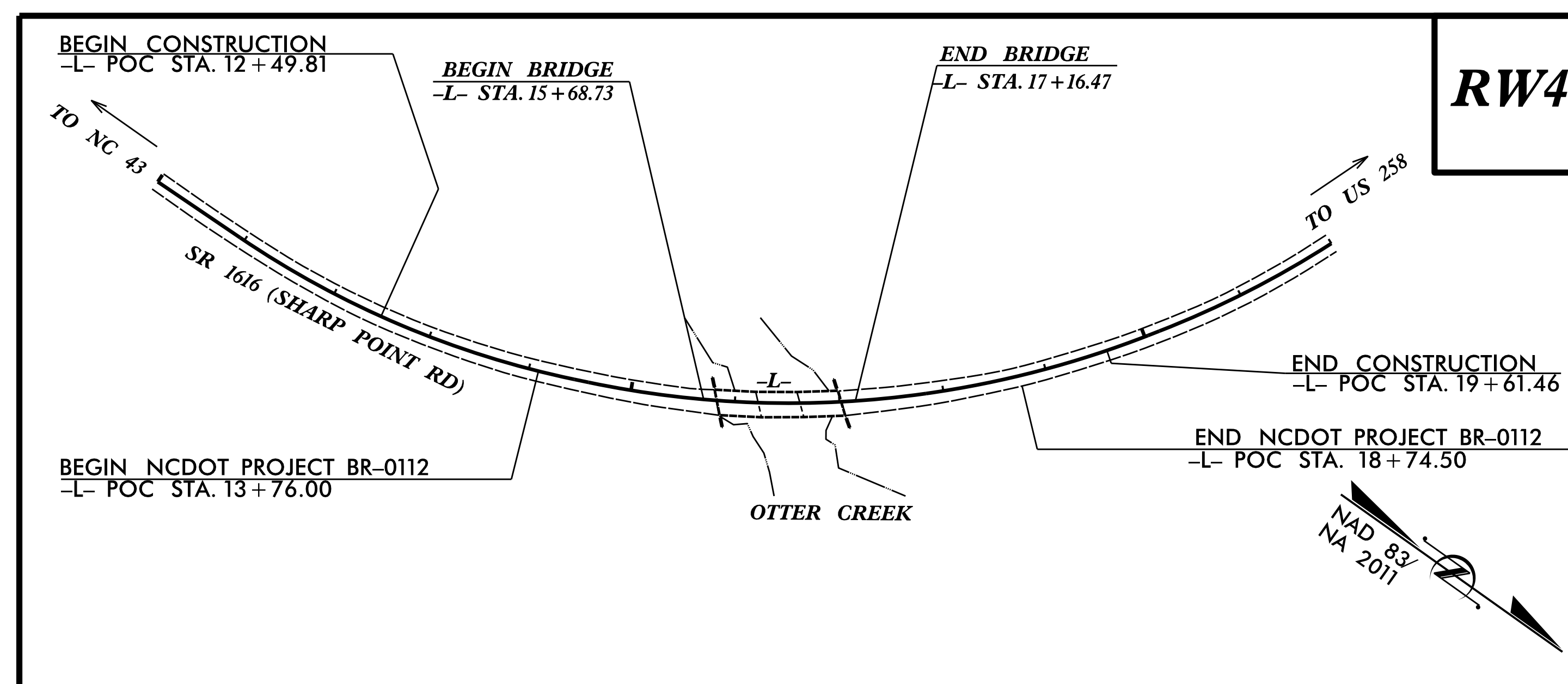

GRAPHIC SCALE

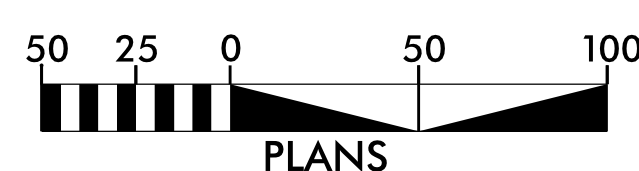

DATUM DESCRIPTION

THE LOCALIZED COORDINATE SYSTEM DEVELOPED FOR THIS PROJECT IS BASED ON THE STATE PLANE COORDINATES ESTABLISHED BY OTHERS FOR MONUMENT "BR0112-2" WITH NAD 83/NA 2011 STATE PLANE GRID COORDINATES OF NORTHING: 723,308.2480(ft) EASTING: 2,411,651.5455(ft) ELEVATION: 66.86(ft)

THE AVERAGE COMBINED GRID FACTOR USED ON THIS PROJECT (GROUND TO GRID) IS: 0.999909293825

THE N.C. LAMBERT GRID BEARING AND LOCALIZED HORIZONTAL GROUND DISTANCE FROM "BR0112-2" TO -L- STATION 10+00 IS S 12-17°00.97" W 52.28(ft)

ALL LINEAR DIMENSIONS ARE LOCALIZED HORIZONTAL DISTANCES VERTICAL DATUM USED IS NAVD 88

Prepared in the Office of:

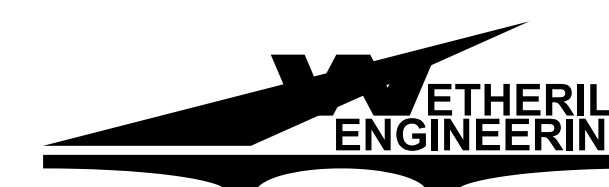

1223 Jones Franklin Rd.
Raleigh, N.C. 27606
License No. F-0377
Bus: 919 851 8077
Fax: 919 851 8107

TRANSPORTATION PLANNING/DESIGN - BRIDGE/STRUCTURE DESIGN
CIVIL/SITE DESIGN - SURVEYING - CONSTRUCTION OBSERVATION

2018 STANDARD SPECIFICATIONS

RIGHT OF WAY DATE:
9/30/2019

LETTING DATE:
7/21/2020

PROFESSIONAL LAND SURVEYOR



DocuSigned by:
Anthony K. Alford
SIGNATURE

12/2/2019
Date:

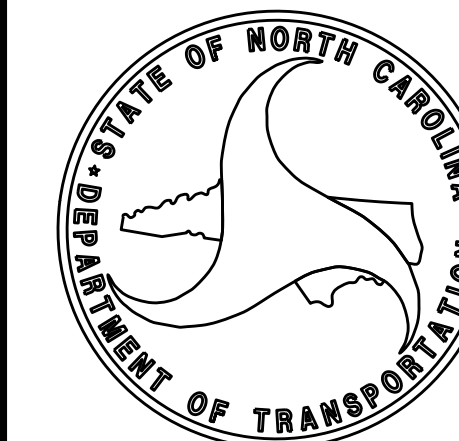

\$\$\$\$\$ SYSTEM \$\$\$\$\$\$
\$\$\$\$\$ DDN \$\$\$\$\$\$
\$\$\$\$\$ USERNAME \$\$\$\$\$\$