

## PHASING NOTES

PERFORM ALL WORK AS SHOWN IN THE CONTRACT AND BRIDGE PLANS IN ACCORDANCE WITH ALL COAST GUARD REGULATIONS & REQUIREMENTS

ALL LANE CLOSURES SHALL BE IN ACCORDANCE WITH THE MOST RECENT EDITION OF THE NCDOT STANDARD SPECIFICATIONS, STANDARD DRAWINGS AND THE TRAFFIC MANAGEMENT PLAN.

### PHASING:

USE NCDOT RSD 1101.01 SHEET 3 OF 3 TO INSTALL ADVANCED WARNING SIGNS AND DEVICES.

#### PHASE 1:

**NOTE:** AT THE END OF EACH WORK PERIOD, REMOVE ALL SIGNS, DEVICES AND FLAGGING OPERATIONS AND REOPEN THE BRIDGE AND ROADWAY TO TRAFFIC.

**STEP 1:** USE NCDOT RSD 1101.02 SHEET 1 OF 14 TO INSTALL SIGNS, DEVICES AND A FLAGGING OPERATION TO CLOSE THE RIGHT LANE OF BRIDGE #13 AND ITS APPROACHES.

**STEP 2:** PERFORM ALL WORK PER BRIDGE PLANS.

REPEAT STEPS 1 THRU 2 UNTIL ALL WORK IS COMPLETE.

#### PHASE 2:

**NOTE:** AT THE END OF EACH WORK PERIOD, REMOVE ALL SIGNS, DEVICES AND FLAGGING OPERATIONS AND REOPEN THE BRIDGE AND ROADWAY TO TRAFFIC.

**STEP 1:** USE NCDOT RSD 1101.02 SHEET 1 OF 14 TO INSTALL SIGNS, DEVICES AND A FLAGGING OPERATION TO CLOSE THE LEFT LANE OF BRIDGE #13 AND ITS APPROACHES.

**STEP 2:** PERFORM ALL WORK PER BRIDGE PLANS.

REPEAT STEPS 1 THRU 2 UNTIL ALL WORK IS COMPLETE.

#### PHASE 3:

**STEP 1:** COMPLETE ALL APPROACH ROADWAY WORK, TIE-INS AND ASSOCIATED ITEMS.

## PCMS MESSAGES

PCMS MESSAGE  
ONE WEEK  
PRIOR TO LANE CLOSURES

MESSAGE NO. 1	MESSAGE NO. 2
LANE CLOSURES	MM/DD ## AM TO ## PM

CHANGEABLE MESSAGE SIGN

PCMS MESSAGE  
DURING  
LANE CLOSURES

MESSAGE NO. 1	MESSAGE NO. 2
LANE CLOSURES	STAY ALERT

CHANGEABLE MESSAGE SIGN

PROVIDE PORTABLE CHANGEABLE MESSAGE SIGNS (PCMS) SHALL BE USED AT LEAST (7) SEVEN CALENDAR DAYS IN ADVANCE OF THE WORK AND RETAIN THESE MESSAGE BOARDS ON THE PROJECT WITH UPDATED MESSAGING THROUGHOUT THE DURATION OF THE PROJECT AND SHALL BE PLACED A MINIMUM OF 500' IN ADVANCE OF THE WORK ZONE. SEE ABOVE FOR TIMING AND MESSAGES. PCMS LOCATION CAN BE CHANGED AT THE APPROVAL OF THE ENGINEER.

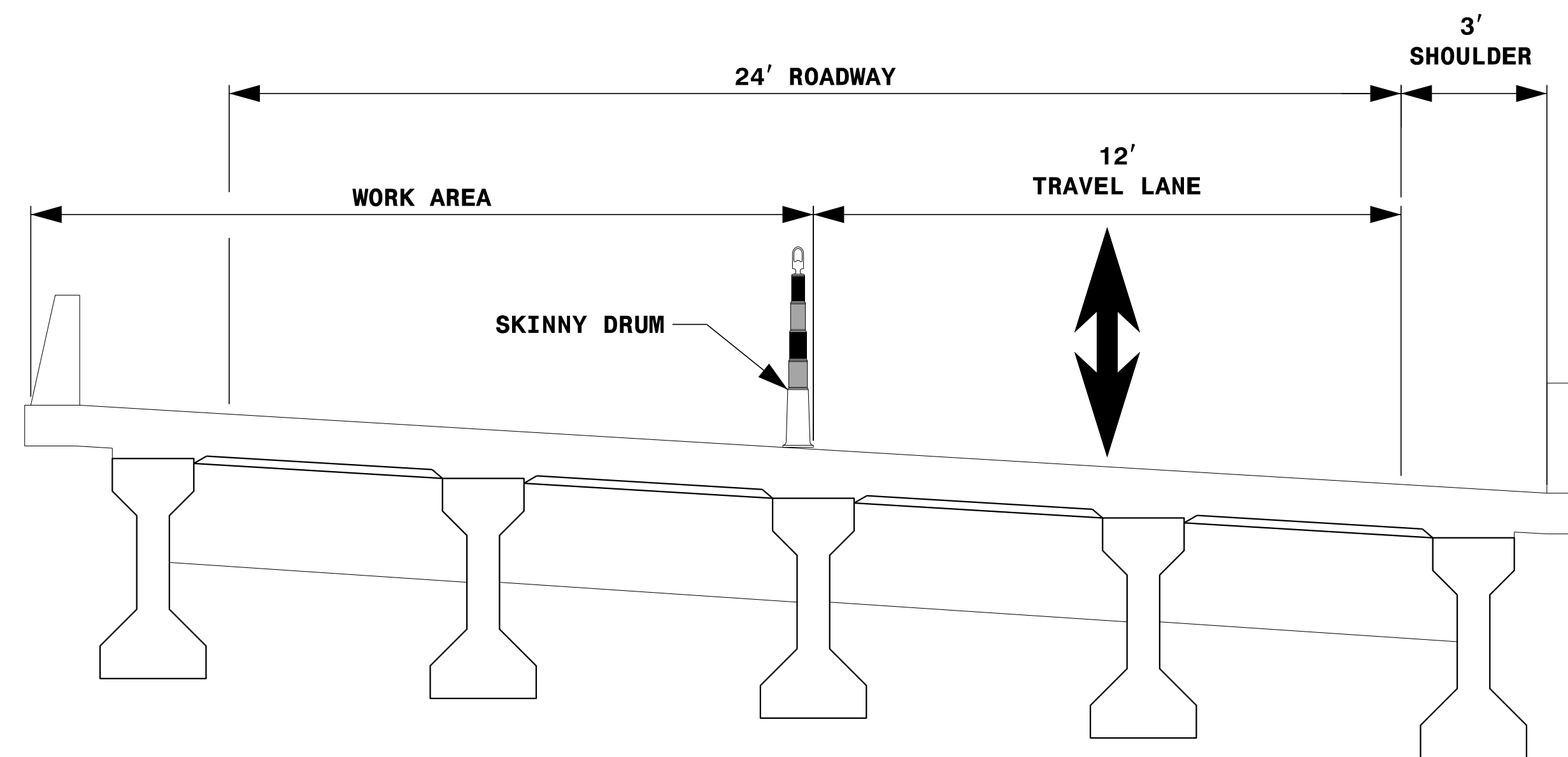

**PHASE 1**  
**TMP TYPICAL SECTION (BRIDGE #13)**

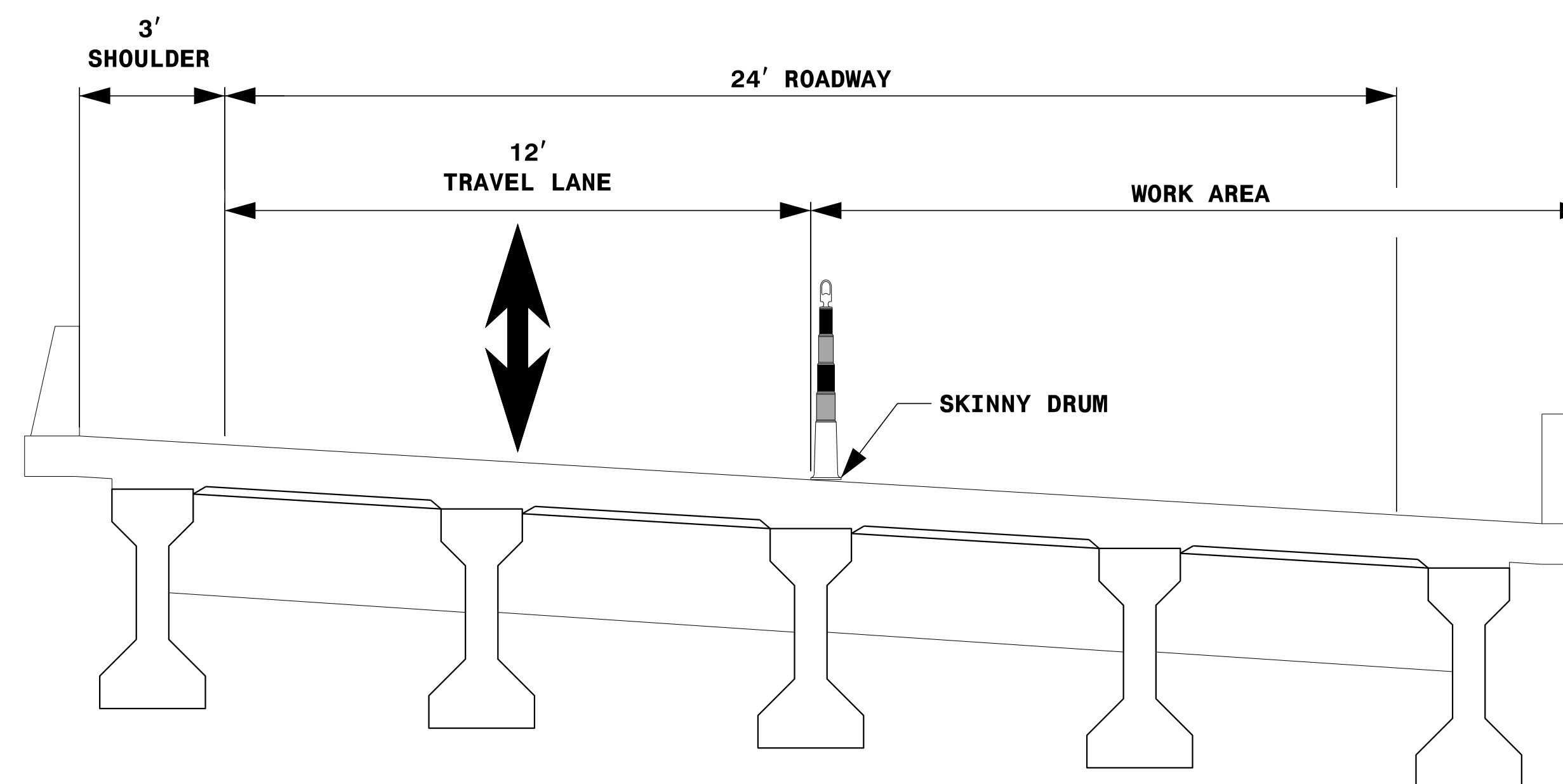

**PHASE 2**  
**TMP TYPICAL SECTION (BRIDGE #13)**

APPROVED: *Jacob H. Duke*  
DATE: 11/18/2019

SEAL

DOCUMENT NOT CONSIDERED FINAL  
UNLESS ALL SIGNATURES COMPLETED

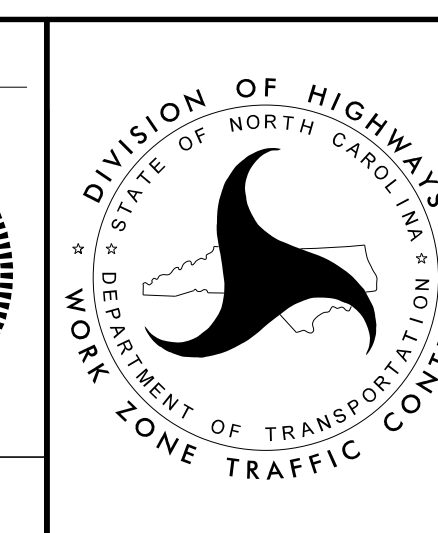

PHASING NOTES