

09, 08, 99

TIP PROJECT: BR-0127

T.I.P. NO.	SHEET NO.
BR-0127	UO-1

NOTE:
 ALL UTILITY WORK SHOWN ON THIS SHEET IS DONE BY OTHERS.
 NO PAYMENT WILL BE MADE TO THE CONTRACTOR FOR UTILITY WORK SHOWN ON THIS SHEET.

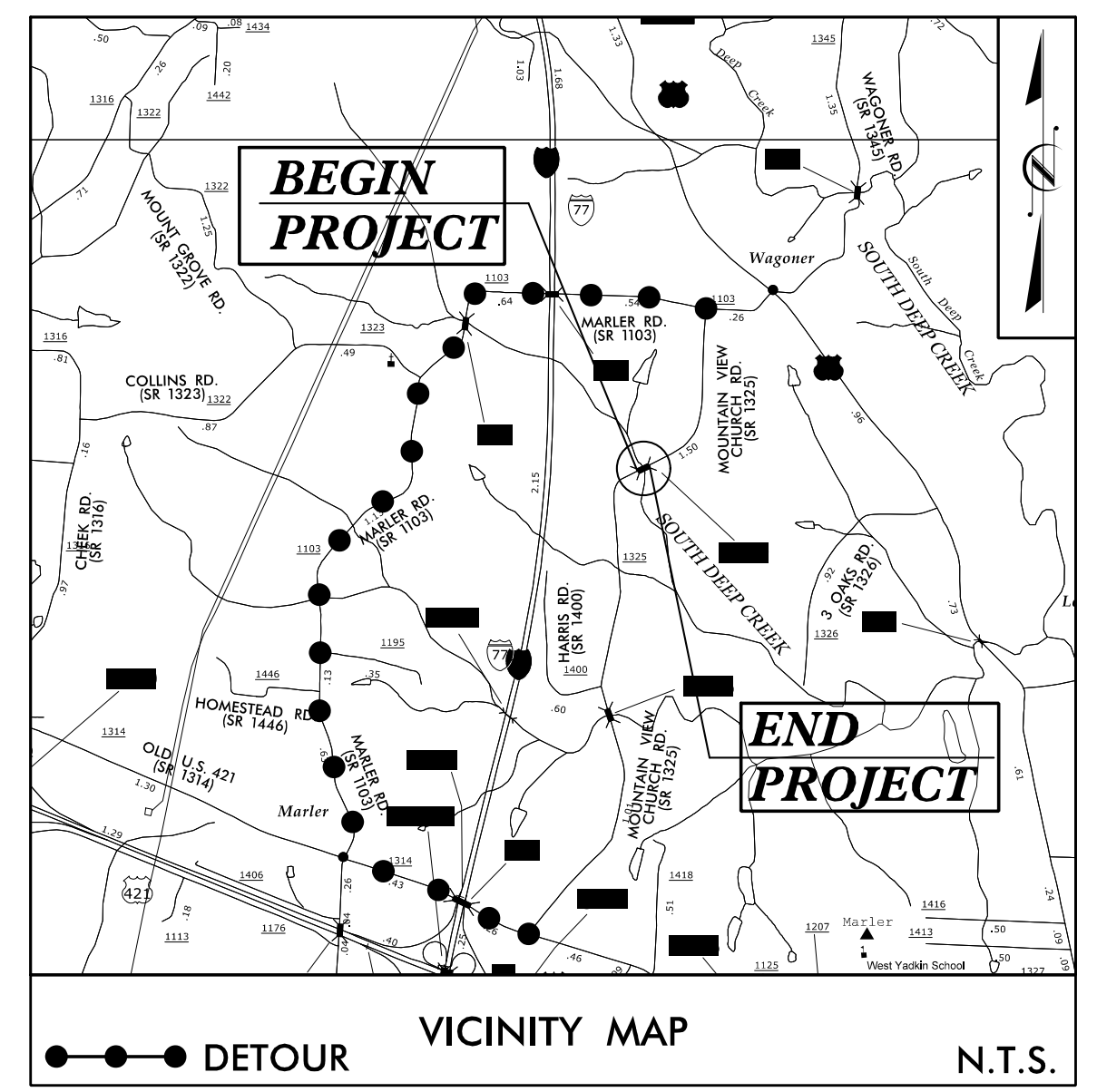
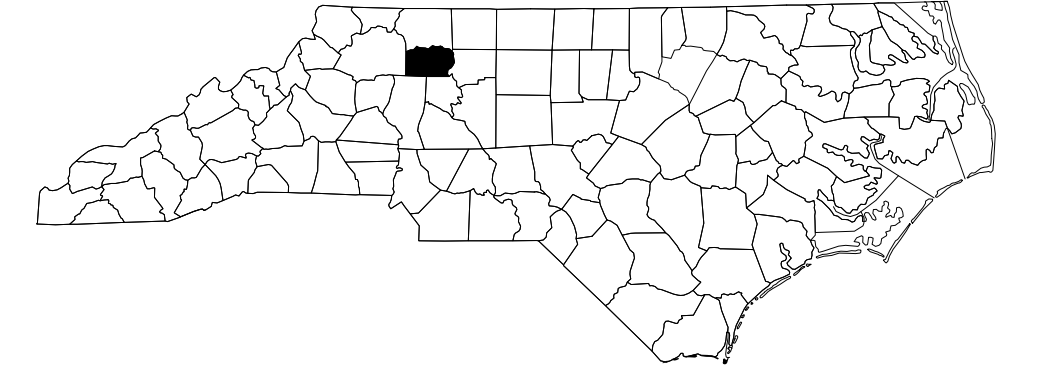

STATE OF NORTH CAROLINA
 DIVISION OF HIGHWAYS

UTILITIES BY OTHERS PLANS YADKIN COUNTY

LOCATION: BRIDGE NO. 980189 OVER UT OF SOUTH DEEP CREEK ON SR 1325 (MOUNTAIN VIEW CHURCH ROAD)
 TYPE OF WORK: GRADING, DRAINAGE, PAVING, AND STRUCTURE

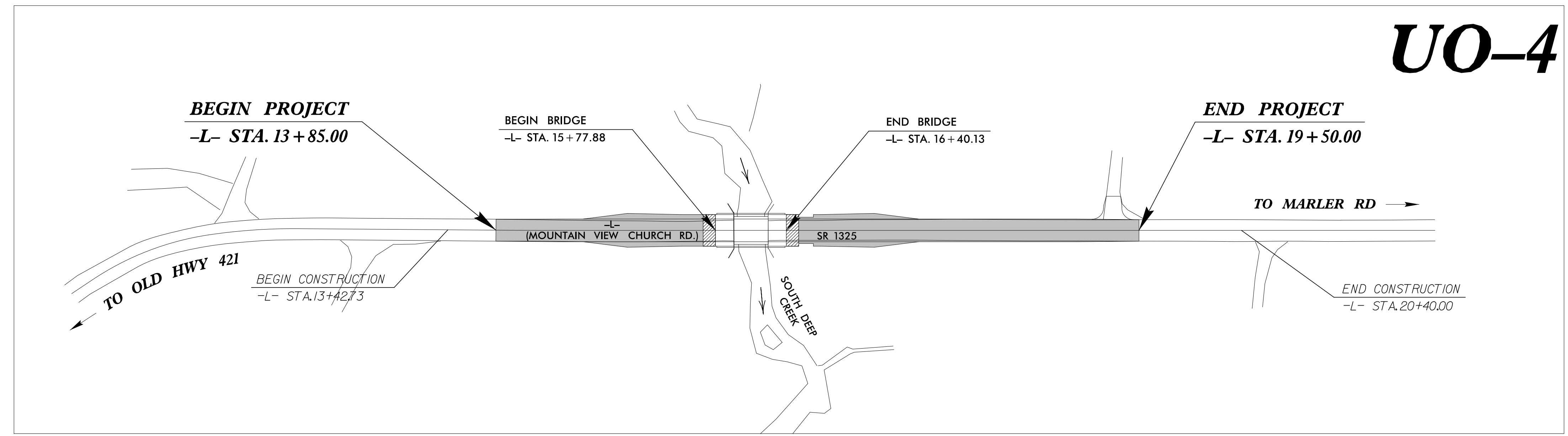
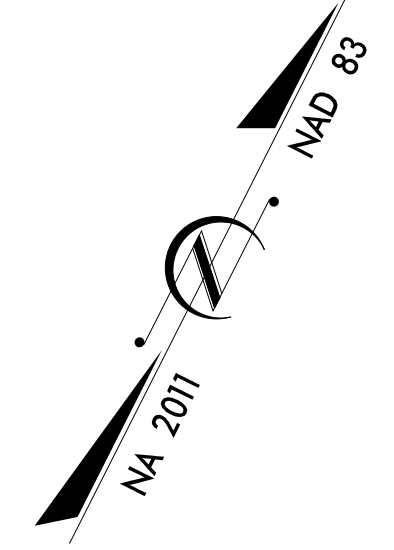

UO-4

PRELIMINARY PLANS
 DO NOT USE FOR CONSTRUCTION

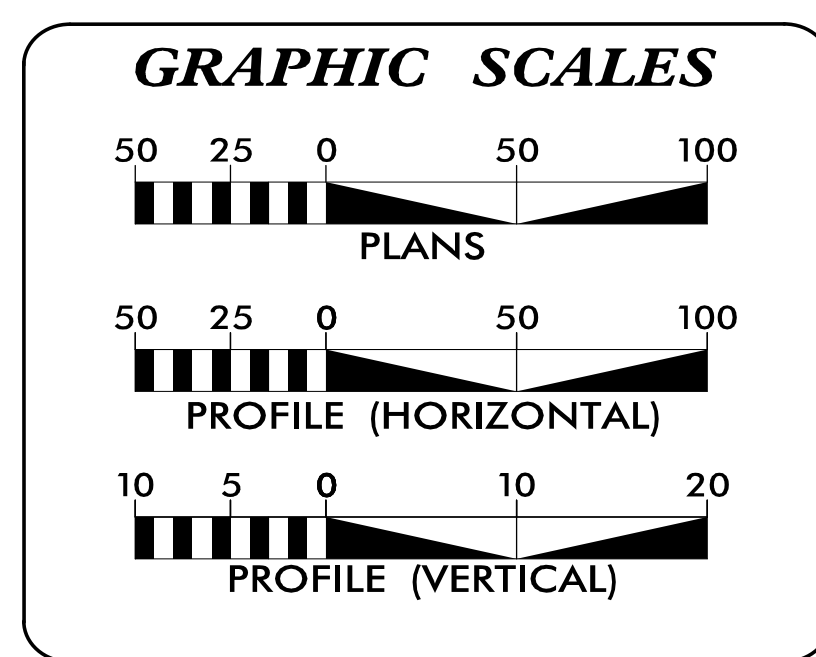

SHEET NO.:	DESCRIPTION:
UO-1	TITLE SHEET
UO-4	UBO PLAN SHEET

UTILITY OWNERS WITH CONFLICTS

(A) POWER - DUKE ENERGY
 (B) GAS - FRONTIER NATURAL GAS
 (C) TELEPHONE - YADTEL

PREPARED IN THE OFFICE OF:

STV Engineers, Inc.
 900 West Trade St., Suite 715
 Charlotte, NC 28202
 NC License Number F-0991

Oriana Hernandez UTILITY PROJECT MANAGER
 Laura Braunfeld PROJECT UTILITY COORDINATOR
 Logan Hedrick PROJECT UTILITY CAD

DIVISION OF HIGHWAYS
 UTILITIES UNIT
 1555 MAIL SERVICES CENTER
 RALEIGH, NC 27699-1555
 PHONE (919) 707-6690
 FAX (919) 250-4151

Michael Bright UTILITIES REGIONAL ENGINEER
 Donald Hampton UTILITIES ENGINEER
 Amy York UTILITIES AREA COORDINATOR
 Sunil Singh UTILITIES COORDINATOR

\$\$\$\$\$ SYSTEM \$\$\$\$\$\$
 \$\$\$ DGN \$\$\$\$\$\$
 \$\$\$ USERNAME \$\$\$\$\$\$

UTILITIES BY OTHERS

NOTE:
ALL UTILITY WORK SHOWN ON THIS SHEET WILL BE DONE BY OTHERS. NO PAYMENT WILL BE MADE TO THE CONTRACTOR FOR UTILITY WORK SHOWN ON THIS SHEET.

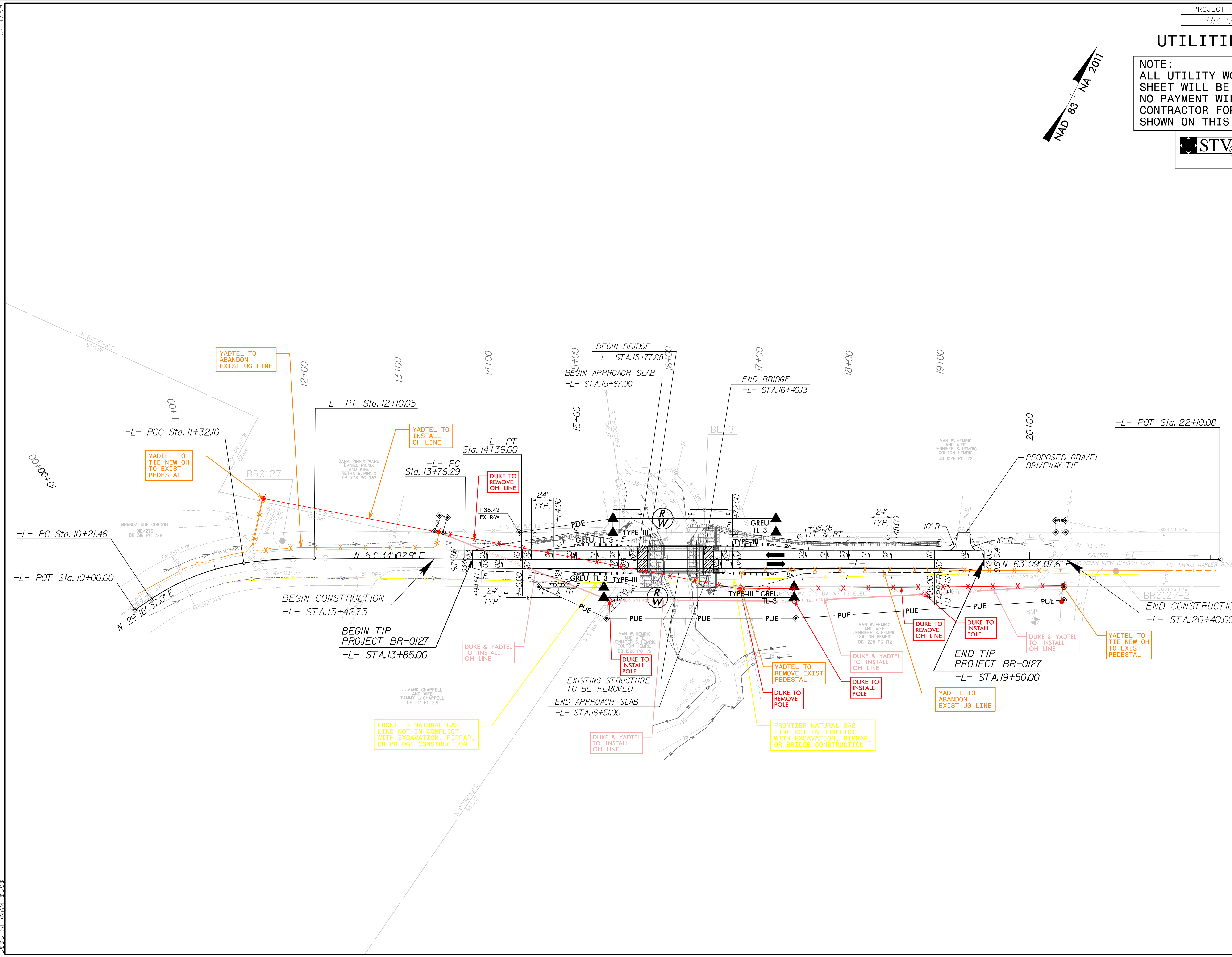
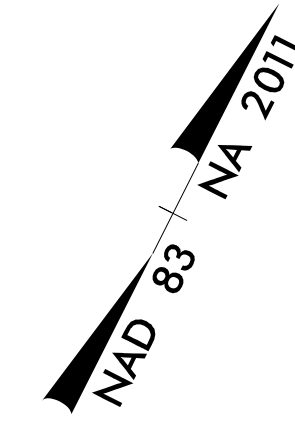

5/14/99
00-00-01
44
45
46
47
48
49
50
51
52
53
54
55
56
57
58
59
60
61
62
63
64
65
66
67
68
69
70
71
72
73
74
75
76
77
78
79
80
81
82
83
84
85
86
87
88
89
90
91
92
93
94
95
96
97
98
99
00

UTILITIES BY OTHERS

NOTE:
ALL UTILITY WORK SHOWN ON THIS SHEET WILL BE DONE BY OTHERS. NO PAYMENT WILL BE MADE TO THE CONTRACTOR FOR UTILITY WORK SHOWN ON THIS SHEET.

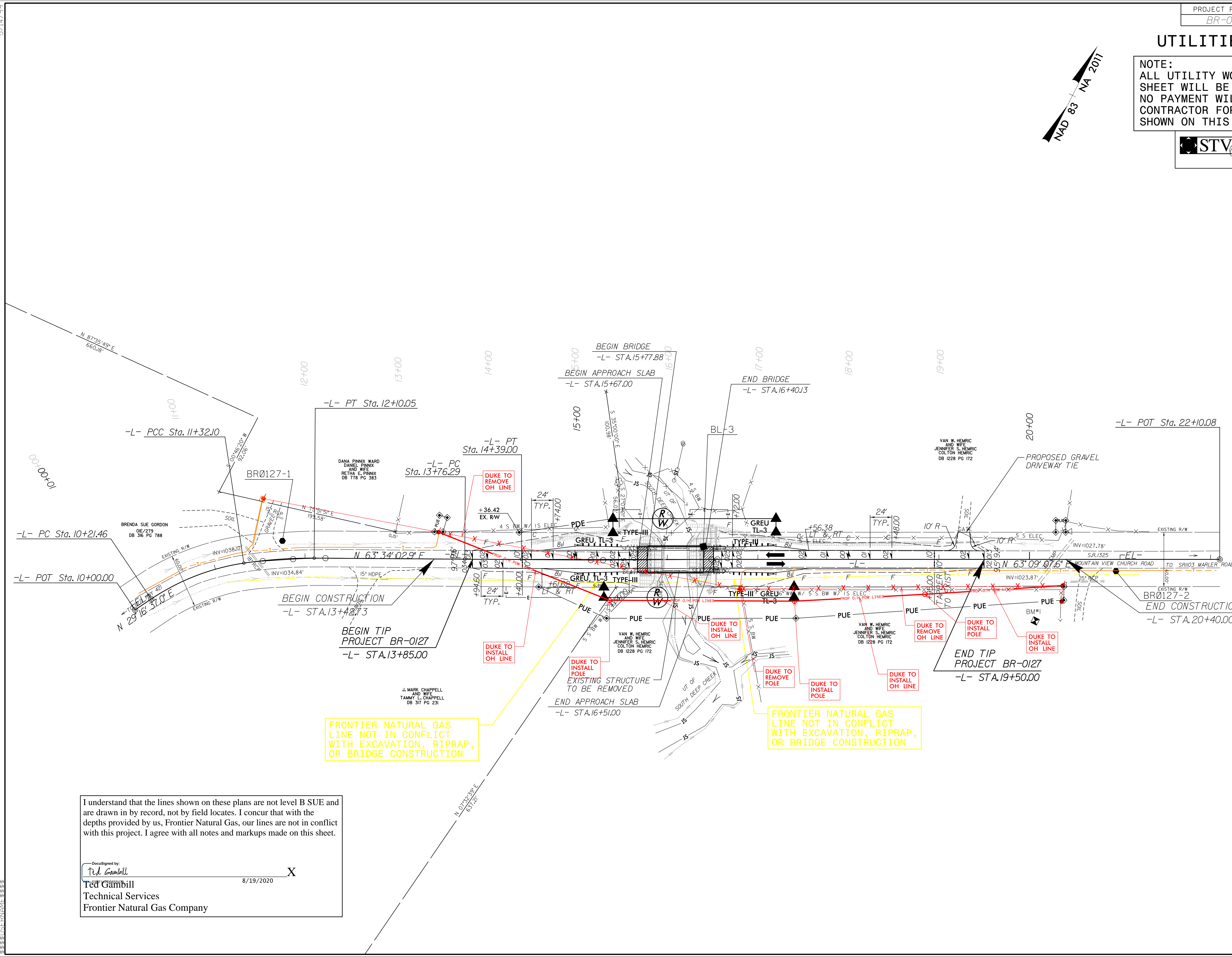
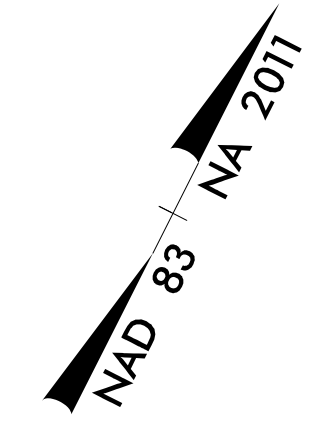
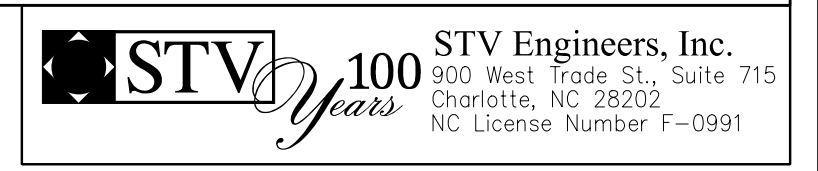

FRONTIER NATURAL GAS LINE NOT IN CONFLICT WITH EXCAVATION, RIPRAP, OR BRIDGE CONSTRUCTION

FRONTIER NATURAL GAS LINE NOT IN CONFLICT WITH EXCAVATION, RIPRAP, OR BRIDGE CONSTRUCTION

I understand that the lines shown on these plans are not level B SUE and are drawn in by record, not by field locates. I concur that with the depths provided by us, Frontier Natural Gas, our lines are not in conflict with this project. I agree with all notes and markups made on this sheet.

DocuSigned by:
Ted Gambill X
8/19/2020
Ted Gambill
Technical Services
Frontier Natural Gas Company

5/14/2020