

PROJECT LOCATION

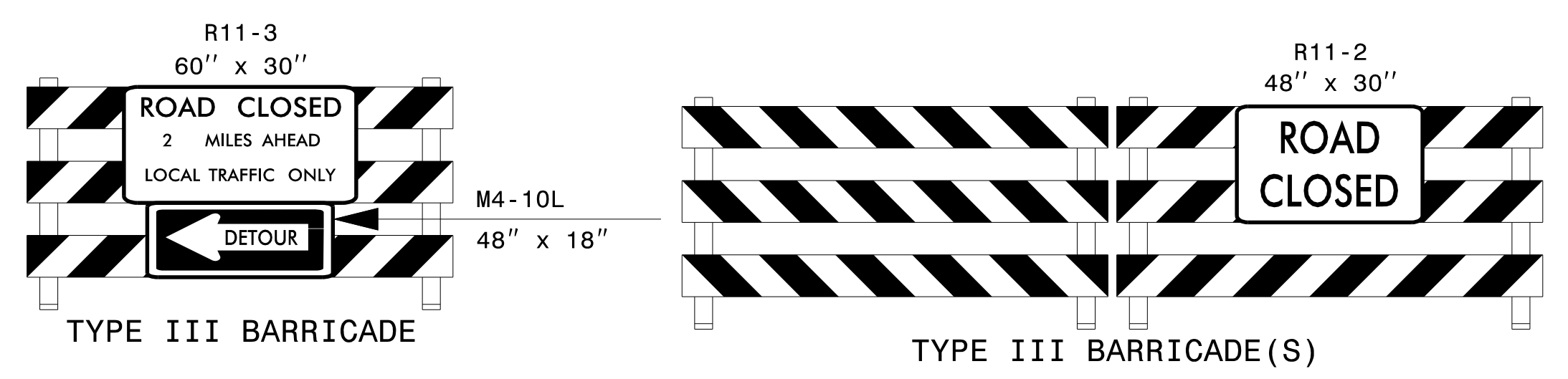

REFER TO RSD 1101.03, SHEET 1, FOR WORK ZONE SIGNS, AND SPACING, REQUIRED ALONG MOUNTAIN VIEW CHURCH RD

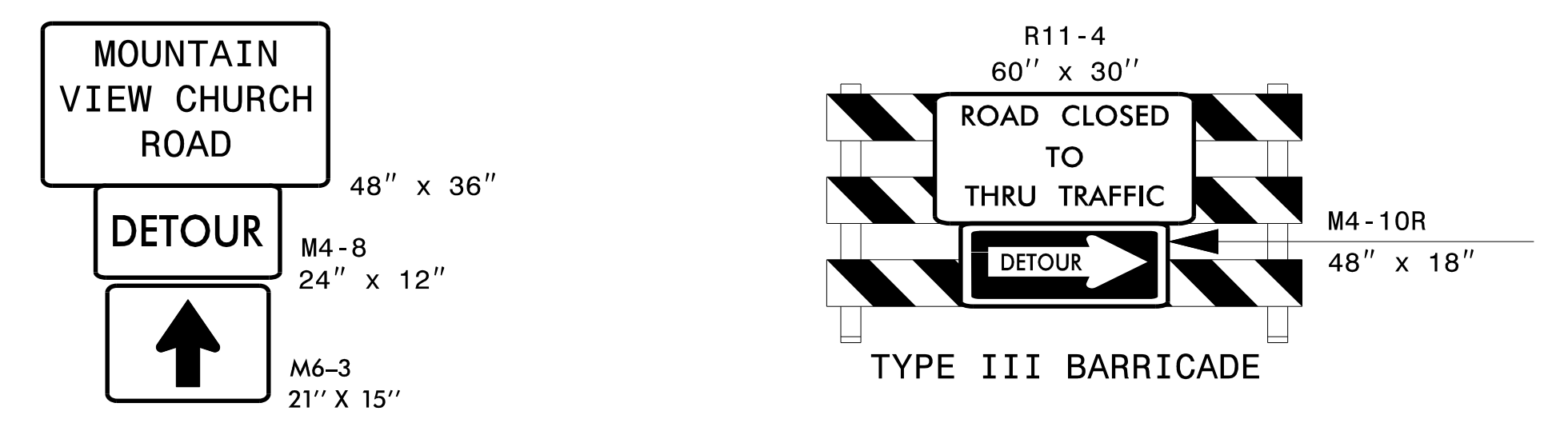
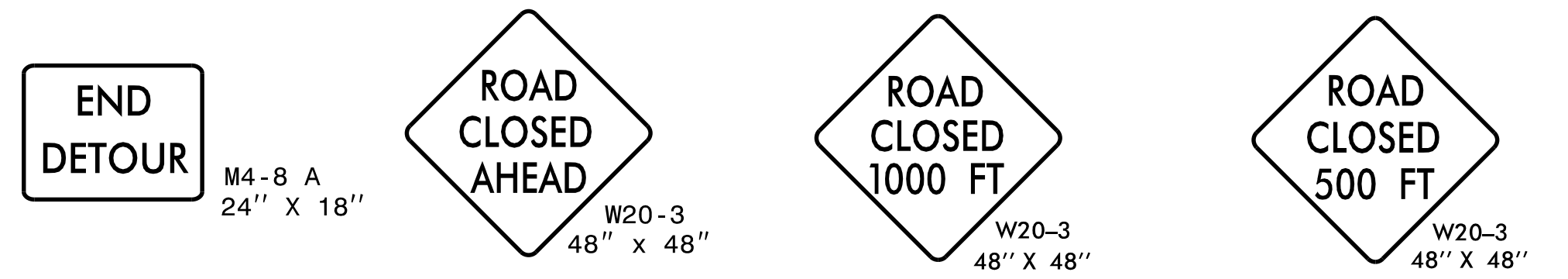
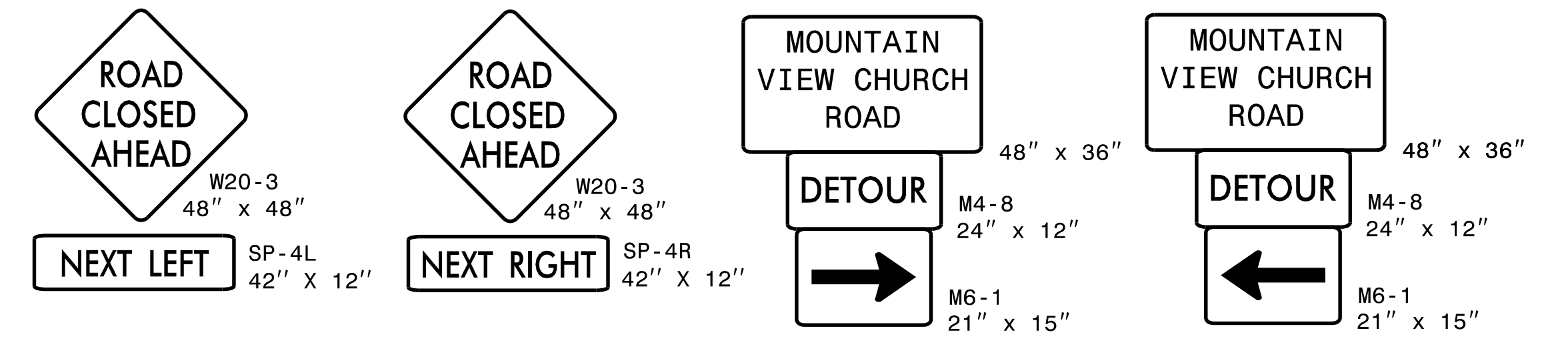

APPROVED: *Don A. Parker*
 DATE: 10/12/2020
 SEAL 043251
 DON A. PARKER
 ENGINEER

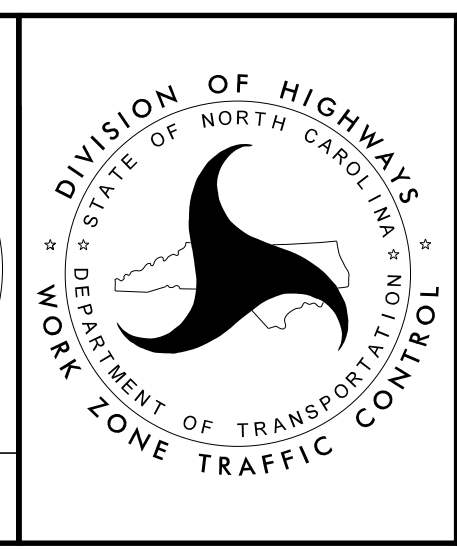

OFFSITE DETOUR ROUTE AND ROAD CLOSURE

4/28/2020 P:\TIP\Projects-B\BR0127\TrafficControl\TCP\BR-0127_TC_TMP_02.dgn User:mackfilu