

Onslow County

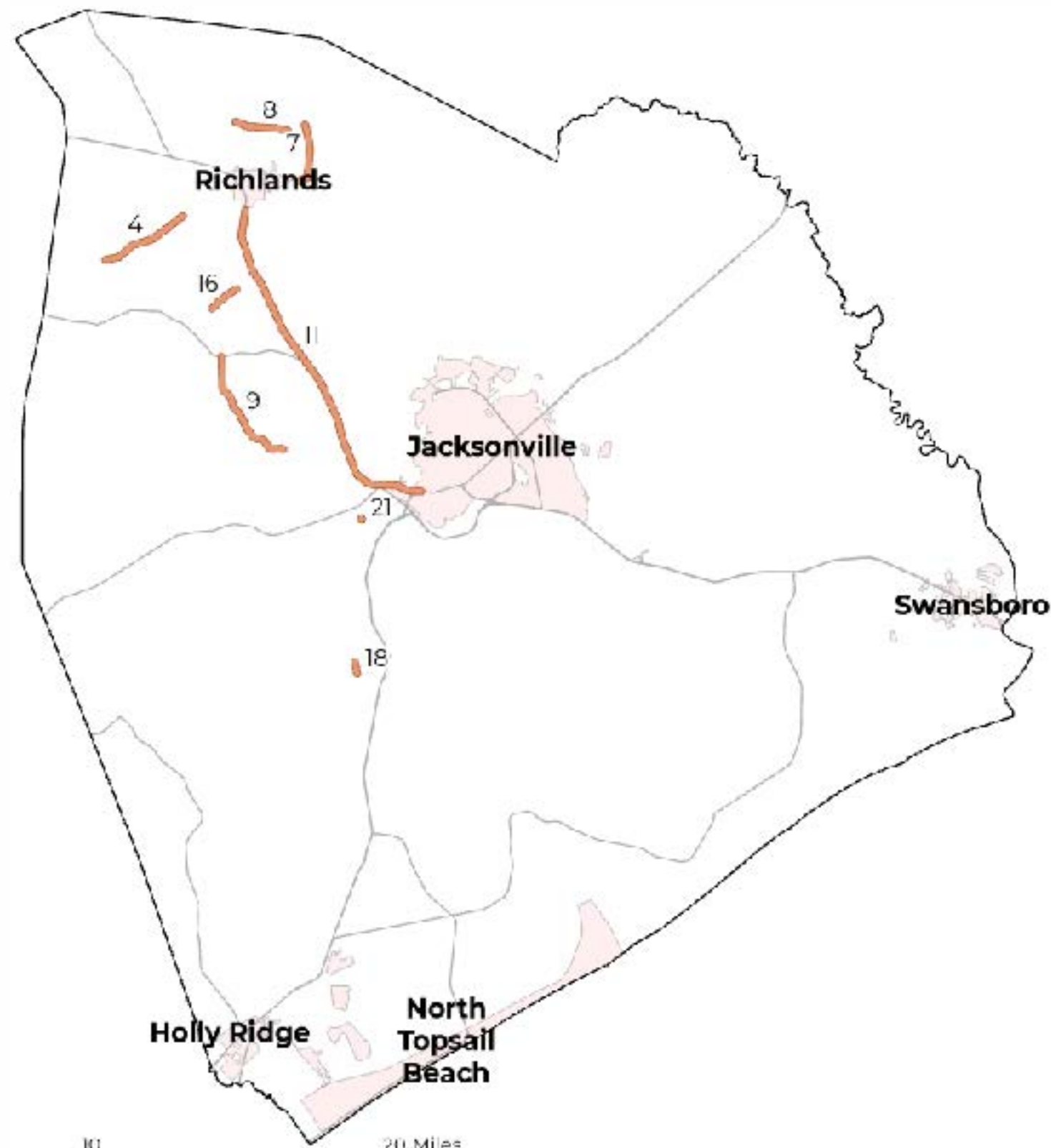

Table of Contents

Maps	Sheet No.
4, 7-9 2
11 3
16, 18, 21 4

Onslow County 4, 7-9

PROJECT REFERENCE NO.	SHEET NO
2021CPT-03-10672 ETC.	2

Legend

- Bridge
- State Maintained Road
- Road Section
- Municipality Road

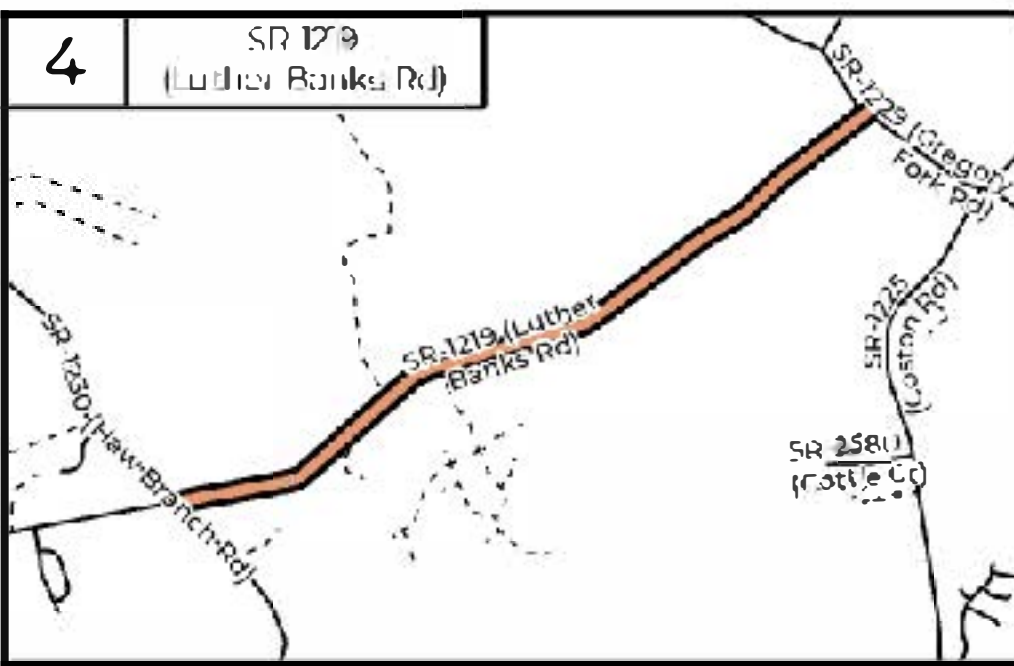
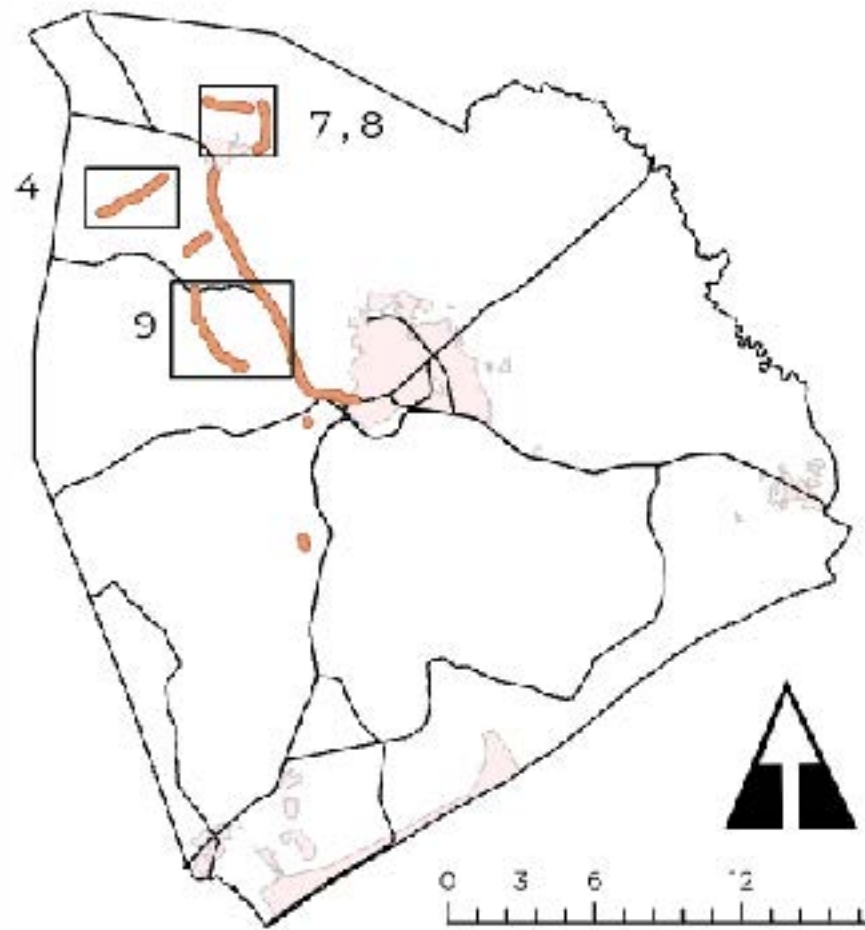

7	SR 1307 (Francktown Rd)
8	SR 1304 (Petersburg Rd)

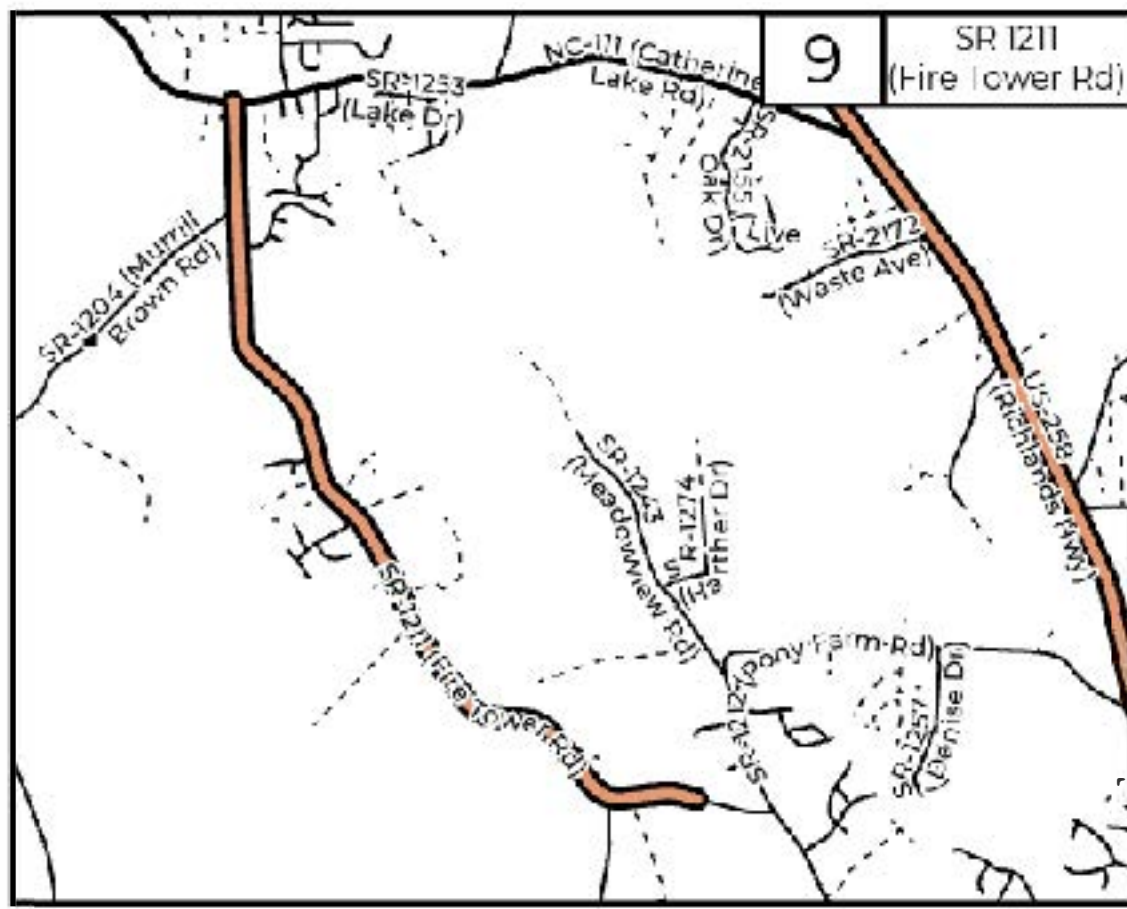
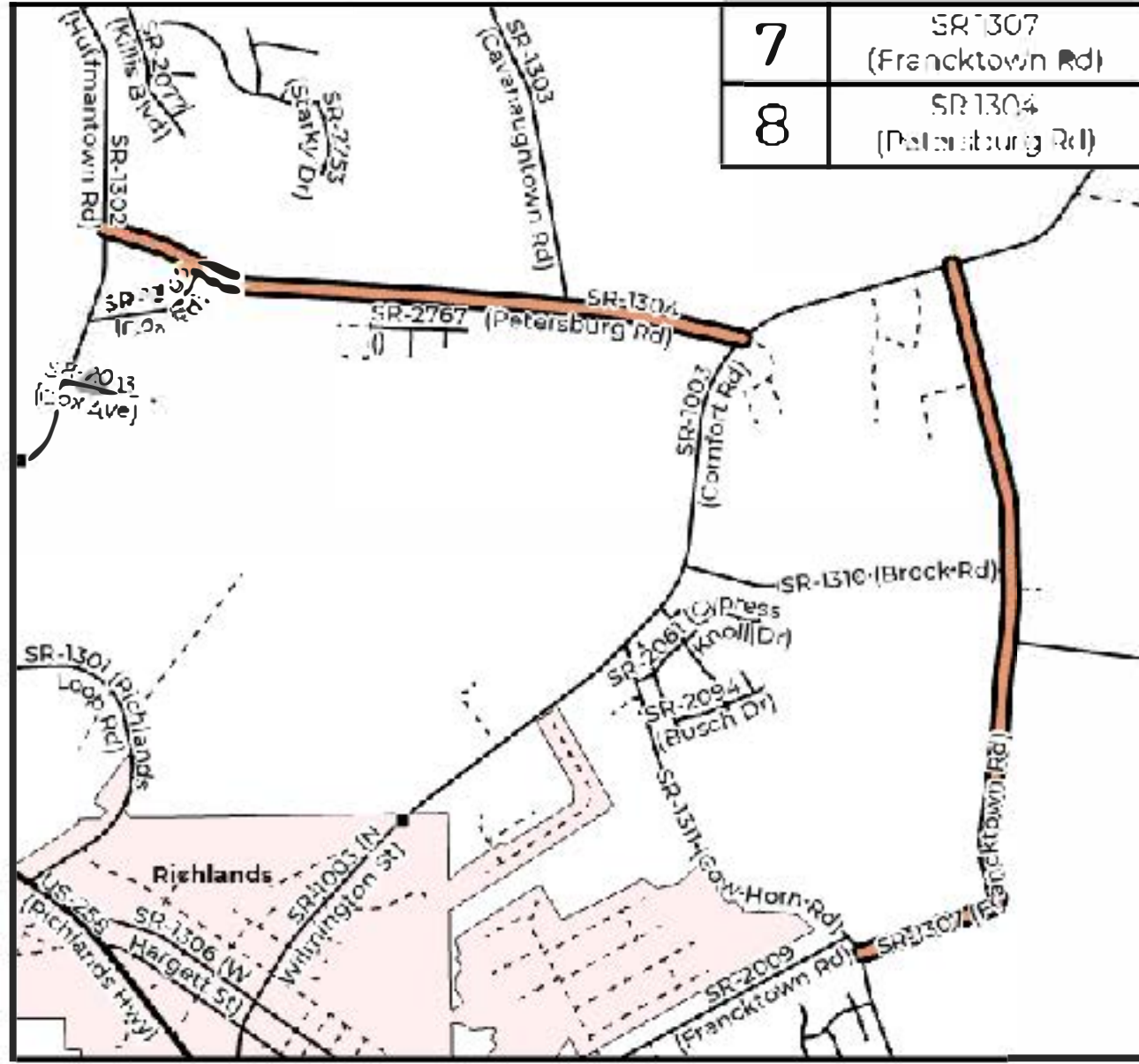

Onslow County 16, 18, 21

PROJECT REFERENCE NO.	SHEET NO
2021 CPT 03 1010672 ETC.	4

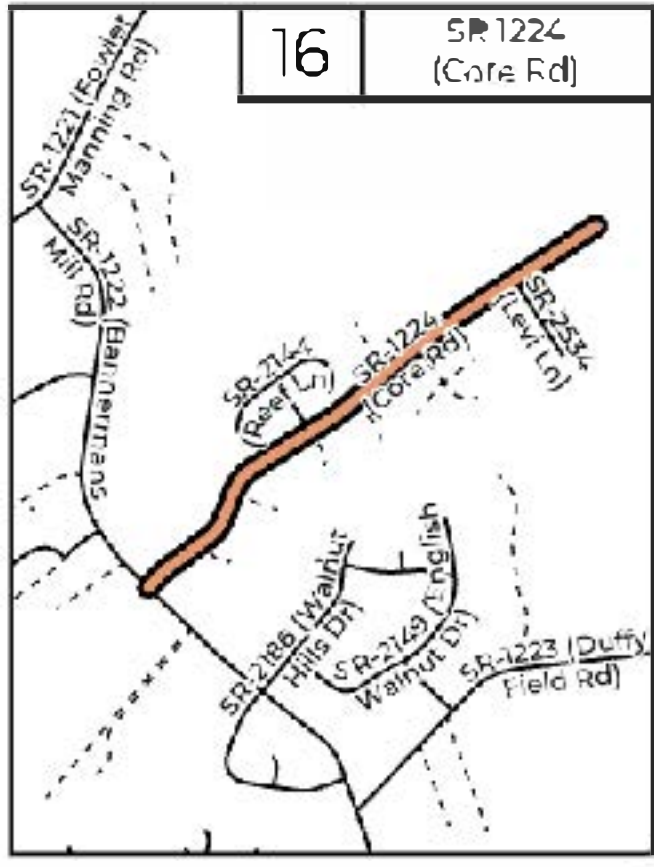
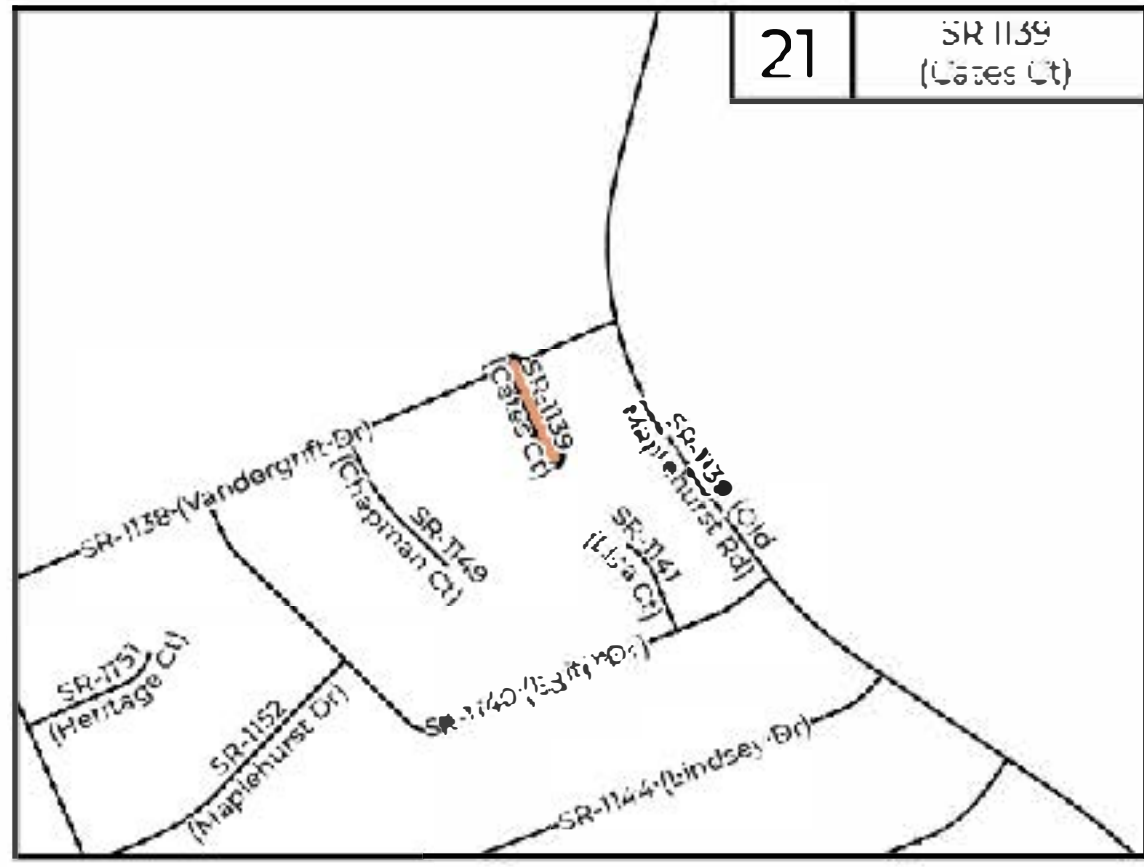
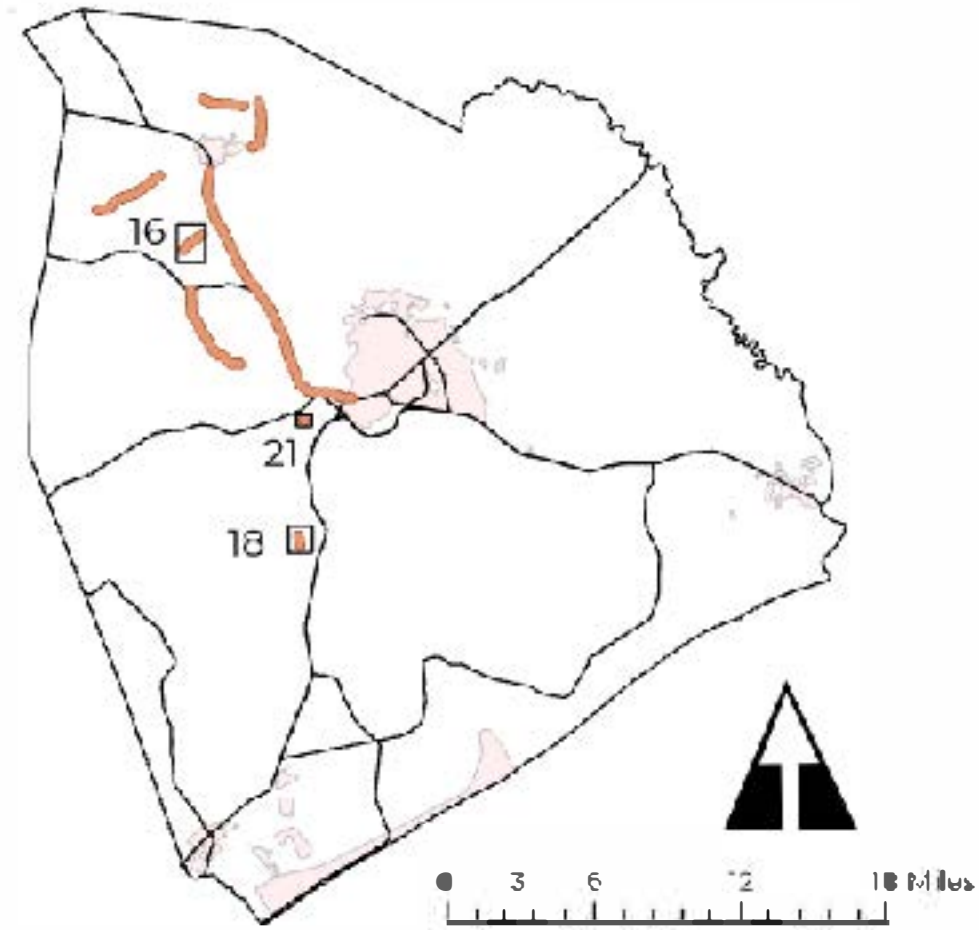

Legend

■	Bridge	—	State Maintained Road
○	Road Section	- - -	Municipality Road

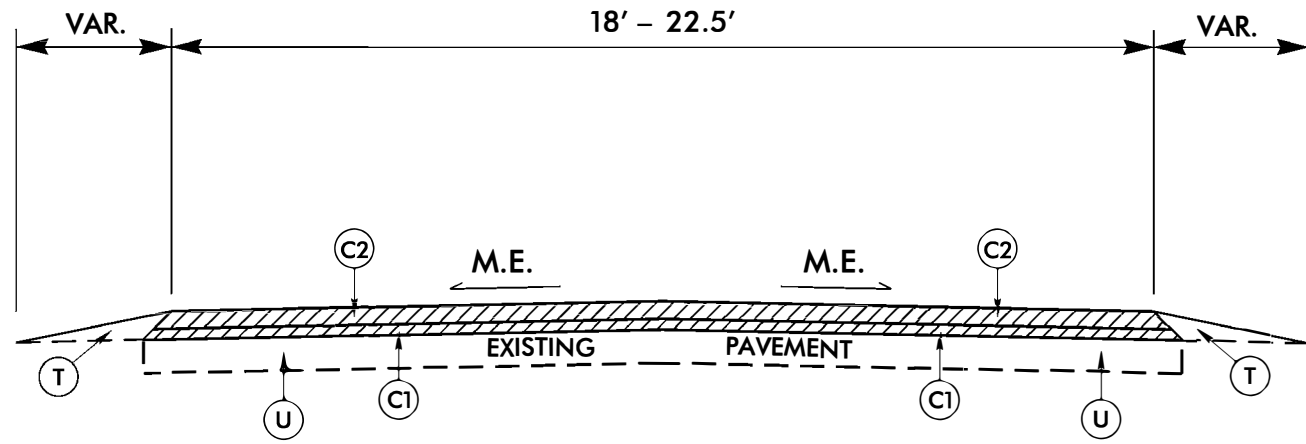

TYPICAL SECTION NO. 1

MAP NO. 4
SR 1219 (LUTHER BANKS RD.)
MP 0.00 - MP 2.99

MAP NO. 7
SR 1307 (FRANCKTOWN RD.)
MP 0.00 - MP 2.05

MAP NO. 9
SR 1211 (FIRE TOWER RD.)
MP 0.00 - MP 4.16

MAP NO. 8
SR 1304 (PETERSBURG RD.)
MP 0.00 - MP 1.76

PAVEMENT SCHEDULE	
C1	PROP. APPROX. 1" DEPTH ASPHALT CONCRETE SURFACE COURSE, TYPE S9.5B, AT AN AVERAGE RATE OF 110 LBS. PER SQ.YD.
C2	PROP. APPROX. 1½" DEPTH ASPHALT CONCRETE SURFACE COURSE, TYPE S9.5B, AT AN AVERAGE RATE OF 165 LBS. PER SQ.YD.
C3	PROP. APPROX. 3" DEPTH ASPHALT CONCRETE SURFACE COURSE, TYPE S9.5B, AT AN AVERAGE RATE OF 165 LBS. PER SQ.YD. IN EACH OF TWO LAYERS.
C4	PROP. APPROX. 1" DEPTH ASPHALT CONCRETE SURFACE COURSE, TYPE S4.75A, AT AN AVERAGE RATE OF 110 LBS. PER SQ.YD.
T	EARTH MATERIAL (SHOULDER RECONSTRUCTION)
U	EXISTING PAVEMENT
V1	MILLING ASPHALT PAVEMENT, 1½" DEPTH

REVISIONS

9:\CCT-2020\17409
 S:\Division Resurfacing\Resurfacing Data\2021
 Resurfacing\ONSLOW\RALEIGH_SUBMITTAL\2021_Onslow_Typical.dgn
 8/17/99

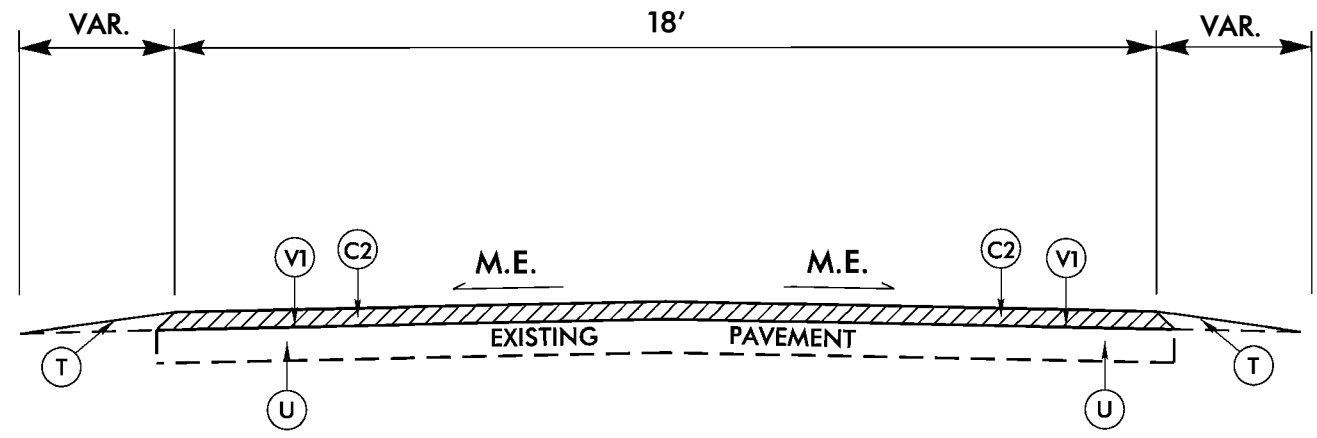

TYPICAL SECTION NO. 3

MAP NO. 7
 SR 1307 (FRANCKTOWN RD.)
 MP 2.05 – MP 2.10

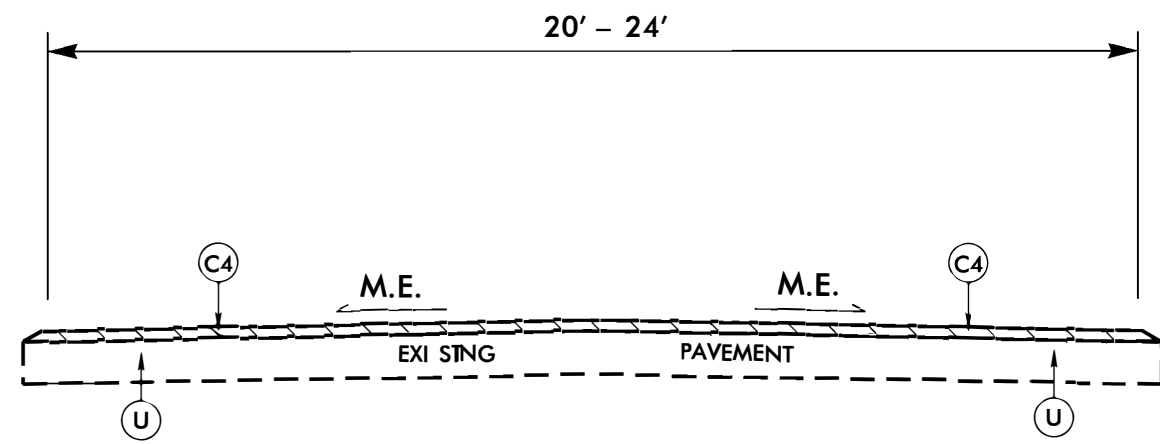

TYPICAL SECTION NO. 4

MAP NO. 16
 SR 1224 (CORE RD.)
 MP 0.00 – MP 1.05

MAP NO. 21
 SR 1139 (CATES CT.)
 MP 0.00 – MP 0.05

MAP NO. 18
 SR 1120 (JOHNNY PARKER RD.)
 MP 0.00 – MP 0.42

PAVEMENT SCHEDULE	
C2	1½" S9.5B
C4	1" S4.75A
T	EARTH MATERIAL SHOULDER RECONST.
U	EXISTING PAVEMENT
V1	MILLING 1½" DEPTH

REVISIONS

28-SEP-2020 14:47
 S:\Shared\NCFE\2021 Resurfacing_Trace & Bridge\Drawings\Typicals\Drawings - Typical.dgn
 8/17/99

- NOTES:
- 1) DETAIL DOES NOT APPLY TO OGAFC AND ULTRA-THIN BONDED WEARING COURSE.
 - 2) BACKFILL SHOULDER WITH APPROVED MATERIAL.
 - 3) THE SHOULDER WEDGE DEVICE MAY BE DISENGAGED AT PAVED DRIVEWAYS, SIDE STREETS, HIGH SHOULDERS, AND OTHER LOCATIONS NOT FEASIBLE TO CONSTRUCT AS APPROVED BY THE ENGINEER.

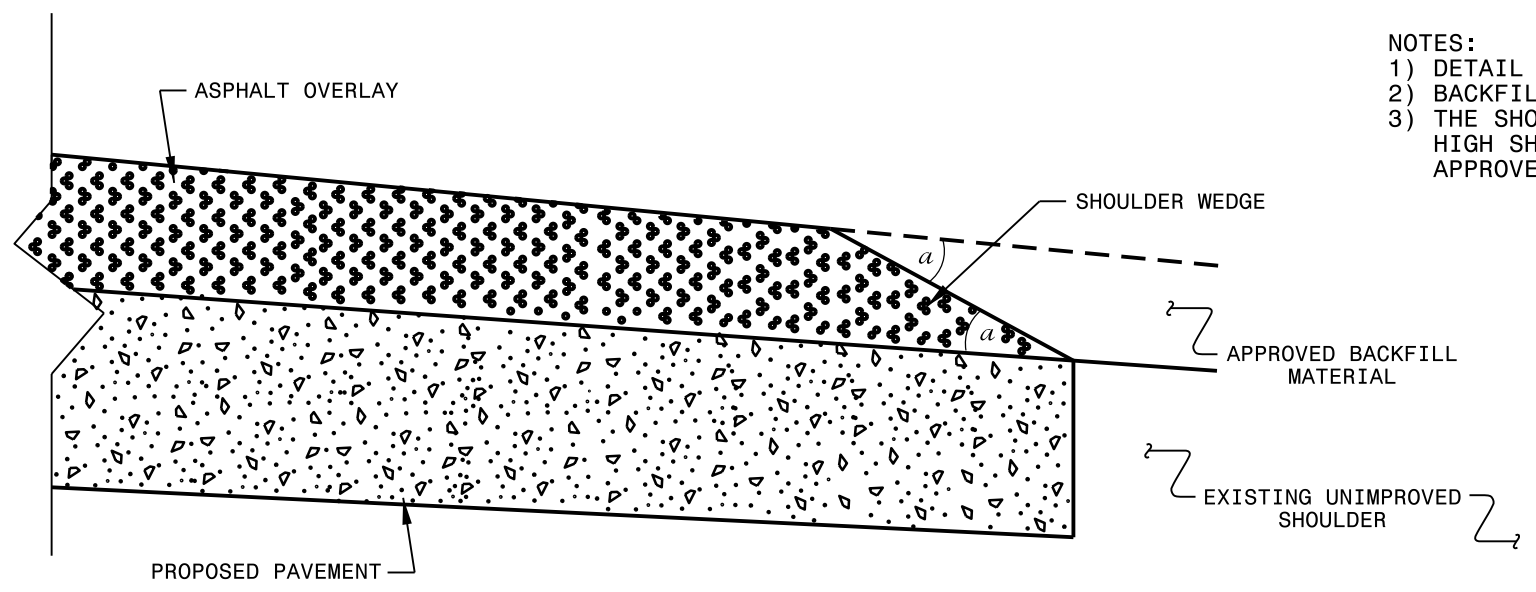

SHOULDER WEDGE DETAIL
 (Resurfacing Projects w/ Widening or
 with Existing Paved Shoulder having no dropoffs)

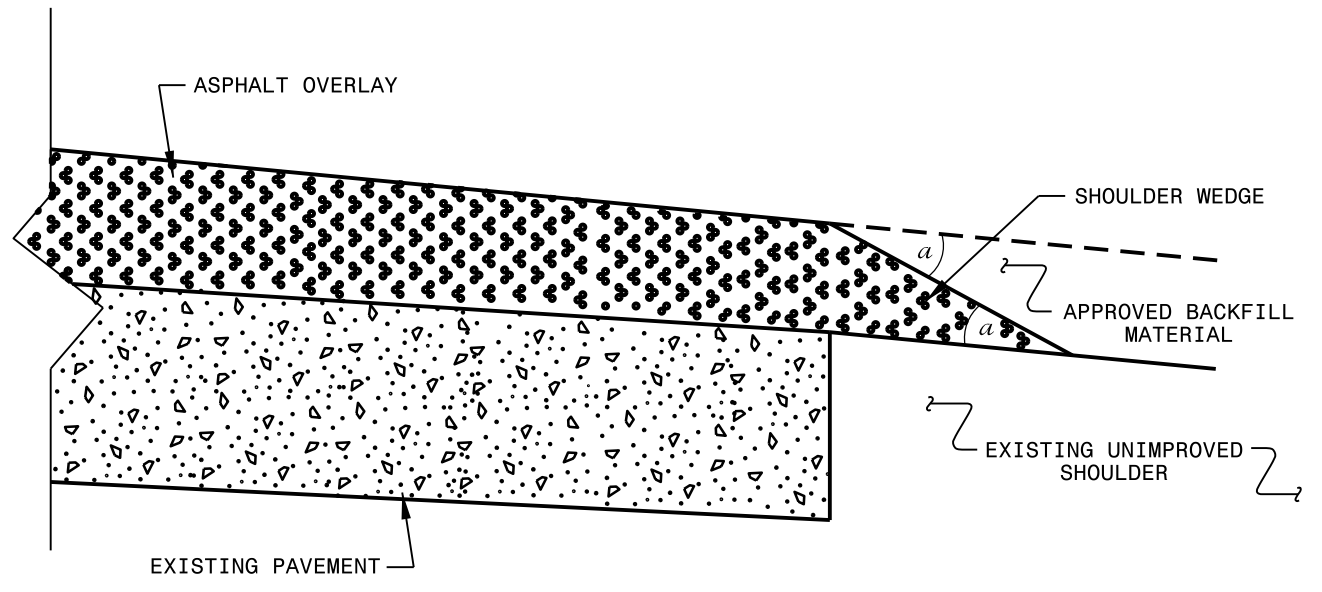

SHOULDER WEDGE DETAIL
 (Resurfacing Projects w/ NO Widening)

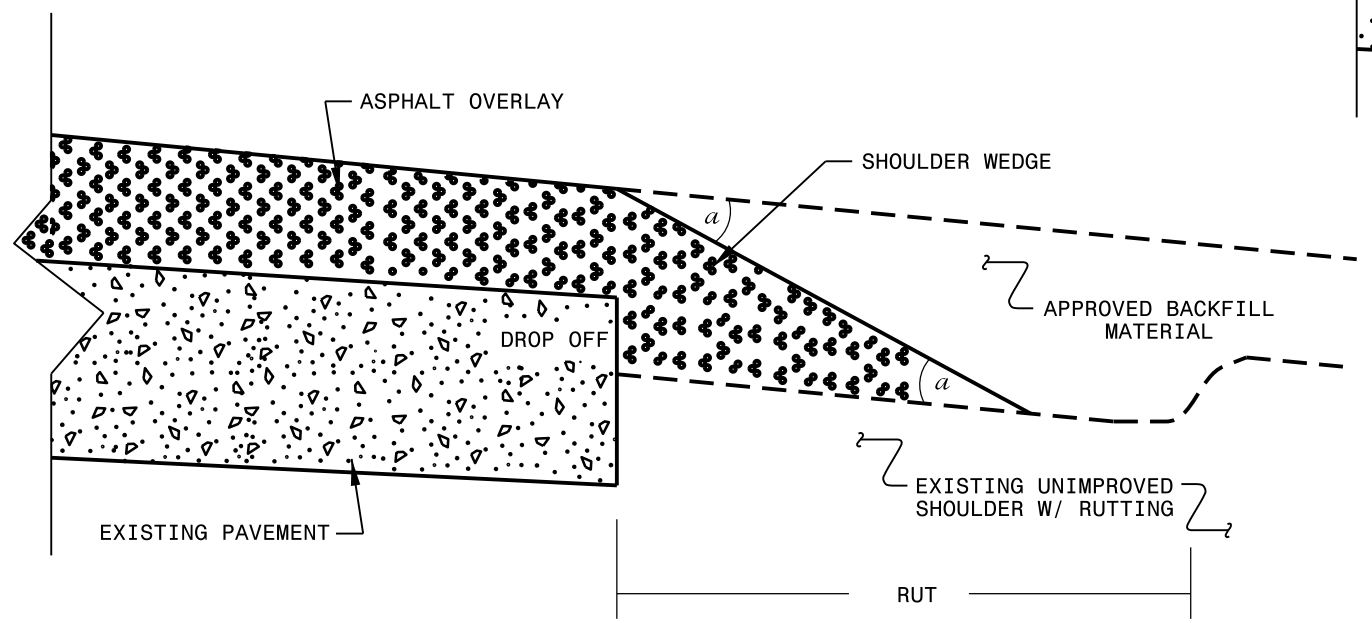

SHOULDER WEDGE DETAIL
 (Resurfacing Adjacent to
 Rutted Shoulder)

- SHOULDER WEDGE ANGLE = 30°

CONTRACT STANDARDS AND DEVELOPMENT UNIT			
Office 919-707-6950		FAX 919-250-4119	
SHOULDER WEDGE DETAILS			
ORIGINAL BY:	T.SPELL	DATE:	7-19-11
MODIFIED BY:		DATE:	2/2/16
CHECKED BY:		DATE:	
FILE SPEC.:	s:\usr\details\stand\shoulderwedgedetail.dgn		

27 JUN 2018 13:22
 s:\projects\Resurfacing Projects\Division 3\Sampson August 2018\Revised Shoulder Wedge Detail.dgn
 P:\porter\A1\CSO\2015\2542

PROJECT NO.	SHEET NO.
2021CPT.03.10.10672, ETC.	10

SUMMARY OF QUANTITIES

PROJECT NO	COUNT	MAP NO	ROUTE	DESCRIPTION	TYP NO	LANES	LANE TYPE	FINAL SURFACE TESTING REQUIRED	WARM MIX ASPHALT REQUIRED	LENGTH		WIDTH		0106000000-E	1220000000-E	1245000000-E	1297000000-E	1330000000-E	1519000000-E	1526000000-E	1575000000-E	1880000000-E		2845000000-N	6000000000-E	6009000000-E	6012000000-E	6015000000-E								
										MI	FT	BORROW EXCAVATION	INCIDENTAL STONE BASE	SHOULDER RECONST.	1.5" MILLING	INCIDENTAL MILLING	SURFACE COURSE, S9.5B	SURFACE COURSE, S4.75A	ASPHALT BINDER FOR PLANT MIX	PATCHING EXISTING PAVEMENT (MILL)	PATCHING EXISTING PAVEMENT (FULL DEPTH)	ADJUSTMENT OF METER OR VALVE BOX	TEMPORARY SILT FENCE	STONE FOR EC CLASS B	SEDIMENT CONTROL STONE	TEMPORARY MULCHING										
											TON	TON	TON	TON	TON	TON	TON	TON	EA	LF	TON	TON	TON	TON	TON	TON	TON									
2021CPT.03.10.20671	Onslow	4	SR 1219 (LUTHER BANKS RD)	FROM SR 1229 (GREGORY FORK RD.) TO SR 1230 (HAW BRANCH RD.) [MP 0.00 - MP 2.99]	1	2	2WU	NO	NO	2.99	20			275	40	6.00		20	5,054		339	300			1	299	75	75	2.99							
TOTAL FOR MAP NO. 4											2.99		275	40	6.00		20	5,054		339	300			1	299	75	75	2.99								
2021CPT.03.10.20671	Onslow	7	SR 1307 (FRANCKTOWN RD)	FROM SR 1003 (COMFORT RD.) TO SR 1311 (COW HORN RD.) [MP 0.00 - MP 2.10]	1,3	2	2WU	NO	NO	2.1	18			193	62	4.20	422	40	3,102		208	269			1	210	53	53	2.10							
TOTAL FOR MAP NO. 7											2.1		193	62	4.20	422	40	3,102		208	269			1	210	53	53	2.10								
2021CPT.03.10.20671	Onslow	8	SR 1304 (PETERSBURG RD)	FROM SR 1302 (HUFFMANTOWN RD.) TO SR 1003 (COMFORT RD.) [MP 0.00 - MP 1.76]	1	2	2WU	NO	NO	1.76	20			162	40	3.52		30	2,890		194	307			1	176	44	44	1.76							
TOTAL FOR MAP NO. 8											1.76		162	40	3.52		30	2,890		194	307			1	176	44	44	1.76								
2021CPT.03.10.20671	Onslow	9	SR 1211 (FIRE TOWER RD)	FROM NC 111 TO PAVEMENT SEAM 0.29 MILES WEST OF SR 1212 (PONY FARM RD.) [MP 0.00 - MP 4.16]	1	2	2WU	NO	NO	4.16	20			383	120	8.90			6,380		427	397				445	111	111	4.45							
TOTAL FOR MAP NO. 9											4.16		383	120	8.90			6,380		427	397				445	111	111	4.45								
TOTAL FOR PROJ NO. 2021CPT.03.10.20671											11.01		1,013	262	22.62	422	90	17,426		1,168	1,273			3	1,130	283	283	11.30								
2021CPT.03.10.20672	Onslow	16	SR 1224 (CORE RD.)	FROM SR 1222 (BANNERMANS MILL RD.) TO END OF MAINTENANCE [MP 0.00 - MP 1.05]	4	2	2WU	NO	NO	1.05	20									717	50															
TOTAL FOR MAP NO. 16											1.05									717	50															
2021CPT.03.10.20672	Onslow	18	SR 1120 (JOHNNY PARKER RD.)	FROM 1121 (VERONA RD.) TO END OF MAINTENANCE [MP 0.00 - MP 0.42]	4	2	2WU	NO	NO	0.42	20									287	20	25														
TOTAL FOR MAP NO. 18											0.42									287	20	25														
2021CPT.03.10.20672	Onslow	21	SR 1139 (CATES RD.)	FROM SR 1138 (VANDERGRIFT DR.) TO CUL-DE-SAC [MP 0.00 - MP 0.05]	4	2	2WU	NO	NO	0.05	20									35	2	24														
TOTAL FOR MAP NO. 21											0.05									35	2	24														
TOTAL FOR PROJ NO. 2021CPT.03.10.20672											1.52									1,039	72	49														
2021CPT.03.10.10672	Onslow	11	US 258 (RICHLANDS HWY)	FROM US 17 BUS. TO SR 1238 (KOONCE FORK RD.) [MP 0.00 - MP 11.94]	N/A	5	MU	NO	NO	11.94	60																		330							
TOTAL FOR MAP NO. 11											11.94																							330		
TOTAL FOR PROJ NO. 2021CPT.03.10.10672											11.94																									330
GRAND TOTAL											24.47		1,013	262	22.62	422	90	17,426		1,039	1,240			3	1,130	283	283	11.30								

PROJECT NO.	SHEET NO.
2021CPT.03.10.10672, ETC.	11

SUMMARY OF QUANTITIES

PROJECT NO	COUNT	MAP NO	ROUTE	DESCRIPTION	TYP NO	LANES	LANE TYPE	FINAL SURFACE TESTING REQUIRED	6018000000-E	6021000000-E	6036000000-E	6042000000-E	6071010000-E	6084000000-E	6090000000-E	6093000000-E	6117000000-N
									SEED FOR TEMPORARY SEEDING	FERTILIZER FOR TEMPORARY SEEDING	MATTING FOR EROSION CONTROL	1/4" HARDWARE CLOTH	WATTLE	SEED & MULCHING	SEED FOR REPAIR SEEDING	FERTILIZER FOR REPAIR SEEDING	RESPONSE FOR EROSION CONTROL
									LBS	TON	SY	LF	LF	AC	LB	TON	EA
2021CPT.03.10.20671	Onslow	4	SR 1219 (LUTHER BANKS RD)	FROM SR 1229 (GREGORY FORK RD.) TO SR 1230 (HAW BRANCH RD.) [MP 0.00 - MP 2.99]	1	2	2WU	NO	150	0.75	20	150	50	2.17	150	0.75	2
TOTAL FOR MAP NO. 4									150	0.75	20	150	50	2.17	150	0.75	2
2021CPT.03.10.20671	Onslow	7	SR 1307 (FRANCKTOWN RD)	FROM SR 1003 (COMFORT RD.) TO SR 1311 (COW HORN RD.) [MP 0.00 - MP 2.10]	1,3	2	2WU	NO	105	0.53	20	105	40	1.53	105	0.53	2
TOTAL FOR MAP NO. 7									105	0.53	20	105	40	1.53	105	0.53	2
2021CPT.03.10.20671	Onslow	8	SR 1304 (PETERSBURG RD)	FROM SR 1302 (HUFFMANTOWN RD.) TO SR 1003 (COMFORT RD.) [MP 0.00 - MP 1.76]	1	2	2WU	NO	88	0.44	20	88	30	1.28	88	0.44	2
TOTAL FOR MAP NO. 8									88	0.44	20	88	30	1.28	88	0.44	2
2021CPT.03.10.20671	Onslow	9	SR 1211 (FIRE TOWER RD)	FROM NC 111 TO PAVEMENT SEAM 0.29 MILES WEST OF SR 1212 (PONY FARM RD.) [MP 0.00 - MP 4.16]	1	2	2WU	NO	223	1.11	30	223	70	3.24	223	1.11	2
TOTAL FOR MAP NO. 9									223	1.11	30	223	70	3.24	223	1.11	2
TOTAL FOR PROJ NO. 2021CPT.03.10.20671									566	2.83	90	566	190	8.22	566	2.83	8
2021CPT.03.10.20672	Onslow	16	SR 1224 (CORE RD.)	FROM SR 1222 (BANNERMANS MILL RD.) TO END OF MAINTENANCE [MP 0.00 - MP 1.05]	4	2	2WU	NO									
TOTAL FOR MAP NO. 16																	
2021CPT.03.10.20672	Onslow	18	SR 1120 (JOHNNY PARKER RD.)	FROM 1121 (VERONA RD.) TO END OF MAINTENANCE [MP 0.00 - MP 0.42]	4	2	2WU	NO									
TOTAL FOR MAP NO. 18																	
2021CPT.03.10.20672	Onslow	21	SR 1139 (CATES RD.)	FROM SR 1138 (VANDERGRIFT DR.) TO CUL-DE-SAC [MP 0.00 - MP 0.05]	4	2	2WU	NO									
TOTAL FOR MAP NO. 21																	
TOTAL FOR PROJ NO. 2021CPT.03.10.20672																	
2021CPT.03.10.10672	Onslow	11	US 258 (RICHLANDS HWY)	FROM US 17 BUS. TO SR 1238 (KOONCE FORK RD.) [MP 0.00 - MP 11.94]	N/A	5	MU	NO									
TOTAL FOR MAP NO. 11																	
TOTAL FOR PROJ NO. 2021CPT.03.10.10672																	
GRAND TOTAL									566	2.83	90	566	190	8.22	566	2.83	8

PROJECT NO.	SHEET NO.
2021CPT.03.10.10672, ETC.	12

THERMOPLASTIC AND PAINT QUANTITIES

PROJECT NO	COUNTY	MAP NO	ROUTE	DESCRIPTION	TYP NO	LANES	LANE TYPE	LENGTH	WIDTH	4413000000-E	4457000000-N	4685000000-E		4892000000-N	4725000000-E	4810000000-E		4835000000-E	4840000000-N	4845000000-N	4890000000-E	4891000000-E		4900000000-N				
										WORK ZONE ADVANCE/GENERAL WARNING SIGNING	TEMPORARY TRAFFIC CONTROL	4" X 90 M WHITE THERMO	4" X 90 M YELLOW THERMO	THERMO MSG SCHOOL 90 M	THERMO RT ARROW 90 M	4" YELLOW PAINT	4" WHITE PAINT	24" WHITE PAINT	PAINT MSG SCHOOL	PAINT RT ARROW	4" WHITE THERMO PROFILED EDGE LINES	24" X 90 M WHITE THERMO	REMOVAL OF PAVEMENT MARKING LINES (4") (REMOVAL OF PROFILED EDGE LINES)	YELLOW & YELLOW MARKERS				
									SF	LS	LF	LF	EA	EA	LF	LF	LF	EA	EA	LF	LF	LF	EA					
2021CPT.03.10.20671	Onslow	4	SR 1219 (LUTHER BANKS RD)	FROM SR 1229 (GREGORY FORK RD.) TO SR 1230 (HAW BRANCH RD.) [MP 0.00 - MP 2.99]	1	2	2WU	2.99	20	336		32,172	31,574			31,574									197			
TOTAL FOR MAP NO. 4											32,172	31,574			31,574										197			
2021CPT.03.10.20671	Onslow	7	SR 1307 (FRANCKTOWN RD)	FROM SR 1003 (COMFORT RD.) TO SR 1311 (COW HORN RD.) [MP 0.00 - MP 2.10]	1,3	2	2WU	2.1	18	240		22,596	16,947			16,947									138			
TOTAL FOR MAP NO. 7											22,596	16,947			16,947											138		
2021CPT.03.10.20671	Onslow	8	SR 1304 (PETERSBURG RD)	FROM SR 1302 (HUFFMANTOWN RD.) TO SR 1003 (COMFORT RD.) [MP 0.00 - MP 1.76]	1	2	2WU	1.76	20			18,938	14,200			14,200									116			
TOTAL FOR MAP NO. 8											18,938	14,200			14,200											116		
2021CPT.03.10.20671	Onslow	9	SR 1211 (FIRE TOWER RD)	FROM NC 111 TO PAVEMENT SEAM 0.29 MILES WEST OF SR 1212 (PONY FARM RD.) [MP 0.00 - MP 4.16]	1	2	2WU	4.16	20	480			43,930	6	2	46,992		50	6	2	44,762	50	44,762		275			
TOTAL FOR MAP NO. 9											43,930	6	2	46,992		50	6	2	44,762	50	44,762		275					
TOTAL FOR PROJ NO. 2021CPT.03.10.20671									11.01	1,056	73,706	106,651	6	2	109,713		50	6	2	44,762	50	44,762		726				
												180,357					109,713											
2021CPT.03.10.20672	Onslow	16	SR 1224 (CORE RD.)	FROM SR 1222 (BANNERMANS MILL RD.) TO END OF MAINTENANCE [MP 0.00 - MP 1.05]	4	2	2WU	1.05	20							15,523	22,176								70			
TOTAL FOR MAP NO. 16															15,523	22,176									70			
2021CPT.03.10.20672	Onslow	18	SR 1120 (JOHNNY PARKER RD.)	FROM 1121 (VERONA RD.) TO END OF MAINTENANCE [MP 0.00 - MP 0.42]	4	2	2WU	0.42	20							6,209	8,870								28			
TOTAL FOR MAP NO. 18															6,209	8,870									28			
2021CPT.03.10.20672	Onslow	21	SR 1139 (CATES RD.)	FROM SR 1138 (VANDERGRIFT DR.) TO CUL-DE-SAC [MP 0.00 - MP 0.05]	4	2	2WU	0.05	20																			
TOTAL FOR MAP NO. 21																												
TOTAL FOR PROJ NO. 2021CPT.03.10.20672									1.52						21,732	31,046											98	
																	52,778											
2021CPT.03.10.10672	Onslow	11	US 258 (RICHLANDS HWY)	FROM US 17 BUS. TO SR 1238 (KOONCE FORK RD.) [MP 0.00 - MP 11.94]	N/A	5	MU	11.94	60																			
TOTAL FOR MAP NO. 11																												
TOTAL FOR PROJ NO. 2021CPT.03.10.10672																												
GRAND TOTAL												24.47		1,056	1	73,706	106,651	6	2	131,445	31,046	50	6	2	44,762	50	44,762	824
												180,357						162,491										

SIGNING FOR RESURFACING PROJECTS

LEGEND
 ┆ STATIONARY SIGN
 ← DIRECTION OF TRAFFIC FLOW

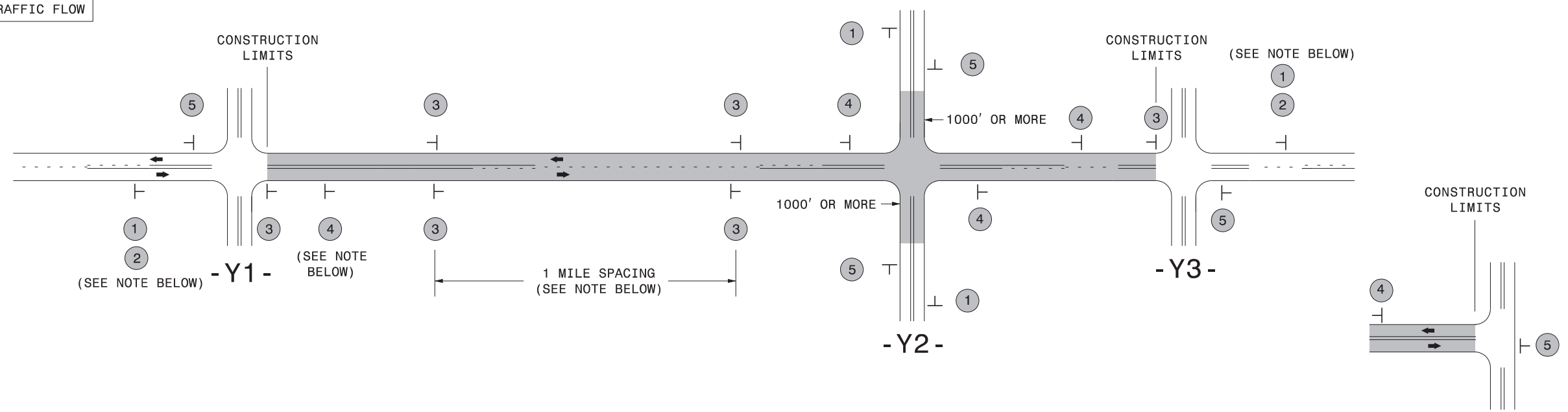

MAINLINE (-L-) SIGNING

-Y- LINE SIGNING

SIGNING NOTES AND PLACEMENT PER DIRECTION	1		PLACE 1000' PRIOR TO BEGINNING OF CONSTRUCTION LIMITS. ONLY USED ON -Y- LINES IF RESURFACING LIMITS EXTEND 1000' ALONG -Y- LINE.	<p>NO REQUIRED STATIONARY SIGNING FOR THE FOLLOWING -Y- LINE CONDITIONS:</p> <ol style="list-style-type: none"> 1) LESS THAN 1000' OF RESURFACING ALONG -Y- LINE 2) SUBDIVISION ROADS 3) DEAD END ROADS <p>WHEN PAVING/CONSTRUCTION ACTIVITIES PROCEED ACROSS AN UNSIGNED -Y- LINE, PORTABLE ADVANCE WARNING SIGNS SHALL BE USED ALONG THE -Y- LINE AS SHOWN BELOW. REMOVE UPON COMPLETION OF WORK.</p> <div style="display: flex; justify-content: space-around;"> <div style="text-align: center;"> W20-1 48" X 48" PLACED 500' IN ADVANCE OF FLAGGER. </div> <div style="text-align: center;"> W20-7 A 48" X 48" PLACED 250' IN ADVANCE OF FLAGGER. </div> </div>
	2		#2 SIGN ONLY USED WHEN CONSTRUCTION LIMITS ARE 2 OR MORE MILES IN LENGTH. ROUND UP TO NEXT WHOLE NUMBER. (NO FRACTIONAL OR DECIMAL NUMBERS)	
	3		<ul style="list-style-type: none"> - PLACE INITIALLY AT THE CONSTRUCTION LIMITS AND SPACE 1 MILE APART THEREAFTER. - AT TEE INTERSECTIONS INSTALL INITIALLY 1/2 MILE FROM INTERSECTION AND SPACE 1 MILE APART THEREAFTER. 	
	4		<ul style="list-style-type: none"> - THESE ARE FOR -Y- LINES THAT ARE "THROUGH" ROADWAYS. - DEAD END AND SUBDIVISION ROADS ARE NOT "THROUGH" ROADWAYS. - INSTALL 500' +/- FROM EACH -Y- LINE APPROACH AS SHOWN ABOVE. - FOR MULTIPLE -Y- LINES THAT ARE SEPARATED BY 0.25 MILES OR LESS, TREAT AS A SINGLE UNIT AND INSTALL WITHIN 500' OF EACH APPROACH. - A MAXIMUM OF 2 SIGN SETS PER MILE. DO NOT INSTALL WHEN -Y- LINES ARE WITHIN 0.5 MILES FROM "END ROAD WORK" SIGN. - FOR TEE INTERSECTIONS, INSTALL WITHIN 500' +/- OF THE INTERSECTION ALONG -L- LINE. 	
	5		PLACE 500' FOLLOWING THE END OF CONSTRUCTION LIMITS OR AS SHOWN WHEN WORK ENDS AT A 3-WAY TEE INTERSECTION.	

THE ABOVE SIGNS ARE ALL THAT ARE REQUIRED FOR A CONTRACTOR TO BEGIN A RESURFACING CONTRACT. ANY ADDITIONAL SIGNS REQUESTED BY NCDOT DIVISIONS SHALL BE INSTALLED WITHIN 7 BUSINESS DAYS OF THE START OF CONTRACT WORK.

MAPS LESS THAN 2 MILES

FOR RESURFACING MAPS WITH CONSTRUCTION LIMITS LESS THAN 2 MILES IN LENGTH, NO STATIONARY SIGNS ARE REQUIRED. USE PORTABLE "ROAD UNDER CONSTRUCTION" OR "ROAD WORK AHEAD" SIGNS IN LIEU OF STATIONARY ADVANCE WARNINGS SIGNS.

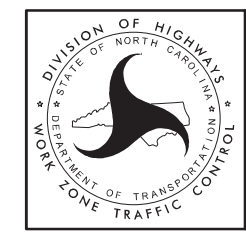

ADVANCE WARNING SIGNS FOR RURAL AND SUBURBAN 2-LANE ROADWAY RESURFACING

DIVISION OF HIGHWAYS
STATE OF NORTH CAROLINA

SOIL STABILIZATION TIMEFRAMES

<i>SITE DESCRIPTION</i>	<i>STABILIZATION TIME</i>	<i>TIMEFRAME EXCEPTIONS</i>
PERIMETER DIKES, SWALES, DITCHES AND SLOPES	7 DAYS	NONE
HIGH QUALITY WATER (HQW) ZONES	7 DAYS	NONE
SLOPES STEEPER THAN 3:1	7 DAYS	IF SLOPES ARE 10' OR LESS IN LENGTH AND ARE NOT STEEPER THAN 2:1, 14 DAYS ARE ALLOWED.
SLOPES 3:1 OR FLATTER	14 DAYS	7 DAYS FOR SLOPES GREATER THAN 50' IN LENGTH.
ALL OTHER AREAS WITH SLOPES FLATTER THAN 4:1	14 DAYS	NONE, EXCEPT FOR PERIMETERS AND HQW ZONES.

NOTES: Less than 5' - 10' undisturbed buffer from ROW, ditchline, water feature, or drainage inlet, add BMP.

EROSION CONTROL DETAIL

BMP Options: Wattle, Silt Fence or Hardened Aggregate.

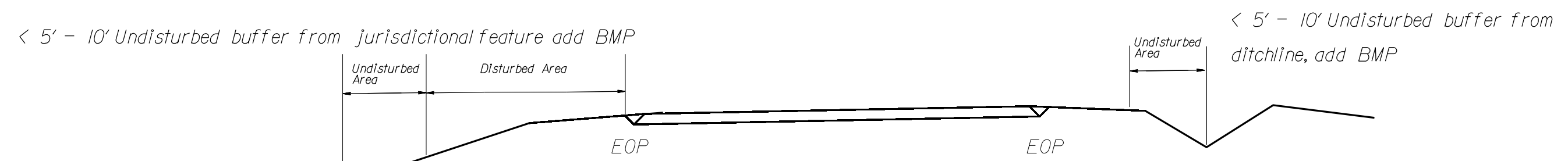
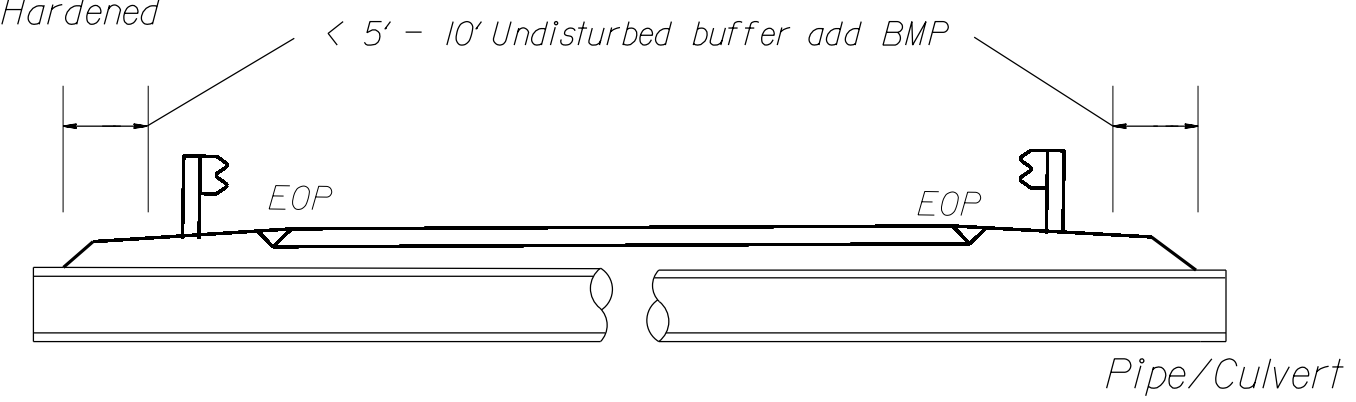

Jurisdictional Feature

Use BMP's if shoulders and/or frontslopes and/or ditchline and/or backslopes are disturbed

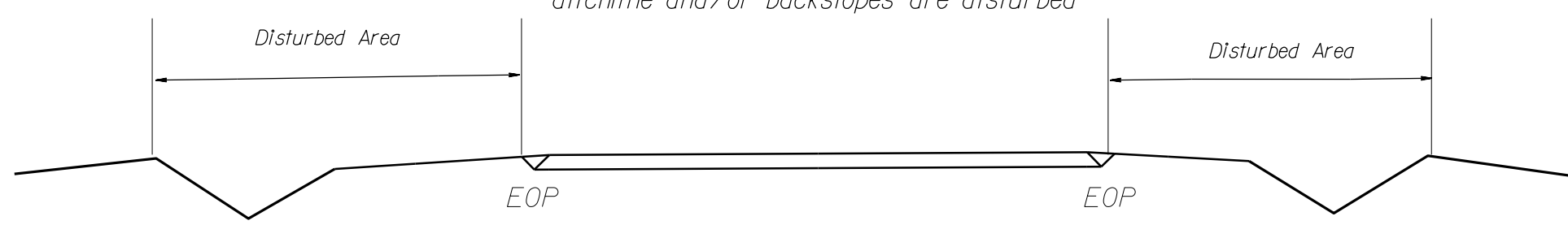

< 5' - 10' Undisturbed buffer from inlet, add wattle

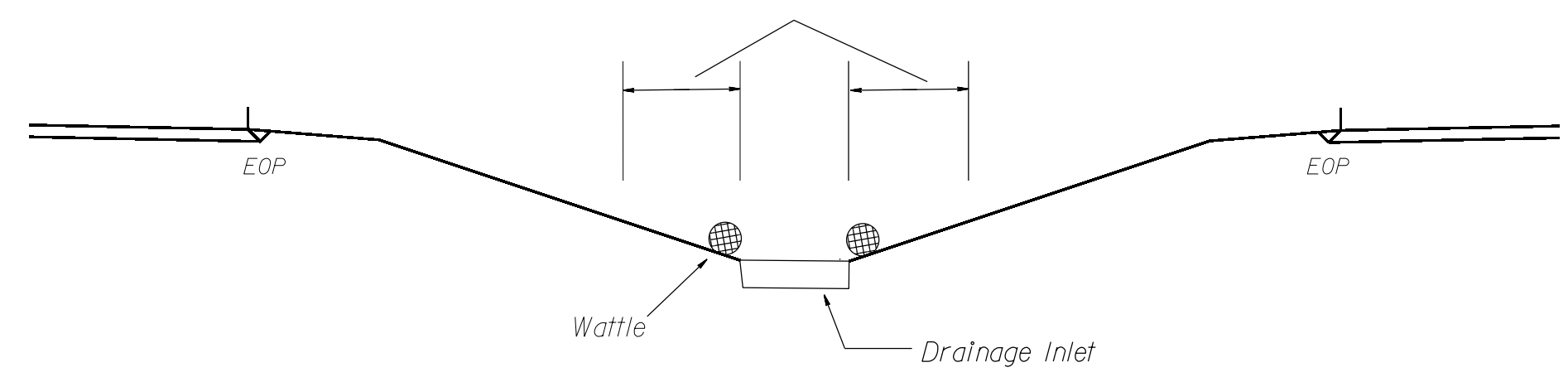

NOT TO SCALE

WATTLE DETAIL

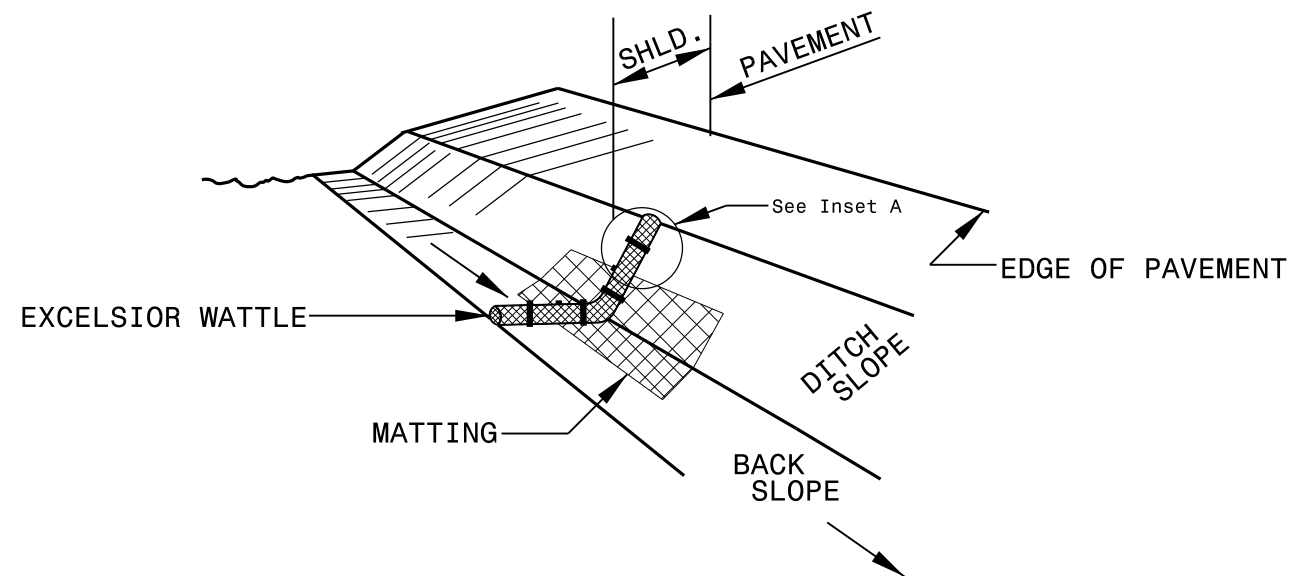

ISOMETRIC VIEW

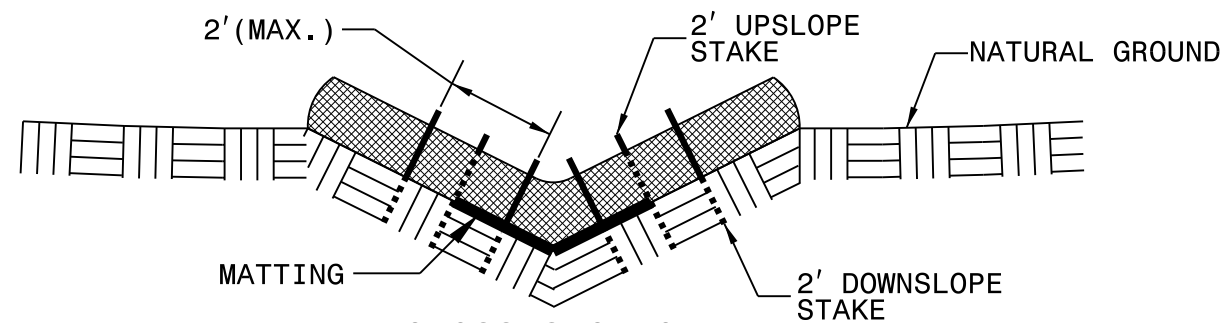

CROSS SECTION VEE DITCH

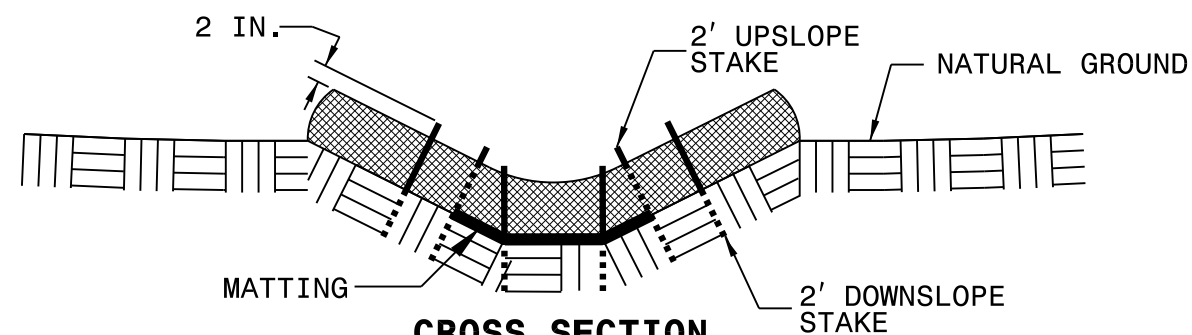

CROSS SECTION TRAPEZOIDAL DITCH

NOTES:

USE MINIMUM 12 IN. DIAMETER EXCELSIOR WATTLE.

USE 2 FT. WOODEN STAKES WITH A 2 IN. BY 2 IN. NOMINAL CROSS SECTION.

ONLY INSTALL WATTLE(S) TO A HEIGHT IN DITCH SO FLOW WILL NOT WASH AROUND WATTLE AND SCOUR DITCH SLOPES AND AS DIRECTED.

INSTALL A MINIMUM OF 2 UPSLOPE STAKES AND 4 DOWNSLOPE STAKES AT AN ANGLE TO WEDGE WATTLE TO BOTTOM OF DITCH.

PROVIDE STAPLES MADE OF 0.125 IN. DIAMETER STEEL WIRE FORMED INTO A U SHAPE NOT LESS THAN 12" IN LENGTH.

INSTALL STAPLES APPROXIMATELY EVERY 1 LINEAR FOOT ON BOTH SIDES OF WATTLE AND AT EACH END TO SECURE IT TO THE SOIL.

INSTALL MATTING IN ACCORDANCE WITH SECTION 1631 OF THE STANDARD SPECIFICATIONS.

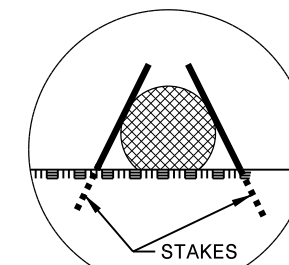

INSET A

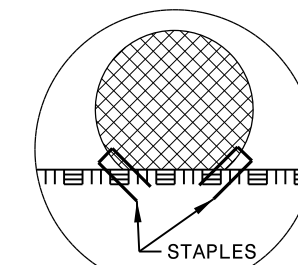

INSET B

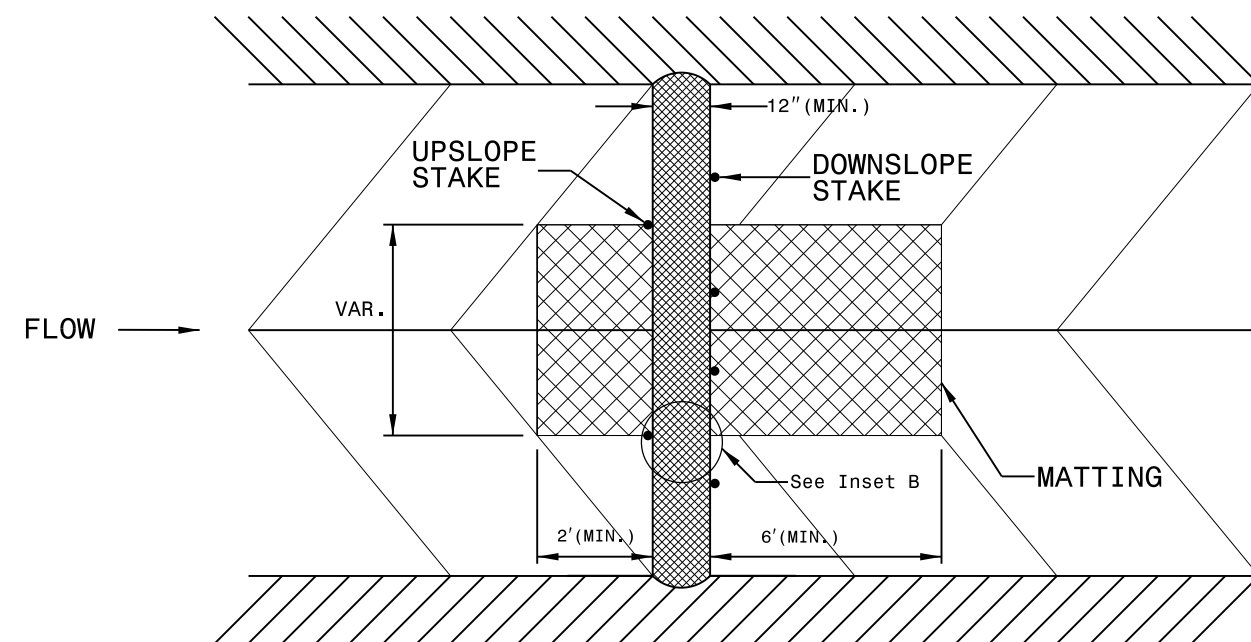

TOP VIEW

I:\FEB-2015 IIR41
 D:\Resurfacing\Plan Sheets\3CR\20711.173. EC RESURF_2015.dgn
 11/11/2015 10:41:10 AM