

ROCK PLATE SLOPES SEE RSD 275.01
 FROM STA. 15+82 +/- RT. TO STA. 16+08 +/- RT.
 FROM STA. 15+76 +/- LT. TO STA. 16+08 +/- LT.
 FROM STA. 17+52 +/- RT. TO STA. 19+81 +/- RT.
 FROM STA. 17+52 +/- LT. TO STA. 18+62 +/- LT.
 FROM STA. 28+24 +/- RT. TO STA. 30+04 +/- RT.

1223 Jones Franklin Rd.
 Raleigh, N.C. 27606
 License No. F-0377
 Bus: 919 851 8077
 Fax: 919 851 8107

PROJECT REFERENCE NO. BR-0111	SHEET NO. EC-05/CONST.04
R/W SHEET NO.	
ROADWAY DESIGN ENGINEER	HYDRAULICS ENGINEER

PERRY PROPERTIES FARMS LLC

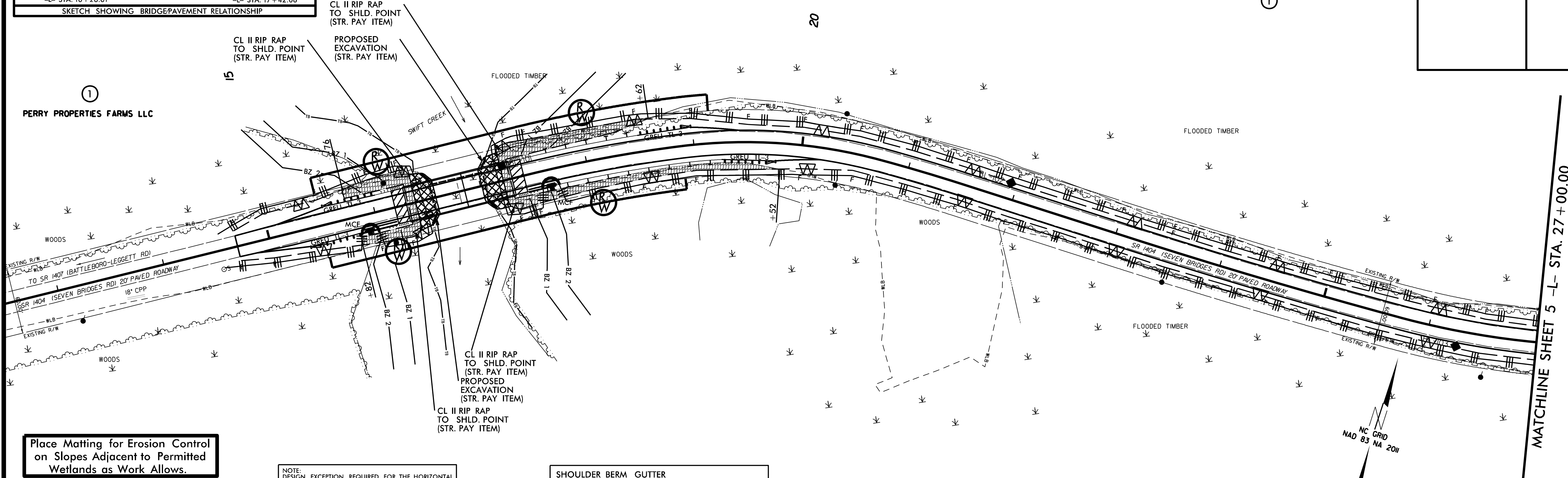

Place Matting for Erosion Control on Slopes Adjacent to Permitted Wetlands as Work Allows.

NOTE: DESIGN EXCEPTION REQUIRED FOR THE HORIZONTAL CURVE RADIUS AND HORIZONTAL STOPPING SIGHT DISTANCE

SHOULDER BERM GUTTER
 FROM STA. 15+85.06 RT. TO STA. 16+17.94 RT.
 FROM STA. 17+42.06 RT. TO STA. 17+68.00 RT.

JEFFREY SKINNER ET AL

REVISIONS

JEFFREY SKINNER ET AL ②

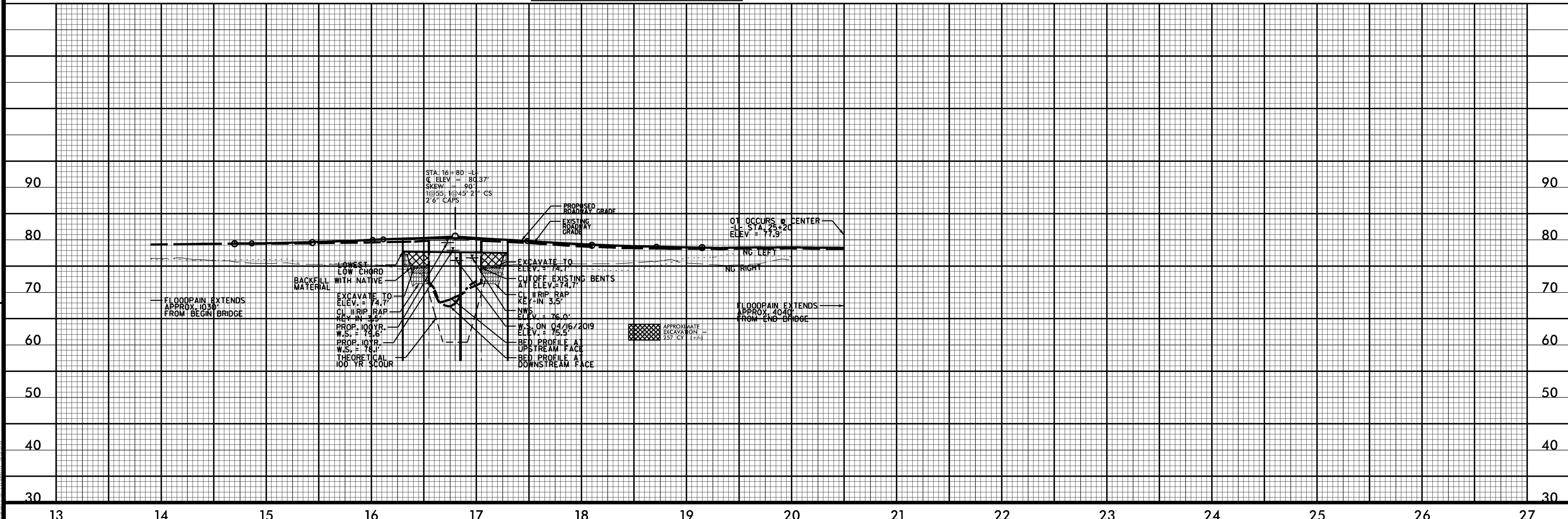

SYSTEMS
 8/17/19