

PAVEMENT SCHEDULE

PROJECT REFERENCE NO.

SHEET NO.

2021CPT.05.03.20921.1

10

		U	EXISTING PAVEMENT
C1	1" ASPHALT CONCRETE SURFACE COURSE, TYPE S9.5B, AT AN AVERAGE RATE OF 110 LBS. PER SQ. YD.	V1	1½" MILLING
C2	1¼" ASPHALT CONCRETE SURFACE COURSE, TYPE S9.5B, AT AN AVERAGE RATE OF 137.5 LBS. PER SQ. YD.	V2	0"-1½" MILLING
C3	1½" ASPHALT CONCRETE SURFACE COURSE, TYPE S9.5B, AT AN AVERAGE RATE OF 165 LBS. PER SQ. YD.	V3	0"-1¼" MILLING
S	SHOULDER GRADING ASB REQUIRED (EXCEPT AT RESIDENTIAL AREAS)		

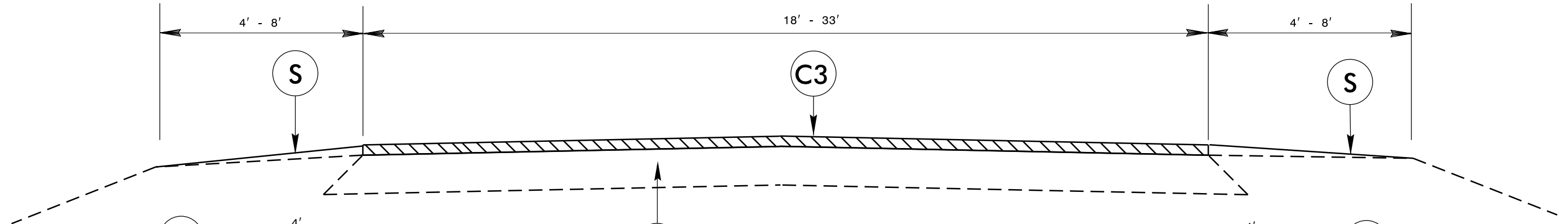

* use this on map 8 only on the new pavement section at Jack Smith Park.

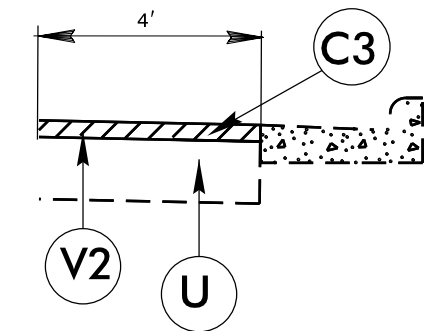
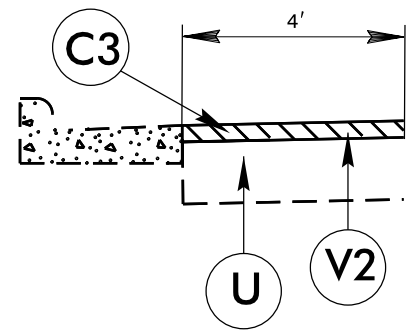

TYPICAL SECTION NO. 3

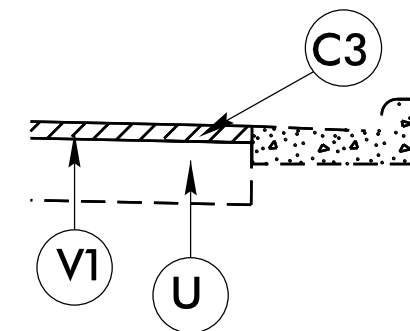
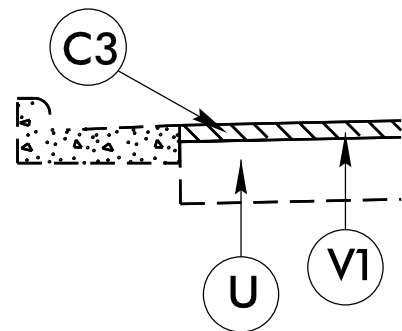
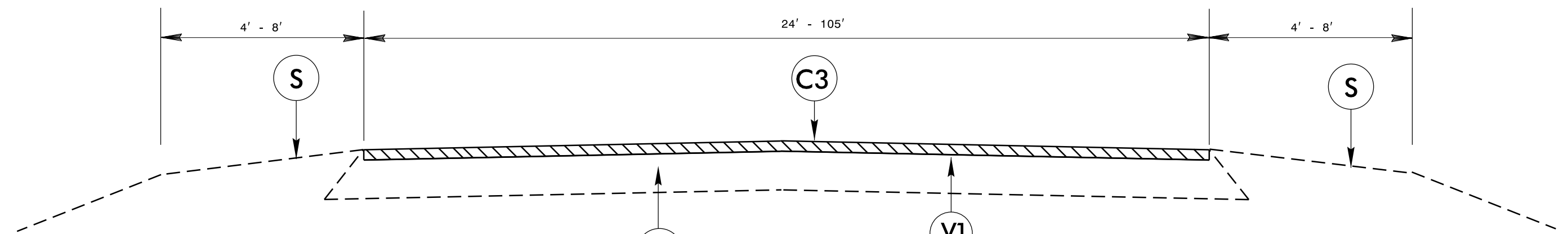

TYPICAL SECTION NO. 4