

(+)-0.6500% (-)-1.9160%
 PI STA. = 119+50.38 -L-
 EL. = 86.37'
 VC = 400.00'
 C-L- GRADE DATA

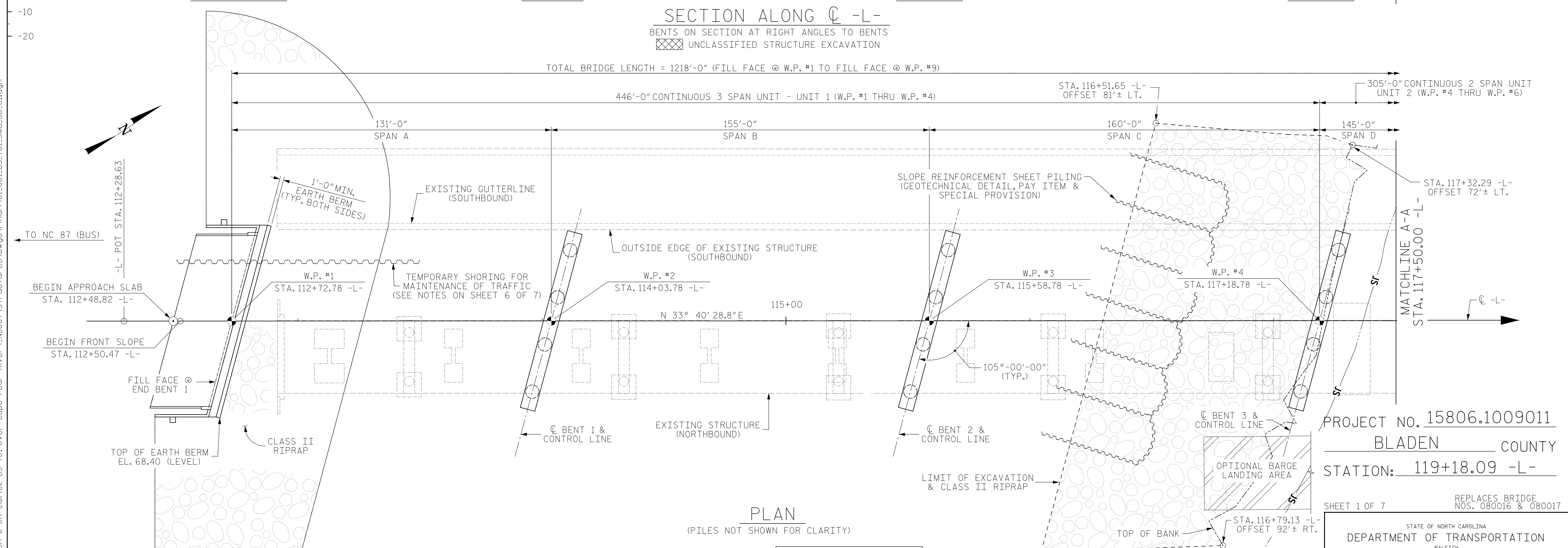

PROJECT NO. 15806.1009011
 BLADEN COUNTY
 STATION: 119+18.09 -L-
 REPLACES BRIDGE NOS. 080016 & 080017
 SHEET 1 OF 7

OVERTOPPING FLOOD DATA

OVERTOPPING DISCHARGE	= 162,000 CFS ±
FREQUENCY OF OVERTOPPING FLOOD	= 500 YR ±
OVERTOPPING FLOOD ELEVATION	= 54.4'

HYDRAULIC DATA

DESIGN DISCHARGE	= 103,000 CFS
FREQUENCY OF DESIGN FLOOD	= 50 YR
DESIGN HIGH WATER ELEVATION	= 48.7'
DRAINAGE AREA	= 5,022 SQ. MI.
BASIC DISCHARGE (Q100)	= 121,000 CFS
BASIC HIGH WATER ELEVATION	= 50.7'

I HEREBY CERTIFY THESE PLANS ARE THE AS-BUILT PLANS.

DRAWN BY: J. N. AUSTIN DATE: 5-5-20
 CHECKED BY: N. REZAEI DATE: 7-9-20
 DESIGN E.O.R.: P. R. HOLSHOUSER DATE: 7-23-20

ICE of Carolinas, PLLC
 4505 Falls of Neuse Road, Suite 110
 Raleigh, North Carolina 27609
 Phone: 919-822-0333
 License #: P-0999

STATE OF NORTH CAROLINA
 DEPARTMENT OF TRANSPORTATION
 RALEIGH

GENERAL DRAWING

FOR BRIDGE OVER CAPE FEAR RIVER ON US 701 (N. POPLAR ST.) BETWEEN NC 87 (BUS) AND NC 53

REVISIONS		SHEET NO.	
NO.	BY:	NO.	DATE:
1		3	
2		4	

TOTAL SHEETS: 107

DOCUMENT NOT CONSIDERED FINAL UNLESS ALL SIGNATURES COMPLETED

Pen Table: \\192.168.64.12\ncerd\RDUCAD\Plotting\Pen Tables\ICE-NC-Struct.tbl
 Print Driver: \\192.168.64.12\ncerd\RDUCAD\Plotting\NGD0T\22x34_PDF-ICE.plt
 User: jmaustin
 Plot: 8/11/2020 10:06:36 PM
 File: R:\Projects\19-77 Division 6 On Call\02 US 701 over Cape Fear River\NCDDOT\Structures\Drawings\Final\401-001-US-701-SWU-GD-01.dgn