

UTILIZE FABRIC INSERT INLET PROTECTION DEVICE AS DIRECTED IN LIEU OF ROCK INLET SEDIMENT TRAP TYPE C TO AVOID IMPOUNDING RUNOFF ON ROADWAYS OPEN TO THE PUBLIC

UTILIZE SPECIAL STILLING BASIN(S) WHERE APPLICABLE

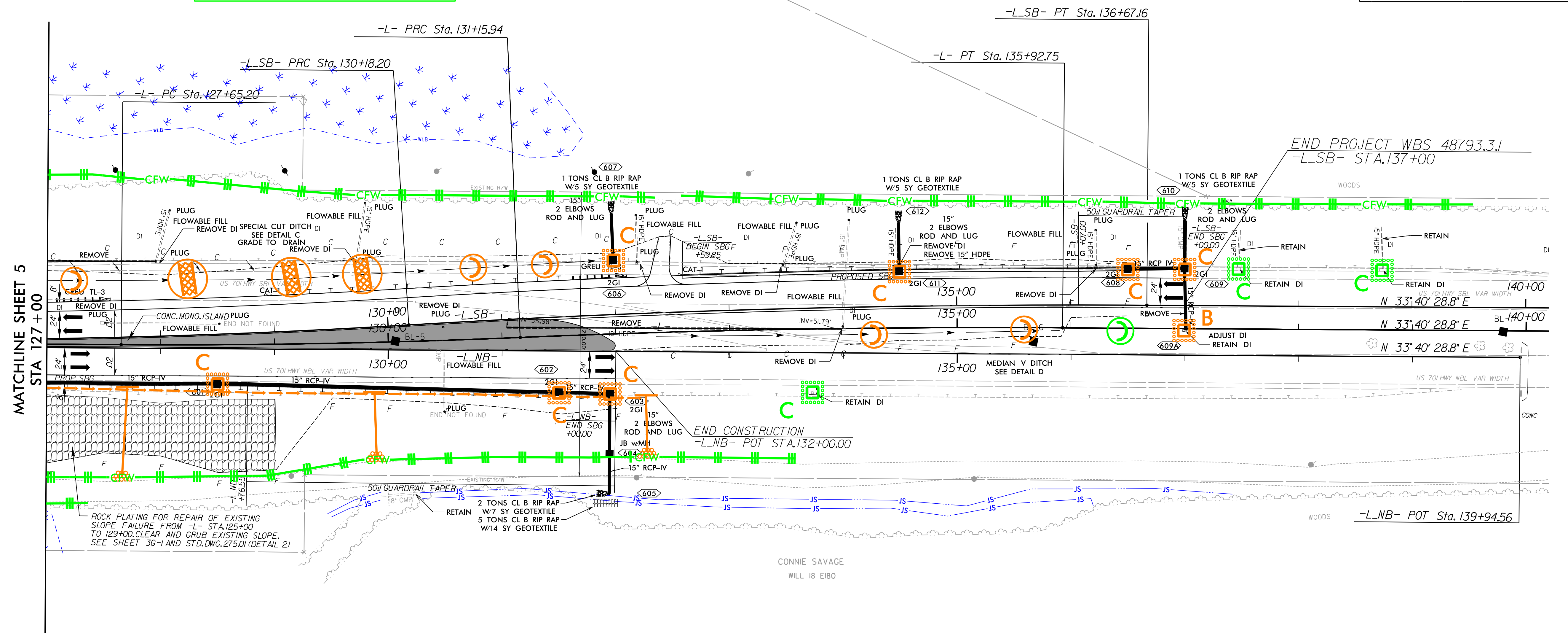

MATCHLINE SHEET 5  
STA 127+00

-L-SB- US 701 SOUTHBOUND	
PI Sta. 127+79.60	PI Sta. 133+42.80
$\Delta = 3^{\circ} 49' 31.4" (LT)$	$\Delta = 3^{\circ} 49' 31.4" (RT)$
$D = 0^{\circ} 48' 04.8"$	$D = 0^{\circ} 35' 22.1"$
$L = 477.37'$	$L = 648.96'$
$T = 238.78'$	$T = 324.60'$
$R = 7,150.00'$	$R = 9,720.00'$
$SE = .02$	$SE = NC$
$DS = 55 MPH$	$DS = 55 MPH$

-L- US 701	
PI Sta. 129+40.61	PI Sta. 133+54.39
$\Delta = 2^{\circ} 48' 38.1" (LT)$	$\Delta = 2^{\circ} 48' 38.1" (RT)$
$D = 0^{\circ} 48' 04.8"$	$D = 0^{\circ} 35' 22.1"$
$L = 350.74'$	$L = 476.81'$
$T = 175.40'$	$T = 238.45'$
$R = 7,150.00'$	$R = 9,720.00'$

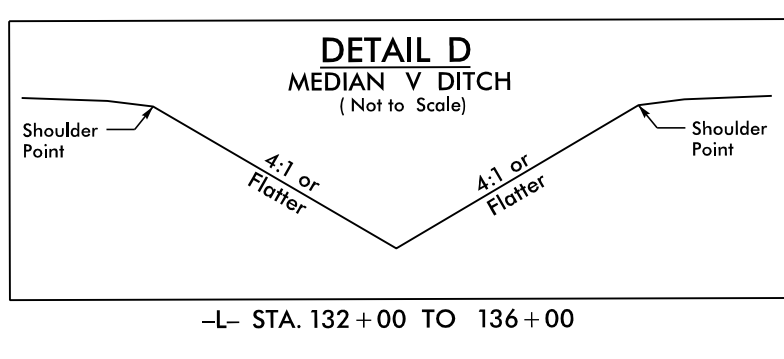
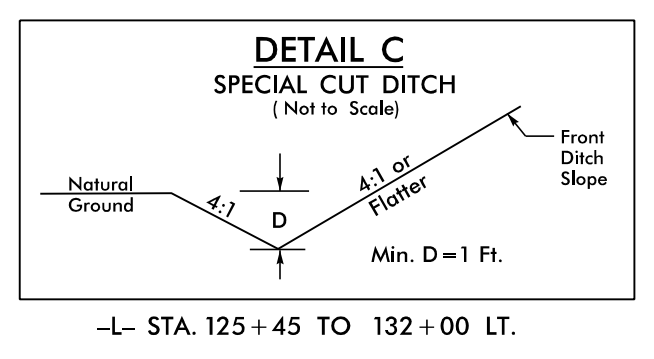

NOTE: ALL EASEMENT CALLOUTS FROM -L- UNLESS OTHERWISE NOTED

PAVEMENT REMOVAL

8/17/2020 8:17:59 B:\Projects\19-77 Division 6 On Call\02 US 701 over Cape Fear River\NCDOT\Hydraulics\CADD\PSHYE\reosonControl\US701-EC-ps06\_FINAL.dgn