

NOTE: PLACE TEMPORARY ROCK SEDIMENT DAMS TYPE - B AND TEMPORARY ROCK SILT CHECKS TYPE - A AT DRAINAGE OUTLETS.

NOTE: PERIMETER EROSION CONTROL MEASURES SHALL BE INSTALLED DURING CLEARING AND GRUBBING PHASE.

UTILIZE FABRIC INSERT INLET PROTECTION DEVICE AS DIRECTED IN LIEU OF ROCK INLET SEDIMENT TRAP TYPE C TO AVOID IMPOUNDING RUNOFF ON ROADWAYS OPEN TO THE PUBLIC

UTILIZE SPECIAL STILLING BASIN(S) WHERE APPLICABLE

CLEARING AND GRUBBING EROSION CONTROL FOR CONSTRUCTION SHEET 6



MATCHLINE SHEET 5
STA 127+00

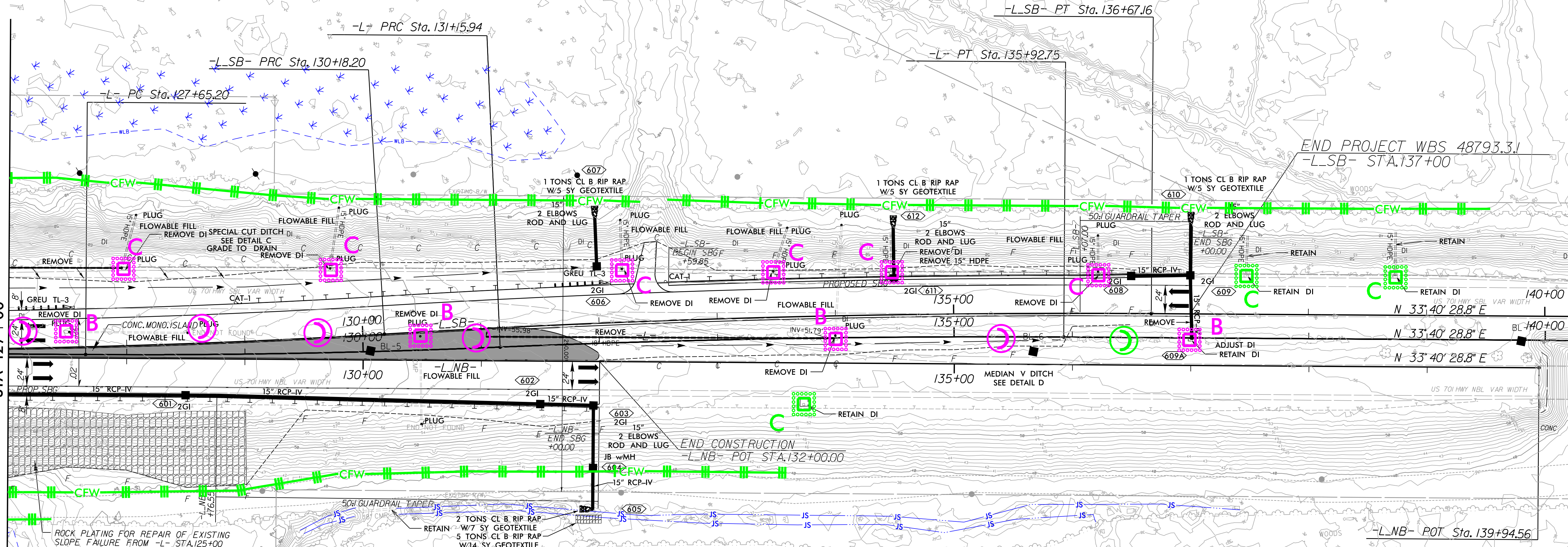

ROCK PLATING FOR REPAIR OF EXISTING SLOPE FAILURE FROM -L- STA. 125+00 TO 129+00. CLEAR AND GRUB EXISTING SLOPE. SEE SHEET 36-1 AND STB.DWG. 275.01 (DETAIL 2)

-L-SB- US 701 SOUTHBOUND	
PI Sta 127+79.60	PI Sta 133+42.80
$\Delta = 3^{\circ} 49' 31.4''$ (LT)	$\Delta = 3^{\circ} 49' 31.4''$ (RT)
D = 0' 48' 04.8"	D = 0' 35' 22.1"
L = 477.37'	L = 648.96'
T = 238.78'	T = 324.60'
R = 7,150.00'	R = 9,720.00'
SE = .02	SE = NC
DS = 55 MPH	DS = 55 MPH

-L- US 701	
PI Sta 129+40.61	PI Sta 133+54.39
$\Delta = 2^{\circ} 48' 38.1''$ (LT)	$\Delta = 2^{\circ} 48' 38.1''$ (RT)
D = 0' 48' 04.8"	D = 0' 35' 22.1"
L = 350.74'	L = 476.81'
T = 175.40'	T = 238.45'
R = 7,150.00'	R = 9,720.00'

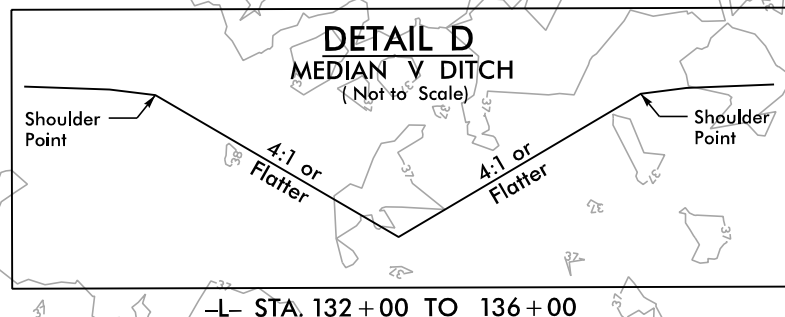
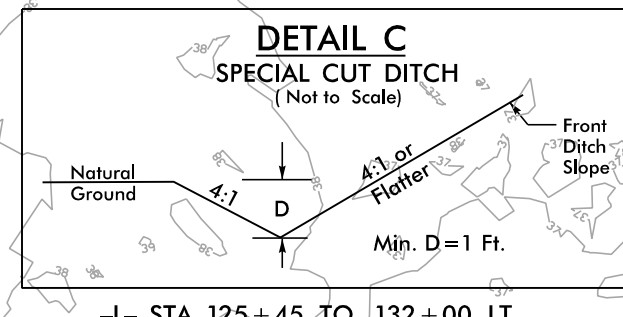

PAVEMENT REMOVAL

NOTE: ALL EASEMENT CALLOUTS FROM -L- UNLESS OTHERWISE NOTED

8/17/19 8/1/2020 R:\Projects\19-77 Division 6 On Call\02 US 701 over Cape Fear River\NCDOT\Hydraulics\CADD\PSHA\ErosionControl\US701-EC_psh06_C&G.dgn