

**Location and Surveys**

NCDOT LOCATION AND SURVEYS  
 DIVISION 6  
 4834 HWY 301 SOUTH  
 HOPE MILLS, NC 28348

PROJECT SURVEYOR

DocuSigned by:  
 John E. Kaukola  
 F360558AF78462

DOCUMENT NOT CONSIDERED FINAL UNLESS ALL SIGNATURES COMPLETED



REVISIONS

I:\AUG-2020\1717P\_P1816400\_Monitoring\_2020\NUS701-ETown\Full\_Survey\_04-2020\1b-RW\_plans\Front\CE\Updated ROW files for J-Stilwell\US701-ETown\psh05.ls.dgn  
 P:\1816400\_Monitoring\_2020\NUS701-ETown\Full\_Survey\_04-2020\1b-RW\_plans\Front\CE\Updated ROW files for J-Stilwell\US701-ETown\psh05.ls.dgn  
 AT: D:\16-312634\_cmblesimon

MATCHLINE SHEET 4  
 STA 114+00

MATCHLINE SHEET 6  
 STA 127+00

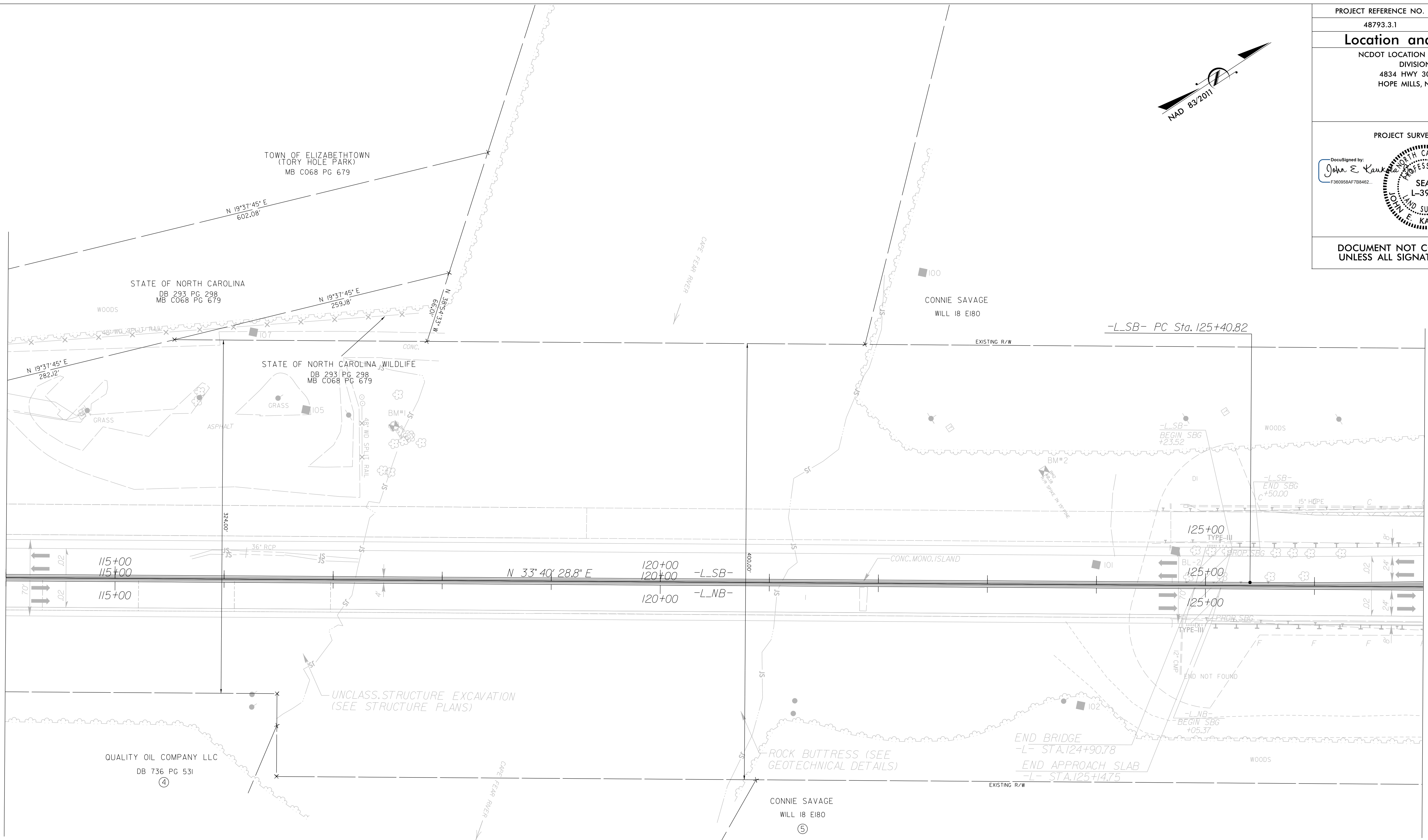

**-L.SB- US 701 SOUTHBOUND**

|        |                 |
|--------|-----------------|
| PI Sta | 127+79.60       |
| Δ      | 3°49'31.4" (LT) |
| D      | 0'48'04.8"      |
| L      | 477.37'         |
| T      | 238.78'         |
| R      | 7,150.00'       |
| SE     | .02             |
| DS     | 55 MPH          |

I, John E. Kaukola, certify that the right of way and permanent easement monumentation for this project shown herein was completed under my direct and responsible charge from an actual survey made under my supervision; that all horizontal closures had a minimum ratio of precision of 1:10,000 (Class A). Field work was performed July of 2020, and all coordinates are based on NAD83/2011. That this survey was performed to meet the requirements of 21NCAC 56.1600 as applicable.

This 15th day of July, 2020.  
 Signed by:  
 John E. Kaukola Jr.  
 Professional Land Surveyor L-3999



**NOTES:**

1. IF FURTHER INFORMATION REGARDING PROJECT CONTROL IS NEEDED PLEASE CONTACT THE LOCATION AND SURVEYS UNIT.
2. PROJECT CONTROL WAS ESTABLISHED USING GNSS, THE GLOBAL NAVIGATION SATELLITE SYSTEM.
3. RIGHT OF WAY MONUMENTATION ESTABLISHED JULY 2020.