



STATE OF NORTH CAROLINA
DEPARTMENT OF TRANSPORTATION

ROY COOPER
GOVERNOR

J. ERIC BOYETTE
SECRETARY

April 30, 2020

Addendum No. 1

RE: Contract # C204350

WBS # 47617.3.1, 49074.3.1, 49075.3.1

FA# NHP-1522(005), STATE FUNDED

Nash County (B-5980/BR-0039/BR-0036)

I-95 AT SR-1544 (HALIFAX RD), BRIDGE #41 OVER I-95 ON NC-33,
AND BRIDGE #224 OVER I-95 ON SR-1510.

May 19, 2020 Letting

To Whom It May Concern:

Reference is made to the plans and proposal form furnished to you on this project.

The following revisions have been made to the Structure plans.

Sheet No.	Revision
S-03	New item added to the Bill of Materials reflecting pay item addition shown below

Please void the above listed existing Sheet in your plans and staple the revised Sheet thereto.

The following revisions have been made to the proposal:

Page No.	Revisions
Proposal Cover	Note added that reads "Includes Addendum No. 1 Dated 04-30-2020"
Table of Contents	Under PROJECT SPECIAL PROVISIONS added DELAY IN RIGHT OF ENTRY and NOTE TO CONTRACTOR
G-36	The Project Special Provision entitled DELAY IN RIGHT OF ENTRY has been added.
G-36	The Project Special Provision entitled NOTE TO CONTRACTOR has been added.

Please void the above listed existing Pages in your proposal and staple the revised Pages thereto.

Mailing Address:
NC DEPARTMENT OF TRANSPORTATION
CONTRACT STANDARDS AND DEVELOPMENT
1591 MAIL SERVICE CENTER
RALEIGH, NC 27699-1591

Telephone: (919) 707-6900
Fax: (919) 250-4127
Customer Service: 1-877-368-4968

Location:
1020 BIRCH RIDGE DR.
RALEIGH, NC 27610

Website: www.ncdot.gov

On the item sheets the following pay item revision has been made:

<u>Item</u>	<u>Description</u>	<u>Old Quantity</u>	<u>New Quantity</u>
0325-8035000000- N-402	REMOVAL OF EXISTING STRUCTURE AT STATION 17+07.50 - Y2-	New Item	Lump Sum

The Contractor's bid must include this pay item revision.

The electronic bidding file has been updated to reflect this revision. Please download the Addendum File and follow the instructions for applying the addendum. Bid Express will not accept your bid unless the addendum has been applied.

The contract will be prepared accordingly.

Sincerely,

DocuSigned by:

 F81B6038A47A442...
 Ronald E. Davenport, Jr., PE
 State Contract Officer

RED/jjr
 Attachments

cc: Mr. Lamar Sylvester, PE
 Mr. Kevin Bowen, PE
 Mr. Chris Peoples, PE
 Mr. Jon Weathersbee, PE
 Mr. Ken Kennedy, PE
 Project File (2)

Mr. Ray Arnold, PE
 Ms. Jaci Kincaid
 Ms. Lori Strickland
 Mr. Mike Gwyn
 Ms. Penny Higgins
 Mr. Mitchell Dixon
 Mr. Kyle Kempf

STATE OF NORTH CAROLINA
DEPARTMENT OF TRANSPORTATION
RALEIGH, N.C.

PROPOSAL

INCLUDES ADDENDUM No.1 DATED 04-30-2020

DATE AND TIME OF BID OPENING: **MAY 19, 2020 AT 2:00 PM**

CONTRACT ID C204350
WBS 47617.3.1, 49074.3.1, 49075.3.1

FEDERAL-AID NO. NHP-1522(005), STATE FUNDED
COUNTY NASH
T.I.P. NO. B-5980, BR-0036, BR-0039
MILES 1.282
ROUTE NO. I 95
LOCATION I-95 AT SR-1544 (HALIFAX RD), BRIDGE #41 OVER I-95 ON NC-33,
AND BRIDGE #224 OVER I-95 ON SR-1510.
TYPE OF WORK GRADING, DRAINAGE, PAVING, AND STRUCTURES.

NOTICE:

ALL BIDDERS SHALL COMPLY WITH ALL APPLICABLE LAWS REGULATING THE PRACTICE OF GENERAL CONTRACTING AS CONTAINED IN CHAPTER 87 OF THE GENERAL STATUTES OF NORTH CAROLINA WHICH REQUIRES THE BIDDER TO BE LICENSED BY THE N.C. LICENSING BOARD FOR CONTRACTORS WHEN BIDDING ON ANY NON-FEDERAL AID PROJECT WHERE THE BID IS \$30,000 OR MORE, EXCEPT FOR CERTAIN SPECIALTY WORK AS DETERMINED BY THE LICENSING BOARD. BIDDERS SHALL ALSO COMPLY WITH ALL OTHER APPLICABLE LAWS REGULATING THE PRACTICES OF ELECTRICAL, PLUMBING, HEATING AND AIR CONDITIONING AND REFRIGERATION CONTRACTING AS CONTAINED IN CHAPTER 87 OF THE GENERAL STATUTES OF NORTH CAROLINA. NOTWITHSTANDING THESE LIMITATIONS ON BIDDING, THE BIDDER WHO IS AWARDED ANY FEDERAL - AID FUNDED PROJECT SHALL COMPLY WITH CHAPTER 87 OF THE GENERAL STATUTES OF NORTH CAROLINA FOR LICENSING REQUIREMENTS WITHIN 60 CALENDAR DAYS OF BID OPENING.

BIDS WILL BE RECEIVED AS SHOWN BELOW:

THIS IS A ROADWAY & STRUCTURE PROPOSAL

5% BID BOND OR BID DEPOSIT REQUIRED

TABLE OF CONTENTS

COVER SHEET

PROPOSAL SHEET

PROJECT SPECIAL PROVISIONS

CONTRACT TIME AND LIQUIDATED DAMAGES: G-1
 INTERMEDIATE CONTRACT TIME NUMBER 1 AND LIQUIDATED DAMAGES: G-1
 INTERMEDIATE CONTRACT TIME NUMBER 2 AND LIQUIDATED DAMAGES: G-2
 INTERMEDIATE CONTRACT TIME NUMBER 3 AND LIQUIDATED DAMAGES: G-3
 INTERMEDIATE CONTRACT TIME NUMBER 4 AND LIQUIDATED DAMAGES: G-4
 INTERMEDIATE CONTRACT TIME NUMBER 5 AND LIQUIDATED DAMAGES: G-5
 INTERMEDIATE CONTRACT TIME NUMBER 6 AND LIQUIDATED DAMAGES: G-5
 INTERMEDIATE CONTRACT TIME NUMBER 7 AND LIQUIDATED DAMAGES: G-6
 INTERMEDIATE CONTRACT TIME NUMBER 8 AND LIQUIDATED DAMAGES: G-6
 INTERMEDIATE CONTRACT TIME NUMBER 9 AND LIQUIDATED DAMAGES: G-6
 INTERMEDIATE CONTRACT TIME NUMBER 10 AND LIQUIDATED DAMAGES: G-7
 INTERMEDIATE CONTRACT TIME NUMBER 11 AND LIQUIDATED DAMAGES: G-7
 INTERMEDIATE CONTRACT TIME NUMBER 12 AND LIQUIDATED DAMAGES: G-7
 INTERMEDIATE CONTRACT TIME NUMBER 13 AND LIQUIDATED DAMAGES: G-7
 PERMANENT VEGETATION ESTABLISHMENT:..... G-8
 MAJOR CONTRACT ITEMS: G-9
 SPECIALTY ITEMS:..... G-9
 FUEL PRICE ADJUSTMENT:..... G-9
 SCHEDULE OF ESTIMATED COMPLETION PROGRESS:..... G-10
 DISADVANTAGED BUSINESS ENTERPRISE: G-10
 CERTIFICATION FOR FEDERAL-AID CONTRACTS: G-24
 CONTRACTOR'S LICENSE REQUIREMENTS:..... G-24
 USE OF UNMANNED AIRCRAFT SYSTEM (UAS): G-24
 U.S. DEPARTMENT OF TRANSPORTATION HOTLINE: G-25
 CARGO PREFERENCE ACT: G-25
 SUBSURFACE INFORMATION:..... G-26
 PORTABLE CONCRETE BARRIER - (Partial Payments for Materials):..... G-26
 REMOVABLE PAVEMENT MARKINGS - (Partial Payments for Materials):..... G-26
 MAINTENANCE OF THE PROJECT: G-26
 COOPERATION BETWEEN CONTRACTORS:..... G-27
 AWARD OF CONTRACT:..... G-27
 ELECTRONIC BIDDING:..... G-28
 TWELVE MONTH GUARANTEE:..... G-28
 EROSION AND SEDIMENT CONTROL/STORMWATER CERTIFICATION: G-29
 PROCEDURE FOR MONITORING BORROW PIT DISCHARGE:..... G-34
 DELAY IN RIGHT OF ENTRY:..... G-36
 NOTE TO CONTRACTOR: G-36
 ROADWAY..... R-1

STANDARD SPECIAL PROVISIONS

AVAILABILITY FUNDS – TERMINATION OF CONTRACTS SSP-1
 NCDOT GENERAL SEED SPECIFICATION FOR SEED QUALITY SSP-2

DELAY IN RIGHT OF ENTRY:

(7-1-95)

108

SPI G22 B

The Contractor will not be allowed right of entry to the following parcels prior to the listed dates unless otherwise permitted by the Engineer.

Parcel No.	Property Owner	Date
B-5980 004	WAKE STONE CORP- *BILLBOARD AREAS ONLY	7/24/2020
BR-0036 002	GENE WATSON	8/15/2020
BR-0036 003	HICKORY MEADOWS, INC.	8/15/2020
BR-0036 004	V F FUTURES, LLC	8/15/2020
BR-0039 001/003	JOEL BOSEMAN	6/15/2021
BR-0039 002	H & C LAND DEVELOPMENT, LLC	6/15/2021
BR-0039 004	GEORGE RICHARDSON	6/15/2021
BR-0039 005	BRAVE QUEST CORP.	6/15/2021
BR-0039 006	SELMA HARRISON	6/15/2021
BR-0039 007	GLENDARINE LYNCH	6/15/2021
BR-0039 008	MCTYEIRE CEMETERY	6/15/2021
BR-0039 009	GOLD ROCK CLUB, INC.	6/15/2021

NOTE TO CONTRACTOR:

Borrow material on this project shall be in accordance with Subarticle 1018-2 (A) **Statewide Criteria for Acceptance of Borrow Material** and meet the requirements contained therein.

County : Nash

Line #	Item Number	Sec #	Description	Quantity	Unit Cost	Amount
ROADWAY ITEMS						
0001	0000100000-N	800	MOBILIZATION	Lump Sum	L.S.	
0002	0000400000-N	801	CONSTRUCTION SURVEYING	Lump Sum	L.S.	
0003	0001000000-E	200	CLEARING & GRUBBING .. ACRE(S)	Lump Sum	L.S.	
0004	0008000000-E	200	SUPPLEMENTARY CLEARING & GRUB- BING	3 ACR		
0005	0022000000-E	225	UNCLASSIFIED EXCAVATION	18,695 CY		
0006	0028000000-N	SP	TYPE I STANDARD APPROACH FILL STATION ***** (42+56.82 -Y1-)	Lump Sum	L.S.	
0007	0030000000-N	SP	TYPE II MODIFIED APPROACH FILL, STATION ***** (19+07.12 -L-)	Lump Sum	L.S.	
0008	0030000000-N	SP	TYPE II MODIFIED APPROACH FILL, STATION ***** (28+02.81 -L-)	Lump Sum	L.S.	
0009	0036000000-E	225	UNDERCUT EXCAVATION	6,400 CY		
0010	0084000000-E	SP	WICK DRAINS	205,000 LF		
0011	0106000000-E	230	BORROW EXCAVATION	332,900 CY		
0012	0127000000-N	235	EMBANKMENT SETTLEMENT GAUGES	8 EA		
0013	0134000000-E	240	DRAINAGE DITCH EXCAVATION	7,165 CY		
0014	0156000000-E	250	REMOVAL OF EXISTING ASPHALT PAVEMENT	21,730 SY		
0015	0163000000-E	250	REMOVAL OF EXISTING CONCRETE PAVEMENT	12,550 SY		
0016	0177000000-E	250	BREAKING OF EXISTING ASPHALT PAVEMENT	4,600 SY		
0017	0194000000-E	265	SELECT GRANULAR MATERIAL, CLASS III	13,600 CY		

County : Nash

Line #	Item Number	Sec #	Description	Quantity	Unit Cost	Amount
0018	0196000000-E	270	GEOTEXTILE FOR SOIL STABILIZATION	14,600 SY		
0019	0199000000-E	SP	TEMPORARY SHORING	3,070 SF		
0020	0223000000-E	275	ROCK PLATING	4,510 SY		
0021	0241000000-E	SP	GENERIC GRADING ITEM GEOTEXTILE FOR WICK DRAINS	10,400 SY		
0022	0255000000-E	SP	GENERIC GRADING ITEM HAULING AND DISPOSAL OF PETRO- LEUM CONTAMINATED SOIL	50 TON		
0023	0318000000-E	300	FOUNDATION CONDITIONING MATE- RIAL, MINOR STRUCTURES	526 TON		
0024	0320000000-E	300	FOUNDATION CONDITIONING GEO- TEXTILE	1,593 SY		
0025	0335200000-E	305	15" DRAINAGE PIPE	208 LF		
0026	0335850000-E	305	*** DRAINAGE PIPE ELBOWS (15")	4 EA		
0027	0354000000-E	310	**** RC PIPE CULVERTS, CLASS ***** (18", V)	160 LF		
0028	0354000000-E	310	**** RC PIPE CULVERTS, CLASS ***** (54", V)	256 LF		
0029	0366000000-E	310	15" RC PIPE CULVERTS, CLASS III	192 LF		
0030	0372000000-E	310	18" RC PIPE CULVERTS, CLASS III	384 LF		
0031	0378000000-E	310	24" RC PIPE CULVERTS, CLASS III	84 LF		
0032	0384000000-E	310	30" RC PIPE CULVERTS, CLASS III	320 LF		
0033	0390000000-E	310	36" RC PIPE CULVERTS, CLASS III	144 LF		

County : Nash

Line #	Item Number	Sec #	Description	Quantity	Unit Cost	Amount
0034	0448200000-E	310	15" RC PIPE CULVERTS, CLASS IV	1,220 LF		
0035	0448400000-E	310	24" RC PIPE CULVERTS, CLASS IV	320 LF		
0036	0448500000-E	310	30" RC PIPE CULVERTS, CLASS IV	200 LF		
0037	0448600000-E	310	36" RC PIPE CULVERTS, CLASS IV	440 LF		
0038	0582000000-E	310	15" CS PIPE CULVERTS, 0.064" THICK	496 LF		
0039	0636000000-E	310	*** CS PIPE ELBOWS, ***** THICK (15", 0.064")	10 EA		
0040	0973100000-E	330	*** WELDED STEEL PIPE, ***** THICK, GRADE B IN SOIL (30", 0.500")	388 LF		
0041	0973100000-E	330	*** WELDED STEEL PIPE, ***** THICK, GRADE B IN SOIL (36", 0.375")	96 LF		
0042	0973300000-E	330	*** WELDED STEEL PIPE, ***** THICK, GRADE B NOT IN SOIL (30", 0.500")	388 LF		
0043	0973300000-E	330	*** WELDED STEEL PIPE, ***** THICK, GRADE B NOT IN SOIL (36", 0.375")	96 LF		
0044	0995000000-E	340	PIPE REMOVAL	462 LF		
0045	1000000000-E	462	6" SLOPE PROTECTION	230 SY		
0046	1011000000-N	500	FINE GRADING	Lump Sum	L.S.	
0047	1099500000-E	505	SHALLOW UNDERCUT	1,900 CY		
0048	1099700000-E	505	CLASS IV SUBGRADE STABILIZATION	3,600 TON		
0049	1121000000-E	520	AGGREGATE BASE COURSE	2,223 TON		
0050	1220000000-E	545	INCIDENTAL STONE BASE	2,700 TON		

County : Nash

Line #	Item Number	Sec #	Description	Quantity	Unit Cost	Amount
0051	1297000000-E	607	MILLING ASPHALT PAVEMENT, **** DEPTH (1-1/2")	7,500 SY		
0052	1308000000-E	607	MILLING ASPHALT PAVEMENT, **** TO ***** (0" TO 1-1/2")	560 SY		
0053	1308000000-E	607	MILLING ASPHALT PAVEMENT, **** TO ***** (0" TO 3")	220 SY		
0054	1330000000-E	607	INCIDENTAL MILLING	2,930 SY		
0055	1491000000-E	610	ASPHALT CONC BASE COURSE, TYPE B25.0C	13,935 TON		
0056	1503000000-E	610	ASPHALT CONC INTERMEDIATE COURSE, TYPE I19.0C	6,210 TON		
0057	1519000000-E	610	ASPHALT CONC SURFACE COURSE, TYPE S9.5B	835 TON		
0058	1523000000-E	610	ASPHALT CONC SURFACE COURSE, TYPE S9.5C	3,455 TON		
0059	1524200000-E	610	ASPHALT CONC SURFACE COURSE, TYPE S9.5D	4,080 TON		
0060	1575000000-E	620	ASPHALT BINDER FOR PLANT MIX	1,197 TON		
0061	1577000000-E	620	POLYMER MODIFIED ASPHALT BIN- DER FOR PLANT MIX	238 TON		
0062	1693000000-E	654	ASPHALT PLANT MIX, PAVEMENT REPAIR	750 TON		
0063	1840000000-E	665	MILLED RUMBLE STRIPS (ASPHALT CONCRETE)	910 LF		
0064	1847000000-E	710	***** PORT CEM CONC PAVEMENT, THROUGH LANES (WITH DOWELS) (11")	6,381 SY		
0065	1891000000-E	SP	GENERIC PAVING ITEM 11" CONCRETE TRUCK APRON	1,571 SY		
0066	2000000000-N	806	RIGHT-OF-WAY MARKERS	11 EA		

County : Nash

Line #	Item Number	Sec #	Description	Quantity	Unit Cost	Amount
0067	2020000000-N	806	CONTROL-OF-ACCESS MARKERS	16 EA		
0068	2022000000-E	815	SUBDRAIN EXCAVATION	224 CY		
0069	2026000000-E	815	GEOTEXTILE FOR SUBSURFACE DRAINS	1,000 SY		
0070	2036000000-E	815	SUBDRAIN COARSE AGGREGATE	168 CY		
0071	2044000000-E	815	6" PERFORATED SUBDRAIN PIPE	1,000 LF		
0072	2070000000-N	815	SUBDRAIN PIPE OUTLET	2 EA		
0073	2077000000-E	815	6" OUTLET PIPE	12 LF		
0074	2209000000-E	838	ENDWALLS	14.1 CY		
0075	2220000000-E	838	REINFORCED ENDWALLS	5 CY		
0076	2253000000-E	840	PIPE COLLARS	1 CY		
0077	2275000000-E	SP	FLOWABLE FILL	150 CY		
0078	2286000000-N	840	MASONRY DRAINAGE STRUCTURES	36 EA		
0079	2308000000-E	840	MASONRY DRAINAGE STRUCTURES	49.5 LF		
0080	2364200000-N	840	FRAME WITH TWO GRATES, STD 840.20	4 EA		
0081	2365000000-N	840	FRAME WITH TWO GRATES, STD 840.22	6 EA		
0082	2366000000-N	840	FRAME WITH TWO GRATES, STD 840.24	4 EA		
0083	2367000000-N	840	FRAME WITH TWO GRATES, STD 840.29	8 EA		
0084	2374000000-N	840	FRAME WITH GRATE & HOOD, STD 840.03, TYPE ** (F)	3 EA		
0085	2396000000-N	840	FRAME WITH COVER, STD 840.54	7 EA		

County : Nash

Line #	Item Number	Sec #	Description	Quantity	Unit Cost	Amount
0086	2407000000-N	840	STEEL FRAME WITH TWO GRATES, STD 840.37	4 EA		
0087	2440000000-N	852	CONCRETE TRANSITIONAL SECTION FOR CATCH BASIN	3 EA		
0088	2451000000-N	852	CONCRETE TRANSITIONAL SECTION FOR DROP INLET	4 EA		
0089	2542000000-E	846	1'-6" CONCRETE CURB & GUTTER	860 LF		
0090	2556000000-E	846	SHOULDER BERM GUTTER	301 LF		
0091	2647000000-E	852	5" MONOLITHIC CONCRETE ISLANDS (SURFACE MOUNTED)	550 SY		
0092	2655000000-E	852	5" MONOLITHIC CONCRETE ISLANDS (KEYED IN)	360 SY		
0093	2752000000-E	SP	GENERIC PAVING ITEM 1'-6" CONCRETE CURB & GUTTER (11" DEPTH)	1,370 LF		
0094	3030000000-E	862	STEEL BEAM GUARDRAIL	12,471 LF		
0095	3045000000-E	862	STEEL BEAM GUARDRAIL, SHOP CURVED	675 LF		
0096	3150000000-N	862	ADDITIONAL GUARDRAIL POSTS	15 EA		
0097	3210000000-N	862	GUARDRAIL END UNITS, TYPE CAT-1	3 EA		
0098	3215000000-N	SP	GUARDRAIL ANCHOR UNITS, TYPE III	5 EA		
0099	3287000000-N	SP	GUARDRAIL END UNITS, TYPE TL-3	21 EA		
0100	3288000000-N	SP	GUARDRAIL END UNITS, TYPE TL-2	5 EA		
0101	3317000000-N	SP	GUARDRAIL ANCHOR UNITS, TYPE B-77	12 EA		
0102	3360000000-E	863	REMOVE EXISTING GUARDRAIL	15,715 LF		
0103	3389400000-E	865	DOUBLE FACED CABLE GUIDERAIL	925 LF		

County : Nash

Line #	Item Number	Sec #	Description	Quantity	Unit Cost	Amount
0104	3389500000-N	865	ADDITIONAL GUIDERAIL POSTS	5 EA		
0105	3389600000-N	865	CABLE GUIDERAIL ANCHOR UNITS	2 EA		
0106	3503000000-E	866	WOVEN WIRE FENCE, 47" FABRIC	3,050 LF		
0107	3509000000-E	866	4" TIMBER FENCE POSTS, 7'-6" LONG	194 EA		
0108	3515000000-E	866	5" TIMBER FENCE POSTS, 8'-0" LONG	45 EA		
0109	3557000000-E	866	ADDITIONAL BARBED WIRE	350 LF		
0110	3566000000-E	867	WOVEN WIRE FENCE RESET	430 LF		
0111	3628000000-E	876	RIP RAP, CLASS I	651 TON		
0112	3649000000-E	876	RIP RAP, CLASS B	536 TON		
0113	3656000000-E	876	GEOTEXTILE FOR DRAINAGE	2,290 SY		
0114	4025000000-E	901	CONTRACTOR FURNISHED, TYPE *** SIGN (A)	626 SF		
0115	4025000000-E	901	CONTRACTOR FURNISHED, TYPE *** SIGN (D)	422 SF		
0116	4025000000-E	901	CONTRACTOR FURNISHED, TYPE *** SIGN (E)	397 SF		
0117	4025000000-E	901	CONTRACTOR FURNISHED, TYPE *** SIGN (F)	203 SF		
0118	4025000000-E	901	CONTRACTOR FURNISHED, TYPE *** SIGN (MILEMARKER)	4 SF		
0119	4048000000-E	902	REINFORCED CONCRETE SIGN FOUN- DATIONS	1 CY		
0120	4054000000-E	902	PLAIN CONCRETE SIGN FOUNDA- TIONS	1 CY		

County : Nash

Line #	Item Number	Sec #	Description	Quantity	Unit Cost	Amount
0121	4060000000-E	903	SUPPORTS, BREAKAWAY STEEL BEAM	2,224 LB		
0122	4072000000-E	903	SUPPORTS, 3-LB STEEL U-CHANNEL	2,727 LF		
0123	4096000000-N	904	SIGN ERECTION, TYPE D	12 EA		
0124	4102000000-N	904	SIGN ERECTION, TYPE E	84 EA		
0125	4108000000-N	904	SIGN ERECTION, TYPE F	102 EA		
0126	4109000000-N	904	SIGN ERECTION, TYPE *** (OVER- HEAD) (A)	2 EA		
0127	4110000000-N	904	SIGN ERECTION, TYPE *** (GROUND MOUNTED) (A)	4 EA		
0128	4110000000-N	904	SIGN ERECTION, TYPE *** (GROUND MOUNTED) (B)	4 EA		
0129	4114000000-N	904	SIGN ERECTION, MILEMARKERS	2 EA		
0130	4116200000-N	904	SIGN ERECTION, REPOSITION OVERHEAD	1 EA		
0131	4155000000-N	907	DISPOSAL OF SIGN SYSTEM, U- CHANNEL	46 EA		
0132	4155000000-N	907	DISPOSAL OF SIGN SYSTEM, U- CHANNEL (E)	2 EA		
0133	4192000000-N	907	DISPOSAL OF SUPPORT, U-CHANNEL	33 EA		
0134	4234000000-N	907	DISPOSAL OF SIGN, A OR B (OVERHEAD)	5 EA		
0135	4236000000-N	907	DISPOSAL OF SIGN, A & B (GROUND MOUNTED)	4 EA		
0136	4238000000-N	907	DISPOSAL OF SIGN, D, E OR F	70 EA		
0137	4238500000-N	907	DISPOSAL OF SIGN, MILEMARKER	2 EA		

County : Nash

Line #	Item Number	Sec #	Description	Quantity	Unit Cost	Amount
0138	4251000000-N	907	DISPOSAL OF LIGHTING SYSTEM	5	EA	
0139	4400000000-E	1110	WORK ZONE SIGNS (STATIONARY)	3,589	SF	
0140	4402000000-E	SP	HIGH VISIBILITY STATIONARY SIGNS	186	SF	
0141	4405000000-E	1110	WORK ZONE SIGNS (PORTABLE)	384	SF	
0142	4407000000-E	SP	HIGH VISIBILITY PORTABLE SIGNS	304	SF	
0143	4410000000-E	1110	WORK ZONE SIGNS (BARRICADE MOUNTED)	531	SF	
0144	4415000000-N	1115	FLASHING ARROW BOARD	10	EA	
0145	4420000000-N	1120	PORTABLE CHANGEABLE MESSAGE SIGN	10	EA	
0146	4422000000-N	1120	PORTABLE CHANGEABLE MESSAGE SIGN (SHORT TERM)	90	DAY	
0147	4423000000-N	SP	WORK ZONE DIGITAL SPEED LIMIT SIGNS	4	EA	
0148	4424000000-N	SP	WORK ZONE PRESENCE LIGHTING	16	EA	
0149	4430000000-N	1130	DRUMS	650	EA	
0150	4432000000-N	SP	HIGH VISIBILITY DRUMS	80	EA	
0151	4434000000-N	SP	SEQUENTIAL FLASHING WARNING LIGHTS	44	EA	
0152	4445000000-E	1145	BARRICADES (TYPE III)	784	LF	
0153	4455000000-N	1150	FLAGGER	53	DAY	
0154	4465000000-N	1160	TEMPORARY CRASH CUSHIONS	7	EA	
0155	4470000000-N	1160	REMOVE & RESET TEMPORARY CRASH CUSHION	2	EA	
0156	4480000000-N	1165	TMA	9	EA	

County : Nash

Line #	Item Number	Sec #	Description	Quantity	Unit Cost	Amount
0157	4485000000-E	1170	PORTABLE CONCRETE BARRIER	3,088 LF		
0158	4490000000-E	1170	PORTABLE CONCRETE BARRIER (ANCHORED)	1,020 LF		
0159	4500000000-E	1170	REMOVE AND RESET PORTABLE CON- CRETE BARRIER	2,254 LF		
0160	4510000000-N	1190	LAW ENFORCEMENT	352 HR		
0161	4516000000-N	1180	SKINNY DRUM	300 EA		
0162	4630000000-N	1251	TEMPORARY RAISED PAVEMENT MARKERS	74 EA		
0163	4685000000-E	1205	THERMOPLASTIC PAVEMENT MARKING LINES (4", 90 MILS)	27,608 LF		
0164	4688000000-E	1205	THERMOPLASTIC PAVEMENT MARKING LINES (6", 90 MILS)	15,344 LF		
0165	4695000000-E	1205	THERMOPLASTIC PAVEMENT MARKING LINES (8", 90 MILS)	1,129 LF		
0166	4700000000-E	1205	THERMOPLASTIC PAVEMENT MARKING LINES (12", 90 MILS)	1,576 LF		
0167	4720000000-E	1205	THERMOPLASTIC PAVEMENT MARKING CHARACTER (90 MILS)	8 EA		
0168	4725000000-E	1205	THERMOPLASTIC PAVEMENT MARKING SYMBOL (90 MILS)	32 EA		
0169	4770000000-E	1205	COLD APPLIED PLASTIC PAVEMENT MARKING LINES, TYPE ** (4") (IV)	1,809 LF		
0170	4810000000-E	1205	PAINT PAVEMENT MARKING LINES (4")	34,421 LF		
0171	4820000000-E	1205	PAINT PAVEMENT MARKING LINES (8")	120 LF		
0172	4835000000-E	1205	PAINT PAVEMENT MARKING LINES (24")	136 LF		
0173	4845000000-N	1205	PAINT PAVEMENT MARKING SYMBOL	20 EA		

County : Nash

Line #	Item Number	Sec #	Description	Quantity	Unit Cost	Amount
0174	4847010000-E	1205	POLYUREA PAVEMENT MARKING LINES (4", 20 MILS)	4,287 LF		
0175	4847030000-E	1205	POLYUREA PAVEMENT MARKING LINES (6", 20 MILS)	3,825 LF		
0176	4847070000-E	1205	POLYUREA PAVEMENT MARKING LINES (12", 20 MILS)	256 LF		
0177	4847500000-E	SP	WORK ZONE PERFORMANCE PAVEMENT MARKING LINES, 6"	6,451 LF		
0178	4848000000-E	SP	WORK ZONE TRAFFIC PATTERN MASKING	86,280 SF		
0179	4875000000-N	1205	REMOVAL OF PAVEMENT MARKING SYMBOLS & CHARACTERS	3 EA		
0180	4891000000-E	1205	GENERIC PAVEMENT MARKING ITEM THERMOPLASTIC PAVEMENT MARKING LINES (24", 90 MILS)	189 LF		
0181	4895000000-N	SP	GENERIC PAVEMENT MARKING ITEM NON-CAST IRON SNOWPLOWABLE PAVEMENT MARKERS	264 EA		
0182	4900000000-N	1251	PERMANENT RAISED PAVEMENT MARKERS	46 EA		
0183	4955000000-N	1264	OBJECT MARKERS (END OF ROAD)	6 EA		
0184	5005000000-E	1401	80' HIGH MOUNT STANDARD	2 EA		
0185	5010000000-E	1401	100' HIGH MOUNT STANDARD	2 EA		
0186	5020000000-N	1401	PORTABLE DRIVE UNIT	1 EA		
0187	5025000000-E	SP	HIGH MOUNT FOUNDATIONS	34 CY		
0188	5070000000-N	SP	STANDARD FOUNDATION ***** (R1)	6 EA		
0189	5070000000-N	SP	STANDARD FOUNDATION ***** (R2)	1 EA		
0190	5120000000-N	1407	ELECTRIC SERVICE POLE ***** (30', CLASS 4)	1 EA		

County : Nash

Line #	Item Number	Sec #	Description	Quantity	Unit Cost	Amount
0191	5125000000-E	1407	ELECTRIC SERVICE LATERAL ***** (3 #1/0 USE)	25 LF		
0192	5155000000-E	1409	ELECTRICAL DUCT, TYPE BD, SIZE ***** (2")	370 LF		
0193	5160000000-E	1409	ELECTRICAL DUCT, TYPE JA, SIZE ***** (3")	530 LF		
0194	5160000000-E	1409	ELECTRICAL DUCT, TYPE JA, SIZE ***** (4")	260 LF		
0195	5170000000-E	1410	** #8 W/G FEEDER CIRCUIT (2)	300 LF		
0196	5175000000-E	1410	** #6 W/G FEEDER CIRCUIT (2)	380 LF		
0197	5180000000-E	1410	** #4 W/G FEEDER CIRCUIT (2)	300 LF		
0198	5205000000-E	1410	** #8 W/G FEEDER CIRCUIT IN ***** CONDUIT (2, 1.5")	2,390 LF		
0199	5210000000-E	1410	** #6 W/G FEEDER CIRCUIT IN ***** CONDUIT (2, 1.5")	3,440 LF		
0200	5215000000-E	1410	** #4 W/G FEEDER CIRCUIT IN ***** CONDUIT (2, 1.5")	2,220 LF		
0201	5240000000-N	1411	ELECTRICAL JUNCTION BOXES ***** (CS36)	1 EA		
0202	5240000000-N	1411	ELECTRICAL JUNCTION BOXES ***** (HM18)	6 EA		
0203	5240000000-N	1411	ELECTRICAL JUNCTION BOXES ***** (HM36)	1 EA		
0204	5240000000-N	1411	ELECTRICAL JUNCTION BOXES ***** (IG18)	9 EA		

County : Nash

Line #	Item Number	Sec #	Description	Quantity	Unit Cost	Amount
0205	5240000000-N	1411	ELECTRICAL JUNCTION BOXES ***** (IG36)	6 EA		
0206	5240000000-N	1411	ELECTRICAL JUNCTION BOXES ***** (LS18)	7 EA		
0207	5255000000-N	1413	PORTABLE LIGHTING	Lump Sum	L.S.	
0208	5260000000-N	SP	GENERIC LIGHTING ITEM EQUIPMENT STORAGE	Lump Sum	L.S.	
0209	5270000000-N	SP	GENERIC LIGHTING ITEM 100' HIGH MOUNT LUMINAIRE - LED	12 EA		
0210	5270000000-N	SP	GENERIC LIGHTING ITEM 80' HIGH MOUNT LUMINAIRE - LED	16 EA		
0211	5270000000-N	SP	GENERIC LIGHTING ITEM CONTROL NODE	9 EA		
0212	5270000000-N	SP	GENERIC LIGHTING ITEM LIGHTING CONTROL SYSTEM	1 EA		
0213	5270000000-N	SP	GENERIC LIGHTING ITEM REINSTALL COMMUNICATION GATE- WAY	1 EA		
0214	5270000000-N	SP	GENERIC LIGHTING ITEM REINSTALL SMART NODE	19 EA		
0215	5270000000-N	SP	GENERIC LIGHTING ITEM RELOCATE HIGH MOUNT LIGHT STANDARD	3 EA		
0216	5270000000-N	SP	GENERIC LIGHTING ITEM RELOCATE SINGLE ARM LIGHT STANDARD	7 EA		
0217	5270000000-N	SP	GENERIC LIGHTING ITEM REMOVE CONTROL SYSTEM	1 EA		
0218	5270000000-N	SP	GENERIC LIGHTING ITEM REMOVE LIGHT STANDARD	19 EA		
0219	5270000000-N	SP	GENERIC LIGHTING ITEM REMOVE LIGHT STANDARD FOUNDA- TION	19 EA		

County : Nash

Line #	Item Number	Sec #	Description	Quantity	Unit Cost	Amount
0220	5270000000-N	SP	GENERIC LIGHTING ITEM RETAIN SINGLE ARM LIGHT STAND- DARD	7 EA		
0221	5325600000-E	1510	6" WATER LINE	26 LF		
0222	5325800000-E	1510	8" WATER LINE	72 LF		
0223	5329000000-E	1510	DUCTILE IRON WATER PIPE FITTINGS	735 LB		
0224	5540000000-E	1515	6" VALVE	2 EA		
0225	5546000000-E	1515	8" VALVE	2 EA		
0226	5666000000-N	1515	FIRE HYDRANT	1 EA		
0227	5673000000-E	1515	FIRE HYDRANT LEG	24 LF		
0228	5686000000-E	1515	*** WATER SERVICE LINE (1")	75 LF		
0229	5801000000-E	1530	ABANDON 8" UTILITY PIPE	180 LF		
0230	5815500000-N	1530	REMOVE FIRE HYDRANT	2 EA		
0231	5872600000-E	1550	DIRECTIONAL DRILLING OF *** (1")	50 LF		
0232	6000000000-E	1605	TEMPORARY SILT FENCE	39,300 LF		
0233	6006000000-E	1610	STONE FOR EROSION CONTROL, CLASS A	1,615 TON		
0234	6009000000-E	1610	STONE FOR EROSION CONTROL, CLASS B	6,125 TON		
0235	6012000000-E	1610	SEDIMENT CONTROL STONE	3,545 TON		
0236	6015000000-E	1615	TEMPORARY MULCHING	64 ACR		
0237	6018000000-E	1620	SEED FOR TEMPORARY SEEDING	3,200 LB		
0238	6021000000-E	1620	FERTILIZER FOR TEMPORARY SEED- ING	20 TON		

County : Nash

Line #	Item Number	Sec #	Description	Quantity	Unit Cost	Amount
0239	6024000000-E	1622	TEMPORARY SLOPE DRAINS	5,250 LF		
0240	6029000000-E	SP	SAFETY FENCE	1,090 LF		
0241	6030000000-E	1630	SILT EXCAVATION	11,160 CY		
0242	6036000000-E	1631	MATTING FOR EROSION CONTROL	56,040 SY		
0243	6037000000-E	SP	COIR FIBER MAT	170 SY		
0244	6038000000-E	SP	PERMANENT SOIL REINFORCEMENT MAT	200 SY		
0245	6042000000-E	1632	1/4" HARDWARE CLOTH	2,200 LF		
0246	6043000000-E	SP	LOW PERMEABILITY GEOTEXTILE	180 SY		
0247	6071012000-E	SP	COIR FIBER WATTLE	1,540 LF		
0248	6071020000-E	SP	POLYACRYLAMIDE (PAM)	1,101 LB		
0249	6071030000-E	1640	COIR FIBER BAFFLE	2,675 LF		
0250	6071050000-E	SP	*** SKIMMER (1-1/2")	5 EA		
0251	6071050000-E	SP	*** SKIMMER (2")	1 EA		
0252	6084000000-E	1660	SEEDING & MULCHING	63.5 ACR		
0253	6087000000-E	1660	MOWING	54.25 ACR		
0254	6090000000-E	1661	SEED FOR REPAIR SEEDING	700 LB		
0255	6093000000-E	1661	FERTILIZER FOR REPAIR SEEDING	2.5 TON		
0256	6096000000-E	1662	SEED FOR SUPPLEMENTAL SEEDING	1,500 LB		
0257	6108000000-E	1665	FERTILIZER TOPDRESSING	45 TON		
0258	6114500000-N	1667	SPECIALIZED HAND MOWING	30 MHR		

Line #	Item Number	Sec #	Description	Quantity	Unit Cost	Amount
0259	6117000000-N	SP	RESPONSE FOR EROSION CONTROL	250 EA		
0260	6117500000-N	SP	CONCRETE WASHOUT STRUCTURE	23 EA		
0261	6132000000-N	SP	GENERIC EROSION CONTROL ITEM FABRIC INSERT INLET PROTECTION DEVICE CLEANOUT	16 EA		
0262	6132000000-N	SP	GENERIC EROSION CONTROL ITEM FABRIC INSERT INLET PROTECTION DEVICE	8 EA		
0263	7060000000-E	1705	SIGNAL CABLE	1,330 LF		
0264	7120000000-E	1705	VEHICLE SIGNAL HEAD (12", 3 SECTION)	2 EA		
0265	7132000000-E	1705	VEHICLE SIGNAL HEAD (12", 4 SECTION)	2 EA		
0266	7144000000-E	1705	VEHICLE SIGNAL HEAD (12", 5 SECTION)	2 EA		
0267	7264000000-E	1710	MESSENGER CABLE (3/8")	540 LF		
0268	7300000000-E	1715	UNPAVED TRENCHING (***** (1, 2")	760 LF		
0269	7300000000-E	1715	UNPAVED TRENCHING (***** (3, 2")	40 LF		
0270	7301000000-E	1715	DIRECTIONAL DRILL (***** (1, 2")	210 LF		
0271	7324000000-N	1716	JUNCTION BOX (STANDARD SIZE)	10 EA		
0272	7348000000-N	1716	JUNCTION BOX (OVER-SIZED, HEA- VY DUTY)	5 EA		
0273	7420000000-E	1722	2" RISER WITH WEATHERHEAD	5 EA		
0274	7444000000-E	1725	INDUCTIVE LOOP SAWCUT	1,580 LF		
0275	7456000000-E	1726	LEAD-IN CABLE (***** (14-2)	4,690 LF		

County : Nash

Line #	Item Number	Sec #	Description	Quantity	Unit Cost	Amount
0276	7481000000-N	SP	SITE SURVEY	1 EA		
0277	7481240000-N	SP	CAMERA WITHOUT INTERNAL LOOP EMULATOR PROCESSING UNIT	2 EA		
0278	7481260000-N	SP	EXTERNAL LOOP EMULATOR PRO- CESSING UNIT	1 EA		
0279	7636000000-N	1745	SIGN FOR SIGNALS	1 EA		
0280	7684000000-N	1750	SIGNAL CABINET FOUNDATION	1 EA		
0281	7756000000-N	1751	CONTROLLER WITH CABINET (TYPE 2070L, BASE MOUNTED)	1 EA		
0282	7780000000-N	1751	DETECTOR CARD (TYPE 2070L)	9 EA		
0283	7901000000-N	1753	CABINET BASE EXTENDER	1 EA		
0284	7980000000-N	SP	GENERIC SIGNAL ITEM CCTV CAMERA ASSEMBLY	1 EA		
0285	7980000000-N	SP	GENERIC SIGNAL ITEM CCTV WOOD POLE	1 EA		
0286	7980000000-N	SP	GENERIC SIGNAL ITEM ETHERNET EDGE SWITCH	1 EA		
0287	7980000000-N	SP	GENERIC SIGNAL ITEM FIELD EQUIPMENT CABINET	1 EA		
0288	7980000000-N	SP	GENERIC SIGNAL ITEM GROUNDING SYSTEM	1 EA		
0289	7980000000-N	SP	GENERIC SIGNAL ITEM METER BASE/DISCONNECT COMBI- NATION PANEL	1 EA		
0290	7990000000-E	SP	GENERIC SIGNAL ITEM 3 WIRE COPPER FEEDER CON- DUCTORS	430 LF		
0291	7990000000-E	SP	GENERIC SIGNAL ITEM ETHERNET CABLE	100 LF		

County : Nash

Line #	Item Number	Sec #	Description	Quantity	Unit Cost	Amount
STRUCTURE ITEMS						
0292	8021000000-N	SP	REMOVAL OF EXISTING STRUCTURE AT STATION ***** (19+07.12 -L-)	Lump Sum	L.S.	
0293	8021000000-N	SP	REMOVAL OF EXISTING STRUCTURE AT STATION ***** (28+02.81 -L-)	Lump Sum	L.S.	
0294	8035000000-N	402	REMOVAL OF EXISTING STRUCTURE AT STATION ***** (42+56.82 -Y1-)	Lump Sum	L.S.	
0295	8065000000-N	SP	ASBESTOS ASSESSMENT	Lump Sum	L.S.	
0296	8091000000-N	410	FOUNDATION EXCAVATION FOR BENT ** AT STATION ***** (1, 19+07.12 -L-)	Lump Sum	L.S.	
0297	8091000000-N	410	FOUNDATION EXCAVATION FOR BENT ** AT STATION ***** (1, 42+56.82 -Y1-)	Lump Sum	L.S.	
0298	8105560000-E	411	4'-0" DIA DRILLED PIERS IN SOIL	86.2 LF		
0299	8105660000-E	411	4'-0" DIA DRILLED PIERS NOT IN SOIL	16 LF		
0300	8112730000-N	450	PDA TESTING	3 EA		
0301	8113000000-N	411	SID INSPECTIONS	1 EA		
0302	8115000000-N	411	CSL TESTING	1 EA		
0303	8121000000-N	412	UNCLASSIFIED STRUCTURE EXCAVA- TION AT STATION ***** (19+07.12 -L-)	Lump Sum	L.S.	
0304	8121000000-N	412	UNCLASSIFIED STRUCTURE EXCAVA- TION AT STATION ***** (28+02.81 -L-)	Lump Sum	L.S.	
0305	8147000000-E	420	REINFORCED CONCRETE DECK SLAB	30,940 SF		
0306	8161000000-E	420	GROOVING BRIDGE FLOORS	30,365 SF		
0307	8182000000-E	420	CLASS A CONCRETE (BRIDGE)	468.6 CY		

County : Nash

Line #	Item Number	Sec #	Description	Quantity	Unit Cost	Amount
0308	8210000000-N	422	BRIDGE APPROACH SLABS, STATION ***** (19+07.12 -L-)	Lump Sum	L.S.	
0309	8210000000-N	422	BRIDGE APPROACH SLABS, STATION ***** (28+02.81 -L-)	Lump Sum	L.S.	
0310	8210000000-N	422	BRIDGE APPROACH SLABS, STATION ***** (42+56.82 -Y1-)	Lump Sum	L.S.	
0311	8217000000-E	425	REINFORCING STEEL (BRIDGE)	82,977 LB		
0312	8238000000-E	425	SPIRAL COLUMN REINFORCING STEEL (BRIDGE)	6,885 LB		
0313	8274000000-E	430	MODIFIED 63" PRESTRESSED CONC GIRDERS	1,143.33 LF		
0314	8280000000-E	440	APPROX LBS STRUCTURAL STEEL	896,000 LS		
0315	8328200000-E	450	PILE DRIVING EQUIPMENT SETUP FOR *** STEEL PILES (HP 12 X 53)	111 EA		
0316	8364000000-E	450	HP12X53 STEEL PILES	5,647 LF		
0317	8391000000-N	450	STEEL PILE POINTS	24 EA		
0318	8393000000-N	450	PILE REDRIVES	30 EA		
0319	8503000000-E	460	CONCRETE BARRIER RAIL	1,437.03 LF		
0320	8531000000-E	462	4" SLOPE PROTECTION	3,369 SY		
0321	8654000000-N	SP	DISC BEARINGS	Lump Sum	L.S.	
0322	8657000000-N	430	ELASTOMERIC BEARINGS	Lump Sum	L.S.	
0323	8692000000-N	SP	FOAM JOINT SEALS	Lump Sum	L.S.	
0324	8867000000-E	SP	GENERIC STRUCTURE ITEM FIBER OPTIC CONDUIT SYSTEM WITH HANGERS	548 LF		

County : Nash

Line #	Item Number	Sec #	Description	Quantity	Unit Cost	Amount
0325	8035000000-N	402	REMOVAL OF EXISTING STRUCTURE AT STATION ***** (17+07.50 -Y2-)	Lump Sum	L.S.	

1348/Apr29/Q2192464.21/D1429107772000/E325

Total Amount Of Bid For Entire Project :

BENCHMARK: BM#1 BENCHTIE NAIL IN 32" PINE, 592.96' LT. OF -Y1- STA. 49+61.76, ELEV. 139.57, COORDINATES: N 844439 E 2348872

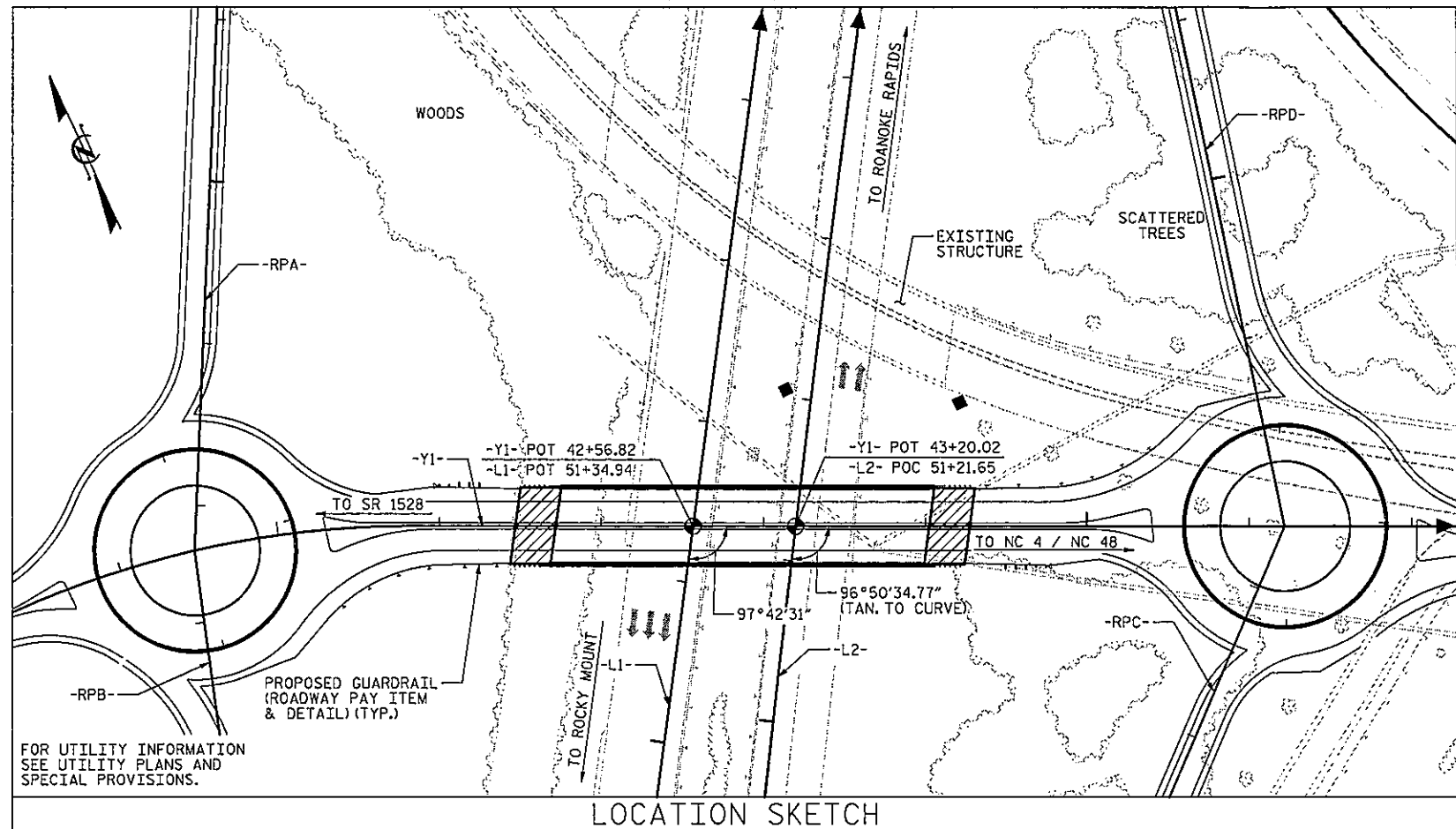

GENERAL NOTES:

ASSUMED LIVE LOAD = HL-93 OR ALTERNATE LOADING.

THIS BRIDGE HAS BEEN DESIGNED IN ACCORDANCE WITH THE AASHTO LRFD BRIDGE DESIGN SPECIFICATIONS.

THIS BRIDGE IS LOCATED IN SEISMIC ZONE 1.

FOR OTHER DESIGN DATA AND GENERAL NOTES, SEE SHEET SN.

FOR FALSEWORK AND FORMWORK, SEE SPECIAL PROVISIONS.

FOR SUBMITTAL OF WORKING DRAWINGS, SEE SPECIAL PROVISIONS.

FOR CRANE SAFETY, SEE SPECIAL PROVISIONS.

FOR GROUT FOR STRUCTURES, SEE SPECIAL PROVISIONS.

THE CONTRACTOR SHALL PROVIDE INDEPENDENT ASSURANCE SAMPLES OF REINFORCING STEEL AS FOLLOWS: FOR PROJECTS REQUIRING UP TO 400 TONS OF REINFORCING STEEL, ONE 30 INCH SAMPLE OF EACH SIZE BAR USED, AND FOR PROJECTS REQUIRING OVER 400 TONS OF REINFORCING STEEL, TWO 30 INCH SAMPLES OF EACH SIZE BAR USED. THE SAMPLE BARS SHOULD COME FROM STEEL ACTUALLY USED IN THE PROJECT AND THE SAMPLE BARS SHOULD BE REPLACED BY SPLICED BARS AS SPECIFIED IN THE SAMPLE BAR REPLACEMENT CHART. PAYMENT FOR THE SAMPLE BARS AND REPLACEMENT REINFORCING STEEL SHALL BE CONSIDERED INCIDENTAL TO VARIOUS PAY ITEMS.

THE ELEVATIONS AND CLEARANCES SHOWN ON THE PLANS AT THE POINTS OF MINIMUM VERTICAL CLEARANCE ARE FROM THE BEST INFORMATION AVAILABLE. PRIOR TO BEGINNING BRIDGE CONSTRUCTION, VERIFY THE ELEVATIONS ON THE EXISTING PAVEMENT AND CHECK THE CLEARANCE. REPORT ANY VARIATIONS TO THE ENGINEER. ANY PLAN REVISIONS NECESSARY TO ACHIEVE THE REQUIRED MINIMUM VERTICAL CLEARANCE WILL BE PROVIDED BY THE DEPARTMENT.

FOR MAINTENANCE AND PROTECTION OF TRAFFIC BENEATH PROPOSED STRUCTURE, SEE SPECIAL PROVISIONS.

PRESTRESSED CONCRETE DECK PANELS MAY BE USED IN LIEU OF METAL STAY-IN-PLACE FORMS IN ACCORDANCE WITH ARTICLE 420-3 OF THE STANDARD SPECIFICATIONS.

REMOVABLE FORMS MAY BE USED IN LIEU OF METAL STAY-IN-PLACE FORMS IN ACCORDANCE WITH ARTICLE 420-3 OF THE STANDARD SPECIFICATIONS.

NEEDLE BEAMS WILL NOT BE ALLOWED UNLESS OTHERWISE CALLED FOR ON THE PLANS OR APPROVED BY THE ENGINEER.

INASMUCH THE PAINT SYSTEM ON THE EXISTING STRUCTURAL STEEL CONTAINS LEAD, THE CONTRACTOR'S ATTENTION IS DIRECTED TO ARTICLE 107-1 OF THE STANDARD SPECIFICATIONS. ANY COSTS RESULTING FROM COMPLIANCE WITH APPLICABLE STATE OR FEDERAL REGULATIONS PERTAINING TO HANDLING OF MATERIALS CONTAINING LEAD BASED PAINT SHALL BE INCLUDED IN THE BID PRICE FOR REMOVAL OF EXISTING STRUCTURE AT STATION 42+56.82 -Y1- AND STATION 17+07.50 -Y2-.

FOR LIMITS OF TEMPORARY SHORING FOR MAINTENANCE OF TRAFFIC, SEE TRAFFIC CONTROL PLANS. FOR PAY ITEM FOR TEMPORARY SHORING FOR MAINTENANCE OF TRAFFIC, SEE ROADWAY PLANS.

THE EXISTING STRUCTURE, CONSISTING OF 4 SPANS: 1 @ 42.5', 1 @ 66', 1 @ 60.5' & 1 @ 42.5'; 41.08' CLEAR ROADWAY WIDTH AND A 7/4" REINFORCED CONCRETE DECK WITH A 4" ASPHALT WEARING SURFACE ON I-BEAMS; AND END BENTS CONSISTING OF REINFORCED CONCRETE CAP WITH STEEL PILES AT END BENT 1, SPREAD FOOTINGS AT END BENT 2, AND INTERIOR BENTS CONSISTING OF REINFORCED CONCRETE POST AND BEAM COLUMNS ON PILE FOOTINGS AND LOCATED AT AND EAST OF THE PROPOSED BRIDGE SHALL BE REMOVED. THE EXISTING BRIDGE IS PRESENTLY NOT POSTED FOR LOAD LIMIT. SHOULD THE STRUCTURAL INTEGRITY OF THE BRIDGE DETERIORATE DURING CONSTRUCTION OF THE PROPOSED BRIDGE, A LOAD LIMIT MAY BE POSTED AND MAY BE REDUCED AS FOUND NECESSARY DURING THE LIFE OF THE PROJECT.

THE SUBSTRUCTURE OF THE EXISTING BRIDGE INDICATED ON THE PLANS IS FROM THE BEST INFORMATION AVAILABLE. THIS INFORMATION IS SHOWN FOR THE CONVENIENCE OF THE CONTRACTOR. THE CONTRACTOR SHALL HAVE NO CLAIM WHATSOEVER AGAINST THE DEPARTMENT OF TRANSPORTATION FOR ANY DELAYS OR ADDITIONAL COST INCURRED BASED ON DIFFERENCES BETWEEN THE EXISTING BRIDGE SUBSTRUCTURE SHOWN ON THE PLANS AND THE ACTUAL CONDITIONS AT THE PROJECT SITE.

FOR EROSION CONTROL MEASURES, SEE EROSION CONTROL PLANS.

FOR ASBESTOS ASSESSMENT FOR BRIDGE DEMOLITION AND RENOVATION ACTIVITIES, SEE SPECIAL PROVISIONS.

TOTAL BILL OF MATERIAL

	REMOVAL OF EXISTING STRUCTURE AT STA. 42+56.82 -Y1-	REMOVAL OF EXISTING STRUCTURE AT STA. 17+07.50 -Y2-	ASBESTOS ASSESSMENT	FOUNDATION EXCAVATION FOR BENT 1	PDA TESTING	REINFORCED CONCRETE DECK SLAB	GROOVING BRIDGE FLOORS	CLASS A CONCRETE	BRIDGE APPROACH SLABS	REINFORCING STEEL	SPIRAL COLUMN REINFORCING STEEL	MODIFIED 63" PRESTRESSED CONCRETE GIRDER	PILE DRIVING EQUIPMENT SETUP FOR HPI2x53 STEEL PILES	HP12X53 STEEL PILES	STEEL PILE POINTS	CONCRETE BARRIER RAIL	4" SLOPE PROTECTION	ELASTOMERIC BEARINGS	FIBER OPTIC CONDUIT SYSTEM WITH HANGERS	JUNCTION BOX (OVER-SIZED, HEAVY DUTY)		
	LUMP SUM	LUMP SUM	LUMP SUM	LUMP SUM	EACH	SO. FT.	SO. FT.	CU. YDS.	LUMP SUM	LBS.	LBS.	NO.	LIN. FT.	EA.	NO.	LIN. FT.	EACH	LIN. FT.	SO. YDS.	LUMP SUM	LIN. FT.	EA.
SUPERSTRUCTURE						11,343	12,011					10	1143.33			461				284		
END BENT 1								47.2		7,418			9	9	495		206					
BENT 1								91.5		17,063	1,679		24	24	720	24						
END BENT 2								47.0		7,441			9	9	585		191					
TOTAL	LUMP SUM	LUMP SUM	LUMP SUM	LUMP SUM	2	11,343	12,011	185.7	LUMP SUM	31,922	1,679	10	1143.33	42	42	1800	24		397	LUMP SUM	284	2

PROJECT NO. B-5980

NASH COUNTY

STATION: 42+56.82 -Y1-

SHEET 3 OF 3

SAMPLE BAR REPLACEMENT			
SIZE	LENGTH	SIZE	LENGTH
#3	6'-2"	#8	12'-0"
#4	7'-4"	#9	13'-2"
#5	8'-6"	#10	14'-6"
#6	9'-8"	#11	15'-10"
#7	10'-10"		

NOTE: SAMPLE BAR REPLACEMENT LENGTHS BASED ON 30" (SAMPLE LENGTH) PLUS TWO SPLICE LENGTHS AND $f_s = 60$ ksi.

SAMPLE BAR REPLACEMENT FOR FEDERAL AID PROJECTS

DOCUMENT NOT CONSIDERED FINAL UNLESS ALL SIGNATURES COMPLETED

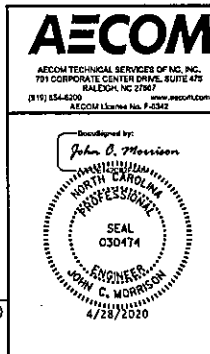

STATE OF NORTH CAROLINA
DEPARTMENT OF TRANSPORTATION
RALEIGH

GENERAL DRAWING
BRIDGE ON SR 1544
(HALIFAX RD.) OVER I-95
BETWEEN SR 1528
& NC 4 / NC 48

REVISIONS						SHEET NO.
NO.	BY	DATE	NO.	BY	DATE	S-03
1			3			TOTAL SHEETS
2			4			34

DRAWN BY: T.B. STUMP DATE: 1/20/19
 CHECKED BY: J.C. MORRISON DATE: 1/20/19
 DESIGNED BY: T.B. STUMP DATE: 1/20/19
 DESIGN CHECKED BY: J.C. MORRISON DATE: 1/20/19

USER: c:\user\stump\dwg\400_05_01_195980_340_1.dwg