

NOTES
 GENERAL DRAWING INFORMATION IS TAKEN FROM THE ORIGINAL PLANS AND THE ROUTINE INSPECTION REPORT DATED 9/6/2018.
 BRIDGE ORIENTATION CONFORMS TO EXISTING BRIDGE PLANS.

- SCOPE OF WORK**
- PARTIALLY REMOVE TOP OF BRIDGE DECK CONCRETE BY SCARIFICATION AND SHOTBLASTING METHODS.
 - OVERLAY PREPARED TOP OF BRIDGE DECK WITH POLYESTER POLYMER CONCRETE (PPC).
 - REMOVE EXISTING JOINT MATERIAL AND INSTALL FOAM JOINTS.
 - GROOVE PPC BRIDGE DECK.
 - CLEAN AND REPAINT EXISTING STRUCTURAL STEEL.
 - REMOVE DEBRIS FROM TOP OF EXISTING END BENT AND BENT CAPS, AND APPLY EPOXY COATING.
 - REMOVE UNSOUND CONCRETE AND PROPERLY PREPARE EXISTING END BENT AND BENT AREAS FOR SHOTCRETE AND CONCRETE REPAIR.

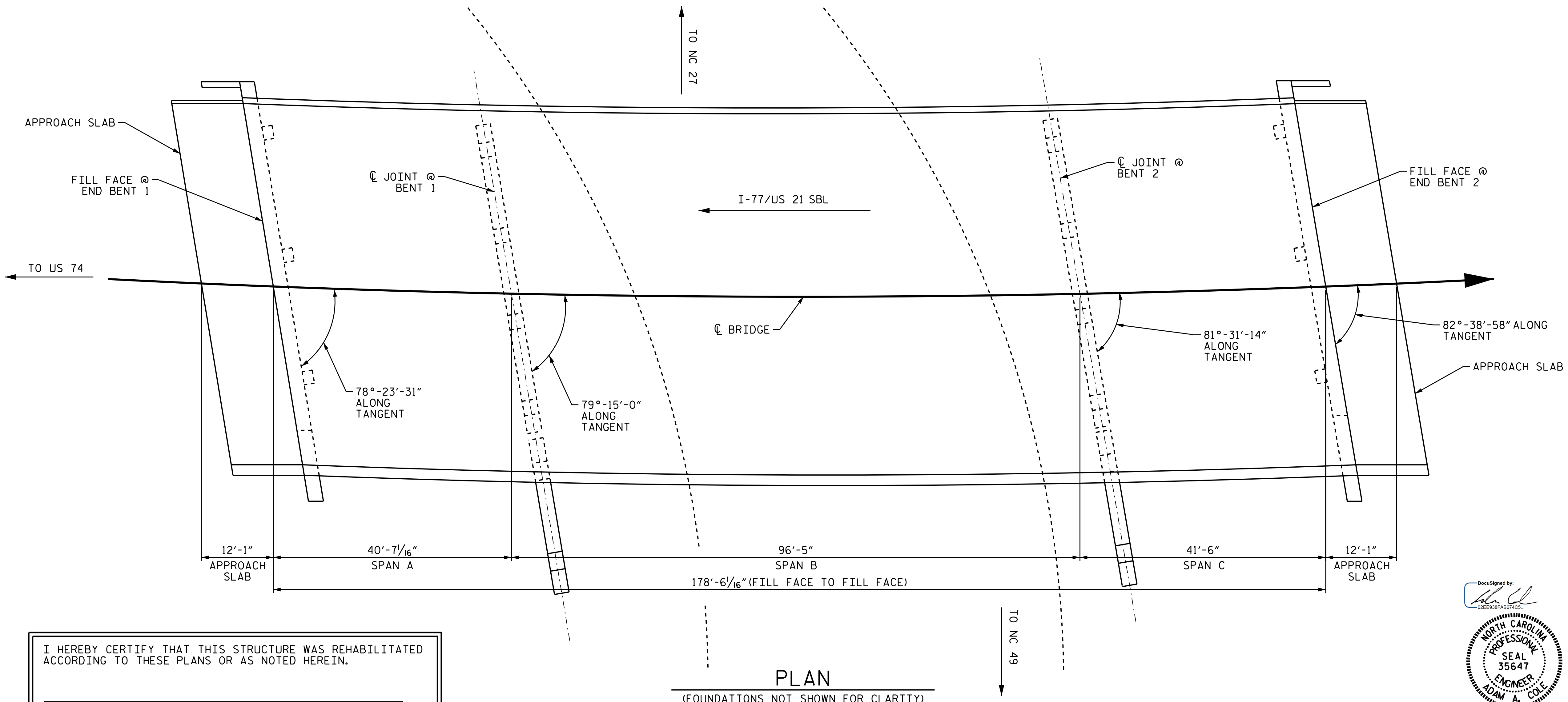

I HEREBY CERTIFY THAT THIS STRUCTURE WAS REHABILITATED ACCORDING TO THESE PLANS OR AS NOTED HEREIN.
 RESIDENT ENGINEER _____ DATE _____

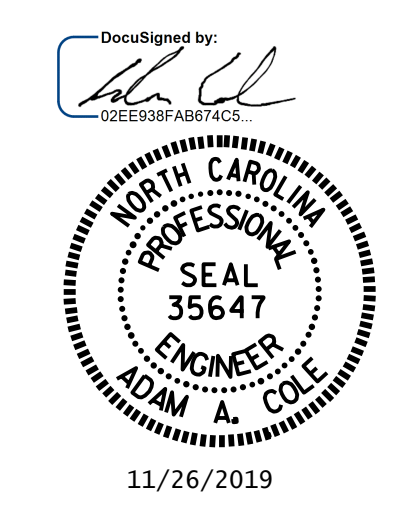

PROJECT NO. I-5769
MECKLENBURG COUNTY
 BRIDGE NO. 590222

STATE OF NORTH CAROLINA
 DEPARTMENT OF TRANSPORTATION
 RALEIGH
GENERAL DRAWING
 FOR BRIDGE ON I-77 SBL
 OVER US 29/NC 27
 (W. MOREHEAD ST.)

DRAWN BY : D.A. CANTRELL DATE : 08/2018
 CHECKED BY : A. SORENGINH DATE : 02/2019

REVISIONS						SHEET NO.
NO.	BY:	DATE:	NO.	BY:	DATE:	S2-01
1			3			TOTAL SHEETS
2			4			8