

**This electronic collection of documents is provided
for the convenience of the user
and is Not a Certified Document –**

**The documents contained herein were originally issued
and sealed by the individuals whose names and license
numbers appear on each page, on the dates appearing
with their signature on that page.**

**This file or an individual page
shall not be considered a certified document.**

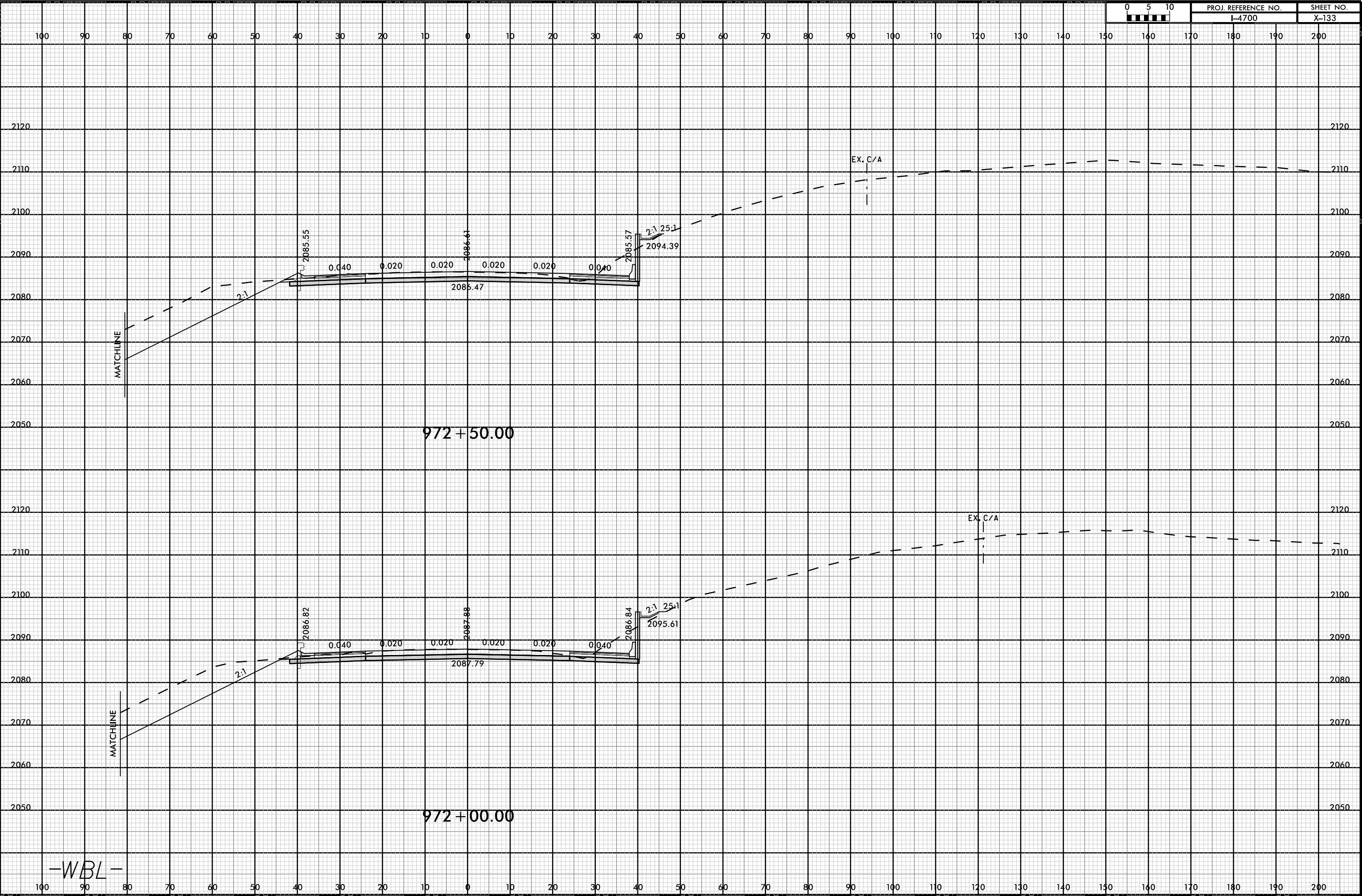

-WBL-

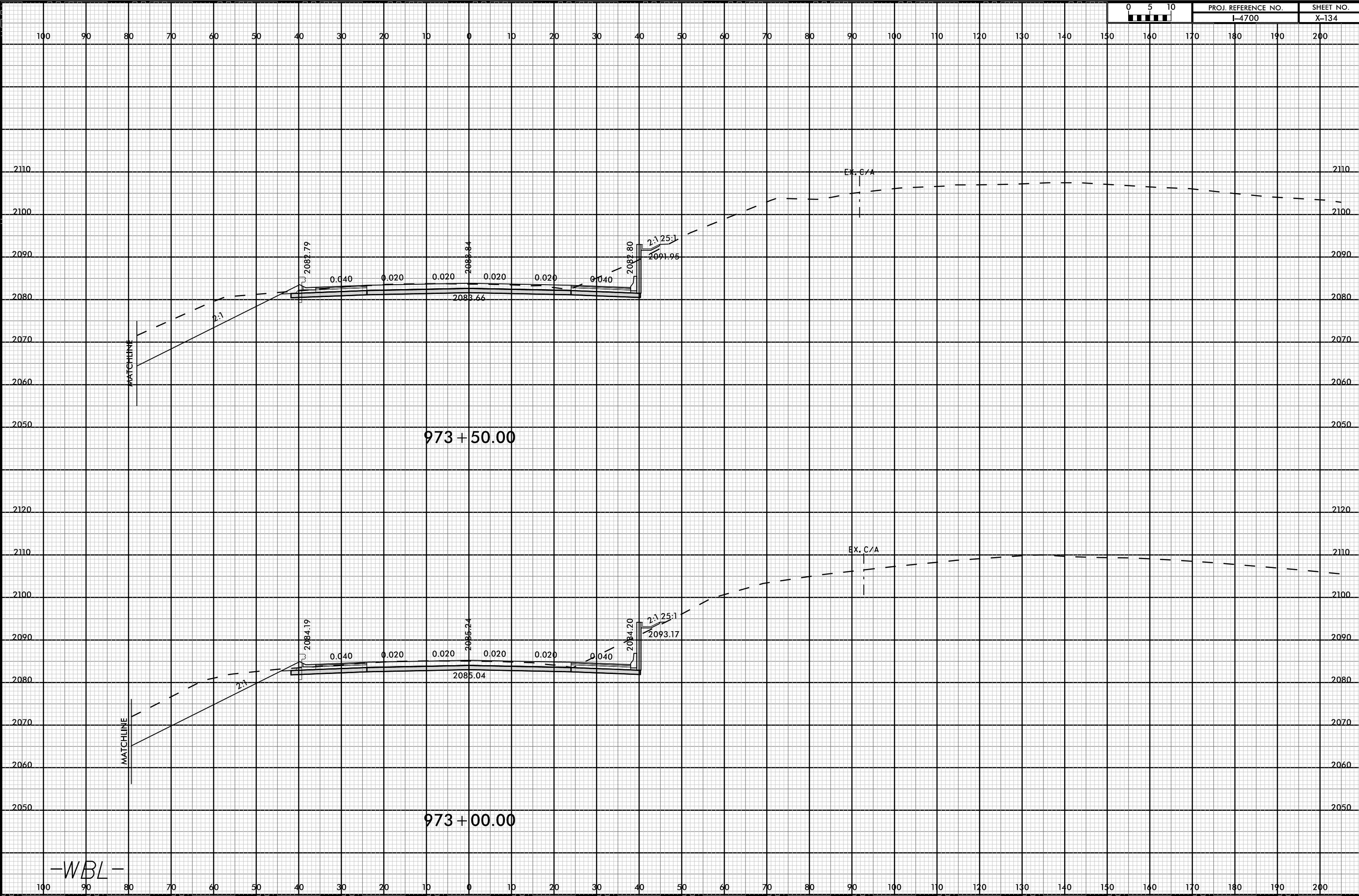

-WBL-



100 90 80 70 60 50 40 30 20 10 0 10 20 30 40 50 60 70 80 90 100 110 120 130 140 150 160 170 180 190 200

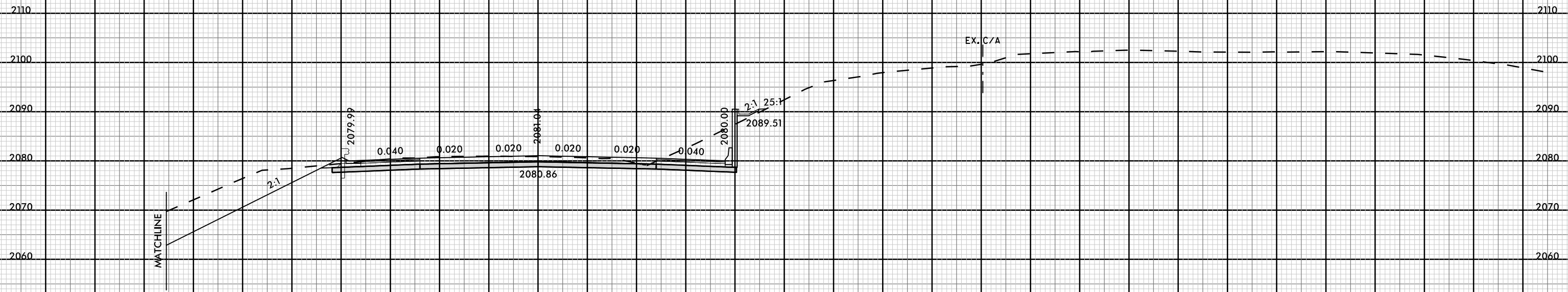

974 + 50.00

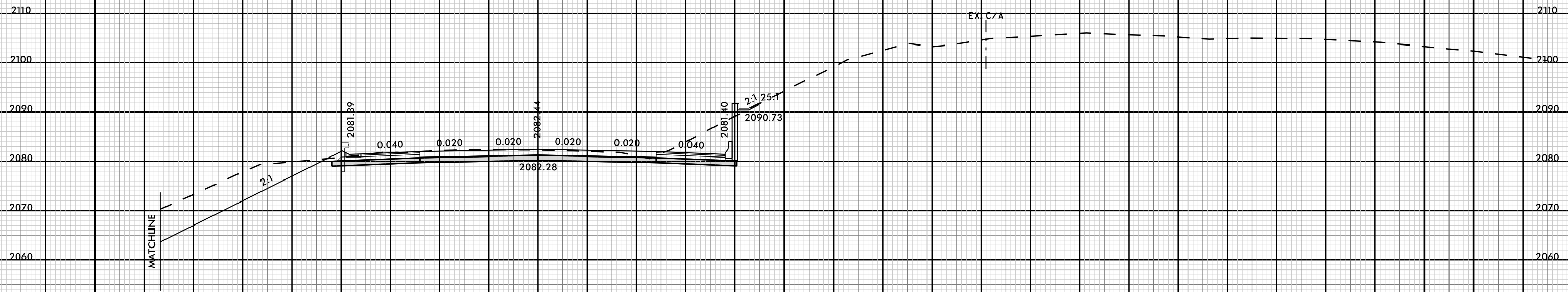

974 + 00.00

-WBL-

100 90 80 70 60 50 40 30 20 10 0 10 20 30 40 50 60 70 80 90 100 110 120 130 140 150 160 170 180 190 200

100 90 80 70 60 50 40 30 20 10 0 10 20 30 40 50 60 70 80 90 100 110 120 130 140 150 160 170 180 190 200

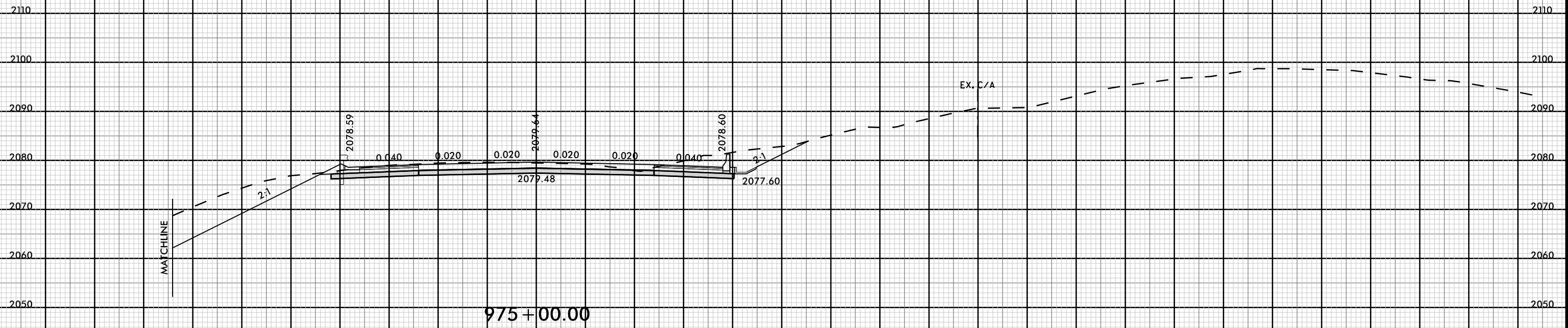
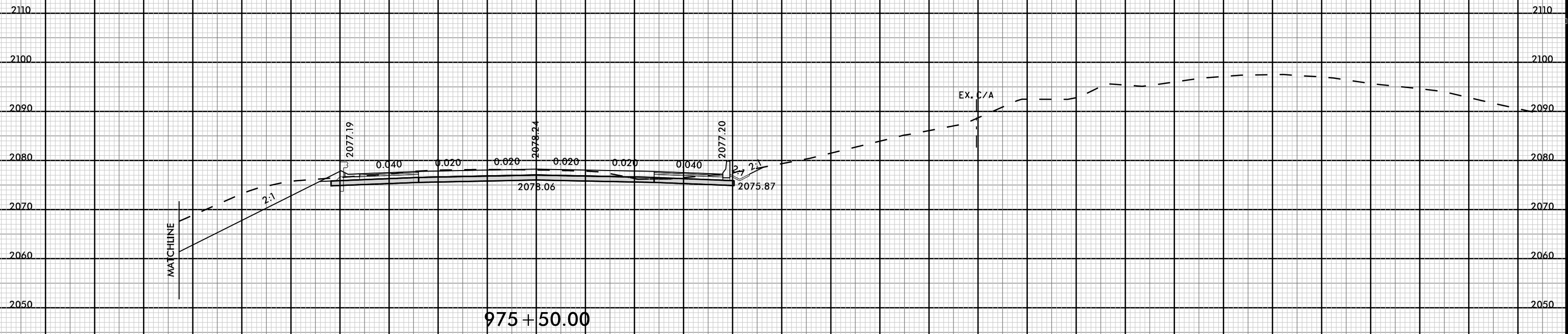

-WBL-

100 90 80 70 60 50 40 30 20 10 0 10 20 30 40 50 60 70 80 90 100 110 120 130 140 150 160 170 180 190 200

8/23/99

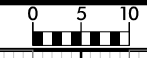

PROJ. REFERENCE NO.	SHEET NO.
I-4700	X-137

100 90 80 70 60 50 40 30 20 10 0 10 20 30 40 50 60 70 80 90 100 110 120 130 140 150 160 170 180 190 200

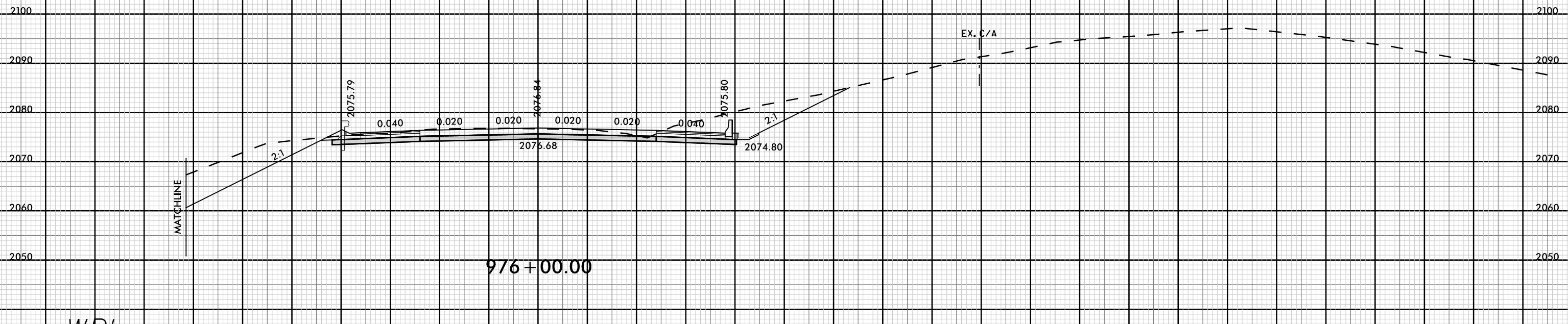
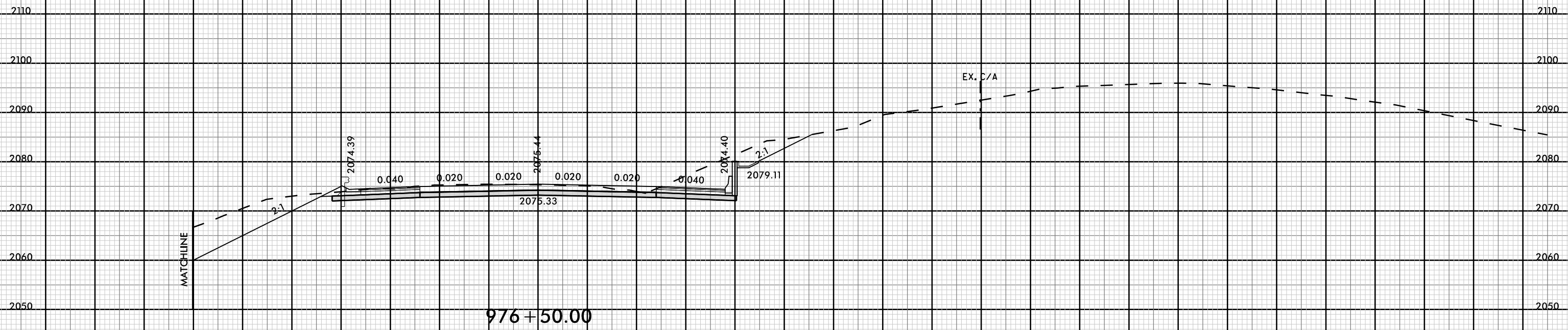

-WBL-

100 90 80 70 60 50 40 30 20 10 0 10 20 30 40 50 60 70 80 90 100 110 120 130 140 150 160 170 180 190 200

08-MAR-2019 12:55
I4700A-ROD-XFL.MXD
FNITB

100 90 80 70 60 50 40 30 20 10 0 10 20 30 40 50 60 70 80 90 100 110 120 130 140 150 160 170 180 190 200

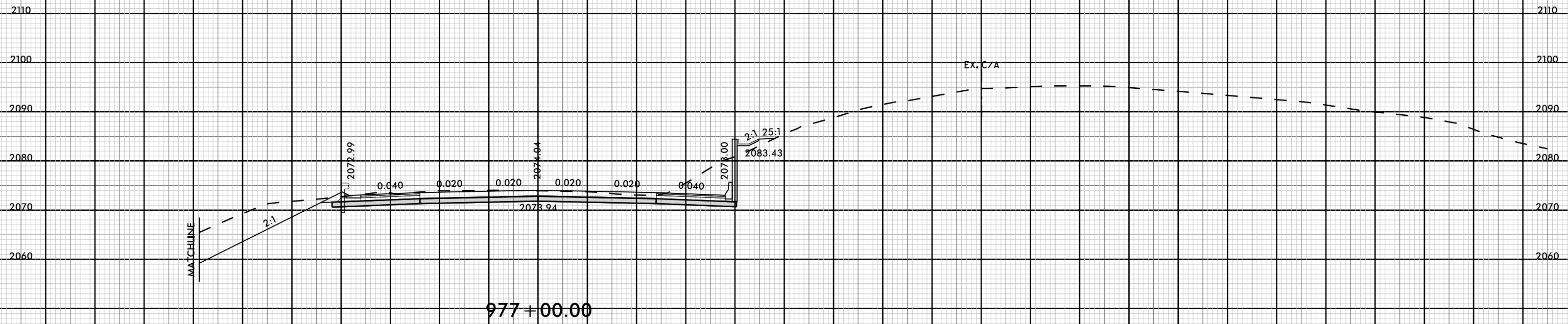
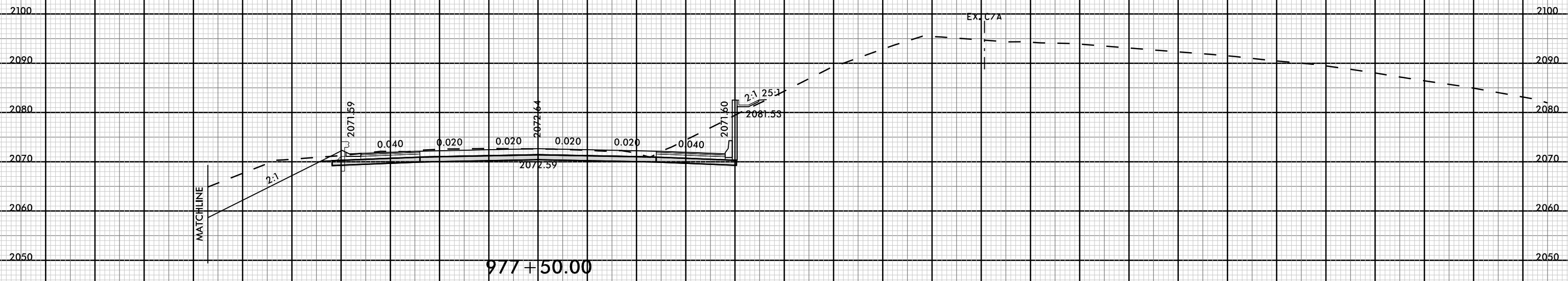

-WBL-

100 90 80 70 60 50 40 30 20 10 0 10 20 30 40 50 60 70 80 90 100 110 120 130 140 150 160 170 180 190 200

8/23/99



PROJ. REFERENCE NO.
I-4700

SHEET NO.
X-139

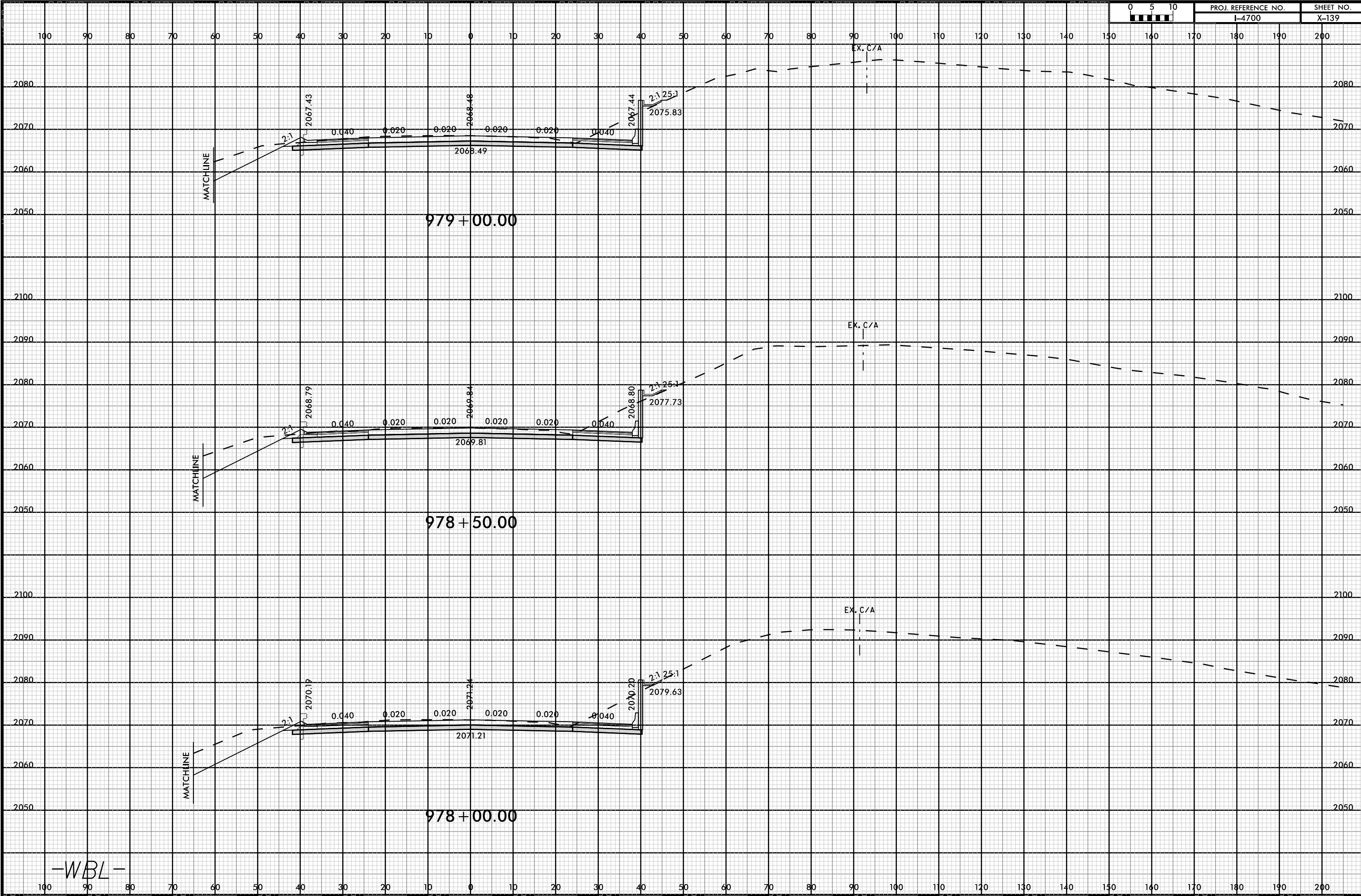

-WBL-

08-MAR-2019 12:55
I-4700A-FOY-XFL-M.dgn
FNITB

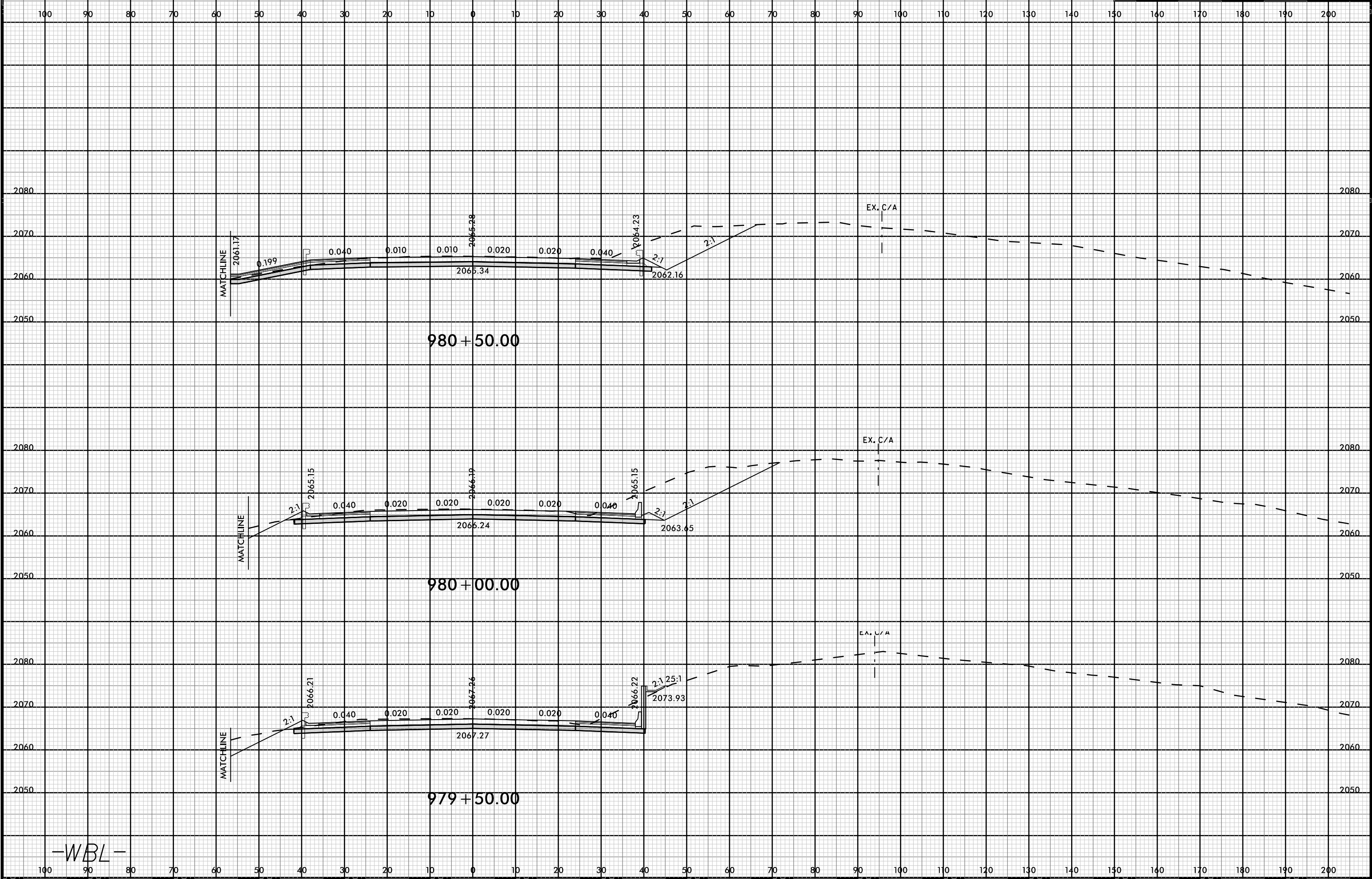

-WBL-



100 90 80 70 60 50 40 30 20 10 0 10 20 30 40 50 60 70 80 90 100 110 120 130 140 150 160 170 180 190 200

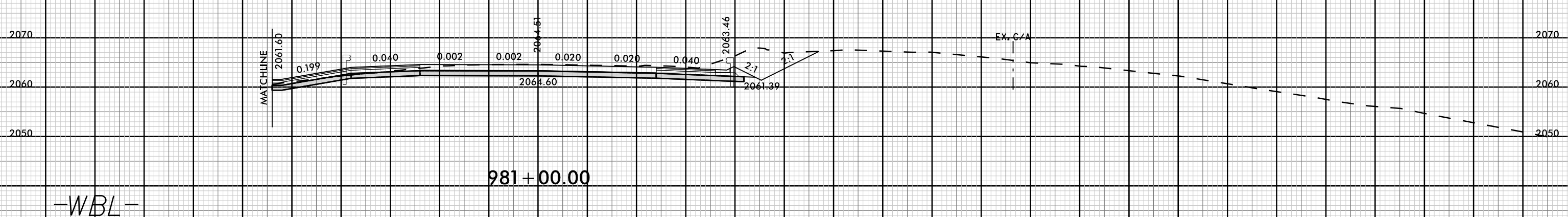
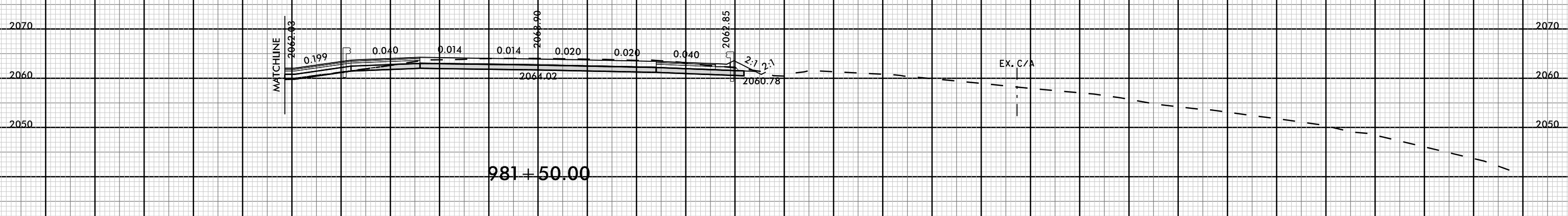
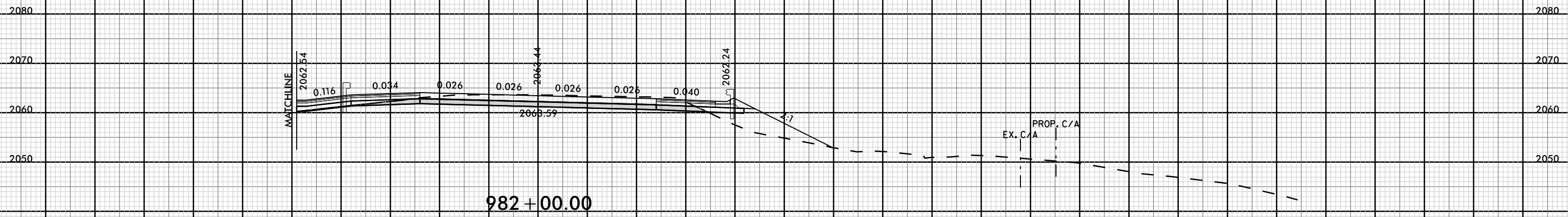

-WBL-

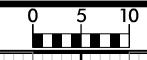

100 90 80 70 60 50 40 30 20 10 0 10 20 30 40 50 60 70 80 90 100 110 120 130 140 150 160 170 180 190 200

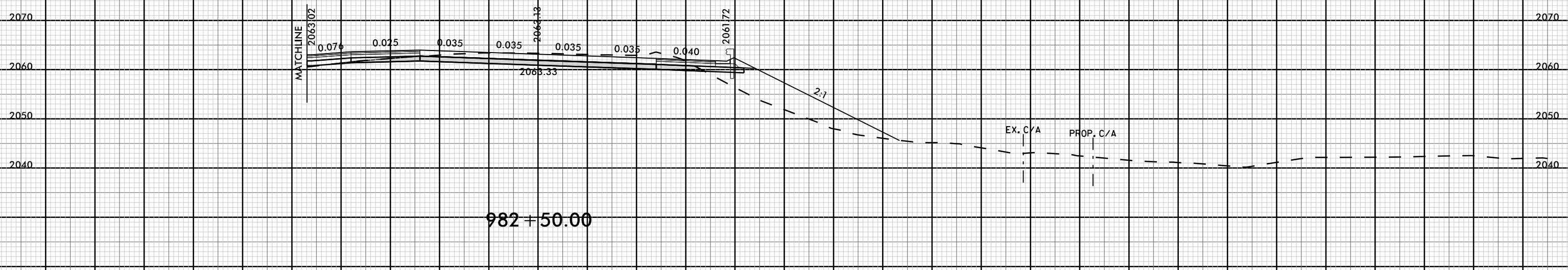
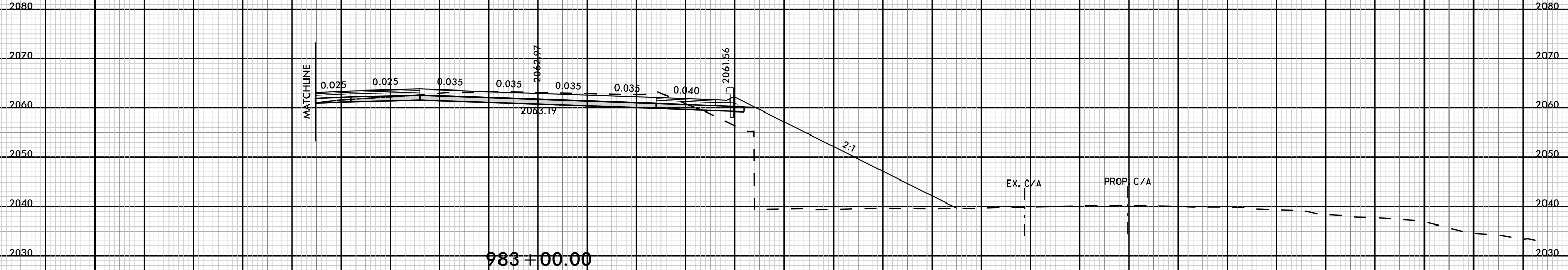

100 90 80 70 60 50 40 30 20 10 0 10 20 30 40 50 60 70 80 90 100 110 120 130 140 150 160 170 180 190 200

-WBL-

100 90 80 70 60 50 40 30 20 10 0 10 20 30 40 50 60 70 80 90 100 110 120 130 140 150 160 170 180 190 200

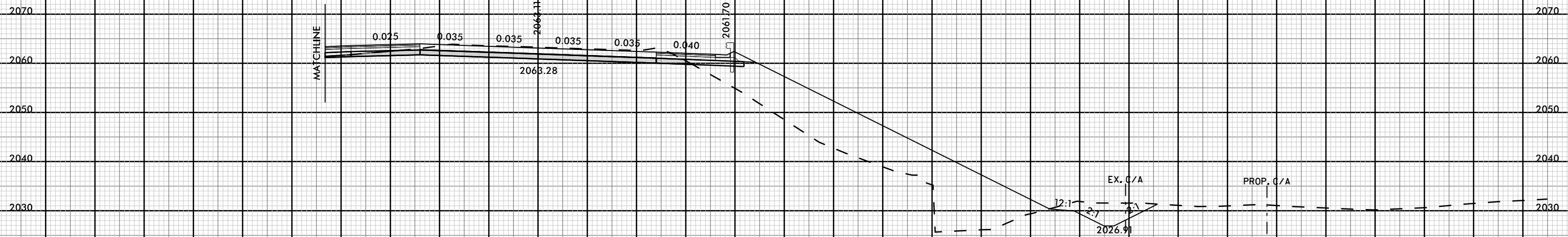

984+00.00

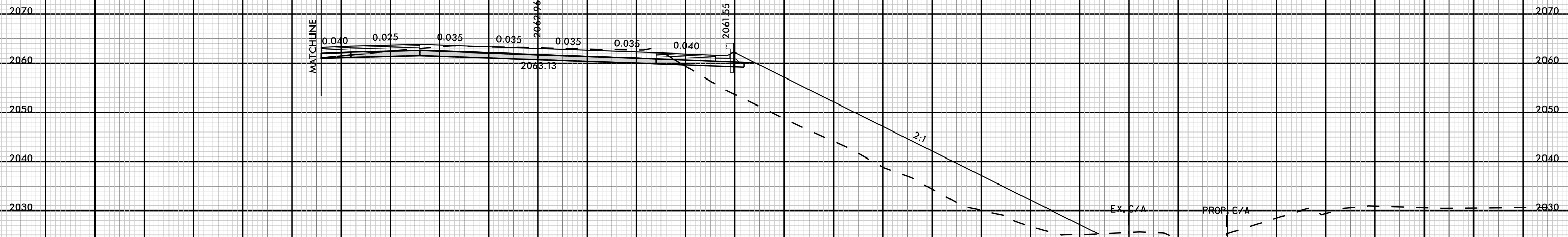

983+50.00

-WBL-

100 90 80 70 60 50 40 30 20 10 0 10 20 30 40 50 60 70 80 90 100 110 120 130 140 150 160 170 180 190 200

8/23/99



PROJ. REFERENCE NO.
I-4700

SHEET NO.
X-144

100 90 80 70 60 50 40 30 20 10 0 10 20 30 40 50 60 70 80 90 100 110 120 130 140 150 160 170 180 190 200

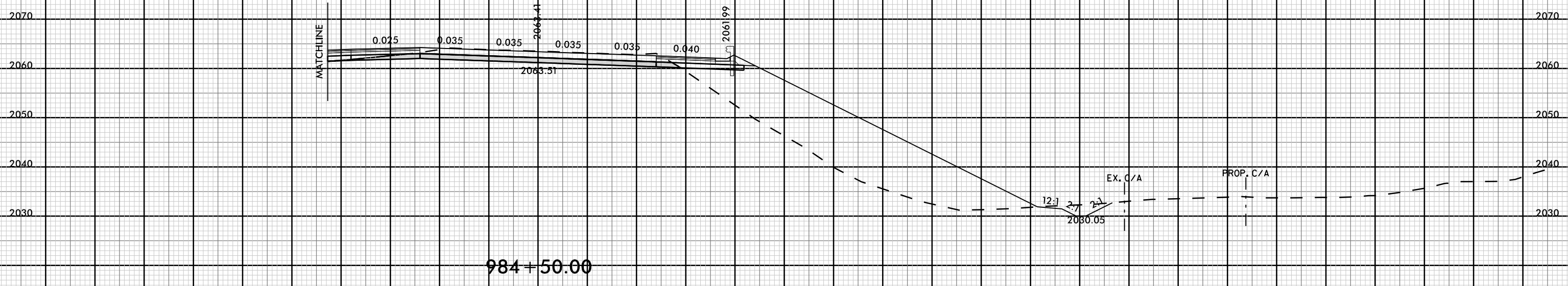
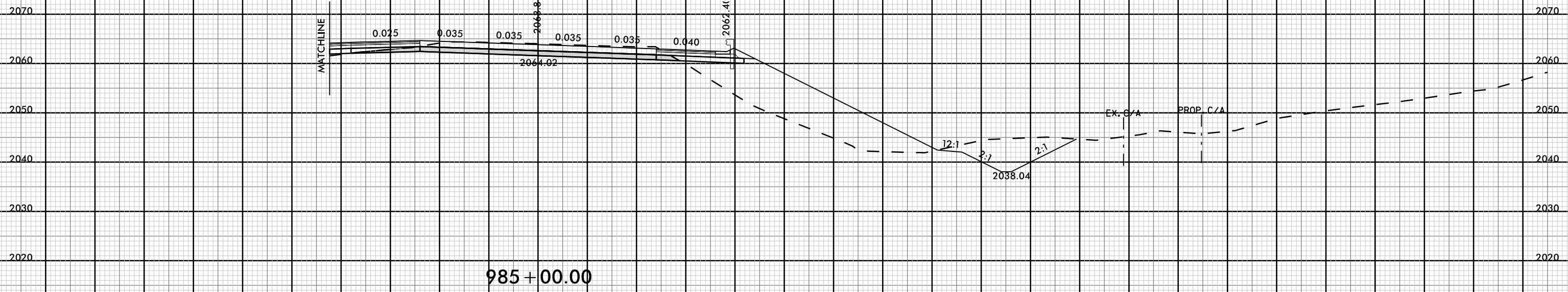

-WBL-

08-MAR-2019 12:57
I-4700A-ROD-XFL-ML.dgn
FNITB

100 90 80 70 60 50 40 30 20 10 0 10 20 30 40 50 60 70 80 90 100 110 120 130 140 150 160 170 180 190 200



100 90 80 70 60 50 40 30 20 10 0 10 20 30 40 50 60 70 80 90 100 110 120 130 140 150 160 170 180 190 200

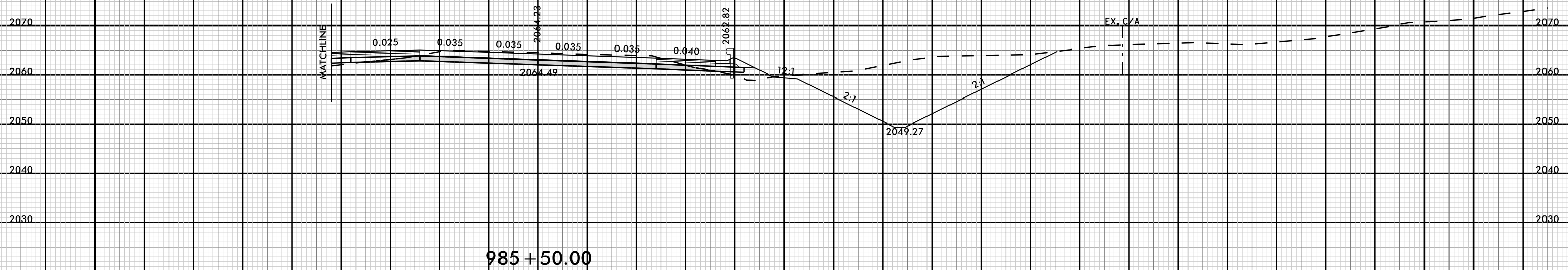
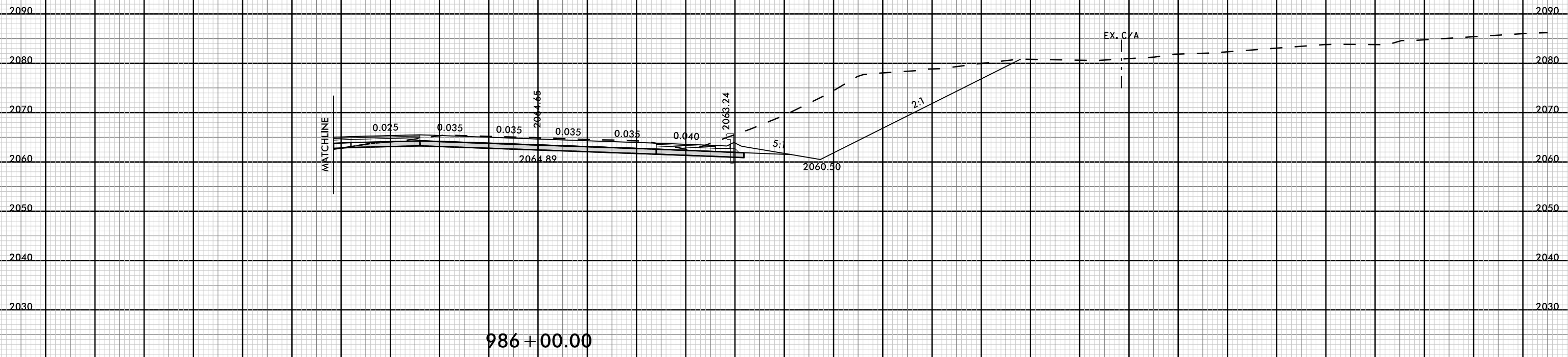

-WBL-

100 90 80 70 60 50 40 30 20 10 0 10 20 30 40 50 60 70 80 90 100 110 120 130 140 150 160 170 180 190 200

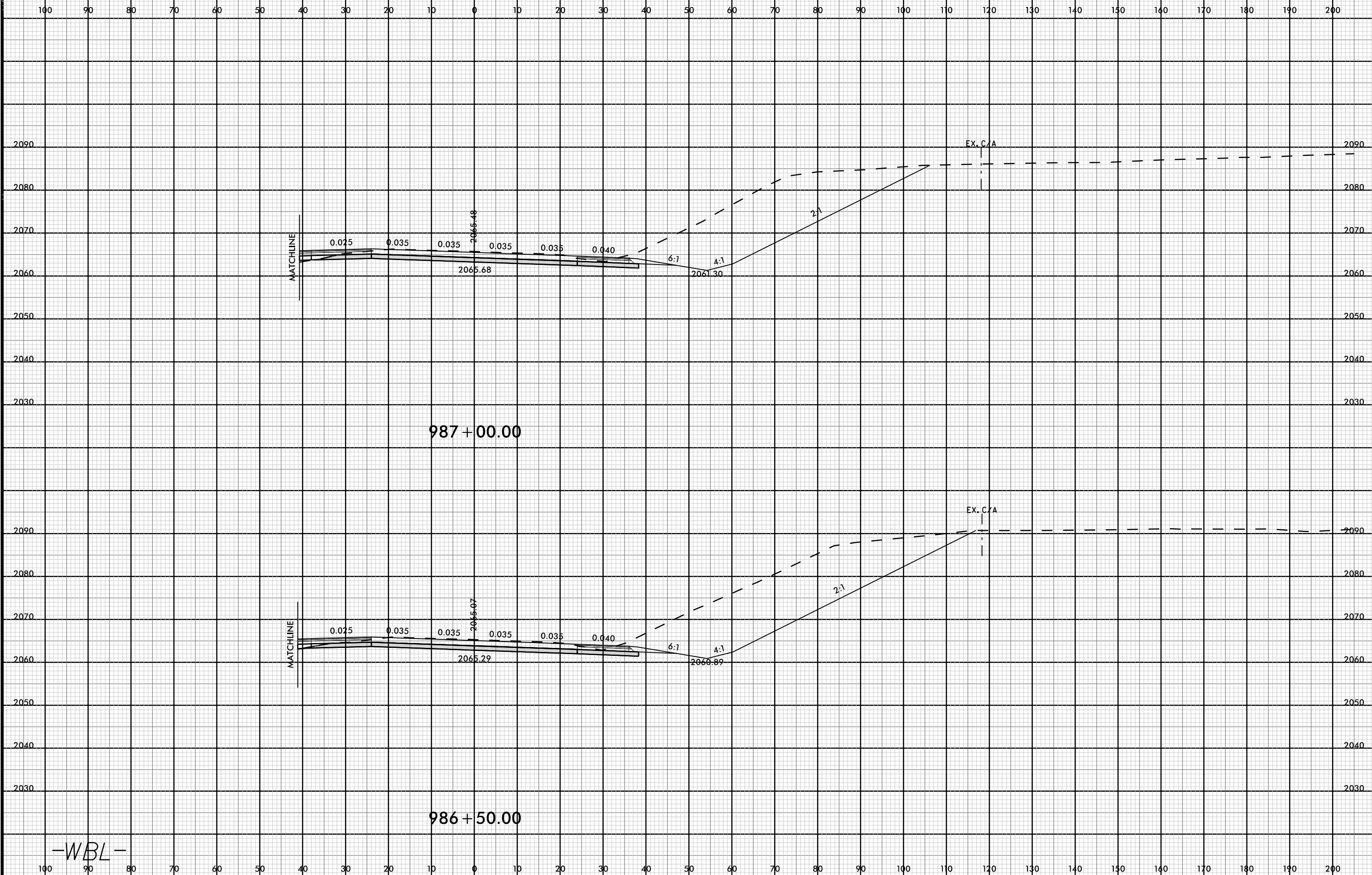

-WBL-

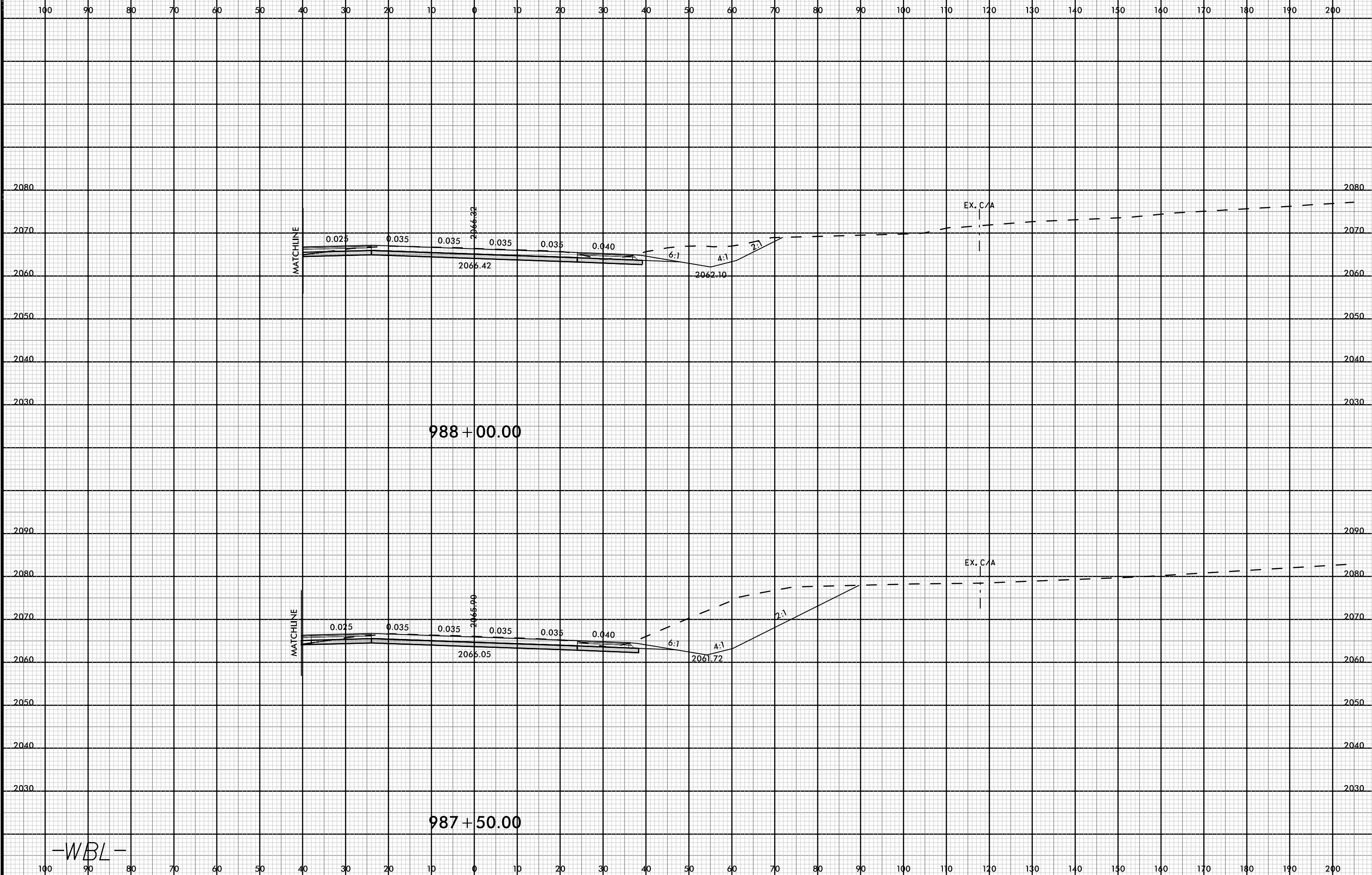

988 + 00.00

987 + 50.00

-WBL-

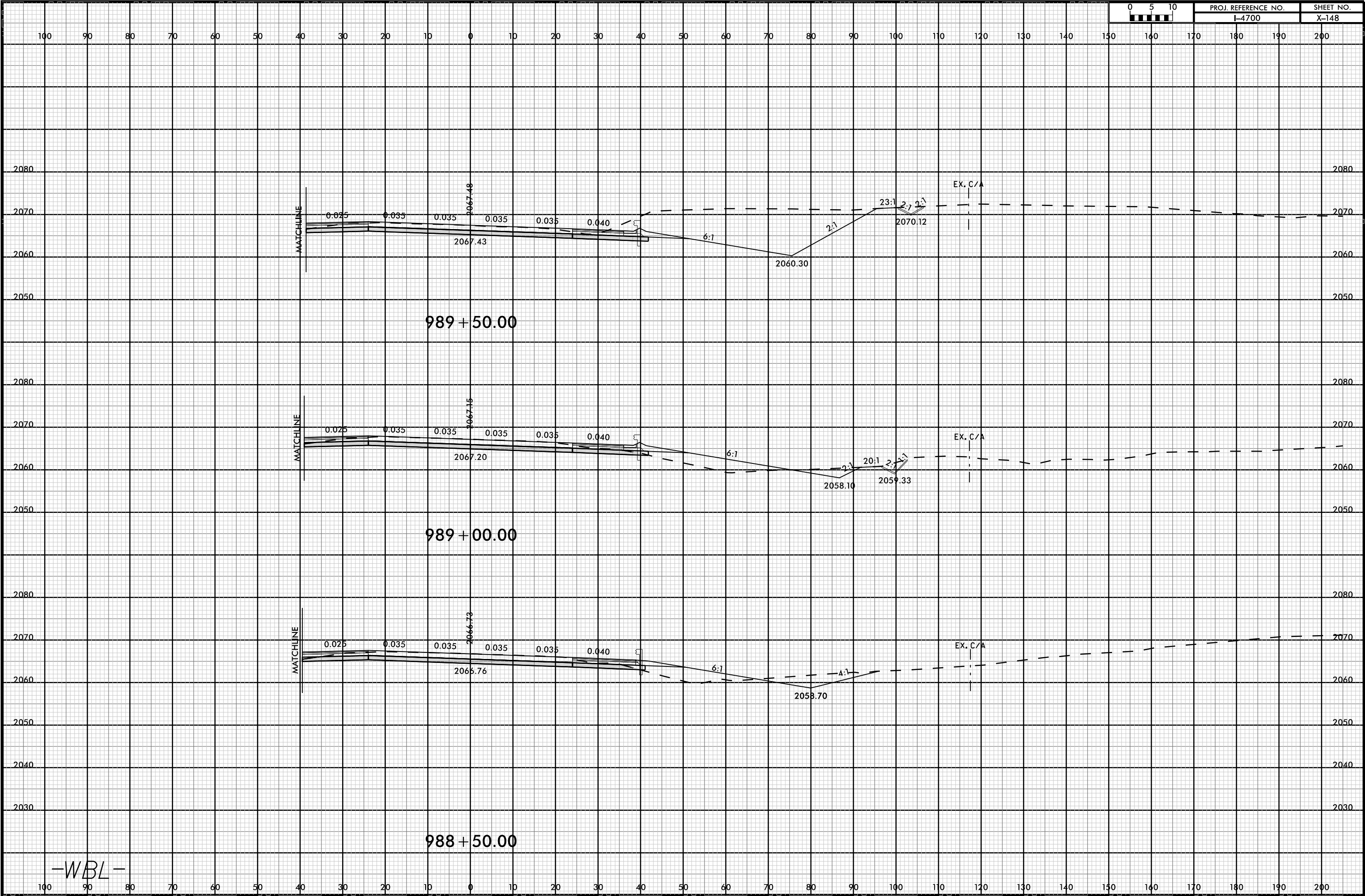

-WBL-



100 90 80 70 60 50 40 30 20 10 0 10 20 30 40 50 60 70 80 90 100 110 120 130 140 150 160 170 180 190 200

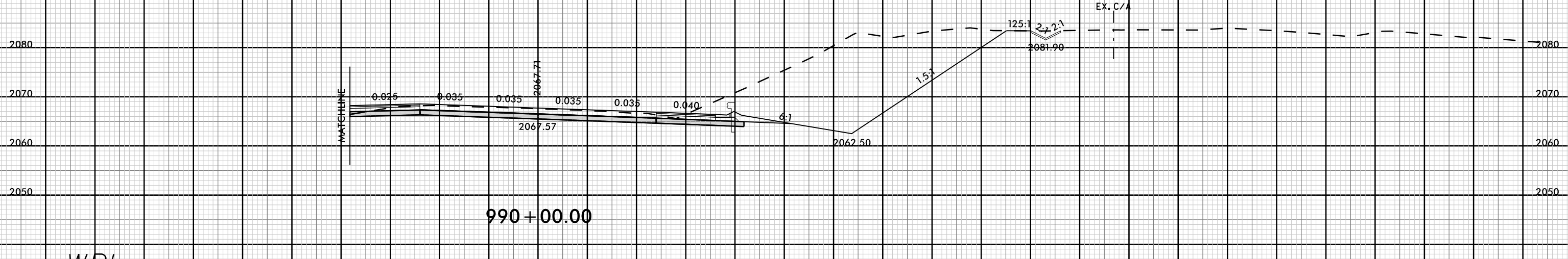
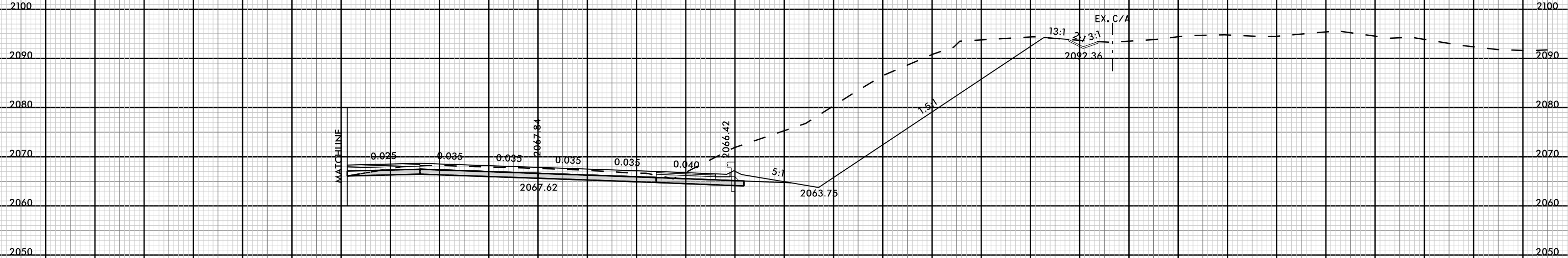

-WBL-

100 90 80 70 60 50 40 30 20 10 0 10 20 30 40 50 60 70 80 90 100 110 120 130 140 150 160 170 180 190 200

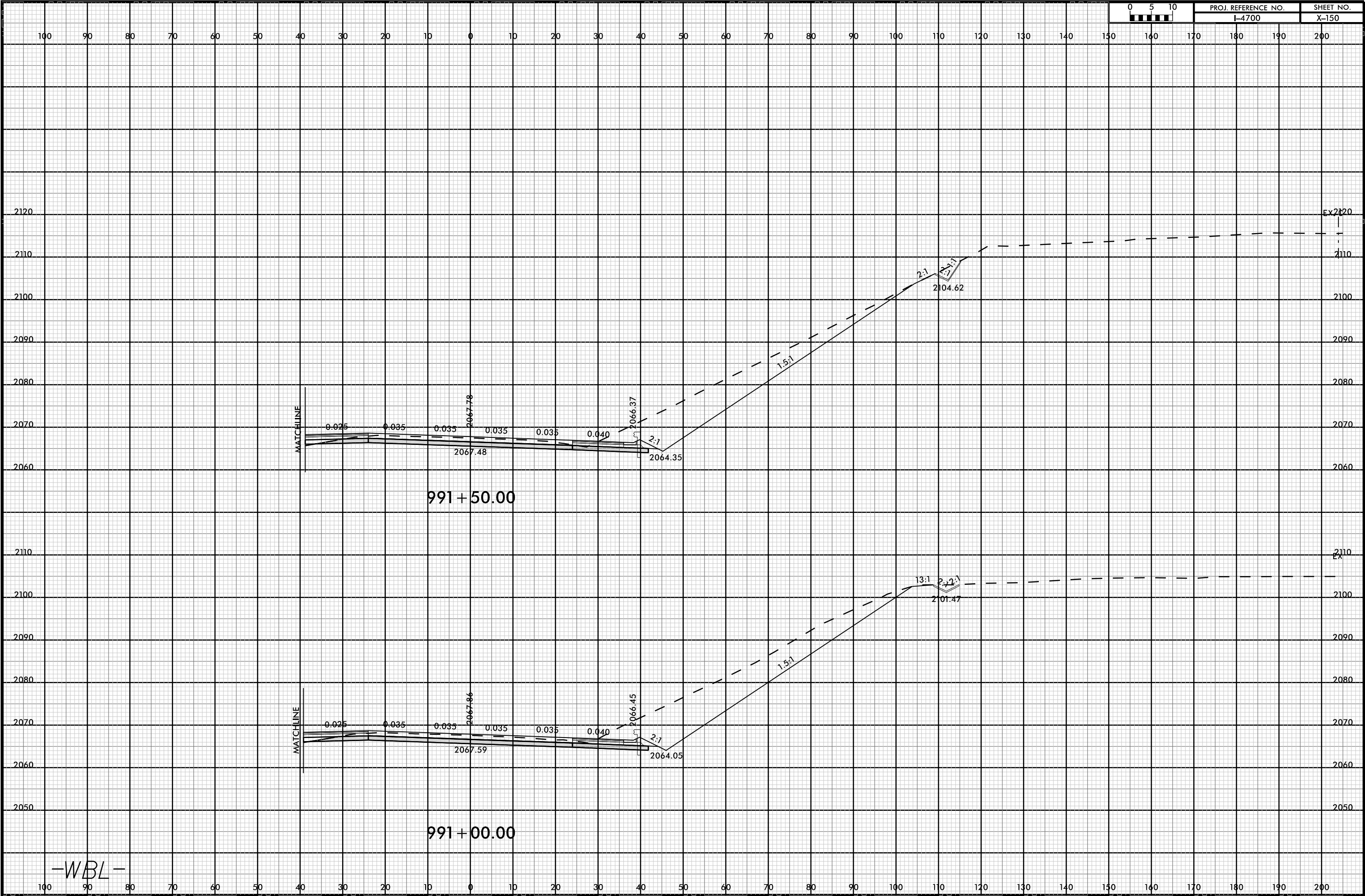

-WBL-

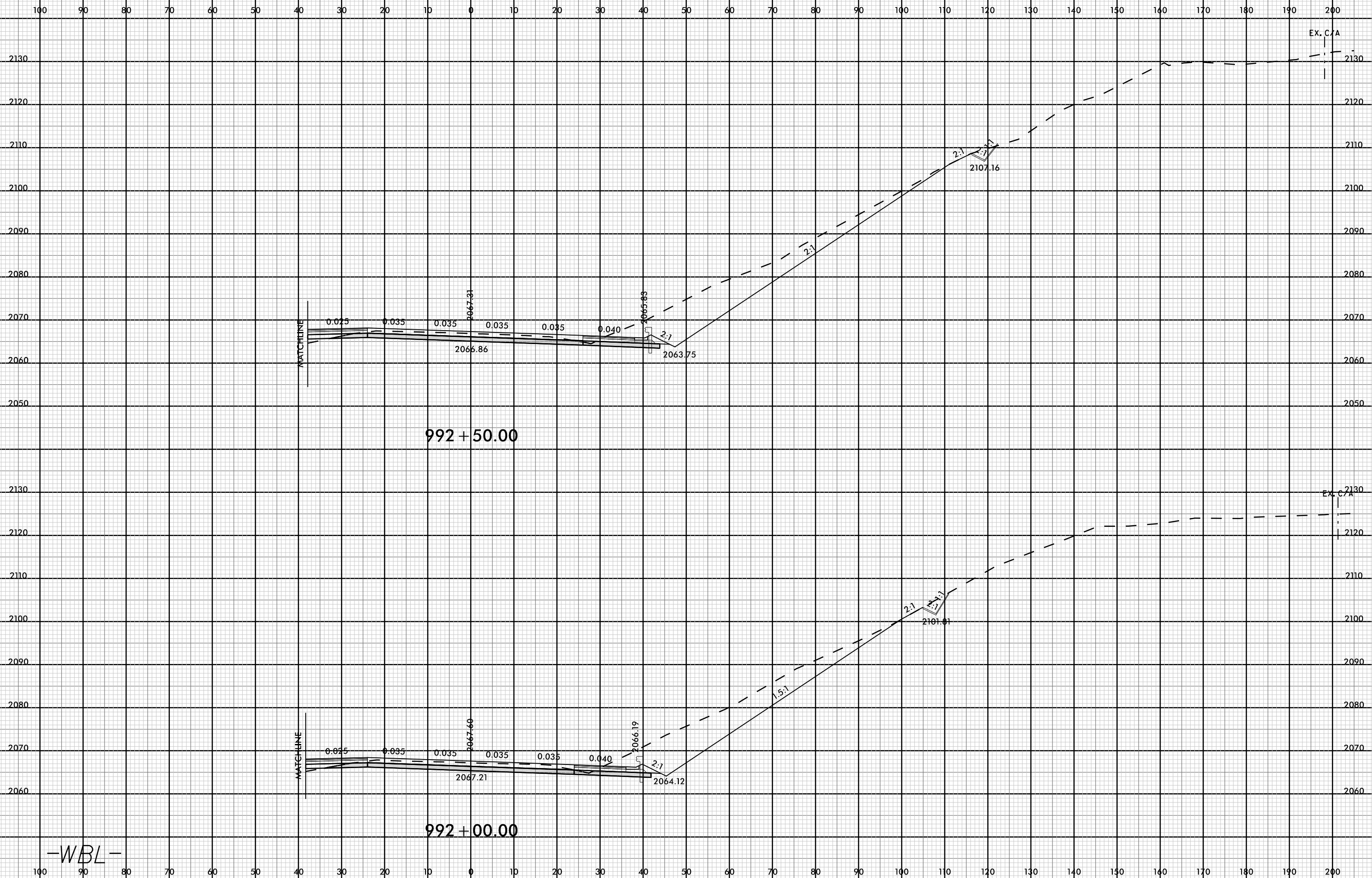

-WBL-

8/23/99



PROJ. REFERENCE NO.
I-4700

SHEET NO.
X-152

100 90 80 70 60 50 40 30 20 10 0 10 20 30 40 50 60 70 80 90 100 110 120 130 140 150 160 170 180 190 200

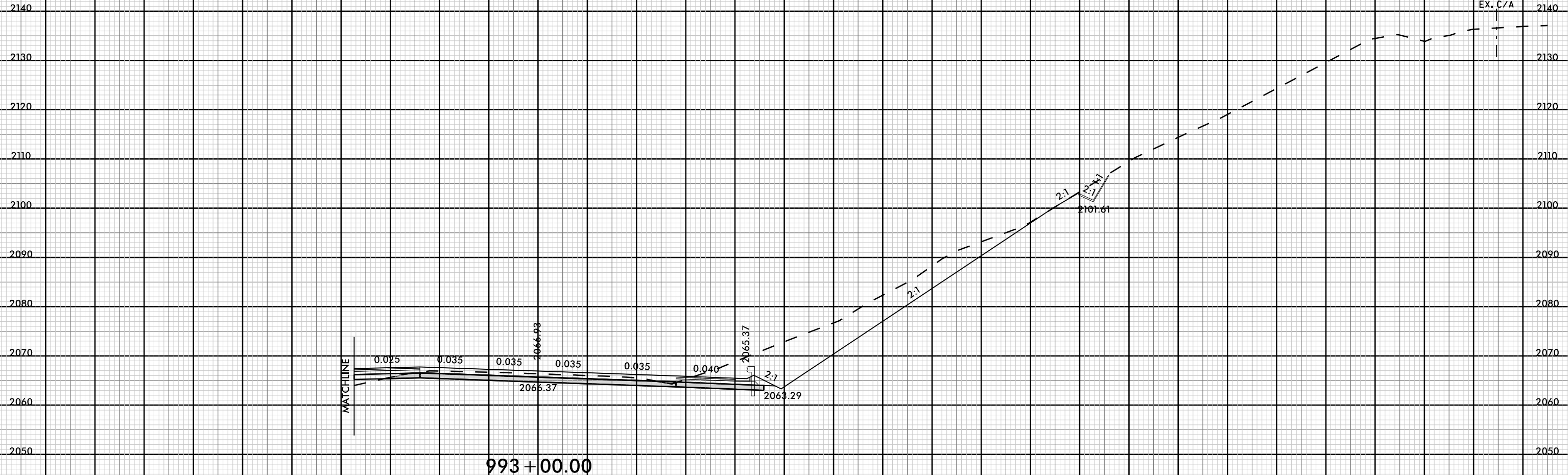

993 + 00.00

MATCHLINE

EX. C/A

-WBL-

08-MAR-2019 12:58
I:\700A_F01_XFL.ML.dgn
FNITB

100 90 80 70 60 50 40 30 20 10 0 10 20 30 40 50 60 70 80 90 100 110 120 130 140 150 160 170 180 190 200

8/23/99



PROJ. REFERENCE NO.	SHEET NO.
I-4700	X-153

100 90 80 70 60 50 40 30 20 10 0 10 20 30 40 50 60 70 80 90 100 110 120 130 140 150 160 170 180 190 200

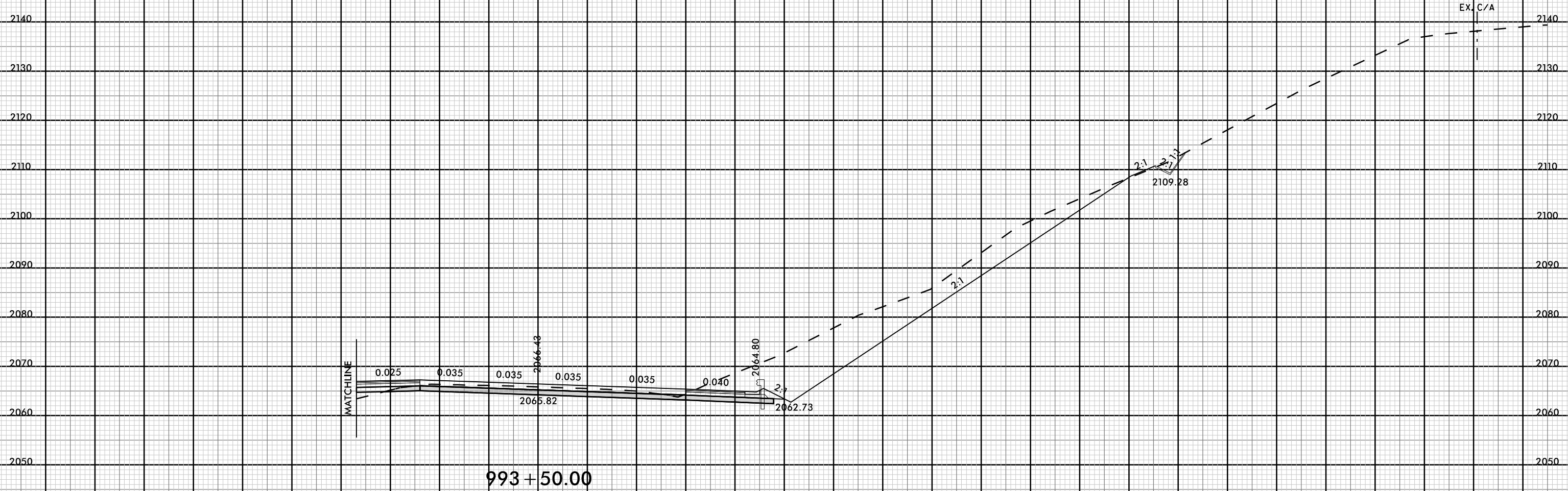

-WBL-

100 90 80 70 60 50 40 30 20 10 0 10 20 30 40 50 60 70 80 90 100 110 120 130 140 150 160 170 180 190 200

08-MAR-2019 12:58
I:\700A_F01_XFL.ML.dgn
FNITB

8/23/99



PROJ. REFERENCE NO.
I-4700

SHEET NO.
X-154

100 90 80 70 60 50 40 30 20 10 0 10 20 30 40 50 60 70 80 90 100 110 120 130 140 150 160 170 180 190 200

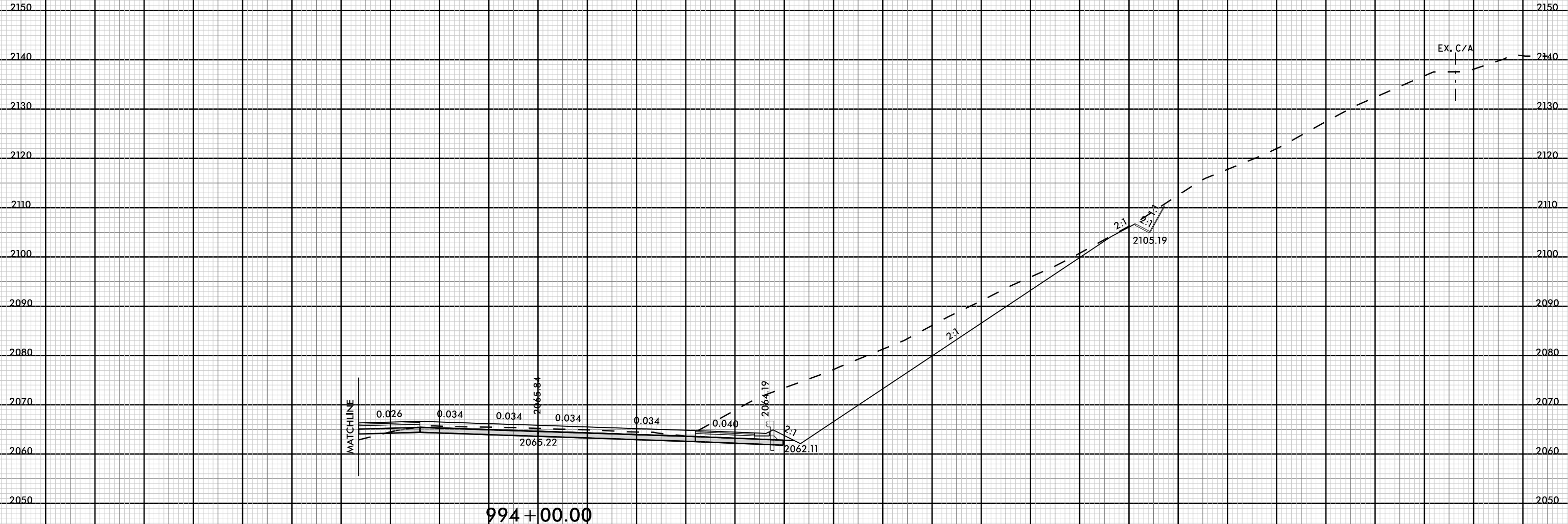

MATCHLINE

-WBL-

08-MAR-2019 12:58
I:\4700A_F01_XFL.ML.dgn
FNITB

100 90 80 70 60 50 40 30 20 10 0 10 20 30 40 50 60 70 80 90 100 110 120 130 140 150 160 170 180 190 200

8/23/99



PROJ. REFERENCE NO.	SHEET NO.
I-4700	X-155

100 90 80 70 60 50 40 30 20 10 0 10 20 30 40 50 60 70 80 90 100 110 120 130 140 150 160 170 180 190 200

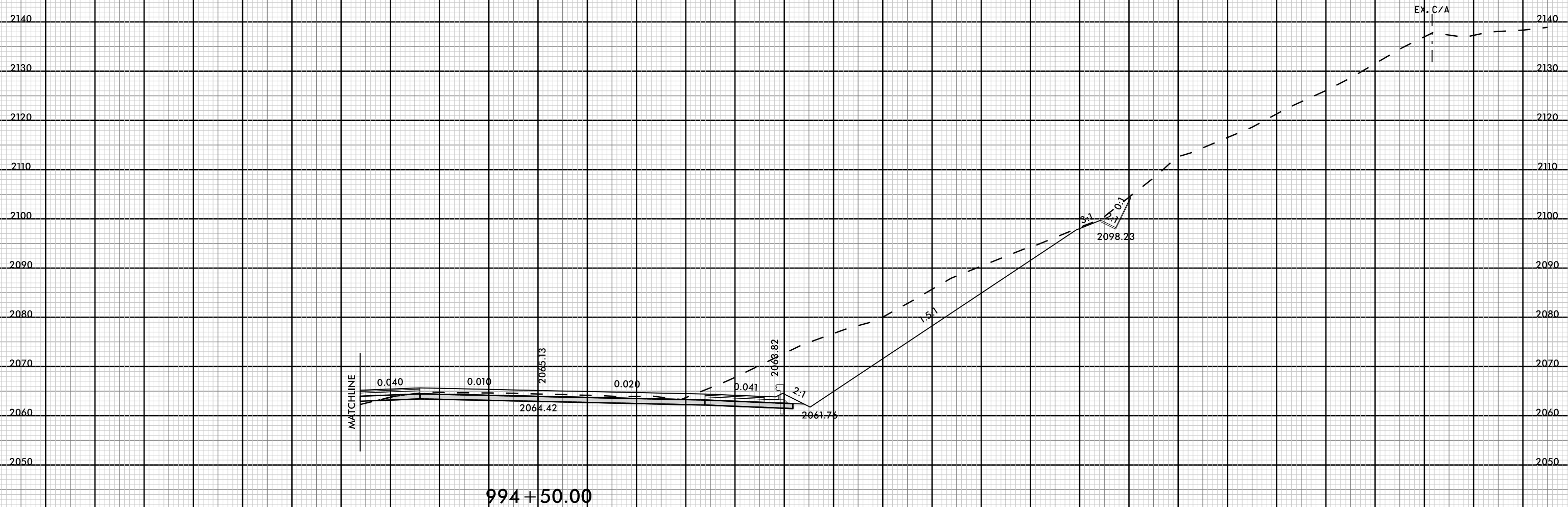

-WBL-

08-MAR-2019 12:58
I-4700A-FOY-XFL-M.dgn
FNITB

100 90 80 70 60 50 40 30 20 10 0 10 20 30 40 50 60 70 80 90 100 110 120 130 140 150 160 170 180 190 200

8/23/99



PROJ. REFERENCE NO.	SHEET NO.
I-4700	X-156

100 90 80 70 60 50 40 30 20 10 0 10 20 30 40 50 60 70 80 90 100 110 120 130 140 150 160 170 180 190 200

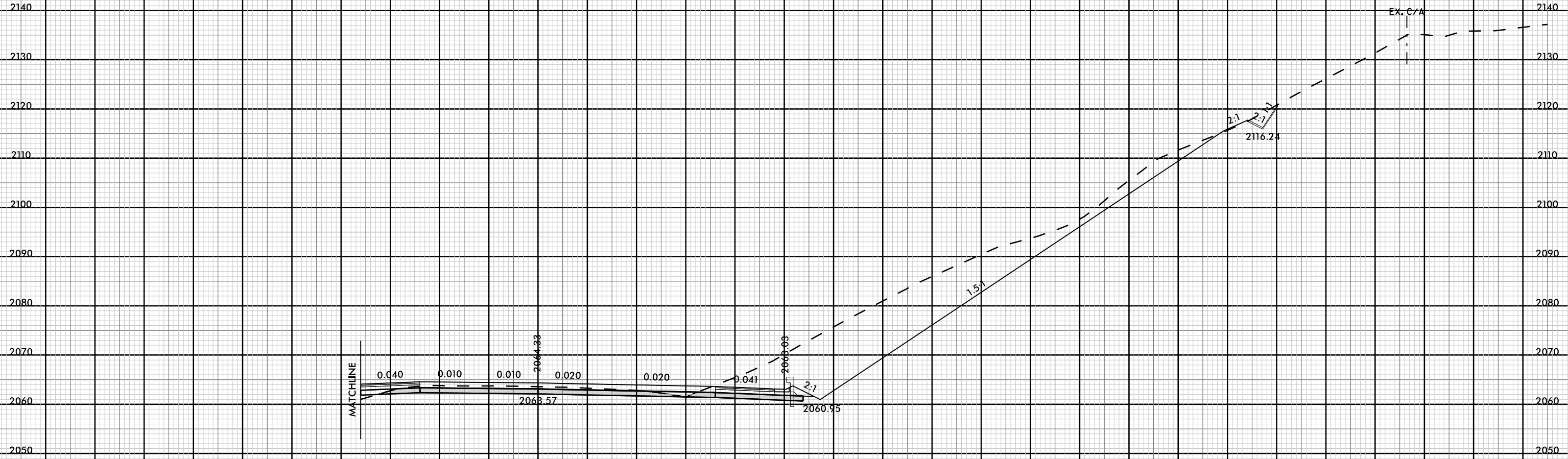

995 + 00.00

-WBL-

08-MAR-2019 12:59
I:\4700A_F01_XFL_M.dgn
FNITB

100 90 80 70 60 50 40 30 20 10 0 10 20 30 40 50 60 70 80 90 100 110 120 130 140 150 160 170 180 190 200