

**This electronic collection of documents is provided
for the convenience of the user
and is Not a Certified Document –**

**The documents contained herein were originally issued
and sealed by the individuals whose names and license
numbers appear on each page, on the dates appearing
with their signature on that page.**

**This file or an individual page
shall not be considered a certified document.**

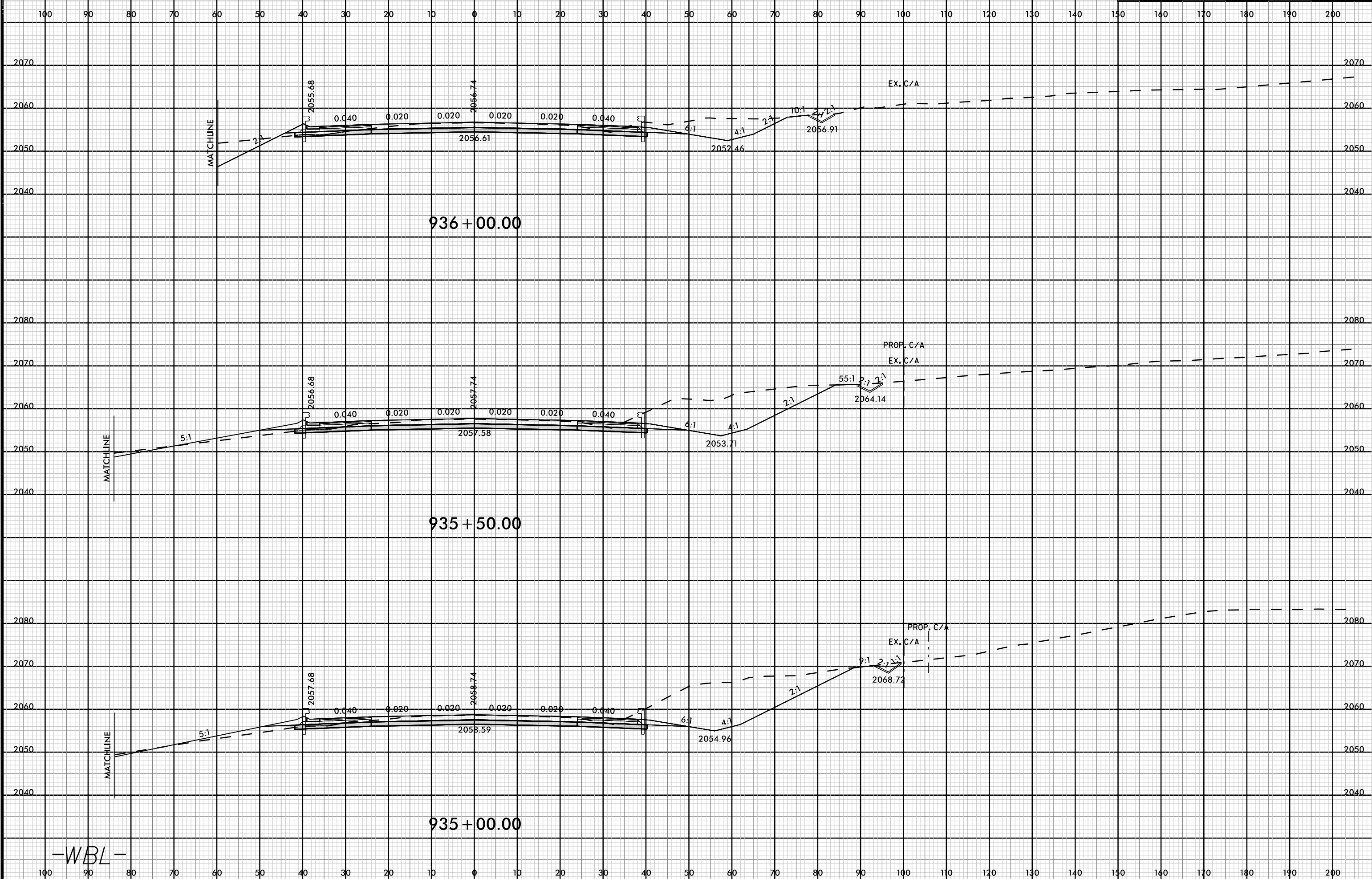

-WBL-

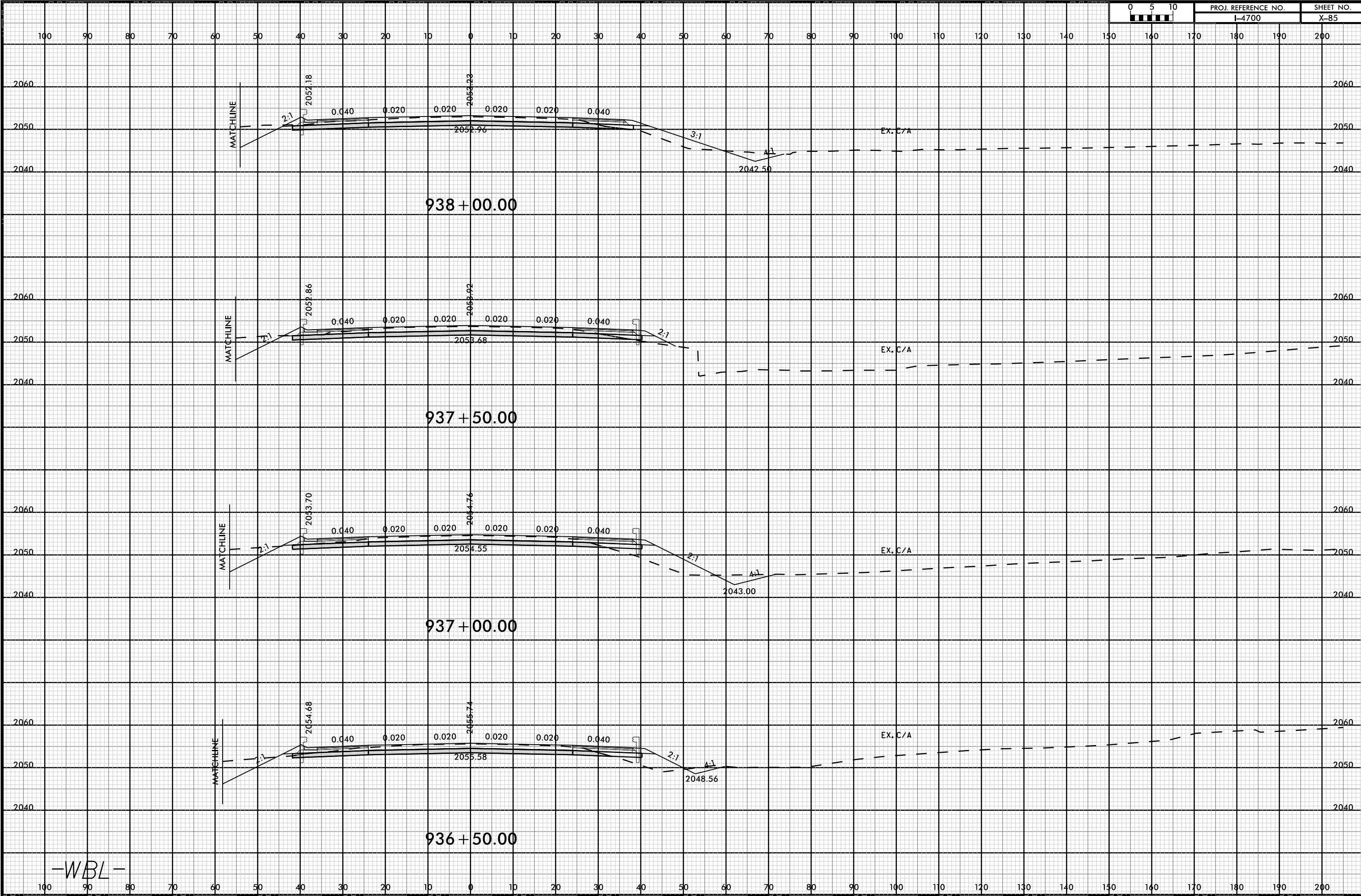

-WBL-

8/23/99



PROJ. REFERENCE NO.	SHEET NO.
I-4700	X-86

100 90 80 70 60 50 40 30 20 10 0 10 20 30 40 50 60 70 80 90 100 110 120 130 140 150 160 170 180 190 200

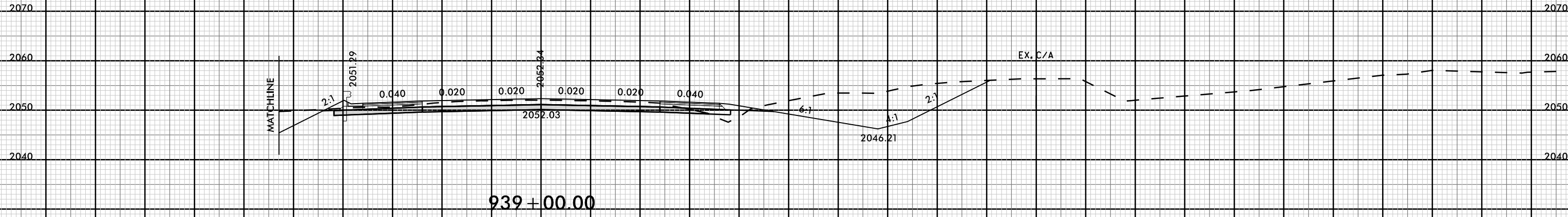
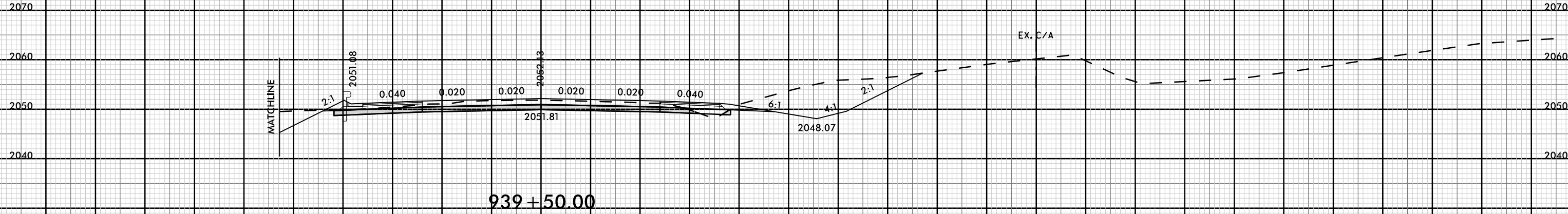

-WBL-

08-MAR-2009 12:48
I4700A_F001_XFL_M.dgn
FNITB

100 90 80 70 60 50 40 30 20 10 0 10 20 30 40 50 60 70 80 90 100 110 120 130 140 150 160 170 180 190 200

100 90 80 70 60 50 40 30 20 10 0 10 20 30 40 50 60 70 80 90 100 110 120 130 140 150 160 170 180 190 200

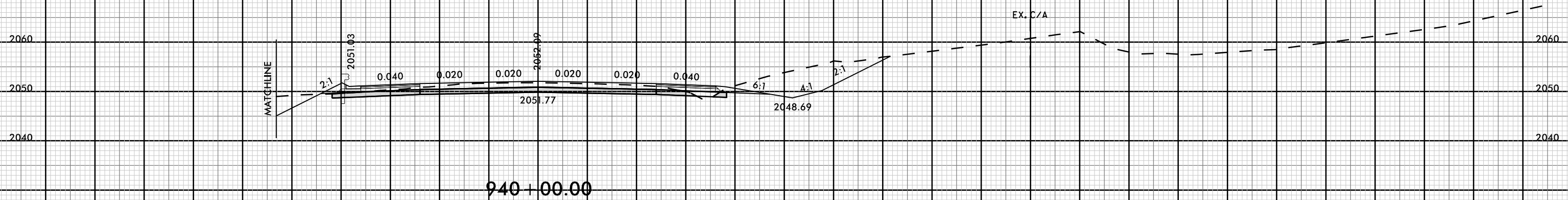
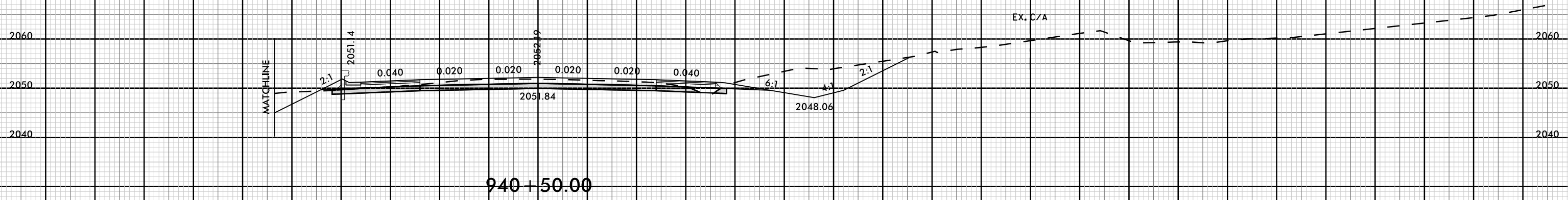
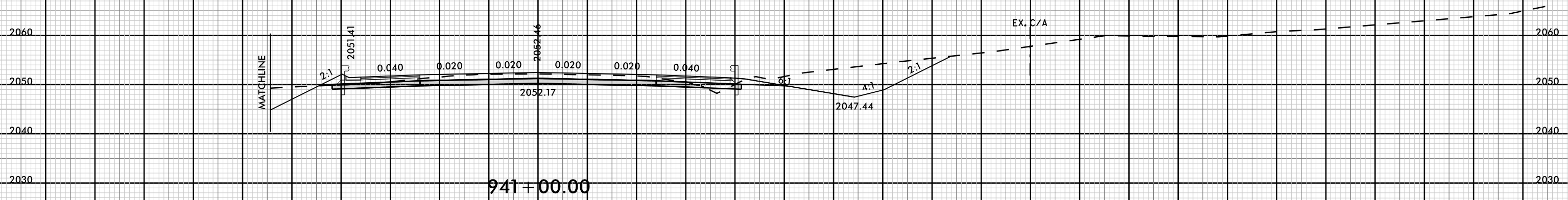

-WBL-

100 90 80 70 60 50 40 30 20 10 0 10 20 30 40 50 60 70 80 90 100 110 120 130 140 150 160 170 180 190 200

100 90 80 70 60 50 40 30 20 10 0 10 20 30 40 50 60 70 80 90 100 110 120 130 140 150 160 170 180 190 200

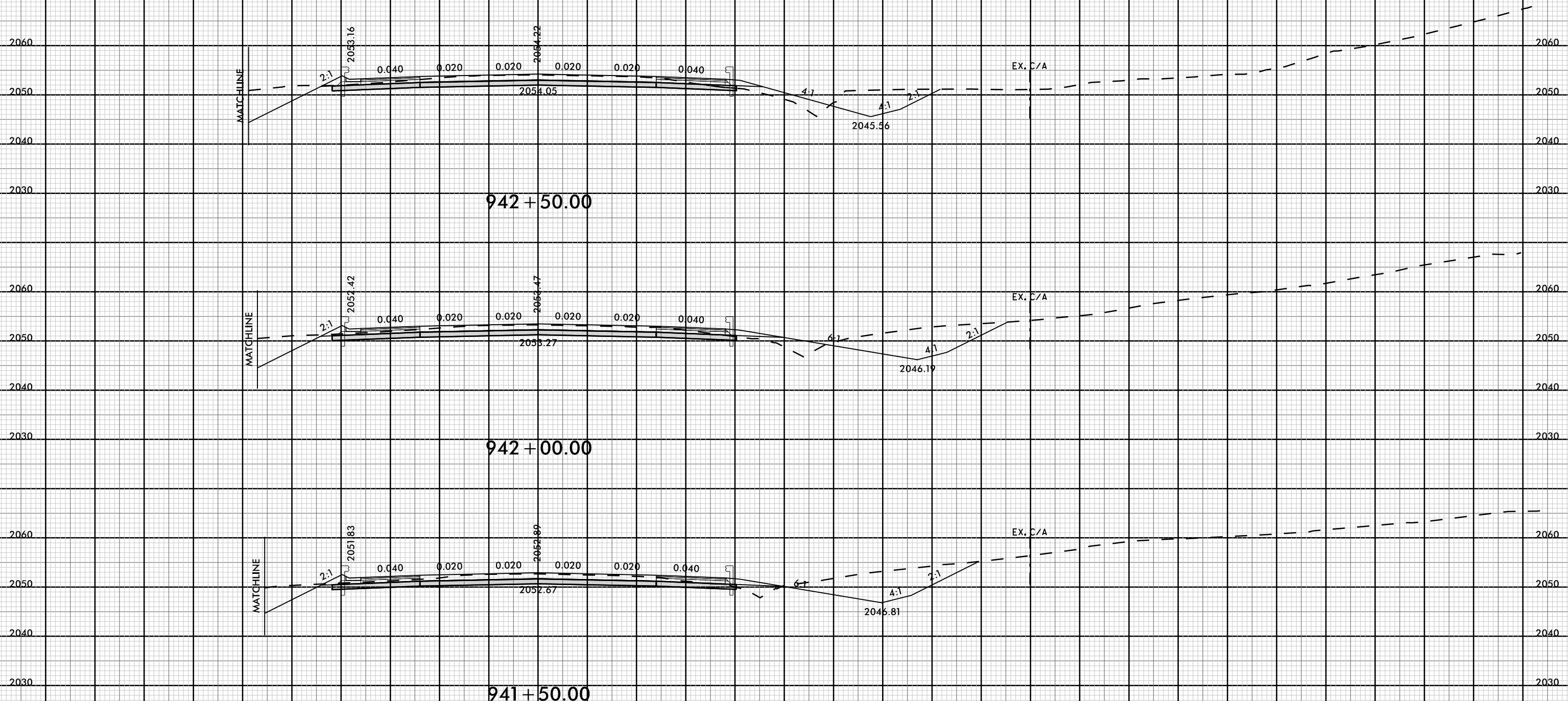

-WBL-

8/23/99



PROJ. REFERENCE NO.	SHEET NO.
I-4700	X-89

100 90 80 70 60 50 40 30 20 10 0 10 20 30 40 50 60 70 80 90 100 110 120 130 140 150 160 170 180 190 200

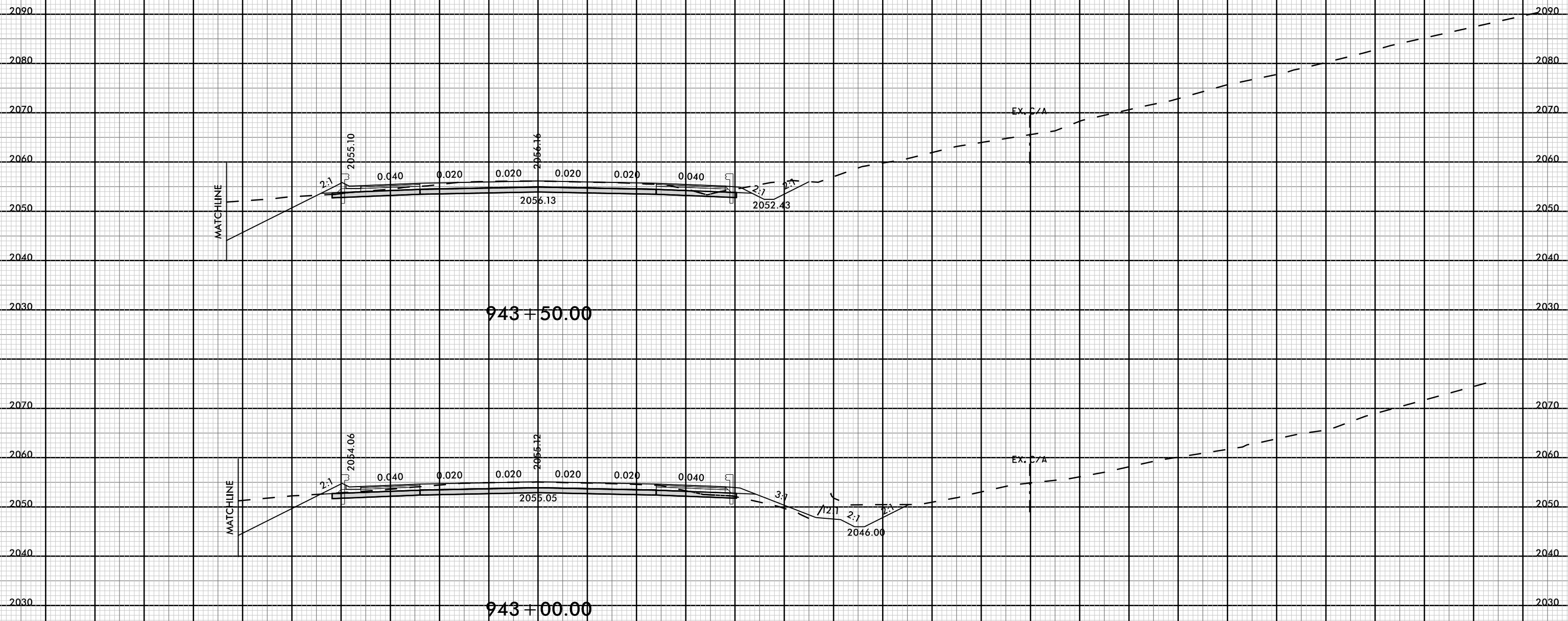

943 + 50.00

943 + 00.00

-WBL-

08-MAR-2009 12:48
I4700A-RDY-XFL-ML.dgn
FNITB

100 90 80 70 60 50 40 30 20 10 0 10 20 30 40 50 60 70 80 90 100 110 120 130 140 150 160 170 180 190 200

8/23/99



PROJ. REFERENCE NO.	SHEET NO.
I-4700	X-90

100 90 80 70 60 50 40 30 20 10 0 10 20 30 40 50 60 70 80 90 100 110 120 130 140 150 160 170 180 190 200

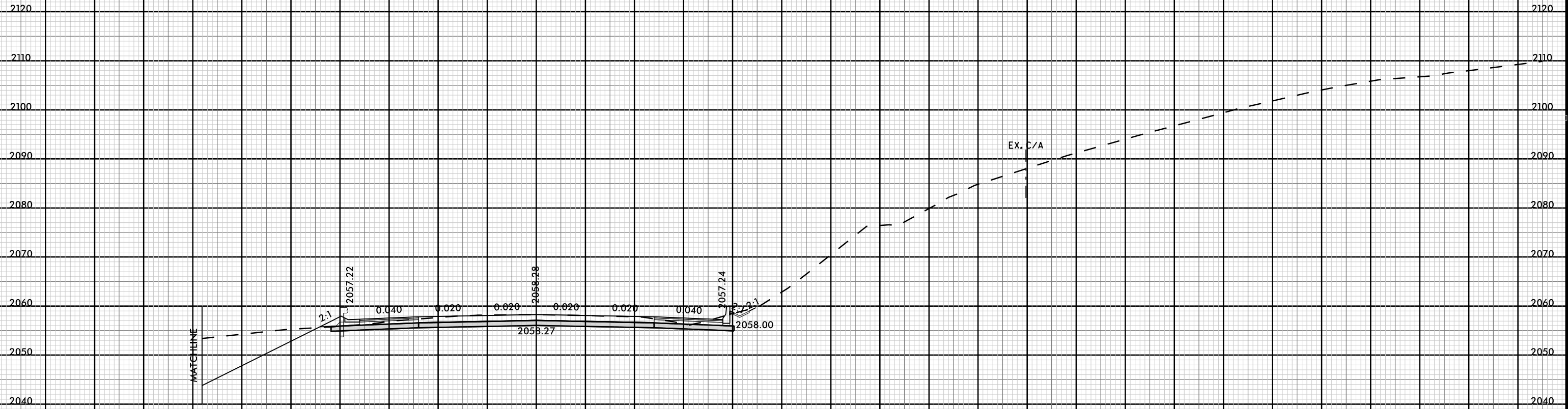

944 + 50.00

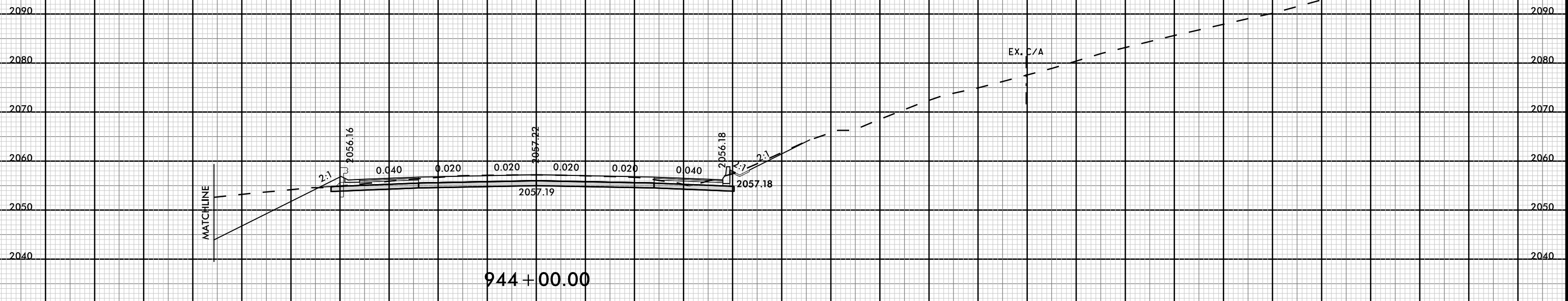

944 + 00.00

-WBL-

100 90 80 70 60 50 40 30 20 10 0 10 20 30 40 50 60 70 80 90 100 110 120 130 140 150 160 170 180 190 200

08-MAR-2009 12:49
I:\4700A\RDY_XFL_ML.dgn
FNITB

8/23/99



PROJ. REFERENCE NO.	SHEET NO.
I-4700	X-91

100 90 80 70 60 50 40 30 20 10 0 10 20 30 40 50 60 70 80 90 100 110 120 130 140 150 160 170 180 190 200

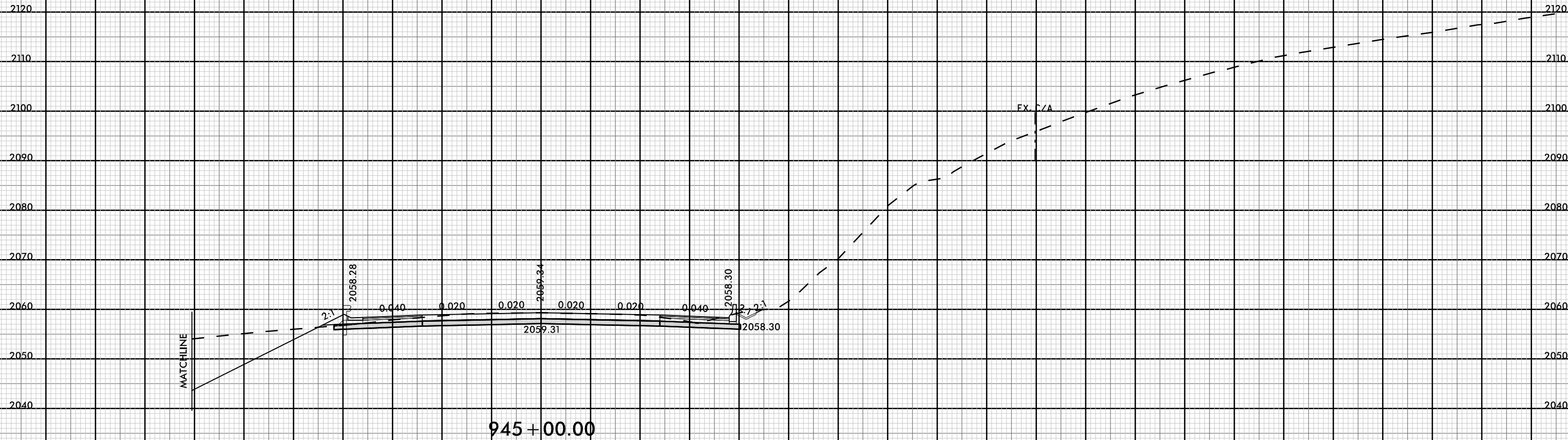

945 + 00.00

-WBL-

08-MAR-2019 12:49
 I:\4700A_F001_XFL_M.L.dgn
 FNITB

8/23/99



PROJ. REFERENCE NO.	SHEET NO.
I-4700	X-92

100 90 80 70 60 50 40 30 20 10 0 10 20 30 40 50 60 70 80 90 100 110 120 130 140 150 160 170 180 190 200

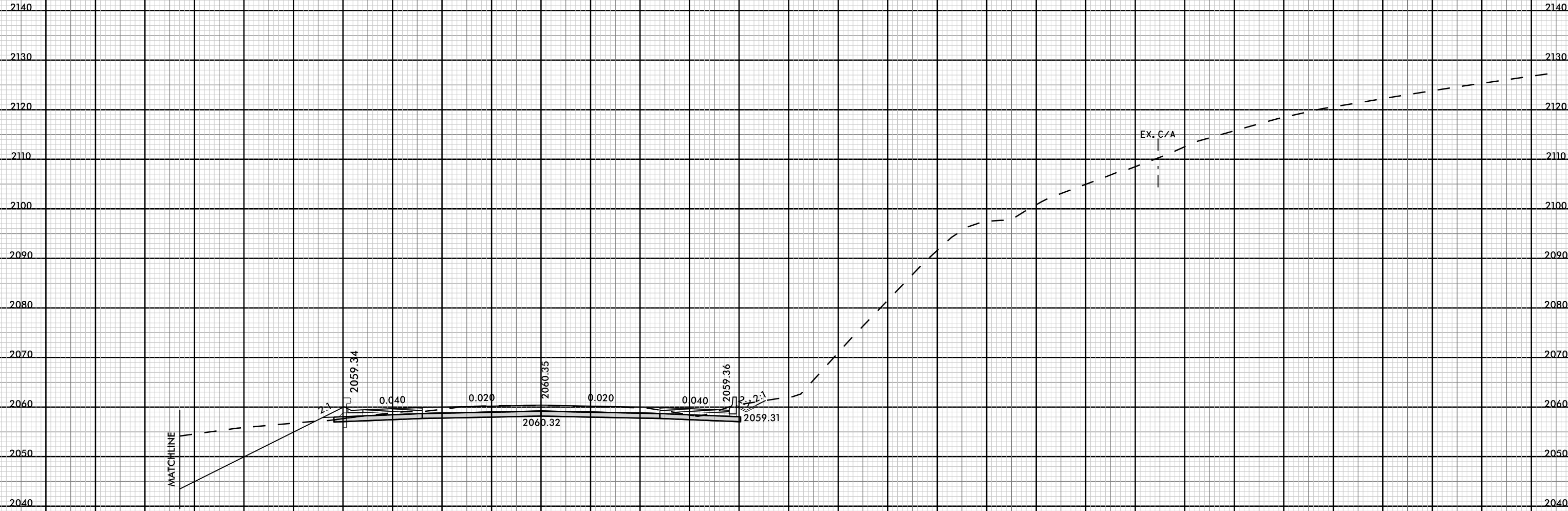

945 + 50.00

-WBL-

08-MAR-2009 12:49
I4700A_F00Y_XFL_M.L.dgn
FNITB

100 90 80 70 60 50 40 30 20 10 0 10 20 30 40 50 60 70 80 90 100 110 120 130 140 150 160 170 180 190 200

8/23/99



PROJ. REFERENCE NO.	SHEET NO.
I-4700	X-93

100 90 80 70 60 50 40 30 20 10 0 10 20 30 40 50 60 70 80 90 100 110 120 130 140 150 160 170 180 190 200

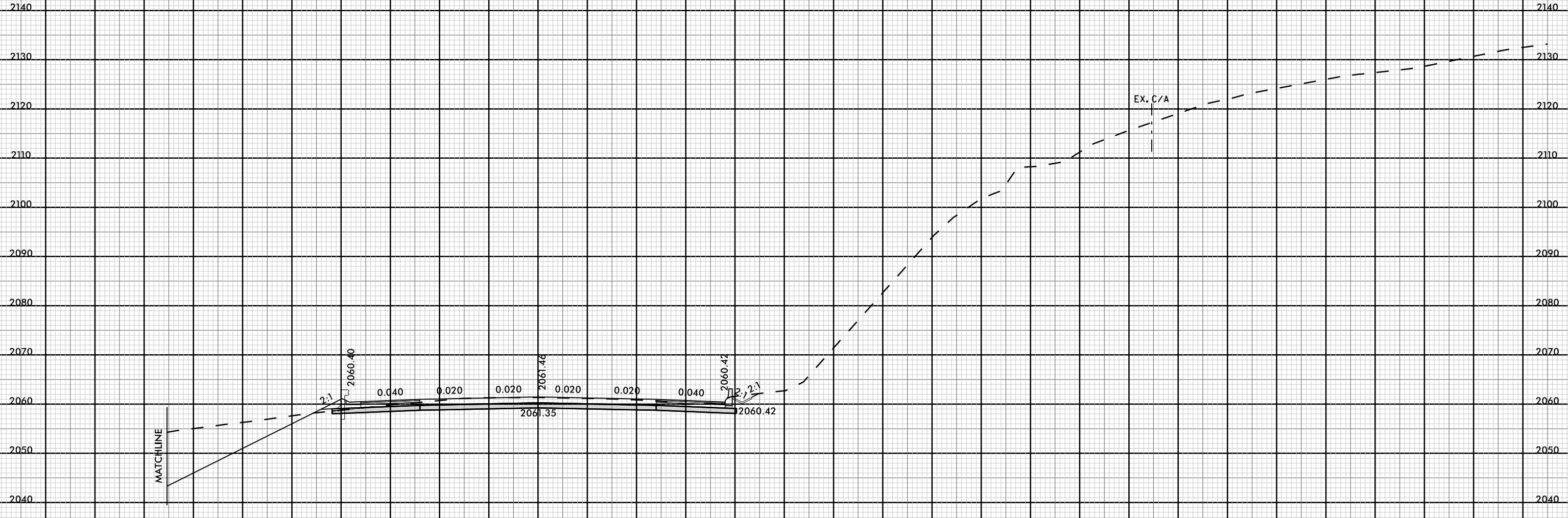

946+00.00

-WBL-

08-MAR-2009 12:49
I4700A_P01_XFL_ML.dgn
FNITB

8/23/99

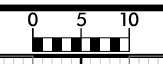

PROJ. REFERENCE NO.	SHEET NO.
I-4700	X-94

100 90 80 70 60 50 40 30 20 10 0 10 20 30 40 50 60 70 80 90 100 110 120 130 140 150 160 170 180 190 200

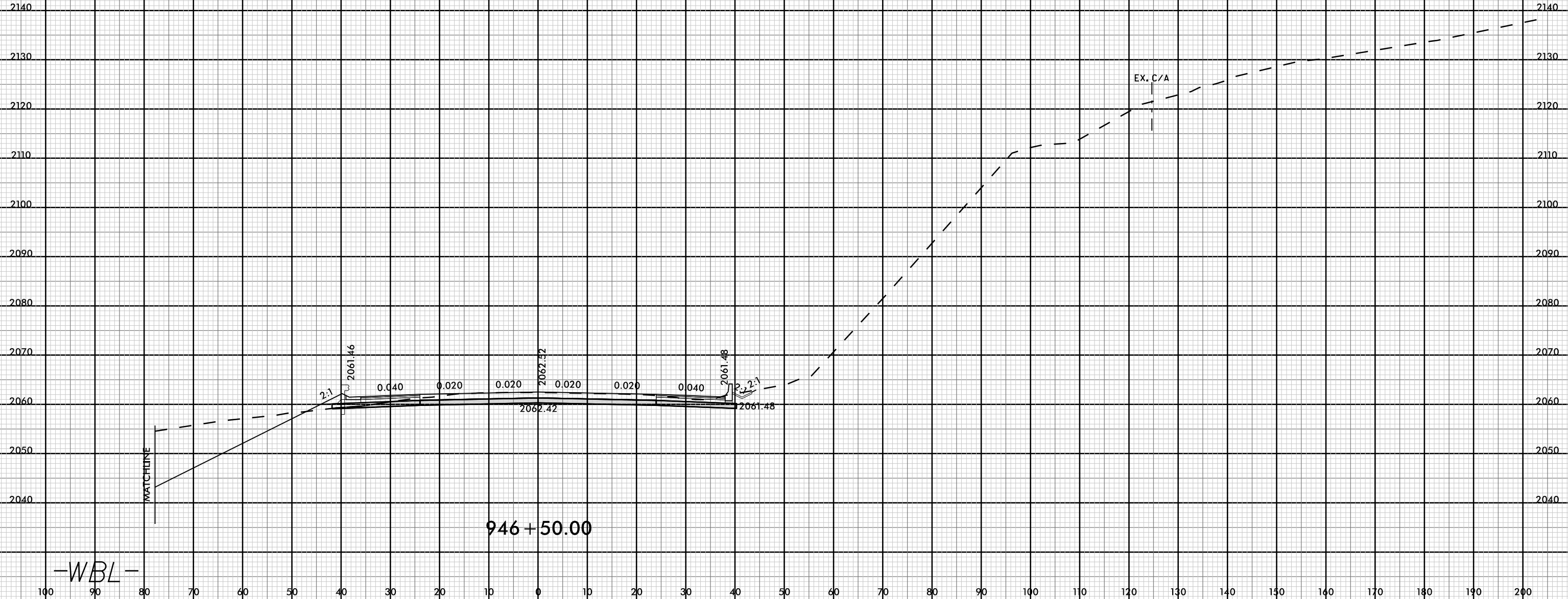

08-MAR-2009 12:49
 I4700A_P01_XFL_M.dgn
 FNITB

-WBL-

100 90 80 70 60 50 40 30 20 10 0 10 20 30 40 50 60 70 80 90 100 110 120 130 140 150 160 170 180 190 200

8/23/99



PROJ. REFERENCE NO.	SHEET NO.
I-4700	X-95

100 90 80 70 60 50 40 30 20 10 0 10 20 30 40 50 60 70 80 90 100 110 120 130 140 150 160 170 180 190 200

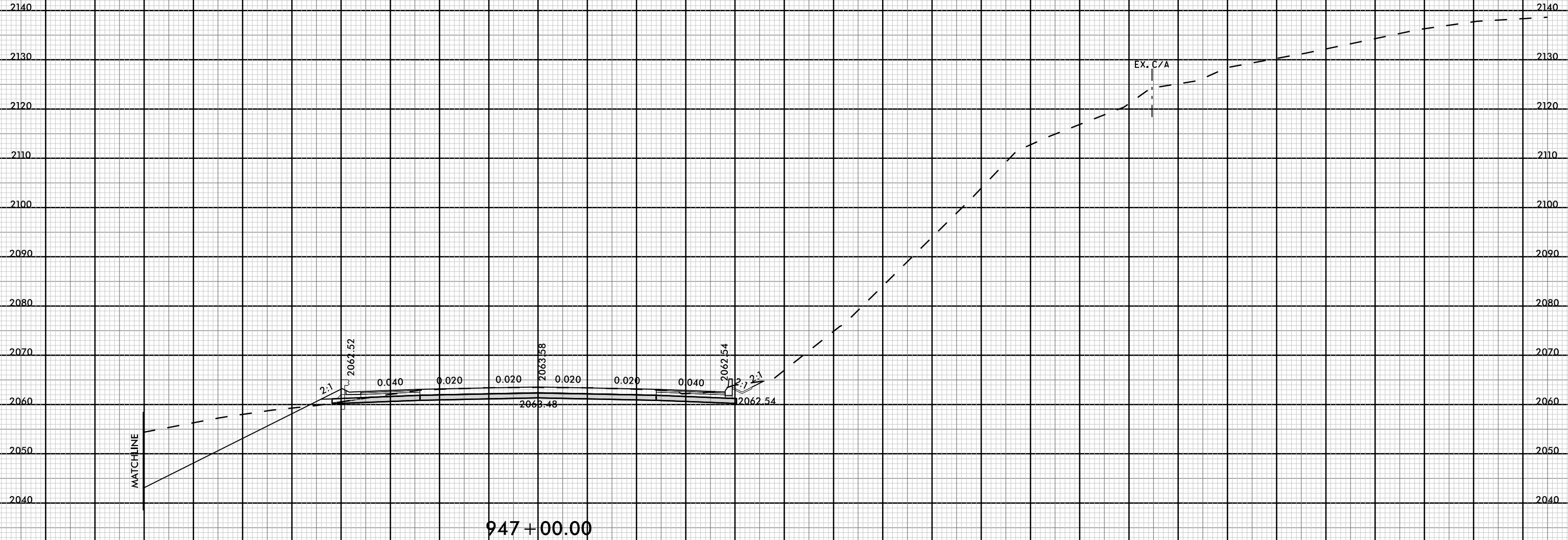

MATCHLINE

-WBL-

08-MAR-2009 12:49
I4700A_F001_XFL_ML.dgn
FNITB

8/23/99



PROJ. REFERENCE NO.	SHEET NO.
I-4700	X-96

100 90 80 70 60 50 40 30 20 10 0 10 20 30 40 50 60 70 80 90 100 110 120 130 140 150 160 170 180 190 200

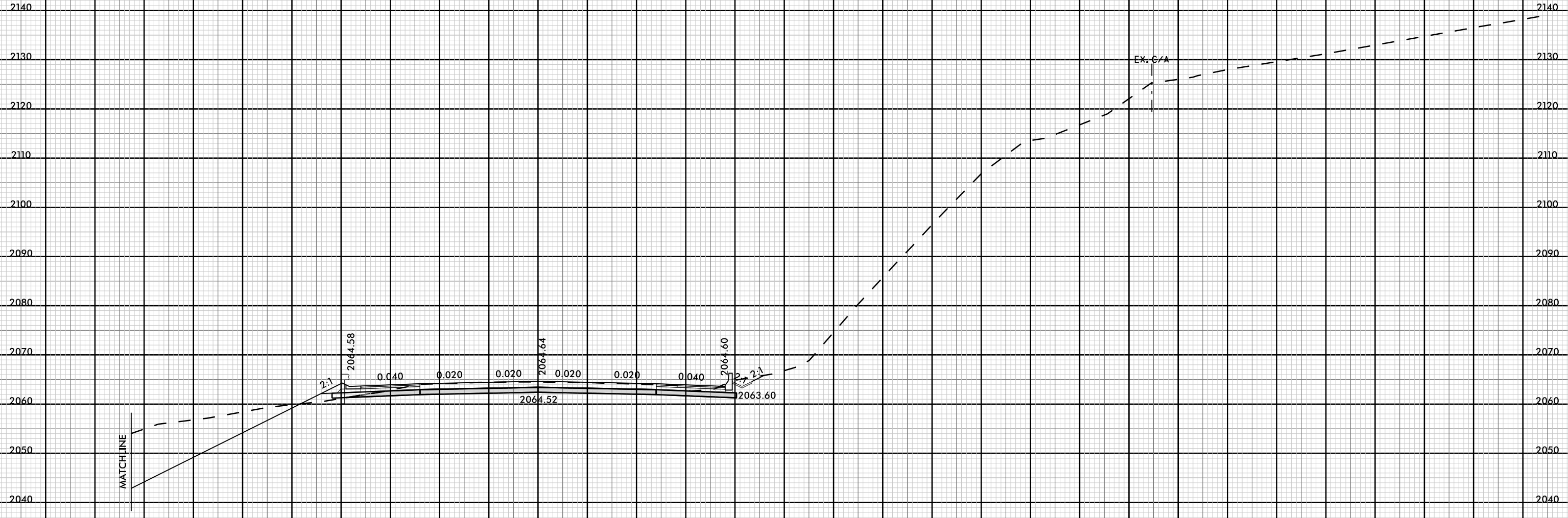

947 + 50.00

-WBL-

MATCHLINE

08-MAR-2009 12:49
I4700A_F001_XFL_M.L.dgn
FNITB

100 90 80 70 60 50 40 30 20 10 0 10 20 30 40 50 60 70 80 90 100 110 120 130 140 150 160 170 180 190 200

8/23/99



PROJ. REFERENCE NO.	SHEET NO.
I-4700	X-97

100 90 80 70 60 50 40 30 20 10 0 10 20 30 40 50 60 70 80 90 100 110 120 130 140 150 160 170 180 190 200

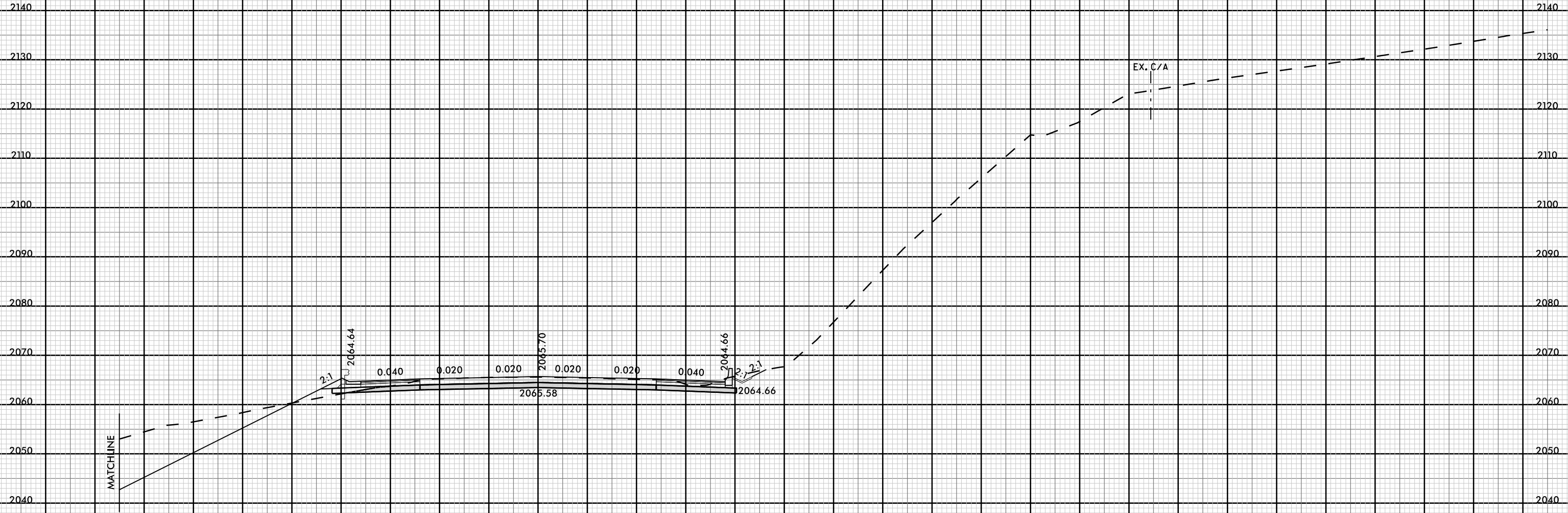

948 + 00.00

-WBL-

08-MAR-2019 12:50
I:\4700A_F01_XFL_M.L.dgn
FINITB

100 90 80 70 60 50 40 30 20 10 0 10 20 30 40 50 60 70 80 90 100 110 120 130 140 150 160 170 180 190 200

8/23/99

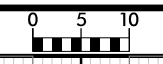

PROJ. REFERENCE NO.	SHEET NO.
I-4700	X-99

100 90 80 70 60 50 40 30 20 10 0 10 20 30 40 50 60 70 80 90 100 110 120 130 140 150 160 170 180 190 200

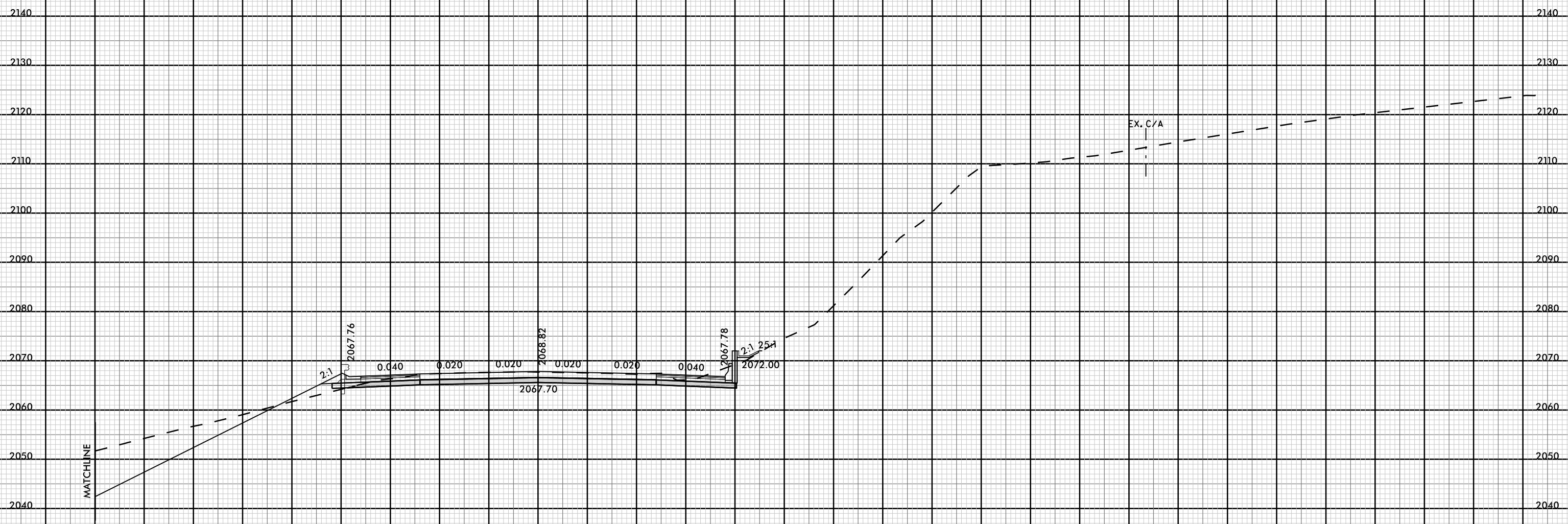

949 + 00.00

-WBL-

100 90 80 70 60 50 40 30 20 10 0 10 20 30 40 50 60 70 80 90 100 110 120 130 140 150 160 170 180 190 200

08-MAR-2019 12:50
I:\4700A_F02_XFL_M.L.dgn
FNITB

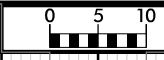

100 90 80 70 60 50 40 30 20 10 0 10 20 30 40 50 60 70 80 90 100 110 120 130 140 150 160 170 180 190 200

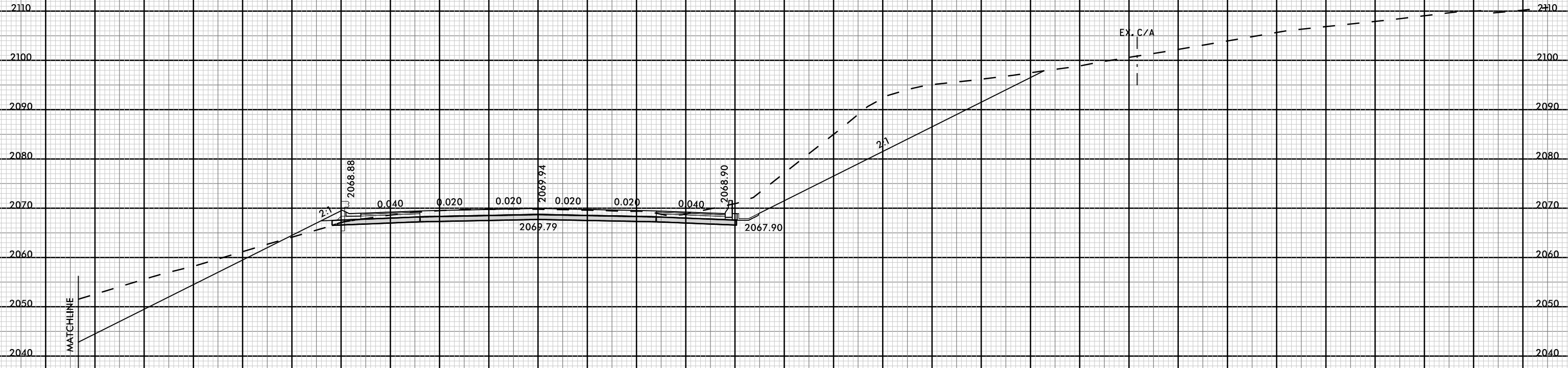

950+00.00

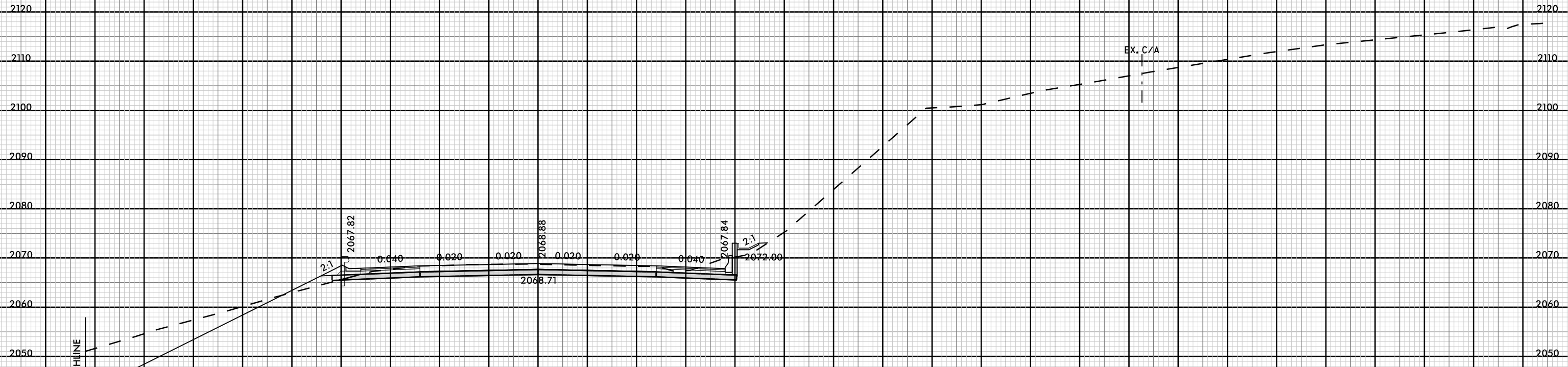

949+50.00

-WBL-

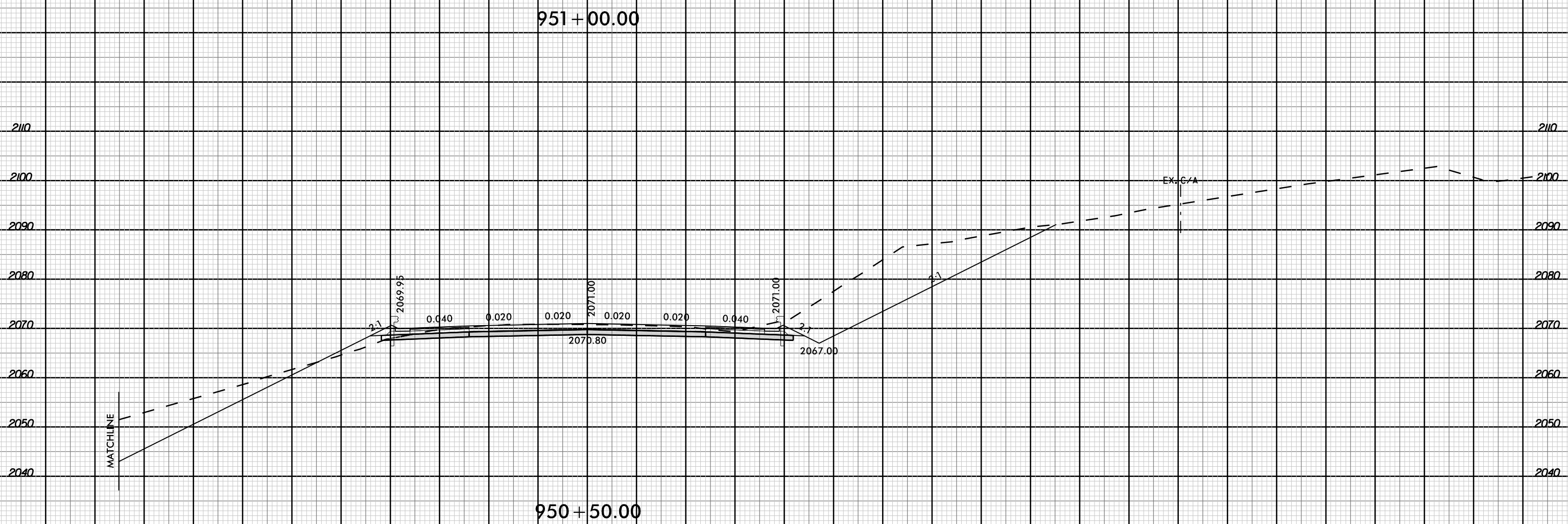
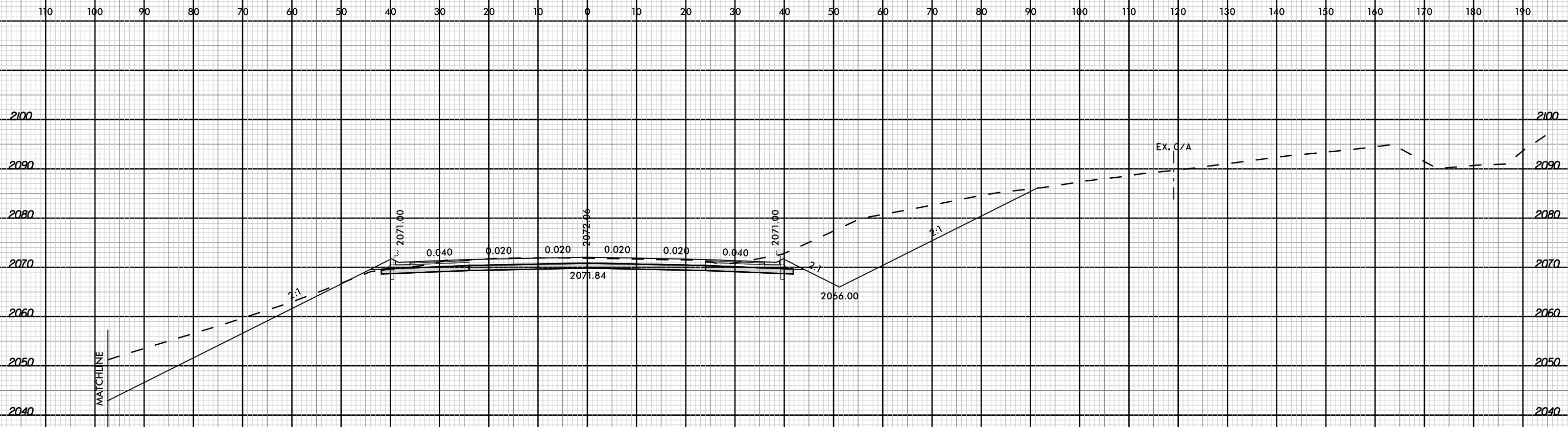

-WBL-

8/23/99



PROJ. REFERENCE NO.	SHEET NO.
I-4700	X-102

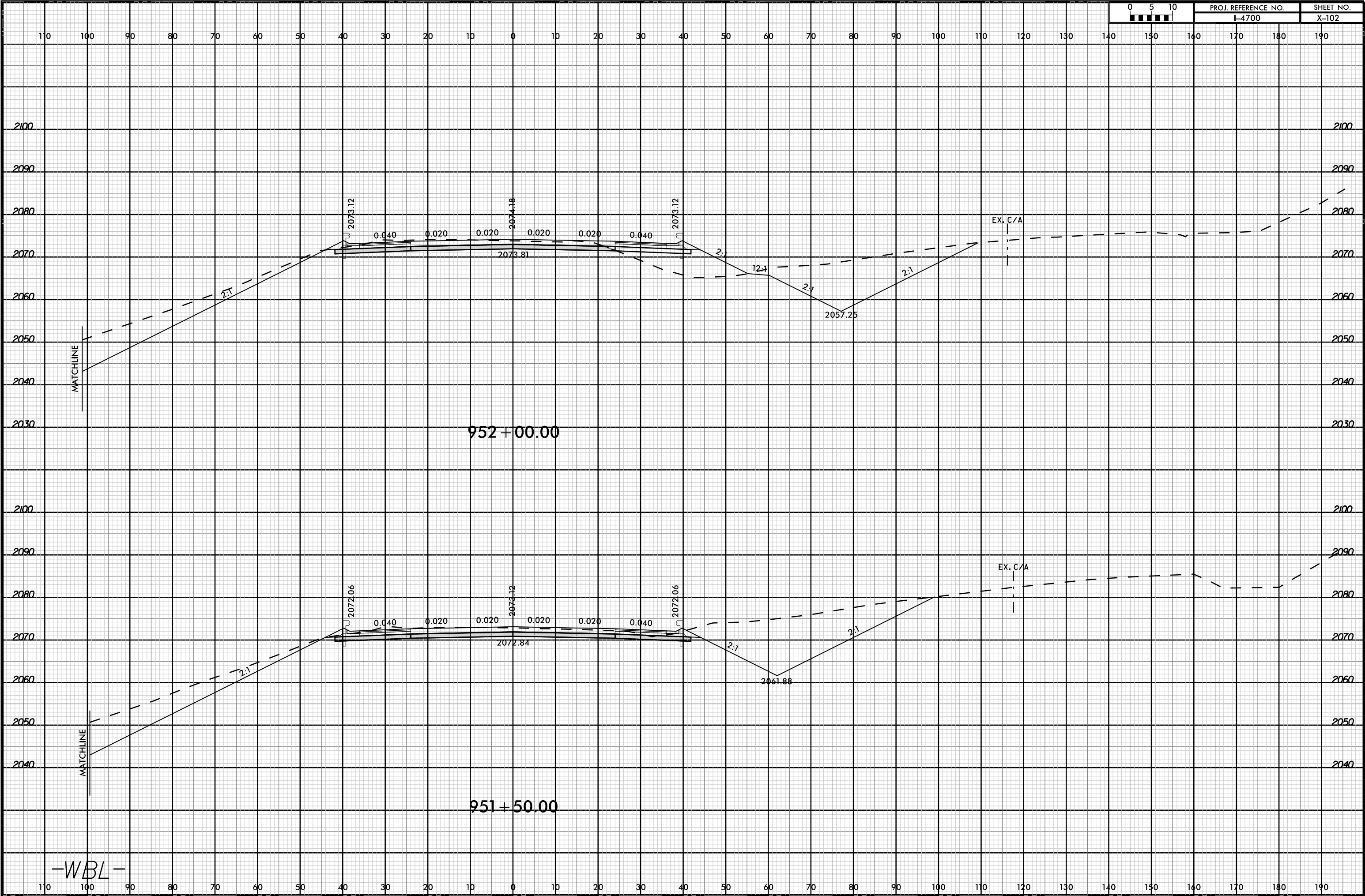

08-MAR-2019 12:51 PM
I:\4700A\RDY_XFL_ML.dgn
FNITB

-WBL-

8/23/99



PROJ. REFERENCE NO.	SHEET NO.
I-4700	X-103

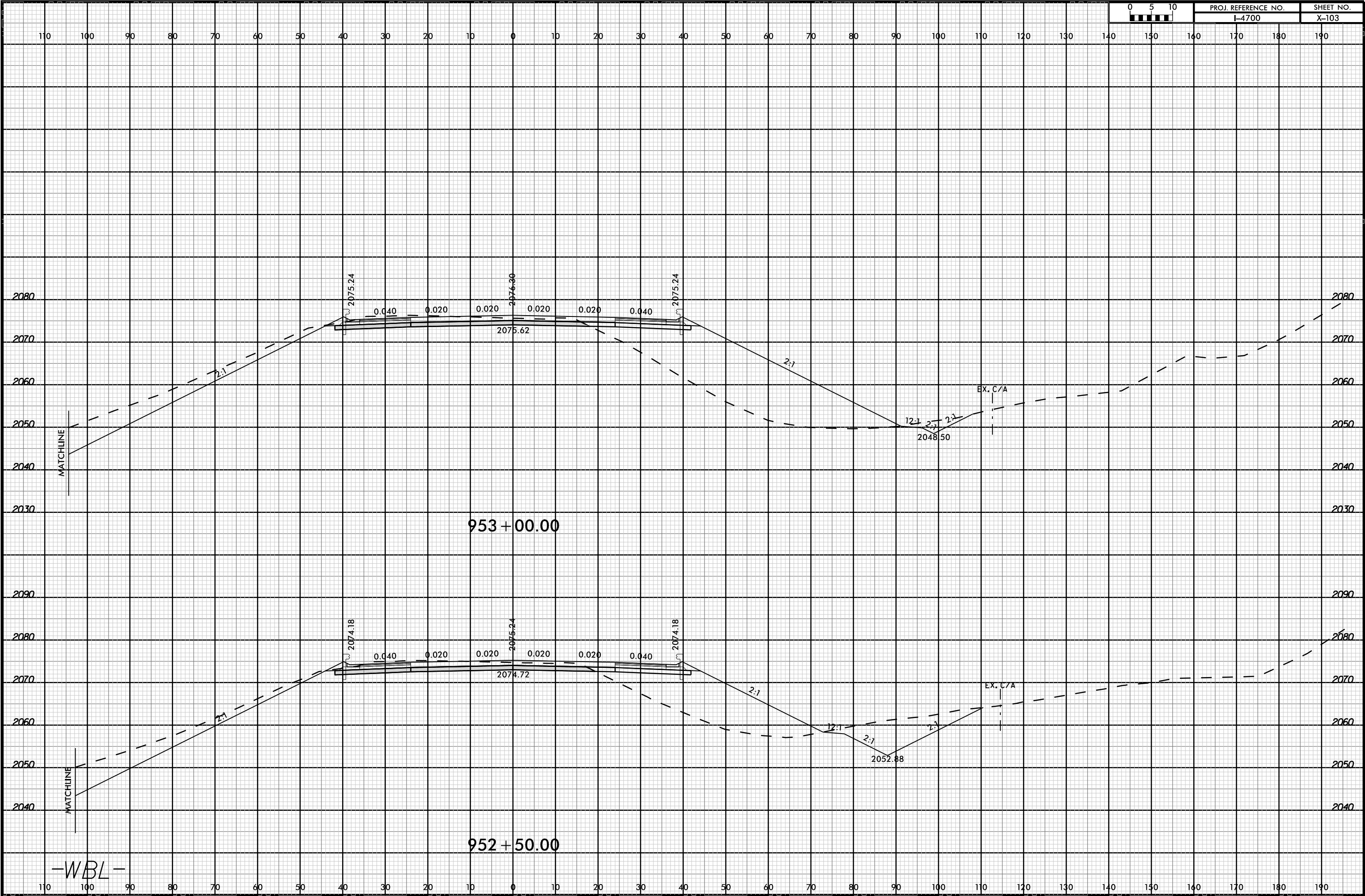

08-MAR-2019 12:51 PM I:\4700A_F001_XFL_ML.dgn

-WBL-



120 110 100 90 80 70 60 50 40 30 20 10 0 10 20 30 40 50 60 70 80 90 100 110 120 130 140 150 160 170 180

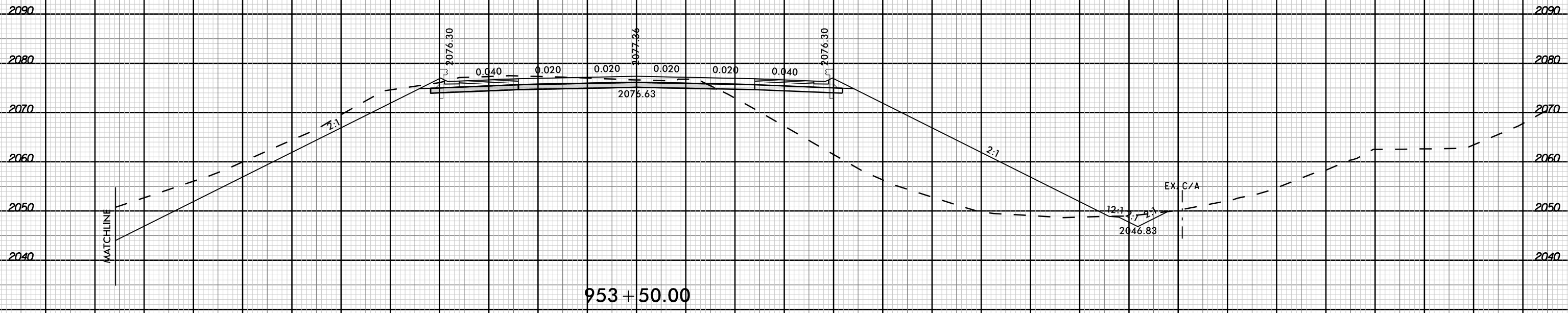
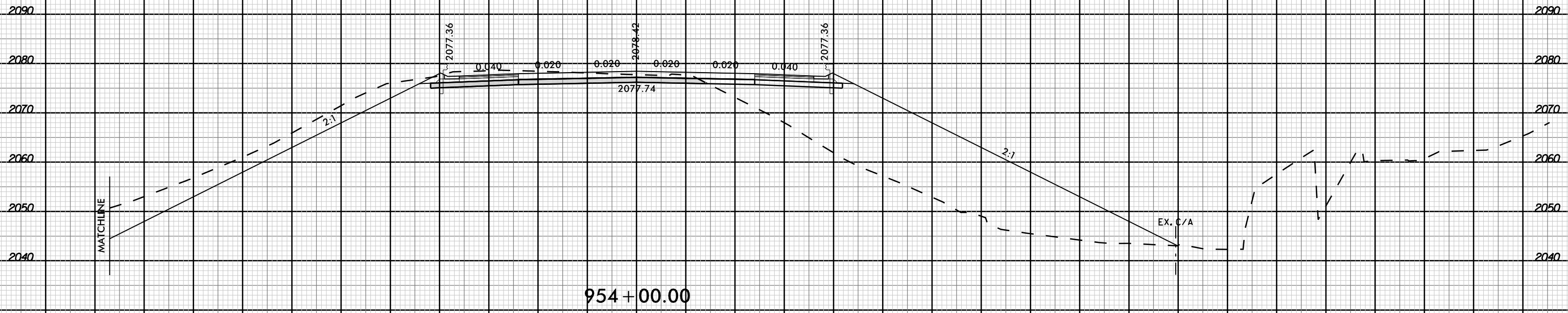

120 110 100 90 80 70 60 50 40 30 20 10 0 10 20 30 40 50 60 70 80 90 100 110 120 130 140 150 160 170 180

-WBL-



120 110 100 90 80 70 60 50 40 30 20 10 0 10 20 30 40 50 60 70 80 90 100 110 120 130 140 150 160 170 180

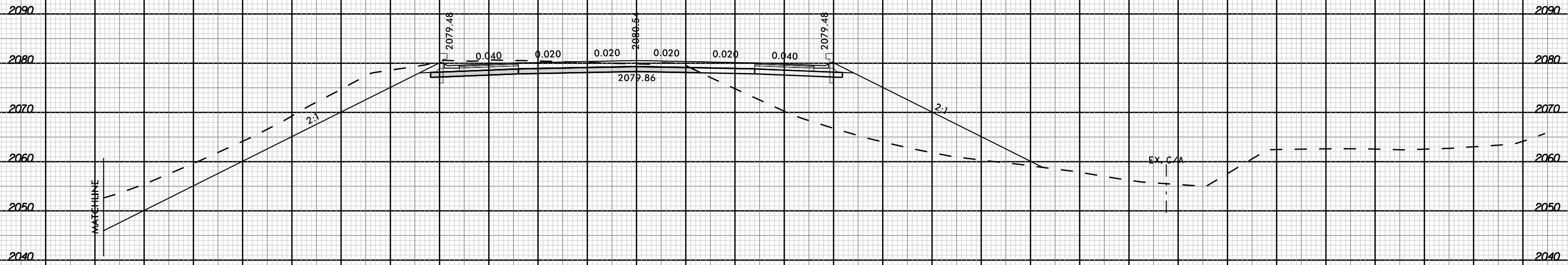

955 + 00.00

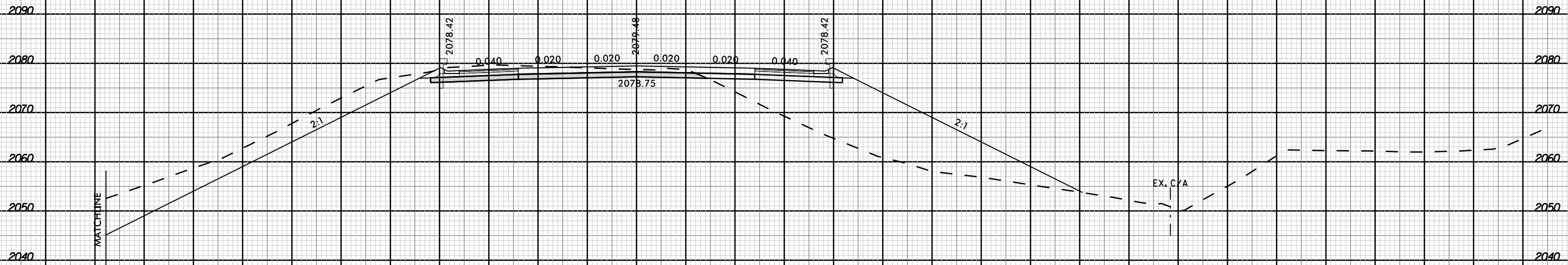

954 + 50.00

-WBL-

120 110 100 90 80 70 60 50 40 30 20 10 0 10 20 30 40 50 60 70 80 90 100 110 120 130 140 150 160 170 180

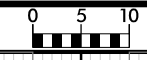

130 120 110 100 90 80 70 60 50 40 30 20 10 0 10 20 30 40 50 60 70 80 90 100 110 120

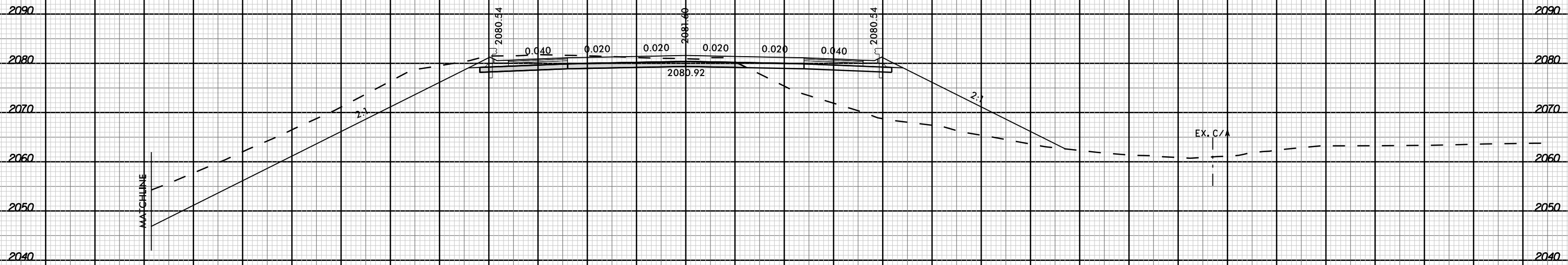
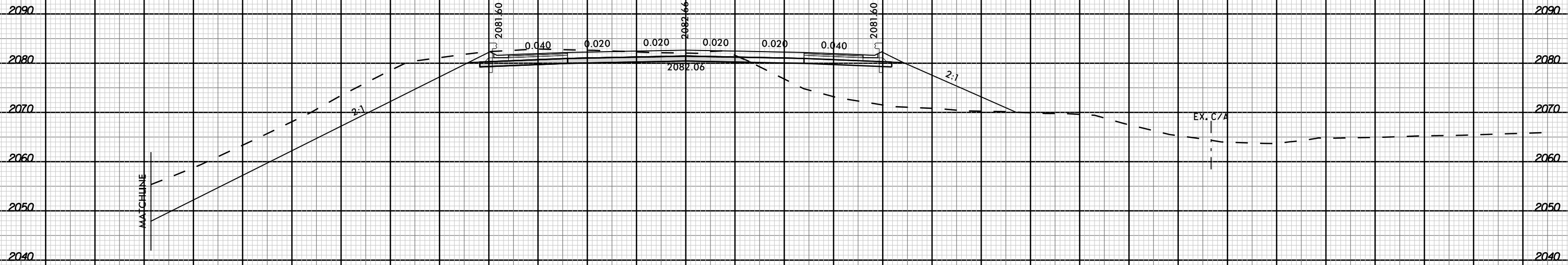

-WBL-

130 120 110 100 90 80 70 60 50 40 30 20 10 0 10 20 30 40 50 60 70 80 90 100 110 120 130 140 150 140 170

130 120 110 100 90 80 70 60 50 40 30 20 10 0 10 20 30 40 50 60 70 80 90 100 110 120 130 140 150 160 170

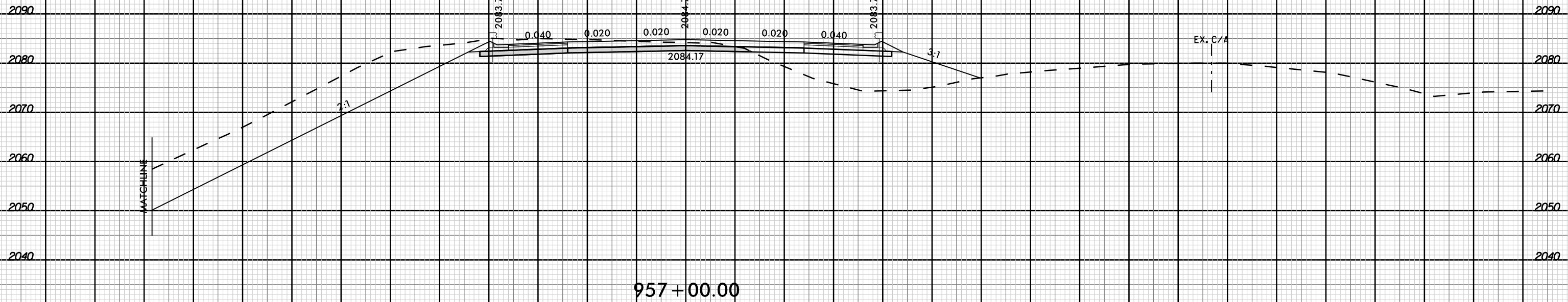

957+00.00

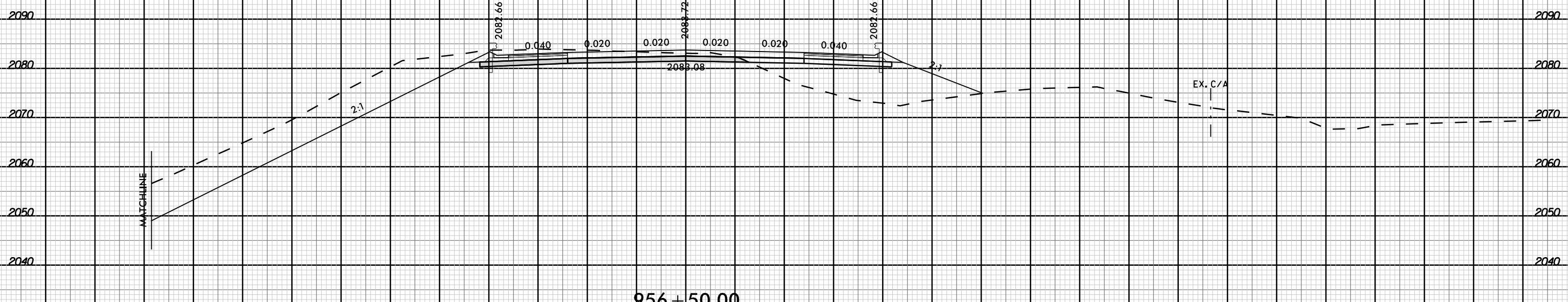

956+50.00

-WBL-