

**This electronic collection of documents is provided
for the convenience of the user
and is Not a Certified Document –**

**The documents contained herein were originally issued
and sealed by the individuals whose names and license
numbers appear on each page, on the dates appearing
with their signature on that page.**

**This file or an individual page
shall not be considered a certified document.**

STRUCTURE RECOMMENDATIONS

W.B.S. NO. 50231 DESCRIPTION Segmental Gravity Retaining Wall #1
 T.I.P. NO. U-5840
 COUNTY Henderson
 STATION 10+00.00 to 10+79.75
-W1-

	INITIALS	DATE
DESIGN	PDM	3/9/2018
CHECKED	DJC	3/9/2018
FINAL	DJC	3/9/2018



COMMENTS & NOTES

Note on Plans:

1. FOR SEGMENTAL GRAVITY RETAINING WALLS, SEE SEGMENTAL GRAVITY RETAINING WALLS PROVISION.
2. FREEZE-THAW DURABLE SRW UNITS THAT MEET ARTICLE 1040-4 OF THE STANDARD SPECIFICATIONS ARE REQUIRED.
3. A DRAIN PIPE IS REQUIRED FOR RETAINING WALL NO. 1.
4. DESIGN RETAINING WALL NO. 1 FOR WALL HEIGHTS EQUAL TO THE DESIGN HEIGHT PLUS DEPTH TO TOP OF FOOTING (DIFFERENCE BETWEEN GRADE ELEVATION AND TOP OF FOOTING ELEVATION).
5. DESIGN RETAINING WALL NO. 1 FOR THE FOLLOWING:
 - 1) MAXIMUM FACTORED VERTICAL STRESS ON FOUNDATION MATERIAL = 2,000 LB/SF. THIS ASSUMES ANY FILL OR SOFT SOILS, IF ENCOUNTERED, WILL BE UNDERCUT AND REPLACED.
 - 2) MAXIMUM COEFFICIENT OF FRICTION = 0.35
 - 3) GROUNDWATER WAS NOT ENCOUNTERED IN THE BORING TERMINATION DEPTHS.
 - 4) IN-SITU ASSUMED MATERIAL PARAMETERS:

MATERIAL TYPE	UNIT WEIGHT (γ) PCF	FRICTION ANGLE (Φ) DEGREES	COHESION (c) PSF
BACKFILL	120	30	0
FOUNDATION	120	28	0

6. DESIGN RETAINING WALL NO. 1 FOR A LIVE LOAD (TRAFFIC) SURCHARGE.
7. IGNORE PASSIVE EARTH PRESSURES IN THE UPPER 18 INCHES.

STRUCTURE RECOMMENDATION NOTES ON PLANS AND COMMENTS

PROJECT No.: U-5840 WALL NO: 1 COUNTY: Henderson
STATION: 10+00.00 to 10+79.75 -W1- DESCRIPTION: SR1547 FROM US 25 TO SR1551

8. DO NOT PLACE NO. 57 STONE FOR FOOTINGS FOR RETAINING WALL NO. 1 UNTIL EXCAVATION DIMENSIONS AND FOUNDATION MATERIAL ARE APPROVED.

RETAINING WALL #1

PROJECT REFERENCE NO. U-5840	SHEET NO. 3
Terracon Consulting Engineers & Scientists 2701 WESTPORT ROAD CHARLOTTE, NORTH CAROLINA 28206 PHONE: (704) 509-1777 FAX: (704) 509-1888 NC REGISTERED FIRM: F-0869	
0 40 80 F E E T	

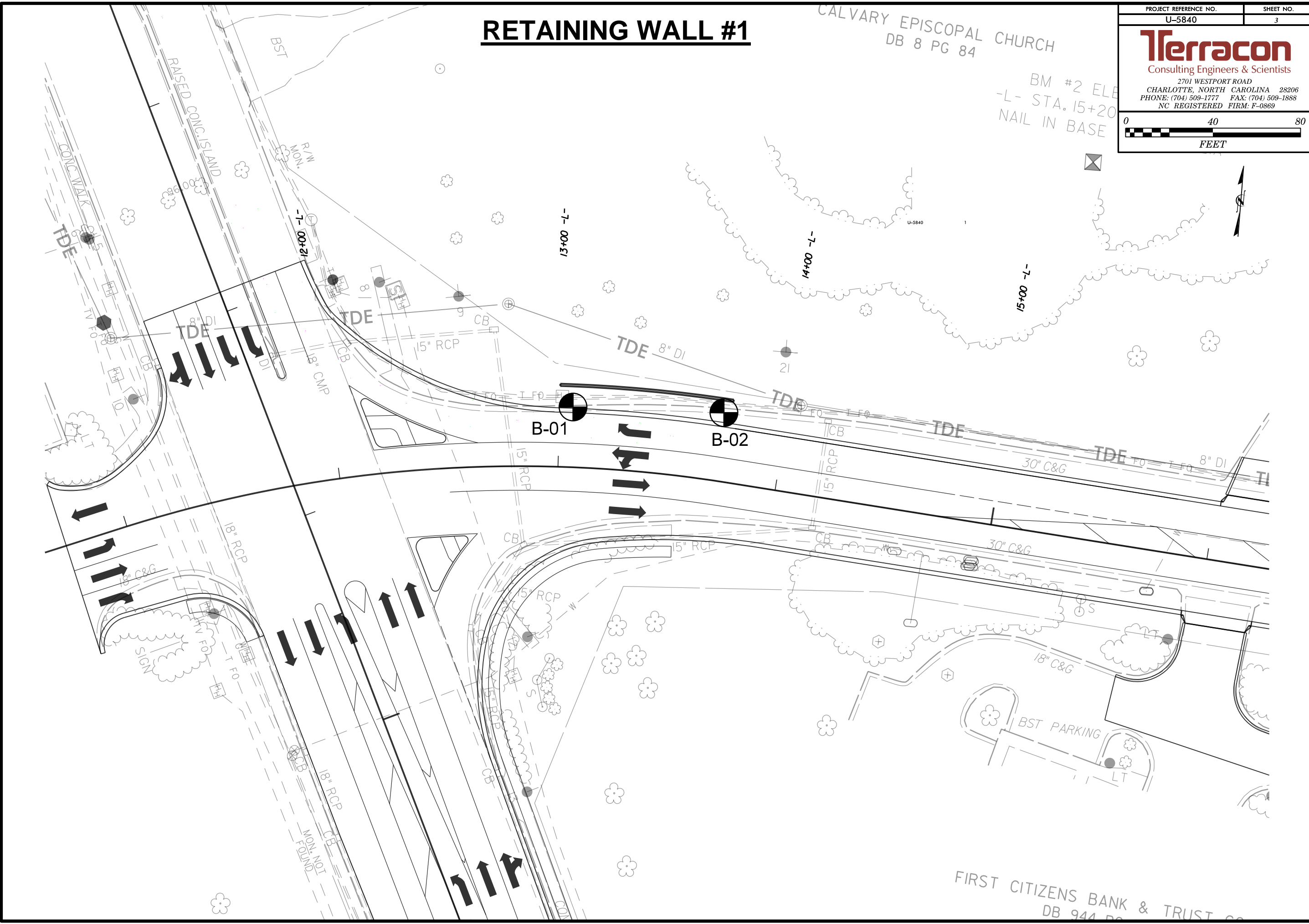

GEOTECHNICAL BORING REPORT

BORE LOG

WBS 50231	TIP U-5840	COUNTY HENDERSON	GEOLOGIST McCloud, P.D.
SITE DESCRIPTION SR 1547 (Old Airport Road) from US 25 (Hendersonville Road) to SR 1551 (Mills Gap Road)			GROUND WTR (ft)
BORING NO. B-01	STATION 10+06	OFFSET 10 ft RT	ALIGNMENT -W1-
COLLAR ELEV. 2,224.2 ft	TOTAL DEPTH 15.0 ft	NORTHING 634,362	EASTING 956,146
DRILL RIG/HAMMER EFF./DATE HPC8513 CME-550 81% 06/06/2016		DRILL METHOD H.S. Augers	HAMMER TYPE Automatic
DRILLER Odom, C.J.	START DATE 05/17/17	COMP. DATE 05/17/17	SURFACE WATER DEPTH N/A

ELEV (ft)	DRIVE ELEV (ft)	DEPTH (ft)	BLOW COUNT			BLOWS PER FOOT					SAMP. NO.	MOI	LOG	SOIL AND ROCK DESCRIPTION	DEPTH (ft)		
			0.5ft	0.5ft	0.5ft	0	25	50	75	100							
2225																	
															2,224.2	GROUND SURFACE	0.0
	2,223.0	1.3	3	4	4										2,223.0	9" Asphalt over 6" Stone Base	1.3
2220	2,220.7	3.5	2	3	4						SS-1	M		2,221.2	ROADWAY EMBANKMENT Stiff, brown, tan, and gray, SILT with sand (A-4)	3.0	
	2,218.2	6.0	4	3	4						SS-2	M			Medium stiff, gray to gray and tan, SILT with sand (A-4)		
2215	2,215.7	8.5	5	5	6						SS-3	M		2,216.2	RESIDUAL Stiff to very stiff, tan and gray to tan, gray, and red, SILT with sand (A-4)	8.0	
											SS-4	M					
2210	2,210.7	13.5	6	10	17						SS-5	M		2,209.2	Boring Terminated at Elevation 2,209.2 ft in Silt with Sand	15.0	

NCDOT BORE SINGLE 71175059 - U-5840 - HENDERSON COUNTY RETAINING WALLS.GPJ NC_DOT.GDT 6/16/17

GEOTECHNICAL BORING REPORT

BORE LOG

WBS 50231		TIP U-5840		COUNTY HENDERSON		GEOLOGIST McCloud, P.D.											
SITE DESCRIPTION SR 1547 (Old Airport Road) from US 25 (Hendersonville Road) to SR 1551 (Mills Gap Road)							GROUND WTR (ft)										
BORING NO. B-02		STATION 10+76		OFFSET 7 ft RT		ALIGNMENT -W1-											
COLLAR ELEV. 2,225.1 ft		TOTAL DEPTH 15.0 ft		NORTHING 634,365		EASTING 956,215											
DRILL RIG/HAMMER EFF./DATE HPC8513 CME-550 81% 06/06/2016				DRILL METHOD H.S. Augers		HAMMER TYPE Automatic											
DRILLER Odom, C.J.		START DATE 05/17/17		COMP. DATE 05/17/17		SURFACE WATER DEPTH N/A											
ELEV (ft)	DRIVE ELEV (ft)	DEPTH (ft)	BLOW COUNT			BLOWS PER FOOT					SAMP. NO.	MOI	LOG	SOIL AND ROCK DESCRIPTION	DEPTH (ft)		
			0.5ft	0.5ft	0.5ft	0	25	50	75	100							
2230																	
2225																	
	2,223.9	1.3													2,225.1	GROUND SURFACE	0.0
	2,221.6	3.5	3	7	8						SS-6	M		2,223.9	9" Asphalt over 6" Stone Base	1.3	
	2,219.1	6.0	2	3	4						SS-7	M		2,222.1	ROADWAY EMBANKMENT Medium dense, tan, red, and gray, clayey SAND, little gravel (A-4 (2))	3.0	
	2,216.6	8.5	4	5	9						SS-8	M		2,219.6	Medium stiff, tan, SILT with sand (A-4)	5.5	
	2,211.6	13.5	5	7	14						SS-9	M			RESIDUAL Stiff to very stiff, tan and gray, SILT with sand (A-4)		
	2,210.1		3	5	6						SS-10	M		2,210.1	Boring Terminated at Elevation 2,210.1 ft in Silt with Sand	15.0	

NCDOT BORE SINGLE 71175059 - U-5840 - HENDERSON COUNTY RETAINING WALLS.GPJ NC_DOT.GDT 6/16/17

STRUCTURE RECOMMENDATIONS

W.B.S. NO. 50231 DESCRIPTION Segmental Gravity Retaining Wall #2

T.I.P. NO. U-5840

COUNTY Henderson

STATION 10+00.00 to 11+01.73

-W2-

	INITIALS	DATE
DESIGN	PDM	6/16/2017
CHECKED	DJC	6/16/2017
FINAL	DJC	6/16/2017

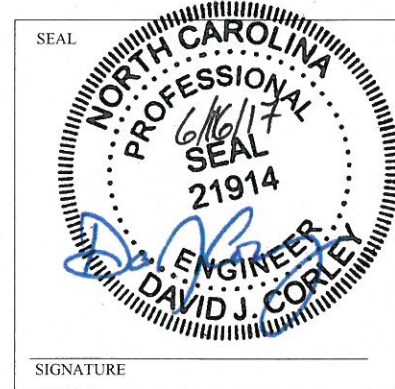

COMMENTS & NOTES

Note on Plans:

1. FOR SEGMENTAL GRAVITY RETAINING WALLS, SEE SEGMENTAL GRAVITY RETAINING WALLS PROVISION.
2. A DRAIN PIPE IS REQUIRED FOR RETAINING WALL NO. 2
3. DESIGN RETAINING WALL NO. 2 FOR WALL HEIGHTS EQUAL TO THE DESIGN HEIGHT PLUS DEPTH TO TOP OF FOOTING (DIFFERENCE BETWEEN GRADE ELEVATION AND TOP OF FOOTING ELEVATION).
4. DESIGN RETAINING WALL NO. 2 FOR THE FOLLOWING:
 - 1) MAXIMUM FACTORED VERTICAL STRESS ON FOUNDATION MATERIAL = 2,500 LB/SF. THIS ASSUMES ANY FILL OR SOFT SOILS, IF ENCOUNTERED, WILL BE UNDERCUT AND REPLACED.
 - 2) MAXIMUM COEFFICIENT OF SLIDING FRICTION = 0.35
 - 3) GROUNDWATER WAS NOT ENCOUNTERED IN THE BORING TERMINATION DEPTHS.
 - 4) IN-SITU ASSUMED MATERIAL PARAMETERS:

MATERIAL TYPE	UNIT WEIGHT (γ) LB/CF	FRICTION ANGLE (Φ) DEGREES	COHESION (c) LB/SF	ACTIVE EARTH PRESSURE (K_a)	PASSIVE EARTH PRESSURE (K_p)
BACKFILL	120	30	0	0.33	3.00
FOUNDATION	120	28	0	0.36	2.77

5. IGNORE PASSIVE EARTH PRESSURES IN THE UPPER 18 INCHES.

RETAINING WALL #2

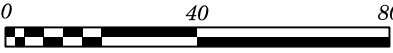
PROJECT REFERENCE NO. U-5840	SHEET NO. 4
	
Consulting Engineers & Scientists 2020 EAST STARITA ROAD CHARLOTTE, NORTH CAROLINA 28206 PHONE: (704) 509-1777 FAX: (704) 509-1888 NC REGISTERED FIRM: F-0869	
	

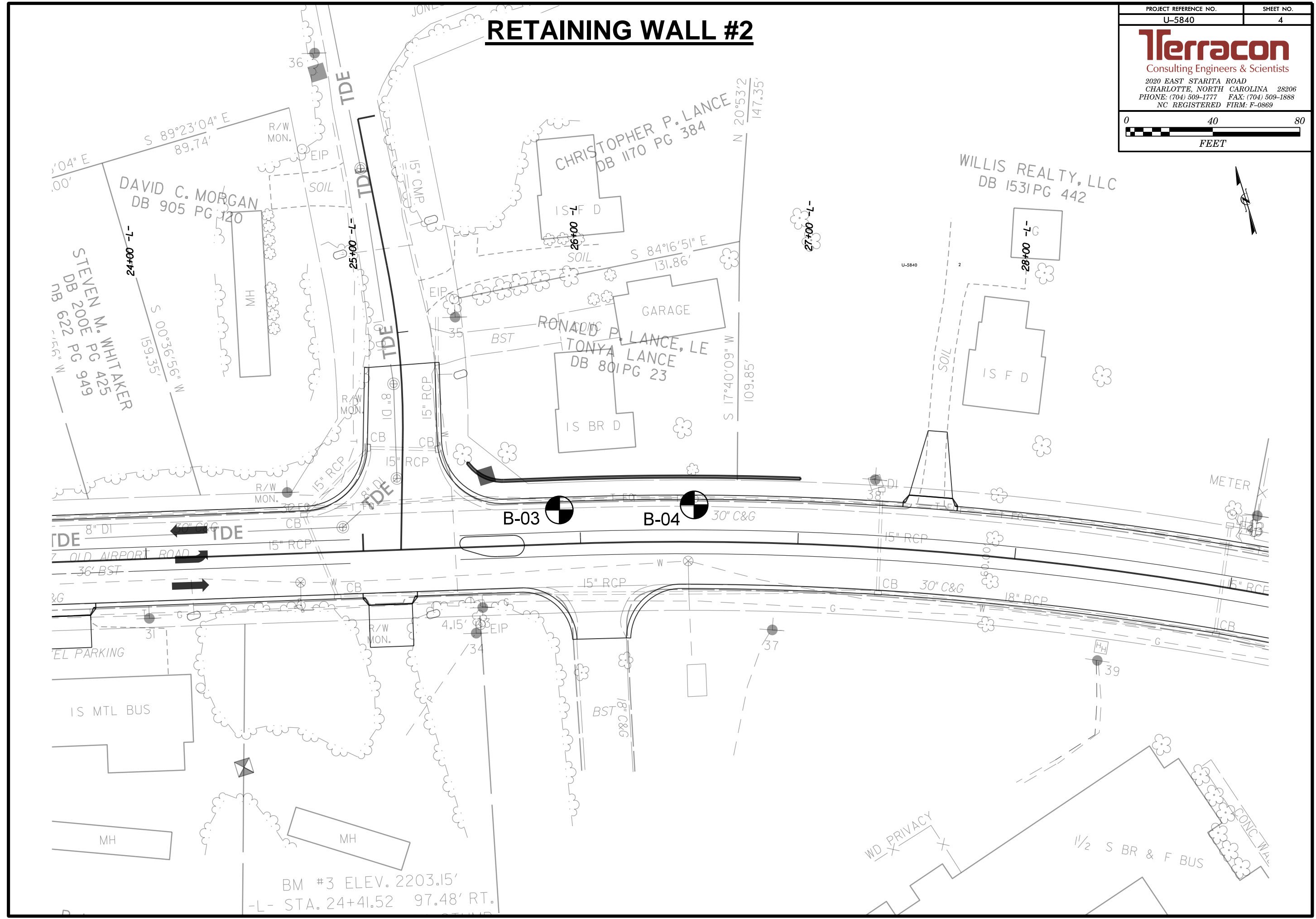

GEOTECHNICAL BORING REPORT BORE LOG

WBS U-5840			TIP U-5840			COUNTY HENDERSON			GEOLOGIST McCloud, P.D.							
SITE DESCRIPTION SR 1547 (Old Airport Road) from US 25 (Hendersonville Road) to SR 1551 (Mills Gap Road)										GROUND WTR (ft)						
BORING NO. B-03			STATION 10+45			OFFSET 14 ft RT			ALIGNMENT -W2-							
COLLAR ELEV. 2,203.9 ft			TOTAL DEPTH 15.0 ft			NORTHING 634,129			EASTING 957,412							
DRILL RIG/HAMMER EFF./DATE HPC8513 CME-550 81% 06/06/2016						DRILL METHOD H.S. Augers			HAMMER TYPE Automatic							
DRILLER Odom, C.J.			START DATE 05/17/17			COMP. DATE 05/17/17			SURFACE WATER DEPTH N/A							
ELEV (ft)	DRIVE ELEV (ft)	DEPTH (ft)	BLOW COUNT			BLOWS PER FOOT					SAMP. NO.	MOI	LOG	SOIL AND ROCK DESCRIPTION	DEPTH (ft)	
			0.5ft	0.5ft	0.5ft	0	25	50	75	100						ELEV. (ft)
2205																
	2,202.9	1.0													2,203.9	0.0
			5	13	15										2,202.9	1.0
2200	2,200.4	3.5													2,200.9	3.0
			9	10	16											
	2,197.9	6.0														
			13	18	16											
2195	2,195.4	8.5														
			14	17	21											
	2,190.4	13.5														
2190			6	7	10											
															2,188.9	15.0
															Boring Terminated at Elevation 2,188.9 ft in Silt with Sand	

NCDOT BORE SINGLE 71175059 - U-5840 - HENDERSON COUNTY RETAINING WALLS.GPJ NC_DOT.GDT 6/16/17

GEOTECHNICAL BORING REPORT

BORE LOG

WBS U-5840		TIP U-5840		COUNTY HENDERSON		GEOLOGIST McCloud, P.D.											
SITE DESCRIPTION SR 1547 (Old Airport Road) from US 25 (Hendersonville Road) to SR 1551 (Mills Gap Road)							GROUND WTR (ft)										
BORING NO. B-04		STATION 11+08		OFFSET 13 ft RT		ALIGNMENT -W2-											
COLLAR ELEV. 2,201.7 ft		TOTAL DEPTH 15.0 ft		NORTHING 634,113		EASTING 957,472											
DRILL RIG/HAMMER EFF./DATE HPC8513 CME-550 81% 06/06/2016				DRILL METHOD H.S. Augers		HAMMER TYPE Automatic											
DRILLER Odom, C.J.		START DATE 05/17/17		COMP. DATE 05/17/17		SURFACE WATER DEPTH N/A											
ELEV (ft)	DRIVE ELEV (ft)	DEPTH (ft)	BLOW COUNT			BLOWS PER FOOT					SAMP. NO.	MOI	LOG	SOIL AND ROCK DESCRIPTION	DEPTH (ft)		
			0.5ft	0.5ft	0.5ft	0	25	50	75	100							
2205																	
															2,201.7	GROUND SURFACE	0.0
2200	2,200.2	1.5	9	14	12										2,200.2	6" Asphalt over 12" Stone Base	1.5
	2,198.2	3.5	9	11	11						SS-16	M				RESIDUAL Very stiff, gray and tan, clayey SAND (A-2-4 (0))	
2195	2,195.7	6.0	8	9	13						SS-17	M			2,196.2	Very stiff to hard, dark gray and tan, SILT with sand (A-4)	5.5
	2,193.2	8.5	16	19	20						SS-18	M					
2190											SS-19	M					
	2,189.7														2,189.7	Very stiff, gray and tan, SILT with sand (A-4)	12.0
	2,188.2	13.5	13	13	10						SS-20	M			2,186.7	Boring Terminated at Elevation 2,186.7 ft in Silt with Sand	15.0

NCDOT BORE SINGLE 71175059 - U-5840 - HENDERSON COUNTY RETAINING WALLS.GPJ NC_DOT.GDT 6/16/17

STRUCTURE RECOMMENDATIONS

W.B.S. NO. 50231 DESCRIPTION Mechanically Stabilized Earth Retaining Wall #3
T.I.P. NO. U-5840
COUNTY Henderson
STATION 10+00.00 to 12+19.00
-W3-

	INITIALS	DATE
DESIGN	PDM	3/9/2018
CHECKED	DJC	3/9/2018
FINAL	DJC	3/9/2018



COMMENTS & NOTES

Note on Plans:

1. FOR MECHANICALLY STABILIZED EARTH (MSE) RETAINING WALLS, SEE MECHANICALLY STABILIZED EARTH RETAINING WALLS PROVISION.
2. USE AN MSE WALL SYSTEM WITH SEGMENTAL RETAINING WALL (SRW) UNITS THAT MEET ARTICLE 1040-4 OF THE STANDARDSPECIFICATIONS FOR RETAINING WALL NO. 3.
3. WHEN USING AN MSE WALL SYSTEM WITH SRW UNITS FOR RETAINING WALL NO. 3, FREEZE-THAW DURABLE SRW UNITS THAT MEET ARTICLE 1040-4 OF THE STANDARD SPECIFICATIONS ARE REQUIRED.
4. AT THE CONTRACTOR'S OPTION, USE FINE AGGREGATE IN THE REINFORCED ZONE OF RETAINING WALL NO. 3.
5. A SEPARATION GEOTEXTILE IS REQUIRED AT THE BACK OF THE REINFORCED ZONE FOR RETAINING WALL NO. 3.
6. A DRAIN IS REQUIRED FOR RETAINING WALL NO. 3.
7. DESIGN RETAINING WALL NO. 3 FOR THE FOLLOWING:
 - 1) $H = \text{DESIGN HEIGHT} + \text{EMBEDMENT}$.
 - 2) DESIGN LIFE = 75 YEARS
 - 3) MAXIMUM FACTORED VERTICAL PRESSURE ON FOUNDATION MATERIAL = 2,000 PSF. THIS ASSUMES ANY FILL OR SOFT SOILS, IF ENCOUNTERED, WILL BE UNDERCUT AND REPLACED.
 - 4) MINIMUM REINFORCEMENT LENGTH (L) = $0.8 \times H$ OR 6 FT, WHICHEVER IS LONGER

STRUCTURE RECOMMENDATION NOTES ON PLANS AND COMMENTS

PROJECT No.: U-5840 WALL NO: 3 COUNTY: Henderson
STATION: 10+00.00 to 12+19.00 -W3- DESCRIPTION: SR1547 FROM US 25 TO SR1551

5) REINFORCED ZONE AGGREGATE PARAMETERS:

AGGREGATE TYPE*	UNIT WEIGHT (γ) PCF	FRICTION ANGLE (Φ) DEGREES	COHESION (c) PSF
COURSE	110	38	0
FINE	115	34	0

*SEE MSE RETAINING WALLS PROVISION FOR COARSE AND FINE AGGREGATE MATERIAL REQUIREMENTS.

7) IN-SITU ASSUMED MATERIAL PARAMETERS:

MATERIAL TYPE	UNIT WEIGHT (γ) PCF	FRICTION ANGLE (Φ) DEGREES	COHESION (c) PSF
BACKFILL	120	30	0
FOUNDATION	120	28	0

8. DESIGN RETAINING WALL NO. 3 FOR A LIVE LOAD (TRAFFIC) SURCHARGE.
9. DO NOT PLACE LEVELING PAD CONCRETE, AGGREGATE OR REINFORCEMENT FOR RETAINING WALL NO. 3 UNTIL EXCAVATION DIMENSIONS AND FOUNDATION MATERIAL ARE APPROVED.
10. IGNORE PASSIVE EARTH PRESSURES IN THE UPPER 18 INCHES.

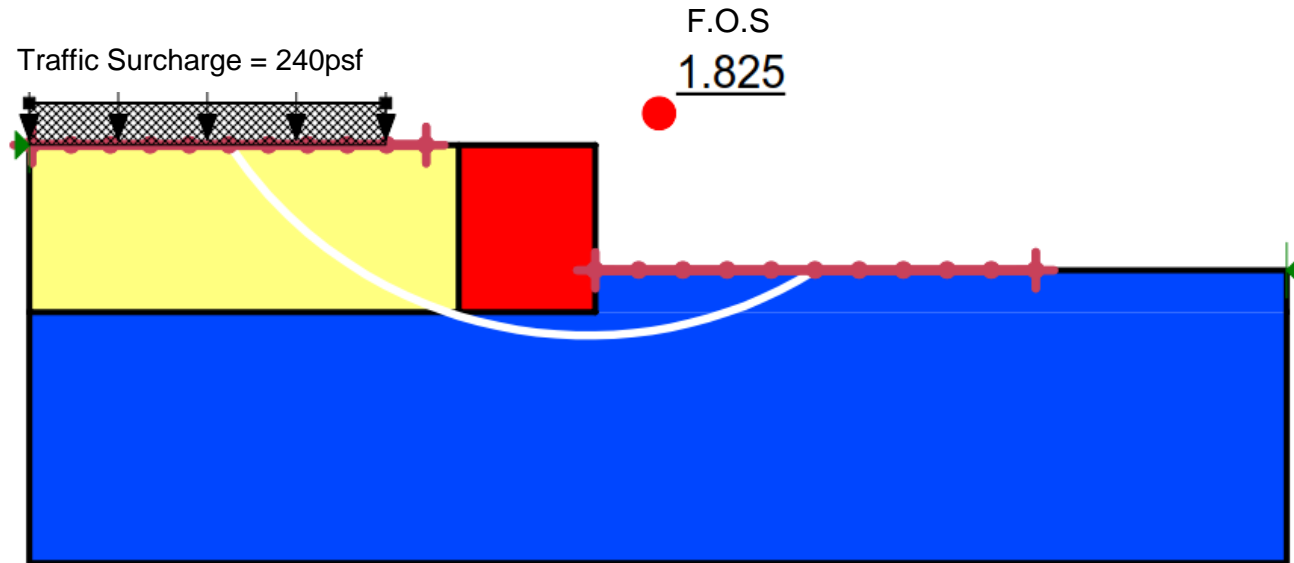

LEGEND:

- = Backfill Soil ($\gamma=120$ pcf, $\Phi=30^\circ$, $c=0$)
- = Foundation Soil ($\gamma=120$ pcf, $\Phi=28^\circ$, $c=0$)

Project Manager: PDM	Project No. 71175059
Drawn by: PDM	Scale: AS SHOWN
Checked by: DJC	File Name: Wall 3
Approved by: DJC	Date: MARCH 2018

Terracon
2701 Westport Road
Charlotte, NC 28208

GLOBAL STABILITY ANALYSIS
Mechanically Stabilized Earth Retaining Wall #3 State Project No. U-5840 Henderson County, North Carolina

Page
3

RETAINING WALL #3

PROJECT REFERENCE NO. U-5840	SHEET NO. 4
Terracon	
Consulting Engineers & Scientists	
2701 WESTPORT ROAD CHARLOTTE, NORTH CAROLINA 28206 PHONE: (704) 509-1777 FAX: (704) 509-1888 NC REGISTERED FIRM: F-0869	
 0 40 80 FEET	

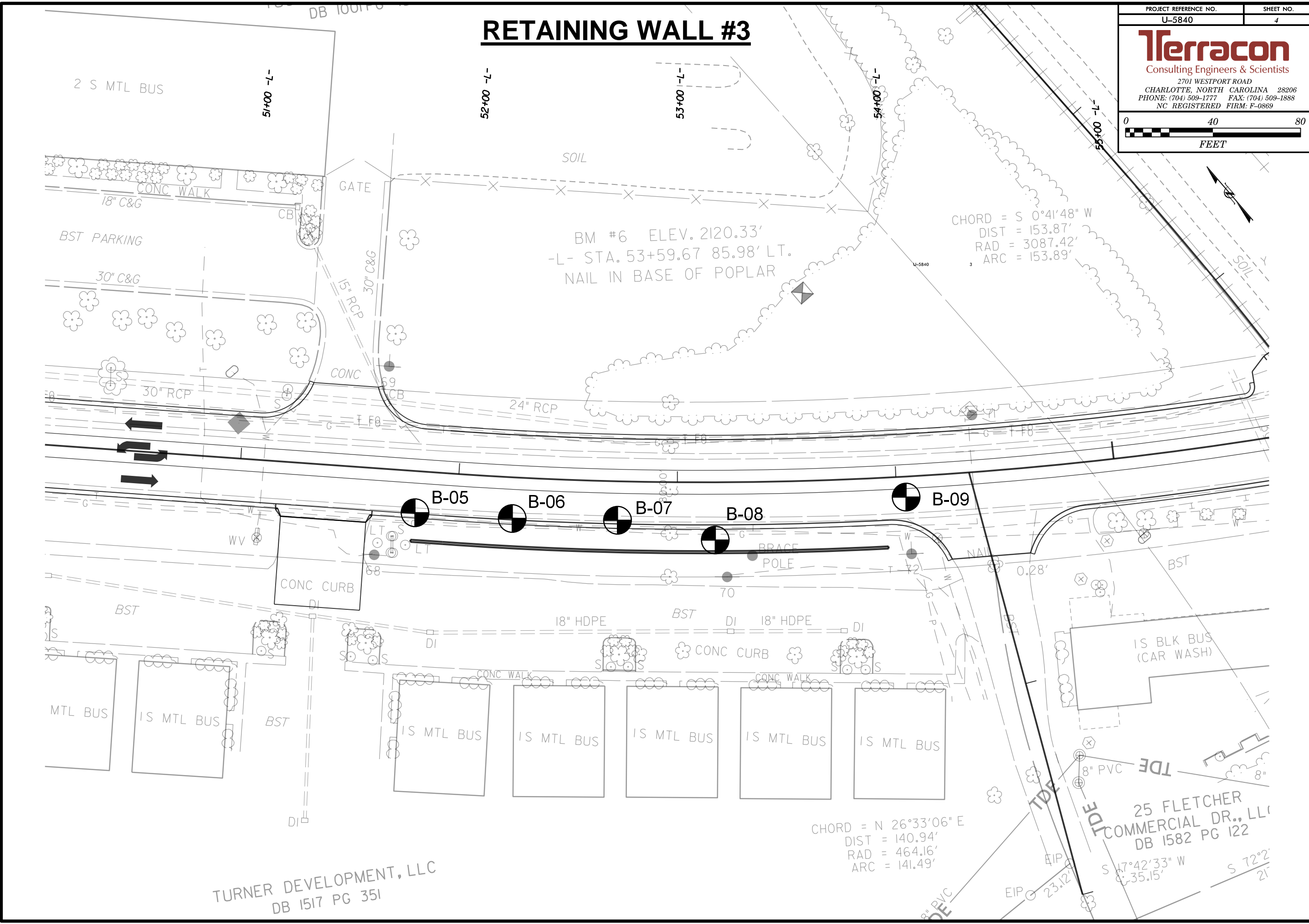

BM #6 ELEV. 2120.33'
 -L- STA. 53+59.67 85.98' LT.
 NAIL IN BASE OF POPLAR

CHORD = S 0°41'48" W
 DIST = 153.87'
 RAD = 3087.42'
 ARC = 153.89'

CHORD = N 26°33'06" E
 DIST = 140.94'
 RAD = 464.16'
 ARC = 141.49'

TURNER DEVELOPMENT, LLC
 DB 1517 PG 351

25 FLETCHER
 COMMERCIAL DR., LL
 DB 1582 PG 122

GEOTECHNICAL BORING REPORT

BORE LOG

WBS 50231			TIP U-5840			COUNTY HENDERSON			GEOLOGIST McCloud, P.D.							
SITE DESCRIPTION SR 1547 (Old Airport Road) from US 25 (Hendersonville Road) to SR 1551 (Mills Gap Road)									GROUND WTR (ft)							
BORING NO. B-05			STATION 10+01			OFFSET 13 ft LT			ALIGNMENT -W3-							
COLLAR ELEV. 2,121.4 ft			TOTAL DEPTH 15.0 ft			NORTHING 632,480			EASTING 959,384							
DRILL RIG/HAMMER EFF./DATE HPC8513 CME-550 81% 06/06/2016						DRILL METHOD H.S. Augers			HAMMER TYPE Automatic							
DRILLER Odom, C.J.			START DATE 05/17/17			COMP. DATE 05/17/17			SURFACE WATER DEPTH N/A							
ELEV (ft)	DRIVE ELEV (ft)	DEPTH (ft)	BLOW COUNT			BLOWS PER FOOT					SAMP. NO.	MOI	LOG	SOIL AND ROCK DESCRIPTION	DEPTH (ft)	
			0.5ft	0.5ft	0.5ft	0	25	50	75	100						
2125																
2120	2,120.4	1.0	3	5	3									GROUND SURFACE	0.0	
														3" Topsoil		
	2,117.9	3.5	2	3	3						SS-22	M		RESIDUAL		
														Medium stiff, reddish tan, SILT with sand (A-4)		
2115	2,115.4	6.0	3	6	10						SS-23	M			5.5	
														Stiff to very stiff, red with gray, SILT with sand (A-4)		
	2,112.9	8.5	6	5	7						SS-24	M				
2110											SS-25	M				
	2,107.9	13.5	5	7	8						SS-26	M			15.0	
														Boring Terminated at Elevation 2,106.4 ft in Silt with Sand		

NCDOT BORE SINGLE 71175059 - U-5840 - HENDERSON COUNTY RETAINING WALLS.GPJ NC_DOT.GDT 6/16/17

GEOTECHNICAL BORING REPORT BORE LOG

WBS 50231	TIP U-5840	COUNTY HENDERSON	GEOLOGIST McCloud, P.D.
SITE DESCRIPTION SR 1547 (Old Airport Road) from US 25 (Hendersonville Road) to SR 1551 (Mills Gap Road)			GROUND WTR (ft)
BORING NO. B-06	STATION 10+46	OFFSET 14 ft LT	ALIGNMENT -W3-
COLLAR ELEV. 2,120.5 ft	TOTAL DEPTH 15.0 ft	NORTHING 632,449	EASTING 959,416
DRILL RIG/HAMMER EFF./DATE HPC8513 CME-550 81% 06/06/2016		DRILL METHOD H.S. Augers	HAMMER TYPE Automatic
DRILLER Odom, C.J.	START DATE 05/17/17	COMP. DATE 05/17/17	SURFACE WATER DEPTH N/A

ELEV (ft)	DRIVE ELEV (ft)	DEPTH (ft)	BLOW COUNT			BLOWS PER FOOT					SAMP. NO.	MOI	LOG	SOIL AND ROCK DESCRIPTION		
			0.5ft	0.5ft	0.5ft	0	25	50	75	100				ELEV. (ft)	DEPTH (ft)	
2125																
2120	2,119.5	1.0												2,120.5	0.0	GROUND SURFACE 4" Topsoil
2115	2,117.0	3.5	2	2	7	·	·	·	·	·	SS-27	M	ROADWAY EMBANKMENT Stiff, reddish tan and gray, SILT with sand (A-4)	2,115.0	5.5	RESIDUAL Medium stiff to stiff, red, tan, and gray, SILT with sand (A-4)
	2,114.5	6.0	3	2	5	·	·	·	·	·	SS-28	M				
	2,112.0	8.5	5	7	7	·	·	·	·	·	SS-29	M				
	2,107.0	13.5	4	6	8	·	·	·	·	·	SS-30	M				
2110													Boring Terminated at Elevation 2,105.5 ft in Silt with Sand			
	2,107.0	13.5	3	5	5	·	·	·	·	·	SS-31	M		2,105.5	15.0	

NCDOT BORE SINGLE 71175069 - U-5840 - HENDERSON COUNTY RETAINING WALLS.GPJ NC_DOT.GDT 6/16/17

GEOTECHNICAL BORING REPORT

BORE LOG

WBS 50231			TIP U-5840			COUNTY HENDERSON			GEOLOGIST McCloud, P.D.							
SITE DESCRIPTION SR 1547 (Old Airport Road) from US 25 (Hendersonville Road) to SR 1551 (Mills Gap Road)									GROUND WTR (ft)							
BORING NO. B-07			STATION 10+95			OFFSET 15 ft LT			ALIGNMENT -W3-							
COLLAR ELEV. 2,119.6 ft			TOTAL DEPTH 15.0 ft			NORTHING 632,417			EASTING 959,452							
DRILL RIG/HAMMER EFF./DATE HPC8513 CME-550 81% 06/06/2016						DRILL METHOD H.S. Augers			HAMMER TYPE Automatic							
DRILLER Odom, C.J.			START DATE 05/17/17			COMP. DATE 05/17/17			SURFACE WATER DEPTH N/A							
ELEV (ft)	DRIVE ELEV (ft)	DEPTH (ft)	BLOW COUNT			BLOWS PER FOOT					SAMP. NO.	MOI	LOG	SOIL AND ROCK DESCRIPTION	DEPTH (ft)	
			0.5ft	0.5ft	0.5ft	0	25	50	75	100						
2120																
	2,118.6	1.0	2	4	5											
	2,116.1	3.5	3	4	5											
	2,113.6	6.0	3	4	7											
	2,111.1	8.5	8	13	16											
	2,106.1	13.5	9	15	24											
2105																

NCDOT BORE SINGLE 71175069 - U-5840 - HENDERSON COUNTY RETAINING WALLS.GPJ NC_DOT.GDT 6/16/17

GEOTECHNICAL BORING REPORT

BORE LOG

WBS 50231	TIP U-5840	COUNTY HENDERSON	GEOLOGIST McCloud, P.D.
SITE DESCRIPTION SR 1547 (Old Airport Road) from US 25 (Hendersonville Road) to SR 1551 (Mills Gap Road)			GROUND WTR (ft)
BORING NO. B-08	STATION 11+40	OFFSET 6 ft LT	ALIGNMENT -W3-
0 HR. Dry			24 HR. FIAD
COLLAR ELEV. 2,117.9 ft	TOTAL DEPTH 15.0 ft	NORTHING 632,381	EASTING 959,480
DRILL RIG/HAMMER EFF./DATE HPC8513 CME-550 81% 06/06/2016		DRILL METHOD H.S. Augers	HAMMER TYPE Automatic
DRILLER Odom, C.J.	START DATE 05/17/17	COMP. DATE 05/17/17	SURFACE WATER DEPTH N/A

ELEV (ft)	DRIVE ELEV (ft)	DEPTH (ft)	BLOW COUNT			BLOWS PER FOOT					SAMP. NO.	MOI	LOG	SOIL AND ROCK DESCRIPTION	DEPTH (ft)	
			0.5ft	0.5ft	0.5ft	0	25	50	75	100						
2120																
	2,116.9	1.0	3	4	5									GROUND SURFACE	0.0	
2115	2,114.4	3.5	4	5	5						SS-37	M		4" Topsoil		
	2,111.9	6.0	6	6	6						SS-38	M		RESIDUAL		
	2,109.4	8.5	3	5	7						SS-39	M		Stiff, tan, SILT with sand (A-4)		
2110	2,109.4	8.5	3	5	7						SS-40	M		Stiff to very stiff, reddish tan, SILT with sand (A-4)	8.0	
2105	2,104.4	13.5	6	5	12						SS-41	M			15.0	
														Boring Terminated at Elevation 2,102.9 ft in Silt with Sand		

NCDOT BORE SINGLE 71175069 - U-5840 - HENDERSON COUNTY RETAINING WALLS.GPJ NC_DOT.GDT 6/16/17

GEOTECHNICAL BORING REPORT

BORE LOG

WBS 50231		TIP U-5840		COUNTY HENDERSON		GEOLOGIST McCloud, P.D.											
SITE DESCRIPTION SR 1547 (Old Airport Road) from US 25 (Hendersonville Road) to SR 1551 (Mills Gap Road)							GROUND WTR (ft)										
BORING NO. B-09		STATION 54+04		OFFSET 9 ft RT		ALIGNMENT -L-											
COLLAR ELEV. 2,117.1 ft		TOTAL DEPTH 15.0 ft		NORTHING 632,339		EASTING 959,559											
DRILL RIG/HAMMER EFF./DATE HPC8513 CME-550 81% 06/06/2016				DRILL METHOD H.S. Augers		HAMMER TYPE Automatic											
DRILLER Odom, C.J.		START DATE 05/17/17		COMP. DATE 05/17/17		SURFACE WATER DEPTH N/A											
ELEV (ft)	DRIVE ELEV (ft)	DEPTH (ft)	BLOW COUNT			BLOWS PER FOOT					SAMP. NO.	MOI	LOG	SOIL AND ROCK DESCRIPTION	DEPTH (ft)		
			0.5ft	0.5ft	0.5ft	0	25	50	75	100							
2120																	
	2,116.1	1.0													2,117.1	GROUND SURFACE	0.0
2115			5	9	7										2,116.0	8" Asphalt over 6" Stone Base	1.1
	2,113.6	3.5	3	4	4											ROADWAY EMBANKMENT	
	2,111.1	6.0	2	4	4											Medium stiff to very stiff, reddish tan and gray, SILT with sand (A-4)	
2110			2	4	4												
	2,108.6	8.5	3	2	3												
2105															2,105.1		12.0
	2,103.6	13.5	6	9	11											RESIDUAL	
															2,102.1	Stiff to very stiff, reddish tan, SILT with sand (A-4)	15.0
																Boring Terminated at Elevation 2,102.1 ft in Silt with Sand	

NCDOT BORE SINGLE 71175059 - U-5840 - HENDERSON COUNTY RETAINING WALLS.GPJ NC_DOT.GDT 6/16/17

STRUCTURE RECOMMENDATIONS

W.B.S. NO. 50231 DESCRIPTION Mechanically Stabilized Earth Retaining Wall #4
T.I.P. NO. U-5840
COUNTY Henderson
STATION 10+00.00 to 11+27.67
-W4-

	INITIALS	DATE
DESIGN	PDM	3/9/2018
CHECKED	DJC	3/9/2018
FINAL	DJC	3/9/2018



COMMENTS & NOTES

Note on Plans:

1. FOR MECHANICALLY STABILIZED EARTH (MSE) RETAINING WALLS, SEE MECHANICALLY STABILIZED EARTH RETAINING WALLS PROVISION.
2. USE AN MSE WALL SYSTEM WITH SEGMENTAL RETAINING WALL (SRW) UNITS THAT MEET ARTICLE 1040-4 OF THE STANDARD SPECIFICATIONS FOR RETAINING WALL NO. 4.
3. WHEN USING AN MSE WALL SYSTEM WITH SRW UNITS FOR RETAINING WALL NO. 4, FREEZE-THAW DURABLE SRW UNITS THAT MEET ARTICLE 1040-4 OF THE STANDARD SPECIFICATIONS ARE REQUIRED.
4. AT THE CONTRACTOR'S OPTION, USE FINE AGGREGATE IN THE REINFORCED ZONE OF RETAINING WALL NO. 4.
5. A SEPARATION GEOTEXTILE IS REQUIRED AT THE BACK OF THE REINFORCED ZONE FOR RETAINING WALL NO. 4.
6. A DRAIN IS REQUIRED FOR RETAINING WALL NO. 4.
7. DESIGN RETAINING WALL NO. 4 FOR THE FOLLOWING:
 - 1) $H = \text{DESIGN HEIGHT} + \text{EMBEDMENT}$.
 - 2) DESIGN LIFE = 75 YEARS
 - 3) MAXIMUM FACTORED VERTICAL PRESSURE ON FOUNDATION MATERIAL = 2,000 PSF. THIS ASSUMES ANY FILL OR SOFT SOILS, IF ENCOUNTERED, WILL BE UNDERCUT AND REPLACED.
 - 4) MINIMUM REINFORCEMENT LENGTH (L) = $0.9 \times H$ OR 6 FT, WHICHEVER IS LONGER

STRUCTURE RECOMMENDATION NOTES ON PLANS AND COMMENTS

PROJECT No.: U-5840 WALL NO: 4 COUNTY: Henderson
STATION: 10+00.00 to 11+27.67 -W4- DESCRIPTION: SR1547 FROM US 25 TO SR1551

5) REINFORCED ZONE AGGREGATE PARAMETERS:

AGGREGATE TYPE*	UNIT WEIGHT (γ) PCF	FRICTION ANGLE (Φ) DEGREES	COHESION (c) PSF
COURSE	110	38	0
FINE	115	34	0

*SEE MSE RETAINING WALLS PROVISION FOR COARSE AND FINE AGGREGATE MATERIAL REQUIREMENTS.

7) IN-SITU ASSUMED MATERIAL PARAMETERS:

MATERIAL TYPE	UNIT WEIGHT (γ) PCF	FRICTION ANGLE (Φ) DEGREES	COHESION (c) PSF
BACKFILL	120	30	0
FOUNDATION	110	26	0

8. DESIGN RETAINING WALL NO. 4 FOR A LIVE LOAD (TRAFFIC) SURCHARGE.
9. DO NOT PLACE LEVELING PAD CONCRETE, AGGREGATE OR REINFORCEMENT FOR RETAINING WALL NO. 4 UNTIL EXCAVATION DIMENSIONS AND FOUNDATION MATERIAL ARE APPROVED.
10. IGNORE PASSIVE EARTH PRESSURES IN THE UPPER 18 INCHES.

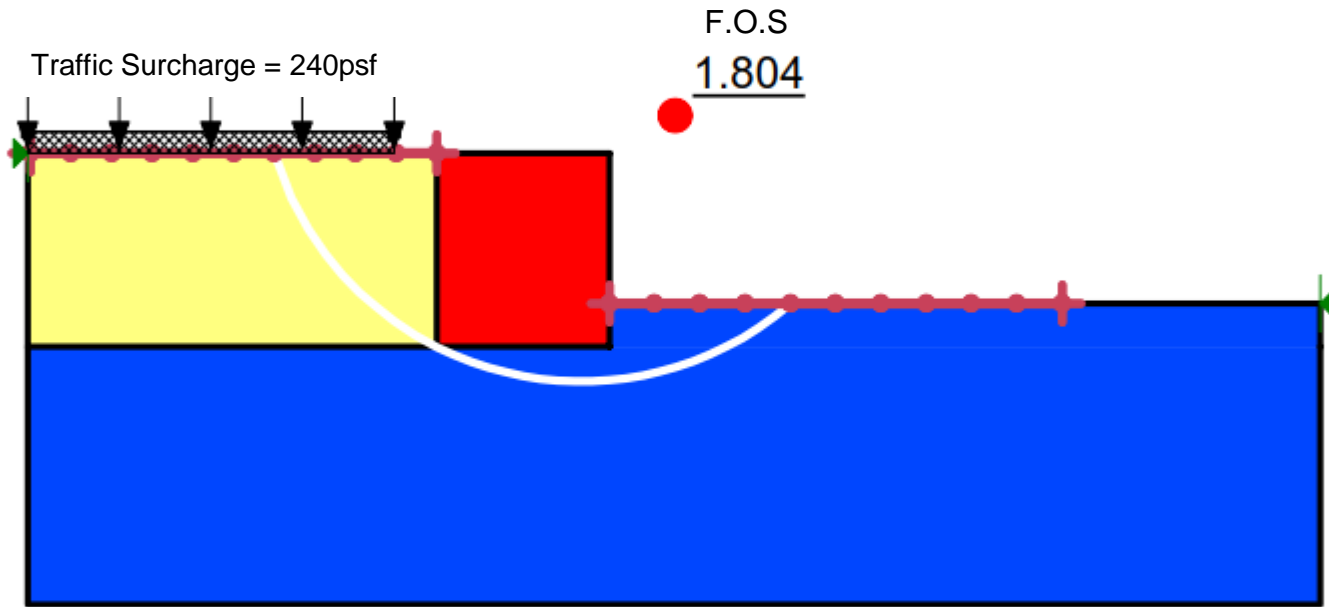

LEGEND:

- = Backfill Soil ($\gamma=120$ pcf, $\Phi=30^\circ$, $c=0$)
- = Foundation Soil ($\gamma=110$ pcf, $\Phi=26^\circ$, $c=0$)

Project Manager: PDM	Project No. 71175059
Drawn by: PDM	Scale: AS SHOWN
Checked by: DJC	File Name: Wall 4
Approved by: DJC	Date: MARCH 2018

Terracon
2701 Westport Road
Charlotte, NC 28208

GLOBAL STABILITY ANALYSIS

Mechanically Stabilized Earth Retaining Wall #4
State Project No. U-5840
Henderson County, North Carolina

Page
3

RETAINING WALL #4

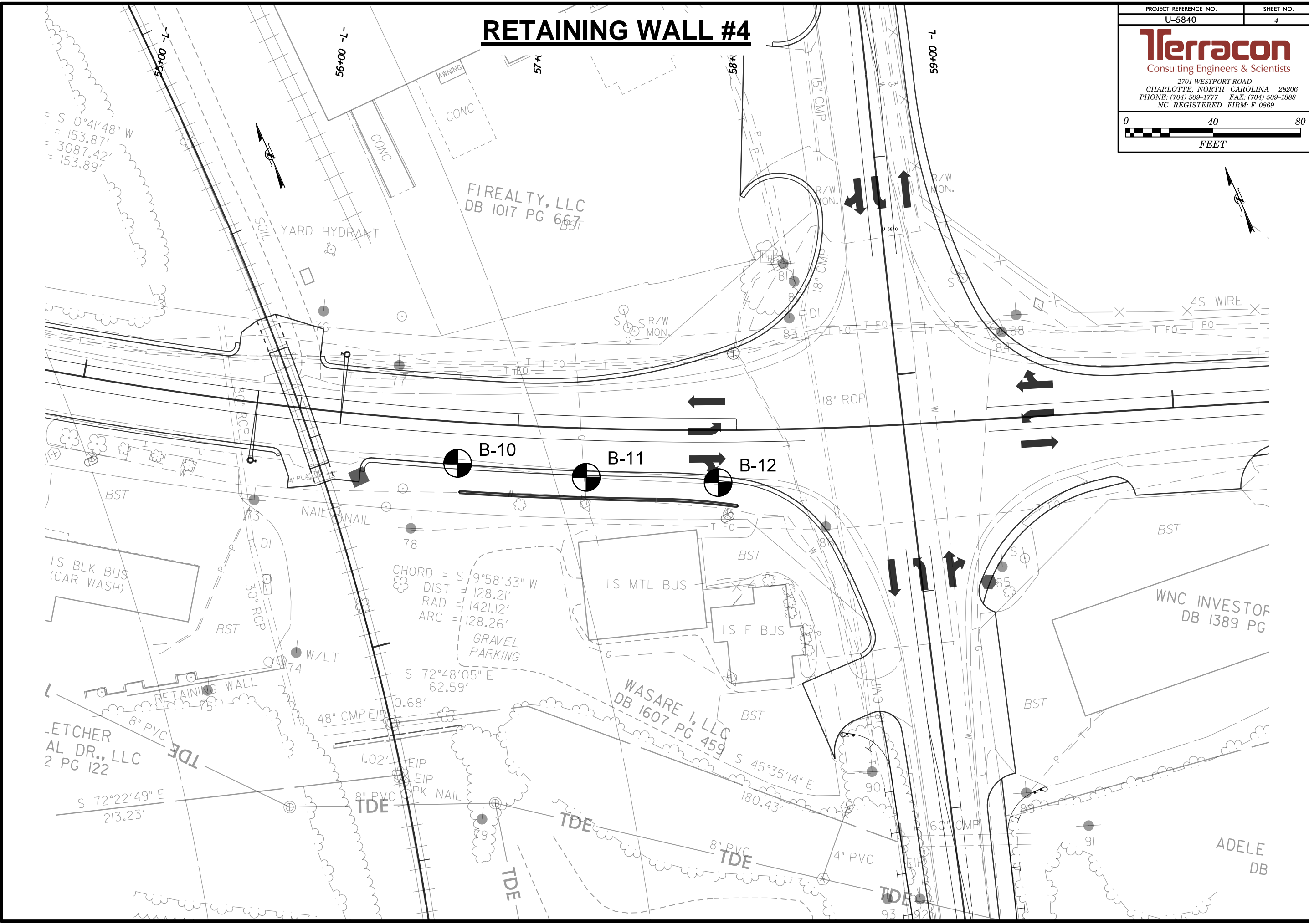

GEOTECHNICAL BORING REPORT

BORE LOG

WBS 50231			TIP U-5840			COUNTY HENDERSON			GEOLOGIST McCloud, P.D.							
SITE DESCRIPTION SR 1547 (Old Airport Road) from US 25 (Hendersonville Road) to SR 1551 (Mills Gap Road)										GROUND WTR (ft)						
BORING NO. B-10			STATION 56+74			OFFSET 19 ft RT			ALIGNMENT -L-							
COLLAR ELEV. 2,106.5 ft			TOTAL DEPTH 20.0 ft			NORTHING 632,184			EASTING 959,782							
DRILL RIG/HAMMER EFF./DATE HPC8513 CME-550 81% 06/06/2016						DRILL METHOD H.S. Augers			HAMMER TYPE Automatic							
DRILLER Odom, C.J.			START DATE 05/17/17			COMP. DATE 05/17/17			SURFACE WATER DEPTH N/A							
ELEV (ft)	DRIVE ELEV (ft)	DEPTH (ft)	BLOW COUNT			BLOWS PER FOOT					SAMP. NO.	MOI	LOG	SOIL AND ROCK DESCRIPTION	DEPTH (ft)	
			0.5ft	0.5ft	0.5ft	0	25	50	75	100						ELEV. (ft)
2110																
2105	2,105.5	1.0	1	1	2	3								2,106.5	GROUND SURFACE	0.0
														2,106.1	5" Topsoil	0.2
	2,103.0	3.5	2	3	5						SS-47	M			ROADWAY EMBANKMENT Soft to medium stiff, red and tan, SILT with sand (A-4)	
	2,100.5	6.0	3	3	5						SS-48	M		2,101.0		
2100	2,098.0	8.5	2	3	3						SS-49	M			Medium stiff, tan to tan, red, and gray, SILT with sand (A-4)	
	2,098.0	8.5	2	3	3						SS-50	M				
2095	2,093.0	13.5	3	3	4									2,094.5	RESIDUAL	12.0
	2,093.0	13.5	3	3	4						SS-51	M			Medium stiff to stiff, tan, SILT with sand (A-4)	
2090	2,088.0	18.5	2	5	7									2,086.5		20.0
											SS-52	M			Boring Terminated at Elevation 2,086.5 ft in Silt with Sand	

GEOTECHNICAL BORING REPORT BORE LOG

WBS 50231	TIP U-5840	COUNTY HENDERSON	GEOLOGIST McCloud, P.D.
SITE DESCRIPTION SR 1547 (Old Airport Road) from US 25 (Hendersonville Road) to SR 1551 (Mills Gap Road)			GROUND WTR (ft)
BORING NO. B-11	STATION 10+58	OFFSET 10 ft LT	ALIGNMENT -W4-
COLLAR ELEV. 2,101.9 ft	TOTAL DEPTH 20.0 ft	NORTHING 632,154	EASTING 959,833
DRILL RIG/HAMMER EFF./DATE HPC8513 CME-550 81% 06/06/2016		DRILL METHOD H.S. Augers	HAMMER TYPE Automatic
DRILLER Odom, C.J.	START DATE 05/17/17	COMP. DATE 05/17/17	SURFACE WATER DEPTH N/A

ELEV (ft)	DRIVE ELEV (ft)	DEPTH (ft)	BLOW COUNT			BLOWS PER FOOT					SAMP. NO.	MOI	LOG	SOIL AND ROCK DESCRIPTION	DEPTH (ft)	
			0.5ft	0.5ft	0.5ft	0	25	50	75	100						
2105																
2100	2,100.9	1.0														
	2,098.4	3.5	2	1	3											
	2,095.9	6.0	2	2	3											
2095	2,095.9	6.0	3	5	6											
	2,093.4	8.5	2	1	1											
2090																
	2,088.4	13.5	2	2	4											
2085																
	2,083.4	18.5	2	5	5											

	GROUND SURFACE	2,101.9				0.0
	4" Topsoil					
	ROADWAY EMBANKMENT					
	Medium stiff, reddish tan to reddish tan and brown, CLAY with sand (A-5 (6))					
		2,095.9				6.0
	RESIDUAL					
	Very soft to stiff, gray and tan, SILT with sand (A-4)					
		2,089.9				12.0
	Medium stiff to stiff, tan, brown, and gray, SILT with sand (A-4)					
		2,081.9				20.0
	Boring Terminated at Elevation 2,081.9 ft in Silt with Sand					

NCDOT BORE SINGLE 71175069 - U-5840 - HENDERSON COUNTY RETAINING WALLS.GPJ NC_DOT.GDT 6/16/17

GEOTECHNICAL BORING REPORT

BORE LOG

WBS 50231		TIP U-5840		COUNTY HENDERSON		GEOLOGIST McCloud, P.D.										
SITE DESCRIPTION SR 1547 (Old Airport Road) from US 25 (Hendersonville Road) to SR 1551 (Mills Gap Road)							GROUND WTR (ft)									
BORING NO. B-12		STATION 11+18		OFFSET 10 ft LT		ALIGNMENT -W4-										
COLLAR ELEV. 2,098.4 ft		TOTAL DEPTH 15.0 ft		NORTHING 632,127		EASTING 959,887										
DRILL RIG/HAMMER EFF./DATE HPC8513 CME-550 81% 06/06/2016		DRILL METHOD H.S. Augers		HAMMER TYPE Automatic		0 HR. Dry										
DRILLER Odom, C.J.		START DATE 05/17/17		COMP. DATE 05/17/17		24 HR. FIAD										
SURFACE WATER DEPTH N/A																
ELEV (ft)	DRIVE ELEV (ft)	DEPTH (ft)	BLOW COUNT			BLOWS PER FOOT					SAMP. NO.	MOI	LOG	SOIL AND ROCK DESCRIPTION	DEPTH (ft)	
			0.5ft	0.5ft	0.5ft	0	25	50	75	100						
2100																
	2,097.4	1.0														
2095	2,094.9	3.5	2	2	1	3						SS-59	M			
	2,092.4	6.0	2	2	3							SS-60	M			
2090	2,089.9	8.5	2	3	4							SS-61	M			
	2,089.9		7	11	16							SS-62	M			
2085	2,084.9	13.5	8	11	11							SS-63	M			

NCDOT BORE SINGLE 71175059 - U-5840 - HENDERSON COUNTY RETAINING WALLS.GPJ NC_DOT.GDT 6/16/17

