

**2020 DIVISION
MICROSURFACING**

5/14/20

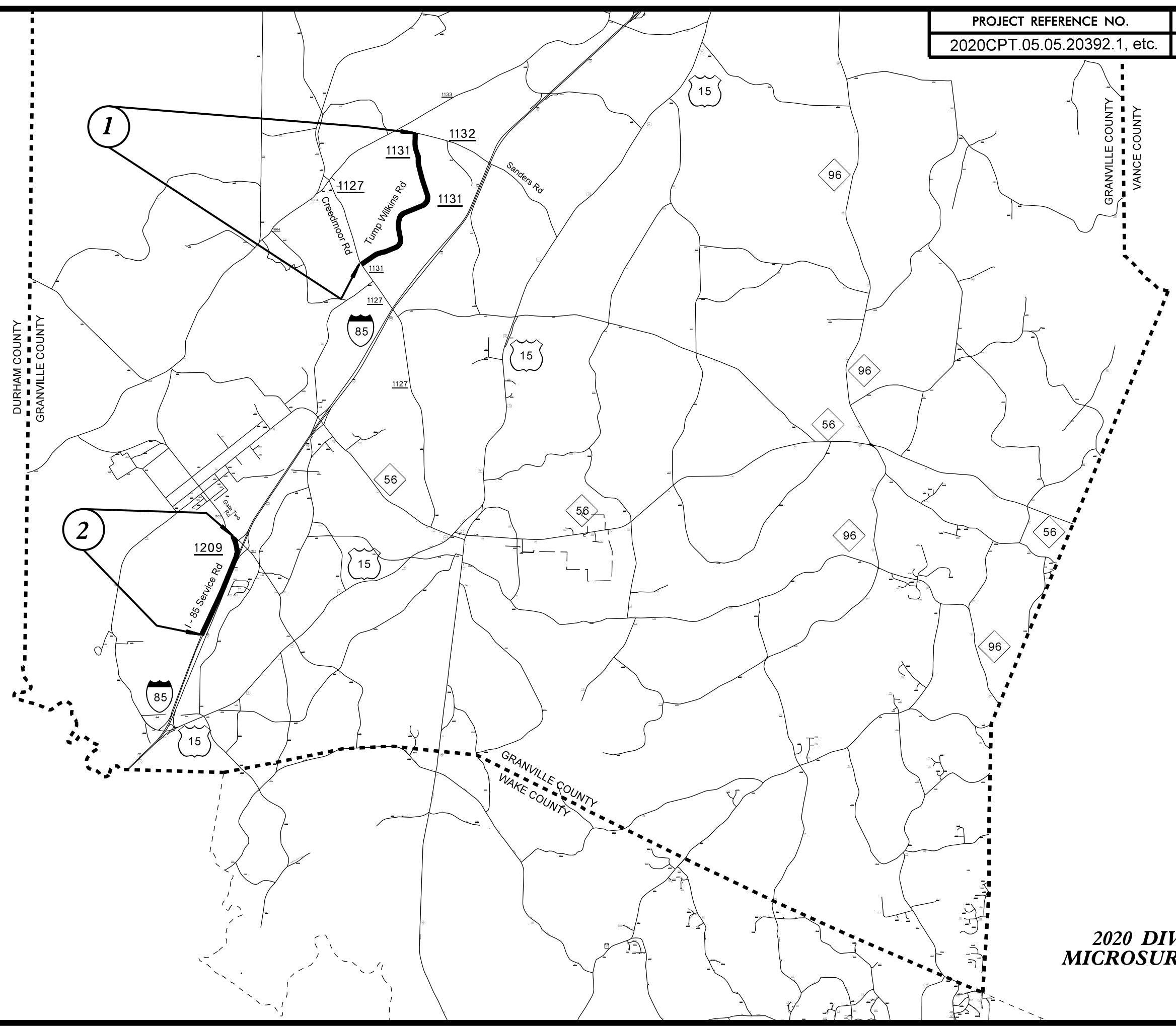

**2020 DIVISION
MICROSURFACING**

5/14/20 11:58 AM C:\Users\jgibson\OneDrive\Documents\2020CPT\05\05\20392\1\2020CPT.05.05.20392.1_SHEET 2.dwg

PAVEMENT SCHEDULE

PROJECT REFERENCE NO.

SHEET NO.

2020CPT.05.05.20392.1, etc.

4

C

PROP. LATEX MODIFIED MICRO-SURFACING, TYPE III
AT AN AVERAGE RATE OF 22 TO 26 LBS. PER SQ. YD.

U

EXISTING PAVEMENT

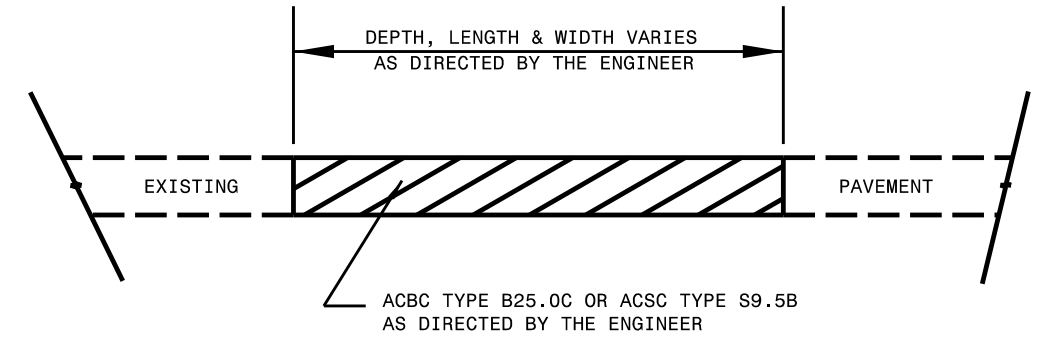

PATCHING EXISTING PAVEMENT

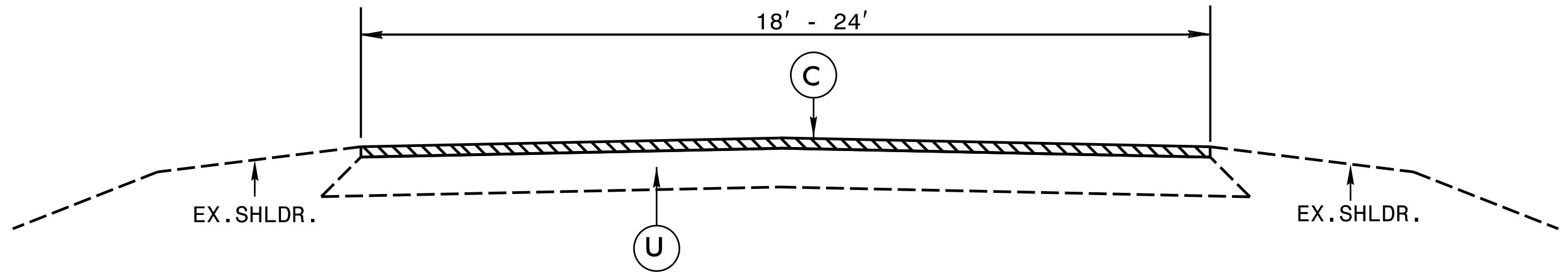

TYPICAL SECTION NO.1

PROJECT NO.	SHEET NO.
2020CPT.05.05.20392.1, etc.	5

SUMMARY OF QUANTITIES

PROJECT NO	COUNTY	MAP NO	ROUTE	DESCRIPTION	TYP NO	LANES	FINAL SURFACE TESTING REQUIRED	WARM MIX ASPHALT REQUIRED	LENGTH	WIDTH	PATCHING EXISTING PAVEMENT	LATEX MODIFIED MICROSURFACING, TYPE III
									MI	FT	TONS	SY
2020CPT.05.05.20392.1	Granville	1	SR 1131 - TUMP WILKINS RD	SR 1132 - SANDERS RD TO SR 1127 - CREEDMOOR ROAD	1	2	NO	NO	2.620	20	100	30,741
		2	SR 1209 I-85 SERVICE RD	SR 1103 - GATE TWO RD TO END OF MAINT	1	2	NO	NO	1.610	20	500	18,891
		3	SR 1422 - WATKINS-WILKINSON RD	SR 1462 - WARRIOR RD TO NC 96	1	2	NO	NO	1.660	20	20	19,477
		4	SR 1452 - GREENWAY RD	SR 1300 - CORNWALL RD TO DEAD END	1	2	NO	NO	1.030	20	350	12,085
		5	SR 1453 - WEBB SCHOOL RD	SR 1422 - WATKINS-WILKINSON TO US 15	1	2	NO	NO	0.810	23	10	10,930
		6	SR 1462 -WARRIOR RD/WATKINS-WILKINSON RD	US 158 BYP TO US 15	1	2	NO	NO	1.130	24	275	15,910
		7	SR 1463 - BENT TREE DR	SR 1452 - GREENWAY RD TO CUL-DE-SAC	1	2	NO	NO	0.290	18	50	3,062
		8	SR 1464 - LEANING OAK DR	END OF MAINT TO END OF MAINT	1	2	NO	NO	0.380	18	50	4,013
		9	SR 1510 - DEXTER RD	SR 1430- ROCKWELL RD TO SR 1514 - CHEWNING RD	1	2	NO	NO	2.800	20	50	32,853
TOTAL FOR PROJ NO. 2020CPT.05.05.20392.1									12.330		1,405	147,962
2020CPT.05.05.20922.1	Wake	10	SR 1831 - OLD CREEDMOOR RD	900' NORTH OF NC 98 TO NC 50	1	2	NO	NO	1.150	21	62	14,168
		11	SR 1931 - HARRIS RD	1585' EAST OF US 1 TO SR 1932 - WALL RD	1	2	NO	NO	0.551	20	32	6,465
		12	SR 1932 - WALL RD	FRANKLIN CO TO SR 1931 - HARRIS RD	1	2	NO	NO	0.960	20	40	11,264
		13	SR 2300 - PULLEY TOWN RD	SR 2308 - FOWLER RD TO US 401 - N MAIN ST SKIPPING INTERSECTIONS WITH US 401 -LOUISBURG RD AND SR 2224 - MITCHELL MILL RD	1	2	NO	NO	5.530	20	84	64,865
		14	SR 2305 - QUARRY RD	2000' EAST OF SR 1003 - ROLESVILLE RD TO SR 2224 - MITCHELL MILL RD	1	2	NO	NO	2.363	20	18	27,727
		15	SR 2321 - RILEY HILL SCHOOL RD/DAVISTOWN RD	SR 1003 - ROLESVILLE RD TO SR 2320 -RILEY HILL RD	1	2	NO	NO	2.030	20	30	23,823
		16	SR 2322 - DAVISTOWN RD	SR 2321 - RILEY HILL SCHOOL RD TO SR 1003 - ROLESVILLE RD	1	2	NO	NO	2.110	20	48	24,758
		17	SR 2923 - TODD RD	SR 2234 - MARKS CREEK RD TO SR 1003 - ROLESVILLE RD	1	2	NO	NO	0.280	20	30	3,285
TOTAL FOR PROJ NO. 2020CPT.05.05.20922.1									14.974		344	176,355
GRAND TOTAL									27.304		1,749	324,317

THERMOPLASTIC AND PAINT QUANTITIES

PROJECT NO	COUNTY	MAP NO	ROUTE	DESCRIPTION	TYP NO	LANES	LENGTH	WIDTH	4413000000-E	4457000000-N	4685000000-E	4686000000-E	4700000000-E	4710000000-E	4721000000-E			4725000000-E	4810000000-E			4835000000-E			4840000000-N			4845000000-N	4850000000-E	4870000000-E	4875000000-N			
									WORK ZONE ADVANCE/GENERAL WARNING SIGNING	TEMPORARY TRAFFIC CONTROL	4" X 90 M WHITE THERMO	4" X 120 M YELLOW THERMO	4" X 120 M WHITE THERMO	12" X 90 M YELLOW THERMO	24" X 120 M WHITE THERMO	THERMO MSG SCHOOL 120 M	THERMO MSG STOP 120 M	THERMO MSG AHEAD 120 M	THERMO LT ARROW 90 M	4" WHITE PAINT	4" YELLOW PAINT	24" WHITE PAINT	PAINT MSG SCHOOL	PAINT MSG STOP	PAINT MSG AHEAD	PAINT LT ARROW	4" LINE REMOVAL	24" LINE REMOVAL	REML OF PVMT MRKG SYMBOLS & CHARACTERS					
									SF	LS	LF	LF	LF	LF	EA	EA	EA	EA	LF	LF	LF	EA	EA	EA	EA	EA	EA	EA	EA					
2020CPT.05.05.20392.1	Granville	1	SR 1131 - TUMP WILKINS RD	SR 1132 - SANDERS RD TO SR 1127 - CREEDMOOR ROAD	1	2	2.620	20	293			28,191	27,668	40						28,191	27,668									55,859				
		2	SR 1209 I-85 SERVICE RD	SR 1103 - GATE TWO RD TO END OF MAINT	1	2	1.610	20	126			17,200	17,002	31						17,002	17,324									34,326				
		3	SR 1422 - WATKINS-WILKINSON RD	SR 1462 - WARRIOR RD TO NC 96	1	2	1.660	20	186			17,579	17,380	71		100	12			17,862	17,862	600	12							35,242	100			
		4	SR 1452 - GREENWAY RD	SR 1300 - CORNWALL RD TO DEAD END	1	2	1.030	20	115			10,950	10,876	33						11,083	10,876									21,959				
		5	SR 1453 - WEBB SCHOOL RD	SR 1422 - WATKINS-WILKINSON TO US 15	1	2	0.810	23	90		*	8,348	8,554	92		150	18			8,716	8,554	150	18	145						34,540	150			
		6	SR 1462 - WARRIOR RD/WATKINS-WILKINSON RD	US 158 BYP TO US 15	1	2	1.130	24	127			11,865	11,932	73						12,159	11,932									48,182				
		7	SR 1463 - BENT TREE DR	SR 1452 - GREENWAY RD TO CUL-DE-SAC	1	2	0.290	18	32																									
		8	SR 1464 - LEANING OAK DR	END OF MAINT TO END OF MAINT	1	2	0.380	18	42																									
		9	SR 1510 - DEXTER RD	SR 1430- ROCKWELL RD TO SR 1514 - CHEWNING RD	1	2	2.800	20	313			30,007	29,568	30							30,128	29,568									59,696			
TOTAL FOR PROJ NO. 2020CPT.05.05.20392.1							12.330		1,324	1	124,140	122,980	370		250	30				125,141	123,784	750	30						289,804	250				
									123,350			30			248,925			30																
2020CPT.05.05.20922.1	Wake	10	SR 1831 - OLD CREEDMOOR RD	900' NORTH OF NC 98 TO NC 50	1	2	1.150	21	129			12,374	10,858	20					12,394	10,858									23,252					
		11	SR 1931 - HARRIS RD	1585' EAST OF US 1 TO SR 1932 - WALL RD	1	2	0.551	20	62			5,929	5,818	22		60	4	5		5,951	5,818		4	5					11,769	60	9			
		12	SR 1932 - WALL RD	FRANKLIN CO TO SR 1931 - HARRIS RD	1	2	0.960	20	108			9,918	10,138	103	115	13		4	5	4	10,330	10,138	13		4	5	4		2,860	13	13			
		13	SR 2300 - PULLEY TOWN RD	SR 2308 - FOWLER RD TO US 401 - N MAIN ST SKIPPING INTERSECTIONS WITH US 401 - LOUISBURG RD AND SR 2224 - MITCHELL MILL RD	1	2	5.530	20	620		*	59,503	48,645	92							59,595	48,645								108,240				
		14	SR 2305 - QUARRY RD	2000' EAST OF SR 1003 - ROLESVILLE RD TO SR 2224 - MITCHELL MILL RD	1	2	2.363	20	265			25,426	22,595	55		50	6				25,481	22,595	50	6						48,076	50	6		
		15	SR 2321 - RILEY HILL SCHOOL RD/DAVISTOWN RD	SR 1003 - ROLESVILLE RD TO SR 2320 - RILEY HILL RD	1	2	2.030	20	228			21,843	21,162	58							21,901	21,162								43,063				
		16	SR 2322 - DAVISTOWN RD	SR 2321 - RILEY HILL SCHOOL RD TO SR 1003 - ROLESVILLE RD	1	2	2.110	20	237			22,704	22,074	62							18,400	22,074								44,840				
		17	SR 2923 - TODD RD	SR 2234 - MARKS CREEK RD TO SR 1003 - ROLESVILLE RD	1	2	0.280	20	31			2,867	2,956	37		100	12				3,013	2,956	100	12						100	12			
TOTAL FOR PROJ NO. 2020CPT.05.05.20922.1							14.974		1,680	1	160,564	144,246	449	115	223	18	8	10	4	157,065	144,246	163	18	8	10	4		282,100	223	40				
									144,695			36			301,311			36																
GRAND TOTAL							27.304		3,004	1	284,704	267,226	819	115	473	48	8	10	4	282,206	268,030	913	48	8	10	4		571,904	473	40				
									268,045			66			550,236			66																

SIGNING FOR ASPHALT SURFACE TREATMENT

LEGEND

- ◻ PORTABLE SIGN
- └ STATIONARY SIGN
- ← DIRECTION OF TRAFFIC FLOW

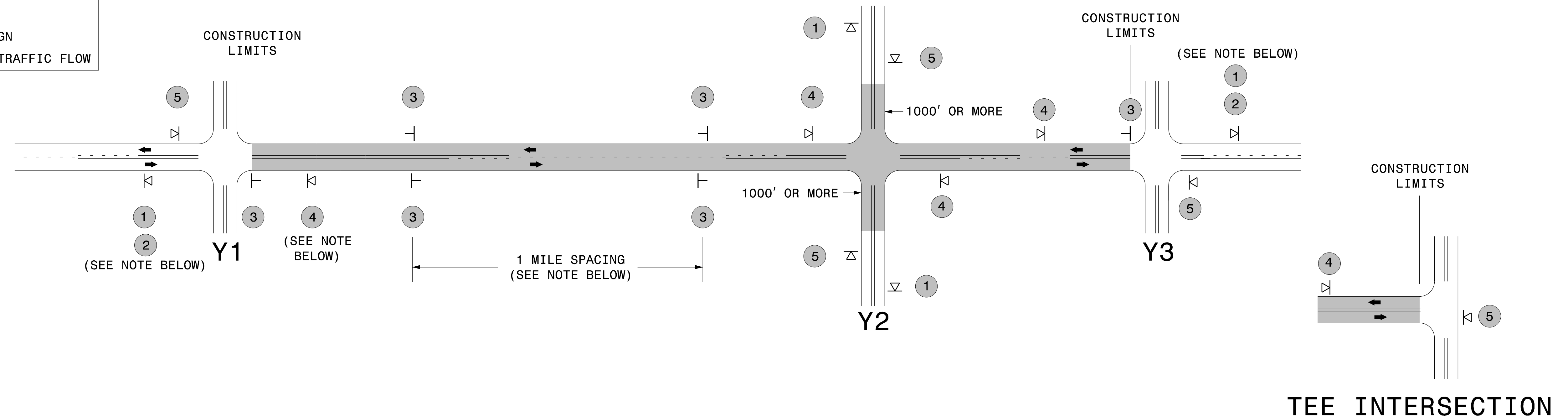

MAINLINE (-L-) SIGNING

-Y- LINE SIGNING

SIGNING NOTES AND PLACEMENT PER DIRECTION	1	 	<ul style="list-style-type: none"> - PLACE 1000' PRIOR TO BEGINNING OF CONSTRUCTION LIMITS. ONLY USED ON -Y- LINES IF RESURFACING LIMITS EXTEND 1000' ALONG -Y- LINE. - SIGN #2 ONLY USED WHEN RESURFACING LIMITS ARE 2 OR MORE MILES IN LENGTH. ROUND UP TO THE NEAREST WHOLE NUMBER. DO NOT USE FRACTIONAL OR DECIMAL NUMBERS. 	<p>STATIONARY SIGNING NOT REQUIRED FOR THE FOLLOWING -Y- LINE CONDITIONS:</p> <ol style="list-style-type: none"> 1) LESS THAN 1000' OF RESURFACING ALONG -Y- LINE 2) SUBDIVISION ROADS 3) DEAD END ROADS <p>WHEN PAVING/CONSTRUCTION ACTIVITIES PROCEED ACROSS AN UNSIGNED -Y- LINE, PORTABLE ADVANCE WARNING SIGNS SHALL BE USED ALONG THE -Y- LINE AS SHOWN BELOW. REMOVE UPON COMPLETION OF WORK.</p> <div style="display: flex; justify-content: space-around; align-items: center;"> <div style="text-align: center;"> <small>W20-1 48" X 48"</small> PLACED 500' IN ADVANCE OF FLAGGER. </div> <div style="text-align: center;"> <small>W20-7 A 48" X 48"</small> PLACED 250' IN ADVANCE OF FLAGGER. </div> </div>
	3	 	<ul style="list-style-type: none"> - ALTERNATE THE FOLLOWING TWO SIGNS: - STARTING WITH "LOOSE GRAVEL" (W8-7) FOLLOWED BY "UNMARKED PAVEMENT". - PLACE INITIALLY AT THE CONSTRUCTION LIMITS AND SPACED 1 MILE APART THEREAFTER. - AT TEE INTERSECTIONS INSTALL INITIALLY 0.5 MILE FROM INTERSECTION AND SPACE 1 MILE APART THEREAFTER. 	
	4		<ul style="list-style-type: none"> - THESE ARE FOR -Y- LINES THAT ARE "THROUGH" ROADWAYS. DEAD END AND SUBDIVISION ROADS ARE NOT "THROUGH" ROADWAYS. - INSTALL 500' +/- FROM EACH -Y- LINE APPROACH AS SHOWN ABOVE. - FOR MULTIPLE -Y- LINES THAT ARE SEPARATED BY 0.25 MILES OR LESS, TREAT AS A SINGLE UNIT AND INSTALL WITHIN 500' OF EACH APPROACH. - A MAXIMUM OF 2 SIGN SETS PER MILE. DO NOT INSTALL WHEN -Y- LINES ARE WITHIN 0.5 MILES FROM "END ROAD WORK" SIGN. 	
	5		<ul style="list-style-type: none"> PLACE 500' FOLLOWING THE END OF CONSTRUCTION LIMITS OR AS SHOWN WHEN WORK ENDS AT A 3-WAY TEE INTERSECTION. 	
	<p>THE ABOVE SIGNS ARE ALL THAT ARE REQUIRED FOR A CONTRACTOR TO BEGIN A RESURFACING CONTRACT. ANY ADDITIONAL SIGNS REQUESTED BY NCDOT DIVISIONS SHALL BE INSTALLED WITHIN 7 BUSINESS DAYS OF THE START OF CONTRACT WORK.</p>			

MAPS LESS THAN 2 MILES

FOR AST RESURFACING MAPS WITH CONSTRUCTION LIMITS LESS THAN 2 MILES IN LENGTH, USE A STATIONARY "LOOSE GRAVEL" SIGN AT THE BEGINNING CONSTRUCTION LIMIT FOLLOWED BY AN "UNMARKED PAVEMENT" SIGN MIDWAY THROUGH AND AN "END ROAD WORK" SIGN AT THE END CONSTRUCTION LIMIT.

ADVANCE WARNING SIGNS FOR 2-LANE ROADWAY ASPHALT SURFACE TREATMENT

5/12/2017 S:\TMS\WZTC\Resurfacing\2L2W & AST Resurfacing Details\Resurfacing_AdvWarn_2Ln - AST.dgn User:kdais