

BM. #13 - BENCH TIE IN POWER POLE, 275' RT. OF -L- STA. 247+67.00, ELEV. 213.28

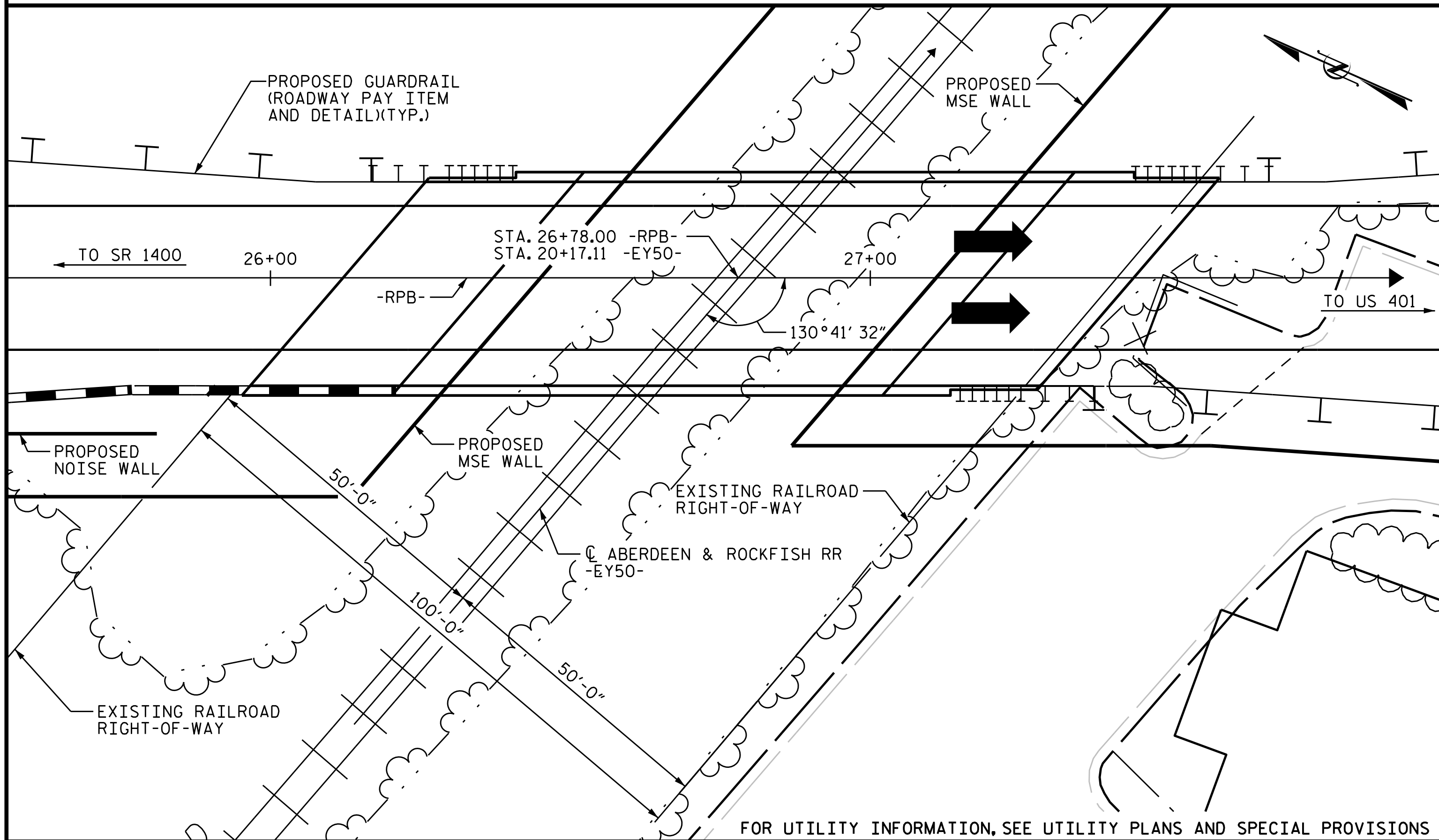

LOCATION SKETCH

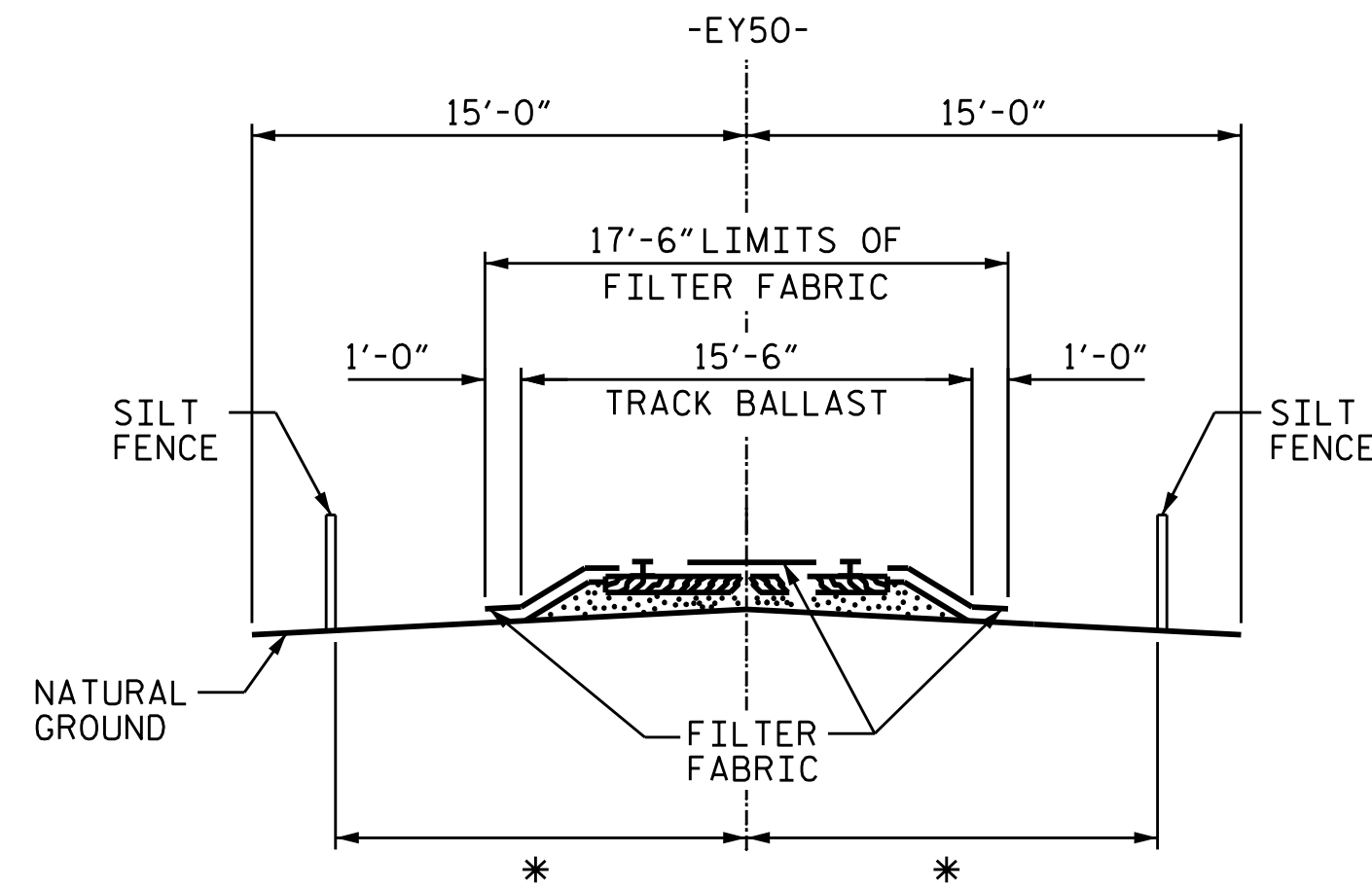

RAILROAD EROSION CONTROL DETAIL

* TO BE DETERMINED BY THE RESIDENT ENGINEER IN CONSULTATION WITH RAILROAD ENGINEER

NOTES

- RAILROAD EROSION CONTROL MEASURES SHALL BE INSTALLED PRIOR TO PERFORMING ANY WORK IN THE RAILROAD RIGHT-OF-WAY.
- ADDITIONAL EROSION CONTROL MEASURES FOR PROTECTION OF RAILROAD DITCHES MAY BE REQUIRED AS DIRECTED BY THE ENGINEER.
- NO SEPERATE PAYMENT WILL BE MADE FOR RAILROAD EROSION CONTROL MEASURES.
- LIMITS OF SILT FENCE AND FILTER FABRIC PARALLEL TO RAILROAD SHALL EXTEND A MINIMUM OF 25'-0" OUTSIDE EDGE OF SUPERSTRUCTURE OR TOE OF SLOPE ON CONSTRUCTION. A GREATER LENGTH OF SILT FENCE OR FILTER FABRIC MAY BE REQUIRED IF SO DIRECTED BY THE ENGINEER.
- FILTER FABRIC TO BE NAILED TO TIMBER RAIL TIES WITH PRIME SOURCE "GRIP CAP" OR EQUIVALENT. FILTER FABRIC ON SHOULDER TO BE SECURED AS DIRECTED BY THE ENGINEER AND RAILROAD.

TOTAL BILL OF MATERIAL

	PDA TESTING	REINFORCED CONCRETE DECK SLAB	GROOVING BRIDGE FLOORS	CLASS A CONCRETE	BRIDGE APPROACH SLABS	REINFORCING STEEL	45" PRESTRESSED CONCRETE GIRDER		HP 12 X 53 STEEL PILES		PILE REDRIVES	PILE DRIVING EQUIPMENT SETUP FOR HP 12x53 STEEL PILES	CONCRETE BARRIER RAIL	4" CONCRETE SLOPE PROTECTION	ELASTOMERIC BEARINGS	EXPANSION JOINT SEALS
	EACH	SO.FT.	SO.FT.	CU.YDS.	LUMP SUM	LBS.	NO.	LIN. FT.	NO.	LIN.FT.	EACH	EACH	LIN. FT.	SO. YDS.	LUMP SUM	LUMP SUM
SUPERSTRUCTURE		3,042	4,473		LUMP SUM		5	396.88					220.3		LUMP SUM	LUMP SUM
END BENT NO. 1				45.2		6,468			7	630.0	4	7		14		
END BENT NO. 2				44.3		6,376			7	595.0	4	7		14		
TOTAL	1	3,042	4,473	89.5	LUMP SUM	12,844	5	396.88	14	1225.0	8	14	220.3	28	LUMP SUM	LUMP SUM

NOTES:

- ASSUMED LIVE LOAD = HL-93 OR ALTERNATE LOADING.
- THIS BRIDGE HAS BEEN DESIGNED IN ACCORDANCE WITH THE AASHTO LRFD BRIDGE DESIGN SPECIFICATIONS.
- THIS BRIDGE IS LOCATED IN SEISMIC ZONE 1.
- FOR OTHER DESIGN DATA AND GENERAL NOTES, SEE SHEET SN.
- FOR SUBMITTAL OF WORKING DRAWINGS, SEE SPECIAL PROVISIONS.
- FOR FALSEWORK AND FORMWORK, SEE SPECIAL PROVISIONS.
- FOR CRANE SAFETY, SEE SPECIAL PROVISIONS.
- THE CONTRACTOR SHALL PROVIDE INDEPENDENT ASSURANCE SAMPLES OF REINFORCING STEEL AS FOLLOWS: FOR PROJECTS REQUIRING UP TO 400 TONS OF REINFORCING STEEL, ONE 30" SAMPLE OF EACH SIZE BAR USED, AND FOR PROJECTS REQUIRING OVER 400 TONS OF REINFORCING STEEL, TWO 30" SAMPLES OF EACH SIZE BAR USED. THE BARS FROM WHICH THE SAMPLES ARE TAKEN MUST BE THEN SPICED WITH REPLACEMENT BARS OF THE SIZE AND LENGTH OF THE SAMPLE, PLUS A MINIMUM LAP SPLICE OF THIRTY BAR DIAMETERS. PAYMENT FOR THE SAMPLES OF REINFORCING STEEL SHALL BE CONSIDERED INCIDENTAL TO VARIOUS PAY ITEMS.
- FOR GROUT FOR STRUCTURES, SEE SPECIAL PROVISIONS.

- REMOVABLE FORMS MAY BE USED IN LIEU OF METAL STAY-IN-PLACE FORMS IN ACCORDANCE WITH ARTICLE 420-3 OF THE STANDARD SPECIFICATIONS.
- THE RAILROAD TRACK TOP OF RAIL ELEVATIONS ON THE PLANS ARE FROM THE BEST INFORMATION AVAILABLE. PRIOR TO BEGINNING BRIDGE CONSTRUCTION, VERIFY THE TOP OF RAIL ELEVATIONS AND REPORT ANY VARIATIONS TO THE ENGINEER. ANY PLAN REVISIONS NECESSARY TO ACHIEVE THE REQUIRED MINIMUM CLEARANCE WILL BE PROVIDED BY THE DEPARTMENT.
- NEEDLE BEAMS WILL NOT BE ALLOWED UNLESS OTHERWISE CALLED FOR ON THE PLANS OR APPROVED BY THE ENGINEER.
- FOR EROSION CONTROL MEASURES, SEE EROSION CONTROL PLANS.
- PRESTRESSED CONCRETE DECK PANELS MAY BE USED IN LIEU OF METAL STAY-IN-PLACE FORMS IN ACCORDANCE WITH ARTICLE 420-3 OF THE STANDARD SPECIFICATIONS.
- IF PRESTRESSED CONCRETE DECK PANELS ARE USED, THE SKEWED END CONDITIONS ARE SUCH THAT THE USE OF 4' WIDE PRESTRESSED CONCRETE DECK PANELS ARE NOT POSSIBLE; USE OF 8' WIDE PRESTRESSED CONCRETE DECK PANELS IS NECESSARY.
- FOR PRESTRESSED CONCRETE GIRDERS, SEE SPECIAL PROVISIONS.

PROJECT NO. U-4405
CUMBERLAND COUNTY
 STATION: 26+78.00 -RPB-

SHEET 3 OF 3

KCA 4800 SIX FORKS ROAD SUITE 120
 KISINGER CAMPO & ASSOCIATES RALEIGH, NC 27609
 (919) 882-7839

DRAWN BY : J. B. HANNA DATE : 05-17
 CHECKED BY : L. MARTINEZ DATE : 05-17
 DESIGN ENGINEER OF RECORD: S. CULLUM DATE : 05-17

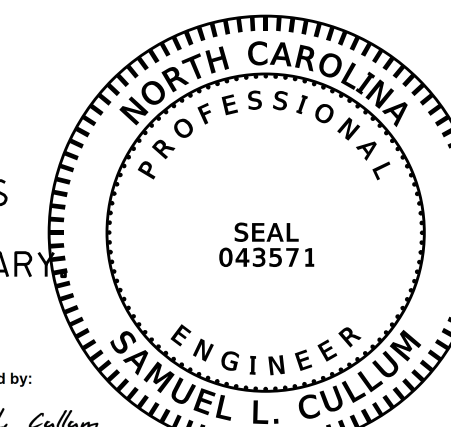

6/6/2018 12:30:46 PM PDT

DOCUMENT NOT CONSIDERED FINAL UNLESS ALL SIGNATURES COMPLETED

STATE OF NORTH CAROLINA
 DEPARTMENT OF TRANSPORTATION
 RALEIGH

GENERAL DRAWING
 FOR BRIDGE ON RAMP B
 OVER ABERDEEN AND
 ROCKFISH RAILROAD
 BETWEEN SR 1400 AND US 401

REVISIONS						SHEET NO.
NO.	BY:	DATE:	NO.	BY:	DATE:	S-3
1			3			TOTAL SHEETS
2			4			26