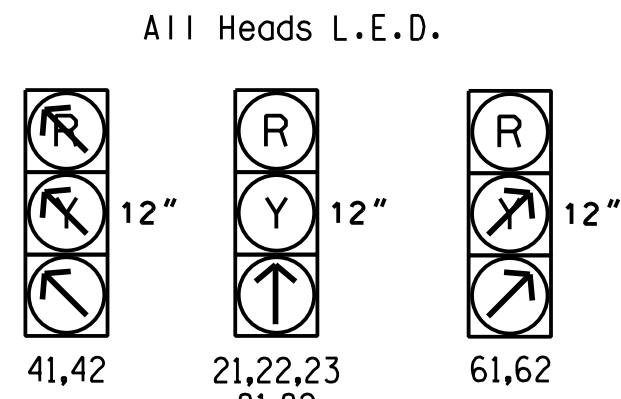

TABLE OF OPERATION

SIGNAL FACE	PHASE			
	02+6	03+8	04+8	FLASH
21,22,23		R	R	R
41,42	R	R	R	R
61,62	/	R	R	R
81,82	R			R

SIGNAL FACE I.D.



OASIS 2070E LOOP & DETECTOR INSTALLATION CHART

LOOP	INDUCTIVE LOOPS			DETECTOR PROGRAMMING								
	SIZE (FT)	DISTANCE FROM STOPBAR (FT)	TURNS	NEW LOOP	PHASE	CALLING	EXTENSION	FULL TIME DELAY	STRETCH TIME	DELAY TIME	SYSTEM LOOP	NEW CARD
2A	6X40	0	*	*	2	Y	Y	-	-	-	-	*
2B	6X40	0	*	*	2	Y	Y	-	-	-	-	*
2C	6X40	0	*	*	2	Y	Y	-	-	-	-	*
4A	6X40	0	*	*	3/4	Y	Y	-	-	-	-	*
6A	6X6	300	*	*	6	-	Y	-	2.4	-	-	*
6B	6X6	300	*	*	6	-	Y	-	2.4	-	-	*
6C	6X40	0	*	*	6	Y	Y	-	-	-	-	*
6D	6X40	0	*	*	6	Y	Y	-	-	-	-	*
8A	6X40	0	*	*	8	Y	Y	-	-	-	-	*
8B	6X40	0	*	*	8	Y	Y	-	-	-	-	*

* Video Detection Zone

3 Phase Fully Actuated Gilead Road Closed Loop System

NOTES

- Refer to "Roadway Standard Drawings NCDOT" dated January 2018 and "Standard Specifications for Roads and Structures" dated January 2018.
- Do not program signal for late night flashing operation unless otherwise directed by the Engineer.
- Omit phase 4 during phase 2+6 on.
- Program controller to clear from phase 2+6 to phase 4 by progressing through phase 3.
- Omit phase 3 during phase 4 on.
- Phase 3 provides red clearance time for vehicles traveling Eastbound on Gilead Rd.
- Set all detector units to presence mode.
- Reposition existing signal heads numbered 81 and 82 and sign (A).
- Program all phases for "Red Rest".
- Incorporate Video Detection system for vehicle detection.
- Provide the Engineer with the Manufacturer's approved Video Detection locations and mounting heights to obtain detection zones as shown.
- Maximum times shown in timing chart are for free-run operation only. Coordinated signal system timing values supersede these values.
- Closed loop system data: Controller Asset #1106

LEGEND

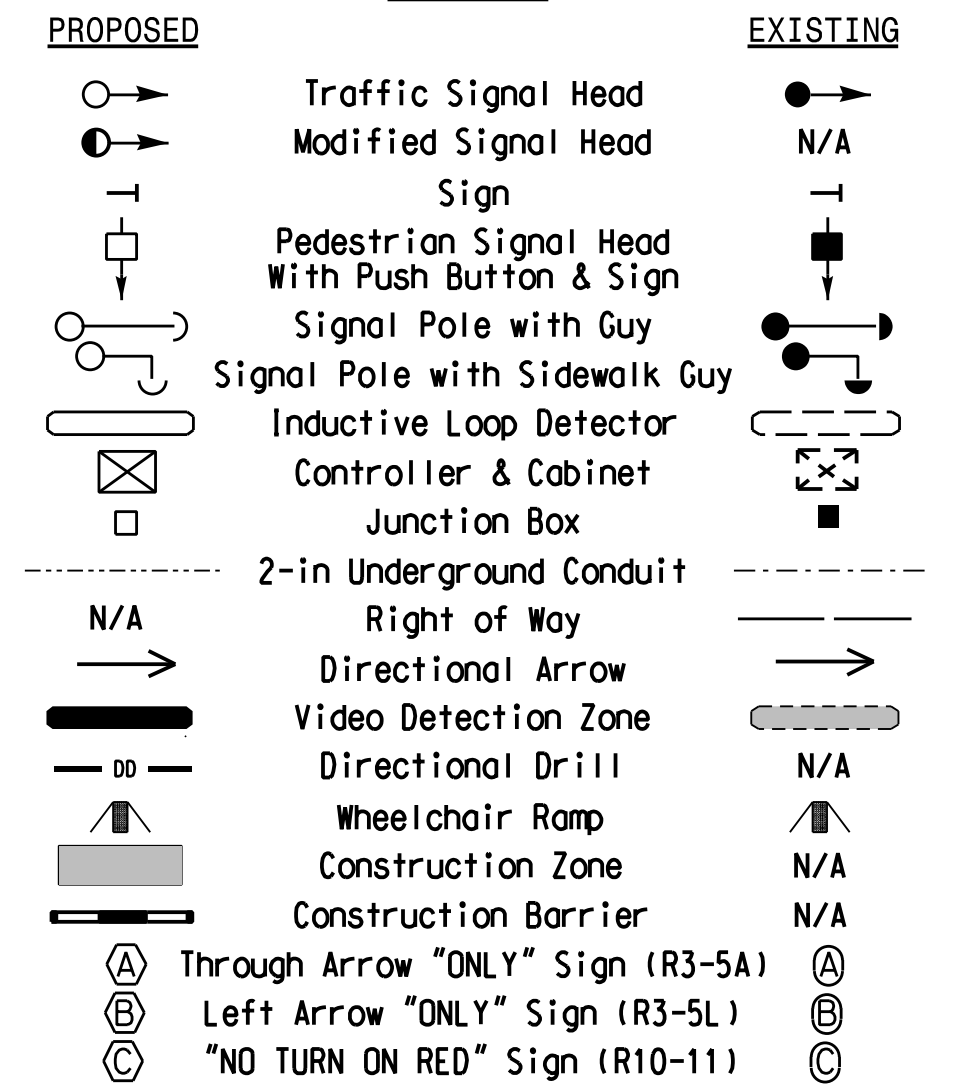

OASIS 2070E TIMING CHART

FEATURE	PHASE				
	2	3 (DUMMY)	4	6	8
Min Green 1 *	10	1	10	10	10
Extension 1 *	2.0	0.0	2.0	2.0	2.0
Max Green 1 *	60	1	60	60	60
Yellow Clearance	3.7	3.0	3.0	4.3	4.1
Red Clearance	1.6	3.8	4.2	1.9	3.1
Red Revert	5.0	5.0	5.0	5.0	5.0
Walk 1 *	-	-	-	-	-
Don't Walk 1	-	-	-	-	-
Seconds Per Actuation *	-	-	-	-	-
Max Variable Initial *	-	-	-	-	-
Time Before Reduction *	-	-	-	-	-
Time To Reduce *	-	-	-	-	-
Minimum Gap	-	-	-	-	-
Recall Mode	-	-	-	-	-
Vehicle Call Memory	-	-	-	-	-
Dual Entry	ON	ON	ON	ON	ON
Simultaneous Gap	ON	ON	ON	ON	ON

* These values may be field adjusted. Do not adjust Min Green and Extension times for phases 2 and 6 lower than what is shown. Min Green for all other phases should not be lower than 4 seconds.

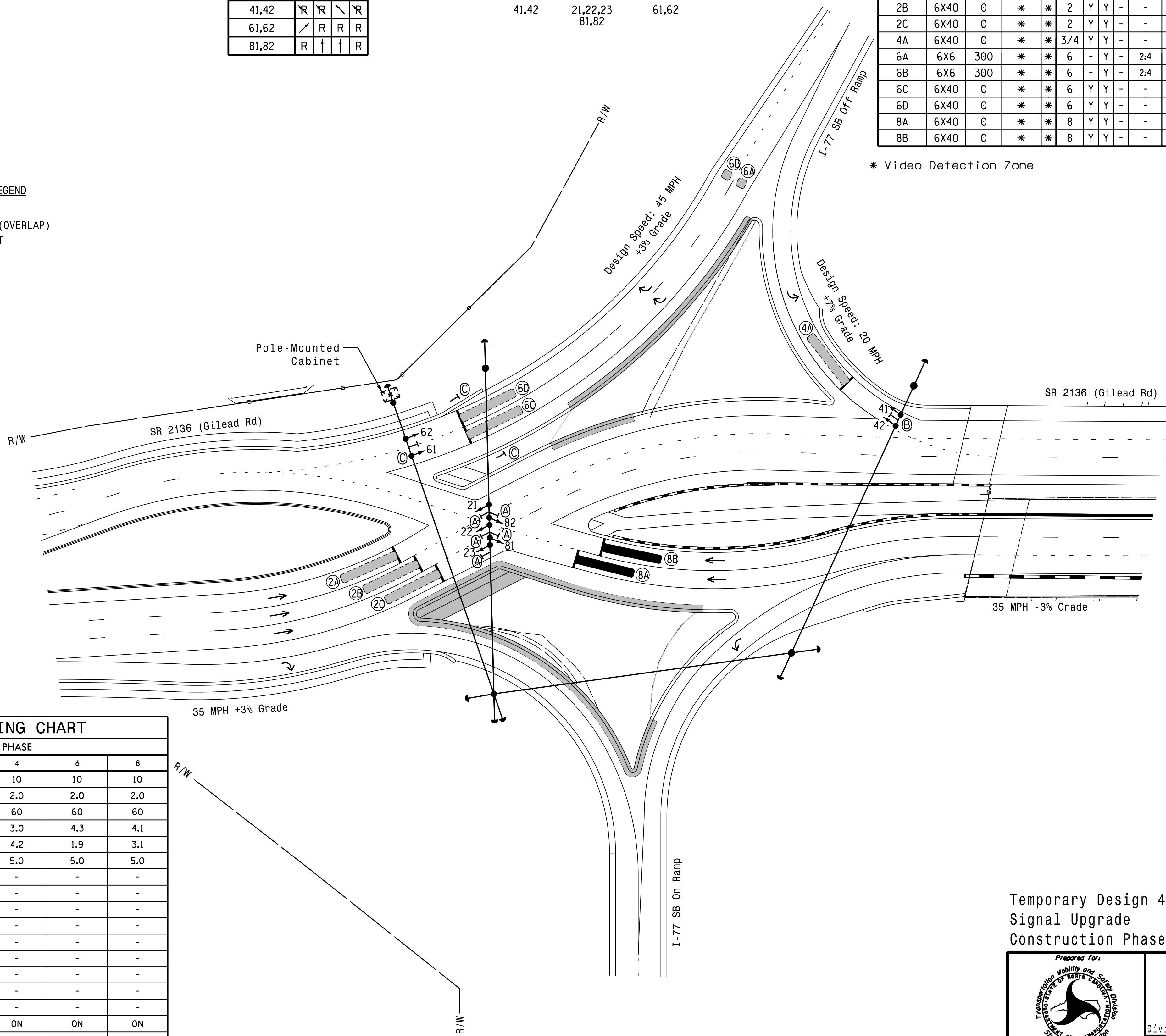

Temporary Design 4
Signal Upgrade
Construction Phase V

DOCUMENT NOT CONSIDERED FINAL UNLESS ALL SIGNATURES COMPLETED

	SR 2136 (Gilead Road) at I-77 SB Ramps		
	Division 10 Mecklenburg Co. Huntersville PLAN DATE: December 2017 REVIEWED BY: A.D. Klinksiek	PREPARED BY: A.H. Thornburg REVIEWED BY: N.R. Simmons	

HNTB HNTB NORTH CAROLINA, P.C.
343 E. Six Forks Road, Suite 200
Raleigh, North Carolina 27609
NC License No: C-1554
(919) 546-8997

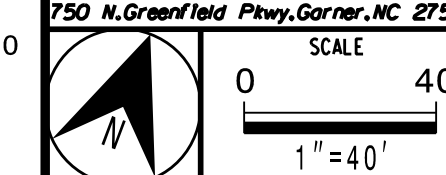

DocuSigned by:
Natasha R. Simmons
4/23/2018
SIG. INVENTORY NO. 10-1106 14