

8/17/19

Dewberry

PROJECT REFERENCE NO. **R-3825B** SHEET NO. **UC-90**

DESIGNED BY:	
DRAWN BY:	
CHECKED BY:	
APPROVED BY:	
REVISED:	
NORTH CAROLINA PROFESSIONAL SEAL 046000	
NORTH CAROLINA DEPARTMENT OF TRANSPORTATION	
UTILITIES ENGINEERING SEC. PHONE: (919) 707-6690 FAX: (919) 250-4151	
8/14/2018 2:35:03 PM EDT	
UTILITY CONSTRUCTION PLANS ONLY	

75+00

80+00

85+00

NOTE:
THE ESTIMATED QUANTITY OF DUCTILE IRON SEWER PIPE FITTINGS ON THIS PLAN SHEET IS 1000 POUNDS. THE ACTUAL QUANTITY AND TYPE OF FITTINGS WILL VARY BASED ON FIELD CONDITIONS.

NOTE:
THE ESTIMATED QUANTITY OF DUCTILE IRON WATER PIPE FITTINGS ON THIS PLAN SHEET IS 1500 POUNDS. THE ACTUAL QUANTITY AND TYPE OF FITTINGS WILL VARY BASED ON FIELD CONDITIONS.

PROP. 2 EA 6" VALVE,
PROP. 10LF 12" WATER LINE,
PROP. 20LF 6" WATER LINE.

PROP. 4" DIA.
UTILITY MANHOLE

PROP. 52LF 8" SANITARY
GRAVITY SEWER

NEW SSMH
TOP= 188.15
INV. IN= 180.83
INV. OUT= 180.73

PROP. 4" DIA.
UTILITY MANHOLE

PROP. 50LF ABANDON 8" UTILITY PIPE

REMOVE UTILITY MANHOLE

PROP. 28LF 8" SANITARY
GRAVITY SEWER

8" PVC SS, S=2.2%
CONNECT TO
EX. SEWER
INV. IN= 178.71

REFER TO DETAIL ON SHEET UC-3D
FOR CONNECTION METHOD TO
JOHNSTON CO. 24" WATER MAIN

POC Sta. 81+26.07 =
POT Sta. 17+35.33

UTILITY CONSTRUCTION

MATCHLINE -L- RDY STA. 75+00.00 UC STA. 17+06.67
SEE SHEET RDY-8 / UC-8A

MATCHLINE -L- RDY STA. 88+00.00
UC STA. 30+05.85
SEE SHEET RDY-10 / UC-100

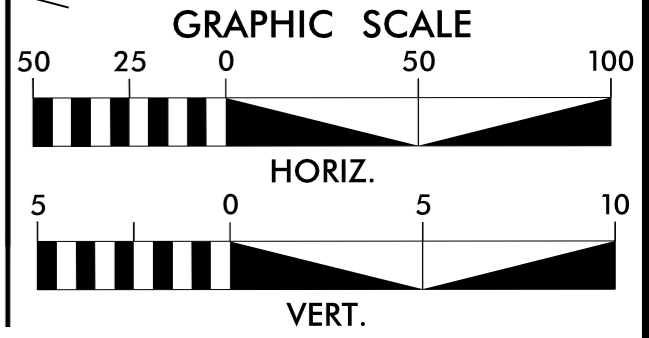
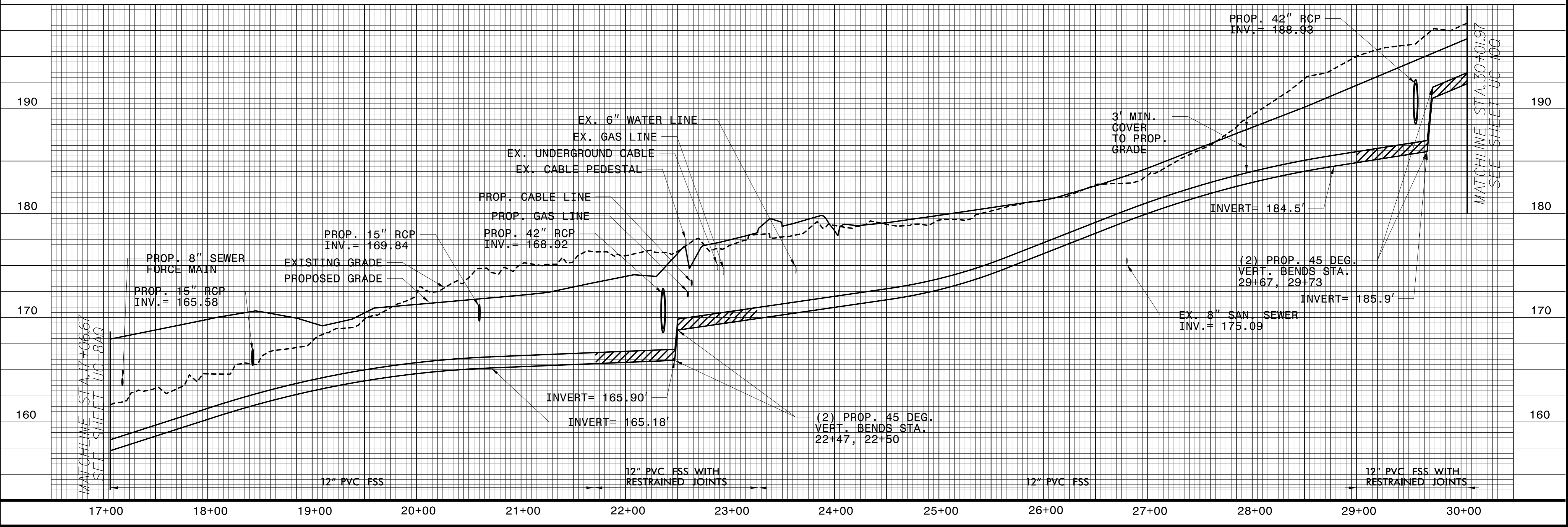

REVISIONS

