

# CONCRETE ISLAND DETAILS

Prepared by  
**URS**  
 URS Corporation - North Carolina  
 1600 Perimeter Park Drive  
 Morrisville, North Carolina 27560  
 TELEPHONE: (919) 461-1100 FAX: (919) 461-1415  
 NC LIC#062 - C-2242

PROJECT REFERENCE NO. <i>R-3825B</i>	SHEET NO. <i>2B-6</i>
RW SHEET NO.	
ROADWAY DESIGN ENGINEER NOT A CERTIFIED DOCUMENT AS TO THE ORIGINAL DOCUMENT	HYDRAULICS ENGINEER NOT A CERTIFIED DOCUMENT AS TO THE ORIGINAL DOCUMENT
THIS DOCUMENT ORIGINALLY ISSUED AND SEALED BY: EDWARD GLENN EDENS, JR. 18470 ON 08/09/2018	THIS DOCUMENT ORIGINALLY ISSUED AND SEALED BY: NO SEALER IN THIS BLOCK ON
THIS DOCUMENT IS ONLY CERTIFIED AS TO THE REVISIONS.	THIS DOCUMENT IS ONLY CERTIFIED AS TO THE REVISIONS.
<b>DOCUMENT NOT CONSIDERED FINAL UNLESS ALL SIGNATURES COMPLETED</b>	

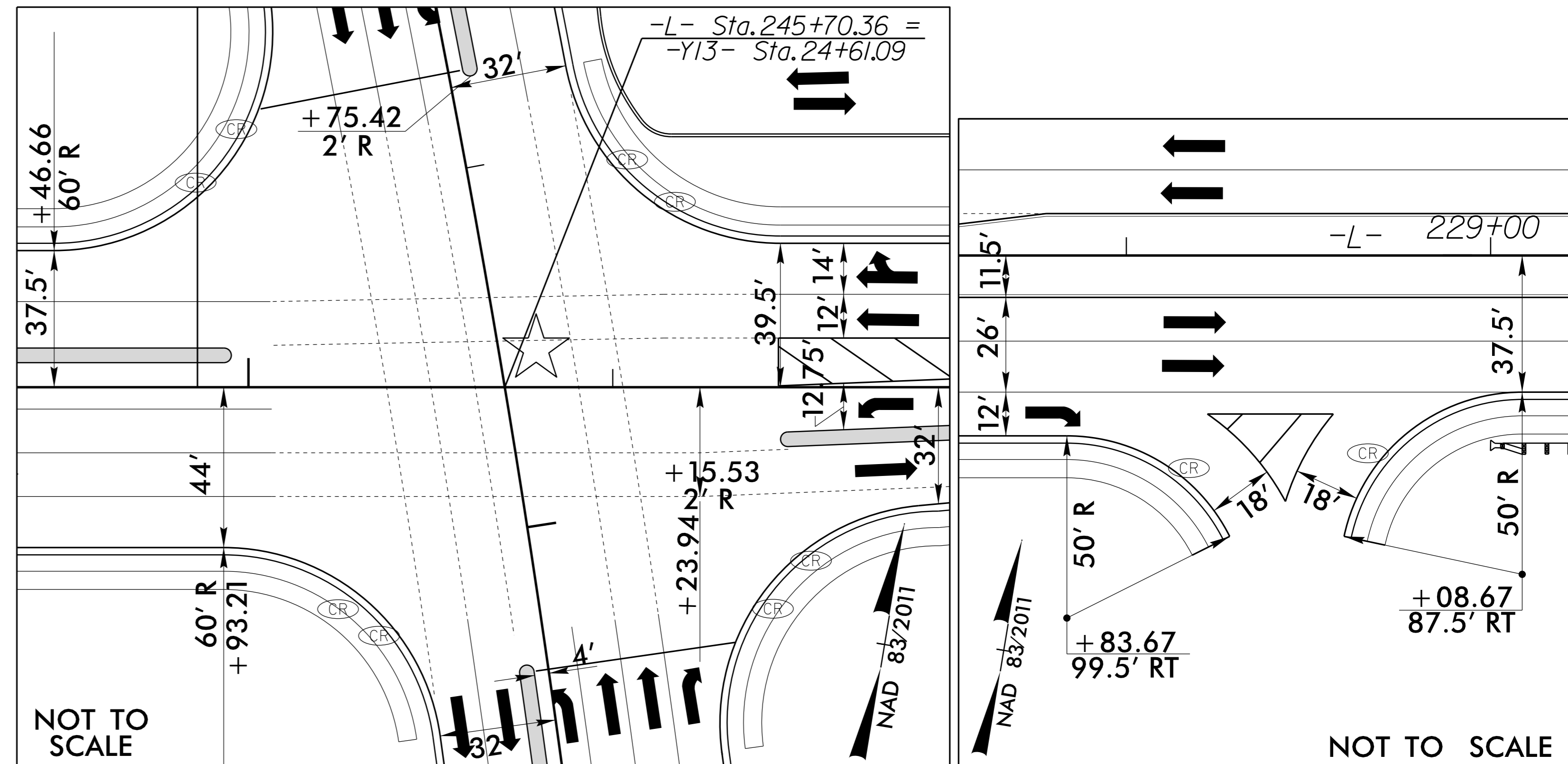
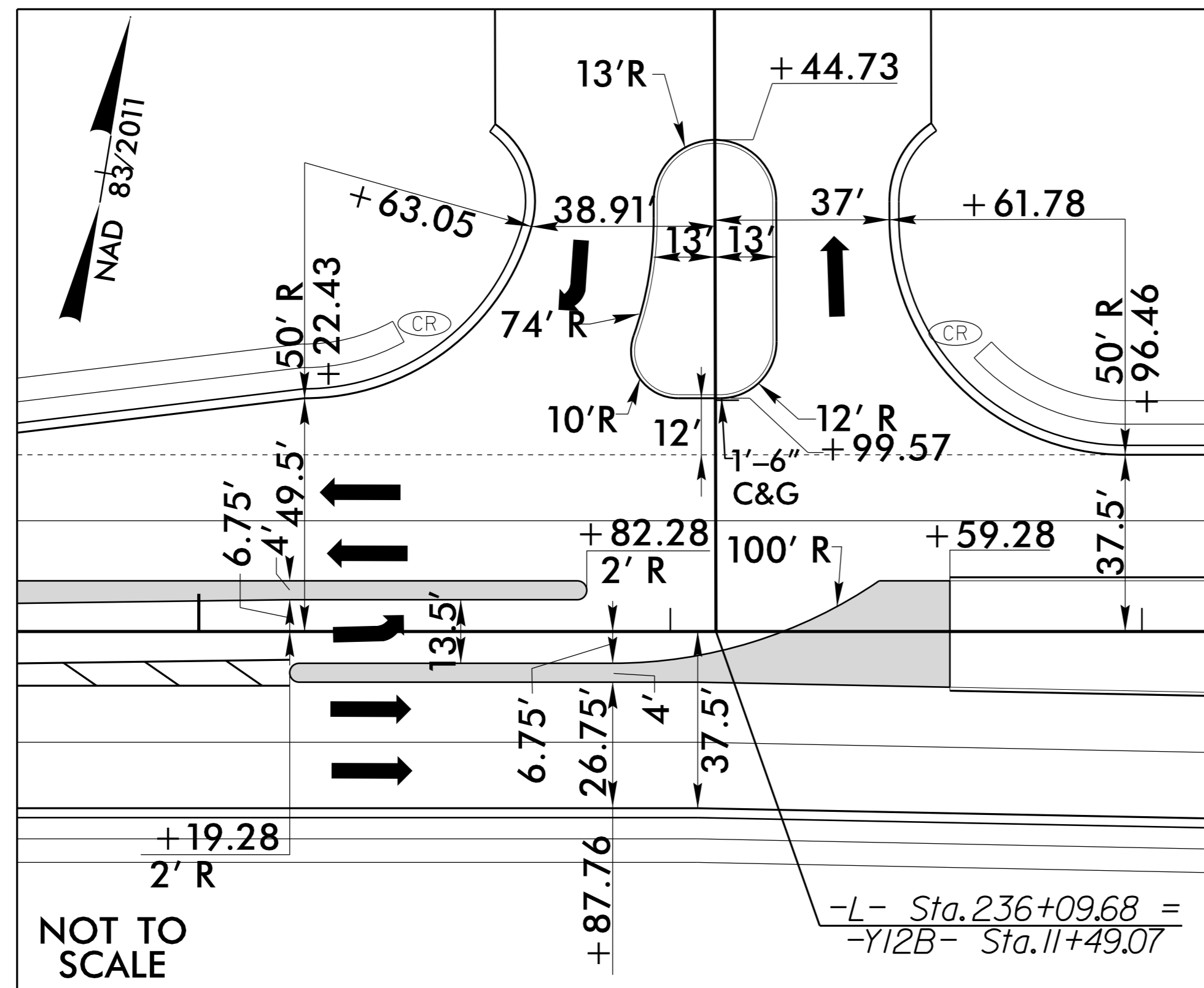
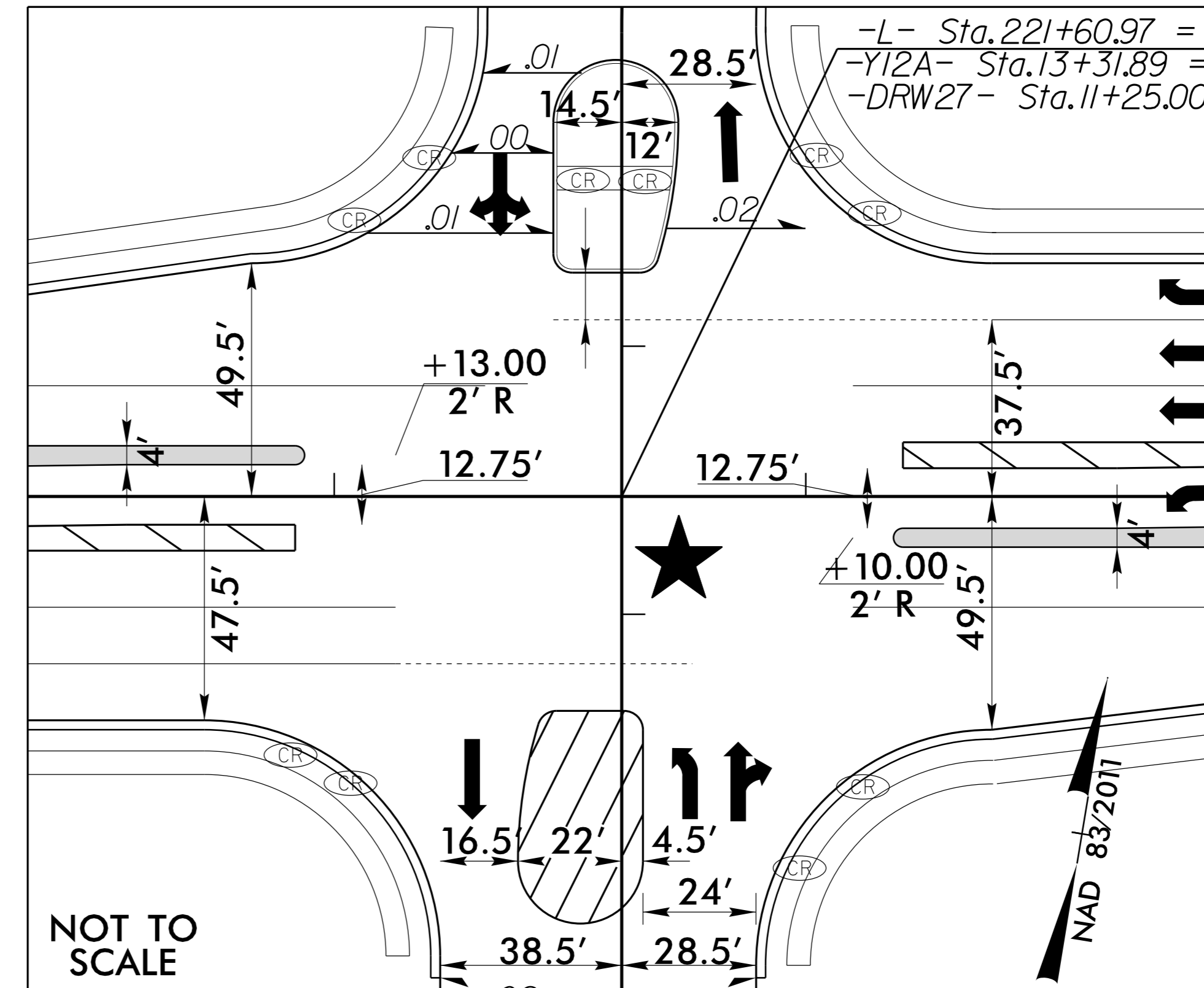
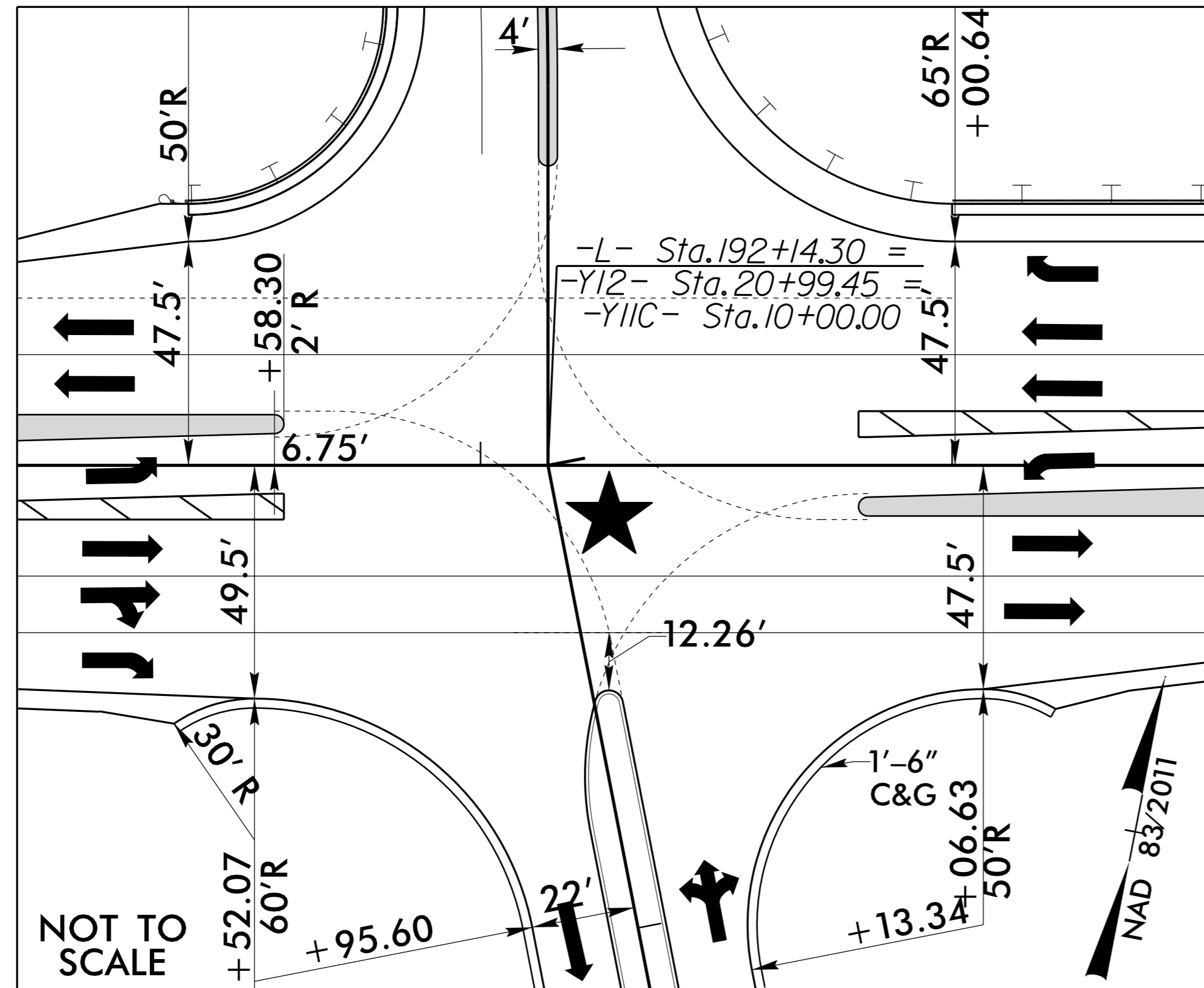
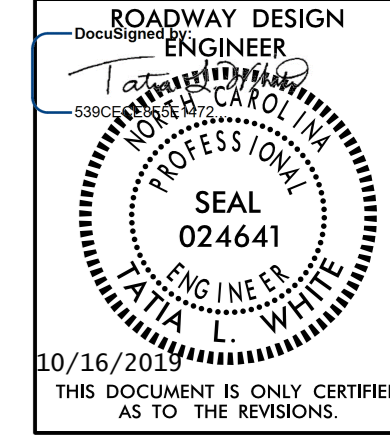

REVISIONS  
 10/16/2019 - CONSTRUCTION REVISION: ADDED DETAIL FOR RIGHT TURN LANE STARTING AT -L- STA. 228+83.67 RIGHT, HN

16-OCT-2019 11:03  
 V:\3825B\2019\20191016\medium layout.dgn  
 TATIANA L. WHITE

8/17/09