

8/17/19

REVISIONS

1 - ROW, PUE, PDE, AND EASEMENTS UPDATED ON PARCEL 100 FROM STA. 218+77 TO 244+77 (10/12/2018) TLH
 10/16/2019 - CONSTRUCTION REVISION: ADDED A RIGHT TURN FROM -L- STATION 224+35.00 TO 229+08.67 RIGHT AND REMOVED -DRW13- AT -L- STA. 228+86.87 TO 229+52.33.
 HYDRAULICS WAS ALSO REVISED IN THESE AREAS. HN
 08/17/2020 - CONSTRUCTION REVISION: ADDED AN EXCLUSIVE LEFT TURN LANE TO -DRW27- AND -Y12A-, WIDENED THE INGRESS RADIUS FOR THE DRIVEWAY AT -L- STATION 227+84,
 REVISED THE BERM AND SLOPES FROM -L- STA. 224+00 TO 227+50 RT. TO TIE TO THE DEVELOPER'S GRADING PLAN, AND ADDED
 GRADING DETAIL #2001. THE ASSOCIATED DRAINAGE WAS UPDATED. HN

17-AUG-2020 17:47
 R:\Projects\2020\1747
 R:\Projects\2020\1747\1747-R3825B-r-dj-ph20.dgn

MATCHLINE -L- STA. 216+00.00 SEE SHEET 19

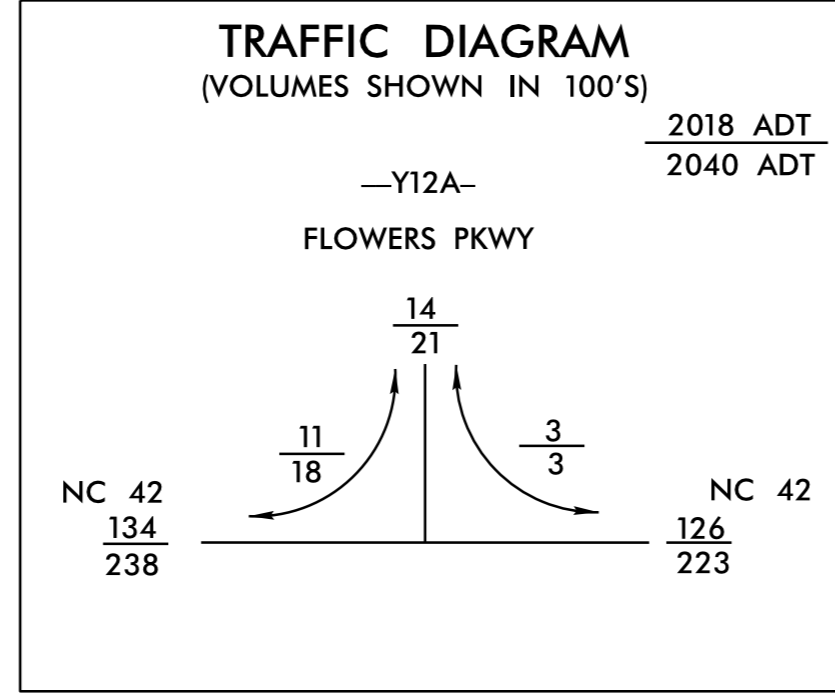
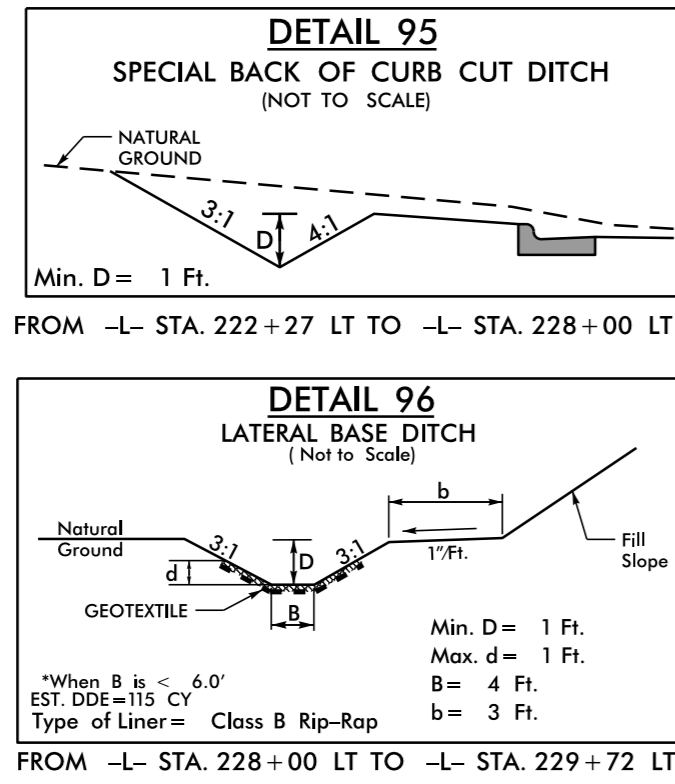

-Y12A- FLOWERS PKWY
 PI Sta 11+21.34
 $\Delta = 38' 28' 14.5''$ (LT)
 $D = 16' 28' 36.2''$
 $L = 233.49'$
 $T = 121.34'$
 $R = 347.74'$

Prepared by
URS
 URS Corporation - North Carolina
 1600 Perimeter Park Drive
 Morrisville, North Carolina 27560
 TELEPHONE: (919) 461-1100 FAX: (919) 461-1415
 NC L103462 • C-2243

PROJECT REFERENCE NO. R-3825B		SHEET NO. 20	
RW SHEET NO.			
ROADWAY DESIGN ENGINEER	HYDRAULICS ENGINEER		NOT A CERTIFIED DOCUMENT AS TO THE ORIGINAL DOCUMENT
NOT A CERTIFIED DOCUMENT AS TO THE ORIGINAL DOCUMENT		NOT A CERTIFIED DOCUMENT AS TO THE ORIGINAL DOCUMENT	
THIS DOCUMENT ORIGINALLY ISSUED AND SEALED BY:		THIS DOCUMENT ORIGINALLY ISSUED AND SEALED BY:	
EDWARD GLENN EDENS, JR. 18470 ON 08/09/2018		MEME D. BUSCEMI 037863 ON 08/09/2018	
THIS DOCUMENT IS ONLY CERTIFIED AS TO THE REVISIONS.		THIS DOCUMENT IS ONLY CERTIFIED AS TO THE REVISIONS.	
DOCUMENT NOT CONSIDERED FINAL UNLESS ALL SIGNATURES COMPLETED			
ROADWAY DESIGN ENGINEER	HYDRAULICS ENGINEER		
8/17/2020	8/18/2020		
Tanya J. White		Matthew J. York, P.E.	
FOR REVISIONS ONLY		FOR REVISIONS ONLY	

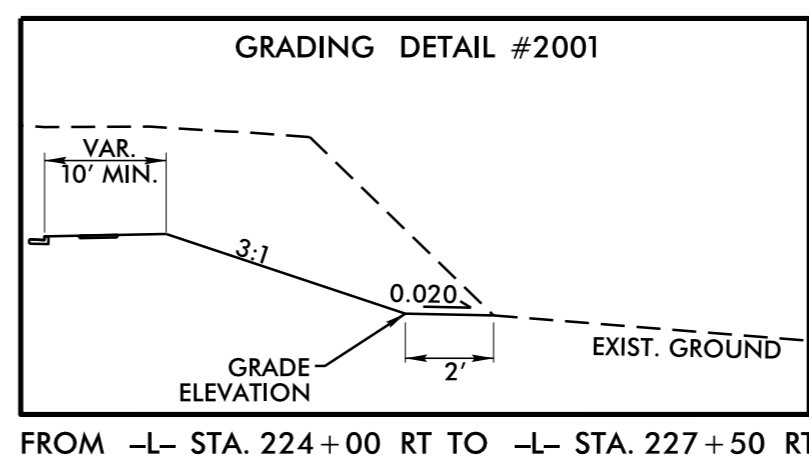
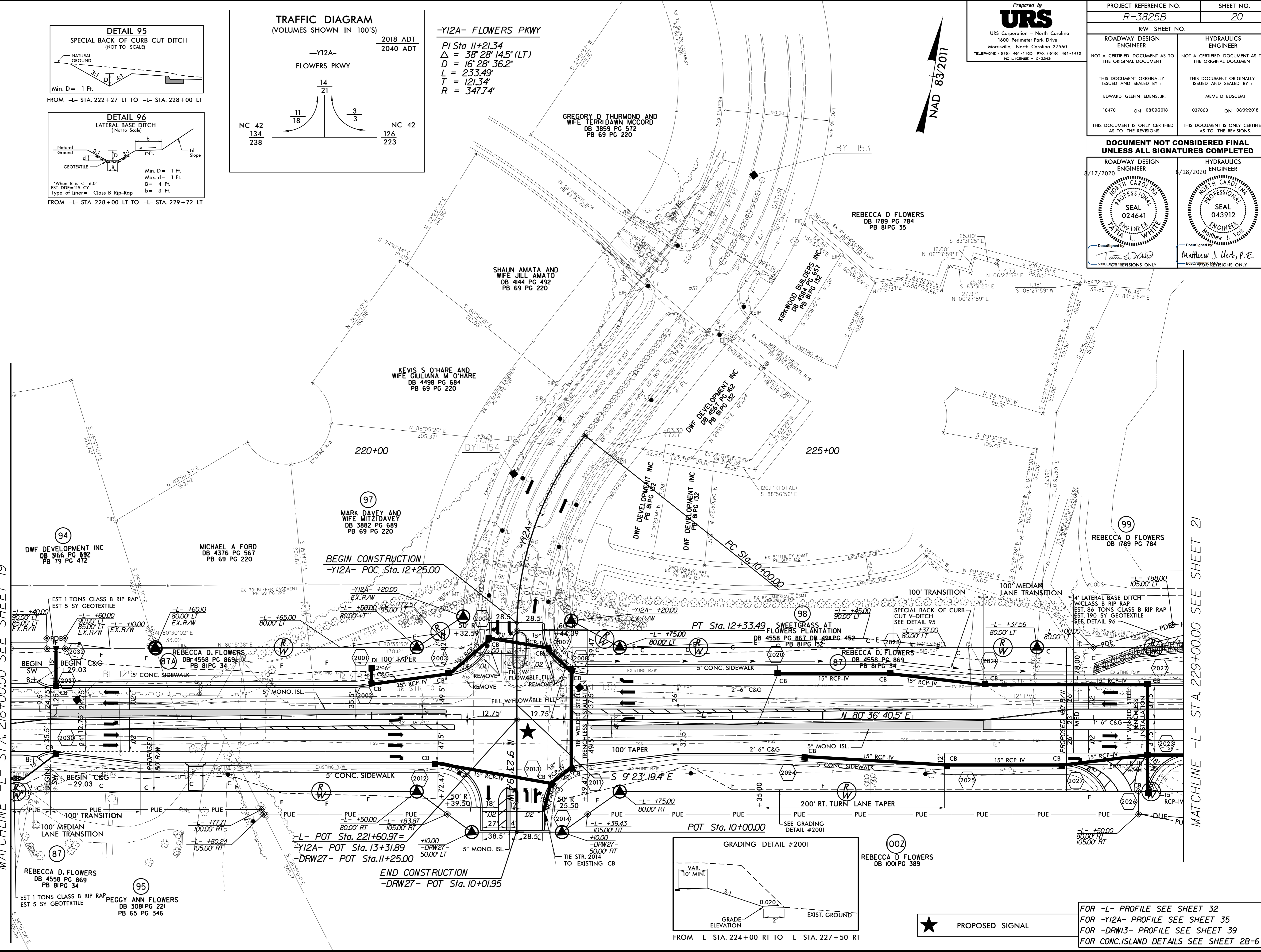
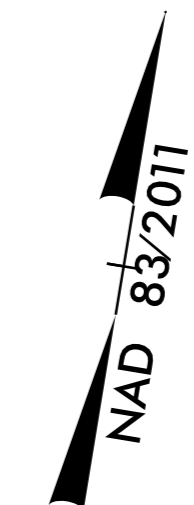

★ PROPOSED SIGNAL

FOR -L- PROFILE SEE SHEET 32
 FOR -Y12A- PROFILE SEE SHEET 35
 FOR -DRW13- PROFILE SEE SHEET 39
 FOR CONC. ISLAND DETAILS SEE SHEET 2B-6

MATCHLINE -L- STA. 229+00.00 SEE SHEET 21