

-L- NC 42
 PI Sta. 179+59.06
 $\Delta = 5^\circ 17' 17.9''$ (RT)
 $D = 1' 08'' 53.6''$
 $L = 460.57'$
 $T = 230.45'$
 $R = 4990.00'$
 $e = 3\%$
 Runoff = 162'

-YIIB- VERONA DR
 PI Sta. 12+01.7
 $\Delta = 72^\circ 15' 26.8''$ (RT)
 $D = 37' 53'' 05.4''$
 $L = 190.73'$
 $T = 110.40'$
 $R = 151.24'$

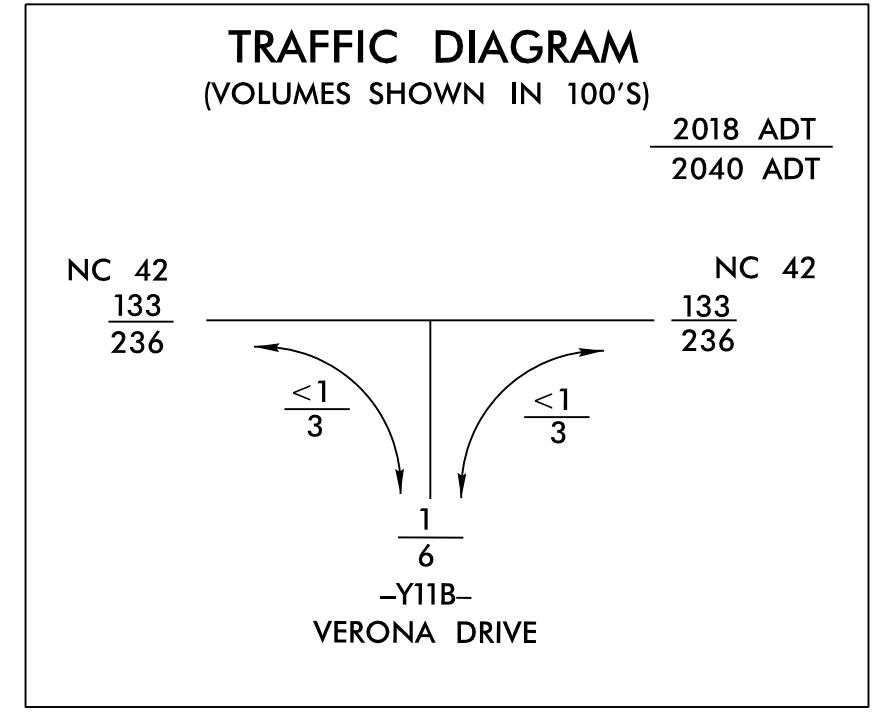

PROJECT REFERENCE NO. R-3825B	SHEET NO. 17
RW SHEET NO.	
ROADWAY DESIGN ENGINEER	HYDRAULICS ENGINEER
8/9/2018	8/9/2018

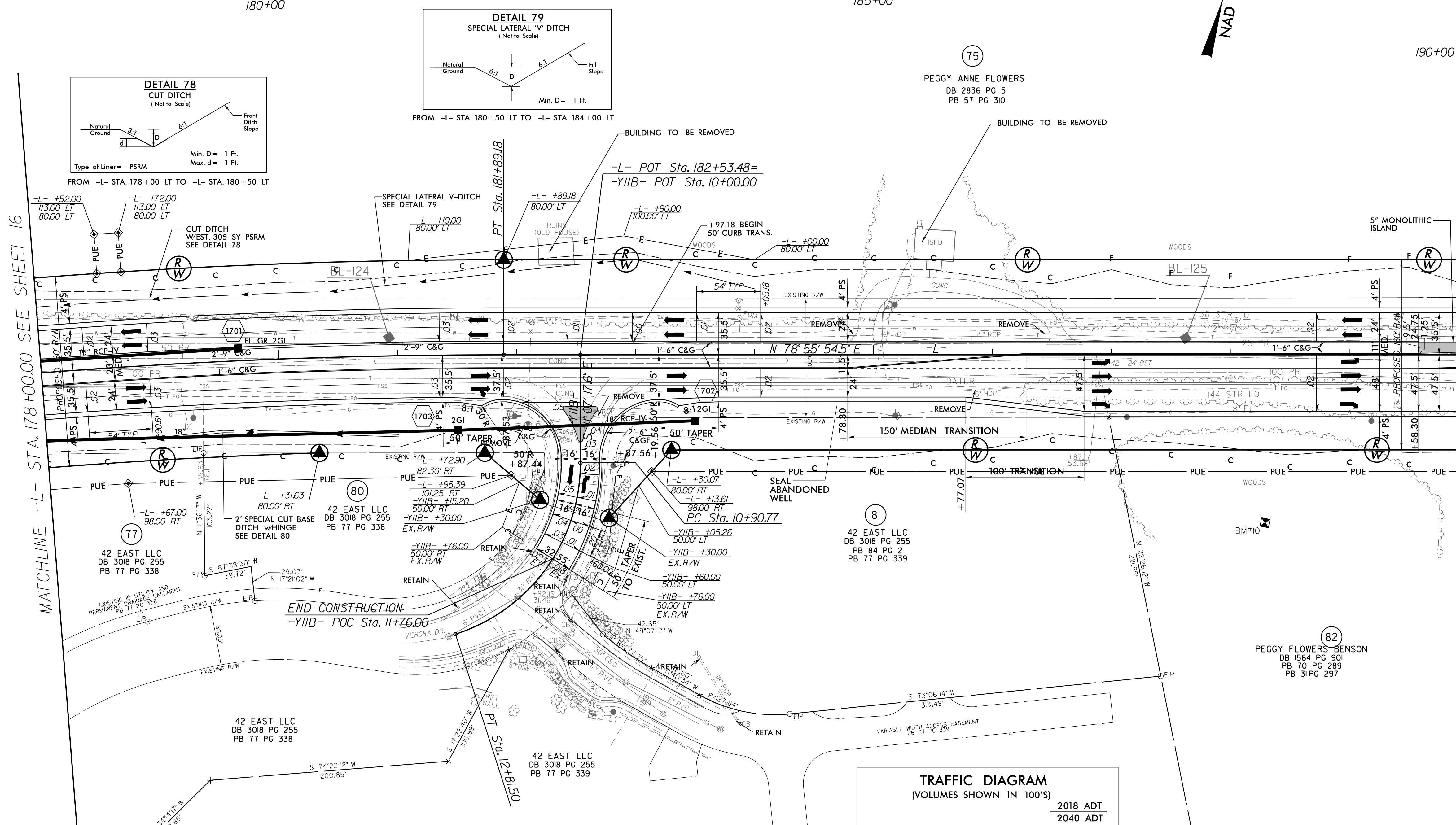
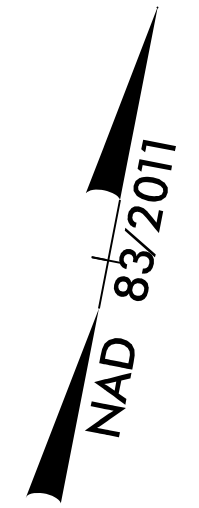

DOCUMENT NOT CONSIDERED FINAL
 UNLESS ALL SIGNATURES COMPLETED

MATCHLINE -L- STA. 178+00.00 SEE SHEET 16

MATCHLINE -L- STA. 190+00.00 SEE SHEET 18

FOR -L- PROFILE SEE SHEET 30
 FOR -YIIB- PROFILE SEE SHEET 35
 FOR CONC. ISLAND DETAILS SEE SHEET 2B-5