

-LI-
 PI Sta 55+85.50
 $\Delta = 13^{\circ} 41' 29.0''$ (RT)
 $D = 1^{\circ} 02' 30.3''$
 $L = 1,314.28'$
 $T = 660.28'$
 $R = 5,500.00'$
 $e = NC$

AFTER PERMANENT STABILIZATION, FILL AND RESTORE BASIN AREAS TO PRECONSTRUCTION CONTOURS

NOTE:
 USE 1.0 FT WEIR HEIGHT FOR TEMPORARY ROCK SILT CHECKS TYPE - A THAT ARE NOT LABELED.

68 ANNE MARIA K EDWARDS
 SEE NOTE IN SURVEY REPORT
 DB 2246 PG 640
 PC 4 PG 395

68 ANNE MARIA K EDWARDS
 SEE NOTE IN SURVEY REPORT
 DB 2246 PG 640
 PC 4 PG 395

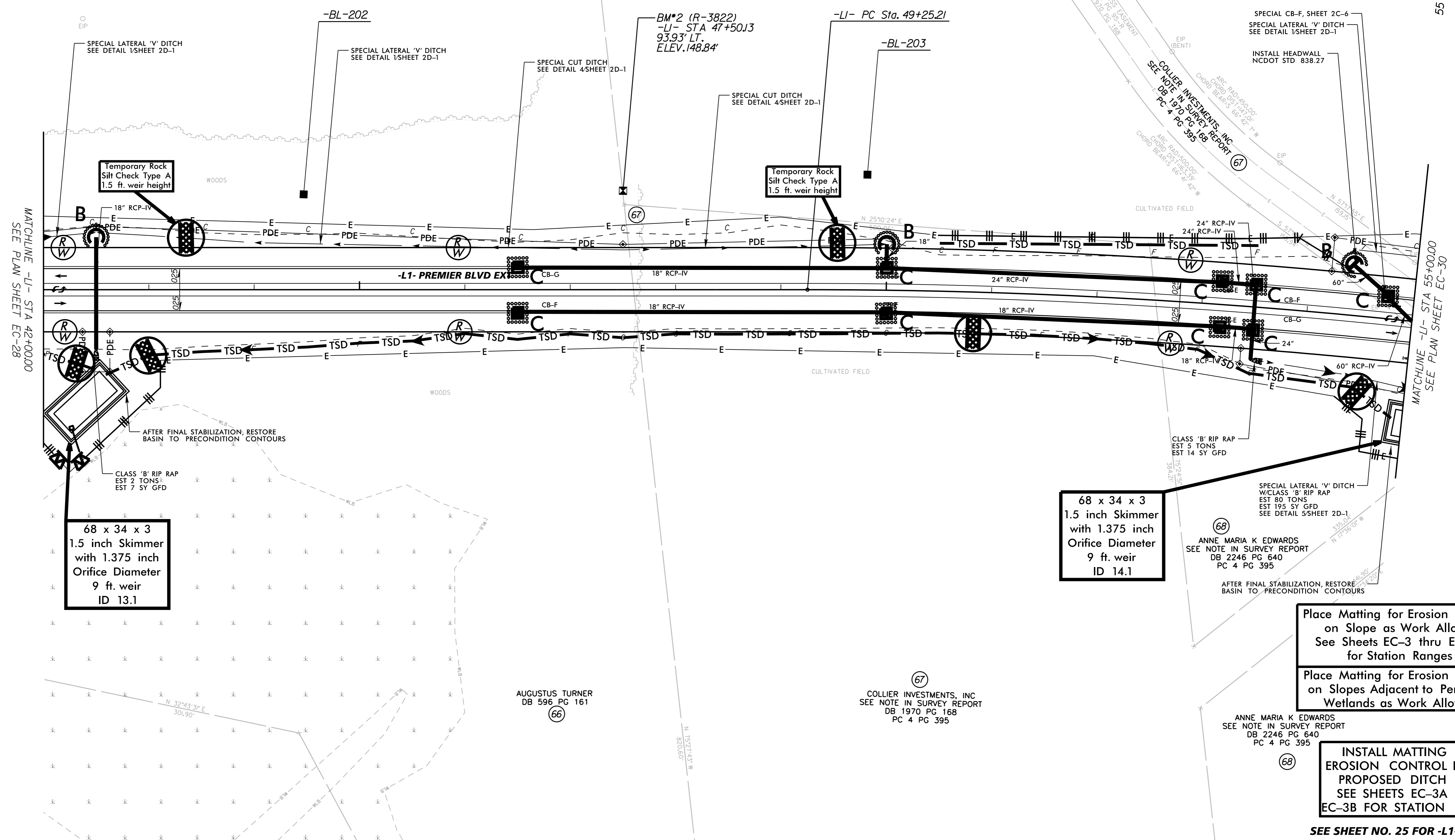
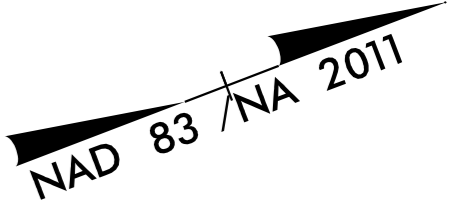

MATCHLINE -LI- STA 42+00.00
 SEE PLAN SHEET EC-28

MATCHLINE -LI- STA 55+00.00
 SEE PLAN SHEET EC-30

**68 x 34 x 3
 1.5 inch Skimmer
 with 1.375 inch
 Orifice Diameter
 9 ft. weir
 ID 13.1**

**68 x 34 x 3
 1.5 inch Skimmer
 with 1.375 inch
 Orifice Diameter
 9 ft. weir
 ID 14.1**

Place Matting for Erosion Control on Slope as Work Allows. See Sheets EC-3 thru EC-3B for Station Ranges

Place Matting for Erosion Control on Slopes Adjacent to Permitted Wetlands as Work Allows.

INSTALL MATTING FOR EROSION CONTROL IN THE PROPOSED DITCH LINE. SEE SHEETS EC-3A THRU EC-3B FOR STATION RANGES

SEE SHEET NO. 25 FOR -L1- PROFILE

REVISIONS

5/14/99

6/28/2018