

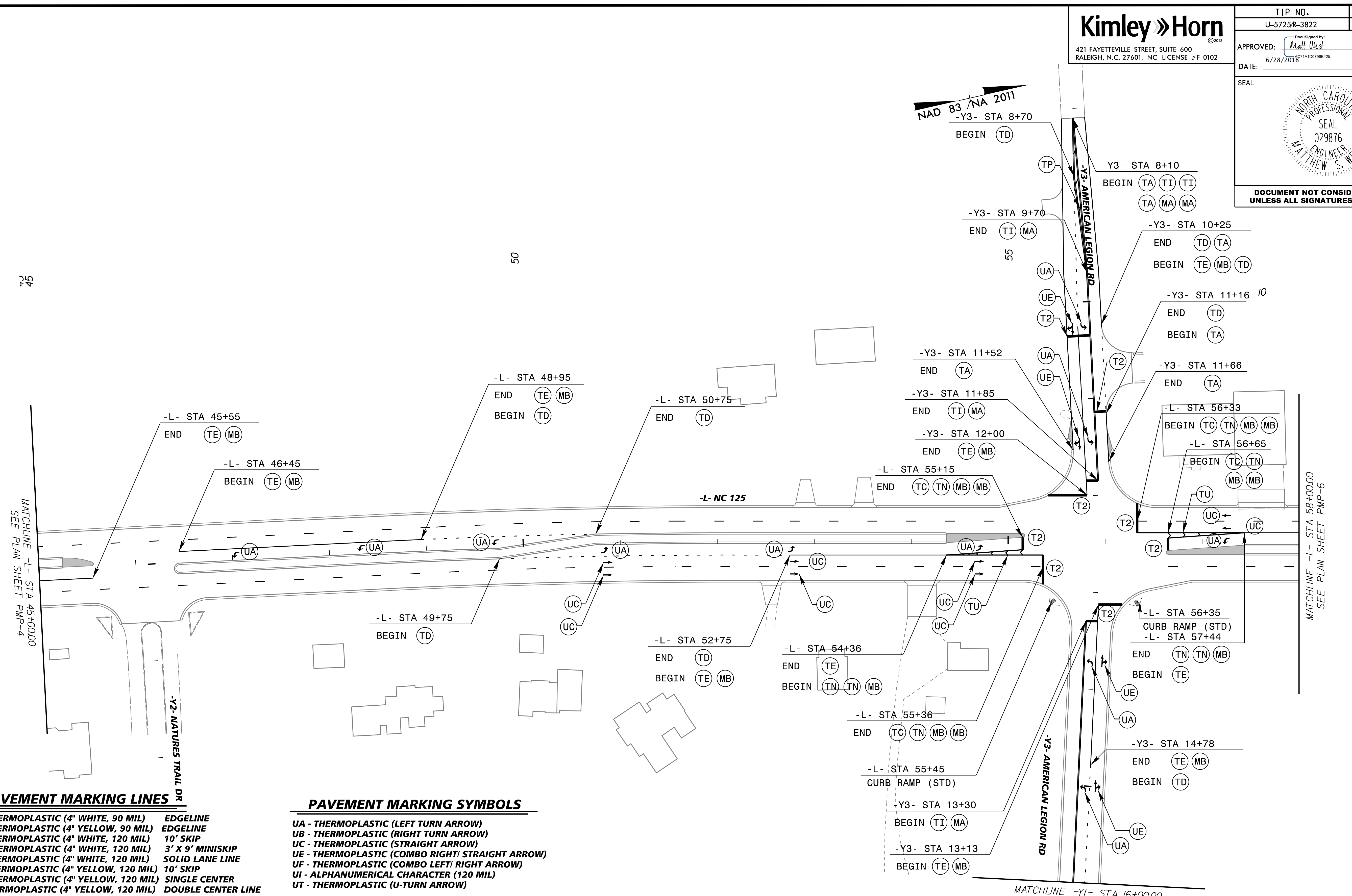

DOCUMENT NOT CONSIDERED FINAL
UNLESS ALL SIGNATURES COMPLETED

NAD 83 / N.A. 2011



PAVEMENT MARKING LINES

- TA - THERMOPLASTIC (4" WHITE, 90 MIL) EDGELINE
- TB - THERMOPLASTIC (4" YELLOW, 90 MIL) EDGELINE
- TC - THERMOPLASTIC (4" WHITE, 120 MIL) 10' SKIP
- TD - THERMOPLASTIC (4" WHITE, 120 MIL) 3' X 9' MINISKIP
- TE - THERMOPLASTIC (4" WHITE, 120 MIL) SOLID LANE LINE
- TF - THERMOPLASTIC (4" YELLOW, 120 MIL) 10' SKIP
- TH - THERMOPLASTIC (4" YELLOW, 120 MIL) SINGLE CENTER
- TI - THERMOPLASTIC (4" YELLOW, 120 MIL) DOUBLE CENTER LINE
- TK - THERMOPLASTIC (6" WHITE, 120 MIL) 3' X 9' MINISKIP
- TL - THERMOPLASTIC (6" WHITE, 120 MIL) SOLID LANE LINE
- TN - THERMOPLASTIC (8" WHITE, 90 MIL) GORELINE
- TP - THERMOPLASTIC (8" YELLOW, 90 MIL) DIAGONAL
- TU - THERMOPLASTIC (12" WHITE, 90 MIL) DIAGONAL
- T2 - THERMOPLASTIC (24" WHITE, 120 MIL) STOPBAR
- T8 - THERMOPLASTIC (4" WHITE, 120 MIL) 2' X 6' MINISKIP
- T9 - THERMOPLASTIC (4" YELLOW, 120 MIL) 2' X 6' MINISKIP
- VA - POLYUREA (4" WHITE) EDGELINE
- VF - POLYUREA (4" YELLOW) 10' SKIP
- VH - POLYUREA (4" YELLOW) SINGLE CENTER

PAVEMENT MARKING SYMBOLS

- UA - THERMOPLASTIC (LEFT TURN ARROW)
- UB - THERMOPLASTIC (RIGHT TURN ARROW)
- UC - THERMOPLASTIC (STRAIGHT ARROW)
- UE - THERMOPLASTIC (COMBO RIGHT/ STRAIGHT ARROW)
- UF - THERMOPLASTIC (COMBO LEFT/ RIGHT ARROW)
- UI - ALPHANUMERICAL CHARACTER (120 MIL)
- UT - THERMOPLASTIC (U-TURN ARROW)

PAVEMENT MARKER SYMBOLS

- MA - PERMANENT RAISED MARKER YELLOW & YELLOW
- MB - PERMANENT RAISED MARKER CRYSTAL & RED

K:\PAL_Roadway\01036392 - R-3822 and U-5725\Roadway\Proj\U5725_R3822_rdy_pmp_05.dgn 6/28/2018

MATCHLINE -L- STA 45+00.00
SEE PLAN SHEET PMP-4

MATCHLINE -L- STA 58+00.00
SEE PLAN SHEET PMP-6

MATCHLINE -Y1- STA 16+00.00
SEE PLAN SHEET PMP-17