

PROJECT REFERENCE NO. U-5725/R-3822		SHEET NO. 8	
ROADWAY DESIGN ENGINEER		HYDRAULICS ENGINEER	
DOCUMENT NOT CONSIDERED FINAL UNLESS ALL SIGNATURES COMPLETED			

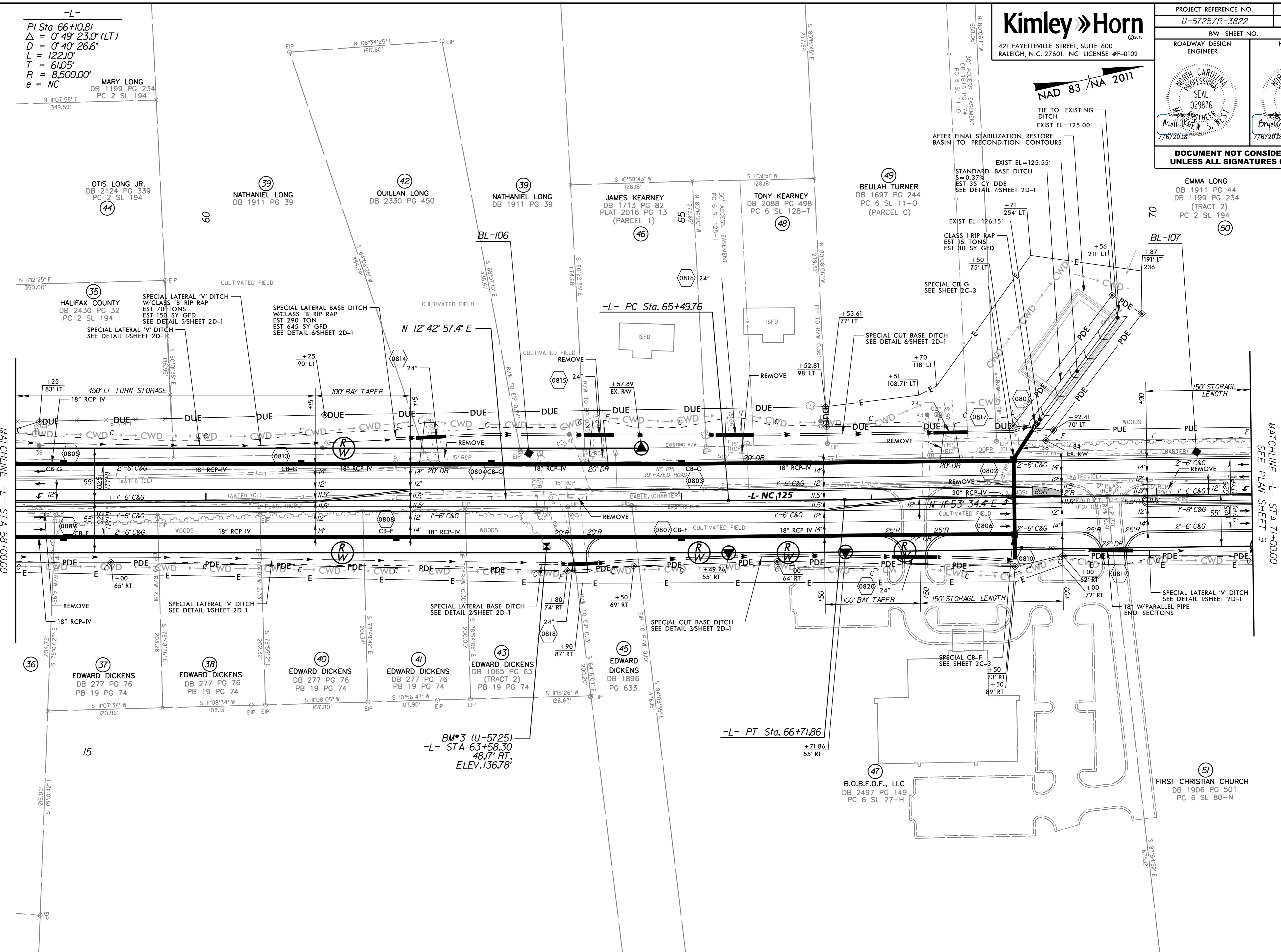

-L-
 PI Sta 66+10.81
 $\Delta = 0^\circ 49' 23.0''$ (LT)
 $D = 0^\circ 40' 26.6''$
 $L = 122.10'$
 $T = 61.05'$
 $R = 8,500.00'$
 $e = NC$

MARY LONG
 DB 1199 PG 234
 PC 2 SL 194

OTIS LONG JR.
 DB 2430 PG 32
 PC 2 SL 194

NATHANIEL LONG
 DB 1911 PG 39

QUILLAN LONG
 DB 2330 PG 450

NATHANIEL LONG
 DB 1911 PG 39

JAMES KEARNEY
 DB 1713 PG 82
 PLAT 2016 PG 13
 (PARCEL 1)

TONY KEARNEY
 DB 2088 PG 498
 PC 6 SL 128-1

BEULAH TURNER
 DB 1697 PG 244
 PC 6 SL 11-0
 (PARCEL C)

EDWARD DICKENS
 DB 277 PG 76
 PB 19 PG 74

EDWARD DICKENS
 DB 277 PG 76
 PB 19 PG 74

EDWARD DICKENS
 DB 277 PG 76
 PB 19 PG 74

EDWARD DICKENS
 DB 277 PG 76
 PB 19 PG 74

EDWARD DICKENS
 DB 1065 PG 63
 PB 19 PG 74
 (TRACT 2)

EDWARD DICKENS
 DB 1896
 PG 633

B.O.B.F.O.F., LLC
 DB 2497 PG 149
 PC 6 SL 27-H

FIRST CHRISTIAN CHURCH
 DB 1906 PG 501
 PC 6 SL 80-N

BM*3 (U-5725)
 -L- STA 63+58.30
 48.17' RT.
 ELEV. 136.78'

-L- PT Sta. 66+71.86
 +71.86
 55' RT

MATCHLINE -L- STA 58+00.00
SEE PLAN SHEET 7

MATCHLINE -L- STA 71+00.00
SEE PLAN SHEET 9

REVISIONS

NOTE: ALL TEMPORARY SEDIMENT TRAPS SHALL BE REMOVED AND REGRADED TO PRECONSTRUCTION TOPOGRAPHY PRIOR TO PROJECT COMPLETION.
SEE SHEET NO. 22 FOR -L- PROFILE

5/14/19

7/6/2018