

PROJECT REFERENCE NO. U-5725/R-3822	SHEET NO. 4
ROADWAY DESIGN ENGINEER	HYDRAULICS ENGINEER
DOCUMENT NOT CONSIDERED FINAL UNLESS ALL SIGNATURES COMPLETED	

-L-

PI Sta 12+33.09 $\Delta = 5^{\circ} 05' 23.8" (RT)$ $D = 2^{\circ} 07' 19.4"$ $L = 239.86'$ $T = 120.01'$ $R = 2,700.00'$	PI Sta 29+17.86 $\Delta = 41^{\circ} 55' 36.6" (RT)$ $D = 2^{\circ} 51' 53.2"$ $L = 1,463.52'$ $T = 766.26'$ $R = 2,000.00'$ $e = 4.0$ $R_{\text{min}} = 192'$
--	---

-LI-

PI Sta 25+10.02 $\Delta = 13^{\circ} 12' 00.6" (RT)$ $D = 4^{\circ} 46' 28.7"$ $L = 276.46'$ $T = 138.85'$ $R = 1,200.00'$ $e = 3.2$ $R_{\text{min}} = 64'$	PI Sta 31+76.35 $\Delta = 32^{\circ} 06' 43.9" (LT)$ $D = 5^{\circ} 43' 46.5"$ $L = 560.46'$ $T = 287.81'$ $R = 1,000.00'$ $e = 3.6$ $R_{\text{min}} = 108'$
--	---

-DRWI-

PI Sta 12+17.43 $\Delta = 17^{\circ} 16' 13.0" (LT)$ $D = 28^{\circ} 38' 52.4"$ $L = 60.28'$ $T = 30.37'$ $R = 200.00'$
--

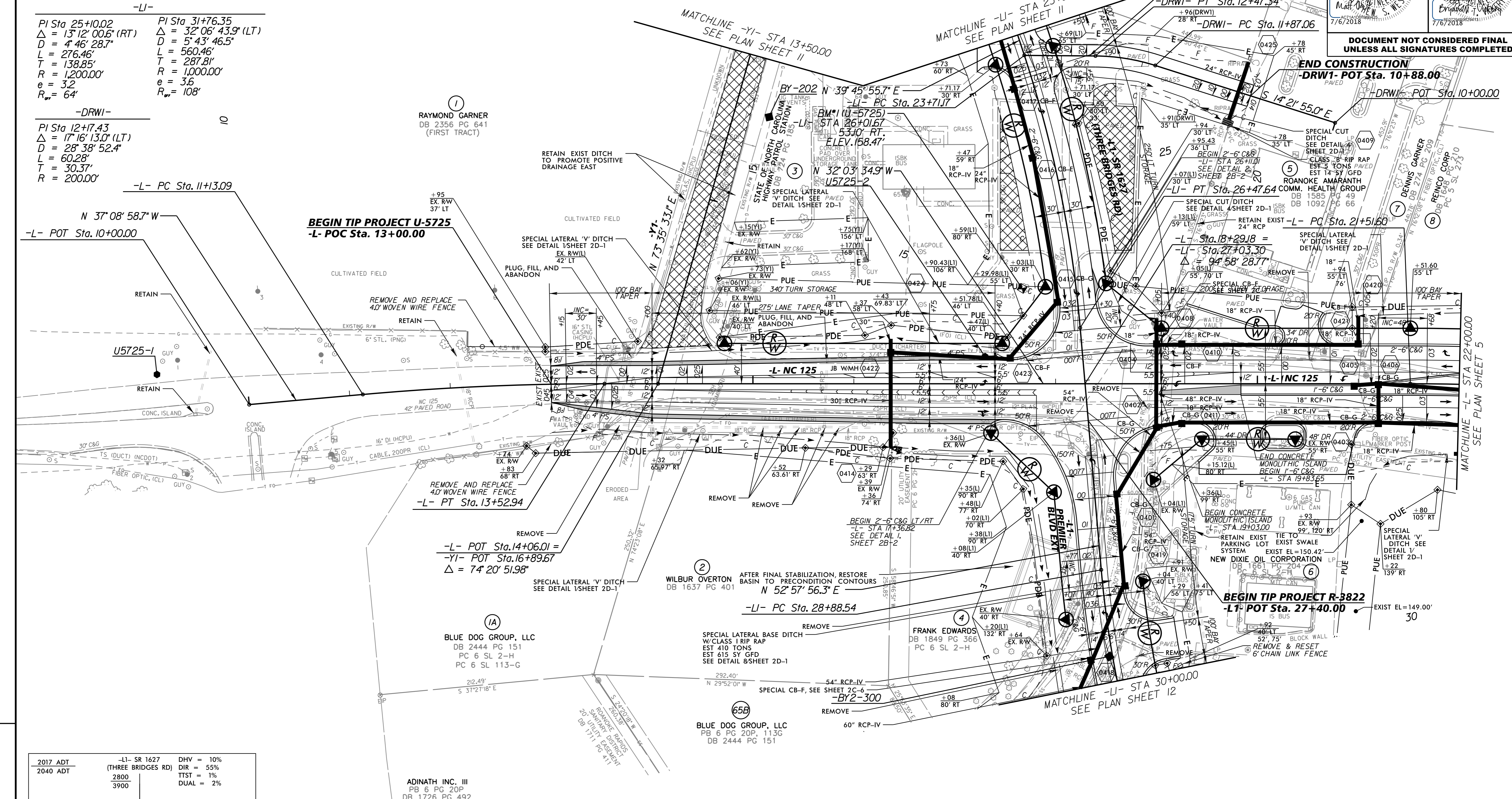

2017 ADT	-LI- SR 1627 (THREE BRIDGES RD)	DHV = 10%
2040 ADT	2800	DIR = 55%
	3900	TTST = 1%
		DUAL = 2%

9600	1000	1800	10400
15100	1400	2200	14400

-L- NC 125	0	-L- NC 125
DHV = 10%	2100	DHV = 9%
DIR = 55%		DIR = 60%
TTST = 1%		TTST = 1%
DUAL = 2%		DUAL = 2%

-LI- PREMIER BLVD EXT
DHV = 8%
DIR = 60%
TTST = 1%
DUAL = 2%

NOTE: ALL TEMPORARY SEDIMENT TRAPS SHALL BE REMOVED AND REGRADED TO PRECONSTRUCTION TOPOGRAPHY PRIOR TO PROJECT COMPLETION.

SEE SHEET NO. 20 FOR -L- PROFILE  
SEE SHEET NO. 24 FOR -LI- PROFILE  
SEE SHEET NO. 27 FOR -Y1- PROFILE  
SEE SHEET NO. 30 FOR -DRWI- PROFILE

7/6/2018