

5/14/99

# Kimley Horn

421 FAYETTEVILLE STREET, SUITE 600  
RALEIGH, N.C. 27601. NC LICENSE #F-0102

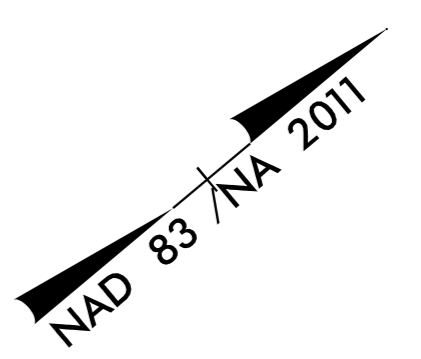

PROJECT REFERENCE NO. U-5725/R-3822		SHEET NO. 15	
RW SHEET NO.			
ROADWAY DESIGN ENGINEER		HYDRAULICS ENGINEER	
9/4/2018		9/4/2018	
<b>DOCUMENT NOT CONSIDERED FINAL UNLESS ALL SIGNATURES COMPLETED</b>			

-LI-

PI Sta 71+45.37 Δ = 15° 15' 37.8" (RT) D = 2' 36" 15.7" L = 585.96' T = 294.72' R = 2,200.00' e = RC R <sub>sup</sub> = 75'	PI Sta 85+81.84 Δ = 47° 06' 17.6" (LT) D = 2' 51" 53.2" L = 1,644.27' T = 871.80' R = 2,000.00' e = 2.6 R <sub>sup</sub> = 78'
--	---

(69)  
EDWARD L. DICKENS  
SEE NOTE IN SURVEY REPORT  
DB 1453 PG 116  
PB 19 PG 74

(70)  
EDWARD L. DICKENS  
DB 1809 PG 729

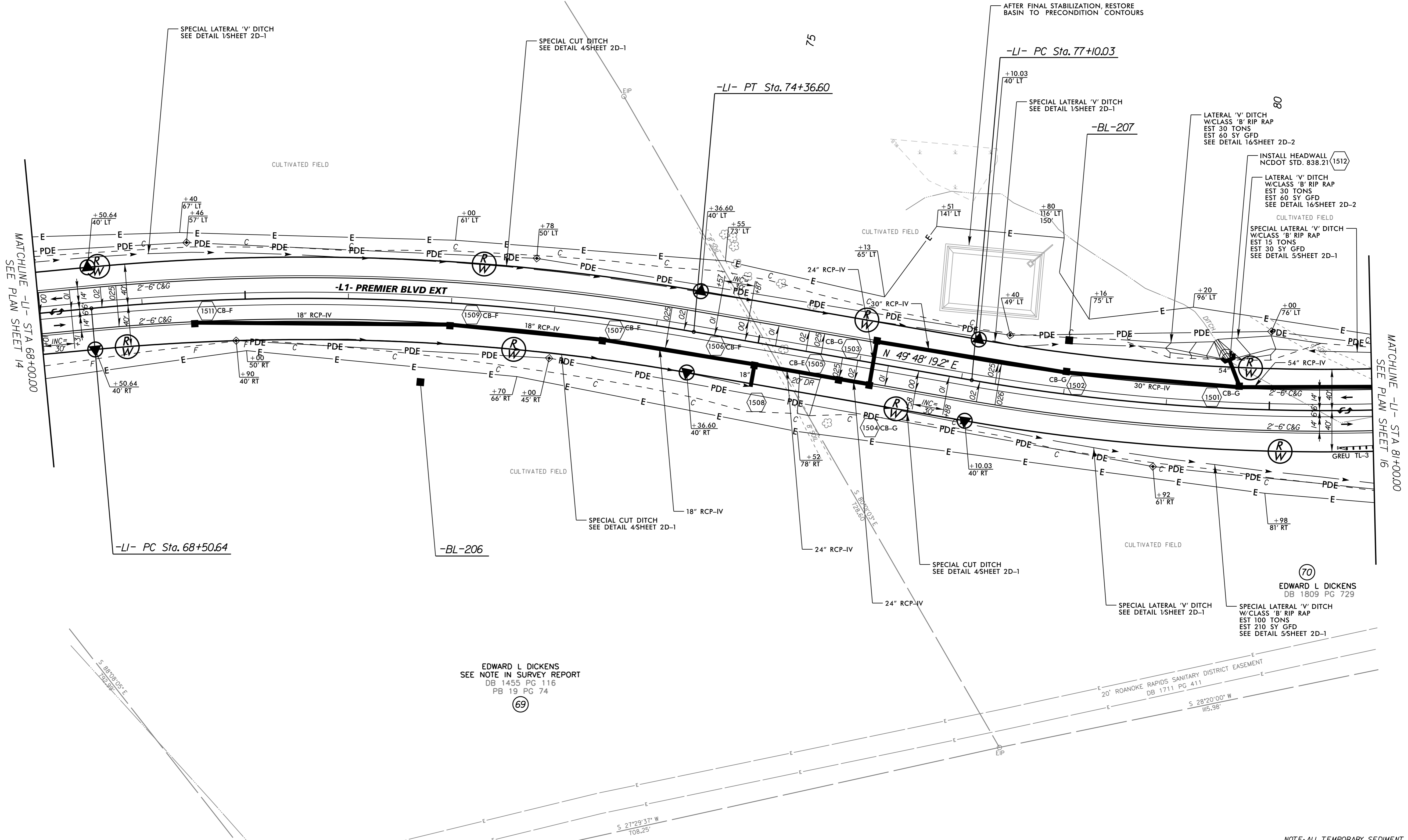

EDWARD L. DICKENS  
SEE NOTE IN SURVEY REPORT  
DB 1453 PG 116  
PB 19 PG 74  
(69)

(70)  
EDWARD L. DICKENS  
DB 1809 PG 729

REVISIONS

9/4/2018

NOTE: ALL TEMPORARY SEDIMENT TRAPS SHALL BE REMOVED AND REGRADED TO PRECONSTRUCTION TOPOGRAPHY PRIOR TO PROJECT COMPLETION.  
**SEE SHEET NO. 26 FOR -L1- PROFILE**