

6/2/99

PROJECT REFERENCE NO. SHEET NO.

R-3822B 1C-11

Location and Surveys

PROJECT SURVEYOR

SURVEY CONTROL SHEET R-3822B

W/EXISTING CENTERLINE ALIGNMENTS PRIOR TO CONSTRUCTION



REVISIONS

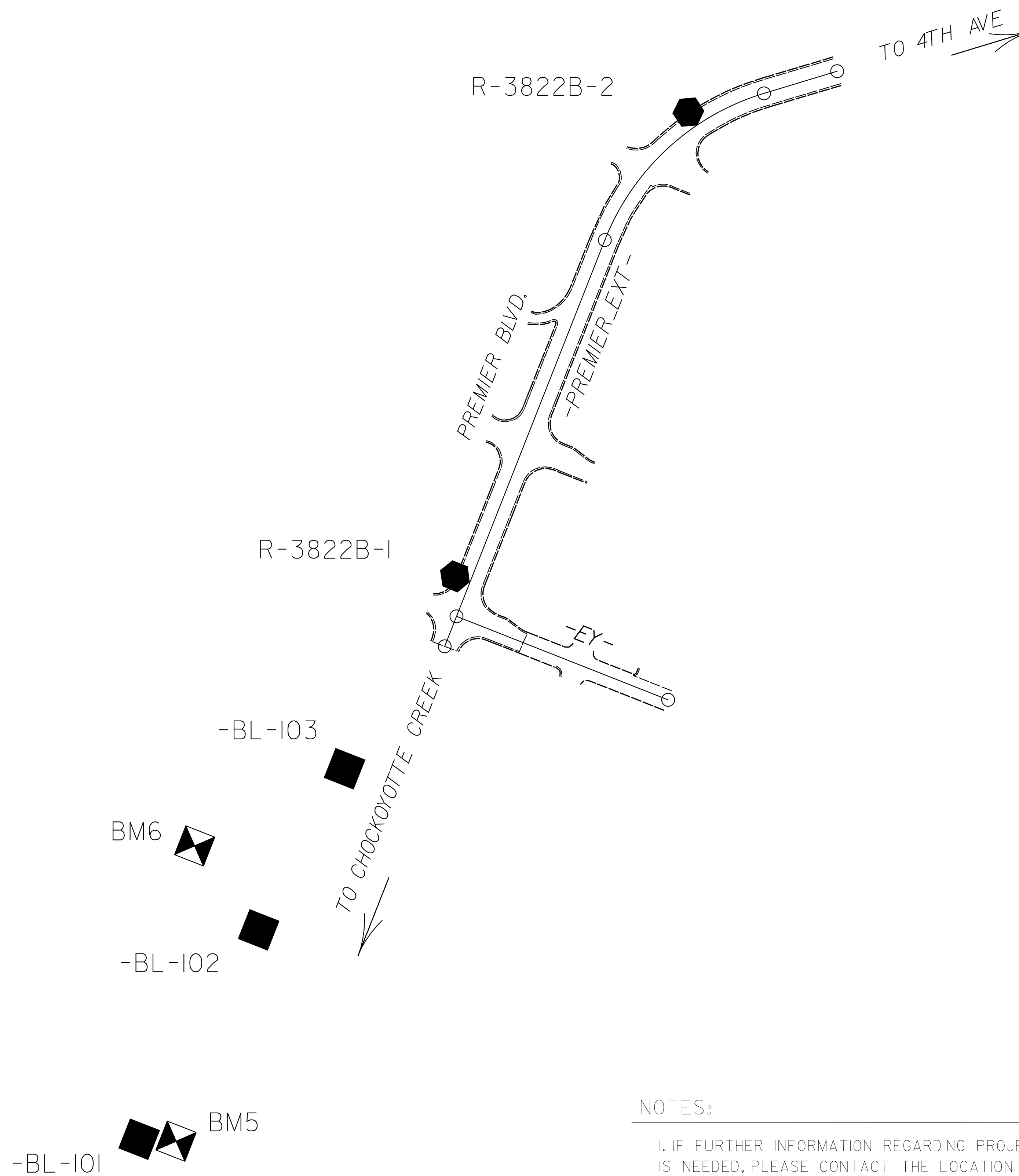

DATUM DESCRIPTION

THE LOCALIZED COORDINATE SYSTEM DEVELOPED FOR THIS PROJECT IS BASED ON THE STATE PLANE COORDINATES ESTABLISHED BY NCGS FOR MONUMENT "U-5725-3" WITH NAD 83/NA 2011 STATE PLANE GRID COORDINATES OF NORTHING: 972020.214(ft) EASTING: 2398028.208(ft) ELEVATION: 158.73(ft) THE AVERAGE COMBINED GRID FACTOR USED ON THIS PROJECT (GROUND TO GRID) IS: 0.9999214800 THE N.C. LAMBERT GRID BEARING AND LOCALIZED HORIZONTAL GROUND DISTANCE FROM "U-5725-3" TO -L- STATION IS

ALL LINEAR DIMENSIONS ARE LOCALIZED HORIZONTAL DISTANCES VERTICAL DATUM USED IS NAVD 88

NOTES:

1. IF FURTHER INFORMATION REGARDING PROJECT CONTROL IS NEEDED, PLEASE CONTACT THE LOCATION AND SURVEYS UNIT.
2. PROJECT CONTROL WAS ESTABLISHED USING GNSS, THE GLOBAL NAVIGATION SATELLITE SYSTEM.
3. NOTE: DRAWING NOT TO SCALE

6/28/2018