

6/2/99

PROJECT REFERENCE NO.	SHEET NO.
R-3822A	1C-9
Location and Surveys	
PROJECT SURVEYOR	

# SURVEY CONTROL SHEET R-3822A

W/EXISTING CENTERLINE ALIGNMENTS PRIOR TO CONSTRUCTION

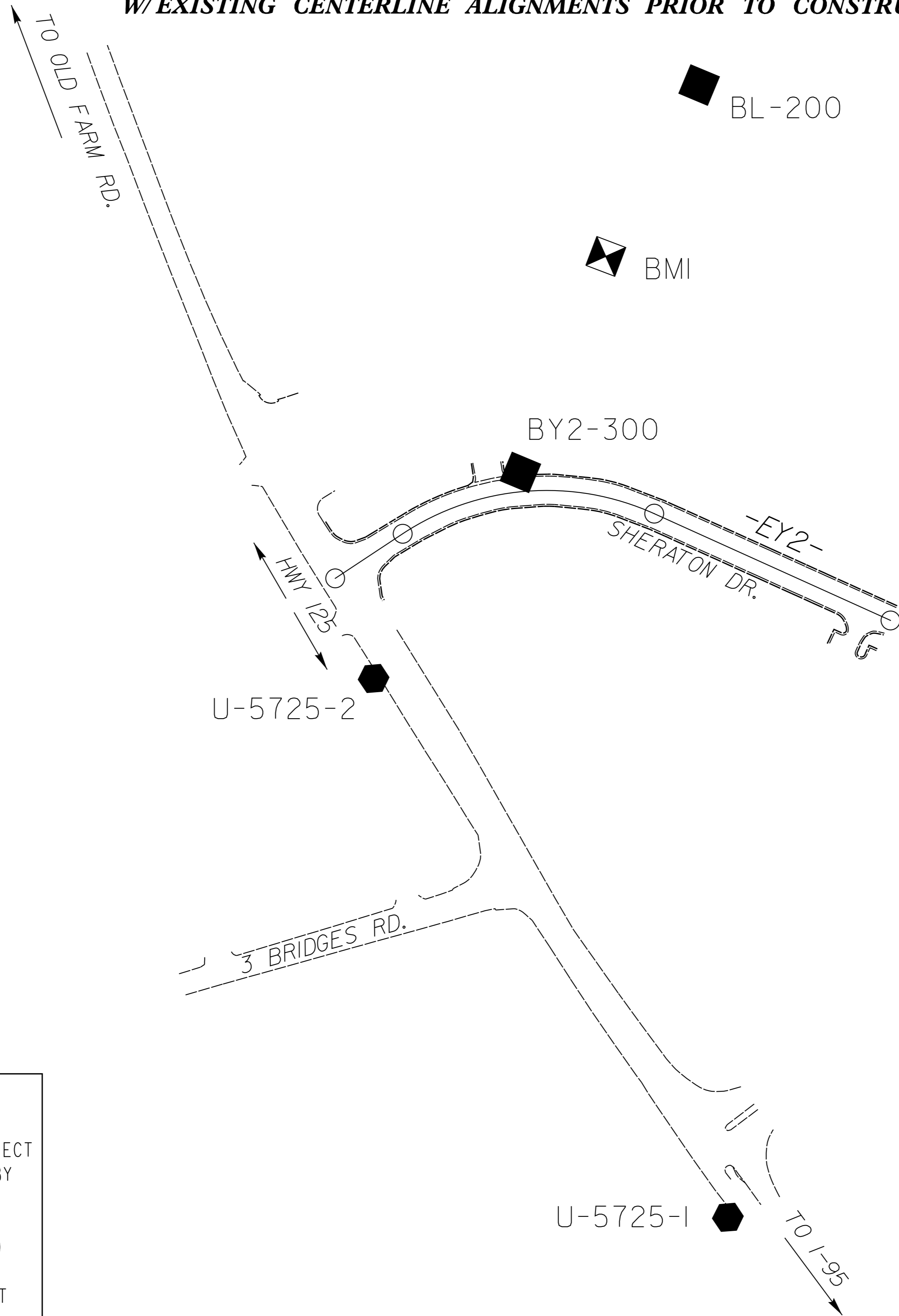

INSET FROM SHEET IC-8

## DATUM DESCRIPTION

THE LOCALIZED COORDINATE SYSTEM DEVELOPED FOR THIS PROJECT IS BASED ON THE STATE PLANE COORDINATES ESTABLISHED BY NCGS FOR MONUMENT "U-5725-3"

WITH NAD 83/NA 2011 STATE PLANE GRID COORDINATES OF  
 NORTHING: 972020.214(ft) EASTING: 2398028.208(ft)  
 ELEVATION: 158.73(ft)

THE AVERAGE COMBINED GRID FACTOR USED ON THIS PROJECT (GROUND TO GRID) IS: 0.9999214800

THE N.C. LAMBERT GRID BEARING AND LOCALIZED HORIZONTAL GROUND DISTANCE FROM "U-5725-3" TO -L- STATION IS

ALL LINEAR DIMENSIONS ARE LOCALIZED HORIZONTAL DISTANCES  
 VERTICAL DATUM USED IS NAVD 88

### NOTES:

1. IF FURTHER INFORMATION REGARDING PROJECT CONTROL IS NEEDED, PLEASE CONTACT THE LOCATION AND SURVEYS UNIT.
2. PROJECT CONTROL WAS ESTABLISHED USING GNSS, THE GLOBAL NAVIGATION SATELLITE SYSTEM.
3. NOTE: DRAWING NOT TO SCALE

REVISIONS

6/28/2018