

DOCUMENT NOT CONSIDERED FINAL
UNTIL ALL SIGNATURES ARE COMPLETED

NC GRID
NAD 83/NA 2011

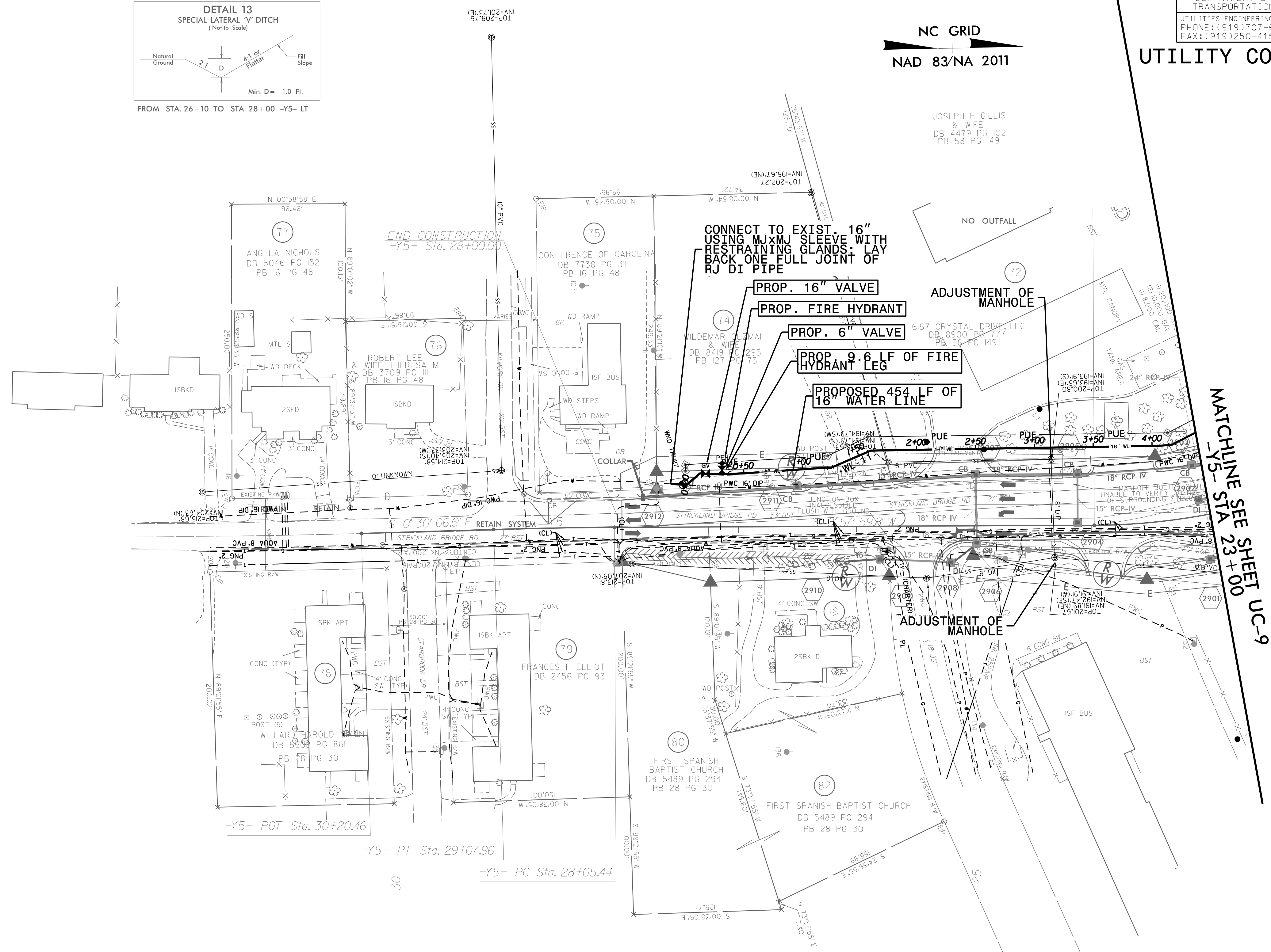
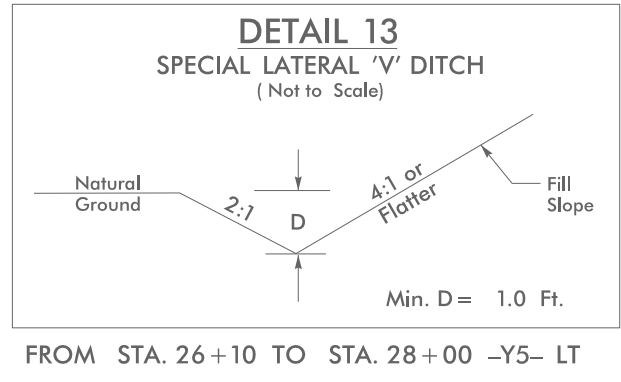

MATCHLINE SEE SHEET UC-9
-Y5- STA 23+00

PROPOSED 2,490 POUNDS OF
DUCTILE IRON WATER PIPE FITTINGS

-Y5-	
PI Sta 28+56.71	PI Sta 22+82.12
$\Delta = 1' 28' 06.4\"$ (LT)	$\Delta = 25' 18' 13.3\"$ (RT)
$D = 1' 25' 56.6\"$	$D = 10' 44' 58.8\"$
$L = 102.52'$	$L = 235.39'$
$T = 51.26'$	$T = 119.65'$
$R = 4,000.00'$	$R = 533.00'$
	$SE = 0.02$

NOTE:
SEE SHEET UC-38 FOR -WL-11 PROFILE

5/14/99
 3-MAY-2018 14:47
 L:\Projects\Public Works Commission\2015\017700RA Reeford Road NCDOT U 4405\CADD\NCDOT PLANS\Utilities\Engineering\UC\Proj\ud4405_ut_rdy29_uc29_psh.dgn
 chuman - AT 11/1/99