

PROJECT REFERENCE NO.	SHEET NO.
U-4405	EC-50/CONST.13
RW SHEET NO.	
ROADWAY DESIGN ENGINEER	HYDRAULICS ENGINEER

-L-
 PIs Sta 139+95.56 PI Sta 144+71.01
 $\Delta s = 1' 43' 07.9"$ $\Delta = 19' 18' 58.8" (RT)$
 $Ls = 150.00'$ $D = 2' 17' 30.6"$
 $LT = 100.00'$ $L = 842.83'$
 $ST = 50.00'$ $T = 425.45'$
 $R = 2,500.00'$
 $SE = 0.03$

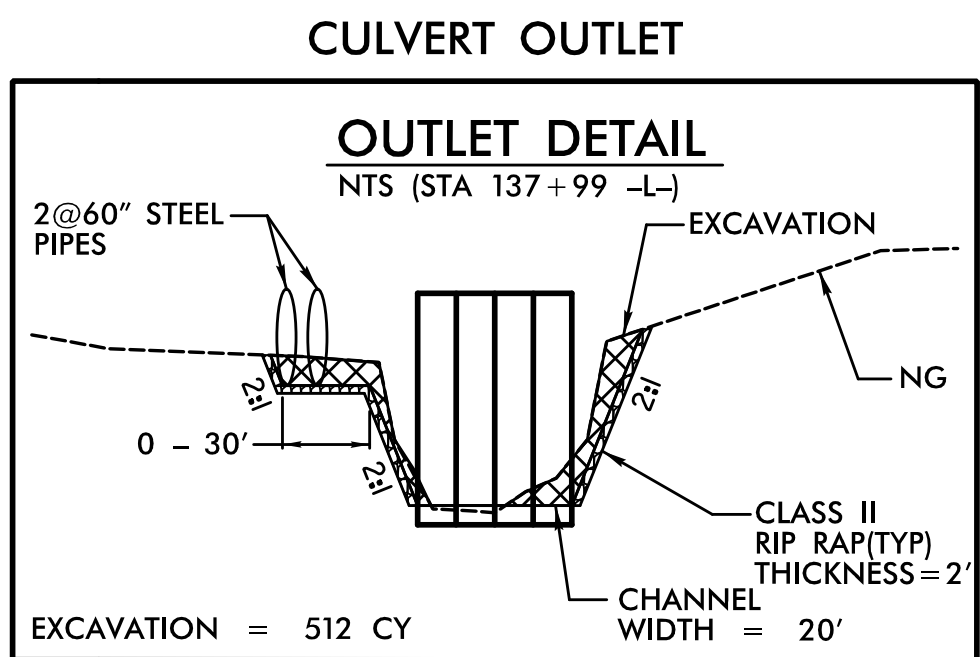
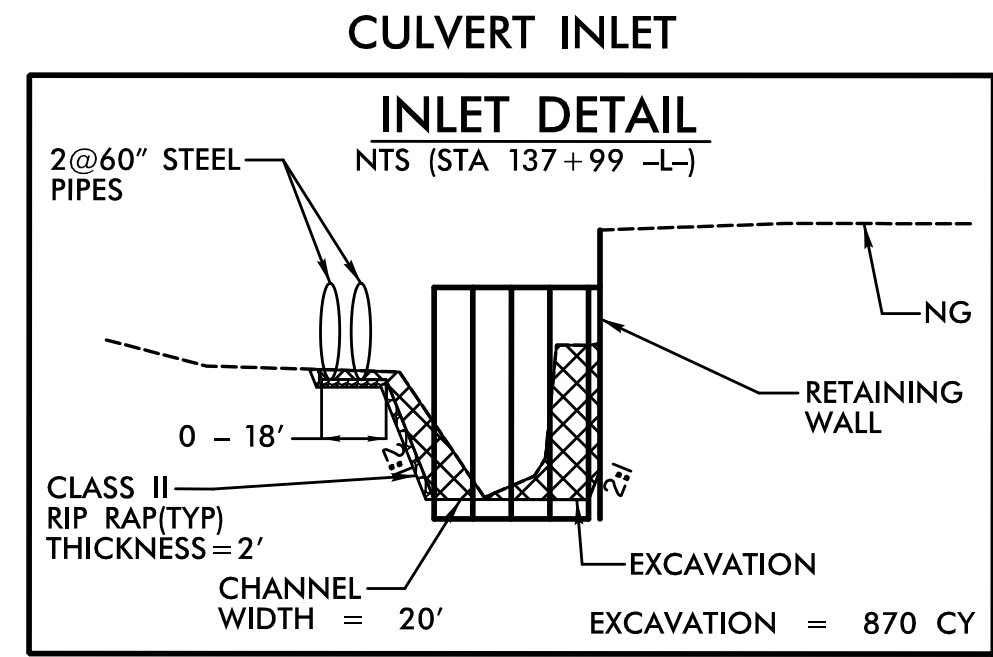

NOTES: ANY DEVIATION FROM OPTIONS GIVEN WILL REQUIRE PRIOR APPROVAL BY ENGINEER.

ADDITIONAL EROSION CONTROL DEVICES MAY NEED TO BE INSTALLED AS DIRECTED.

INSTALL FABRIC INSERT INLET PROTECTION DEVICE IN LIEU OF ROCK INLET SEDIMENT TRAP TYPE 'C' AS DIRECTED TO AVOID PONDING OF RUNOFF IN ROADWAY OPEN TO PUBLIC TRAFFIC

MATCHLINE SEE SHEET 12 -L- STA 128+00

MATCHLINE SEE SHEET 14 -L- STA 141+00

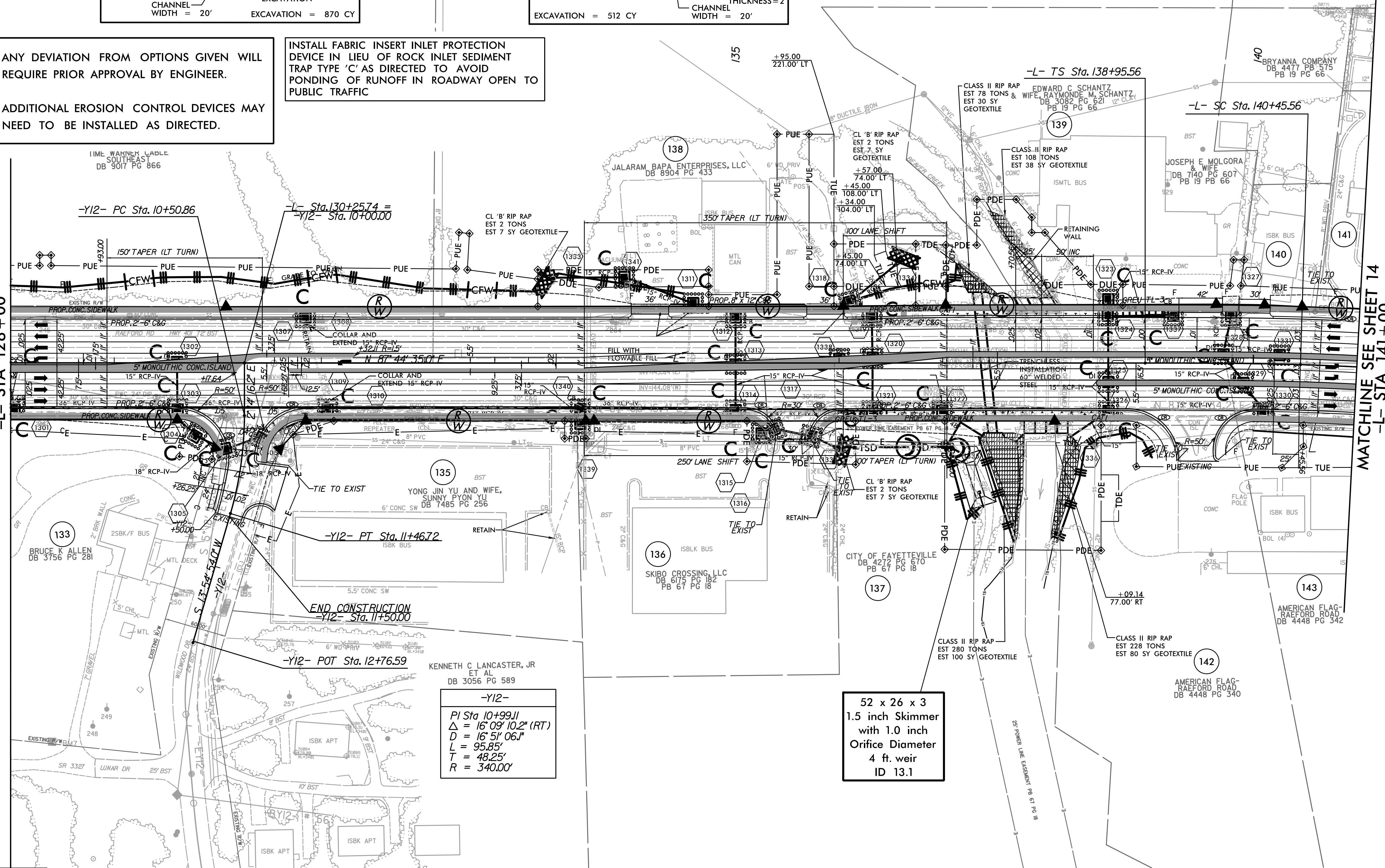

52 x 26 x 3
 1.5 inch Skimmer
 with 1.0 inch
 Orifice Diameter
 4 ft. weir
 ID 13.1

-Y12-
 PI Sta 10+99.11
 $\Delta = 16' 09' 10.2" (RT)$
 $D = 16' 51' 06.1"$
 $L = 95.85'$
 $T = 48.25'$
 $R = 340.00'$

NOTE: SEE SHEET 37 FOR -L- PROFILE
 SEE SHEET 47 FOR -Y12- PROFILE

** A DESIGN EXCEPTION FOR LANE WIDTH IS REQUIRED FOR -L- STA. 38+95.00 TO -L- 319+95.00

REVISIONS

8/17/99
 R:\Environmental\Design\4405_REU_EC_psh_13_Final.dgn
 10:36:02 AM
 R:\Environmental\Design\4405_REU_EC_psh_13_Final.dgn