

5/28/18

**-SR2-**

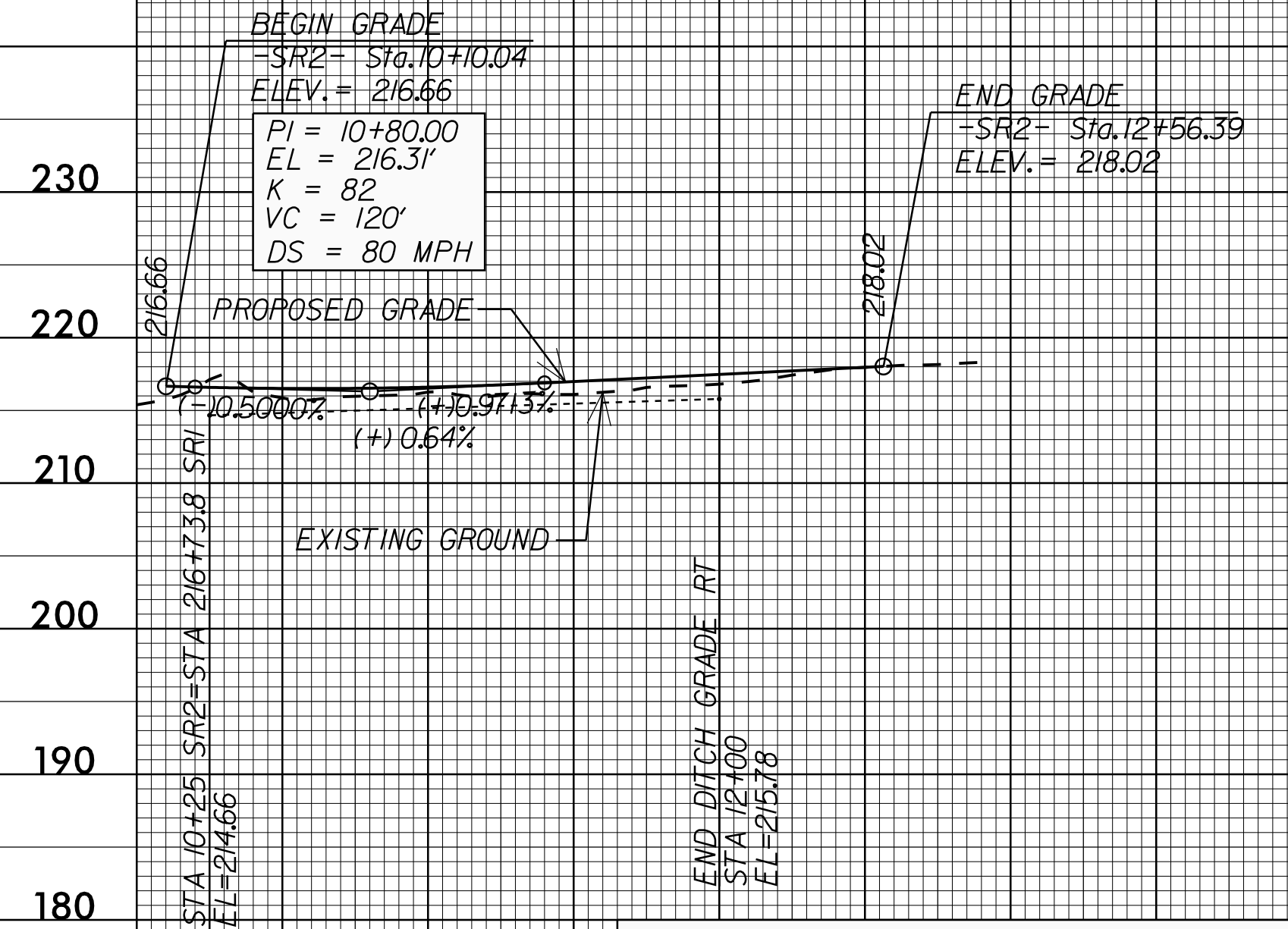

**NOTE: SEE SHEET 28 FOR -SR2- PLAN VIEW**

PI = 12+65.00  
EL = 219.17'  
VC = 95'  
K = 30  
DS = 35 MPH

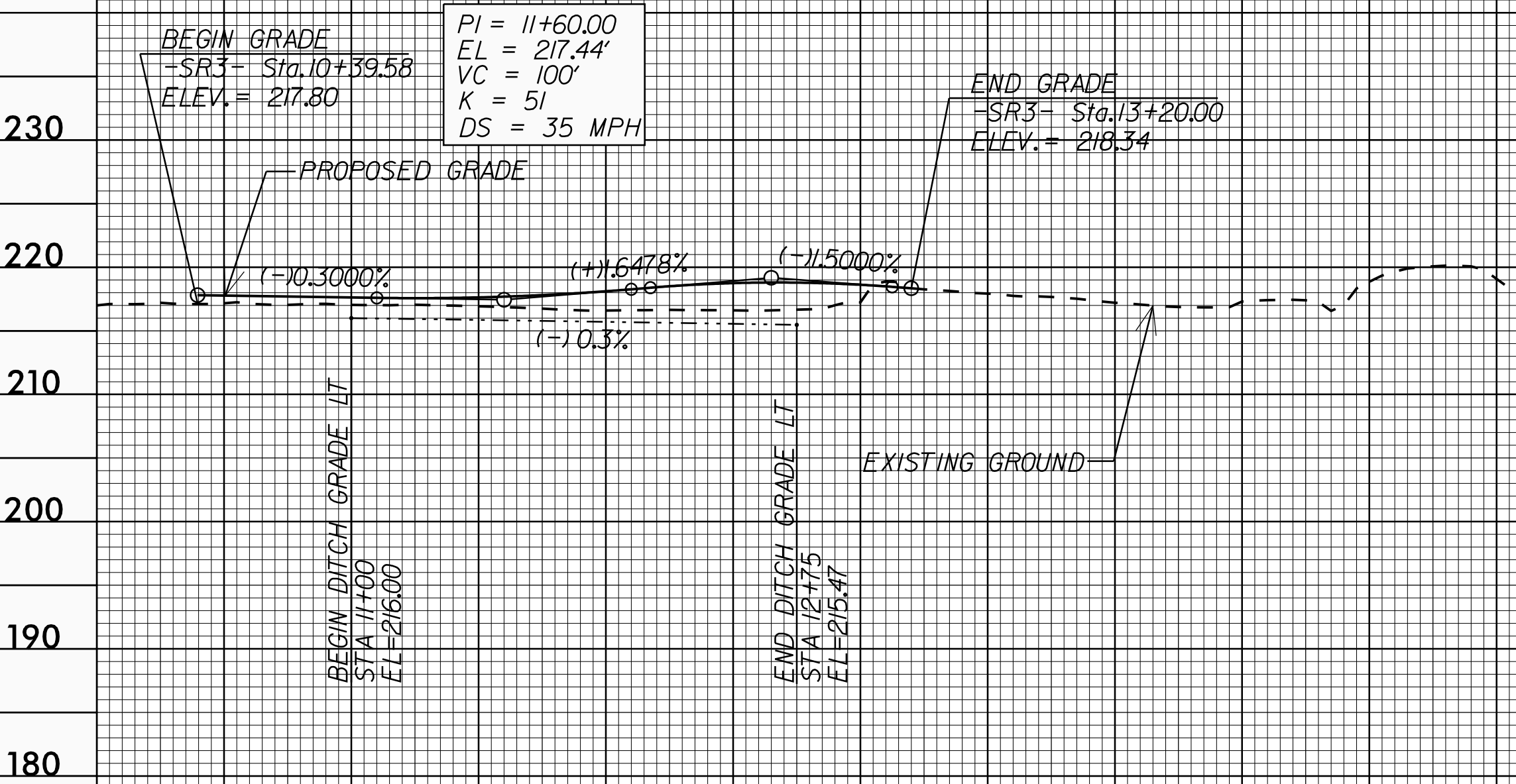

**NOTE: SEE SHEET 6 & 28 FOR -SR3- PLAN VIEW**

**-SR3-**

PROJECT REFERENCE NO. U-4405	SHEET NO. 51
ROADWAY DESIGN ENGINEER CLINTON J. MORRIS SEAL 20147 NORTH CAROLINA PROFESSIONAL ENGINEER	HYDRAULICS ENGINEER FRANK F. FLEMING SEAL 20147 NORTH CAROLINA PROFESSIONAL ENGINEER

**DOCUMENT NOT CONSIDERED FINAL UNLESS ALL SIGNATURES COMPLETED**

DITCH LEGEND	
LEFT DITCH	-----
RIGHT DITCH	-----