

PROJECT REFERENCE NO. U-4405		SHEET NO. 27	
RW SHEET NO.		HYDRAULICS ENGINEER	
ROADWAY DESIGN ENGINEER		SEAL	
<b>DOCUMENT NOT CONSIDERED FINAL UNLESS ALL SIGNATURES COMPLETED</b>			

NC GRID  
NAD 83/NA 2011

END TIP PROJECT U-4405  
-L- Sta. 324+00.00

-L-  
PI Sta 320+13.00  
 $\Delta = 43^{\circ} 34' 29.9" (LT)$   
 $D = 8^{\circ} 00' 48.2"$   
 $L = 543.78'$   
 $T = 285.80'$   
 $R = 715.00'$   
 $SE = 0.04$

MATCHLINE SEE SHEET 26  
-L- STA 309+50

MATCHLINE SEE SHEET 32  
-Y43- STA 13+00

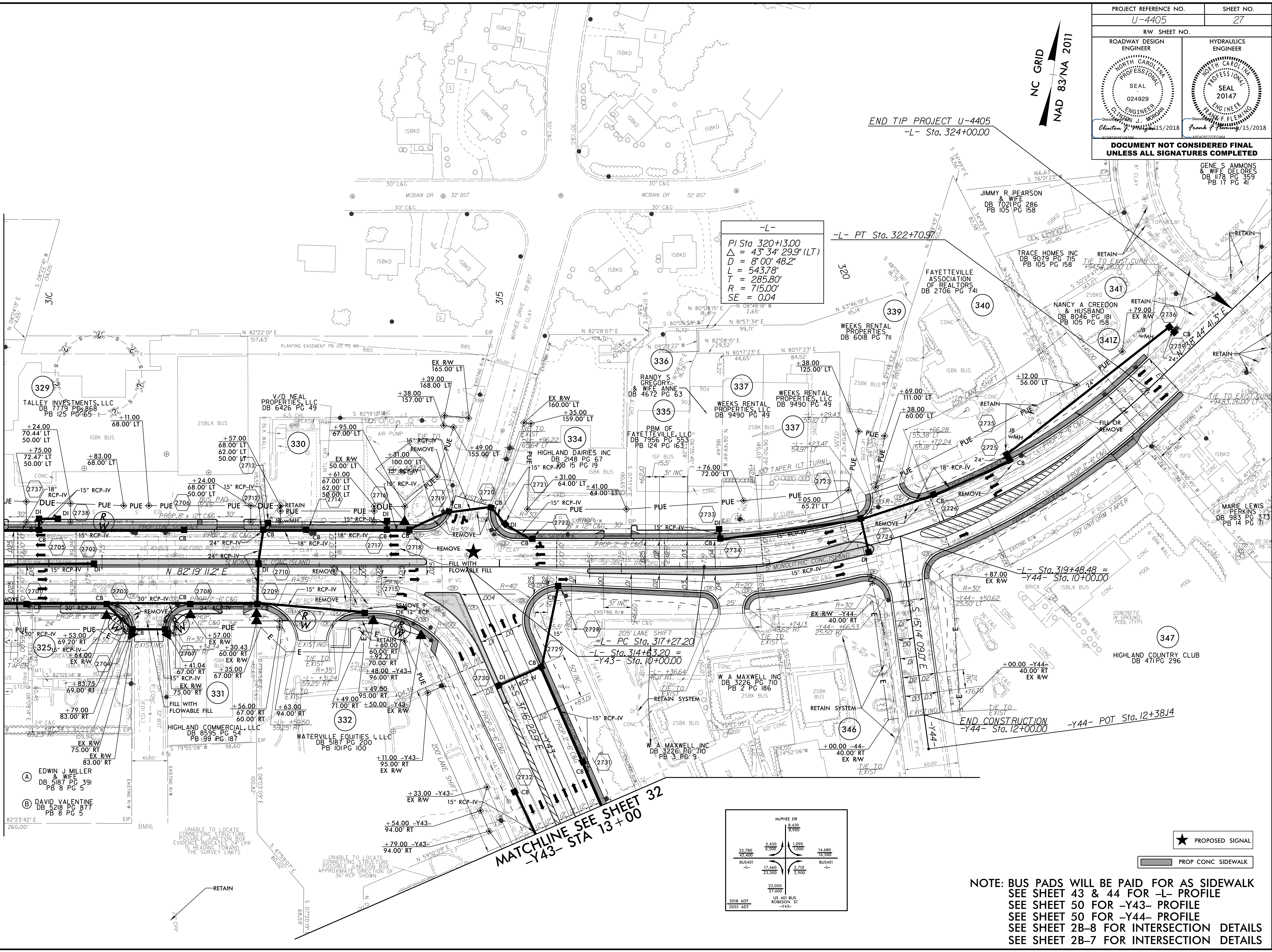

- (A) EDWIN J MILLER  
DB 5187 PG 391  
PB 8 PG 5
- (B) DAVID VALENTINE  
DB 5218 PG 877  
PB 8 PG 5

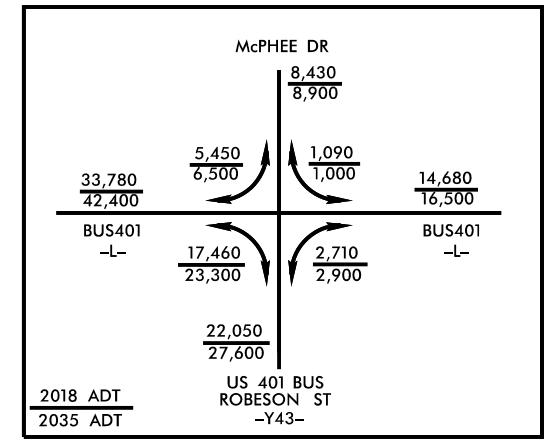

- PROPOSED SIGNAL
- PROP CONC SIDEWALK

NOTE: BUS PADS WILL BE PAID FOR AS SIDEWALK  
SEE SHEET 43 & 44 FOR -L- PROFILE  
SEE SHEET 50 FOR -Y43- PROFILE  
SEE SHEET 50 FOR -Y44- PROFILE  
SEE SHEET 2B-8 FOR INTERSECTION DETAILS  
SEE SHEET 2B-7 FOR INTERSECTION DETAILS

REVISIONS

8/17/99  
 1/11/2018 22:12  
 R:\Projects\4405\rdw\psh\_27.dgn  
 1/11/2018 22:12  
 R:\Projects\4405\rdw\psh\_27.dgn