

5/28/19 5:28/19 31 MAY 2018 14:27 L:\Projects\2018\20180517\00RA_Reeford Road Commission\2015017700RA_Reeford Road NCDOT U 4405\CADD\NCDOT PLANS\Utilities\Engineering\UC\Proj\U4405.ut.pfl_uc57_psh.dgn

DOCUMENT NOT CONSIDERED FINAL
UNTIL ALL SIGNATURES ARE COMPLETED

PROJECT REFERENCE NO.	U-4405	SHEET NO.	UC-57
DESIGNED BY:	AMH		
DRAWN BY:	AMH/AB		
CHECKED BY:	AMH		
APPROVED BY:	MWF		
REVISED:		NORTH CAROLINA DEPARTMENT OF TRANSPORTATION UTILITIES ENGINEERING SECTION PHONE: (919) 707-6699 FAX: (919) 250-4151	
		6/12/2018 UTILITIES CONSTRUCTION PLANS ONLY	

UTILITY CONSTRUCTION

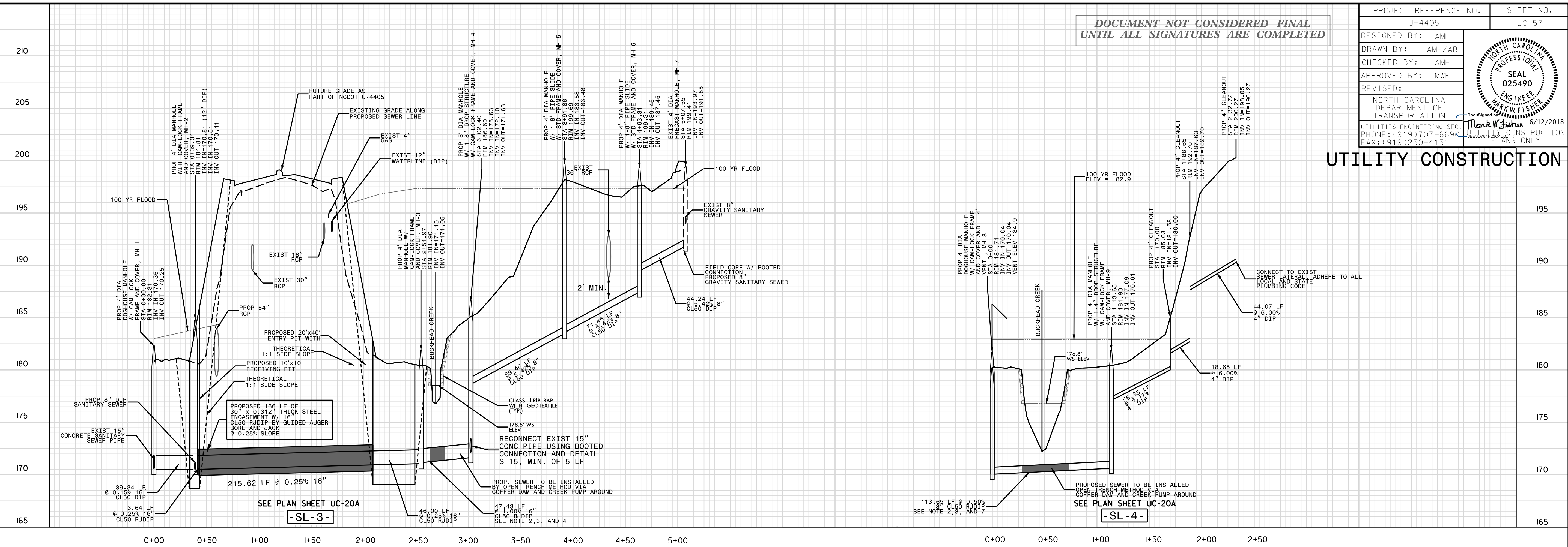

NOTES:

- PIPE THROUGH ENCASUREMENT AND FOR SUBMERGED STREAM CROSSINGS SHALL BE FACTORY RESTRAINED.
- SEWERS CROSSING STREAMS SHALL BE HYDROSTATICALLY TESTED TO 200 PSI ACCORDING TO THE NCDOT STANDARD SPECIFICATIONS FOR ROADS AND STRUCTURES.
- STREAM CROSSINGS SHALL NOT HAVE JOINTS BELOW STREAM CHANNEL (NORMAL WATER SURFACE ELEVATION) OR WITHIN TWO FEET OF BANKS UNLESS OTHERWISE NOTED
- PROP. RIM ELEVATION IS DESIGNED BASED ON OWNER'S REQUIREMENT OF EXIST 18" ABOVE EXIST. GRADE. MANHOLE ELEVATION WILL BE ADJUSTED AS PART OF ROAD CONTRACT AND HAS NOT BEEN INCLUDED IN THIS CONTRACT.
- SINCE SUBMERGED CREEK CROSSING EXCEEDS 20 LF, NOTE 4 IS EXEMPTED FOR THIS CROSSING ATTEMPT TO KEEP JOINTS OUTSIDE OF NORMAL WATER SURFACE TO THE EXTENT POSSIBLE.