

UTILITY CONSTRUCTION

**DOCUMENT NOT CONSIDERED FINAL
UNTIL ALL SIGNATURES ARE COMPLETED**

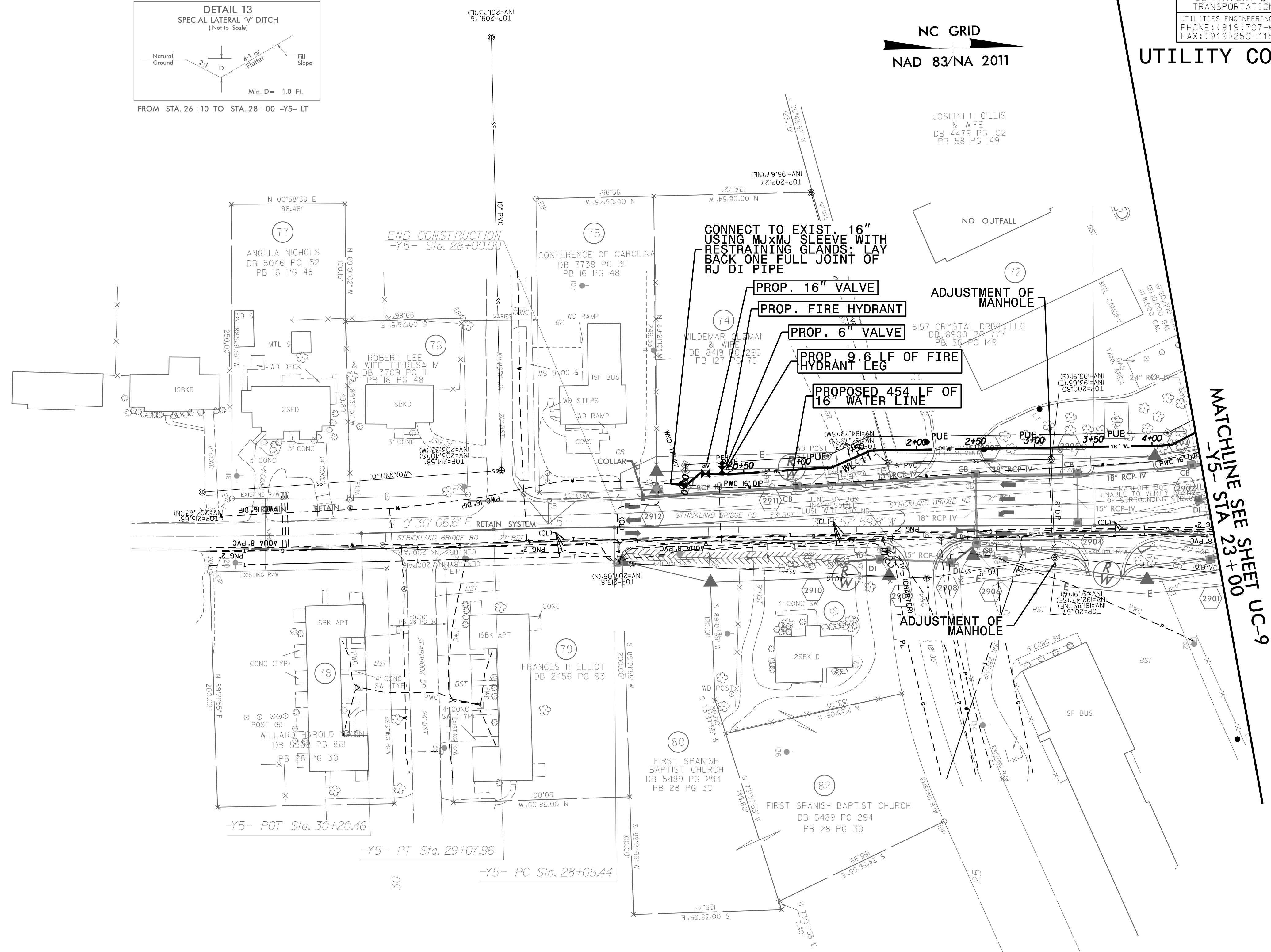
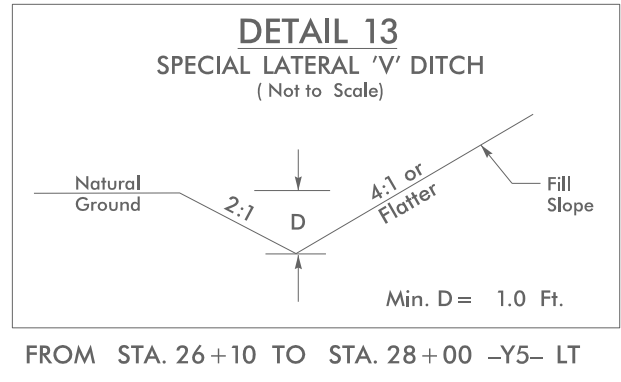

MATCHLINE SEE SHEET UC-9
-Y5- STA 23+00

**PROPOSED 2,490 POUNDS OF
DUCTILE IRON WATER PIPE FITTINGS**

| | |
|-------------------------------|--------------------------------|
| -Y5- | |
| PI Sta 28+56.71 | PI Sta 22+82.12 |
| $\Delta = 1' 28' 06.4\"$ (LT) | $\Delta = 25' 18' 13.3\"$ (RT) |
| $D = 1' 25' 56.6\"$ | $D = 10' 44' 58.8\"$ |
| $L = 102.52'$ | $L = 235.39'$ |
| $T = 51.26'$ | $T = 119.65'$ |
| $R = 4,000.00'$ | $R = 533.00'$ |
| | $SE = 0.02$ |

NOTE:
SEE SHEET UC-38 FOR -WL-11 PROFILE

5/14/99
3-MAY-2018 14:47
L:\Projects\Public Works Commission\2015017700RA Reeford Road NCDOT U 4405\CADD\NCDOT PLANS\Utilities\Engineering\UC\Proj\ud4405_ut_rdy29_uc29_psh.dgn
chuman - AT 11/21/99