

PROJECT REFERENCE NO.	SHEET NO.
U-4405	EC-60/CONST.23
RW SHEET NO.	
ROADWAY DESIGN ENGINEER	HYDRAULICS ENGINEER

NOTES: ANY DEVIATION FROM OPTIONS GIVEN WILL REQUIRE PRIOR APPROVAL BY ENGINEER.

ADDITIONAL EROSION CONTROL DEVICES MAY NEED TO BE INSTALLED AS DIRECTED.

INSTALL FABRIC INSERT INLET PROTECTION DEVICE IN LIEU OF ROCK INLET SEDIMENT TRAP TYPE 'C' AS DIRECTED TO AVOID PONDING OF RUNOFF IN ROADWAY OPEN TO PUBLIC TRAFFIC

-L-
 Pls Sta 258+90.08
 $\theta_s = 0^\circ 31' 15.1''$
 $L_s = 100.00'$
 $LT = 66.67'$
 $ST = 33.33'$

-Y29-
 PI Sta 12+84.20
 $\Delta = 4^\circ 24' 27.7'' (RT)$
 $D = 3^\circ 57' 05.2''$
 $L = 111.55'$
 $T = 55.80'$
 $R = 1,450.00'$

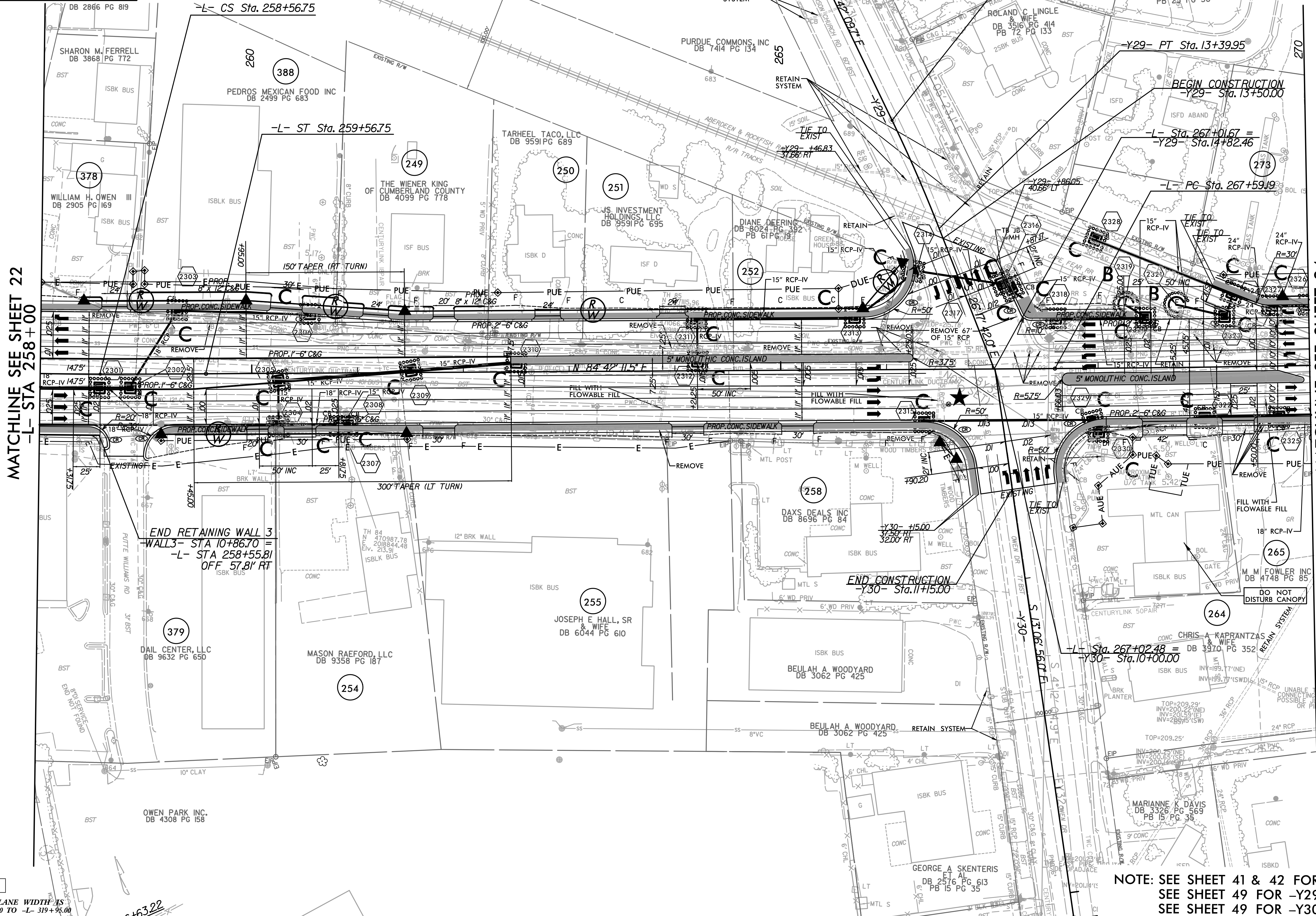

MATCHLINE SEE SHEET 22
-L- STA 258+00

MATCHLINE SEE SHEET 24
-L- STA 270+00

NC GRID
NAD 83/NA 2011

- ★ PROPOSED SIGNAL
- ▬ PROP CONC SIDEWALK

** A DESIGN EXCEPTION FOR LANE WIDTH IS REQUIRED FOR -L- STA. 38+95.00 TO -L- 319+95.00

NOTE: SEE SHEET 41 & 42 FOR -L- PROFILE
 SEE SHEET 49 FOR -Y29- PROFILE
 SEE SHEET 49 FOR -Y30- PROFILE

REVISIONS

10:38:58 AM R:\Environmental\Design\4405.REU.EC.psh_23.fina1.dgn 8/17/99