

TIP NO. W-5601EV	SHEET NO. PMP-6
APPROVED: _____	
DATE: _____	
SEAL	
5/24/2018	
DOCUMENT NOT CONSIDERED FINAL UNLESS ALL SIGNATURES COMPLETED	

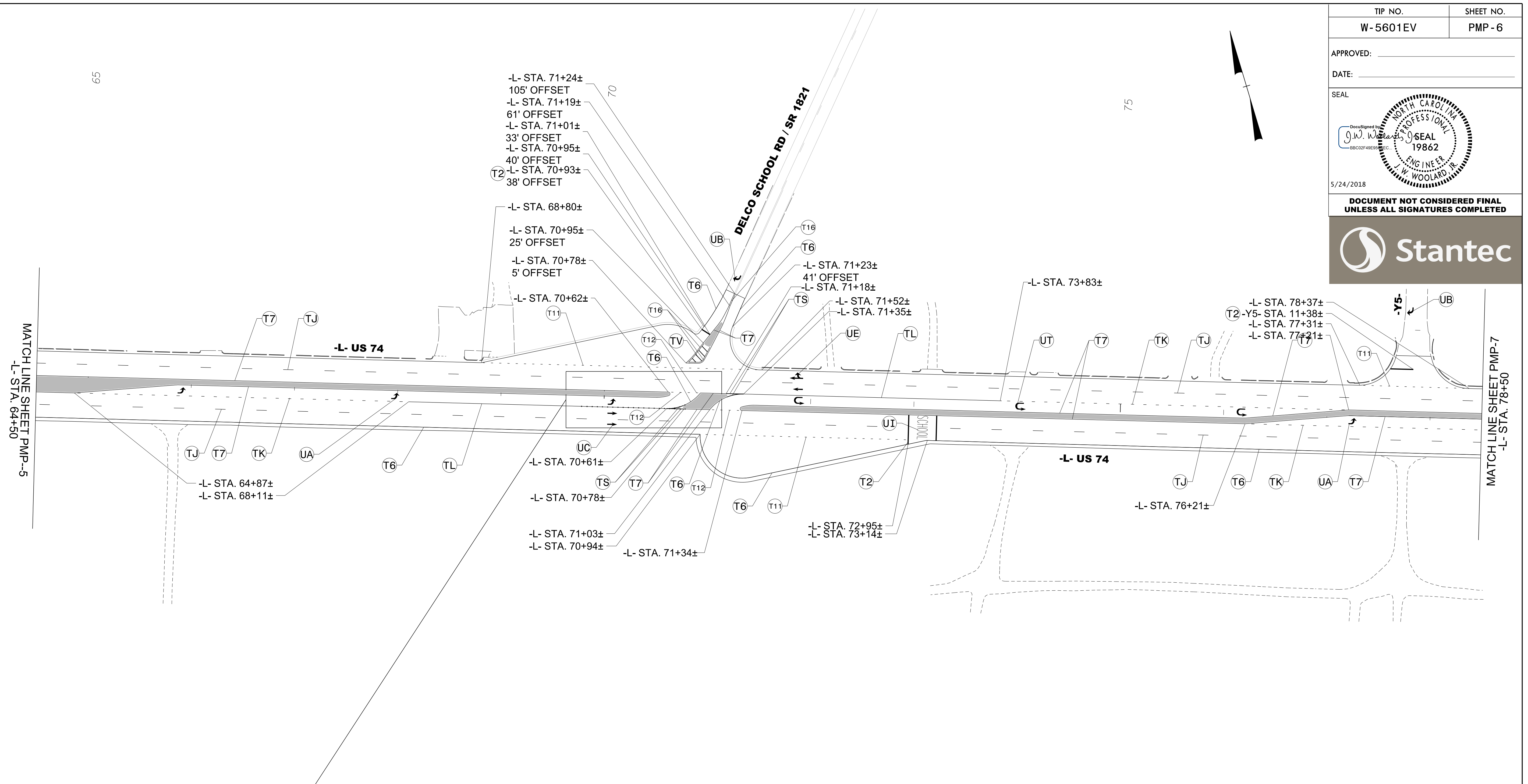

TUBULAR MARKER INSET

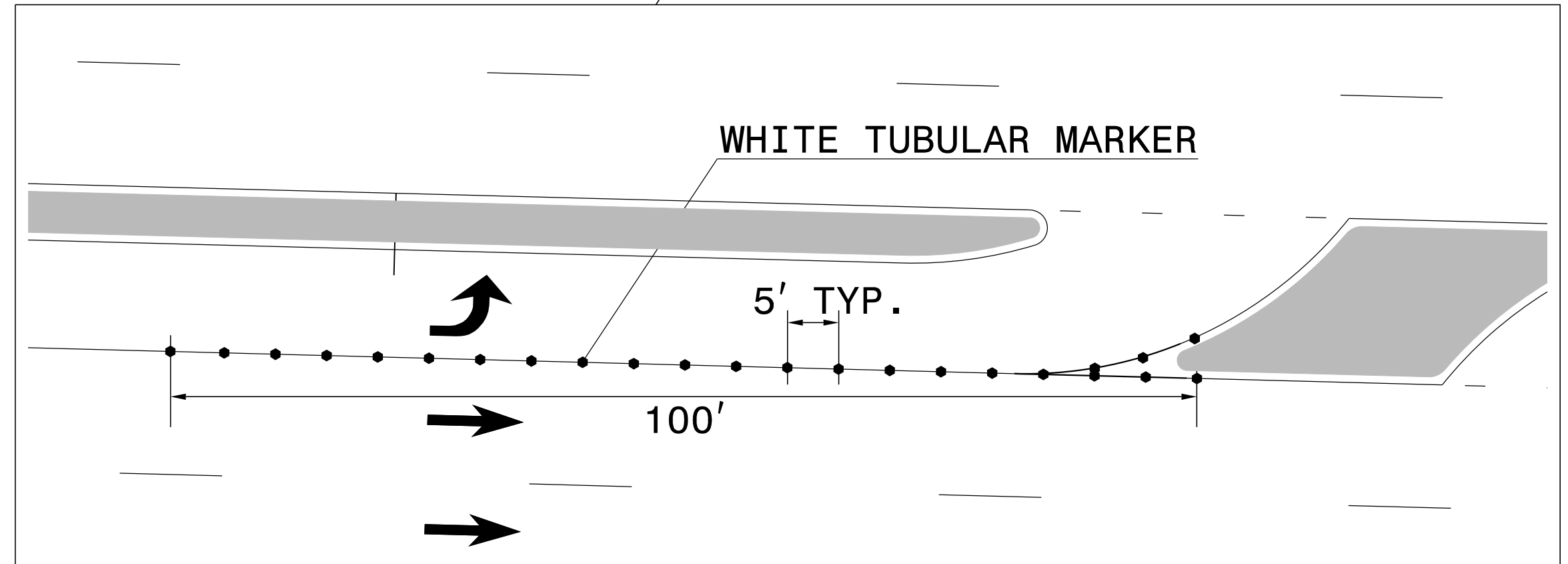

REFER TO ROADWAY STANDARD DRAWING 1266.01 SHEET 1 OF 1 FOR TUBULAR MARKER ASSEMBLY

THERMOPLASTIC PAVEMENT MARKING LEGEND	
(UA) LEFT TURN ARROW	(T2) WHITE STOPBAR (24")
(UB) RIGHT TURN ARROW	(T6) WHITE EDGELINE (6")
(UC) STRAIGHT ARROW	(T7) YELLOW EDGELINE (6")
(UE) STRAIGHT/RIGHT ARROW	(T11) 2 FT-6 FT/SP WHITE MINISKIP (6")
(UI) ONLY ALPHANUMERIC CHARACTERS	(T12) 2 FT-6 FT/SP YELLOW MINISKIP (6")
(UT) U-TURN ARROW	(T16) YELLOW DOUBLE CENTER (6")
	(TJ) 10 FT WHITE SKIP (6")
	(TK) 3 FT - 9 FT/SP WHITE MINISKIP (6")
	(TL) WHITE SOLID LANE LINE (6")
	(TS) WHITE GORELINE (12")
	(TV) YELLOW DIAGONAL (12")

PAVEMENT MARKING DETAIL

5/24/2018 UsTraffic\Signing\CADD\pmp\plan_sheets\W-5601EV_pmp_06.dgn