

- -Y1- DETOUR ROUTE
- ▶ -Y2-/Y3- DETOUR ROUTE

NOTE: -Y2- DEW OIL PLANT RD MAY NOT BE CLOSED WHILE -Y1- OR -Y3- IS CLOSED FOR DRAINAGE WORK.

CONSTRUCT DRAINAGE WORK FOR -Y1- WATER TANK RD, -Y2- DEW OIL PLANT RD, AND -Y3- KAISER RD UNDER WEEKEND CLOSURE.

***COORDINATE MEDIAN CONSTRUCTION WITH -Y- LINE CLOSURES AS NECESSARY.**

****NOTE: BARRICADES AND DETOUR SIGNS SHOWN ARE FOR -Y1- CLOSURE ONLY.**

FOR -Y2- AND -Y3- CLOSURES, REVISE SIGNAGE, BARRICADES, AND LOCATIONS ACCORDINGLY FOR EACH CLOSURE.

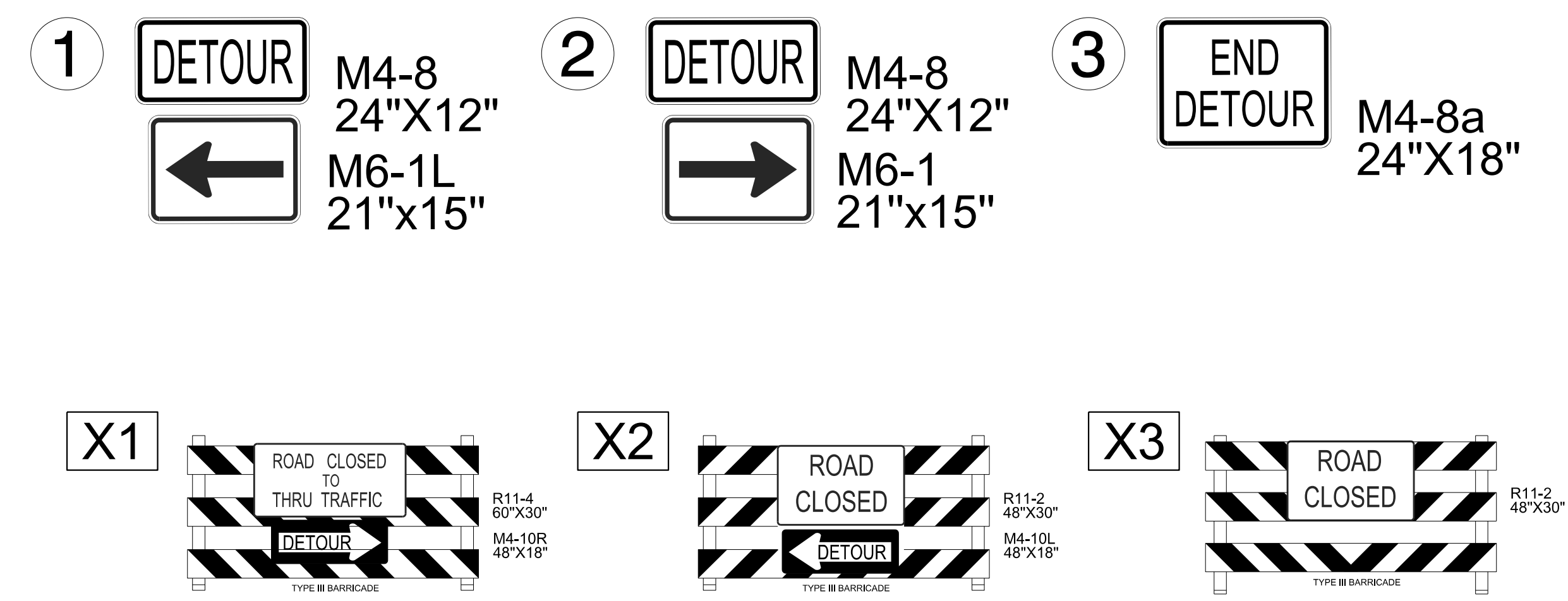
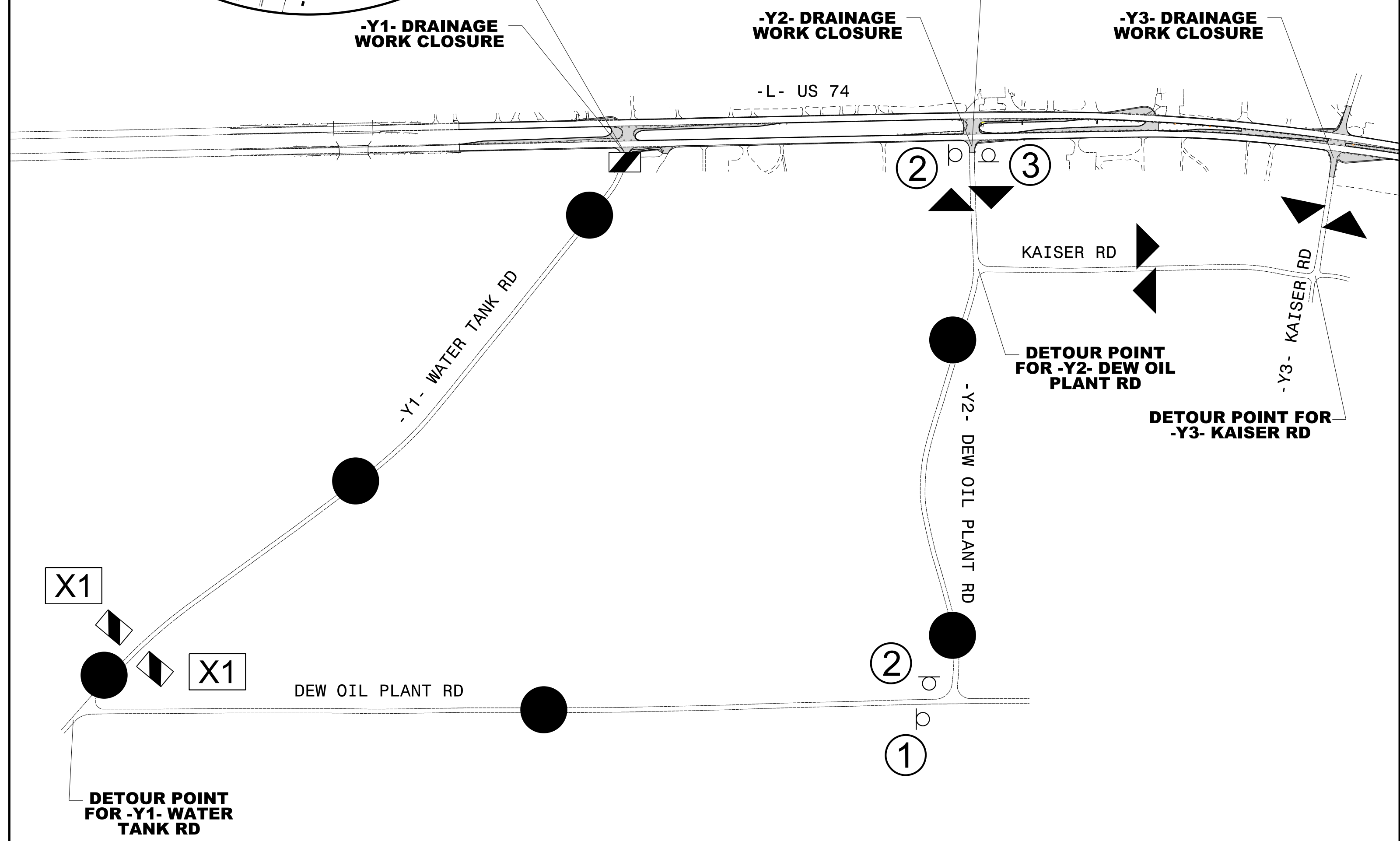

6/14/2018
U:\Traffic\Transportation Management Plan\TCP\PLAN SHEETS\W-5601EV_TMP_05_PHASE 1_DRAINAGE_DETLOUR.dgn
cowings

Stantec Consulting Services Inc.
801 Jones Franklin Road
Suite 300
Raleigh, NC 27606
Tel. 919.851.6866
Fax. 919.851.7024
www.stantec.com
License No. F-0672

**DOCUMENT NOT CONSIDERED FINAL
UNLESS ALL SIGNATURES COMPLETED**

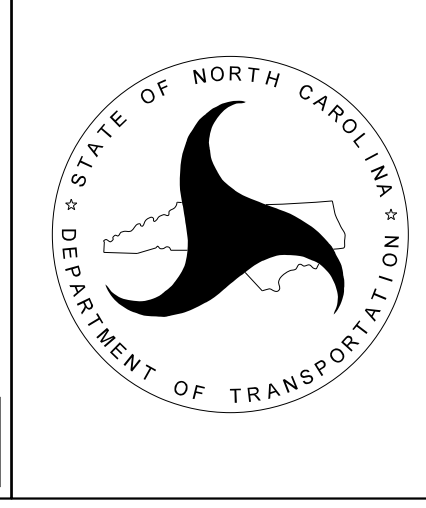

**-Y1- WATER TANK RD,
-Y2- DEW OIL PLANT RD,
& -Y3- KAISER RD
DETOUR ROUTES**