

8/17/99

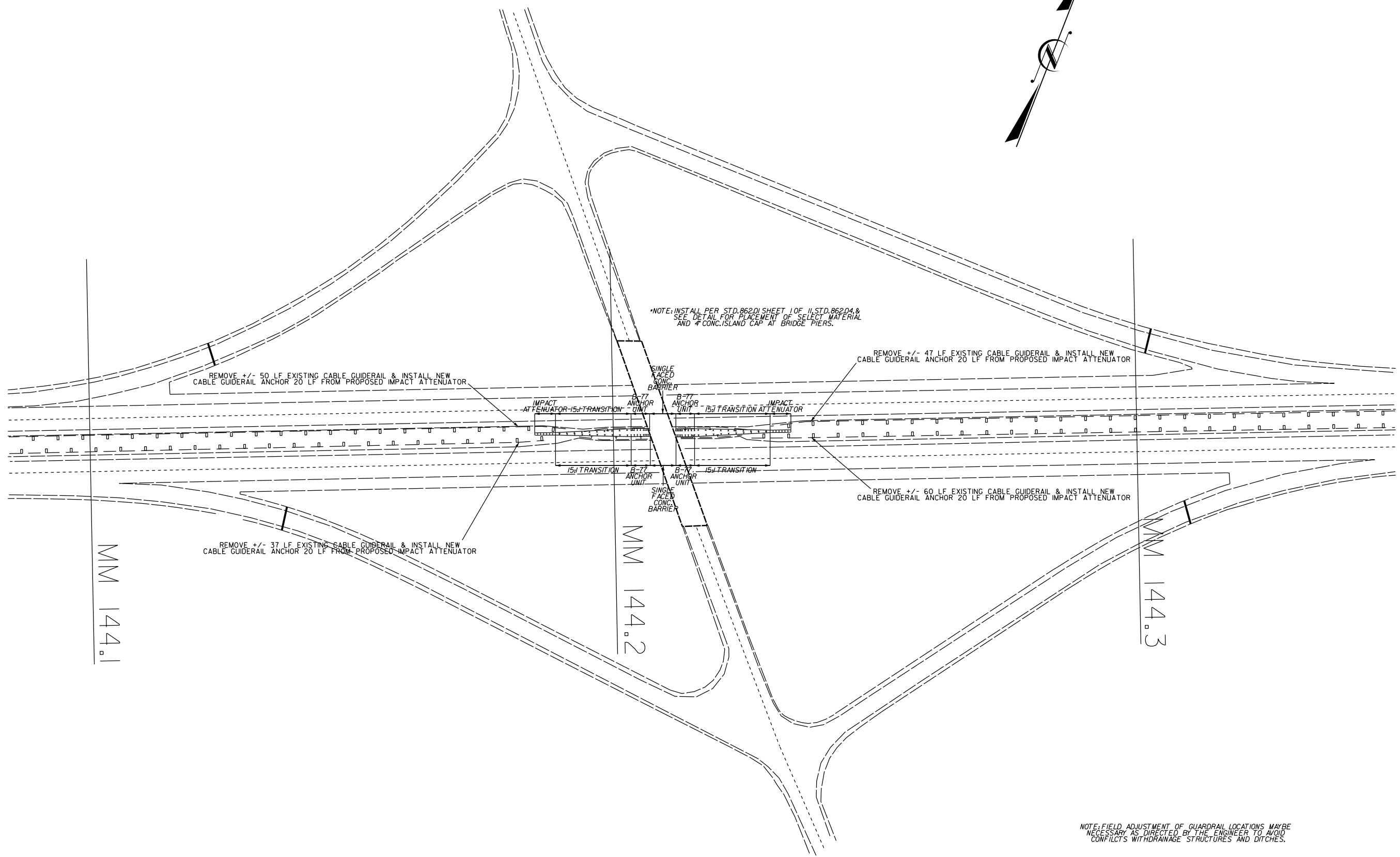
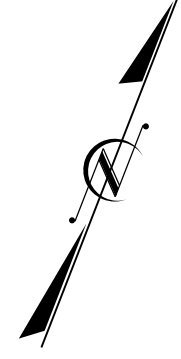

\*NOTE: INSTALL PER STD. 862.01 SHEET 1 OF 11, STD. 862.04 & SEE DETAIL FOR PLACEMENT OF SELECT MATERIAL AND 4 CONC. ISLAND CAP AT BRIDGE PIERS.

REMOVE +/- 50 LF EXISTING CABLE GUIDERAIL & INSTALL NEW CABLE GUIDERAIL ANCHOR 20 LF FROM PROPOSED IMPACT ATTENUATOR

REMOVE +/- 47 LF EXISTING CABLE GUIDERAIL & INSTALL NEW CABLE GUIDERAIL ANCHOR 20 LF FROM PROPOSED IMPACT ATTENUATOR

REMOVE +/- 37 LF EXISTING CABLE GUIDERAIL & INSTALL NEW CABLE GUIDERAIL ANCHOR 20 LF FROM PROPOSED IMPACT ATTENUATOR

REMOVE +/- 60 LF EXISTING CABLE GUIDERAIL & INSTALL NEW CABLE GUIDERAIL ANCHOR 20 LF FROM PROPOSED IMPACT ATTENUATOR

MM 144.1

MM 144.2

MM 144.3

NOTE: FIELD ADJUSTMENT OF GUARDRAIL LOCATIONS MAYBE NECESSARY AS DIRECTED BY THE ENGINEER TO AVOID CONFLICTS WITH DRAINAGE STRUCTURES AND DITCHES.

05-APR-2018 12:34  
 S:\Contracts\1234\Resurfacing Projects\Division 12\1-5915 Catamba Iredell May 2018\1-5915-Rdy.dtl.2B-7.dgn  
 12/24/2017 10:55:30 AM