

CLEARING AND GRUBBING
 EROSION CONTROL FOR
 CONSTRUCTION SHEET 4

NOTE:
 PLACE TEMPORARY ROCK SEDIMENT DAMS TYPE - B
 AND TEMPORARY ROCK SET CHECKS TYPE - A AT
 DRAINAGE OUTLETS.

UTILIZE FABRIC INSERT INLET PROTECTION DEVICES
 IN LIEU OF ROCK INLET SEDIMENT TRAPS
 TYPE-C AS DIRECTED TO AVOID IMPEDIMENT OF
 RUNOFF IN ROADWAY OPEN TO TRAFFIC.

★ PROPOSED TRAFFIC SIGNAL

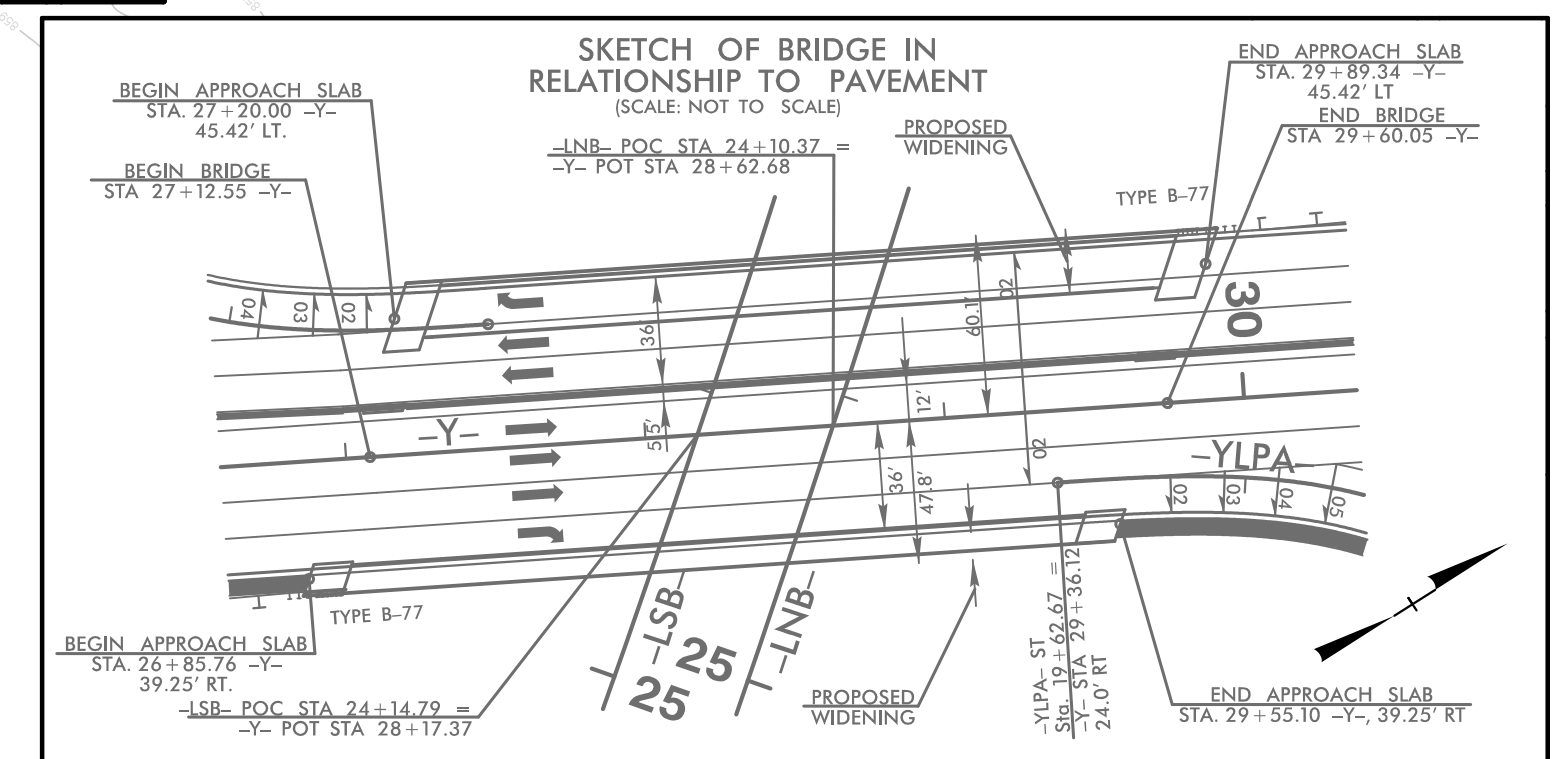
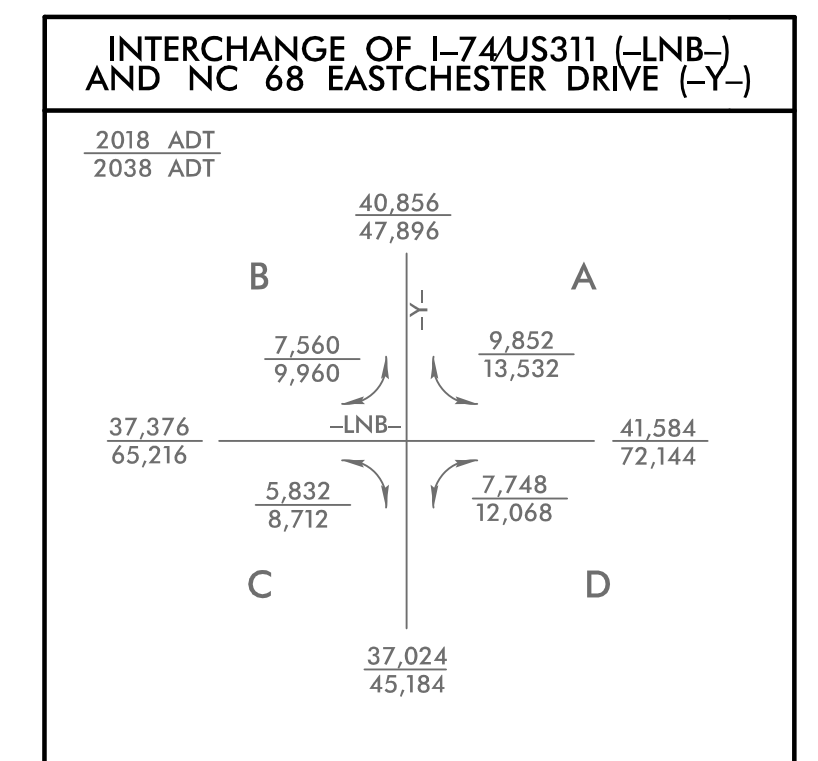

FOR -LNB- PROFILE, SEE SHEET 9
 FOR -LSB- PROFILE, SEE SHEETS 10 & 11
 FOR -Y- PROFILE, SEE SHEET 12
 FOR -Y3- PROFILE, SEE SHEET 15
 FOR -YRPA- PROFILE, SEE SHEET 16
 FOR -YRPB- PROFILE, SEE SHEET 17
 FOR -YRPC- PROFILE, SEE SHEET 18
 FOR -YRPD- PROFILE, SEE SHEET 19
 FOR -YLPA- PROFILE, SEE SHEET 17
 FOR -YLPC- PROFILE, SEE SHEET 18

LOCATION:
 I-74/US 311 AND NC 68/EAST CHESTER DRIVE
 INTERCHANGE RAMP REPLACEMENT

TR NO. U-5169 COUNTY: GUILFORD

DESIGNED BY: BRIAN BLACKWELL
 CHECKED BY: DATE:

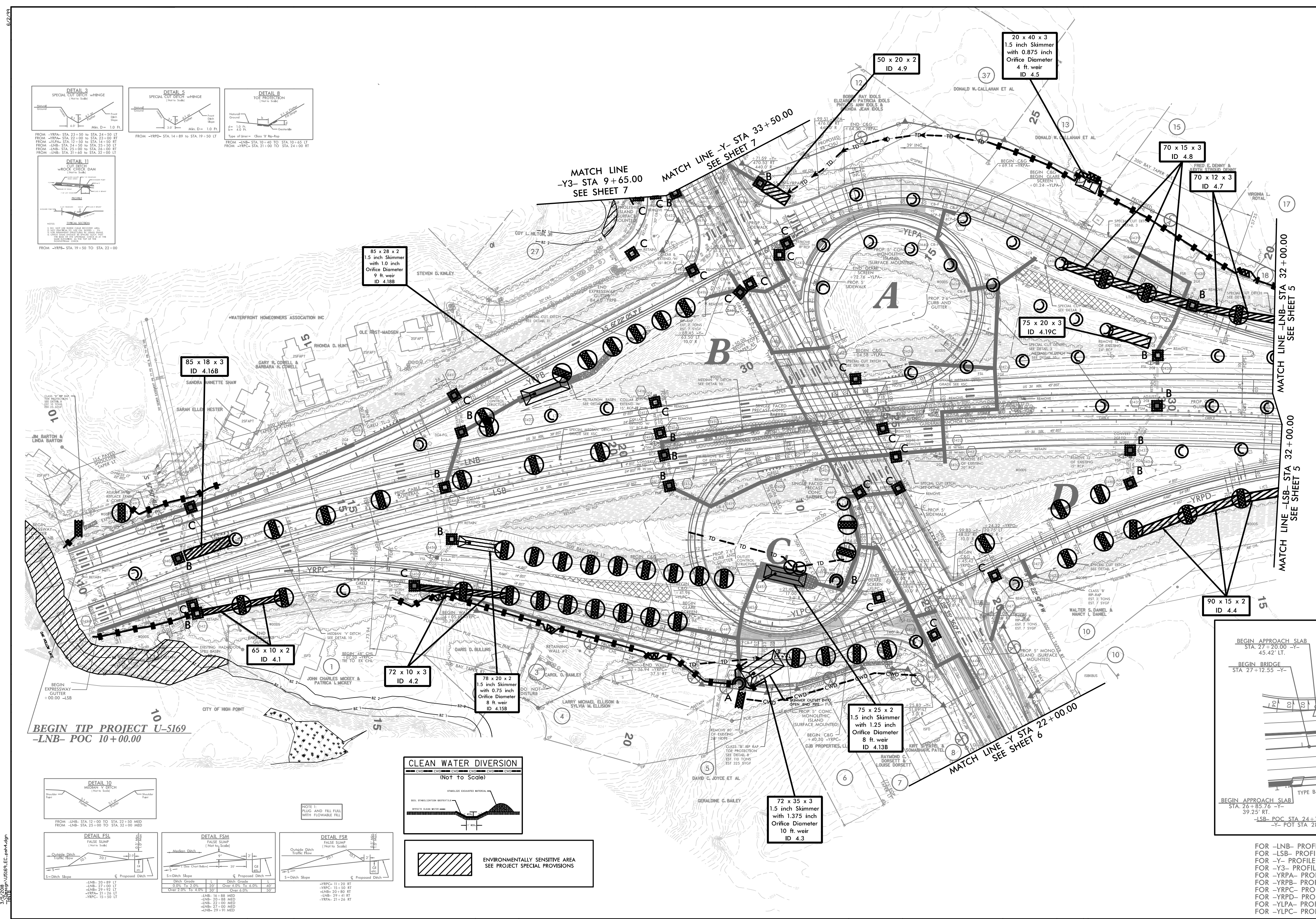
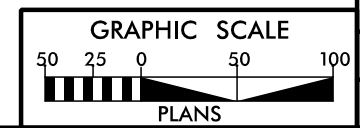

1/2" = 10' (VERTICAL)
 1" = 100' (HORIZONTAL)