

**DOCUMENT NOT CONSIDERED FINAL  
UNLESS ALL SIGNATURES COMPLETED**

-L- CURVE DATA		-DRWI- CURVE DATA	
PI Sta 31+7.51	PI Sta 35+67.79	PI Sta 10+73.49	PI Sta 13+36.72
$\Delta = 4' 48" 24.6" (RT)$	$\Delta = 5' 03" 38.8" (LT)$	$\Delta = 80' 23' 06.1" (RT)$	$\Delta = 72' 09' 16.0" (LT)$
$D = 0' 51' 46.4"$	$D = 1' 28' 22.4"$	$D = 136' 25' 06.7"$	$D = 63' 39' 43.1"$
$L = 557.06'$	$L = 343.59'$	$L = 58.93'$	$L = 113.34'$
$T = 278.69'$	$T = 171.91'$	$T = 35.48'$	$T = 65.57'$
$R = 6,640.00'$	$R = 3,890.00'$	$R = 42.00'$	$R = 90.00'$
$SE = .025$	$SE = .04$	$SE = .04$	$SE = .03$
$RO = 67'$	$RO = 107'$	$RO = 48'$	$RO = 36'$

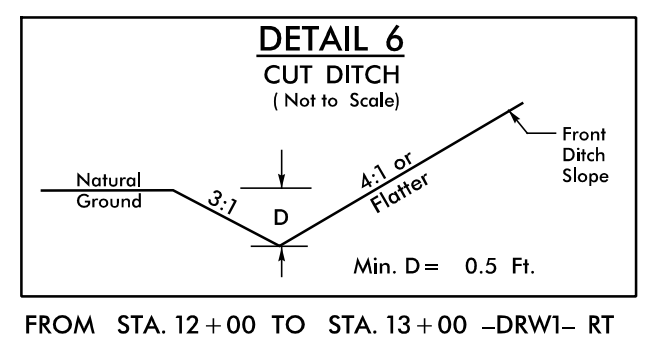
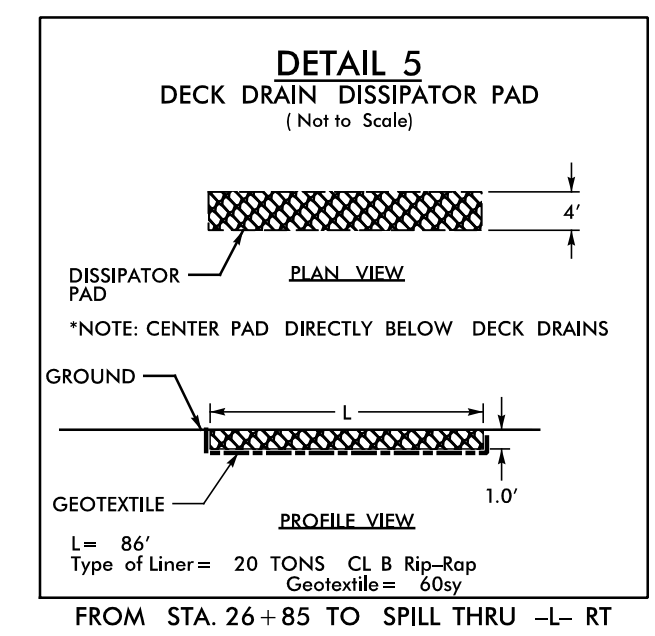

**DECK DRAINS REQUIRED**  
6" DECK DRAINS ON 12' CENTERS  
FROM STA. 26+90 TO STA. 27+02 RT.  
FROM STA. 27+20 TO STA. 27+92 RT.

**NOTE:**  
USE REINFORCED SOIL SLOPES (RSS)  
AT -L- STA. 28+26 +/- (1.5:1 SLOPE) TO 34+25 +/- (2.5:1 SLOPE) LT  
2,000 SY OF RSS, 2,000 SY OF COIR FIBER MAT  
(SEE SHEETS 2G-1 THRU 2G-4)

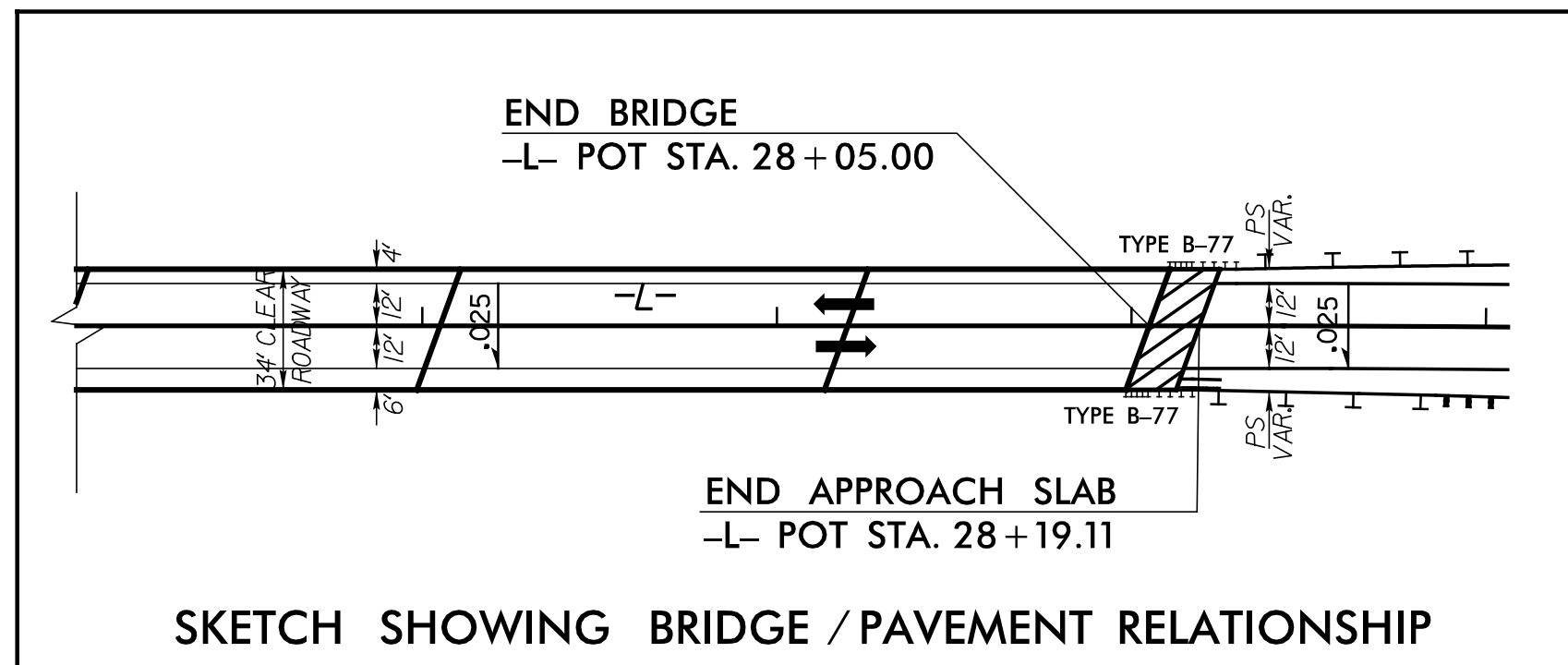
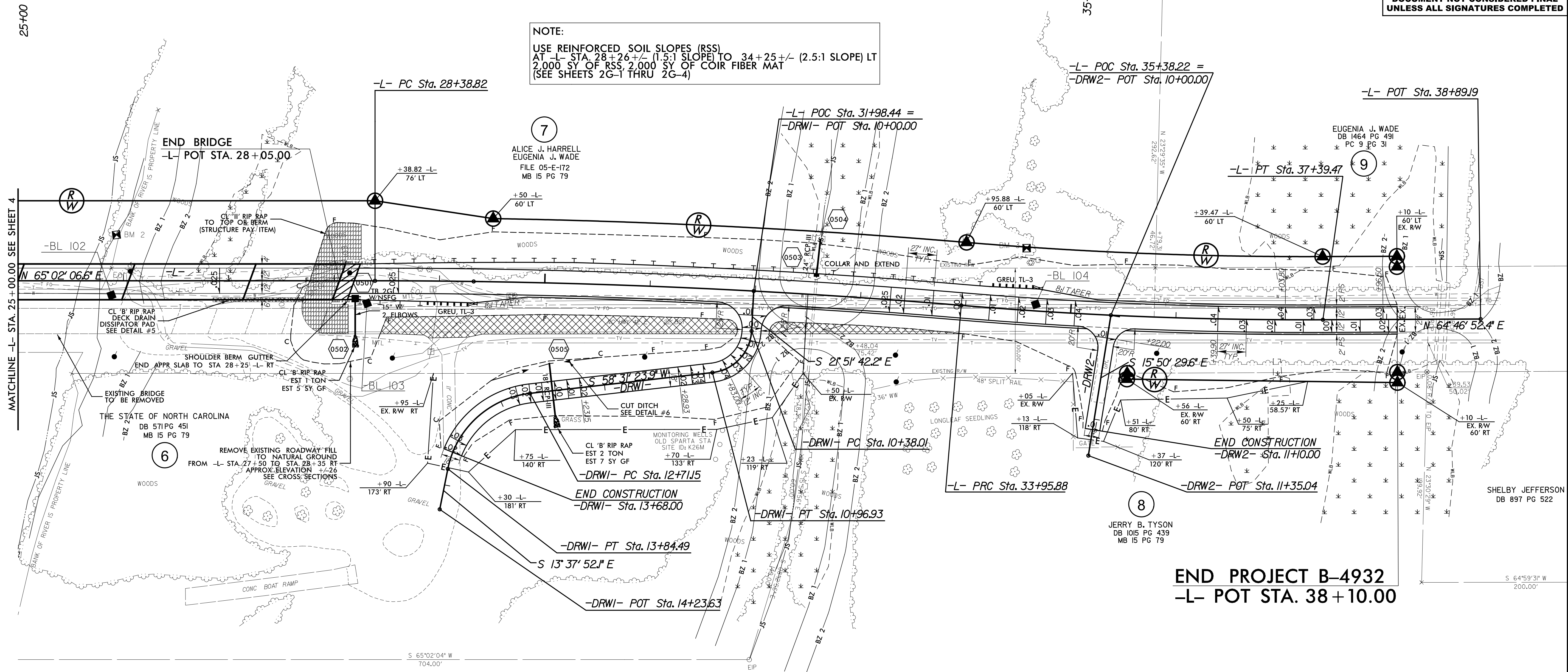

**NOTE: TEMPORARY SIGNAL WILL BE USED FOR ONSITE DETOUR**  
FOR -L- PROFILE SEE SHEET 6  
FOR -DRW1- & -DRW2- PROFILES SEE SHEET 7  
FOR STRUCTURE PLANS SEE SHEET S-1 THRU S-46

REVISIONS

8/17/99  
R:\Projects\B4932\Pro\B4932\_r.dwg\_psh05.dgn  
1/29/2017