

**This electronic collection of documents is provided  
for the convenience of the user  
and is Not a Certified Document –**

**The documents contained herein were originally issued  
and sealed by the individuals whose names and license  
numbers appear on each page, on the dates appearing  
with their signature on that page.**

**This file or an individual page  
shall not be considered a certified document.**

STATE OF NORTH CAROLINA  
DIVISION OF HIGHWAYS

**TRANSPORTATION MANAGEMENT PLAN**

**CAMDEN COUNTY**

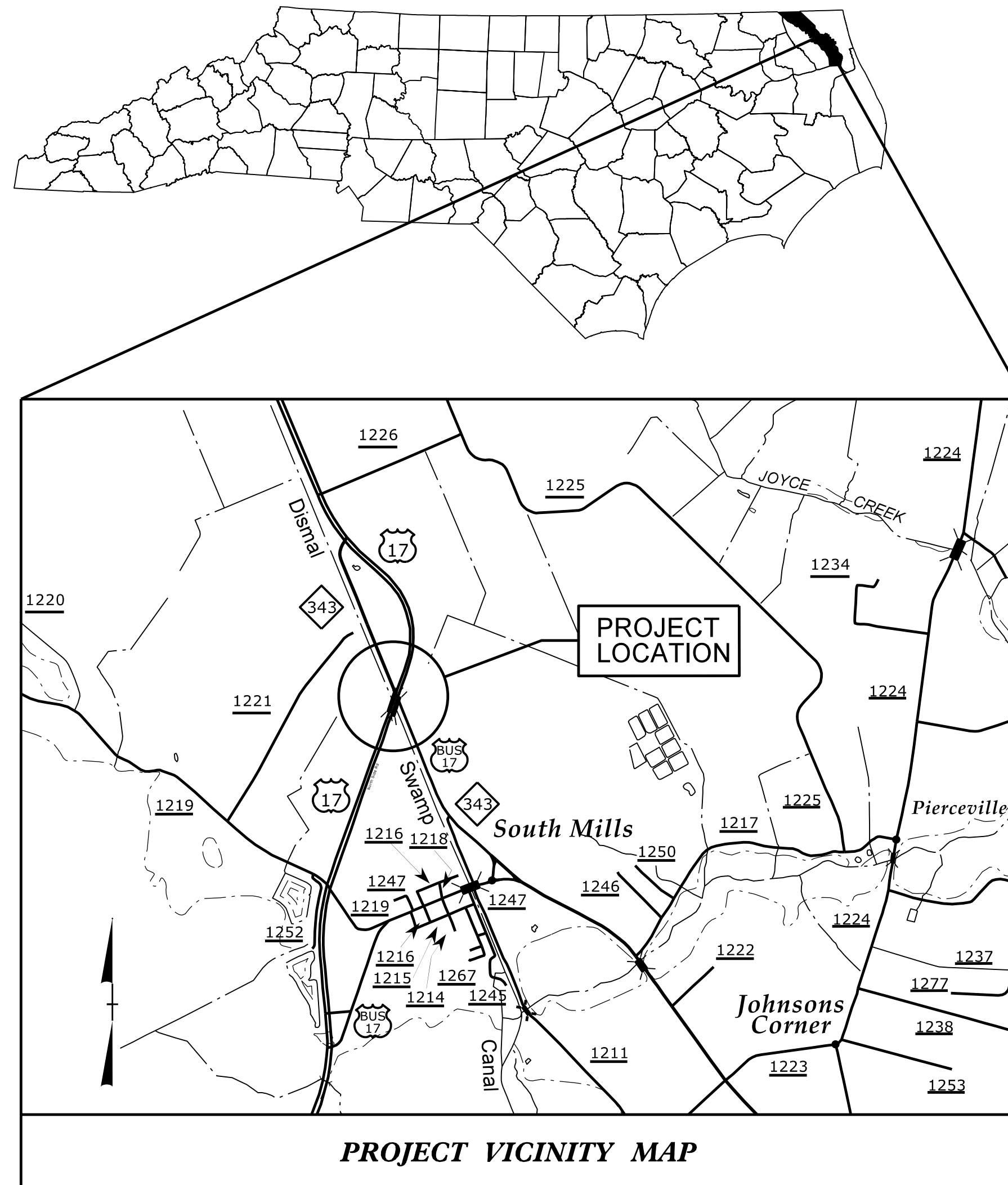

**LOCATION: BRIDGES #43 AND #44 – US 17 SB AND NB  
OVER US 17B/NC 343, AND DISMAL SWAMP CANAL**

**TYPE OF WORK: SILANE DECK TREATMENT, FOAM JOINT SEAL REPLACEMENTS,  
PSG GIRDER REPAIRS, SUBSTRUCTURE CONCRETE/SHOTCRETE REPAIRS,  
SPOT PAINTING OF STEEL SUPERSTRUCTURE**

SHEET NO.	TITLE
TMP-1	INDEX OF SHEETS
TMP-1A	LIST OF APPLICABLE ROADWAY STANDARD DRAWINGS AND LEGEND
TMP-2	TRAFFIC MANAGEMENT STRATEGY, GENERAL NOTES, PHASING AND LOCAL NOTES
TMP-2A	DETOUR FOR NC 343 CLOSURE
TMP-3	INSIDE LANE AND SHOULDER WORK AREA DETAILS
TMP-4	OUTSIDE LANE AND SHOULDER WORK AREA DETAILS

SHEET NO.  
TMP-1

**WBS 15BPR.11**

3/13/2018 4:11:54 PM U:\lib\projects\DIV\15BPR.11\C Camden\TCP\com15bpr.11\tmp\_1.tle.dgn

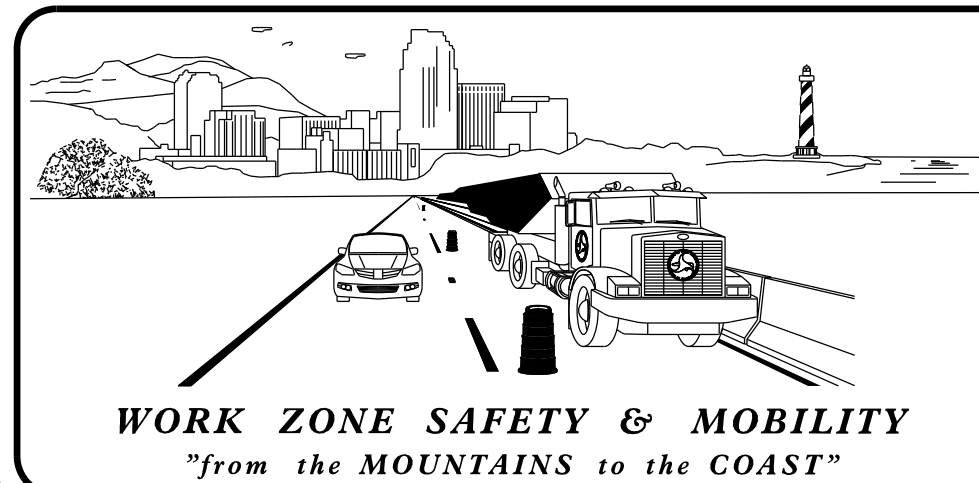

PLANS PREPARED BY:

MIKE RZEPKA, P.E.  
PROJECT ENGINEER

YVETTE MARIOTTE  
PROJECT DESIGN ENGINEER

NCDOT CONTACTS:

T. M. SHERRILL, P.E.  
PRESERVATION AND REPAIR STAFF ENGINEER

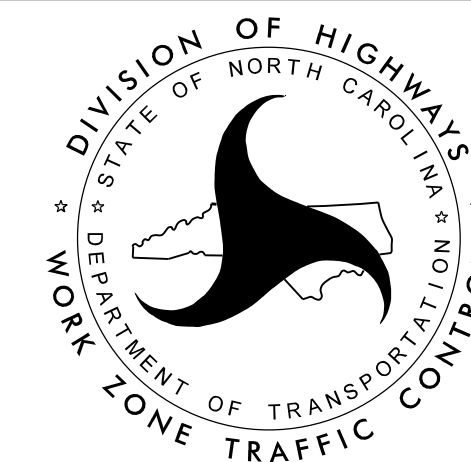

555 Fayetteville St,  
Suite 900  
Raleigh, NC 27601  
NC License No: F-0258

**DOCUMENT NOT CONSIDERED FINAL  
UNLESS ALL SIGNATURES COMPLETED**

APPROVED: Michael T. Rzepka  
DATE: 3/13/2018

SEAL





555 Fayetteville St.  
Suite 900  
Raleigh, NC 27601  
NC License No. E-0258

PROJ. REFERENCE NO.	SHEET NO.
15BPR.11	TMP-1A

## ROADWAY STANDARD DRAWINGS

THE FOLLOWING ROADWAY STANDARDS AS APPEAR IN "ROADWAY STANDARD DRAWINGS" - PROJECT SERVICES UNIT - N.C. DEPARTMENT OF TRANSPORTATION - RALEIGH, N.C., DATED JANUARY 2018 ARE APPLICABLE TO THIS PROJECT AND BY REFERENCE HEREBY ARE CONSIDERED A PART OF THESE PLANS:

<u>STD. NO.</u>	<u>TITLE</u>
1101.01	WORK ZONE ADVANCE WARNING SIGNS
1101.02	TEMPORARY LANE CLOSURES
1101.03	TEMPORARY ROAD CLOSURES
1101.04	TEMPORARY SHOULDER CLOSURES
1101.11	TRAFFIC CONTROL DESIGN TABLES
1110.01	STATIONARY WORK ZONE SIGNS
1110.02	PORTABLE WORK ZONE SIGNS
1115.01	FLASHING ARROW BOARDS
1130.01	DRUMS
1135.01	CONES
1145.01	BARRICADES
1165.01	TRUCK MOUNTED ATTENUATOR
1180.01	SKINNY-DRUMS
1205.01	PAVEMENT MARKINGS - LINE TYPES AND OFFSETS
1205.02	PAVEMENT MARKINGS - TWO-LANE AND MULTI-LANE ROADWAYS
1251.01	RAISED PAVEMENT MARKERS - (PERMANENT)

## LEGEND

### GENERAL

- DIRECTION OF TRAFFIC FLOW
- DIRECTION OF PEDESTRIAN TRAFFIC FLOW
- EXIST. PVMT.
- NORTH ARROW
- PROPOSED PVMT.
- WORK AREA

### TRAFFIC CONTROL DEVICES

- BARRICADE (TYPE III)
- CONE
- DRUM SKINNY DRUM TUBULAR MARKER
- TEMPORARY CRASH CUSHION
- FLASHING ARROW PANEL (TYPE C)
- FLAGGER
- LAW ENFORCEMENT
- TRUCK MOUNTED IMPACT ATTENUATOR (TMIA)
- CHANGEABLE MESSAGE SIGN

### TEMPORARY SIGNING

- PORTABLE SIGN
- STATIONARY SIGN
- STATIONARY OR PORTABLE SIGN

### SIGNALS

- EXISTING
- PROPOSED
- TEMPORARY

### PAVEMENT MARKINGS

- EXISTING LINES
- TEMPORARY LINES

### PAVEMENT MARKERS

- CRYSTAL / CRYSTAL
- CRYSTAL / RED
- YELLOW / YELLOW

### PAVEMENT MARKING SYMBOLS

- PAVEMENT MARKING SYMBOLS

APPROVED:   
018C348C28048D...  
 DATE: 3/13/2018

**DOCUMENT NOT CONSIDERED FINAL  
UNLESS ALL SIGNATURES COMPLETED**

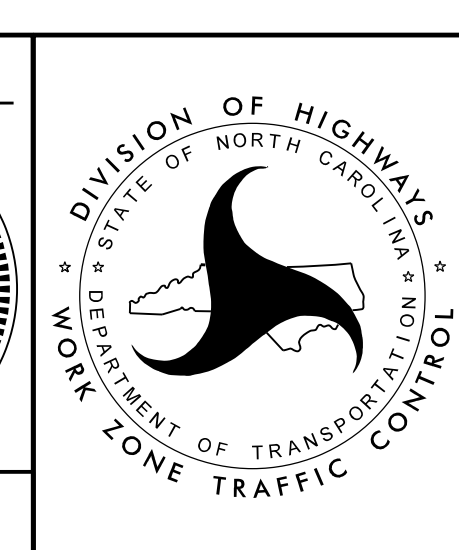

ROADWAY STANDARD DRAWINGS  
AND LEGEND

3/13/2018  
U:\BPR\Projects\15BPR\11\Camden\TCP\cam15bpr\11\tmp\_1\file\_la.dgn  
7:39:55 AM

# TRAFFIC MANAGEMENT STRATEGY

PROPOSED REPAIRS TO BRIDGES #43 & 44 WILL BE PERFORMED USING LANE CLOSURES. REFER TO THIS SHEET FOR PHASING.

## GENERAL NOTES

CHANGES MAY BE REQUIRED WHEN PHYSICAL DIMENSIONS IN THE DETAIL DRAWINGS, STANDARD DETAILS, AND ROADWAY DETAILS ARE NOT ATTAINABLE TO MEET FIELD CONDITIONS OR RESULT IN DUPLICATE OR UNDESIRABLE OVERLAPPING OF DEVICES. MODIFICATION MAY INCLUDE: MOVING, SUPPLEMENTING, COVERING, OR REMOVAL OF DEVICES AS DIRECTED BY THE ENGINEER.

THE FOLLOWING GENERAL NOTES APPLY AT ALL TIMES FOR THE DURATION OF THE CONSTRUCTION PROJECT EXCEPT WHEN OTHERWISE NOTED IN THE PLAN OR DIRECTED BY THE ENGINEER.

### TIME RESTRICTIONS

A) DO NOT CLOSE OR NARROW TRAVEL LANES DURING HOLIDAYS AND SPECIAL EVENTS AS FOLLOWS:

#### ROAD NAME

US 17

#### HOLIDAY

- FOR ANY UNEXPECTED OCCURRENCE THAT CREATES UNUSUALLY HIGH TRAFFIC VOLUMES, AS DIRECTED BY THE ENGINEER.
- FOR NEW YEAR'S, BETWEEN THE HOURS OF 12:00 A.M. DECEMBER 31st TO 11:59 P.M. JANUARY 2ND. IF NEW YEAR'S DAY IS ON A FRIDAY, SATURDAY, SUNDAY, OR MONDAY THEN UNTIL 11:59 P.M. THE FOLLOWING TUESDAY.
- FOR EASTER, BETWEEN THE HOURS OF 12:00 A.M. THURSDAY AND 11:59 P.M. MONDAY.
- FOR MEMORIAL DAY, BETWEEN THE HOURS OF 12:00 A.M. FRIDAY TO 11:59 P.M. TUESDAY.
- FOR INDEPENDENCE DAY, BETWEEN THE HOURS OF 12:00 A.M. THE DAY BEFORE INDEPENDENCE DAY AND 11:59 P.M. THE DAY AFTER INDEPENDENCE DAY.  
  
IF INDEPENDENCE DAY IS ON A FRIDAY, SATURDAY, SUNDAY OR MONDAY THEN BETWEEN THE HOURS OF 12:00 A.M. THE THURSDAY BEFORE INDEPENDENCE DAY AND 11:59 P.M. THE TUESDAY AFTER INDEPENDENCE DAY.
- FOR LABOR DAY, BETWEEN THE HOURS OF 12:00 A.M. FRIDAY AND 11:59 P.M. TUESDAY.
- FOR THANKSGIVING DAY, BETWEEN THE HOURS OF 12:00 A.M. TUESDAY TO 11:59 P.M. MONDAY.
- FOR CHRISTMAS, BETWEEN THE HOURS OF 12:00 A.M. THE FRIDAY BEFORE THE WEEK OF CHRISTMAS DAY AND 11:59 P.M. THE FOLLOWING TUESDAY AFTER THE WEEK OF CHRISTMAS.

B) DO NOT CONDUCT ANY HAULING OPERATIONS AGAINST THE FLOW OF TRAFFIC OF AN OPEN TRAVELWAY UNLESS THE HAULING OPERATION IS PROTECTED BY BARRIER OR GUARDRAIL OR AS DIRECTED BY THE ENGINEER.

### LANE AND SHOULDER CLOSURE REQUIREMENTS

- C) REMOVE LANE CLOSURE DEVICES FROM THE LANE WHEN WORK IS NOT BEING PERFORMED BEHIND THE LANE CLOSURE OR WHEN A LANE CLOSURE IS NO LONGER NEEDED OR AS DIRECTED BY THE ENGINEER.
- D) WHEN PERSONNEL AND/OR EQUIPMENT ARE WORKING WITHIN 15 FT OF AN OPEN TRAVEL LANE, CLOSE THE NEAREST OPEN SHOULDER USING ROADWAY STANDARD DRAWING NO. 1101.04 UNLESS THE WORK AREA IS PROTECTED BY BARRIER OR GUARDRAIL OR A LANE CLOSURE IS INSTALLED.

E) WHEN PERSONNEL AND/OR EQUIPMENT ARE WORKING ON THE SHOULDER ADJACENT TO AN UNDIVIDED FACILITY AND WITHIN 5 FT OF AN OPEN TRAVEL LANE, CLOSE THE NEAREST OPEN TRAVEL LANE USING ROADWAY STANDARD DRAWING NO. 1101.02 UNLESS THE WORK AREA IS PROTECTED BY BARRIER OR GUARDRAIL.

WHEN PERSONNEL AND/OR EQUIPMENT ARE WORKING ON THE SHOULDER ADJACENT TO A DIVIDED FACILITY AND WITHIN 10 FT OF AN OPEN TRAVEL LANE, CLOSE THE NEAREST OPEN TRAVEL LANE USING ROADWAY STANDARD DRAWING NO. 1101.02 UNLESS THE WORK AREA IS PROTECTED BY BARRIER OR GUARDRAIL.

F) WHEN PERSONNEL AND/OR EQUIPMENT ARE WORKING WITHIN A LANE OF TRAVEL OF AN UNDIVIDED OR DIVIDED FACILITY, CLOSE THE LANE ACCORDING TO THE TRAFFIC CONTROL PLANS, ROADWAY STANDARD DRAWINGS, OR AS DIRECTED BY THE ENGINEER. CONDUCT THE WORK SO THAT ALL PERSONNEL AND/OR EQUIPMENT REMAIN WITHIN THE CLOSED TRAVEL LANE.

G) DO NOT WORK SIMULTANEOUSLY WITHIN 15 FT ON BOTH SIDES OF AN OPEN TRAVELWAY, RAMP, OR LOOP WITHIN THE SAME LOCATION UNLESS PROTECTED WITH GUARDRAIL OR BARRIER.

H) DO NOT INSTALL MORE THAN ONE LANE CLOSURE IN ANY ONE DIRECTION ON US 17.

I) INSTALL ADVANCE WORK ZONE WARNING SIGNS WHEN WORK IS WITHIN 40 FT FROM THE EDGE OF TRAVEL LANE AND NO MORE THAN THREE (3) DAYS PRIOR TO THE BEGINNING OF CONSTRUCTION.

### TRAFFIC PATTERN ALTERATIONS

J) NOTIFY THE ENGINEER THIRTY (30) CALENDAR DAYS PRIOR TO ANY TRAFFIC PATTERN ALTERATION.

### SIGNING

K) INSTALL ADVANCE WORK ZONE WARNING SIGNS WHEN WORK IS WITHIN 40 FT FROM THE EDGE OF TRAVEL LANE AND NO MORE THAN THREE (3) DAYS PRIOR TO THE BEGINNING OF CONSTRUCTION.

L) PROVIDE SIGNING AND DEVICES REQUIRED TO CLOSE THE ROAD ACCORDING TO THE ROADWAY STANDARD DRAWINGS AND TRAFFIC CONTROL PLANS.

PROVIDE SIGNING REQUIRED FOR THE OFF-SITE DETOUR ROUTE AS SHOWN IN THE TRAFFIC CONTROL PLANS.

M) COVER OR REMOVE ALL SIGNS AND DEVICES REQUIRED TO CLOSE THE ROAD WHEN ROAD CLOSURE IS NOT IN OPERATION.

COVER OR REMOVE ALL SIGNS REQUIRED FOR THE OFF-SITE DETOUR WHEN THE DETOUR IS NOT IN OPERATION.

N) ENSURE ALL NECESSARY SIGNING IS IN PLACE PRIOR TO ALTERING ANY TRAFFIC PATTERN.

### TRAFFIC CONTROL DEVICES

O) WHEN LANE CLOSURES ARE NOT IN EFFECT SPACE CHANNELIZING DEVICES IN WORK AREAS NO GREATER IN FEET THAN TWICE THE POSTED SPEED LIMIT (MPH) EXCEPT, 10 FT ON-CENTER IN RADII, AND 3 FT OFF THE EDGE OF AN OPEN TRAVELWAY. REFER TO STANDARD SPECIFICATIONS FOR ROADS AND STRUCTURES SECTIONS 1130 (DRUMS), 1135 (CONES) AND 1180 (SKINNY DRUMS) FOR ADDITIONAL REQUIREMENTS.

### PAVEMENT MARKINGS AND MARKERS

P) UPON COMPLETION OF ALL CONSTRUCTION OPERATIONS, INSTALL FINAL PAVEMENT MARKINGS AND PAVEMENT MARKERS IN ORIGINAL LOCATIONS AS FOLLOWS:

ROAD NAME	MARKING	MARKER
US 17	POLYUREA	PERMANENT RAISED

Q) INSTALL TEMPORARY PAVEMENT MARKINGS IN ORIGINAL LOCATIONS AS FOLLOWS UNTIL FINAL MARKINGS ARE PLACED:

ROAD NAME	MARKING	MARKER
US 17	PAINT	NONE

R) TIE PROPOSED PAVEMENT MARKING LINES TO EXISTING PAVEMENT MARKING LINES.

S) REMOVE/REPLACE ANY CONFLICTING/DAMAGED PAVEMENT MARKINGS AND MARKERS BY THE END OF EACH DAY'S OPERATION.

### MISCELLANEOUS

T) LAW ENFORCEMENT SHALL BE USED TO MAINTAIN TRAFFIC THROUGH THE WORK AREA AND/OR INTERSECTIONS AS DIRECTED BY THE ENGINEER.

## PHASING

PERFORM BRIDGE WORK. WHEN WORK REQUIRES LANE CLOSURES, SEE SHEETS TMP-3 & TMP-4 AND USE WITH ROADWAY STANDARD DRAWINGS 1101.02, SHEET 4 OF 14 FOR LEFT-LANE OR RIGHT-LANE CLOSURES, RESPECTIVELY. (SEE LOCAL NOTES 1 & 2)

FOR BRIDGE WORK AFFECTING NAVIGABLE WATERS SEE LOCAL NOTE 3.

WHEN PERFORMING BRIDGE WORK AFFECTING US 17B/NC 343 TRAFFIC, MAY CLOSE US 17B/NC 343 TO THROUGH-TRAFFIC, AS DIRECTED BY THE ENGINEER (SEE SHEET TMP-2A). WHEN THE WORK PERIOD AFFECTING US 17B/NC 343 IS COMPLETE, REMOVE DETOUR AND ROAD CLOSURE SIGNING AND REOPEN US 17B/NC 343.

REPLACE PAVEMENT MARKINGS OBLITERATED DURING DECK WORK WITH TEMPORARY PAVEMENT MARKINGS IN THEIR ORIGINAL LOCATIONS UNTIL FINAL MARKINGS ARE INSTALLED.

AT THE COMPLETION OF ALL BRIDGE WORK, USE ROADWAY STANDARD DRAWINGS 1101.02, SHEETS 4 OF 14 AND PLACE FINAL PAVEMENT MARKINGS AND MARKERS IN THEIR ORIGINAL LOCATIONS.

## LOCAL NOTES

- OVERWEIGHT/OVERSIZE LOAD RESTRICTIONS WILL BE NEEDED DURING LANE CLOSURE USE.
- IF LANE CLOSURE REMAINS IN PLACE DURING INACTIVE WORK PERIODS, RETURN TRAFFIC TO EXISTING OPEN LANE BY REMOVING THE LANE-NARROWING DRUM TAPER ADJACENT TO WORK AREA AND SHIFT SKINNY DRUMS INTO WORK AREA. COVER/REMOVE SIGNS W26-1, W5-1 & W1-4. SEE SECTION VIEWS ON SHEETS TMP-3 & TMP-4.
- COORDINATE WITH THE U.S. COAST GUARD FOR WORK AFFECTING NAVIGABLE WATERS (SEE SPECIAL PROVISION).

3/13/2018 4:18:56 PM U:\BPR\Projects\15BPR\11Camden\TCP\cam5bpr\lmp\_top\_2.dgn 7:39:56 AM

APPROVED: *Michael T. Rzepka*  
01B03480C29048D...  
DATE: 3/13/2018

SEAL

**DOCUMENT NOT CONSIDERED FINAL UNLESS ALL SIGNATURES COMPLETED**

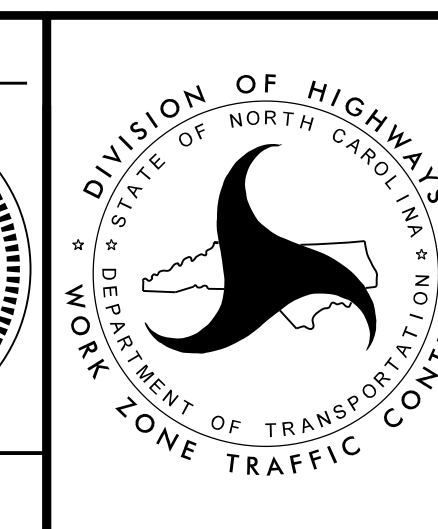

TRAFFIC MANAGEMENT STRATEGY,  
GENERAL NOTES, PHASING  
AND LOCAL NOTES

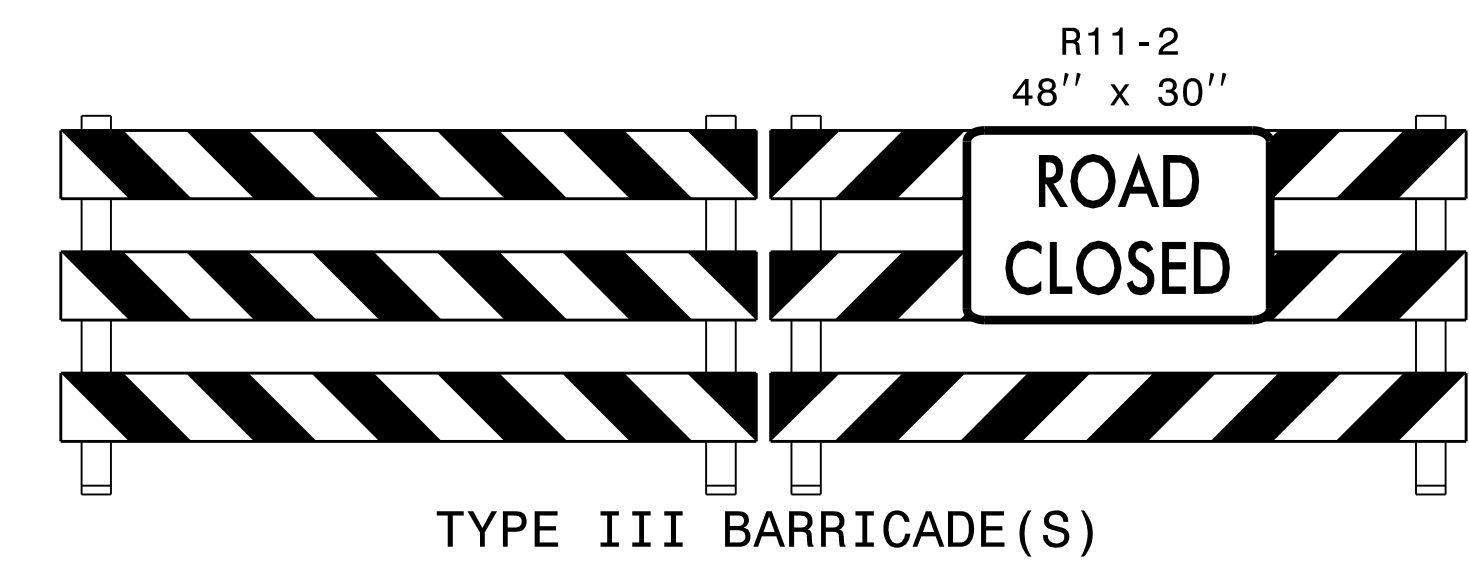
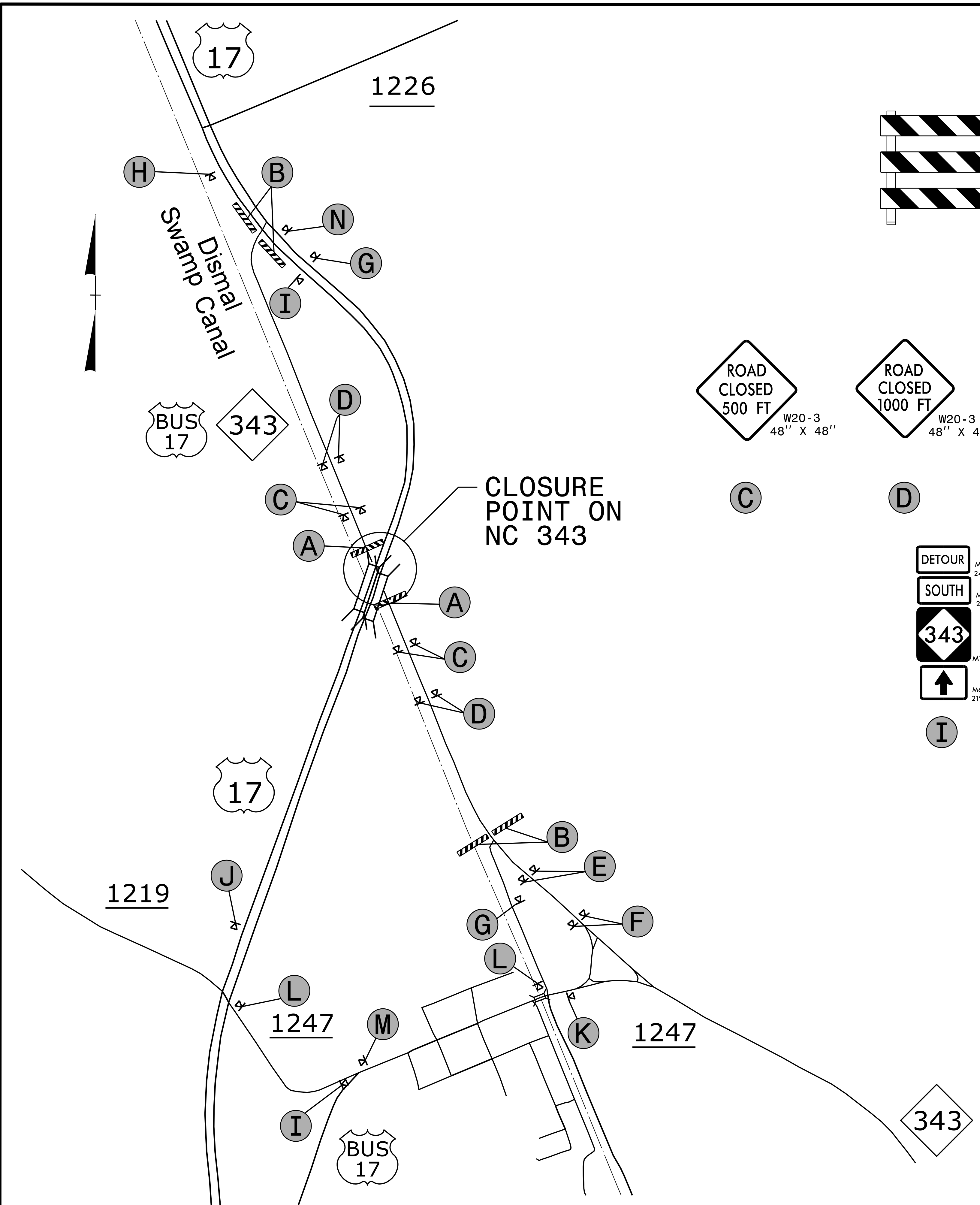

(A)

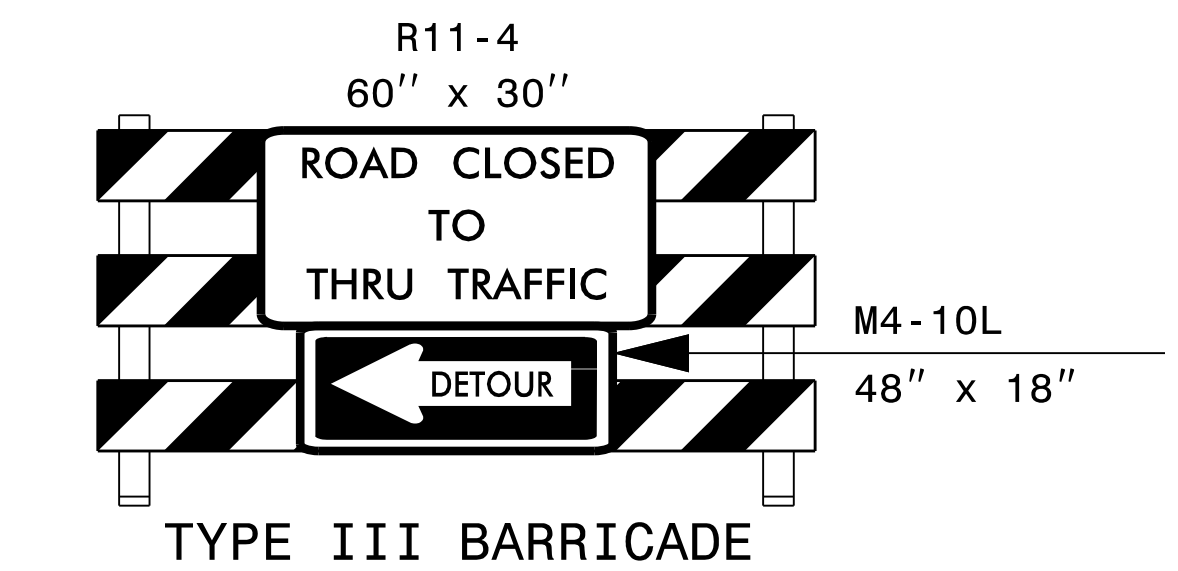

(B)

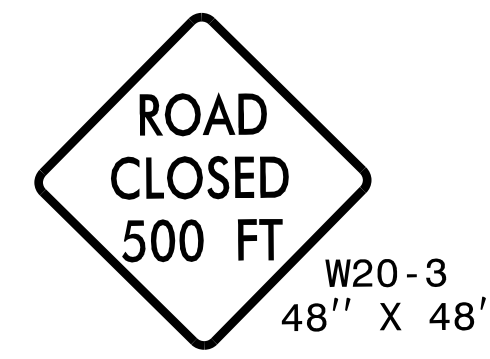

(C)

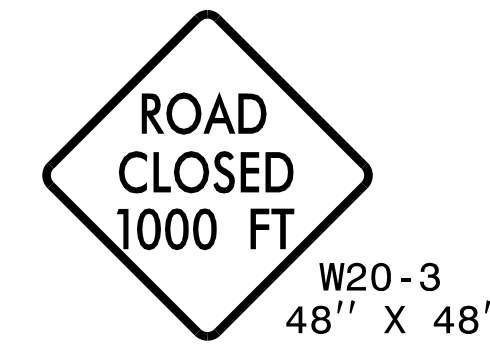

(D)

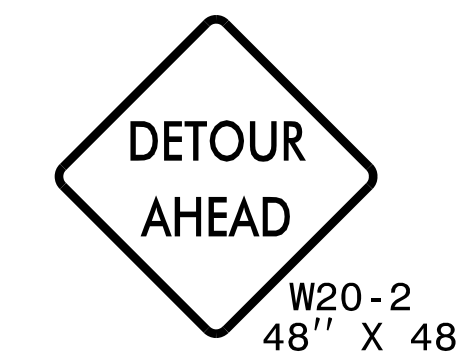

(E)



(F)

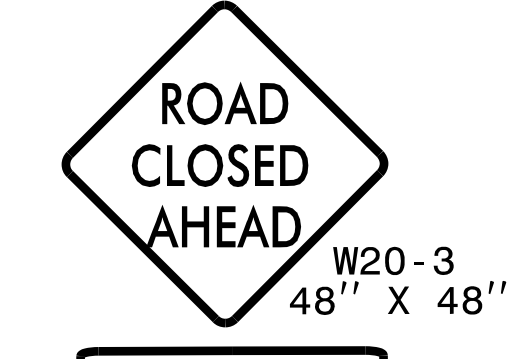

(G)

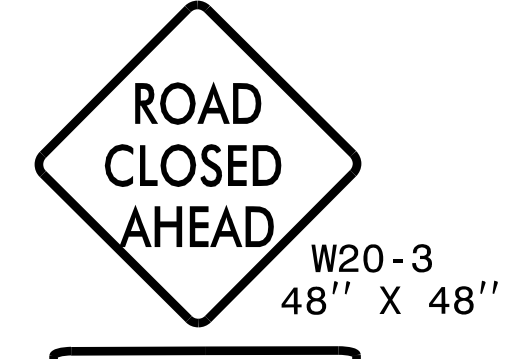

(H)

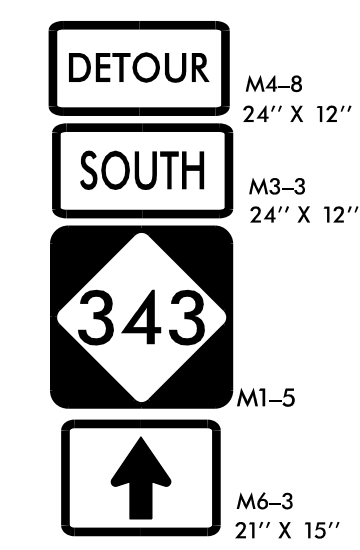

(I)

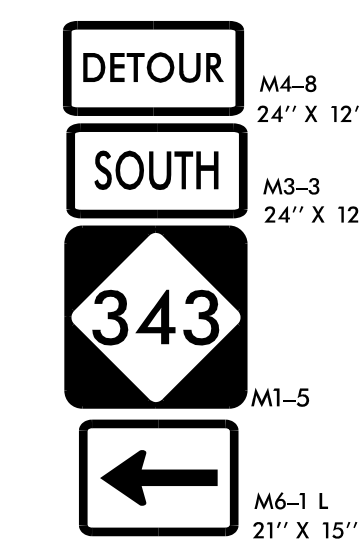

(J)

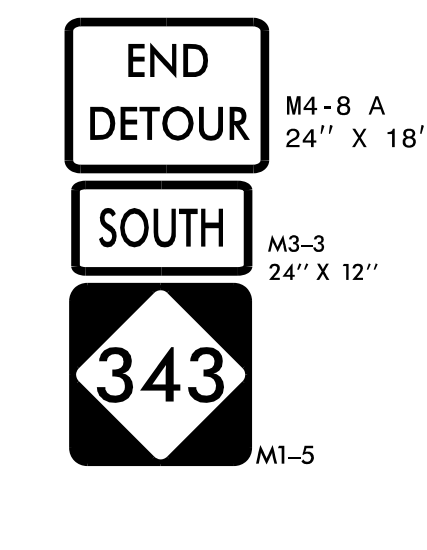

(K)

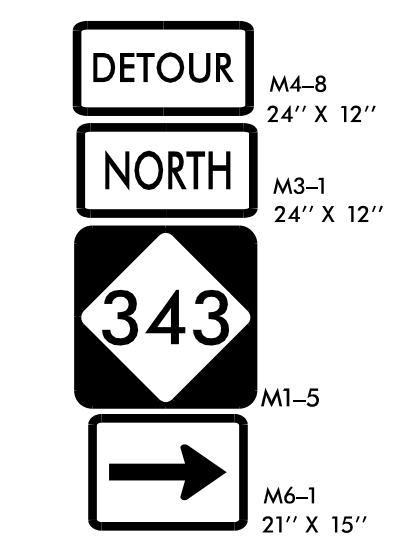

(L)

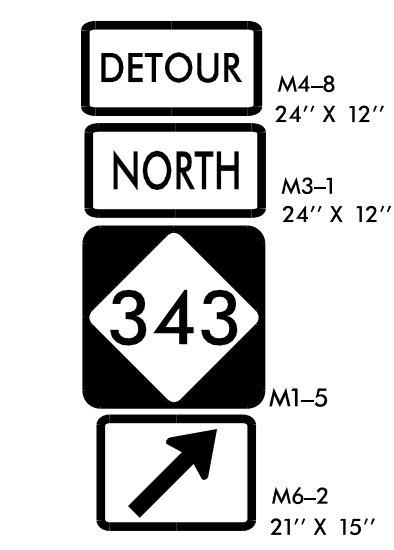

(M)

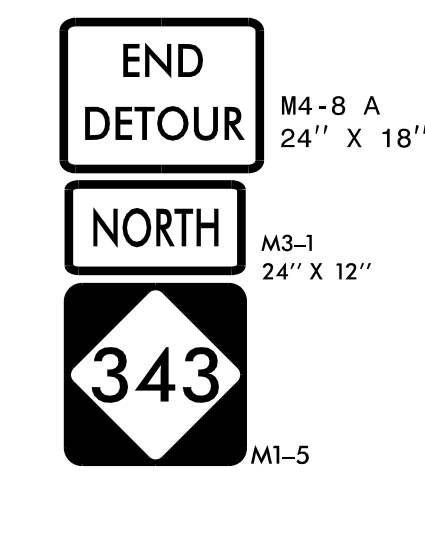

(N)

3/13/2018 4:51:18 PM J:\BPR\Projects\15BPR\11\Camden\TCP\cam5bpr\11\_tmp\_det\_2a.dgn 7:39:58 AM

APPROVED: *Michael T. Rzepka*  
DATE: 3/13/2018

SEAL

DOCUMENT NOT CONSIDERED FINAL  
UNLESS ALL SIGNATURES COMPLETED

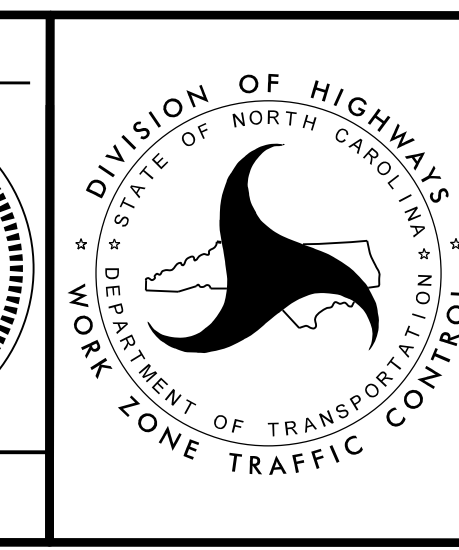

DETOUR FOR  
NC 343 CLOSURE



555 Fayetteville St,  
Suite 900  
Raleigh, NC 27601  
NC License No: F-0258

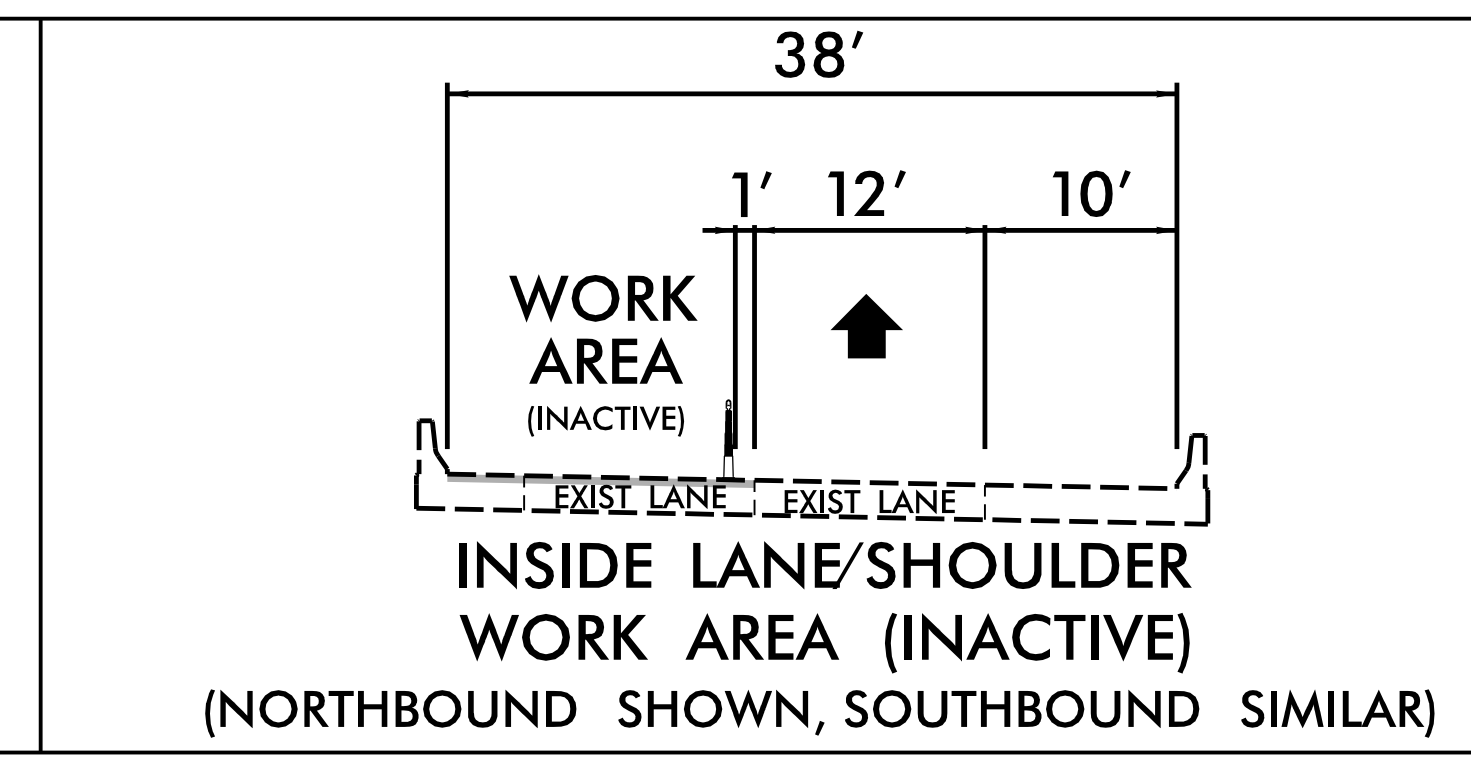
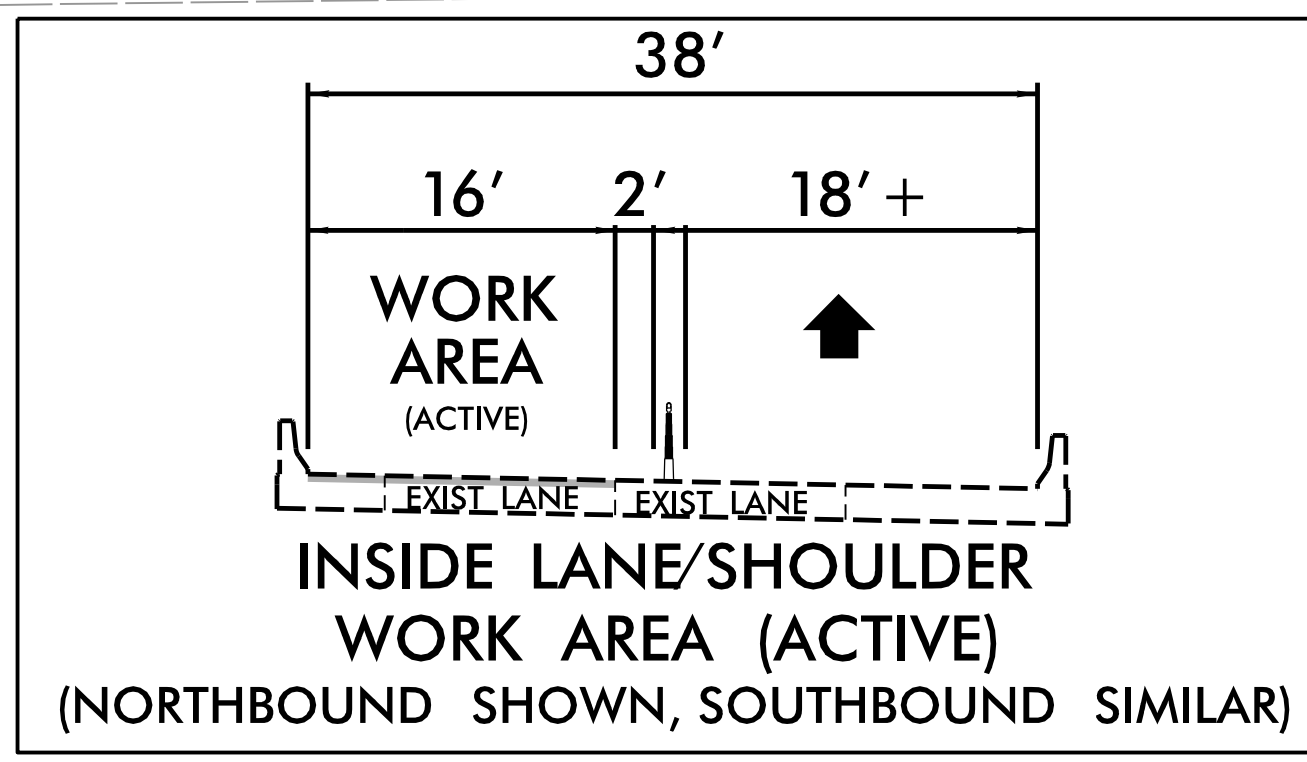
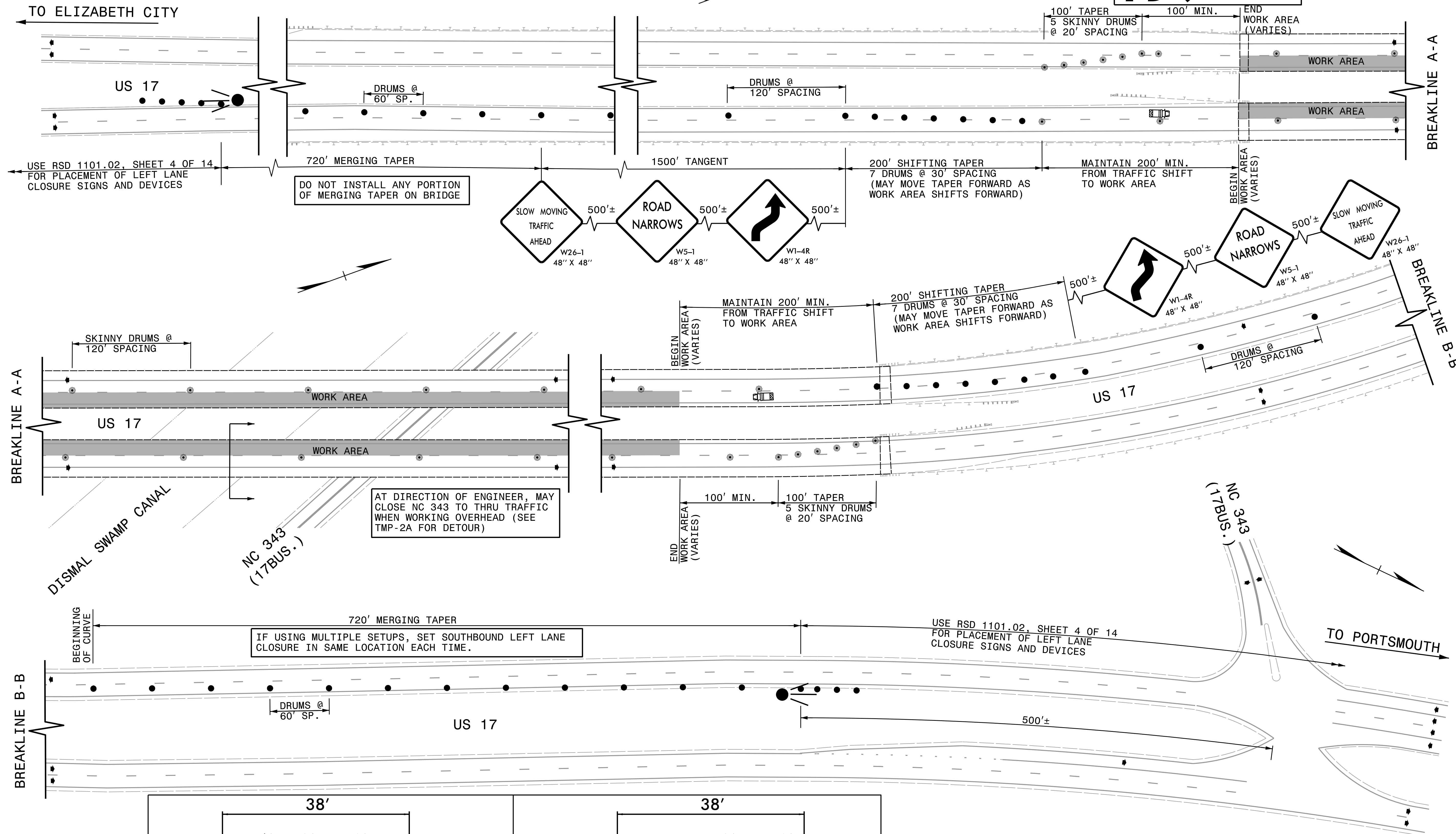

APPROVED: *Michael T. Rzepka*  
DATE: 3/13/2018

SEAL

DOCUMENT NOT CONSIDERED FINAL UNLESS ALL SIGNATURES COMPLETED

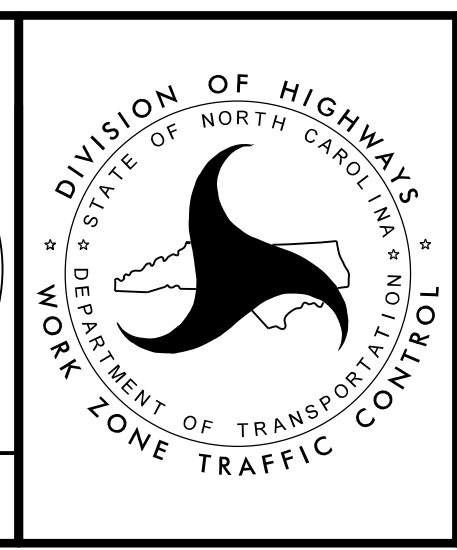

DIVISION OF HIGHWAYS  
DEPARTMENT OF TRANSPORTATION & WORK ZONE TRAFFIC CONTROL

INSIDE LANE AND SHOULDER WORK AREA DETAILS

3/13/2018 4:11:18 PM  
 U:\Lib\Projects\15BPR\11\Camden\TCP\cam5bpr\11\tmp\_dtl\_3.dgn  
 7:40:00 AM



555 Fayetteville St,  
Suite 900  
Raleigh, NC 27601  
NC License No: F-0258

PROJ. REFERENCE NO.	SHEET NO.
15BPR.11	TMP-4

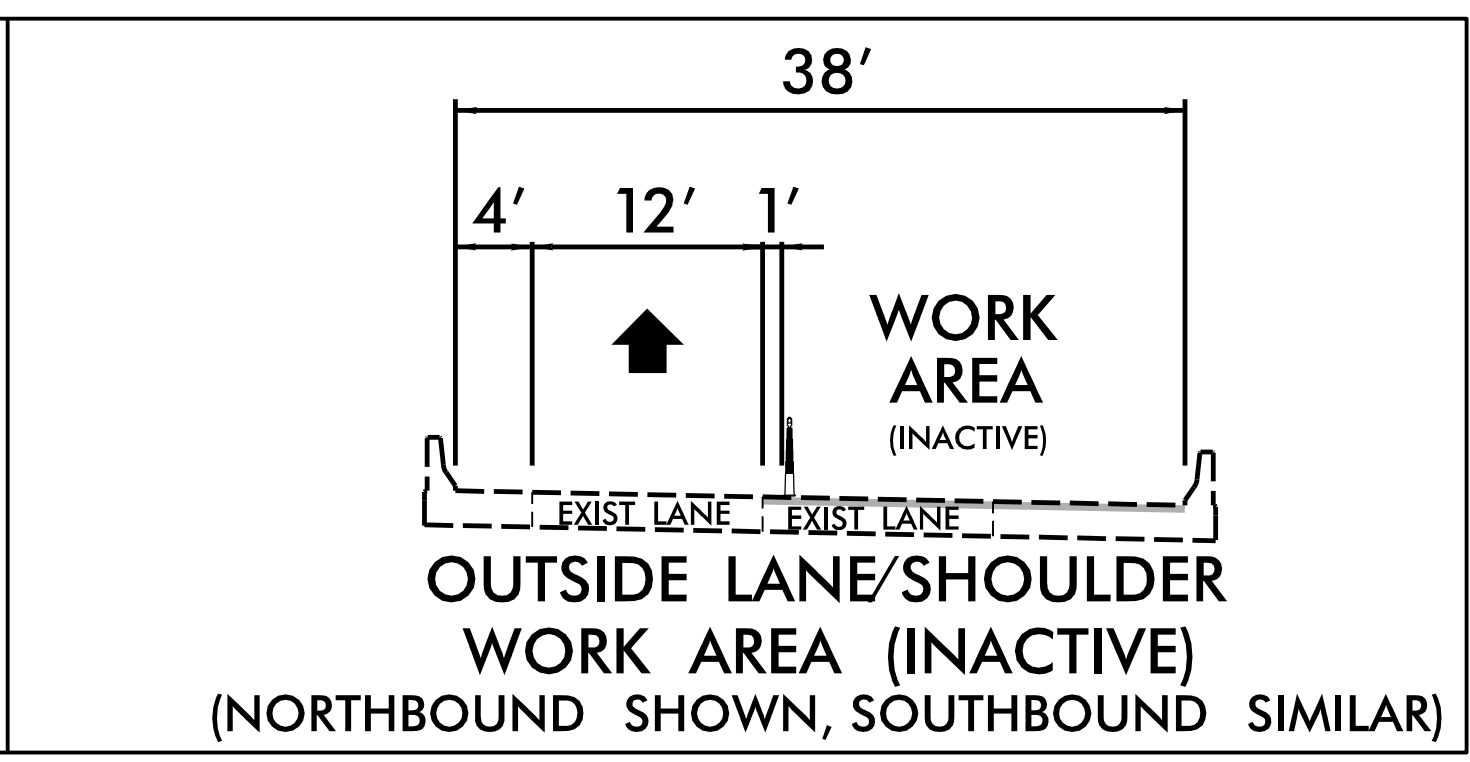
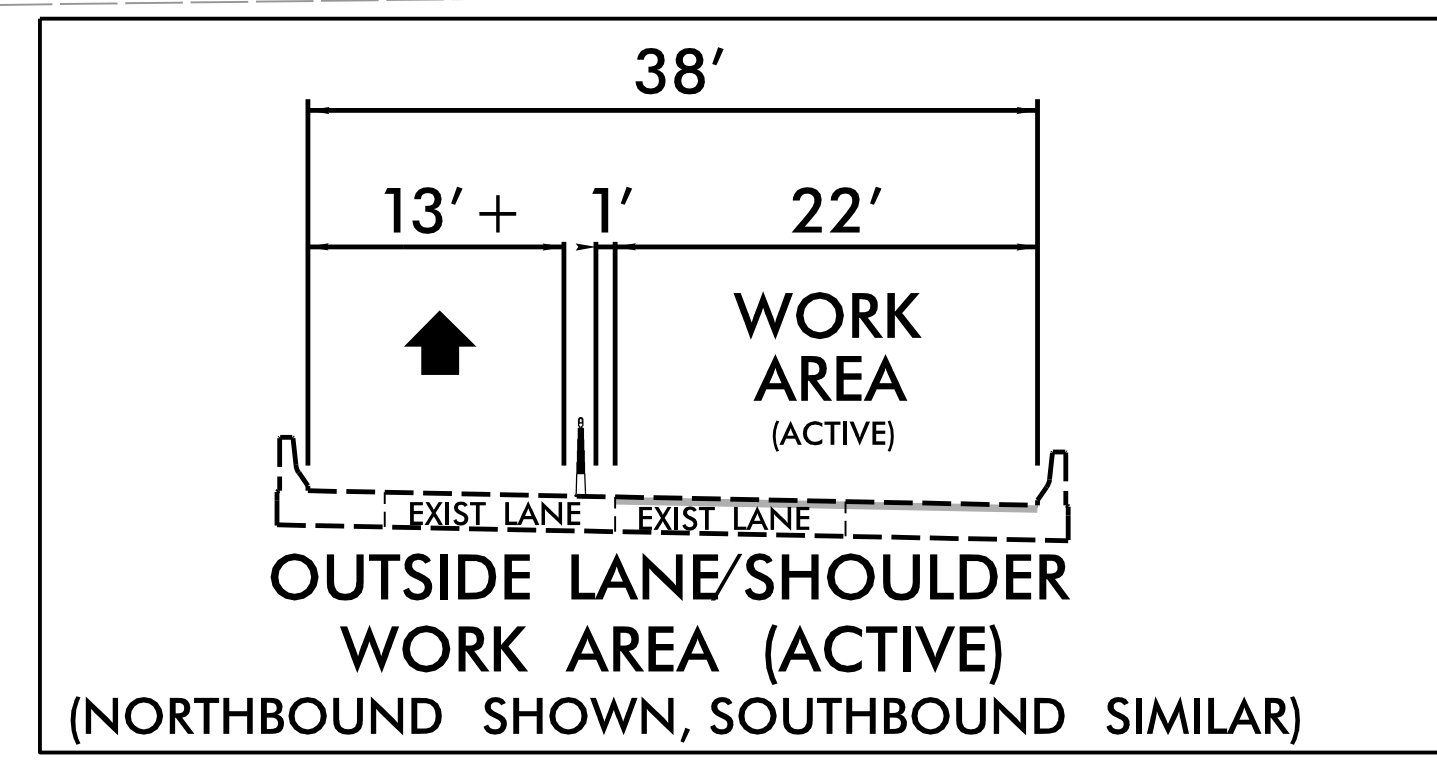
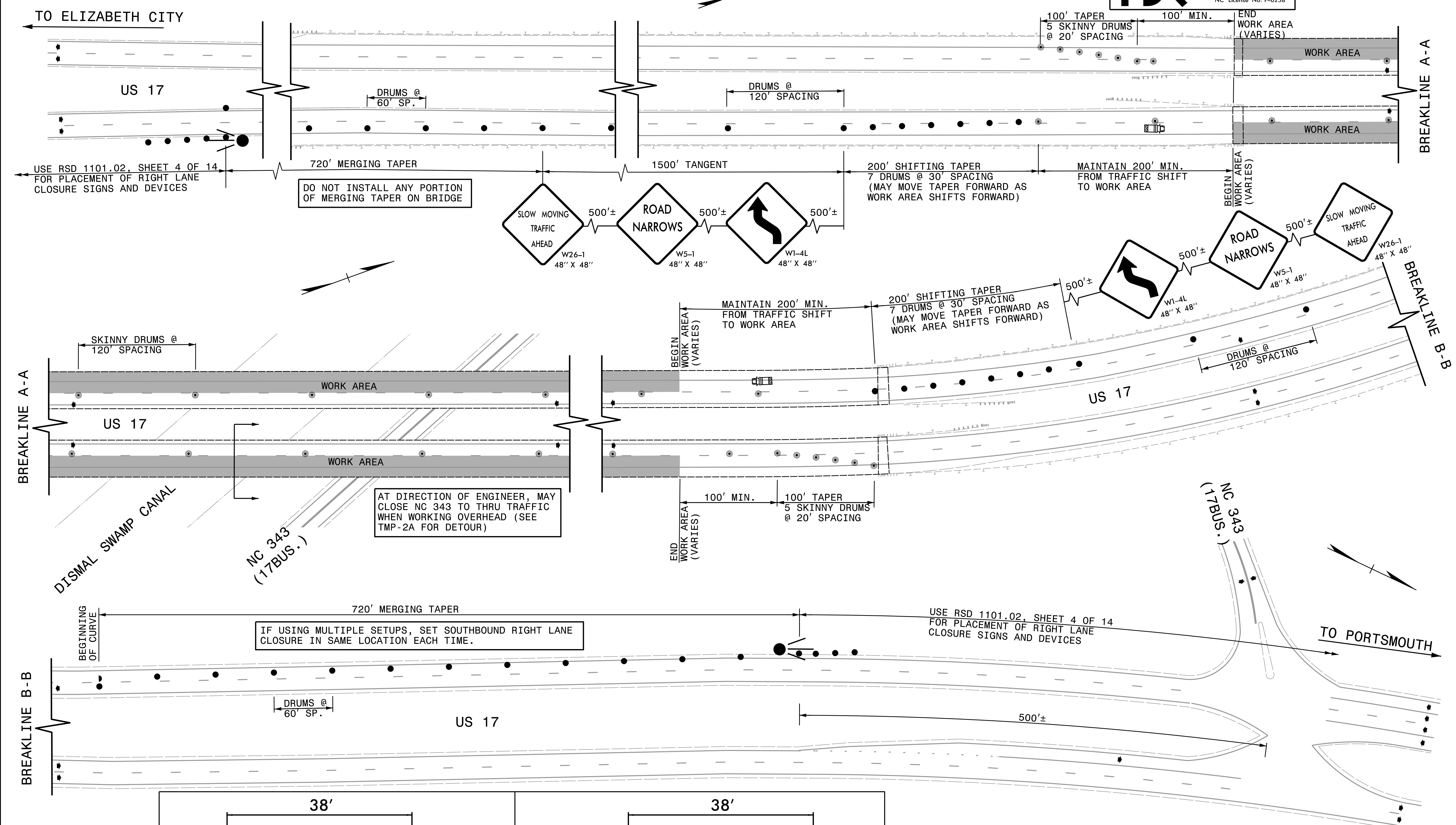

APPROVED: *Michael T. Rzepka*  
DATE: 3/13/2018  
SEAL  
NORTH CAROLINA PROFESSIONAL ENGINEER  
MICHAEL T. RZEPKA  
15876

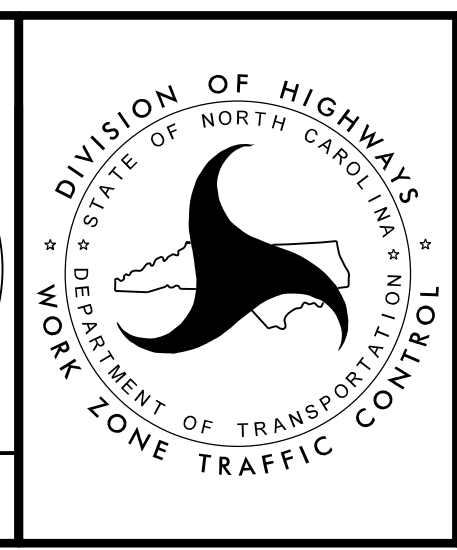

**OUTSIDE LANE AND SHOULDER WORK AREA DETAILS**

3/13/2018 4:11:18 PM Projects\15BPR\11Camden\TCP\cam5bpr\11tmp\_dtl\_4.dgn