

# SURVEY CONTROL SHEET B-4448 FINAL

PROJECT REFERENCE NO. <b>B-4448</b>	SHEET NO. <b>1C-1</b>
Location and Surveys	



GPS POINT	DESC.	NORTH	EAST	ELEVATION	L STATION	OFFSET
GPS1	GPS1	729759.9930	1243672.7020	1242.40	19+29.49	53.77 RT
GPS2	GPS2	729909.7120	1244690.1780	1188.85	29+23.40	318.00 RT

BL POINT	DESC.	NORTH	EAST	ELEVATION	L STATION	OFFSET
1	BL1	729494.1040	1242833.1190	1260.27	10+52.03	1.64 RT
2	BL2	729714.2450	1243418.0750	1248.22	16+77.48	4.74 LT
3	BL3	729957.1090	1243991.7140	1236.52	23+00.41	1.35 LT
4	BL4	730190.0050	1244544.7140	1224.14	29+00.44	3.04 RT
5	BL5	730447.4580	1245142.3240	1211.68	35+51.15	2.50 RT
6	BL6	730683.2340	1245694.8680	1200.50	41+51.89	4.07 RT
7	BL7	730914.5600	1246249.8880	1190.13	OUTSIDE PROJECT LIMITS	

.....  
 BM1 ELEVATION = 1255.18  
 N 729497 E 1243058  
 L STATION 12+65.25 68.44' RIGHT  
 PUNCH HOLE IN CENTER POST OF CONC. BASE  
 OF VALDESE EXIT SIGN  
 .....  
 BM2 ELEVATION = 1227.07  
 N 730136 E 1244430  
 L STATION 27+73.92 7.58' RIGHT  
 PUNCH HOLE IN NW COR. OF EB BRIDGE END  
 BENT  
 .....  
 BM3 ELEVATION = 1195.10  
 N 730805 E 1246211  
 LOCATED S 19°25'37.44" W DIST 116.65'  
 FROM BL-7  
 RR SPIKE IN BASE OF 15" WHITE OAK  
 .....

BY POINT	DESC.	NORTH	EAST	ELEVATION	Y1 STATION	OFFSET
8	BY8	729401.5190	1244724.8630	1194.83	OUTSIDE PROJECT LIMITS	
9	BY9	729969.4520	1244656.2150	1189.93	16+61.57	38.16 LT
10	BY10	730371.4720	1244316.5090	1220.81	11+42.86	21.89 RT
11	BY11	730791.2160	1244073.4860	1245.28	OUTSIDE PROJECT LIMITS	

BY1 POINT	DESC.	NORTH	EAST	ELEVATION	L STATION	OFFSET
12	BY12	729499.6730	1243248.9960	1242.93	14+42.92	130.93 RT
13	BY13	729637.3200	1243821.8310	1226.04	20+18.06	225.36 RT

BY2 POINT	DESC.	NORTH	EAST	ELEVATION	Y1 STATION	OFFSET
14	BY14	730240.8120	1244046.9950	1259.84	10+97.05	317.88 RT
10	BY10	730371.4720	1244316.5090	1220.81	11+42.86	21.89 RT

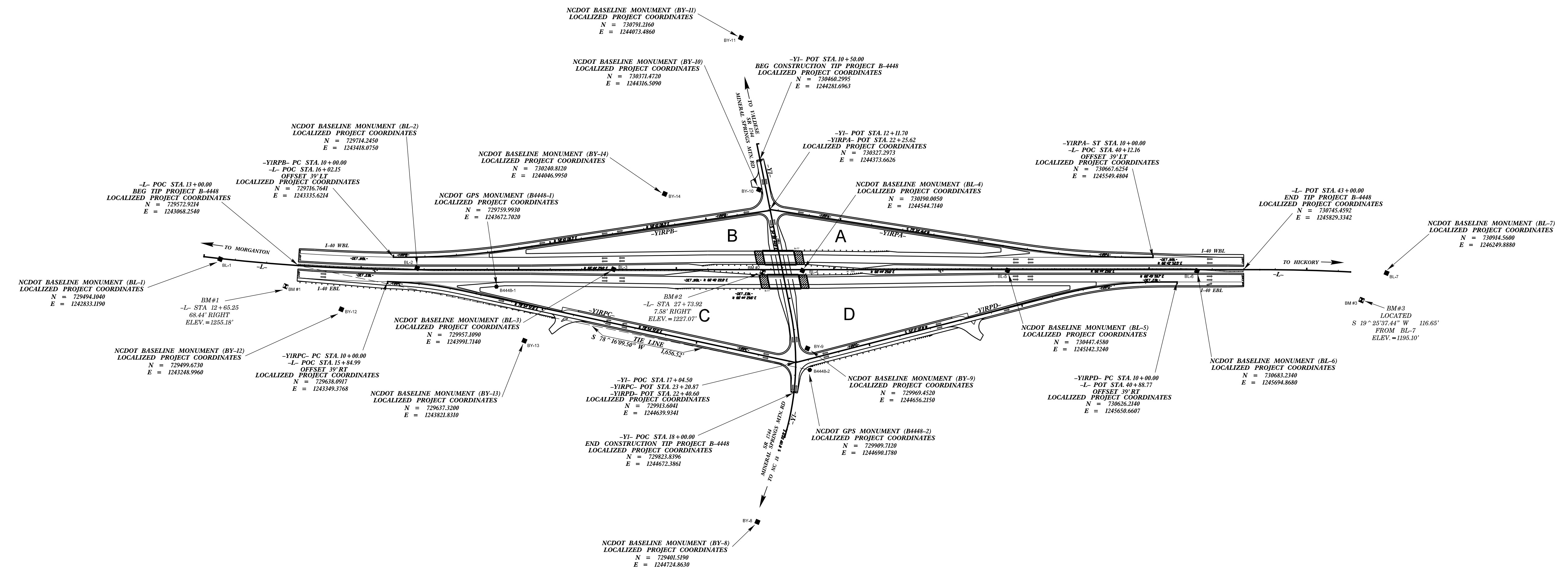

**NOTES:**

- THE CONTROL DATA FOR THIS PROJECT CAN BE FOUND ELECTRONICALLY BY SELECTING PROJECT CONTROL DATA AT:  
[HTTP://WWW.DOH.DOT.STATE.NC.USPRECONSTRUCTHIGHWAY/LOCATION/PROJECT/](http://www.doh.dot.state.nc.us/preconstructhighway/location/project/)  
 THE FILES TO BE FOUND ARE AS FOLLOWS:  
**B4448\_LS\_CONTROL.TXT**  
 SITE CALIBRATION INFORMATION HAS NOT BEEN PROVIDED FOR THIS PROJECT. IF FURTHER INFORMATION IS NEEDED, PLEASE CONTACT THE LOCATION AND SURVEYS UNIT.
- INDICATES GEODETIC CONTROL MONUMENTS USED OR SET FOR HORIZONTAL PROJECT CONTROL BY THE NCDOT LOCATION AND SURVEYS UNIT.  
 PROJECT CONTROL ESTABLISHED USING GLOBAL POSITIONING SYSTEM.  
 NETWORK ESTABLISHED FROM NGS ONLINE POSITIONING SERVICE (OPUS)

**DATUM DESCRIPTION**

THE LOCALIZED COORDINATE SYSTEM DEVELOPED FOR THIS PROJECT IS BASED ON THE STATE PLANE COORDINATES ESTABLISHED BY NCDOT FOR MONUMENT "B-4448-2" WITH NAD 83 STATE PLANE GRID COORDINATES OF  
 NORTHING: 729909.7120(±) EASTING: 1244690.1780(±)  
 ELEVATION: 1188.85(±)  
 THE AVERAGE COMBINED GRID FACTOR USED ON THIS PROJECT (GROUND TO GRID) IS: 0.999856906  
 THE N.C. LAMBERT GRID BEARING AND LOCALIZED HORIZONTAL GROUND DISTANCE FROM "B-4448-2" TO -L- 13+00 STATION IS  
 S 78°16'09.50" W 1.656.52'  
 ALL LINEAR DIMENSIONS ARE LOCALIZED HORIZONTAL DISTANCES  
 VERTICAL DATUM USED IS NAVD 88

NOTE: DRAWING NOT TO SCALE

4/1/2008 11:58:10 AM N:\Projects\B4448.LS.1C-1.dgn