

5TH ST. ROADWAY PLAN SHEET

HNTB HNTB NORTH CAROLINA, P.C.
343 E. Six Forks Road, Suite 200
Raleigh, North Carolina 27609
NC License No: C-1554

PROJECT REFERENCE NO. P-5705BA SHEET NO. 14

DATE: MARCH 16, 2018

R/W SHEET NO.

ROADWAY DESIGN ENGINEER

Eric W. Seckinger 3/15/2018

NORTH CAROLINA
DEPARTMENT OF TRANSPORTATION
DB 14797 PG 69
DB 13723 PG 187
DB 13723 PG 184
DB 13723 PG 174
DB 13713 PG 486
DB 13713 PG 382

NOTE:
SEE SHEETS 4 THRU 6
FOR TRACK PLANS AND
PROFILES AND DRAINAGE
DETAILS

PROP. EMERGENCY EGRESS
STAIRS AND WALKWAY
(SEE P-5705BB PLANS)

BEGIN P-5705BB -SI- STA.19+15.71
(GATE, WALKWAY, EGRESS STAIRS,
AND OTHER ITEMS DETAILED
IN P-5705BB PLANS)

CHARLOTTE GATEWAY VILLAGE, LLC
DB 10126 PG 259
MB 30 PG 203

TIE TO EXISTING CURB
& GUTTER
-Y3- STA 12+55.99

END PROP. FULL
DEPTH PAVEMENT
-Y3- STA 12+56.96

TIE TO EXISTING SIDEWALK
AT -Y3- STA 12+70.83

Y3 ROADWAY CURVE DATA

PI Sta 13+83.72
Δ = 2° 55' 32.0" (LT)
D = 2° 18' 43.3"
L = 126.54'
T = 63.28'
R = 2,478.15'
e = EXISTING

S 45°50'00" E
331.67'

END CONSTRUCTION
TIE TO EXISTING PAVEMENT
END PROP. 3" MILL AND RESURFACE
AT -Y3- STA 13+50.00

POST GATEWAY PLACE, LLC
DB 24172 PG 796
MB 32 PG 338

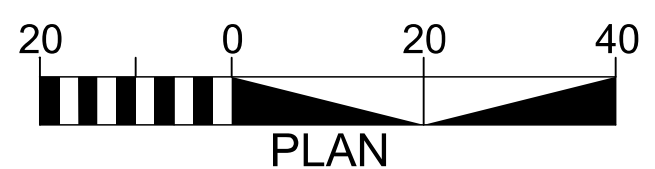
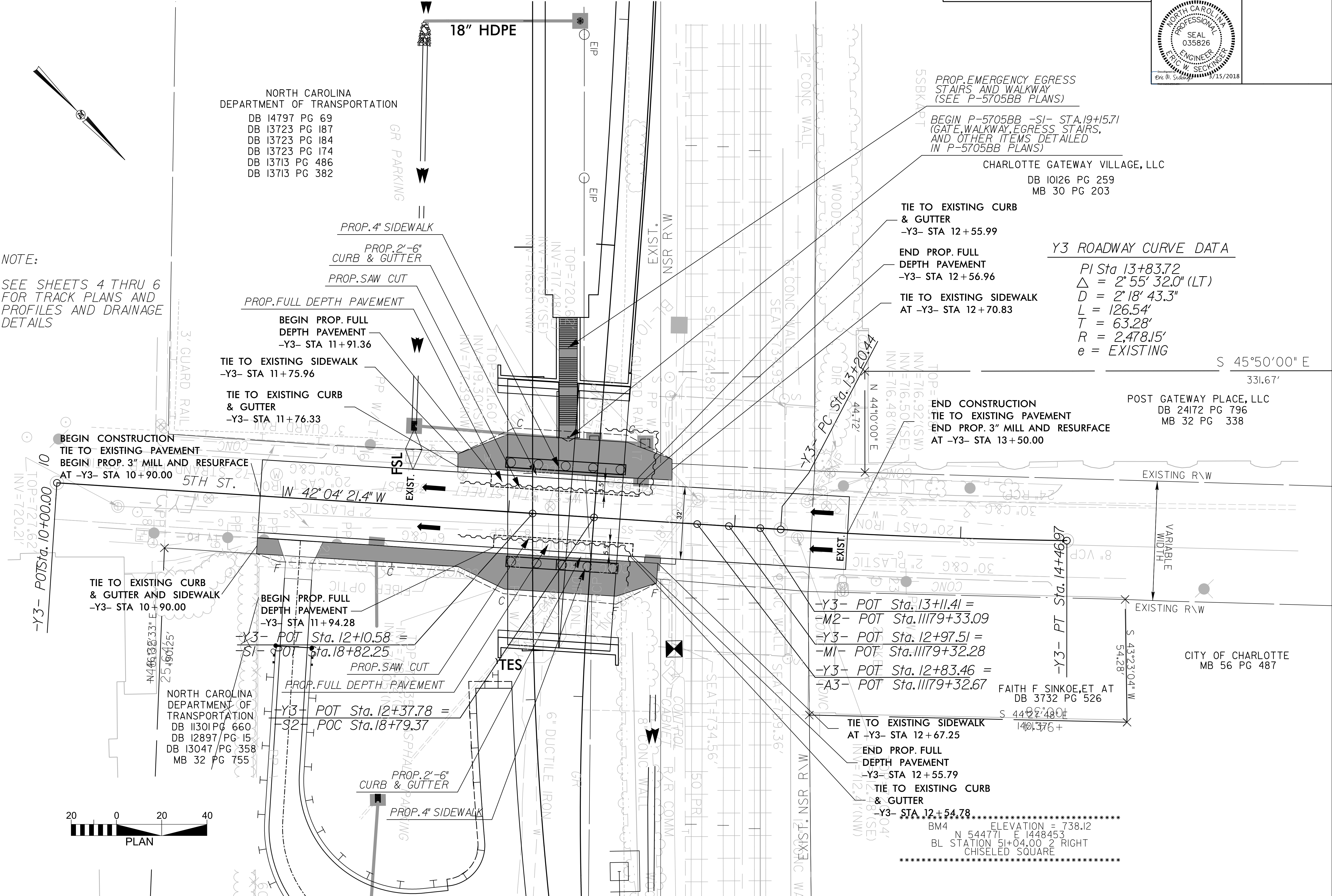

3/14/2018
hntb-14.dgn

ELEVATION = 738.12
BM4 N 544771 E 1448453
BL STATION 51+04.00 2 RIGHT
CHISELED SQUARE
