

DRAWINGS AND DIMENSIONS:

- DO NOT SCALE DRAWINGS FOR DIMENSIONS NOT GIVEN.
- VERIFY ALL EXISTING FIELD CONDITIONS AND DIMENSIONS (INCLUDING MINIMUM VERTICAL CLEARANCE) PRIOR TO COMMENCING REPAIRS OR ORDERING ANY MATERIAL. NOTIFY ENGINEER OF ANY DISCREPANCIES FOUND.
- ALL DIMENSIONS ARE IN FEET AND INCHES.

DESIGN SPECIFICATIONS:

- LRFD BRIDGE DESIGN SPECIFICATIONS (8TH EDITION, 2017)
- 2018 NCDOT STANDARD SPECIFICATIONS AND PROJECT SPECIAL PROVISIONS.

PROJECT SCOPE:

- SUPERSTRUCTURE REPLACEMENT (SPANS 1 - 28)
- POLYESTER POLYMER CONCRETE (PPC) OVERLAY
- APPROACH ROADWAY - MILLING AND GUARDRAIL REPLACEMENT
- BRIDGE RAIL RETROFIT
- SUPERSTRUCTURE CONCRETE REPAIRS
- SUBSTRUCTURE CONCRETE REPAIRS
- GALVANIC CATHODIC PROTECTION PILE JACKET
- GALVANIC CATHODIC PROTECTION - METALIZING
- GALVANIC CATHODIC PROTECTION - BULK ANODE
- JOINT REPLACEMENT
- NAVIGATIONAL LIGHT SYSTEM

GENERAL NOTES:

- IT IS THE CONTRACTORS RESPONSIBILITY TO FOLLOW ALL STATE AND FEDERAL REQUIREMENTS.
- FOR SUBMITTAL OF FALSEWORK AND FORMWORK, SEE SPECIAL PROVISIONS.
- FOR SUBMITTAL OF WORKING DRAWINGS, SEE SPECIAL PROVISIONS.
- FOR CONTROL OF TRAFFIC AND LIMITS ON PHASING CONSTRUCTION, SEE TRANSPORTATION MANAGEMENT PLAN.
- FOR EPOXY RESIN INJECTION, SEE SPECIAL PROVISIONS.
- FOR SHOTCRETE REPAIRS, SEE SPECIAL PROVISIONS.
- FOR SILICONE JOINT SEALANT, SEE SPECIAL PROVISIONS.
- FOR CONCRETE REPAIRS, SEE PLAN DETAILS AND SPECIAL PROVISIONS.
- FOR GROUT FOR STRUCTURES, SEE SPECIAL PROVISIONS.
- FOR CONCRETE DECK REPAIR FOR PPC OVERLAY, SEE SPECIAL PROVISIONS.
- ALL PROPOSED EXPANSION JOINT DIMENSIONS, OPENINGS AND BLOCKOUTS ARE SHOWN AT 60°F, CONTRACTOR SHALL FOLLOW MANUFACTURER'S INSTALLATION GUIDELINES AND MAKE ANY NECESSARY ADJUSTMENTS.
- WORK ON BRIDGE SHALL BE PERFORMED SO AS NOT TO ALLOW DEBRIS TO FALL INTO THE WATER. THE CONTRACTOR SHALL SUBMIT PLANS FOR CONSTRUCTION IN ACCORDANCE WITH ARTICLE 402-2 OF THE STANDARD SPECIFICATIONS.
- PRIOR TO BEGINNING WORK, THE CONTRACTOR SHALL SUBMIT FOR REVIEW AND APPROVAL, A COMPLETE SEQUENCE OF TASKS FOR EACH OPERATION AFFECTING THE BRIDGE SURFACE AND/OR TRAFFIC.
- ANY DAMAGE TO EXISTING REINFORCING STEEL, DURING CONTRACTOR'S OPERATIONS, SHALL BE REPAIRED AS DIRECTED BY THE ENGINEER AND PERFORMED AT NO ADDITIONAL COST.
- FOR SURFACE PREPARATION FOR PPC OVERLAY, SEE SPECIAL PROVISIONS.
- FOR PPC OVERLAY, SEE SPECIAL PROVISIONS.
- FOR SILICONE JOINT SEALANT, SEE SPECIAL PROVISIONS.
- FOR MAINTENANCE OF WATER TRAFFIC, SEE SPECIAL PROVISIONS.
- FOR WORK IN, OVER AND ADJACENT TO NAVIGABLE WATERS, SEE SPECIAL PROVISIONS.

DATUM:

ALL ELEVATIONS REFER TO NGVD '29 UNLESS NOTED OTHERWISE.

ENVIRONMENT:

SUPERSTRUCTURE: EXTREMELY AGGRESSIVE - COASTAL
 SUBSTRUCTURE: EXTREMELY AGGRESSIVE - COASTAL

SITE CONDITIONS:

HABITAT BEYOND THE LIMITS OF CONSTRUCTION SHALL NOT BE DISTURBED.

CONCRETE CLASS:

SEE PROJECT SPECIAL PROVISIONS FOR CONCRETE REPAIR MATERIALS.

CONCRETE COVER:

- CONCRETE COVER SHOWN IN THE PLANS DOES NOT INCLUDE PLACEMENT OR FABRICATION TOLERANCES UNLESS SHOWN AS "MINIMUM COVER." SEE NCDOT SPECIFICATIONS FOR ALLOWABLE REINFORCEMENT PLACEMENT TOLERANCES.
- CONSTRUCTION JOINTS ARE PERMITTED ONLY AT LOCATIONS SPECIFIED IN THE PLANS. ADDITIONAL CONSTRUCTION JOINTS OR ALTERATIONS TO THOSE SHOWN REQUIRE THE ENGINEER'S APPROVAL.

CONCRETE FINISHES:

FINISH IN ACCORDANCE WITH THE LATEST NCDOT SPECIFICATIONS. MATCH EXISTING FINISH ON ALL EXPOSED EDGES UNLESS OTHERWISE NOTED. A CLASS 5 FINISH COATING SHALL BE APPLIED TO THE BEAM ENDS WHERE CONCRETE REPAIRS HAVE BEEN PERFORMED, MATCHING THE COLOR OF SURROUNDING CONCRETE.

REINFORCING STEEL:

- ALL REINFORCING STEEL SHALL BE ASTM A615-96, GRADE 60.
- ALL DIMENSIONS PERTAINING TO LOCATION OF REINFORCEMENT ARE TO CENTERLINE OF BARS EXCEPT WHERE THE CLEAR DIMENSION IS SHOWN TO FACE OF CONCRETE.
- REINFORCEMENT DETAIL DIMENSIONS ARE OUT-TO-OUT OF BARS.

ADJACENT EDGE CONCRETE REPAIRS:

WHEN PROPOSED CONCRETE REPAIRS (OR DETERMINED LOCATIONS) ARE ADJACENT TO A CORNER, REPAIR ON THE ADJACENT EDGE SHOULD BE ANTICIPATED IN ADDITION TO THE AREA SHOWN ON CONCRETE REPAIR SHEETS. CONTRACTOR IS RESPONSIBLE FOR THIS REPAIR AT ALL LOCATIONS REGARDLESS OF CALL-OUT ON RESPECTIVE SHEET(S).

LIMIT OF REPAIRS:

- LIMITS OF REPAIRS PROVIDED IN THESE PLANS ARE BASED ON PREVIOUS NBIS ELEMENT INSPECTIONS AND LIMITED FIELD WORK. THE EXTENT OF THE REPAIRS IS EXPECTED TO VARY DURING CONSTRUCTION.
- DUE TO TIME SINCE INSPECTION, DEFICIENCIES MAY HAVE DETERIORATED OR INCREASED IN NUMBER. NOTIFY THE ENGINEER OF SIGNIFICANT CHANGES.

FORMS CONSTRUCTION:

FORMS MUST BE SUPPORTED BY THE EXISTING STRUCTURE. FULL DEPTH COFFERDAMS WILL NOT BE ACCEPTED. THE CONTRACTOR SHALL SUBMIT DETAILED PLANS FOR FORMS AND FALSEWORK TO BE USED FOR CONSTRUCTION OF THE PIER AND CONCRETE REPAIR.

CONSTRUCTION SURVEYING:

ALL SURVEYING AND STAKING IS INCIDENTAL TO ALL OTHER PAY ITEMS FOR THIS PROJECT.

ENVIRONMENTAL NOTES:

STANDARD CONSTRUCTION CONDITIONS SHALL BE IMPLEMENTED FOR THE FOLLOWING PROTECTED/ENDANGERED SPECIES AS APPLICABLE AND INCLUDED IN CONTRACT DOCUMENTS.

- A. WEST INDIAN MANATEE
- B. VARIOUS SEA TURTLE SPECIES
- C. ATLANTIC STURGEON

POLLUTION CONTROL:

- THE CONTRACTOR SHALL SUBMIT A POLLUTION CONTROL PLAN TO THE ENGINEER IN ACCORDANCE THE NCDOT STANDARD SPECIFICATIONS, PRIOR TO COMMENCING ANY CONSTRUCTION ACTIVITIES.
- THE CONTRACTOR SHALL NOT ALLOW, AT ANY TIME, ANY DISCHARGE OR MATERIALS TO FALL INTO THE WATERWAY.
- THE CONTRACTORS SHALL SUBMIT TO THE ENGINEER AN EROSION CONTROL PLAN AS REQUIRED BY THE NCDOT STANDARD SPECIFICATIONS AND BEST MANAGEMENT PRACTICES.
- NO OFFSITE IMPACTS SHALL BE PERMITTED.

INCIDENTAL NOTES:

- PAYMENT FOR INCIDENTAL ITEMS NOT SPECIFICALLY COVERED IN THE INDIVIDUAL BID ITEMS SHALL BE INCLUDED IN THE CONTRACT UNIT PRICE FOR THE BID ITEMS CONTAINED IN THE CONTRACT.

INTERMEDIATE CONTRACT TIME:

- FOR ICT, SEE CONTRACT DOCUMENTS.

DOWEL DETAIL:

DOWEL DIMENSIONS (UNLESS OTHERWISE NOTED)			
DOWEL SIZE	HOLE DIAMETER	EMBEDMENT LENGTH	MIN LAP LENGTH
4	5/8"	8"	1'-9"
5	3/4"	9"	2'-2"
6	7/8"	11"	2'-7"
8	1 1/8"	1'-4"	4'-0"

- ANY REQUIRED DOWEL HOLES SHALL BE DRILLED INTO EXISTING CONCRETE ACCORDING TO THE DETAIL AND NCDOT SPECIFICATIONS.
- NOTIFY THE ENGINEER OF ANY BROKEN BARS OR BARS WHICH ARE DETERMINED TO HAVE A SECTION LOSS OF 25% OR GREATER.
- INSTALL DOWELS IN ACCORDANCE WITH NCDOT SPECIFICATIONS.

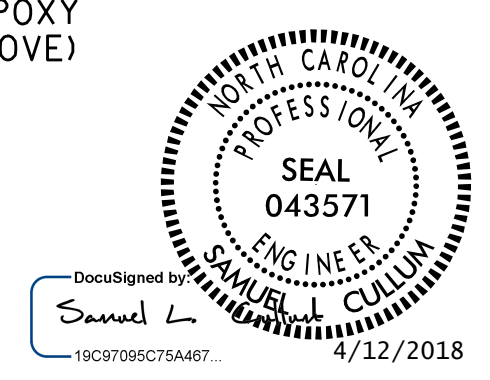
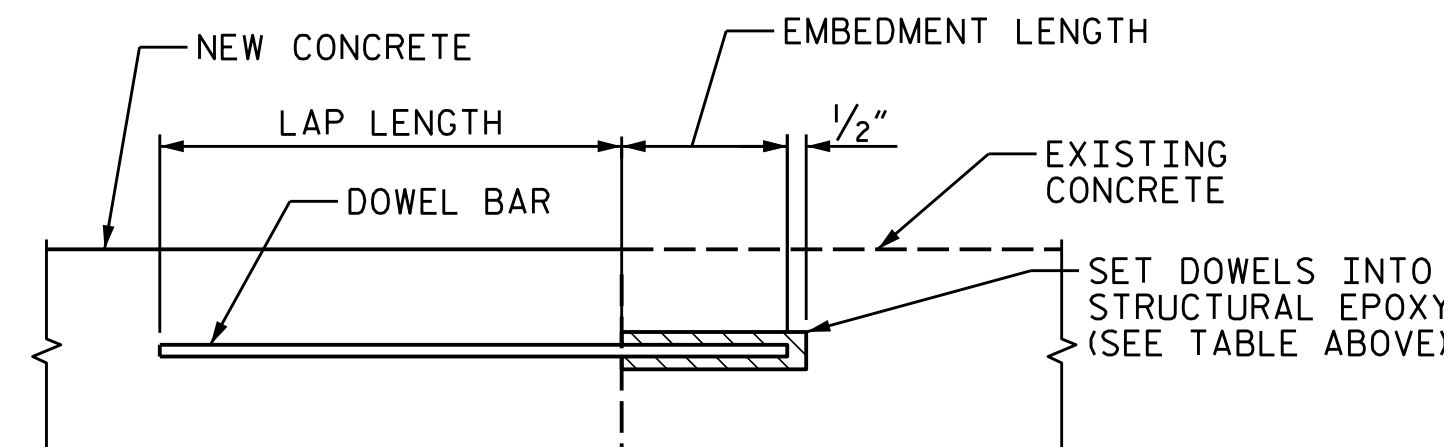

PROJECT NO. 15BPR.25
 BRUNSWICK COUNTY
 BRIDGE NO. 14

SHEET 1 OF 2

STATE OF NORTH CAROLINA
 DEPARTMENT OF TRANSPORTATION
 RALEIGH

GENERAL NOTES

KCA 4800 SIX FORKS ROAD SUITE 120
 KISINGER CAMPO & ASSOCIATES RALEIGH, NC 27609
 (919) 882-7839

DRAWN BY :	JACOB H. DUKE	DATE :	03-2018
CHECKED BY :	DIEGO A. AGUIRRE	DATE :	03-2018
DESIGN ENGINEER OF RECORD :	SAMUEL L. CULLUM	DATE :	03-2018

REVISIONS						SHEET NO.
NO.	BY:	DATE:	NO.	BY:	DATE:	S-2A
1			3			TOTAL SHEETS
2			4			111

DOCUMENT NOT CONSIDERED FINAL UNLESS ALL SIGNATURES COMPLETED