

PLAN - LIFT SPAN GRID DECK

NOTES:

FOR REPLACEMENT OF STEEL GRID DECK, SEE SPECIAL PROVISIONS.

CONTRACTOR MAY ADJUST THE DIMENSIONS AND NUMBER OF PANELS BETWEEN FLOORBEAMS. GRID DECK PANEL WIDTHS SHALL NOT BE LESS THAN 5'-0" OR GREATER THAN 8'-8". NEW GRID DECK SHOP DRAWINGS SHALL INDICATE THAT PROPOSED PANEL DIMENSIONS HAVE BEEN FIELD VERIFIED AND ARE CONSISTENT WITH EXISTING FLOOR SYSTEM DIMENSIONS.

EXISTING FINGER JOINTS AT ENDS OF LIFT SPAN SHALL REMAIN AND SHALL NOT BE ALTERED OR DAMAGED DURING GRID DECK REPLACEMENT OPERATIONS.

CONTRACTOR SHALL SURVEY TOP OF EXISTING GRID DECK ELEVATIONS AT EACH OF THE FOUR CURB LINES TAKEN AT THE ENDS OF THE LIFT SPAN AND AT EACH FLOORBEAM. PRE-CONSTRUCTION SURVEY ELEVATIONS SHALL BE PROVIDED TO THE ENGINEER PRIOR TO COMMENCING GRID DECK REPLACEMENT. SURVEYING SHALL OCCUR WHEN NO LIVE LOAD IS PRESENT ON THE BRIDGE.

UPON COMPLETION OF THE GRID DECK REPLACEMENT, CONTRACTOR SHALL RE-SURVEY THE SAME POINTS AND PROVIDE THE SURVEYED AS-BUILT TOP OF GRID DECK ELEVATIONS TO THE ENGINEER. SURVEYING SHALL OCCUR WHEN NO LIVE LOAD IS PRESENT ON THE BRIDGE.

DIMENSIONS SHOWN ARE HORIZONTAL UNLESS OTHERWISE NOTED.

GRID DECK REPLACEMENT PROCEDURE:

EXISTING GRID DECK PANELS SHALL BE REMOVED AND REPLACED IN A PROGRESSIVE MANNER. GROUPS OF PANELS REMOVED SHALL BE REPLACED WITH NEW PANELS, WITH MINIMAL WELDS OR CLAMPS TO EXISTING STRINGERS, BEFORE MOVING TO THE NEXT WORK AREA.

CONTRACTOR SHALL SUBMIT A PANEL REMOVAL AND REPLACEMENT SEQUENCE TO THE ENGINEER FOR REVIEW PRIOR TO IMPLEMENTING THE TOTAL BRIDGE CLOSURE.

- STEP 1. IMPLEMENT REQUIRED TRAFFIC CONTROL SCHEME PER THE TRAFFIC MANAGEMENT PLANS ASSOCIATED WITH TOTAL CLOSURE OF THE BRIDGE.
- STEP 2. REMOVE EXISTING GRID DECK PANELS FROM WORK AREA. MINIMIZE UNBALANCED LOADING AND DEAD LOAD VARIATIONS DURING REMOVAL AND REPLACEMENT OPERATIONS.
- STEP 3. EXISTING GRID DECK PANEL WELDS ON FLOOR SYSTEM MEMBERS IN WORK AREA SHALL BE GROUND SMOOTH.
- STEP 4. HAND CLEAN EXISTING STRINGER AND FLOORBEAM TOP FLANGES TO BE CLEAR OF DEBRIS TO THE SATISFACTION OF THE ENGINEER PRIOR TO INSTALLING ANY NEW GRID DECK PANELS IN THE GIVEN WORK LOCATION.
- STEP 5. INSTALL NEW GRID DECK PANEL(S) IN WORK AREA. SET NEW GRID DECK PANELS IN PLACE WITH MINIMAL WELDS OR CLAMPS.
- STEP 6. REPEAT STEPS 2 THROUGH 5.

ONCE ALL NEW GRID DECK PANELS ARE SET IN PLACE ON ENTIRE SPAN WITH MINIMAL WELDS OR CLAMPS, MAKE FINAL ADJUSTMENTS BEFORE COMMENCING FINAL WELDING TO STRINGERS.

FINAL FIELD WELDING SHALL BE PERFORMED AFTER FINAL PANEL ADJUSTMENTS ARE COMPLETE AND PRIOR TO OPENING THE BRIDGE TO VEHICULAR TRAFFIC.

UPON COMPLETION OF ALL FIELD WELDING OF PANELS TO FLOOR SYSTEM, FIELD PAINT STRINGER TOP FLANGE PER THE SPECIAL PROVISIONS.

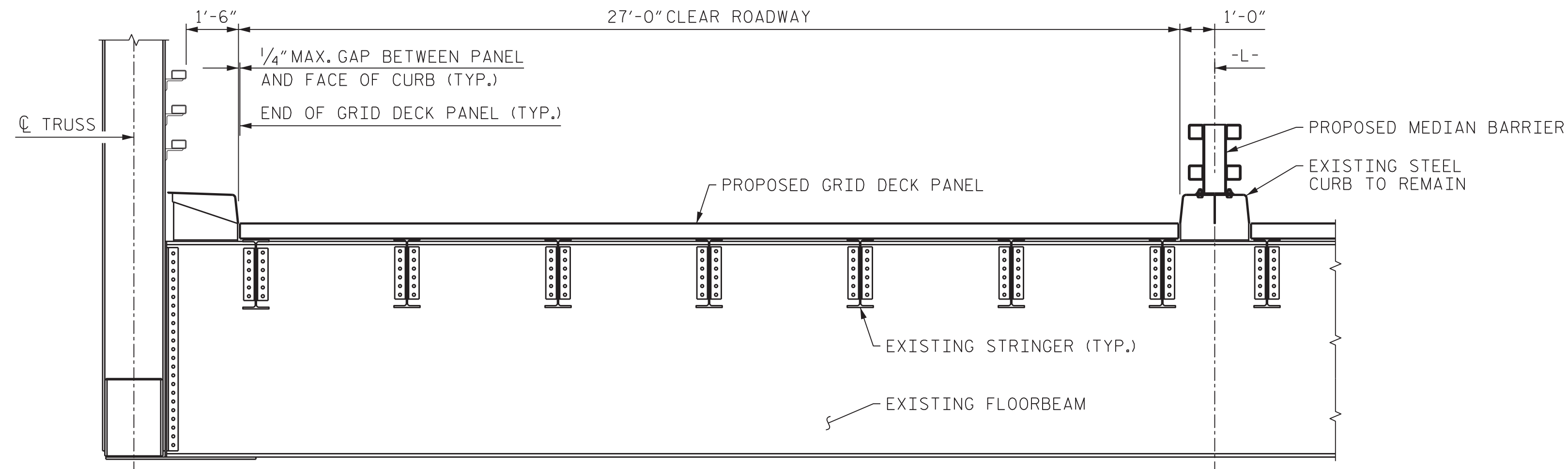

SECTION A-A

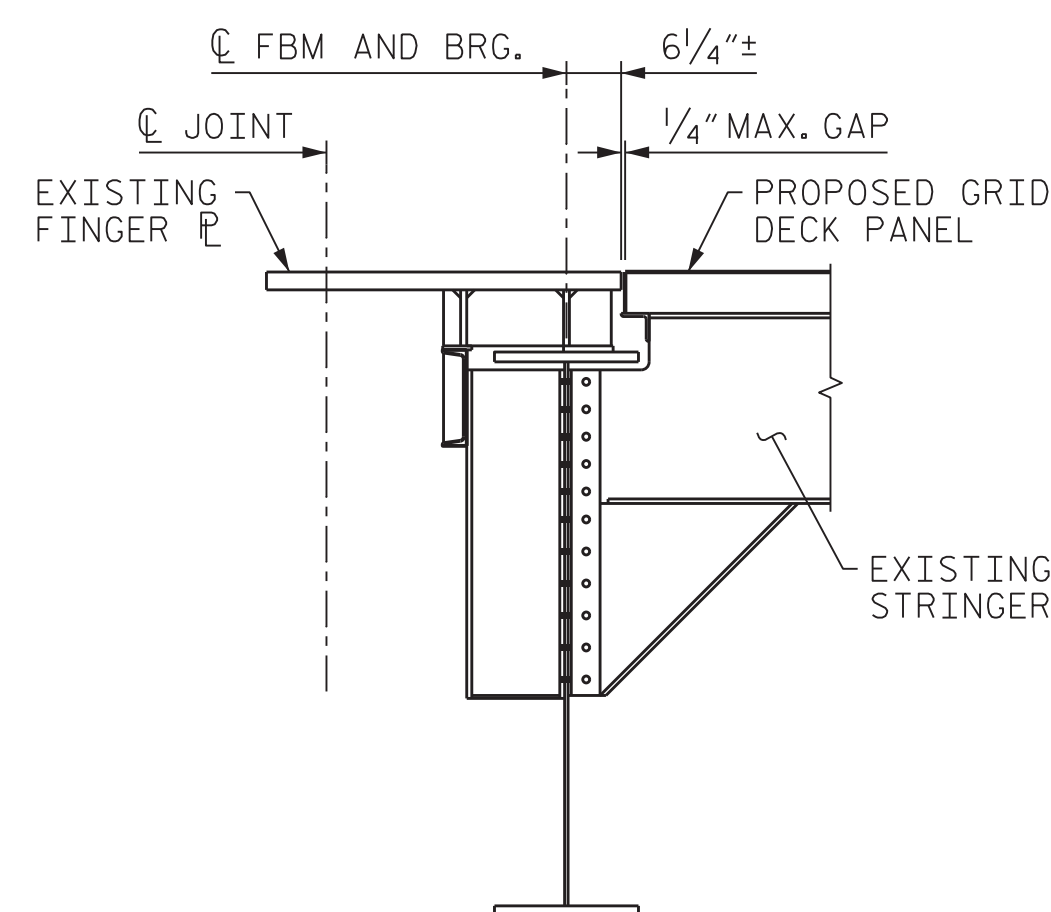

SECTION B-B

PROJECT NO. 15BPR.15
NEW HANOVER COUNTY

STATION: _____

SHEET 1 OF 3

STATE OF NORTH CAROLINA
 DEPARTMENT OF TRANSPORTATION
 RALEIGH

GRID DECK REPLACEMENT

MODJESKI and MASTERS
 Experience great bridges.
 333 FAYETTEVILLE STREET, SUITE 505
 RALEIGH, NC 27601
 NC LICENSE NO. C-2979

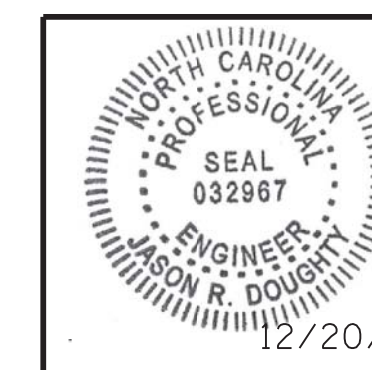

DocuSigned by:
 Jason R Doughty
 5F73FA2DEA974E8...

REVISIONS						SHEET NO.
NO.	BY:	DATE:	NO.	BY:	DATE:	TOTAL SHEETS
1			3			S-21
2			4			66

DOCUMENT NOT CONSIDERED FINAL UNLESS ALL SIGNATURES COMPLETED

12/21/2017 4:00:04 PM 36B202_SML_GRID1_640013.dgn

DESIGNED BY: C. CORMAN/J. DOUGHTY DATE: NOV 2017
 DRAWN BY: K. WHITE DATE: NOV 2017
 CHECKED BY: B. LOFLIN DATE: DEC 2017
 DESIGN ENGINEER OF RECORD: J. DOUGHTY DATE: DEC 2017