

**This electronic collection of documents is provided
for the convenience of the user
and is Not a Certified Document –**

**The documents contained herein were originally issued
and sealed by the individuals whose names and license
numbers appear on each page, on the dates appearing
with their signature on that page.**

**This file or an individual page
shall not be considered a certified document.**

6/23/16



PROJ. REFERENCE NO.
B-5406

SHEET NO.
X-1

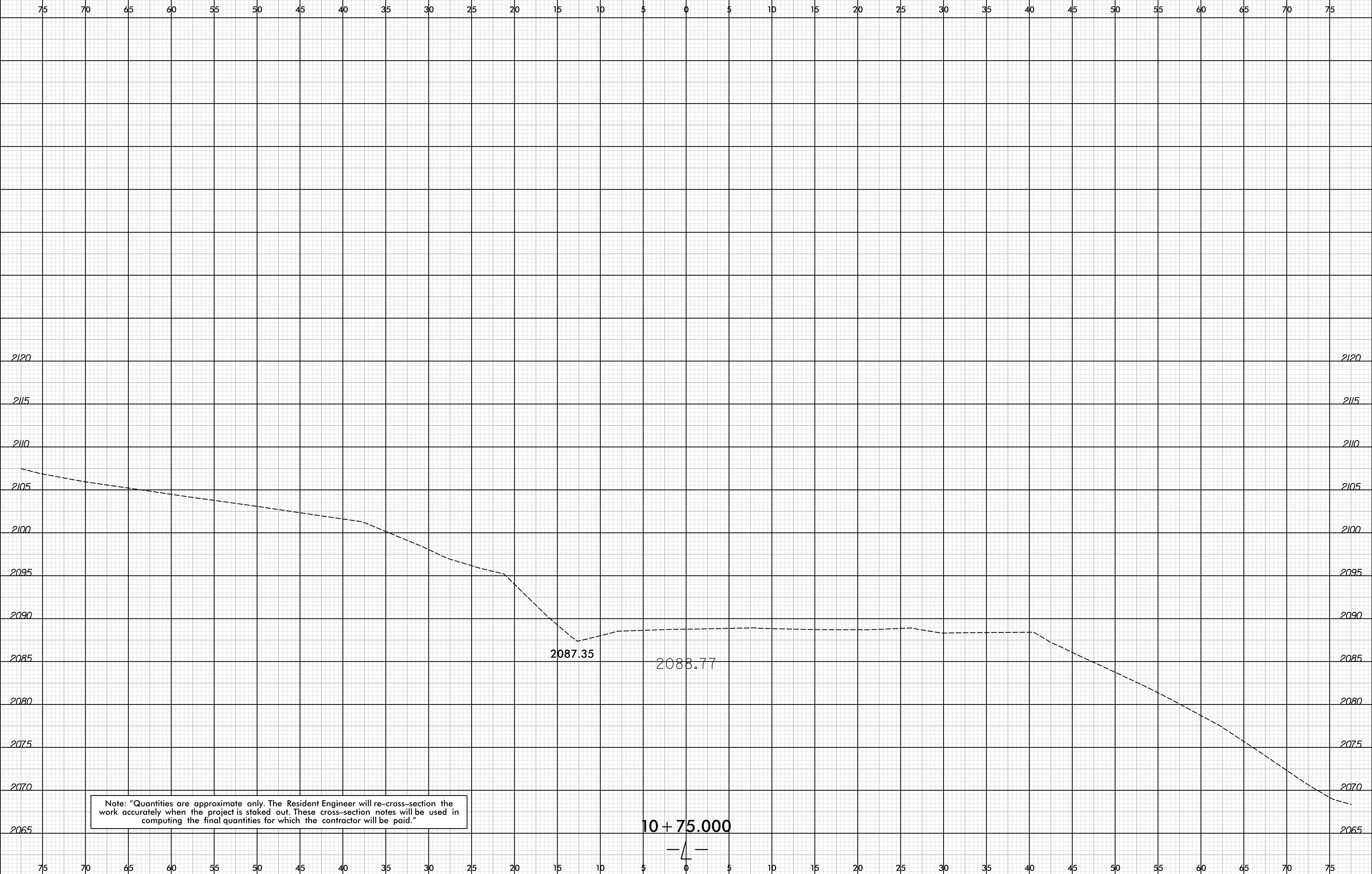

Note: "Quantities are approximate only. The Resident Engineer will re-cross-section the work accurately when the project is staked out. These cross-section notes will be used in computing the final quantities for which the contractor will be paid."

10 + 75.000

10/23/2017
B5406_rdy_xpl.dgn
dgn

6/23/16



PROJ. REFERENCE NO.
B-5406

SHEET NO.
X-2

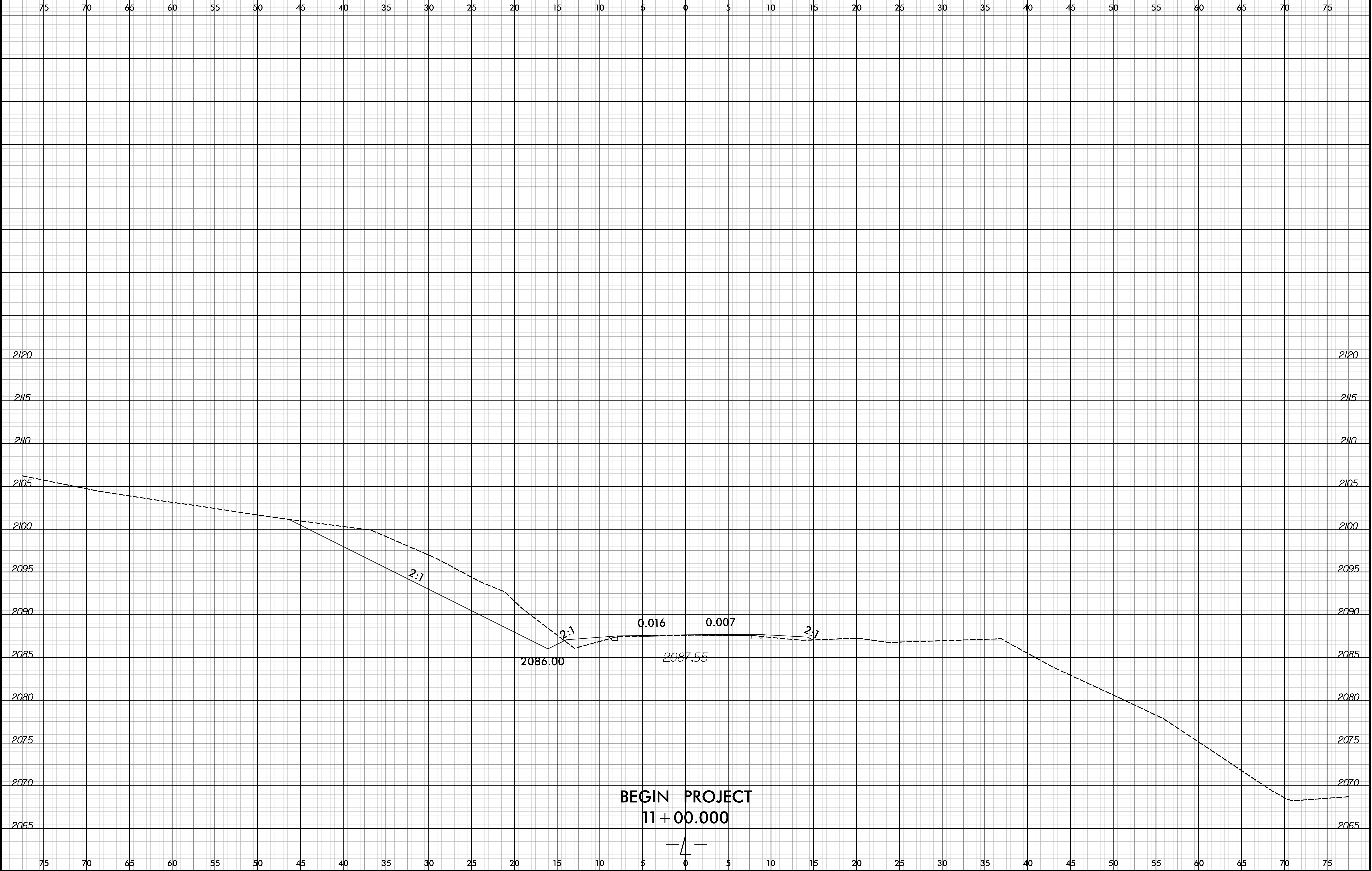

10/23/2017 8:40:06 PM rdj_xpl.dgn

6/23/16



PROJ. REFERENCE NO.	SHEET NO.
B-5406	X-3

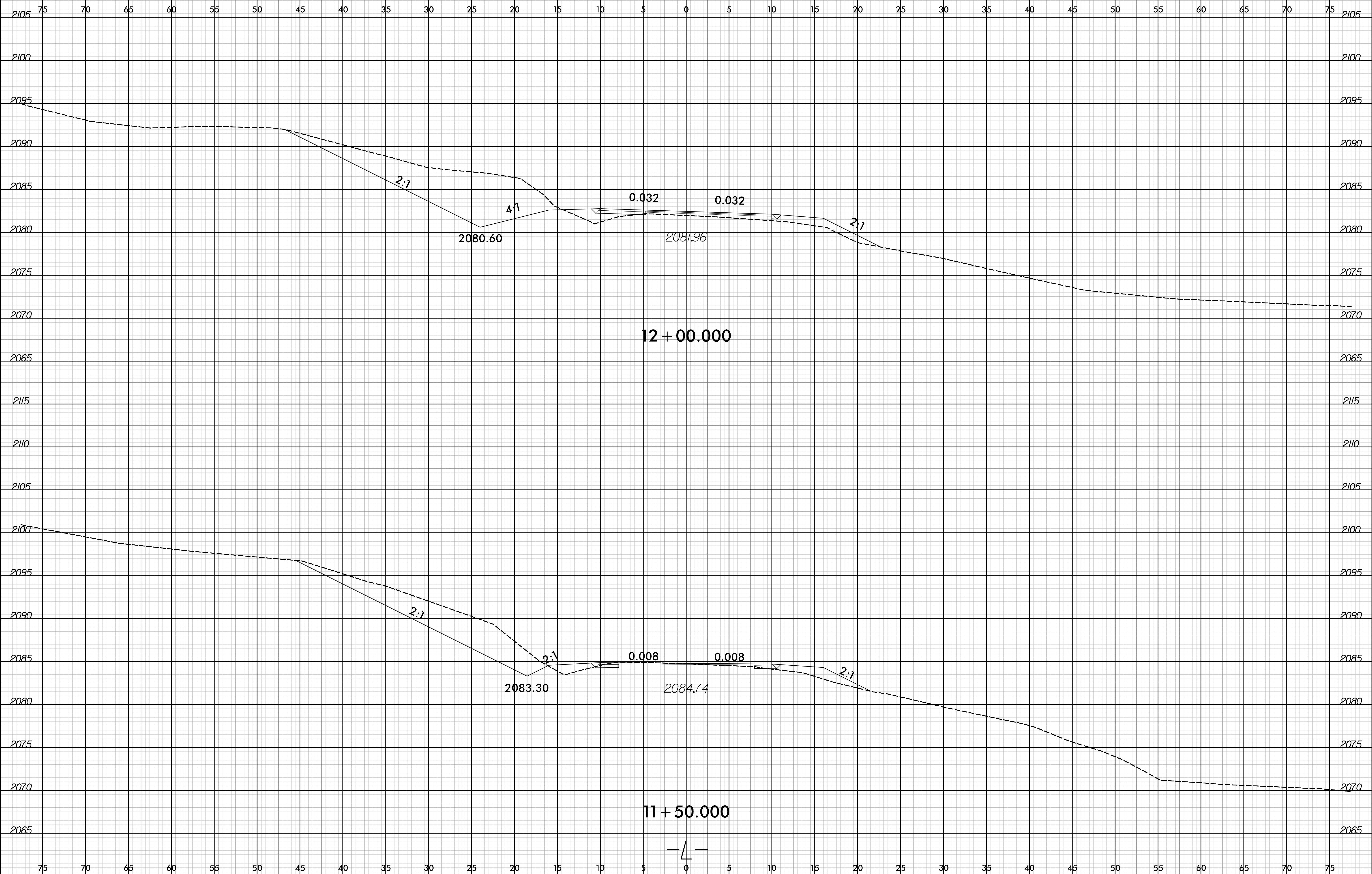

10/23/2017 8:40:06 PM xPL.dgn

6/23/16



PROJ. REFERENCE NO.
B-5406

SHEET NO.
X-4

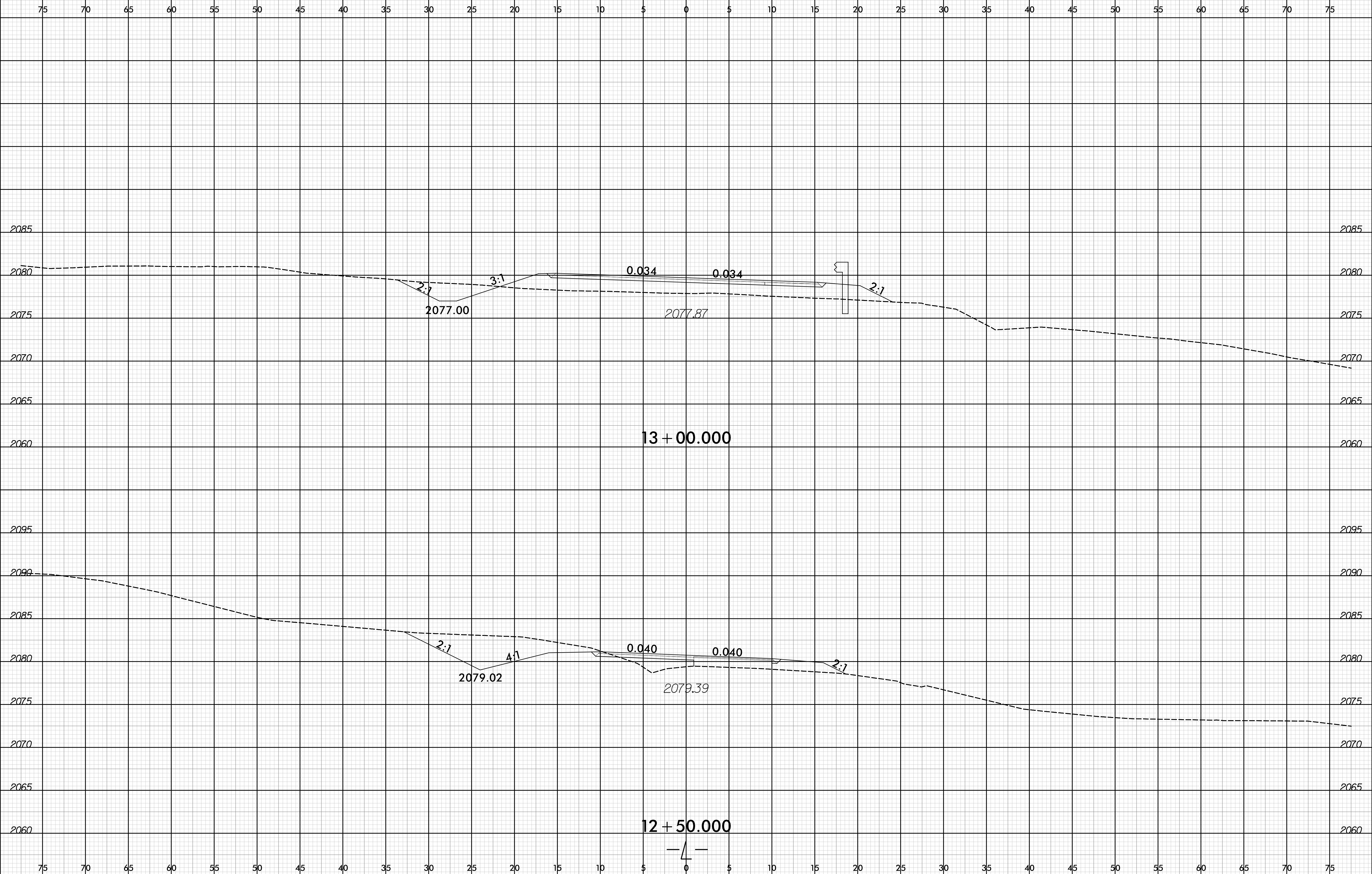

10/23/2017
B5406_rdy_xpl.dgn
jgese



75 70 65 60 55 50 45 40 35 30 25 20 15 10 5 0 5 10 15 20 25 30 35 40 45 50 55 60 65 70 75

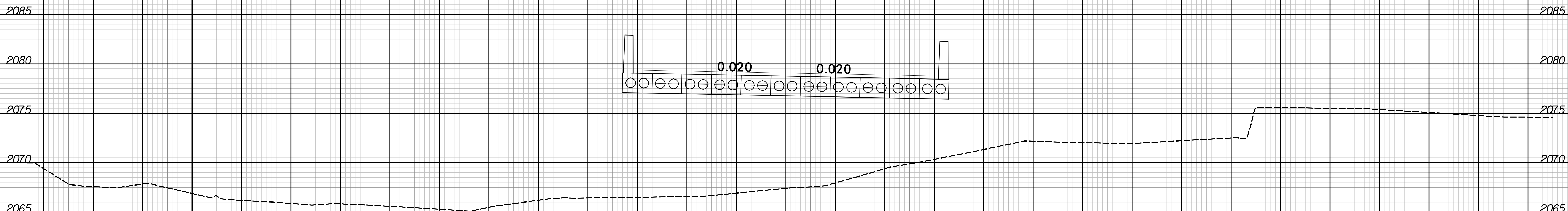

2067.40
14 + 00.000

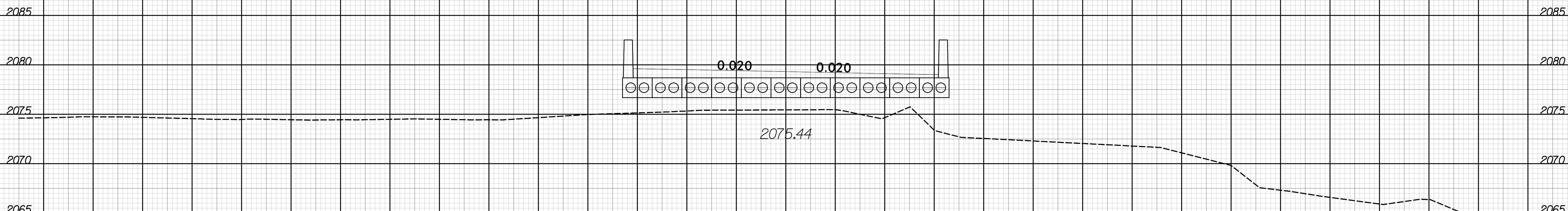

2075.44
13 + 50.000

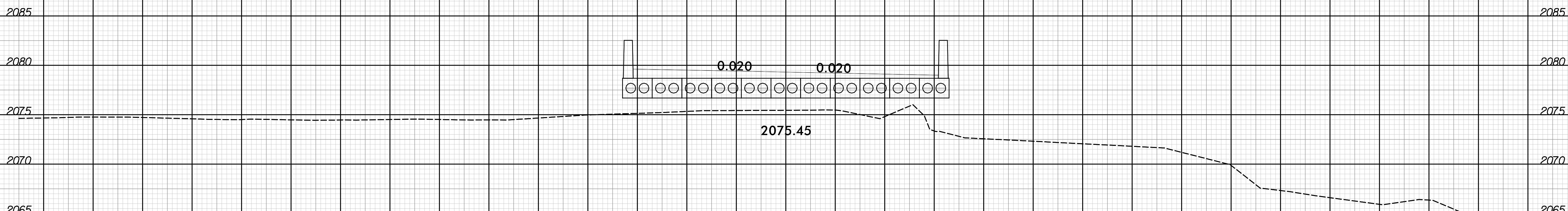

2075.45
13 + 49.830

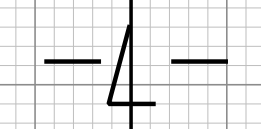

75 70 65 60 55 50 45 40 35 30 25 20 15 10 5 0 5 10 15 20 25 30 35 40 45 50 55 60 65 70 75

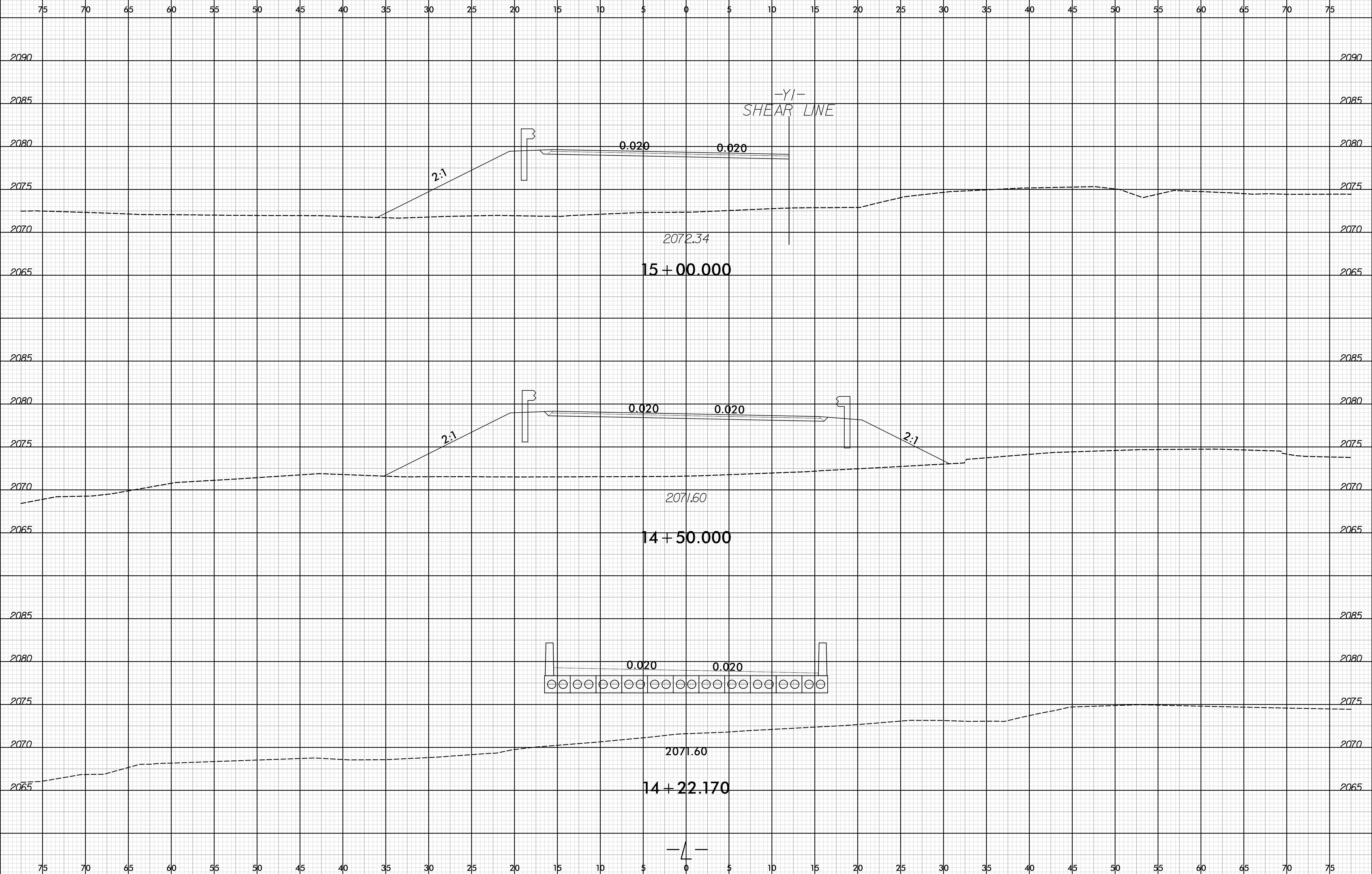



75 70 65 60 55 50 45 40 35 30 25 20 15 10 5 0 5 10 15 20 25 30 35 40 45 50 55 60 65 70 75

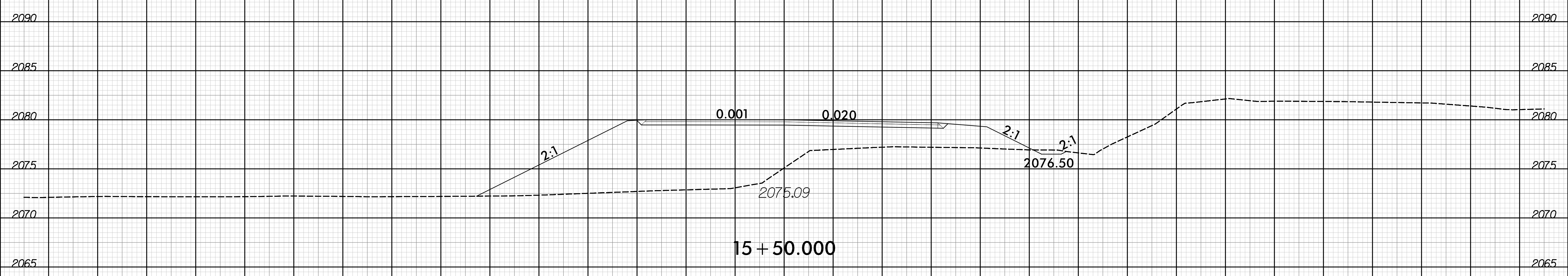
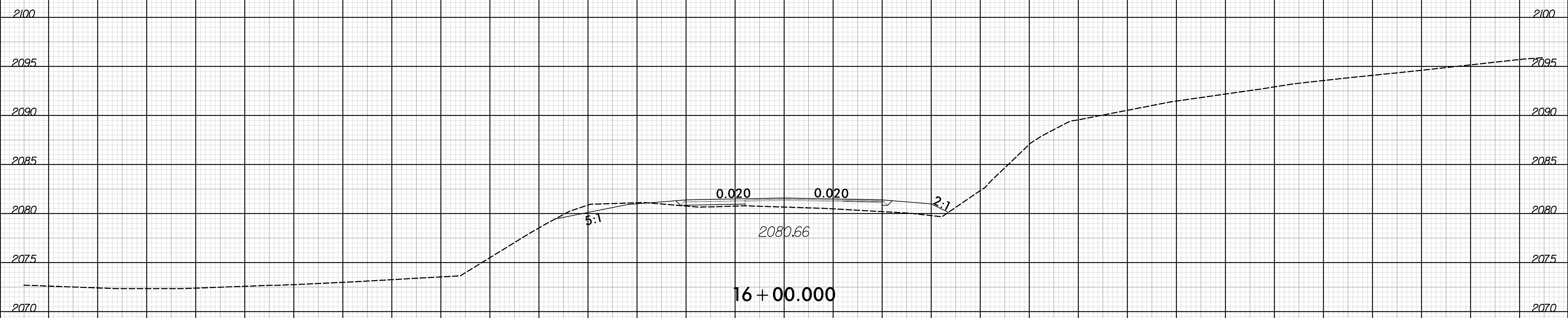

75 70 65 60 55 50 45 40 35 30 25 20 15 10 5 0 5 10 15 20 25 30 35 40 45 50 55 60 65 70 75

6/23/16



PROJ. REFERENCE NO.	SHEET NO.
B-5406	X-8

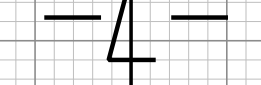
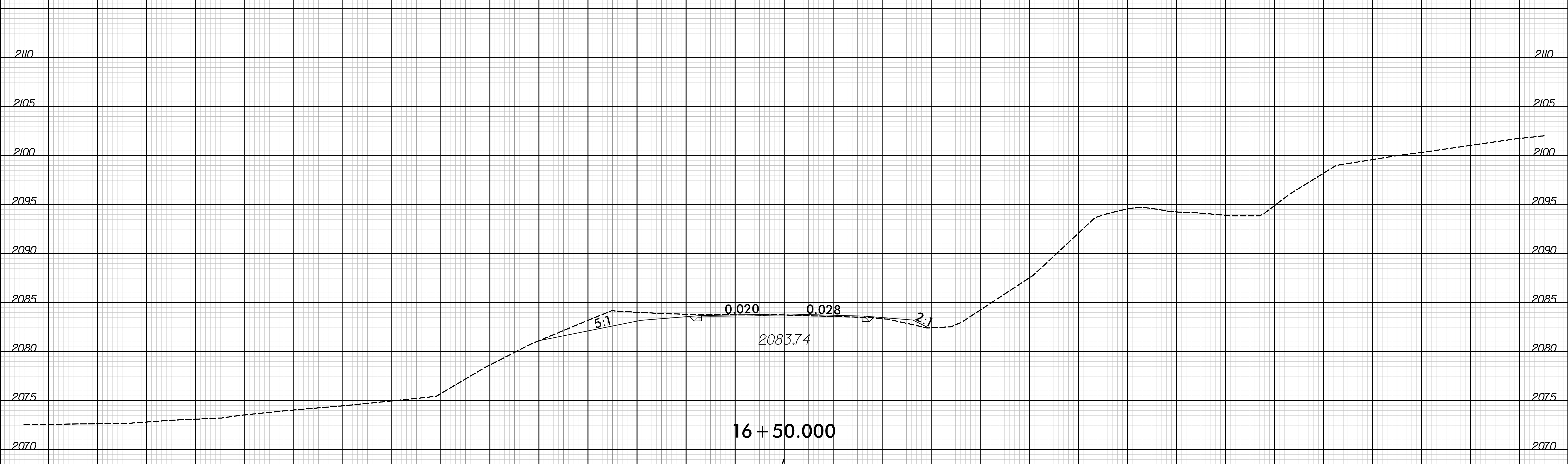
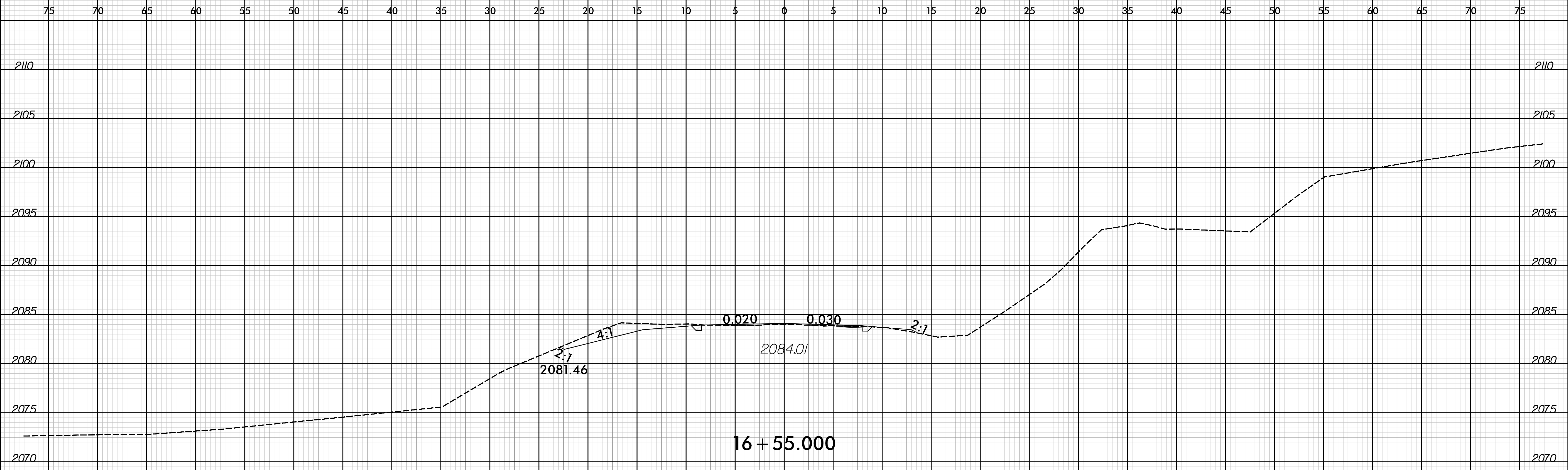

10/23/2017 8:40:06 PM xPL.dgn

6/23/16



PROJ. REFERENCE NO.	SHEET NO.
B-5406	X-9

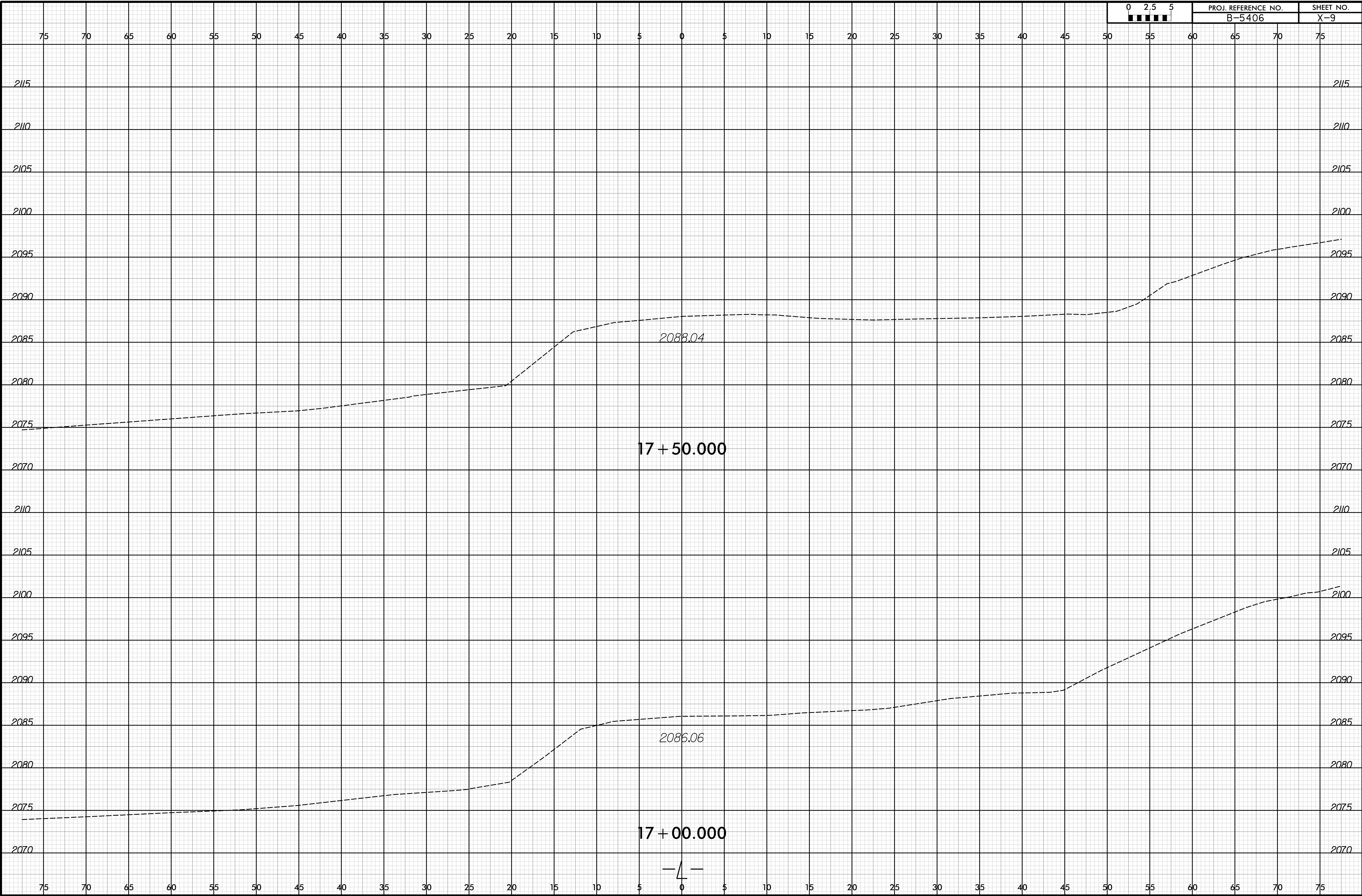

10/23/2017
 B5406_rdy_XPL.dgn
 gprase

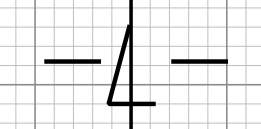

8/23/99



PROJ. REFERENCE NO.
B-5406

SHEET NO.
X-10

75 70 65 60 55 50 45 40 35 30 25 20 15 10 5 0 5 10 15 20 25 30 35 40 45 50 55 60 65 70 75

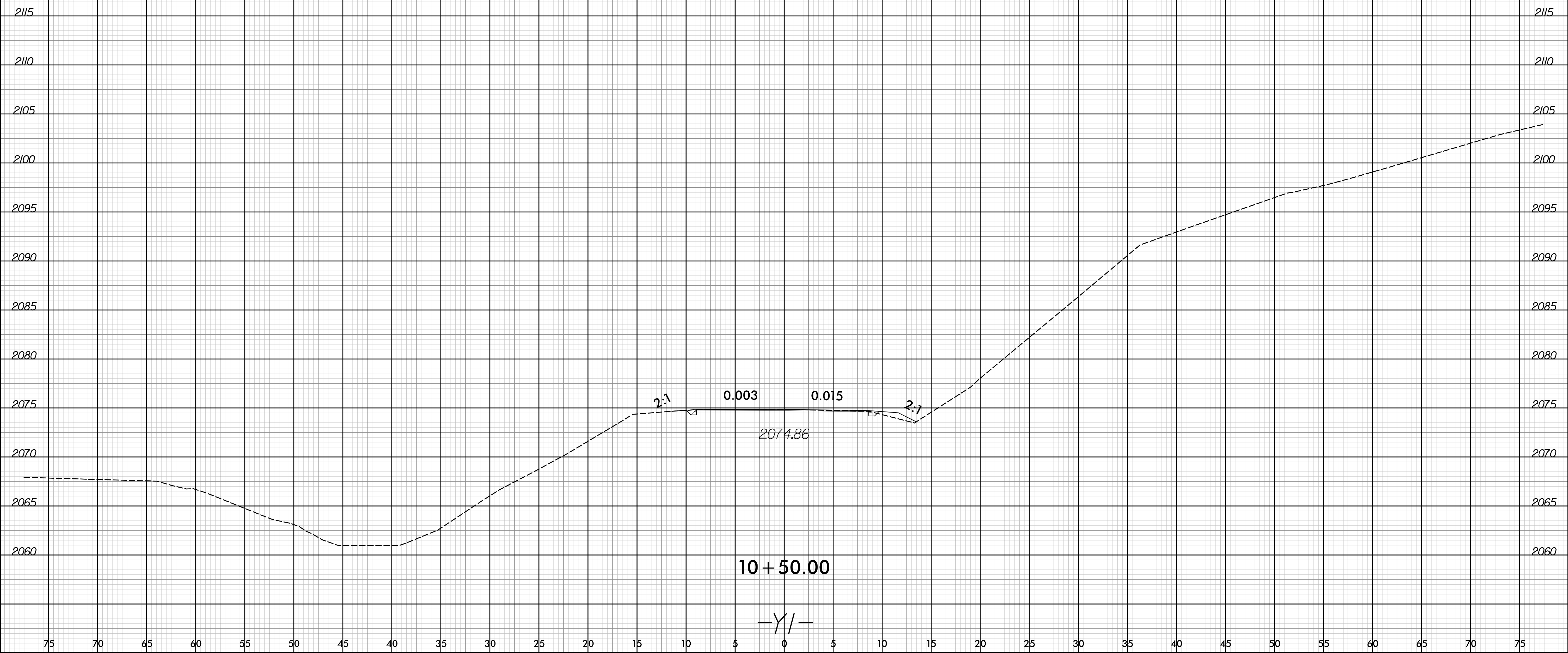

10/23/2011
B5406_rdy_XPL_Y1.dgn
cease

8/23/99



PROJ. REFERENCE NO.
B-5406

SHEET NO.
X-11

75 70 65 60 55 50 45 40 35 30 25 20 15 10 5 0 5 10 15 20 25 30 35 40 45 50 55 60 65 70 75

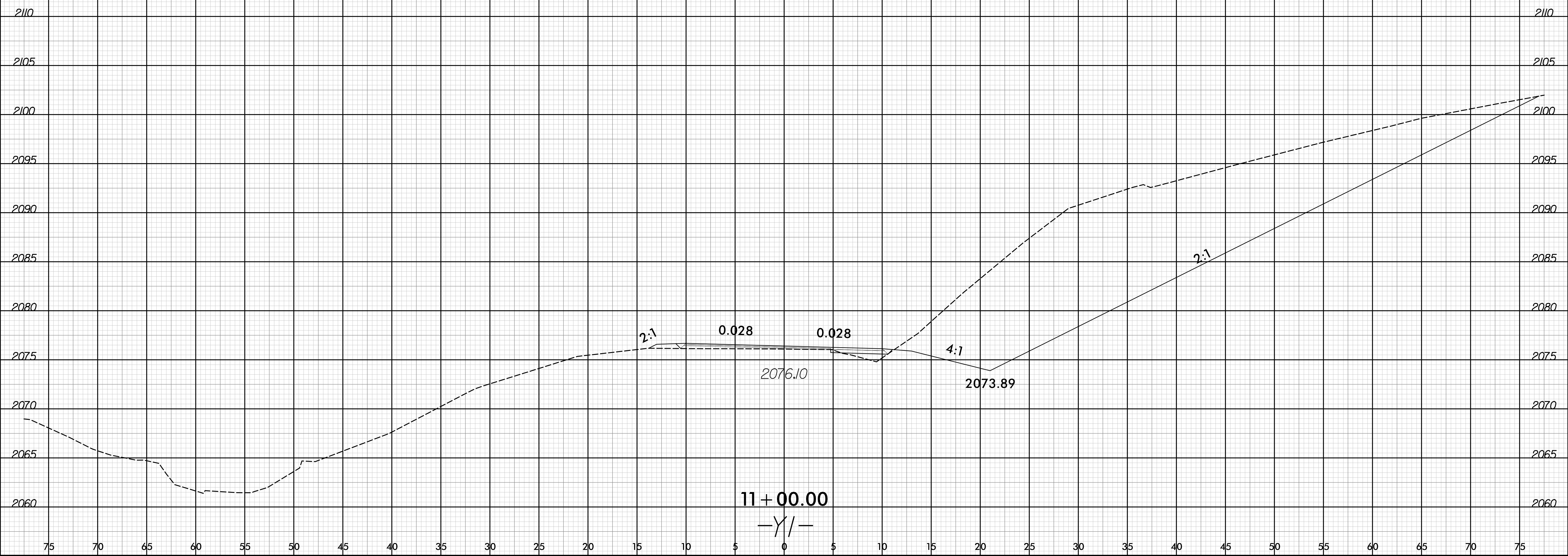

10/23/2011
B5406_rdy_XPL_Y1.dgn
gbase

8/23/99



PROJ. REFERENCE NO.
B-5406

SHEET NO.
X-12

75 70 65 60 55 50 45 40 35 30 25 20 15 10 5 0 5 10 15 20 25 30 35 40 45 50 55 60 65 70 75

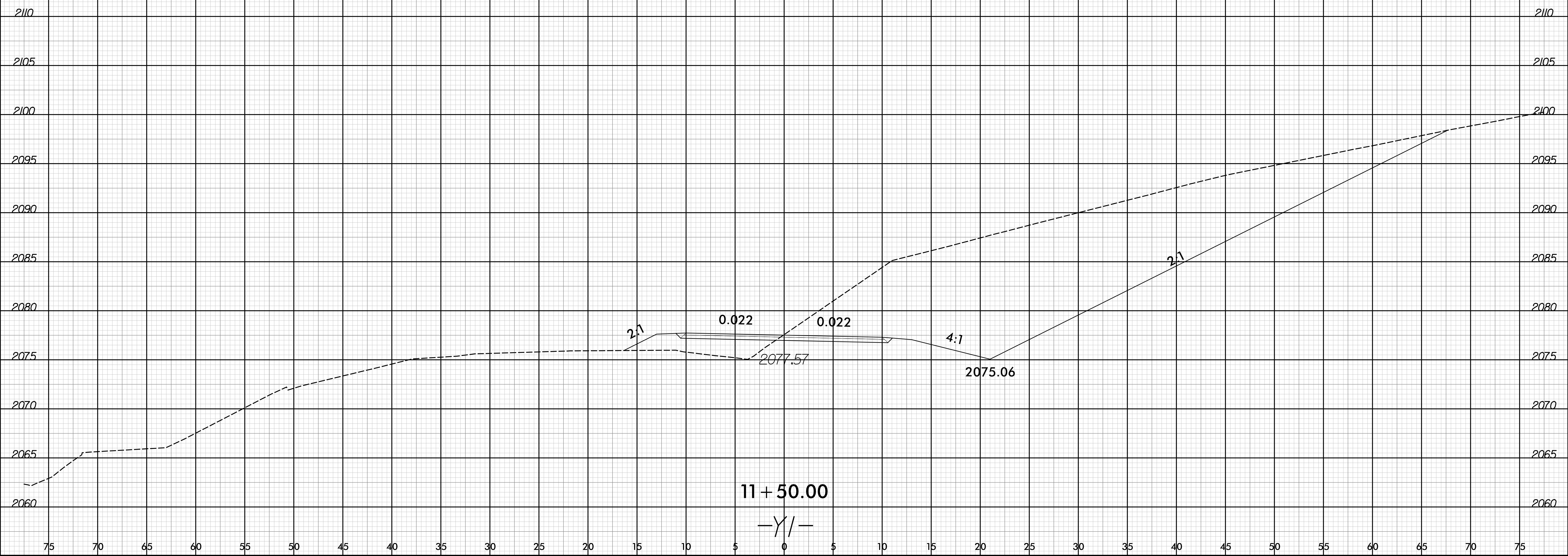

10/23/2011
B5406_rdy_XPL_Y1.dgn
gbase

8/23/99



PROJ. REFERENCE NO.
B-5406

SHEET NO.
X-13

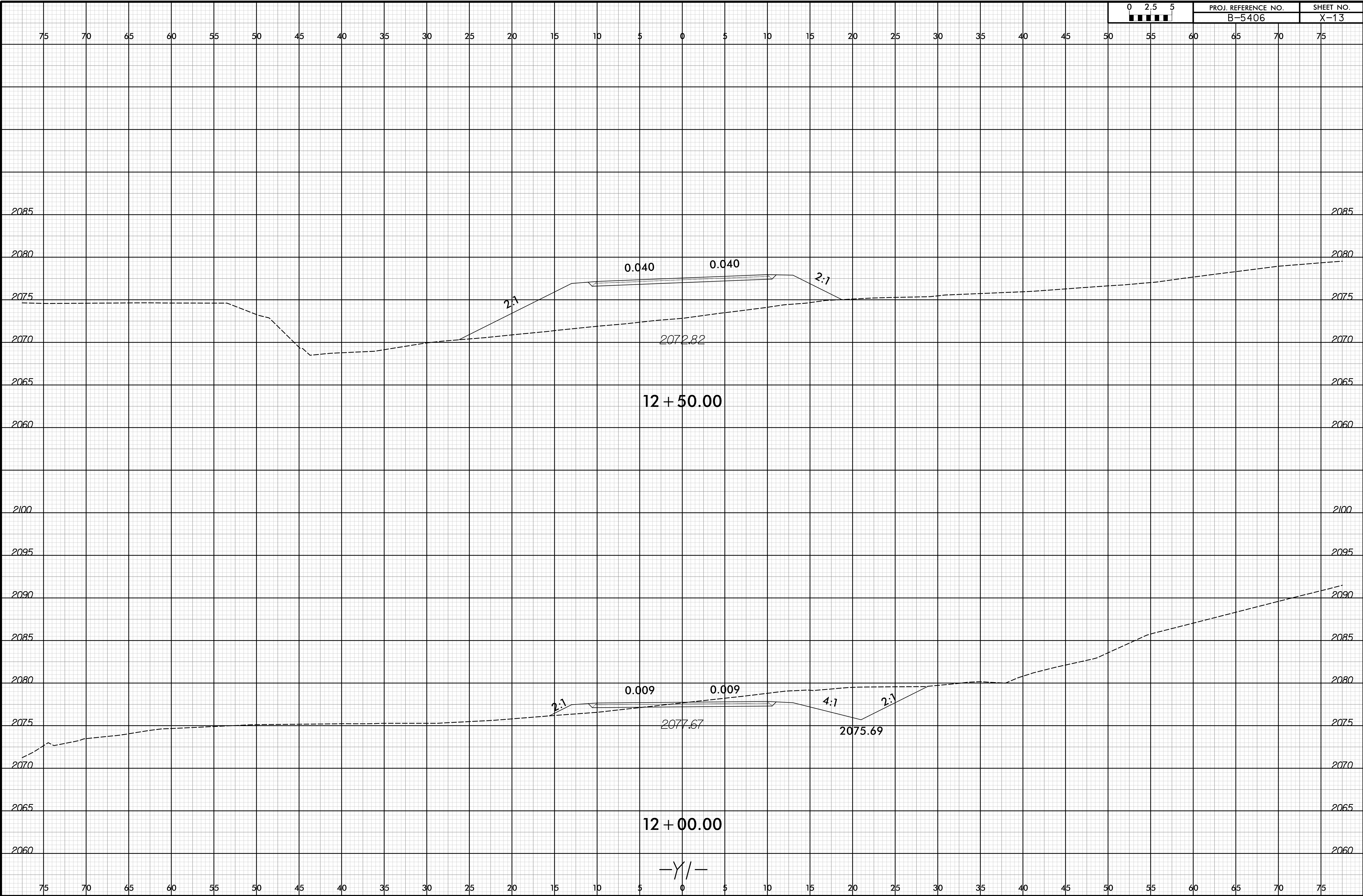

10/23/2011
B5406_rdy_XPL_Y1.dgn
gause

8/23/99



PROJ. REFERENCE NO.
B-5406

SHEET NO.
X-14

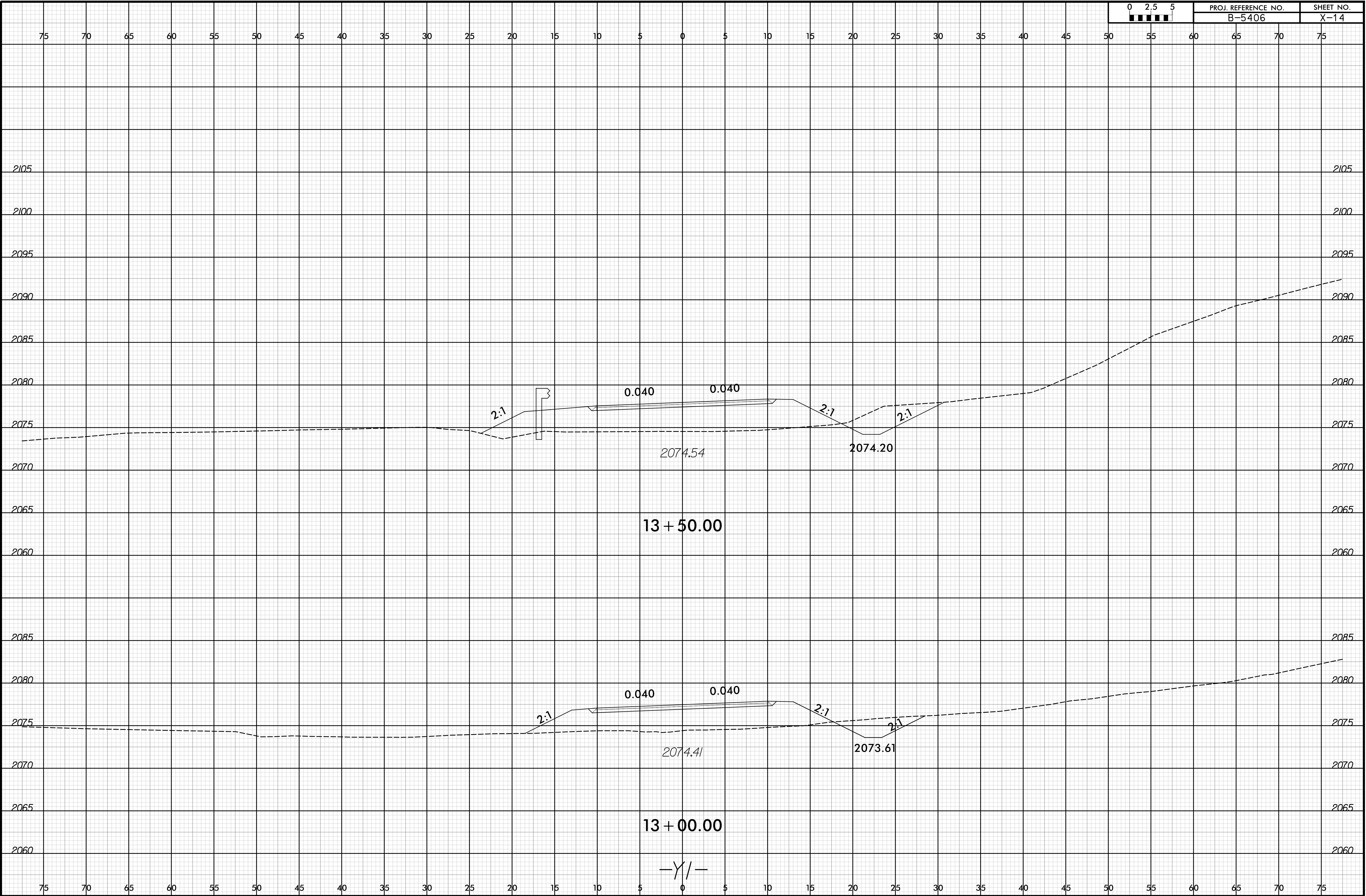

10/23/2011
B5406_rdy_XPL_Y1.dgn
gbase

8/23/99



PROJ. REFERENCE NO.
B-5406

SHEET NO.
X-15

75 70 65 60 55 50 45 40 35 30 25 20 15 10 5 0 5 10 15 20 25 30 35 40 45 50 55 60 65 70 75

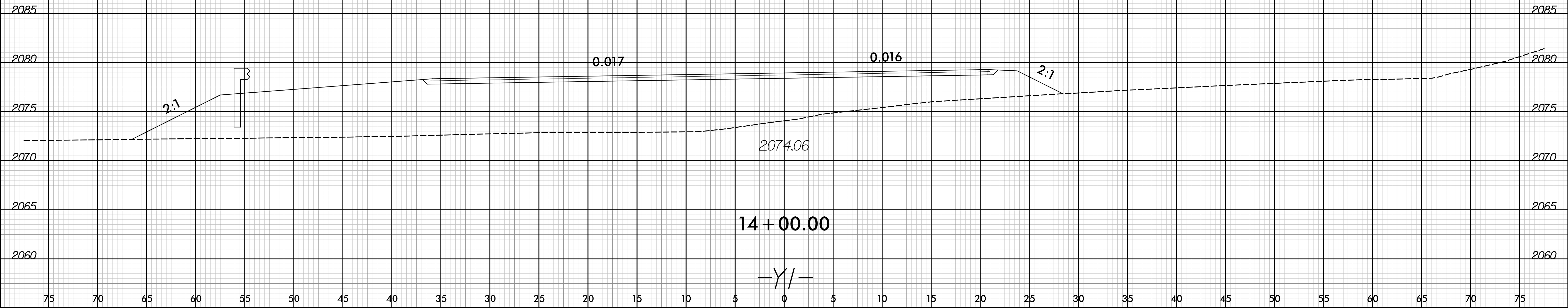

10/23/2011
B5406_rdy_XPL_Y1.dgn
gbase

8/23/99



PROJ. REFERENCE NO.
B-5406

SHEET NO.
X-16

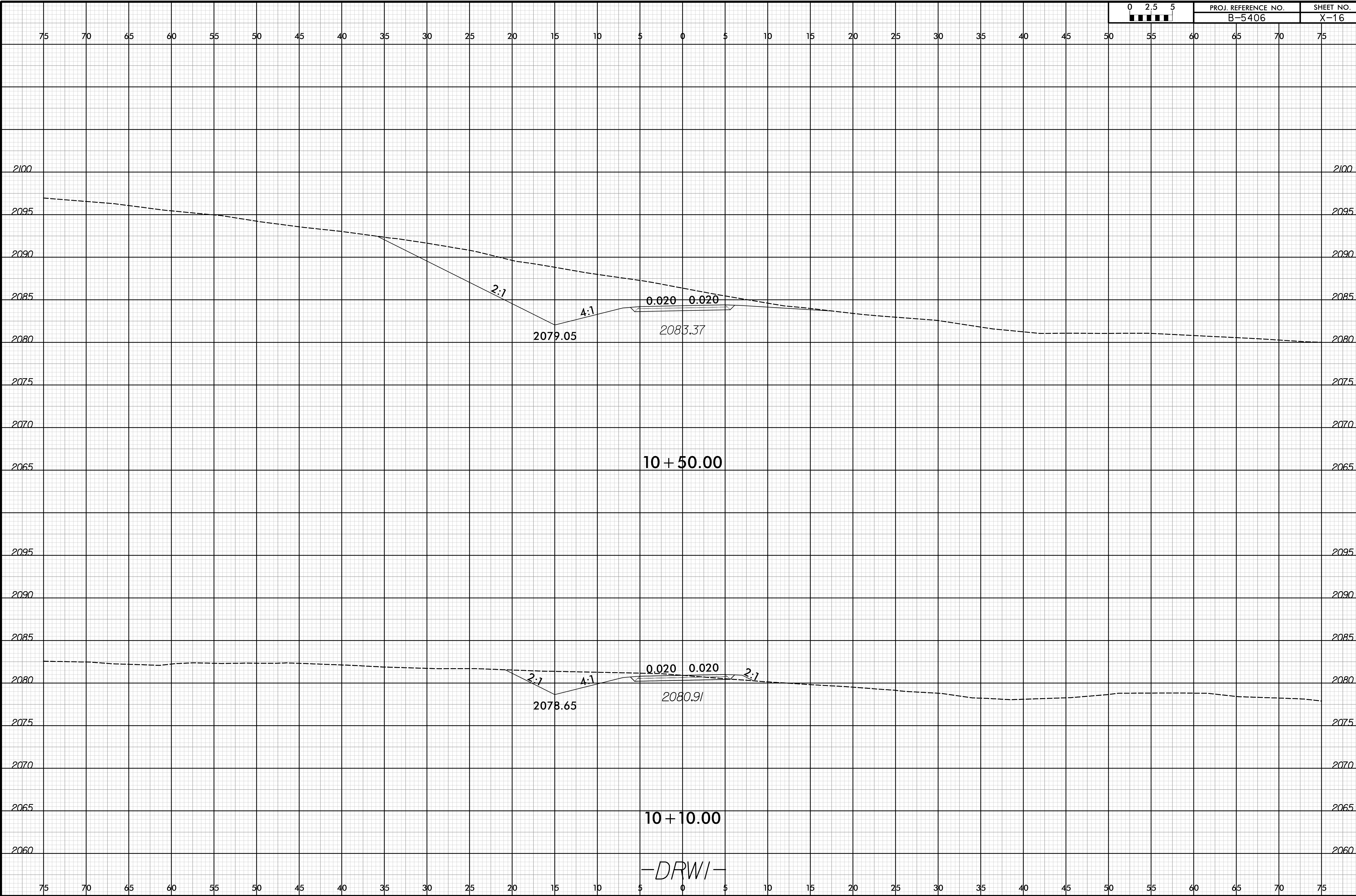

10/23/2011
B5406_rdy_XPL_DRWI.dgn
gbase

8/23/99



PROJ. REFERENCE NO.
B-5406

SHEET NO.
X-17

75 70 65 60 55 50 45 40 35 30 25 20 15 10 5 0 5 10 15 20 25 30 35 40 45 50 55 60 65 70 75

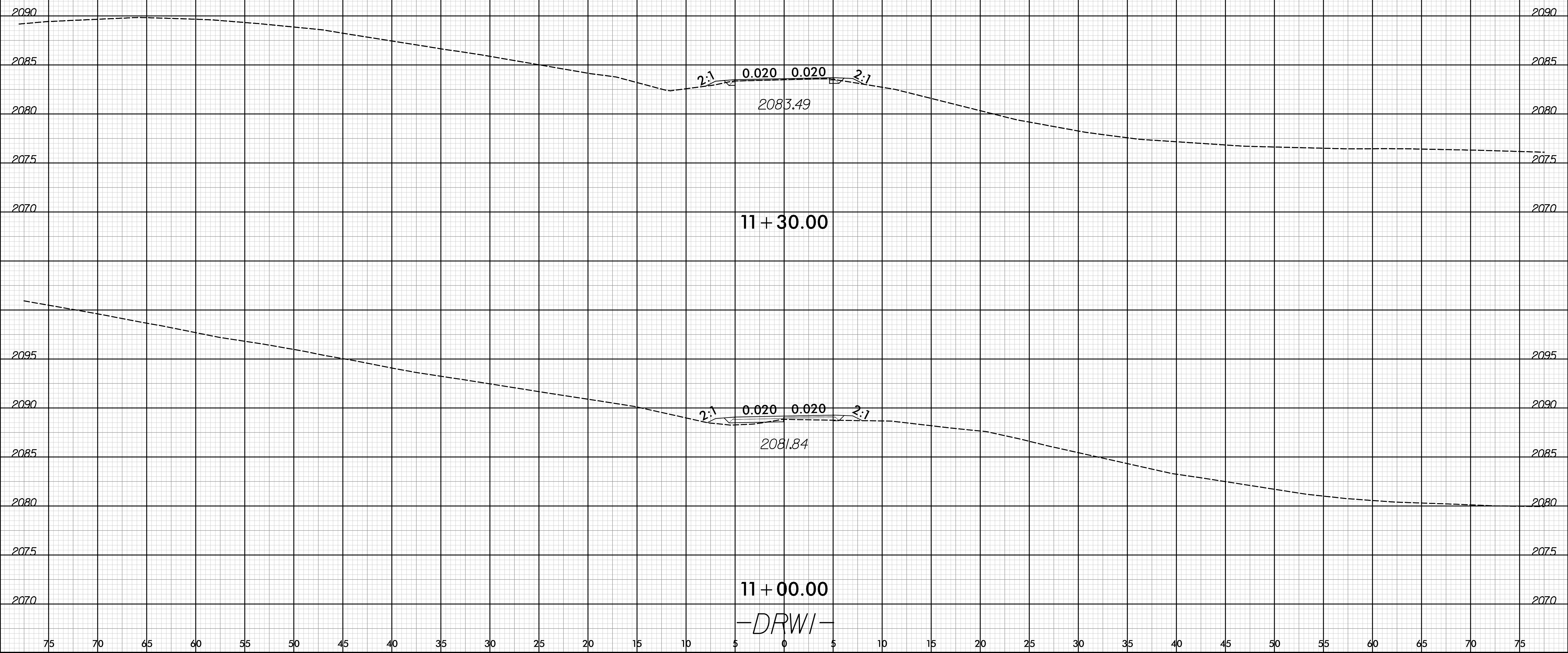

10/23/2011
B5406_rdy_XPL_DRWI.dgn
gbase

75 70 65 60 55 50 45 40 35 30 25 20 15 10 5 0 5 10 15 20 25 30 35 40 45 50 55 60 65 70 75