

**This electronic collection of documents is provided
for the convenience of the user
and is Not a Certified Document –**

**The documents contained herein were originally issued
and sealed by the individuals whose names and license
numbers appear on each page, on the dates appearing
with their signature on that page.**

**This file or an individual page
shall not be considered a certified document.**

STATE OF NORTH CAROLINA
DIVISION OF HIGHWAYS

TRANSPORTATION MANAGEMENT PLAN

SAMPSON COUNTY

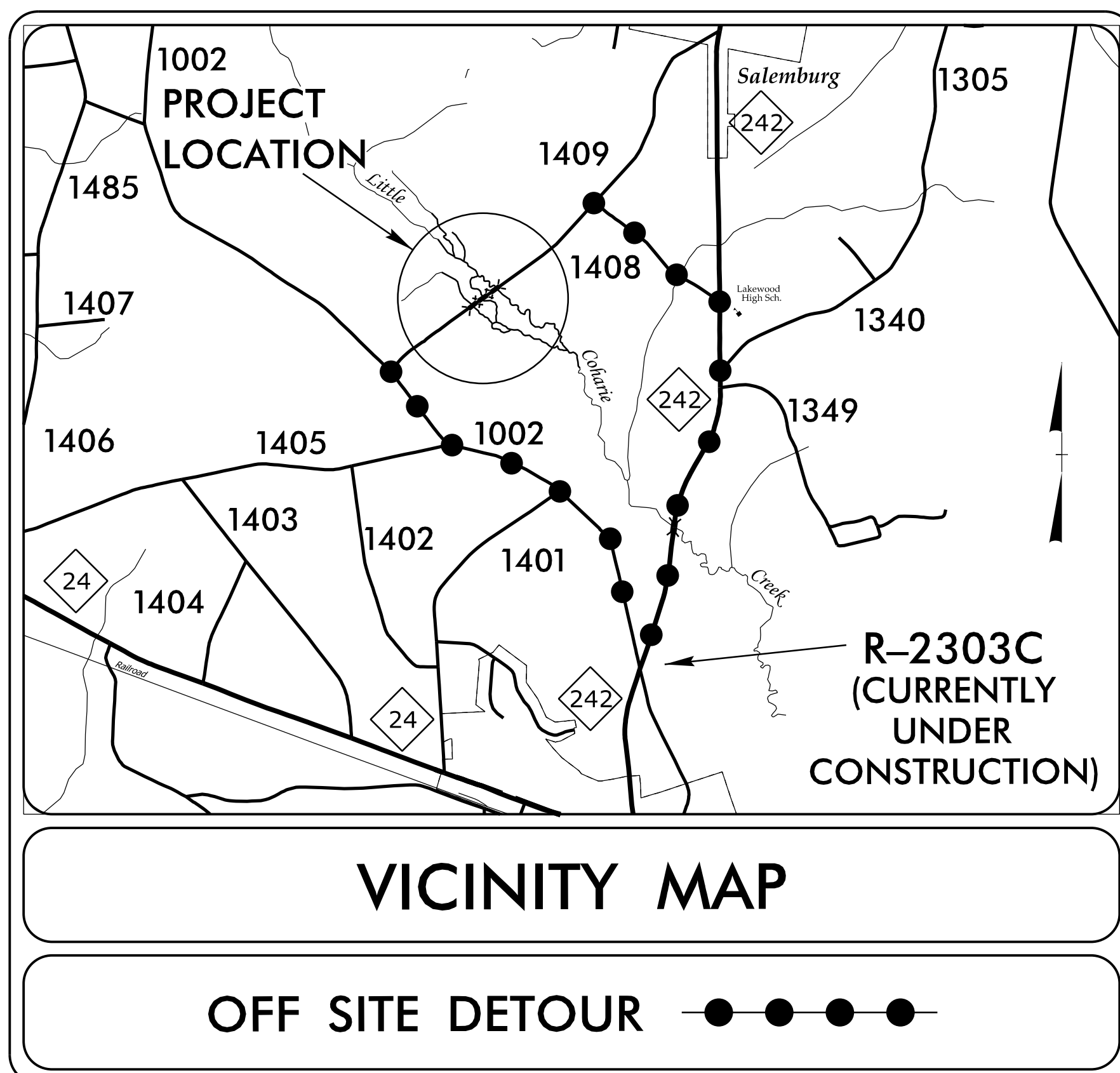
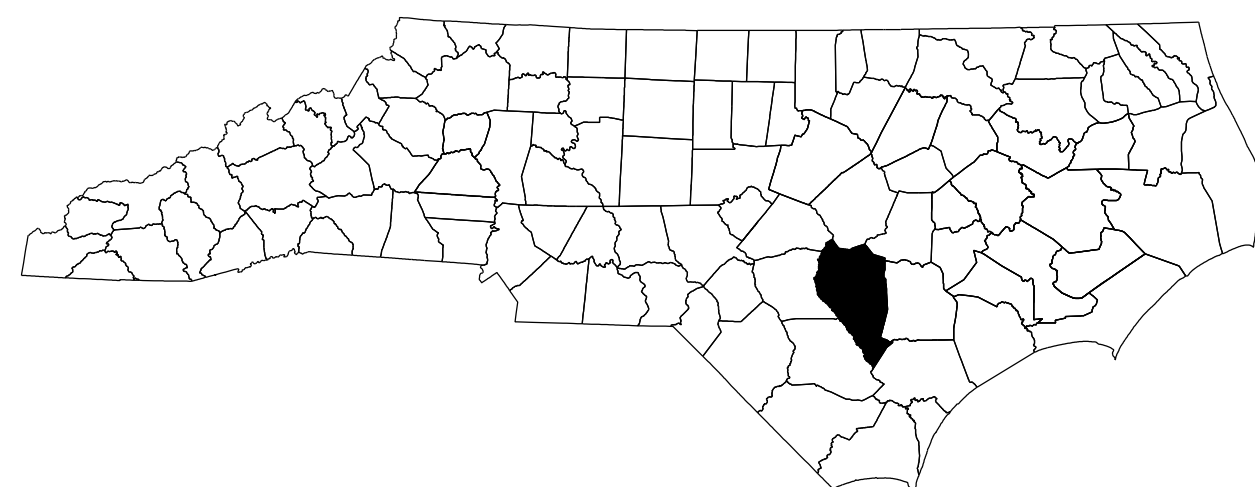

LOCATION: BRIDGES 325 AND 326 OVER LITTLE COHARIE CREEK OVERFLOW AND BRIDGE 327 OVER LITTLE COHARIE CREEK ON SR 1409 (OLD SALEMURG RD)

ATKINS 1616 EAST MILLBROOK ROAD, SUITE 160
RALEIGH, NORTH CAROLINA 27609
(919) 876-6888 NCBEES #F-0326

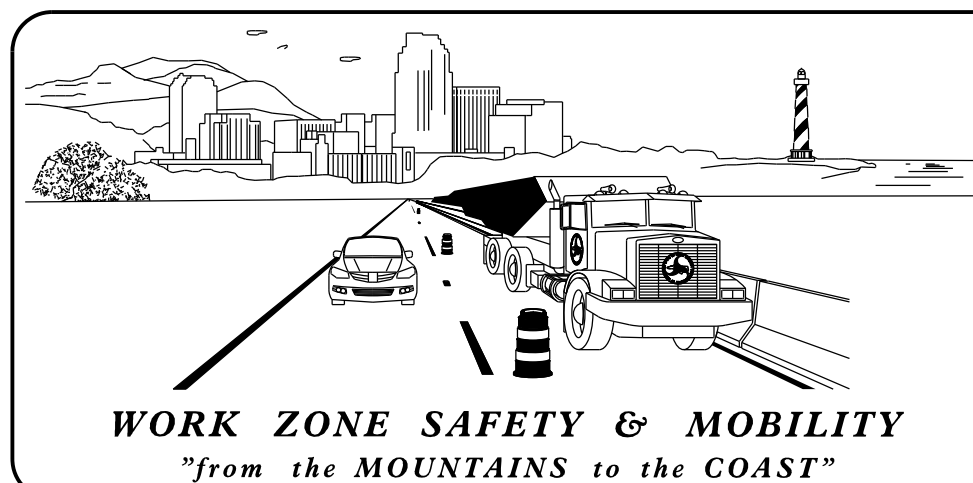

N.C.D.O.T. WORK ZONE TRAFFIC CONTROL
1561 MAIL SERVICE CENTER (MSC) RALEIGH, NC 27699-1561
750 N. GREENFIELD PARKWAY, GARNER, NC 27529 (DELIVERY)
PHONE: (919) 773-2800 FAX: (919) 771-2745

J. S. BOURNE, P.E. STATE TRAFFIC MANAGEMENT ENGINEER
J. STEVE KITE, P.E. TRAFFIC CONTROL PROJECT ENGINEER
MATT SPRINGER, P.E. TRAFFIC CONTROL PROJECT DESIGN ENGINEER
TRAFFIC CONTROL DESIGN ENGINEER



**DOCUMENT NOT CONSIDERED FINAL
UNLESS ALL SIGNATURES COMPLETED**

APPROVED: *Lori D. Stouckho*
DATE: 4/3/2017

SEAL

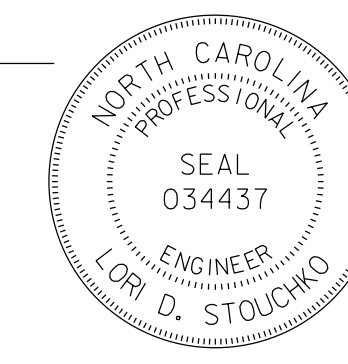

INDEX OF SHEETS

SHEET NO.	TITLE
TMP-1	TITLE SHEET, VICINITY MAP, AND INDEX OF SHEETS
TMP-1A	LIST OF APPLICABLE ROADWAY STANDARD DRAWINGS, LEGEND, GENERAL NOTES, AND PHASING
TMP-2	SPECIAL SIGN DESIGN
TMP-3	TEMPORARY TRAFFIC CONTROL - OFF-SITE DETOUR AND DETOUR SIGNS

SHEET NO.
TMP-1

TIP PROJECT: B-4637

ROADWAY STANDARD DRAWINGS

THE FOLLOWING ROADWAY STANDARDS AS SHOWN IN "ROADWAY STANDARD DRAWINGS" - PROJECT SERVICES UNIT - N.C. DEPARTMENT OF TRANSPORTATION - RALEIGH, N.C., DATED JANUARY 2012 ARE APPLICABLE TO THIS PROJECT AND BY REFERENCE HEREBY ARE CONSIDERED A PART OF THESE PLANS:

STD. NO.	TITLE
1101.01	WORK ZONE ADVANCE WARNING SIGNS
1101.03	TEMPORARY ROAD CLOSURES
1101.11	TRAFFIC CONTROL DESIGN TABLES
1110.01	STATIONARY WORK ZONE SIGNS
1145.01	BARRICADES

LEGEND

GENERAL

- DIRECTION OF TRAFFIC FLOW
- DIRECTION OF PEDESTRIAN TRAFFIC FLOW
- EXIST. PVMT.
- NORTH ARROW
- PROPOSED PVMT.
- TEMP. SHORING (LOCATION PURPOSES ONLY)
- WORK AREA
- REMOVAL
- USER DEFINED (IF NEEDED)
- USER DEFINED (IF NEEDED)

TRAFFIC CONTROL DEVICES

- BARRICADE (TYPE III)
- CONE
- DRUM SKINNY DRUM TUBULAR MARKER
- TEMPORARY CRASH CUSHION
- FLASHING ARROW BOARD
- FLAGGER
- LAW ENFORCEMENT
- TRUCK MOUNTED ATTENUATOR (TMA)
- CHANGEABLE MESSAGE SIGN

TEMPORARY SIGNING

- PORTABLE SIGN
- STATIONARY SIGN
- STATIONARY OR PORTABLE SIGN

GENERAL NOTES

CHANGES MAY BE REQUIRED WHEN PHYSICAL DIMENSIONS IN THE DETAIL DRAWINGS, STANDARD DETAILS AND ROADWAY DETAILS ARE NOT ATTAINABLE TO MEET FIELD CONDITIONS OR RESULT IN DUPLICATE OR UNDESIRE OVERLAPPING OF DEVICES. MODIFICATION MAY INCLUDE: MOVING, SUPPLEMENTING, COVERING, OR REMOVAL OF DEVICES AS DIRECTED BY THE ENGINEER.

THE FOLLOWING GENERAL NOTES APPLY AT ALL TIMES FOR THE DURATION OF THE CONSTRUCTION PROJECT EXCEPT WHEN OTHERWISE NOTED IN THE PLAN OR DIRECTED BY THE ENGINEER.

TRAFFIC PATTERN ALTERATIONS

- A) NOTIFY THE ENGINEER TWENTY ONE (21) CALENDAR DAYS PRIOR TO ANY TRAFFIC PATTERN ALTERATION.

SIGNING

- B) INSTALL ADVANCED WORK ZONE WARNING SIGNS WHEN WORK IS WITHIN 40 FT FROM THE EDGE OF TRAVEL LANE AND NO MORE THAN THREE (3) DAYS PRIOR TO THE BEGINNING OF CONSTRUCTION.

- C) PROVIDE SIGNING AND DEVICES REQUIRED TO CLOSE THE ROAD ACCORDING TO THE ROADWAY STANDARD DRAWINGS AND TRAFFIC CONTROL PLANS.

PROVIDE SIGNING REQUIRED FOR THE OFF-SITE DETOUR ROUTE AS SHOWN IN THE TRAFFIC CONTROL PLANS.

- D) COVER OR REMOVE ALL SIGNS AND DEVICES REQUIRED TO CLOSE THE ROAD WHEN ROAD CLOSURE IS NOT IN OPERATION.

COVER OR REMOVE ALL SIGNS AND DEVICES REQUIRED FOR THE OFF-SITE DETOUR WHEN THE DETOUR IS NOT IN OPERATION.

- E) ENSURE ALL NECESSARY SIGNING IS IN PLACE PRIOR TO ALTERING ANY TRAFFIC PATTERN.

TRAFFIC CONTROL DEVICES

- F) PLACE TYPE III BARRICADES, WITH "ROAD CLOSED" SIGN R11-2 ATTACHED, OF SUFFICIENT LENGTH TO CLOSE ENTIRE ROAD.

PAVEMENT MARKINGS AND MARKERS

- G) TIE PROPOSED PAVEMENT MARKING LINES TO EXISTING PAVEMENT MARKING LINES.
- H) REMOVE/REPLACE ANY CONFLICTING/DAMAGED PAVEMENT MARKINGS.

PHASING

- STEP 1: INSTALL ALL DETOUR SIGNING, KEEPING SIGNS COVERED PRIOR TO CLOSING SR 1409 TO TRAFFIC. (SEE SHEET TMP-3)
- STEP 2: USING ROADWAY STANDARD DRAWING 1101.03, SHEET 1 OF 9, CLOSE SR 1409 TO TRAFFIC, UNCOVER ALL DETOUR SIGNING AND SHIFT TRAFFIC TO DETOUR (SEE SHEET TMP-3). RELOCATE, AS NECESSARY, DETOUR SIGNS AT THE INTERSECTION OF SR 1002 (DUNN RD) AND NC 242 IN COORDINATION WITH THE REALIGNMENT OF THE INTERSECTION BEING COMPLETED IN TIP R-2303C.
- STEP 3: DISMANTLE AND REMOVE EXISTING BRIDGES
- STEP 4: COMPLETE CONSTRUCTION OF PROPOSED STRUCTURES, APPROACH ROADWAY TIE-INS AND ASSOCIATED ITEMS INCLUDING FINAL PAVEMENT MARKINGS AND MARKERS.
- STEP 5: REMOVE ALL DETOUR SIGNING, ALL TEMPORARY TRAFFIC CONTROL DEVICES AND OPEN SR 1409 TO TRAFFIC.

4/3/2017 02:11:00 User:STOU7940 C:\Users\STOU7940\Documents\Transportation\Traffic\NCDOT 10 Bridges\TMP\00053587 - B-4637 TMP Bridge Replace 587\TrafficControl\TCP\B-4637 TCP 01A.dgn

APPROVED: DocuSigned by: Lori D. Stouchko F70F17C3324468...

DATE: 4/3/2017

**DOCUMENT NOT CONSIDERED FINAL
 UNLESS ALL SIGNATURES COMPLETED**

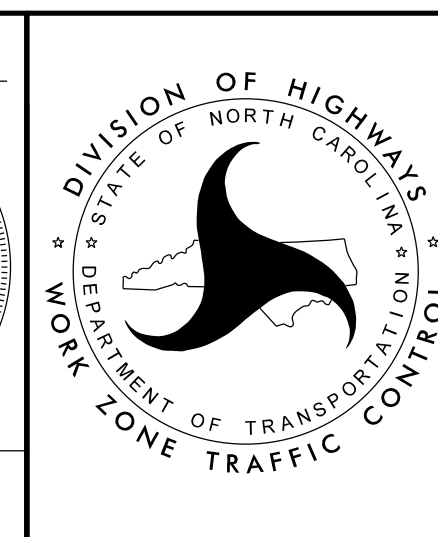

SIGN NUMBER: SP1 TYPE: STATIONARY QUANTITY: SEE PLANS SIGN WIDTH: 3'-0" HEIGHT: 2'-0" TOTAL AREA: 6.1 Sq.Ft. BORDER TYPE: INSET RECESS: 0.38" WIDTH: 0.5" RADII: 1.5" NO. Z BARS: LENGTH:	BACKG COLOR: Fluorescent Orange COPY COLOR: Black <table border="1" style="width: 100%; text-align: center;"> <tr> <th>SYMBOL</th> <th>X</th> <th>Y</th> <th>WID</th> <th>HT</th> </tr> <tr><td> </td><td> </td><td> </td><td> </td><td> </td></tr> <tr><td> </td><td> </td><td> </td><td> </td><td> </td></tr> <tr><td> </td><td> </td><td> </td><td> </td><td> </td></tr> <tr><td> </td><td> </td><td> </td><td> </td><td> </td></tr> <tr><td> </td><td> </td><td> </td><td> </td><td> </td></tr> <tr><td> </td><td> </td><td> </td><td> </td><td> </td></tr> <tr><td> </td><td> </td><td> </td><td> </td><td> </td></tr> <tr><td> </td><td> </td><td> </td><td> </td><td> </td></tr> <tr><td> </td><td> </td><td> </td><td> </td><td> </td></tr> </table> MAT'L: 0.080" (2.0 mm) ALUMINUM	SYMBOL	X	Y	WID	HT																																														DESIGN BY: LD STOUCKO PROJECT ID: B-4637	CHECKED BY: LOCATION: SAMPSON COUNTY Mar 22, 2017 DIV: 3
SYMBOL	X	Y	WID	HT																																																	

Spacing Factor is 1 unless specified otherwise

LETTER POSITIONS

Letter locations are panel edge to lower left corner

										Series/Size
										Text Length
O	L	D								C 2000
13.1	17	20.3								10
S	A	L	E	M	B	U	R	G		C 2000
2	5.3	9.2	12.4	15.8	20.2	23.9	27.8	31.3		32.2
R	O	A	D							C 2000
11.2	14.7	18.3	22.2							13.8

NORTH CAROLINA D.O.T. SIGN DETAIL

4/3/2017 0:\transportation\Traffic\Curr\NCDOT 10 Bridges TMP\000053587 - B-4637 TMP Bridge Replace 587\Traffic\TrafficControl\TCP\B-4637 TCP 02.dgn User:STOU7940

APPROVED: *Lori D. Stoucko*
 DATE: 4/3/2017

NORTH CAROLINA PROFESSIONAL ENGINEER
 SEAL 034437
 LORI D. STOUCKO

DOCUMENT NOT CONSIDERED FINAL UNLESS ALL SIGNATURES COMPLETED

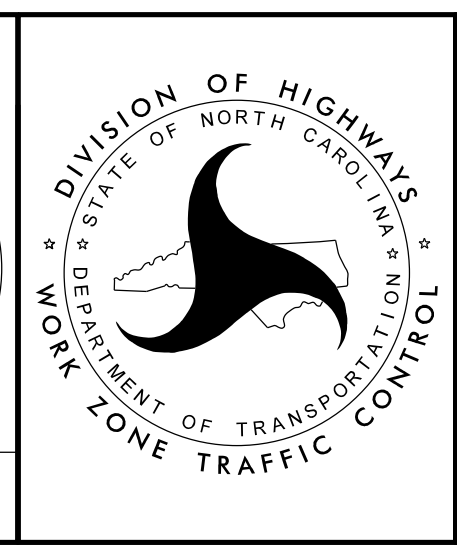

SPECIAL SIGN DESIGN
SR 1409
(OLD SALEMURG ROAD)

4/3/2017 0:\Transportation\Traffic\NCDOT 10 Bridges\TMP\00053587 - B-4637 TMP Bridge Replace 587\TrafficControl\TCP\B-4637 TCP 03.dgn User:STOUT940

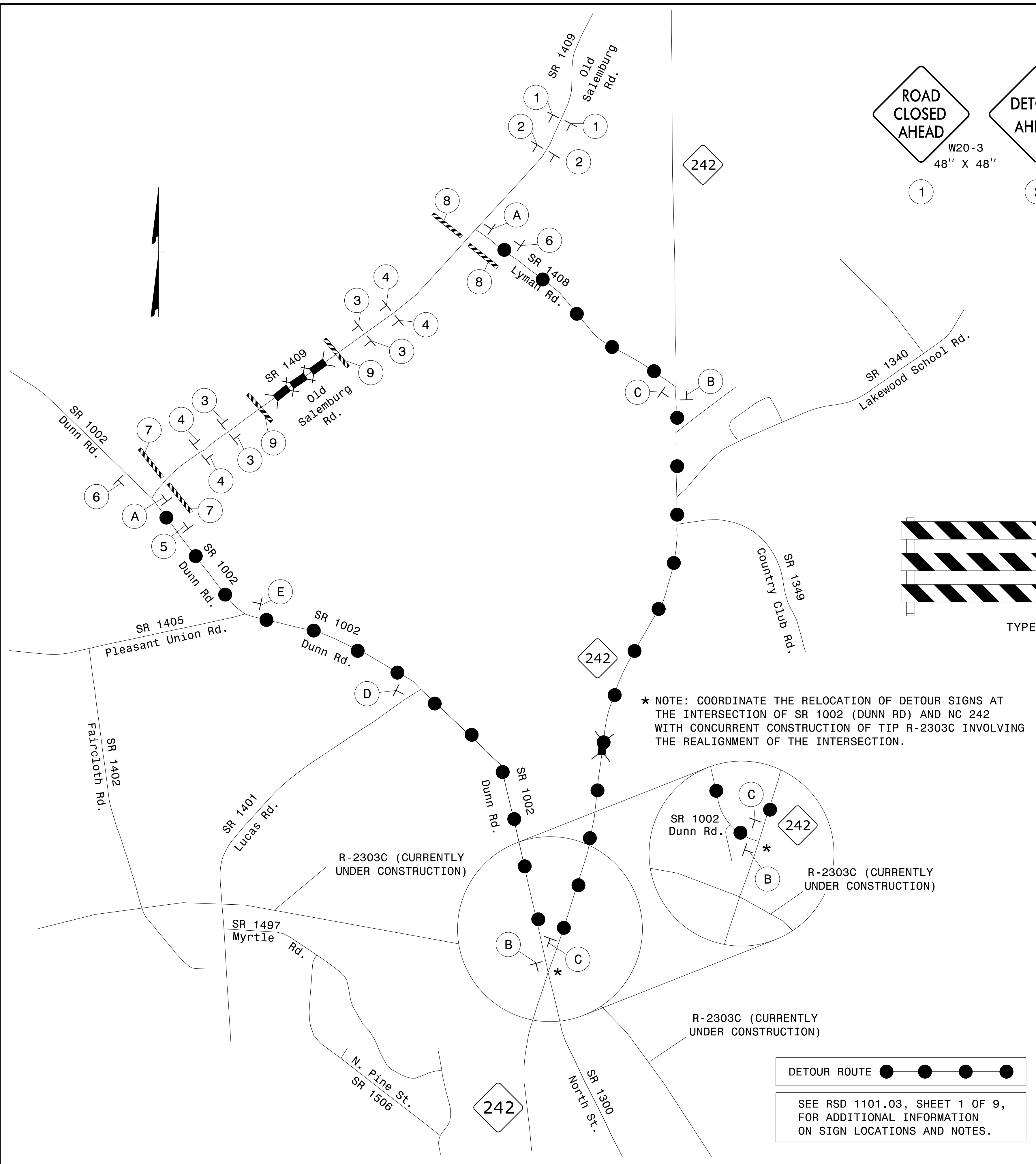

* NOTE: COORDINATE THE RELOCATION OF DETOUR SIGNS AT THE INTERSECTION OF SR 1002 (DUNN RD) AND NC 242 WITH CONCURRENT CONSTRUCTION OF TIP R-2303C INVOLVING THE REALIGNMENT OF THE INTERSECTION.

DETOUR ROUTE ●—●—●—●—●

SEE RSD 1101.03, SHEET 1 OF 9, FOR ADDITIONAL INFORMATION ON SIGN LOCATIONS AND NOTES.

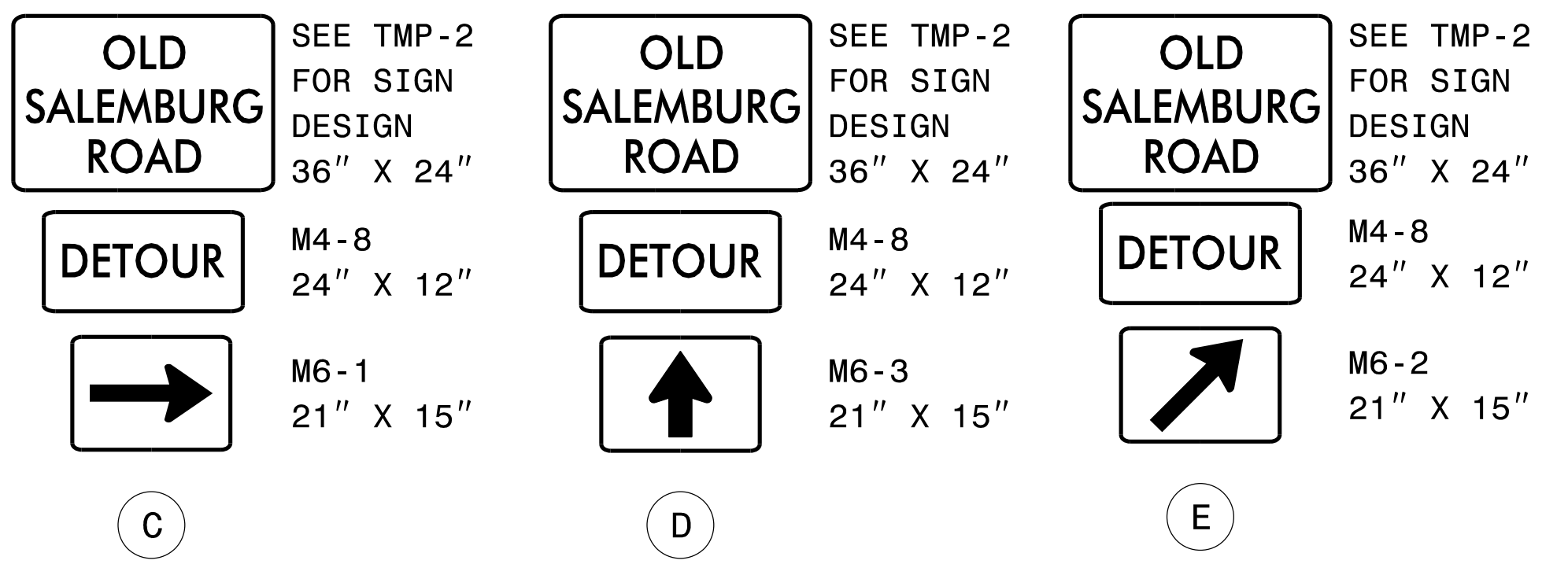
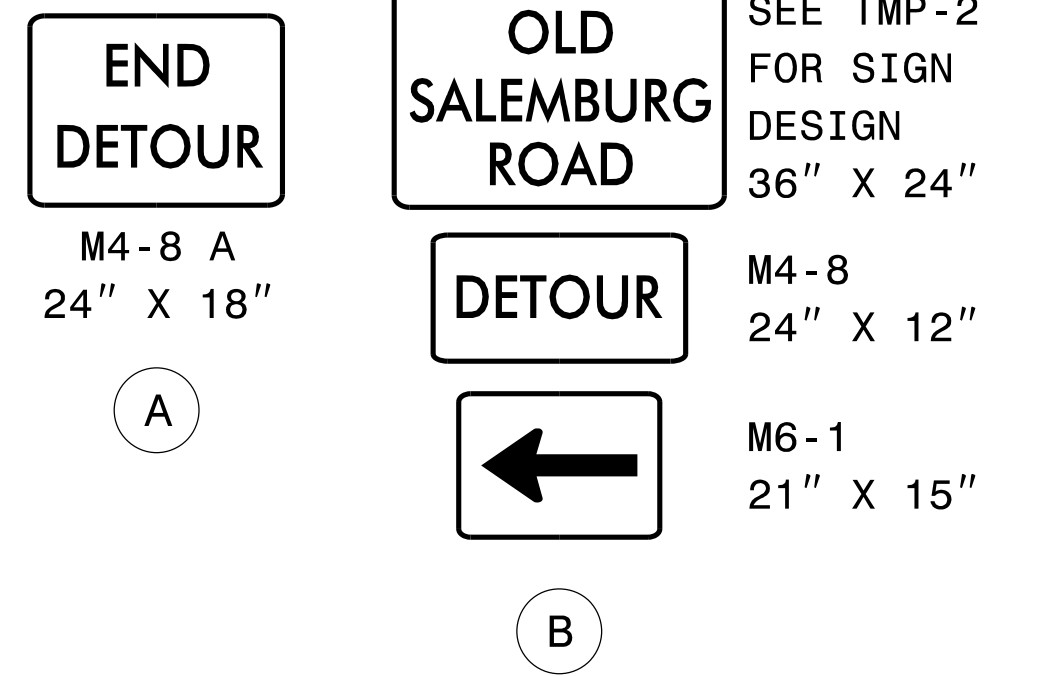
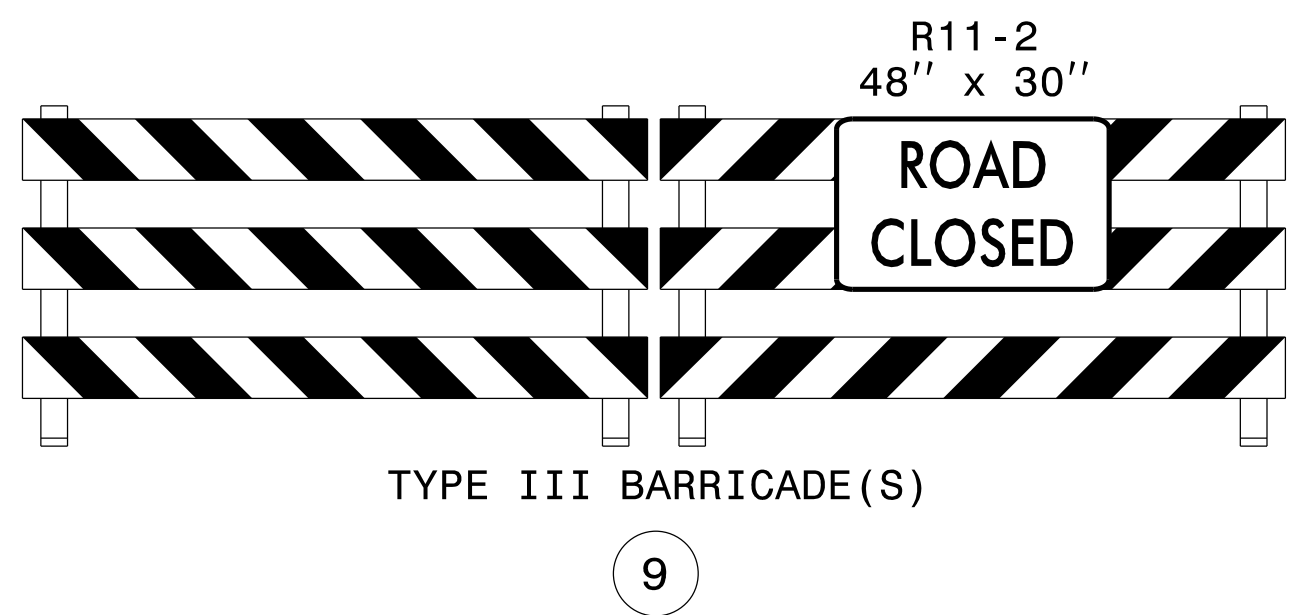
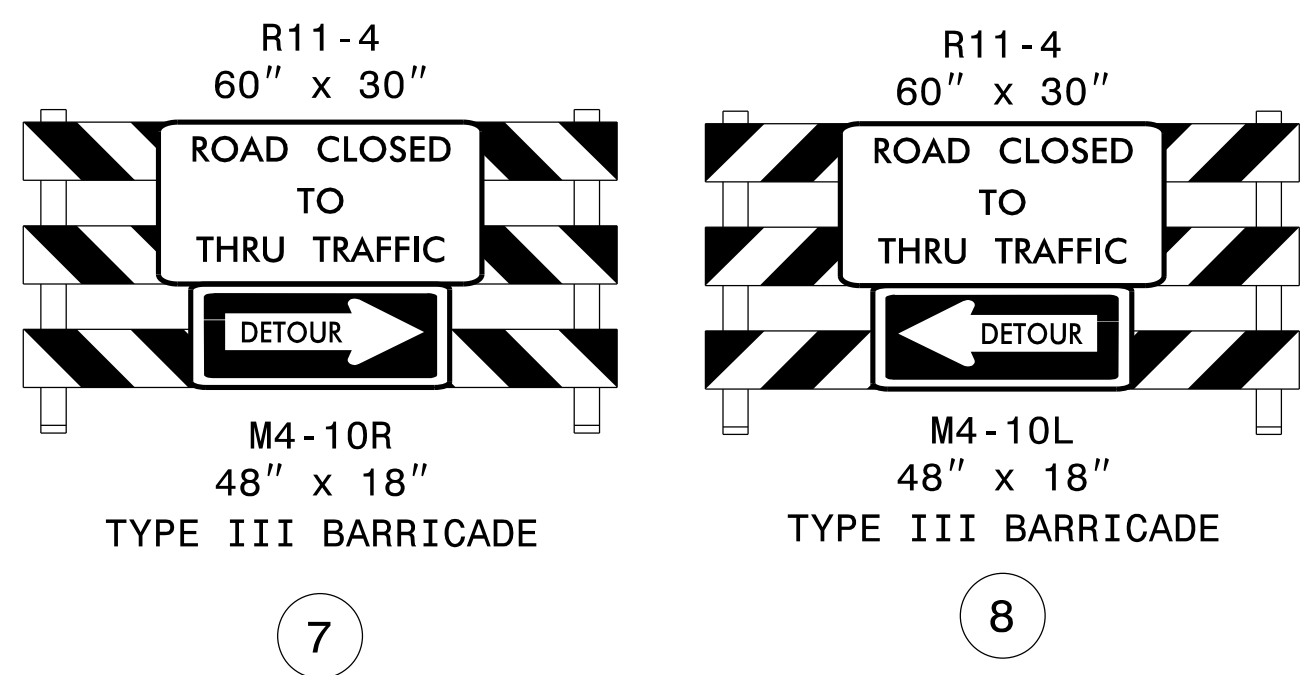
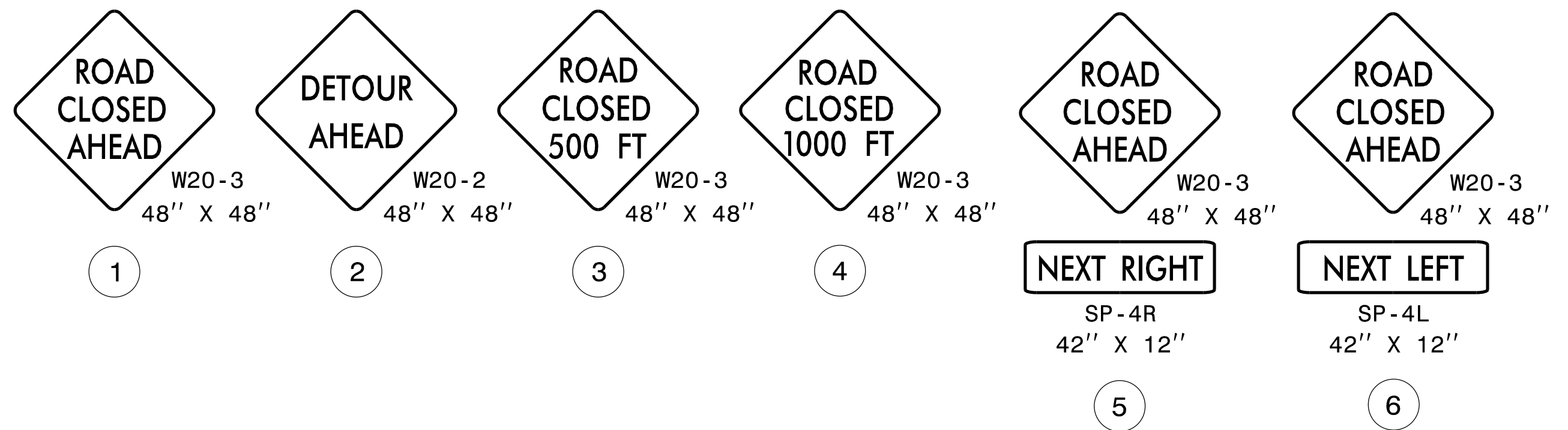

ATKINS 1616 EAST MILLBROOK ROAD, SUITE 160
RALEIGH, NORTH CAROLINA 27609
(919) 876-6888 NCBEES #F-0326

APPROVED: *Lori D. Stouckho*
DATE: 4/3/2017

SEAL
NORTH CAROLINA PROFESSIONAL ENGINEER
LOPI D. STOUCKHO
034437

DOCUMENT NOT CONSIDERED FINAL UNLESS ALL SIGNATURES COMPLETED



OFF-SITE DETOUR AND DETOUR SIGNS
SR 1409
(OLD SALEMBURG ROAD)